

Skipsmodeller.com

Haugsfjell Holdeplass



Laserskåret trebyggesett



Modell: 1:87 Lengde 26 cm bredde 11,8 cm høyde 8,5 cm

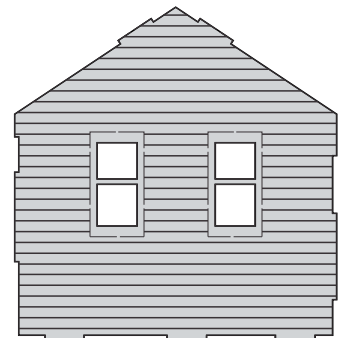
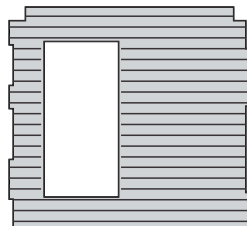
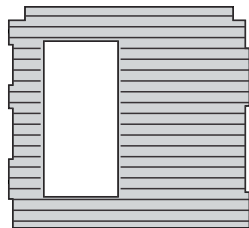
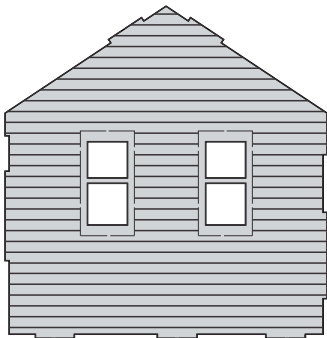
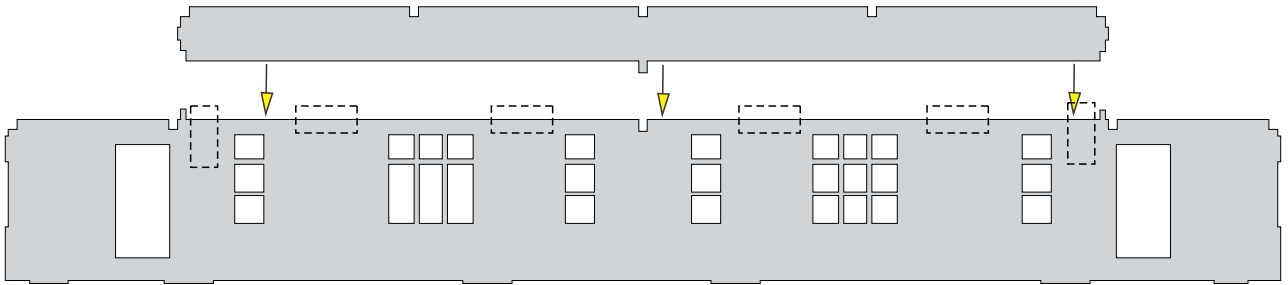
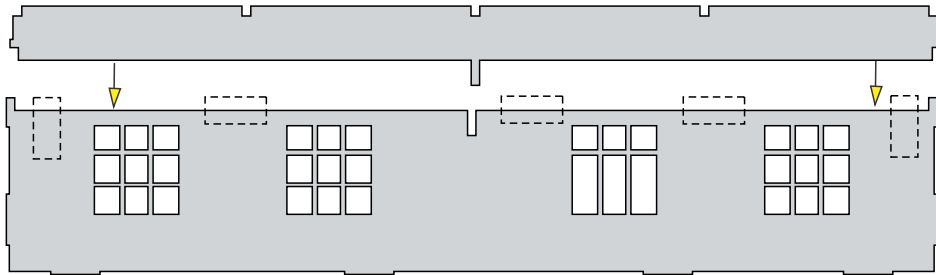
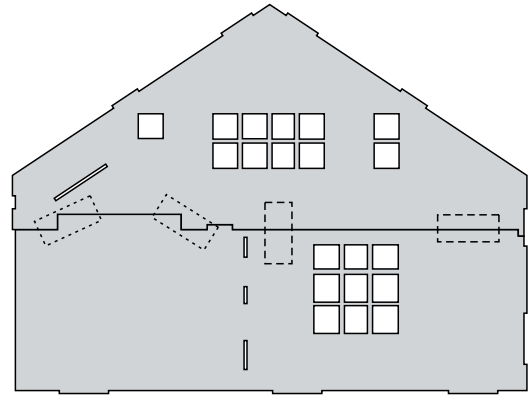
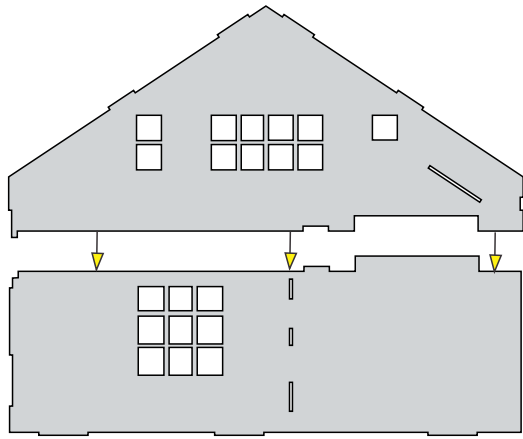

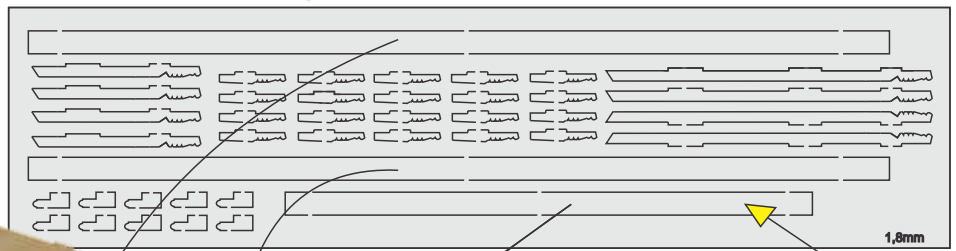

Kuttes til 39mm lengde

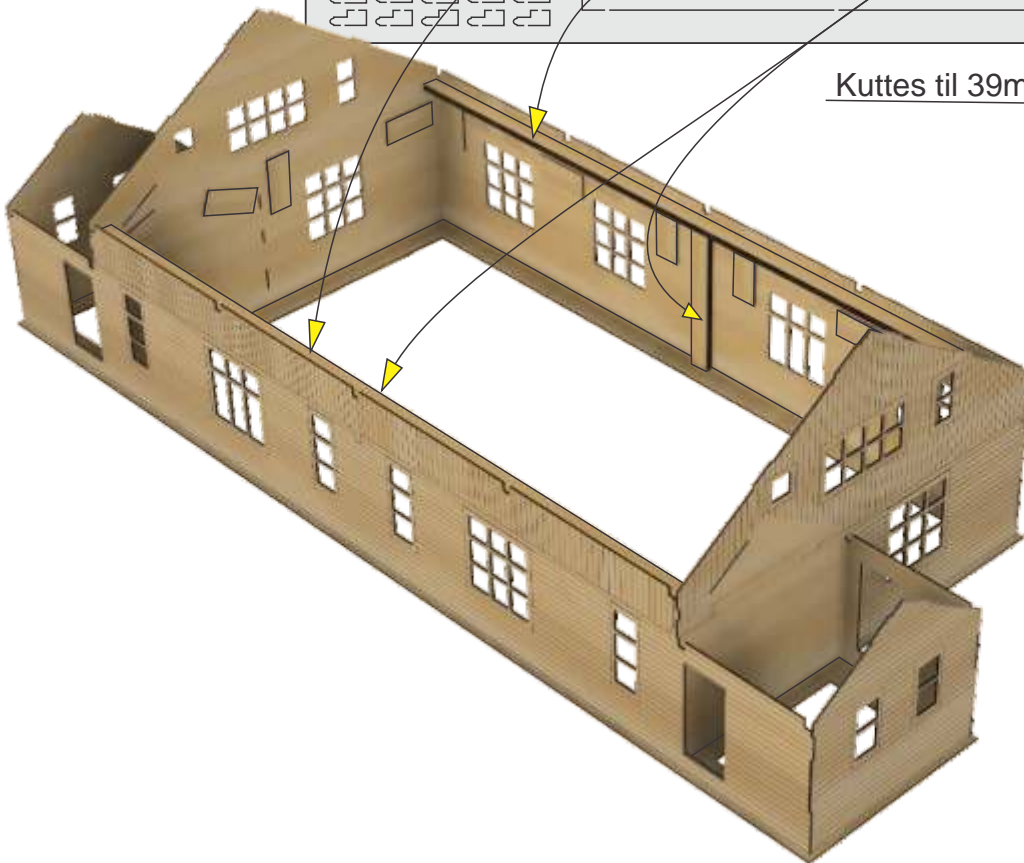

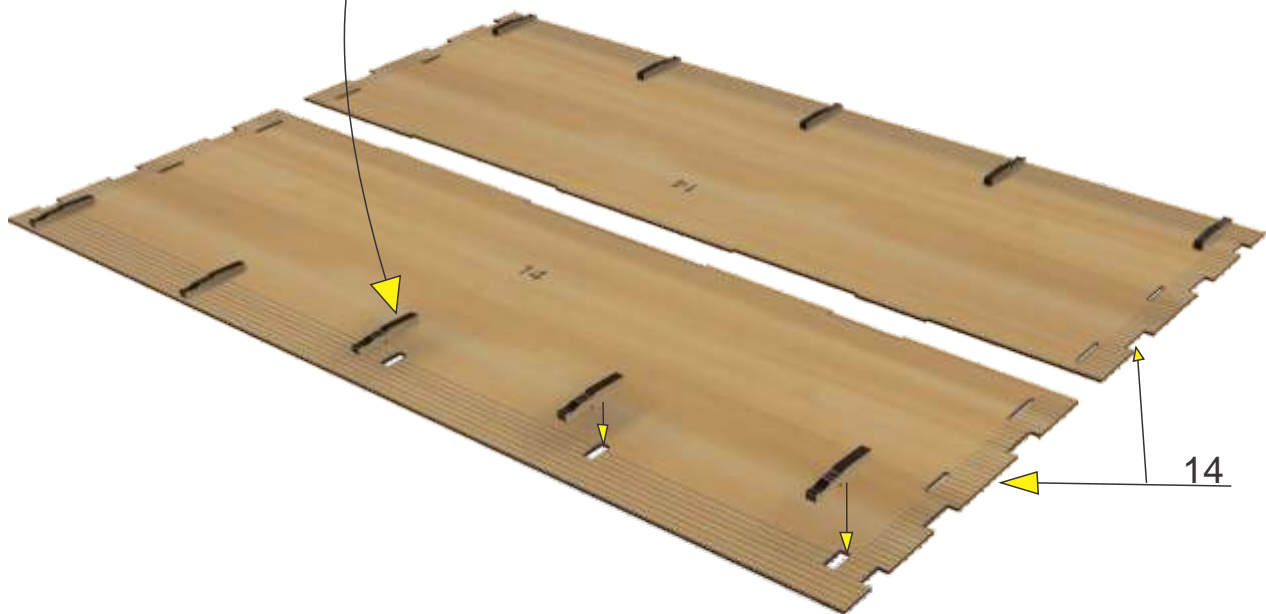
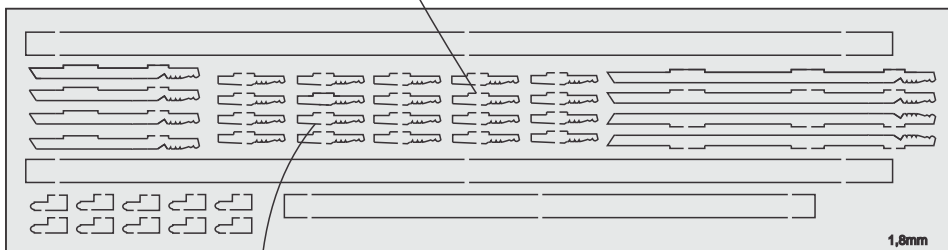
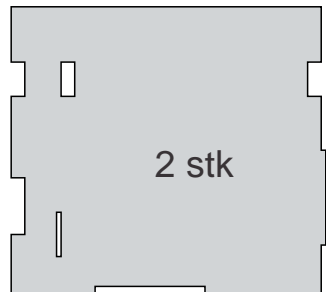
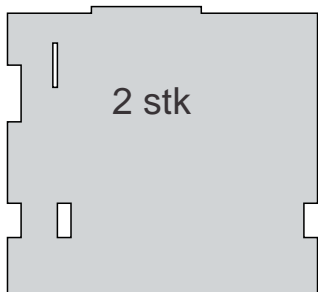
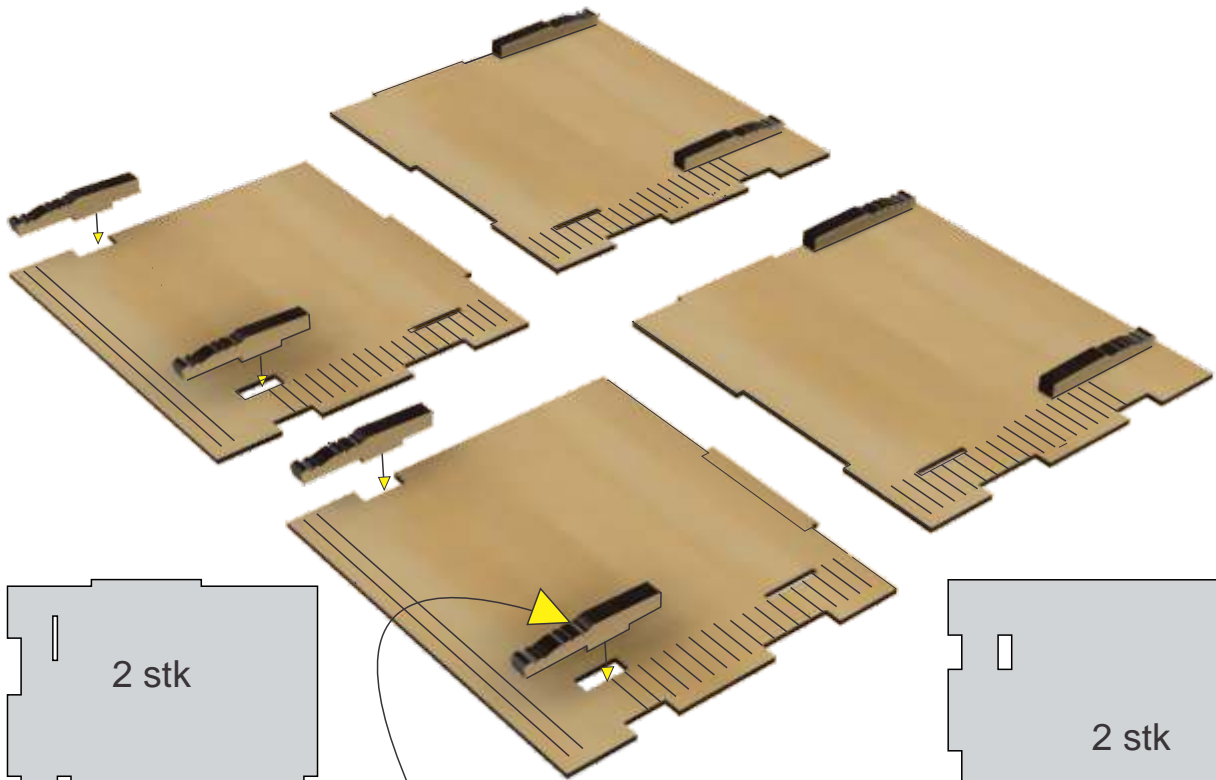

Sett på taket

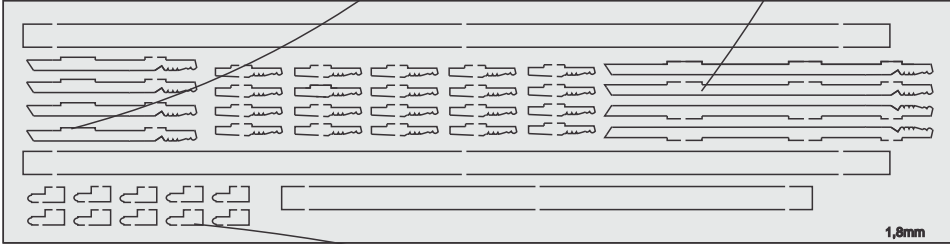
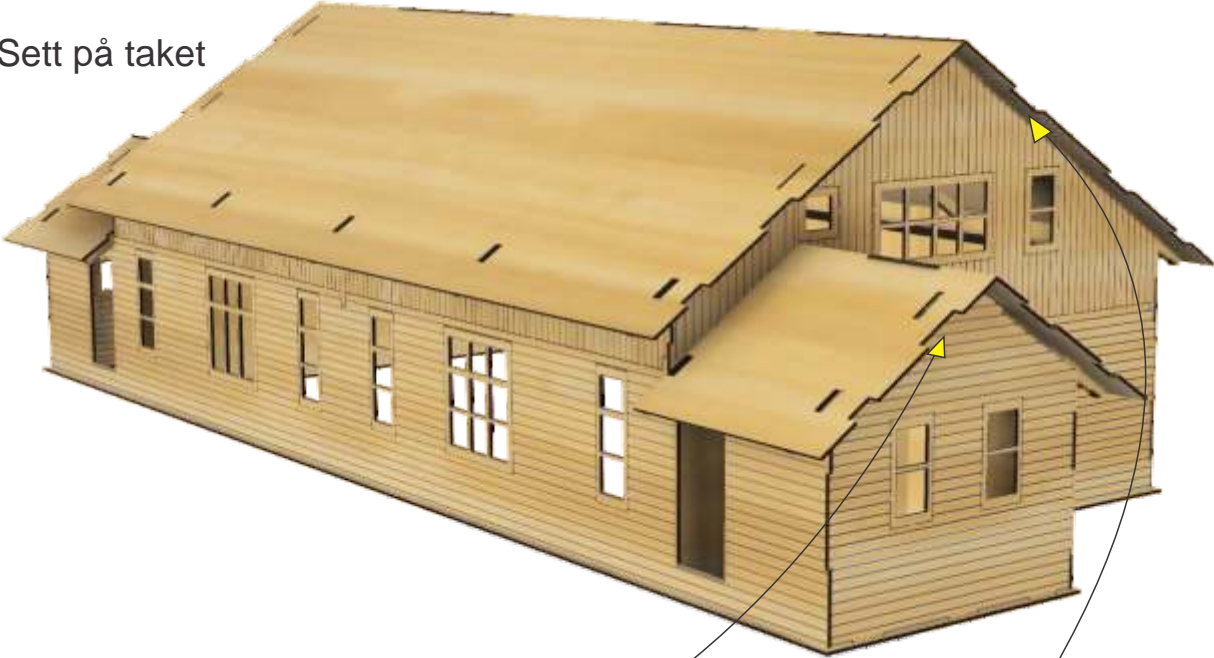

8 stk

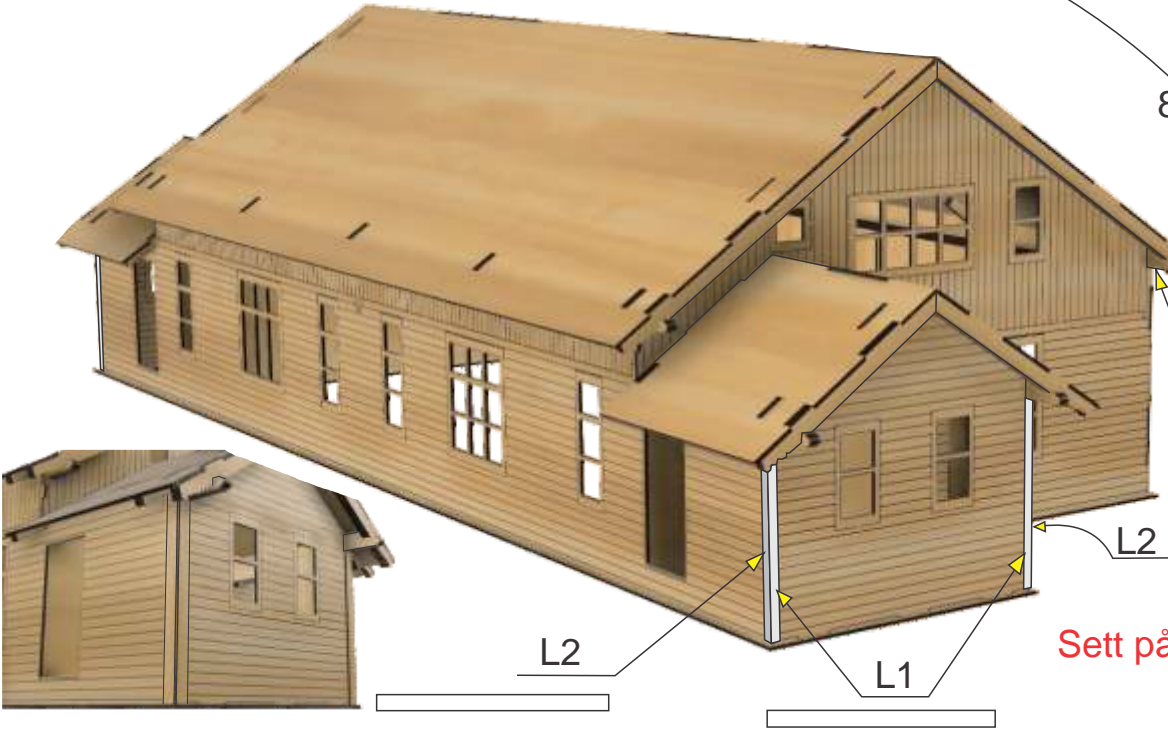

Sett på L2 først

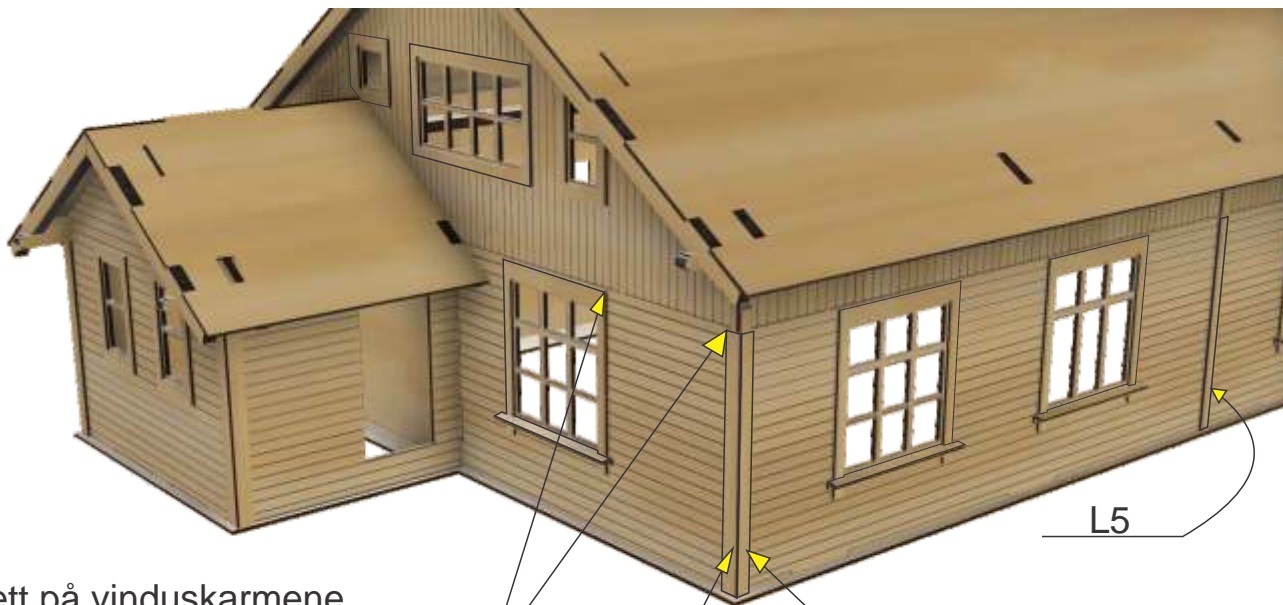

Sett på vinduskarmene.
NB like høyt som L3, L4 og L5

L8,L9 og L10 Skal ligge over

Sett på L4 først

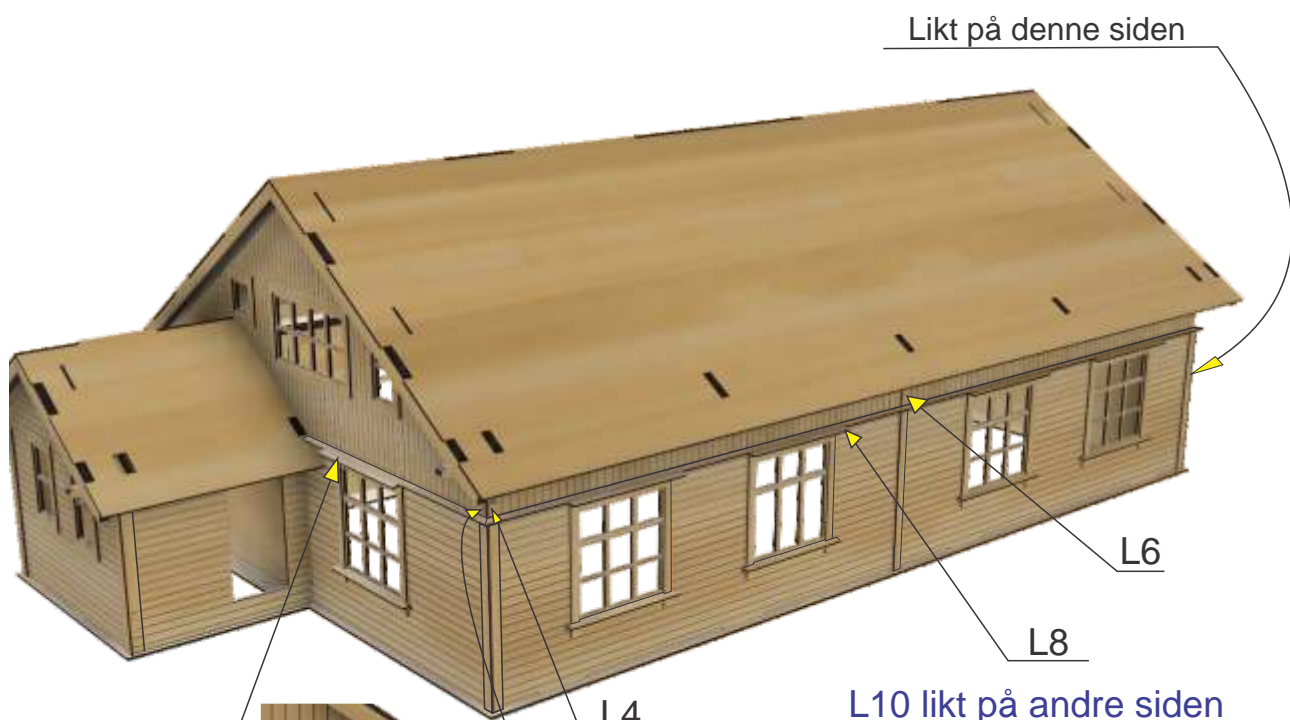

Likt på denne siden

L10 likt på andre siden

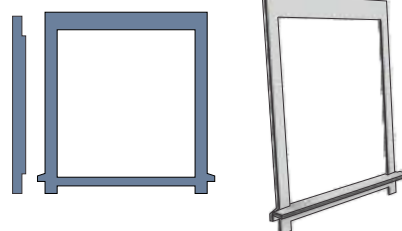
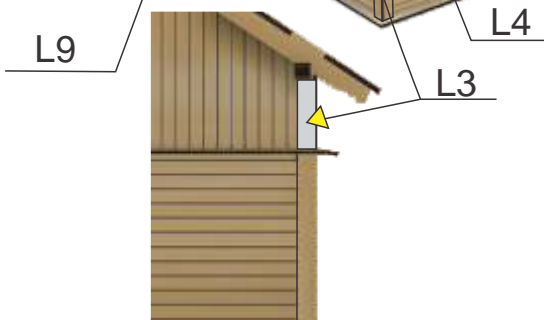

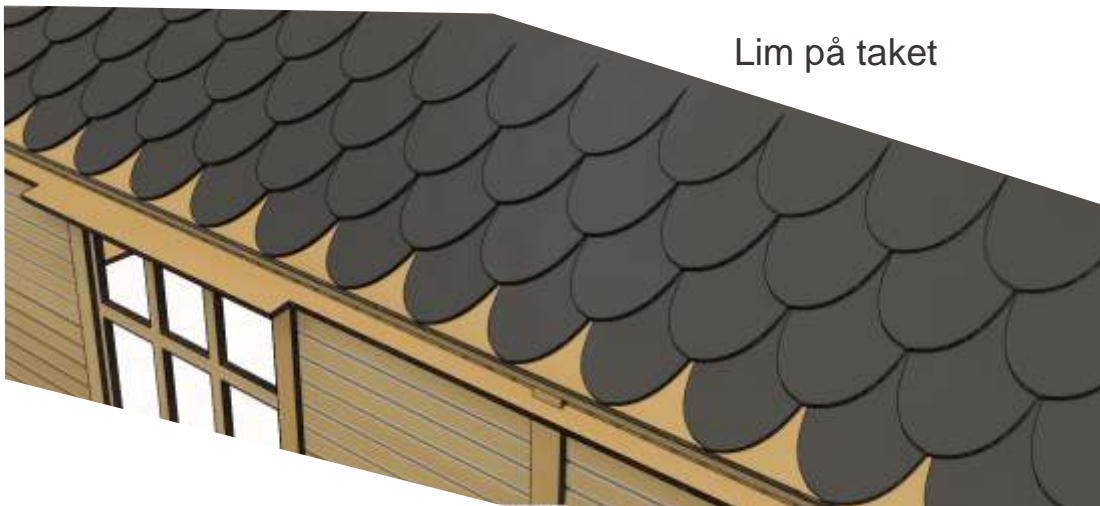
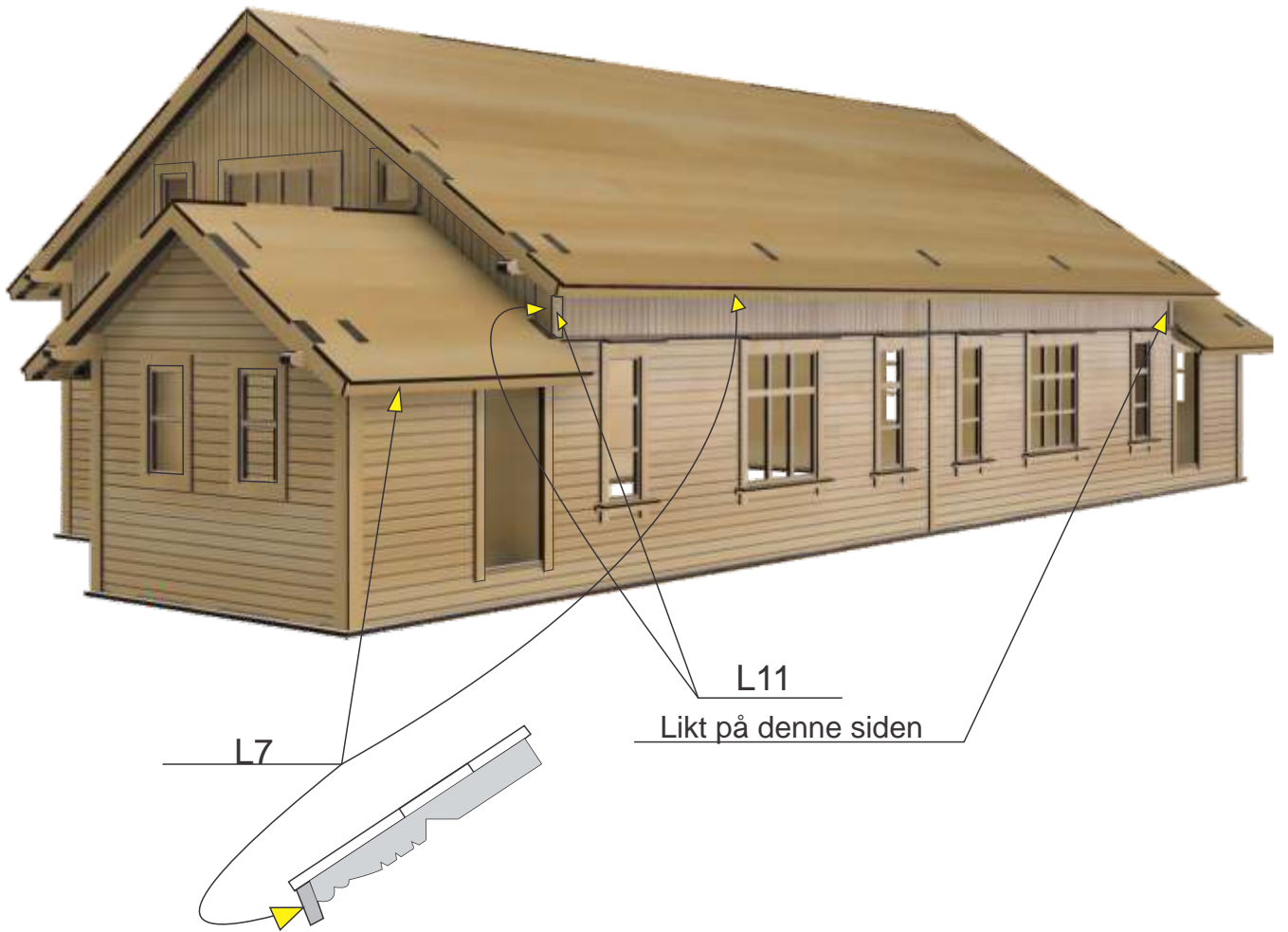

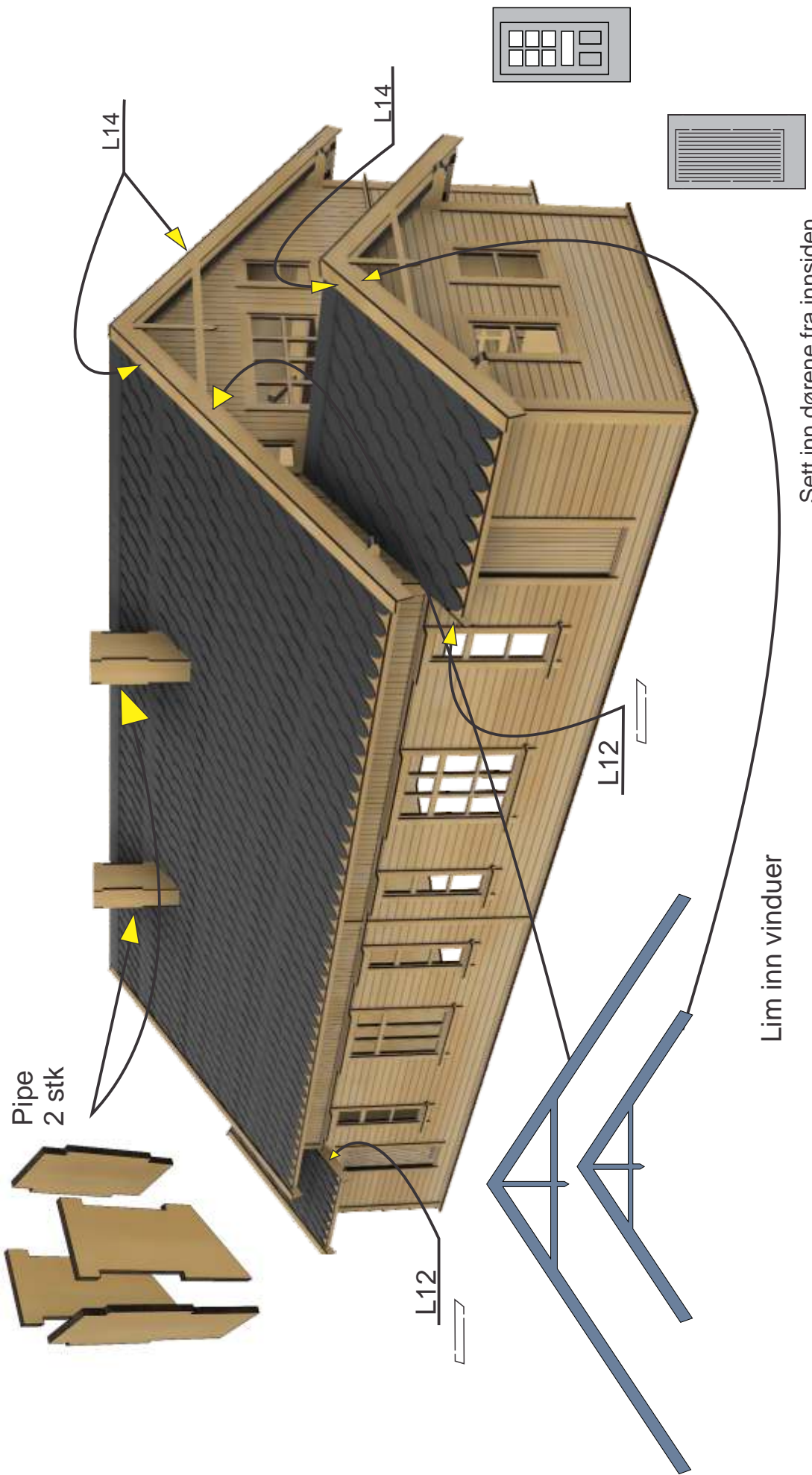

Pipe
2 stk

L14

L14

L12

L12

Lim inn vinduer

Sett inn dørene fra innsiden