











	Model	EW 3512	
	Code Production	T111ENZT	
Interface : 			
	Overall Dimension (Width-Depth-Height) *open		<i>mm</i> 1.150 x 770 x 1.615(2088*)
	Packaging Dimension (WxDxH)		<i>mm</i> 1.280x920x1800
	Gross weight		<i>Kg</i> 240
	Net weight		<i>Kg</i> 200
	Volume		<i>mc</i> 2,3
	Rack size		<i>mm</i> 500x500
	Useable wash chamber height		<i>mm</i> 450
	Tank wash construction		deep drawn
	Tank pre-wash construction		-
	General construction		double skin
	Door Construction		double skin and insulated
	Wash Tank volume		<i>liter</i> 70
	Wash Tank heating element		<i>W</i> 10.500
	Wash Tank surface strainers		stainless steel
	Wash drawer-like strainers		optional
	Pre-Wash Tank volume		<i>liter</i> -
	Pre-Wash Tank heating element		<i>W</i> -
	Pre-Wash Tank surface strainers		-
	Pre-Wash drawer-like strainers		-
	Wash pump type		double flow
	Wash pump power		<i>W</i> 1.500
	Wash pump delivery		<i>Lt/min</i> 720
	Wash temperature		<i>°C</i> 60 (63)
	Pre-Wash pump type		-
	Pre-Wash pump power		<i>W</i> -
	Pre-Wash temperature		<i>°C</i> -
	Boiler volume		<i>liter</i> 17
	Boiler heating element (with 50°C inlet water) standard		<i>W</i> 10.500
	Boiler heating element (with 10°C inlet water)		<i>W</i> 20.000
	Boiler heating element (with 10°C inlet water +Recovery)		<i>W</i> 14.000
	Back-flow system		break tank
	Rinse type		single rinse
	Pre-Rinse		-
	Rinse temperature		<i>°C</i> 82 (65)
	Rinse water consumption		<i>Liter /hour</i> 170min - 220max
	Inlet water temperature		<i>°C</i> Cold:10-40°C Hot:45-60°C

	<i>Optimal external water pressure</i>	<i>bar</i>	<i>from 1 to 4</i>
	<i>Drain system</i>		<i>overflow</i>
	<i>Drain size</i>	<i>G</i>	<i>1' ½"</i>
	<i>Productivity – speed 1</i>	<i>Racks per hour</i>	<i>160</i>
	<i>Productivity – speed 2</i>	<i>r/h</i>	<i>120</i>
	<i>Productivity – speed 3</i>	<i>r/h</i>	<i>60</i>
	<i>Noise level</i>	<i>db</i>	<i>< 70</i>
	<i>Conveyor power</i>	<i>W</i>	<i>500</i>
	<i>Electric Connection</i>	<i>V - ph - Hz</i>	<i>400V 3N 50Hz</i>
	<i>Max Electric Power with 50°C standard</i>	<i>W</i>	<i>23.200</i>
	<i>Max Electric Power with 10°C</i>	<i>W</i>	<i>32.700</i>
	<i>Max Electric Power with 10°C +recovery</i>	<i>W</i>	<i>26.900</i>
	<i>Plates racks</i>	<i>Nr1</i>	<i>780072</i>
	<i>Flat Rack</i>	<i>Nr1</i>	<i>780135</i>
	<i>Cutterly Rack</i>	<i>Nr1</i>	<i>780139</i>
	<i>Electric cable</i>		<i>not included</i>
	<i>Drain hose</i>		<i>YES</i>
	<i>Fill hose</i>		<i>YES</i>

<i>Rinse aid and detergent dispenser</i>	<i>Optional</i>
<i>Increase power for cold feed</i>	<i>Optional</i>
<i>Drying zone (6 or 9kw)</i>	<i>Optional</i>
<i>Corner drying zone on 90° (6 or 9kw)</i>	<i>Optional</i>
<i>Heat recovery system</i>	<i>Optional</i>
<i>Chemical product's level probe</i>	<i>Optional</i>
<i>Emergency switch</i>	<i>Optional</i>
<i>End limit switch</i>	<i>Optional</i>
<i>Heat pump</i>	<i>Optional</i>
<i>Neutral entry module</i>	<i>Optional</i>
<i>Drawer pre-filter</i>	<i>Optional</i>
<i>Possibility for shipment in separate modules</i>	<i>Optional</i>



* USEFUL WIDTH FOR BASKET
** USEFUL HEIGHT FOR BASKET

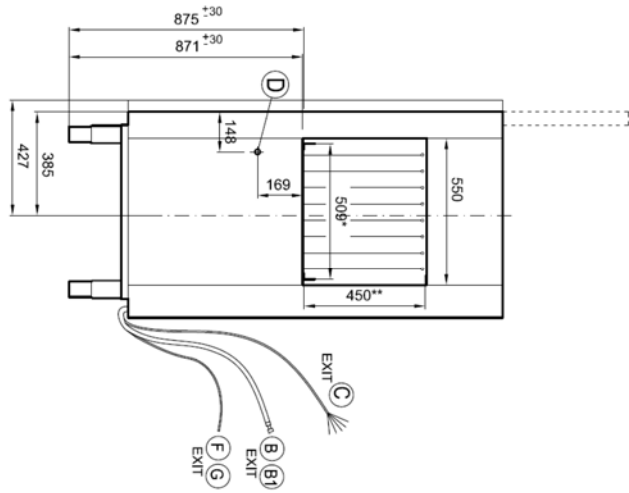
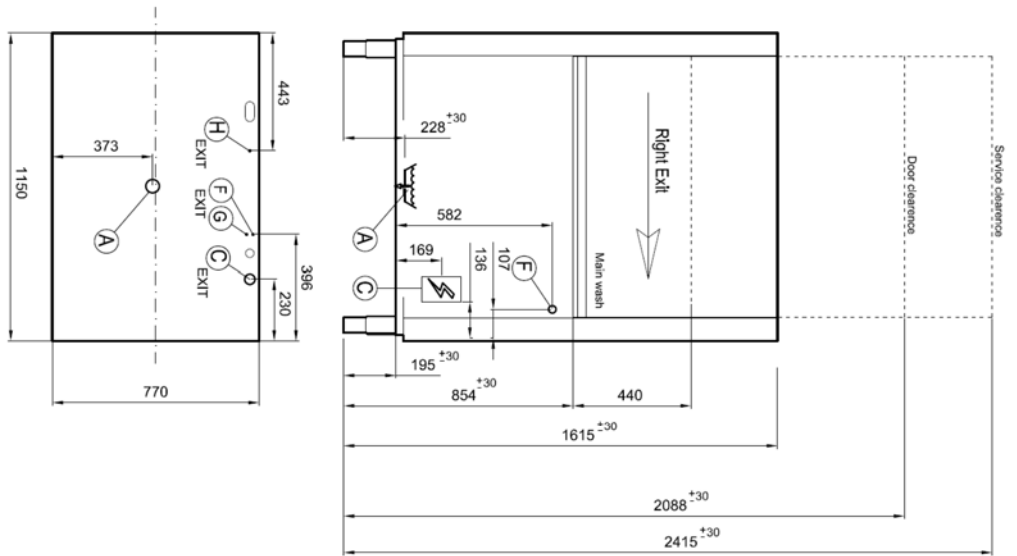

A		Ø 1 1/2 M	D		Ø PG11	End switch
A1		Ø 31 M	E		Ø 250	Steam exhaust
B		G 3/4" M	F		Ø 14 M	Detergent inlet
B1		G 3/4" M	G		Ø 7 M	Rinse aid inlet
C		PG36	H		Ø 6	Equipotential

L		Ø 250	Drier section
---	--	-------	---------------

Installation layout		Rack Type	
Designed by:	M.PUCCI	Denomination:	T101D
Date:	15.05.2015	Code:	00
		Rev.:	



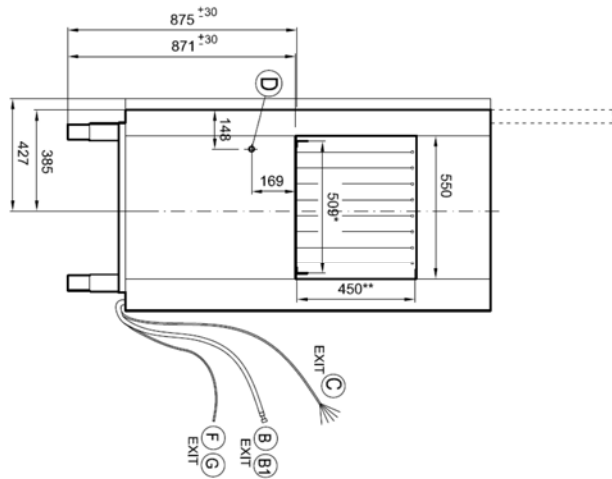

* USEFUL WIDTH FOR BASKET
** USEFUL HEIGHT FOR BASKET

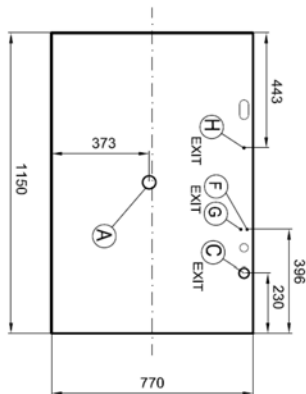
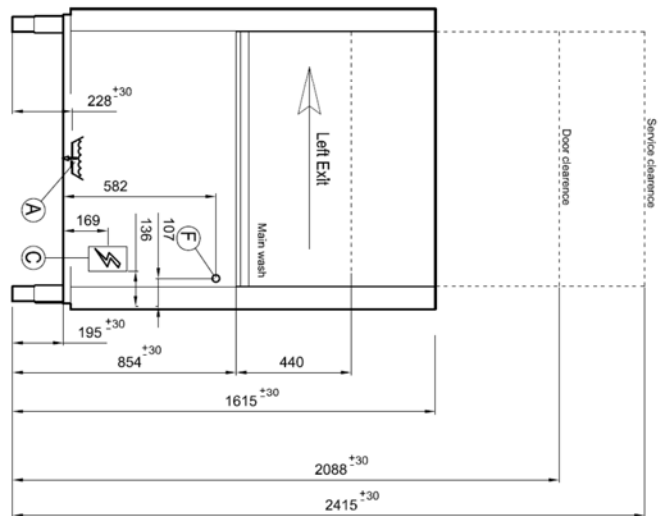

A		Ø 1"1/2 M	D		Ø PG11	End switch
A1		Ø 31 M	E		Ø 250	Steam exhaust
B		G 3/4" M	F		Ø 14 M	Detergent inlet
B1		G 3/4" M	G		Ø 7 M	Rinse aid inlet
C		PG36	H		Ø 6	Equipotential

L		Ø 250	Dryer suction
---	--	-------	---------------

Designed by:	M.PUCCI	Date:	15.05.2015	Denomination:	Rack Type	Code:	T101S	Rev.:	00
Installation layout									

