



# POWERLOCK KEYLESS ENTRY 7 INSTALLATION GUIDE

Instructions for Powerlock Keyless Entry 7.



**IMPORTANT INFORMATION!**

Disconnect the battery before fitting.  
Always best fitted by a professional auto electrician.

## Unit Operation

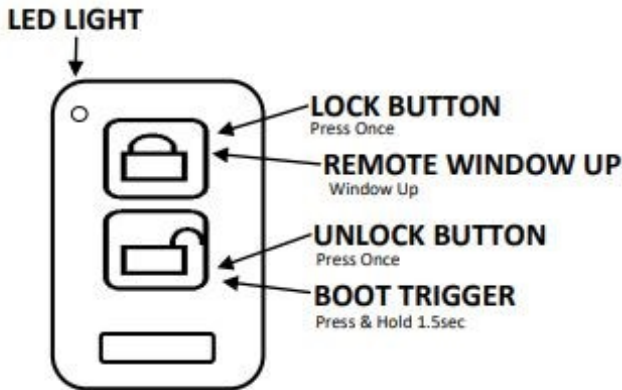

### Remote Code Learning Method

Make sure the keyless system is in unlock state. Press and hold the small learning button on the right side of the module, the indicators lights will flash then release the button then you're ready to set in the pre learning state. Press any button on the remote transmitter; the indicator will flash confirming that the code is learnt successfully. Repeat conducting the above operations up to 3 remote controls.

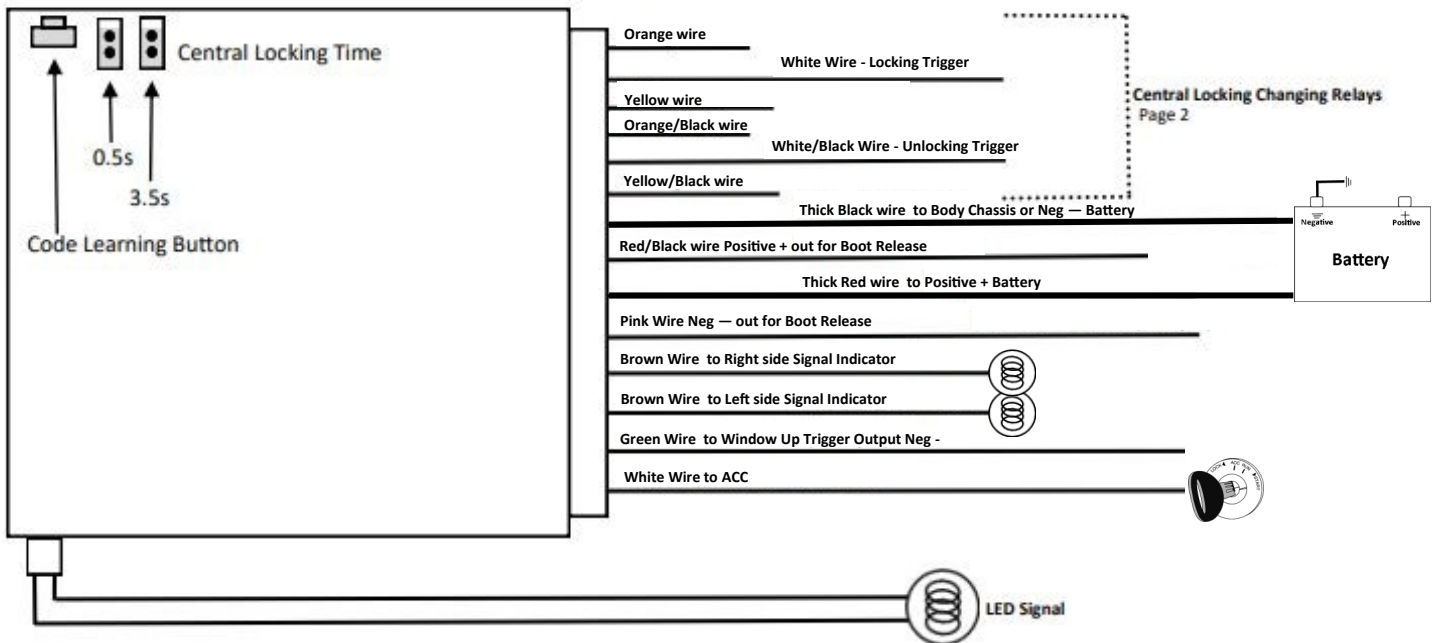



## Fitting Instructions for Standard Powerlock Keyless Entry 7.

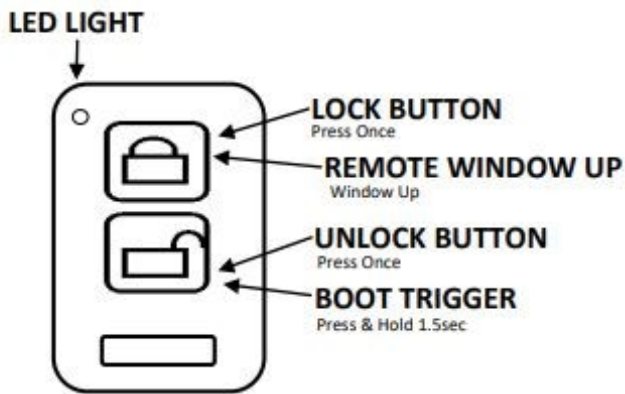

### Remote Code Learning Method

Make sure the keyless system is in unlock state. Press and hold the small learning button on the right side of the module, the indicators lights will flash then release the button then you're ready to set in the pre learning state. Press any button on the remote transmitter; the indicator will flash confirming that the code is learnt successfully. Repeat conducting the above operations up to 3 remote controls.

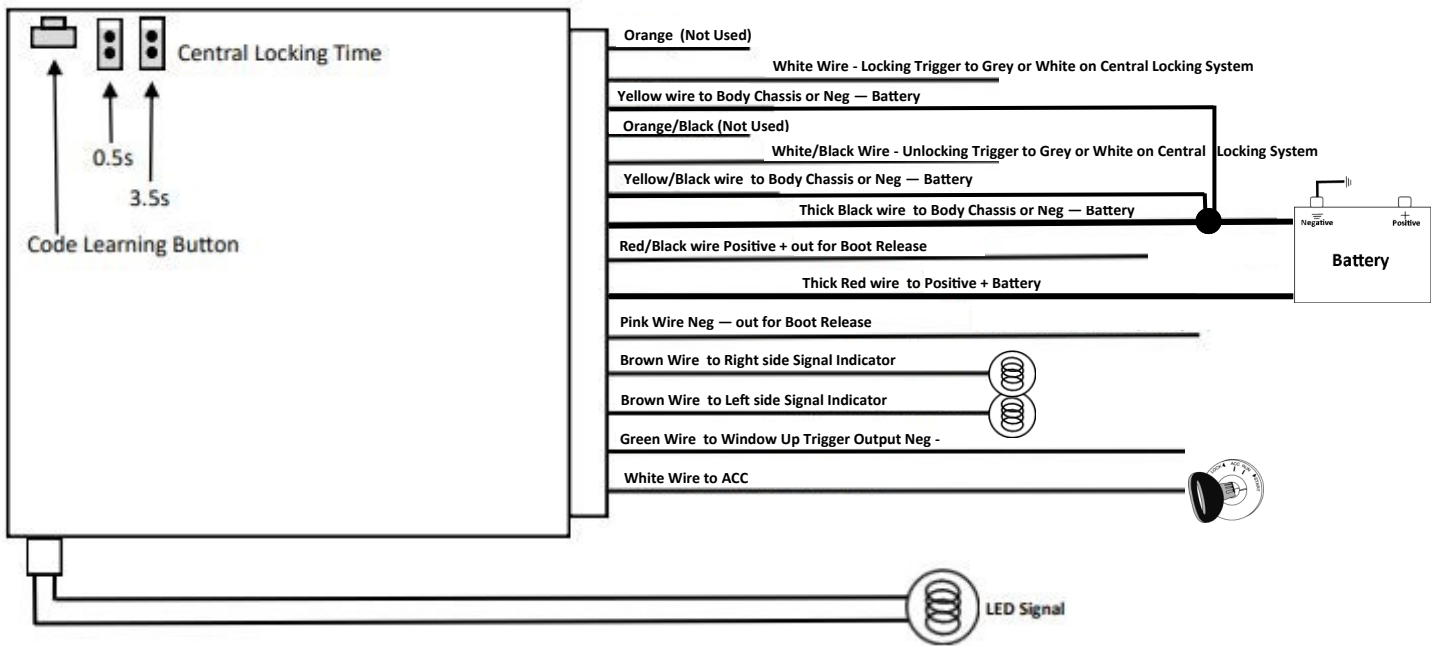

### Connecting to central lock system



Fig. 1 principle

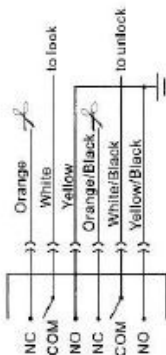

Fig. 2 Negative trigger

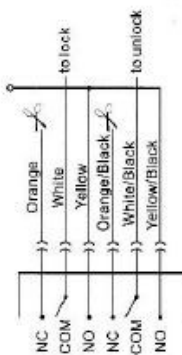

Fig. 3 Positive trigger

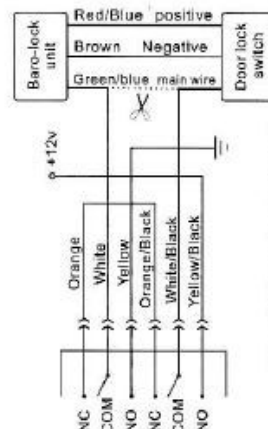

Fig. 4 Baro-lock circuit

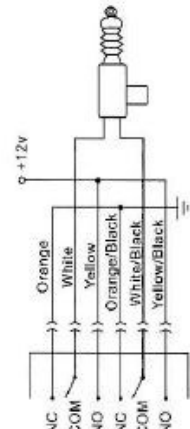

Fig. 5 Positive/Negative trigger