

Other Software

Presto!
BizCard



Business card management software from NewSoft Technology Corp.
* Presto! BizCard is a registered trademark of NewSoft Technology Corp.

EVERNOTE



Evernote is a cloud based data management application. The CaptureOnTouch software comes equipped with an option to send and store data (scanned images, photos, memos, etc.) to the Evernote server.

CaptureOnTouch Mobile



CaptureOnTouch Mobile is scanning software for smartphones and tablets that can be used when a WU10 optional wireless unit is connected to the scanner. Using this software, you can easily scan images from a wirelessly connected scanner, and then if you like, upload them to a cloud service. Available through App Store and Google Play.

P-208 Specifications

Type		Desktop sheet-fed scanner	
Scanning Document Size	Plain Paper	Width: 50.8 to 216 mm (2 to 8.5") Length: 70 to 356 mm (2.756 to 14")	
	Postcard	Width: 88.9 to 108 mm (3.5 to 4.25") Length: 127 to 152.4 mm (5 to 6")	
	Business card	Width: 49 to 55 mm (1.93 to 2.17") Length: 85 to 91 mm (3.35 to 3.58")	
	Card (ISO/IEC compliant)	Width: 86 mm (3.39") Length: 54 mm (2.13")	
Document Thickness (density)	Plain Paper	52 to 209 g/m ² (14 to 55 lb bond) Thickness 0.06 to 0.22 mm (0.0024 to 0.0087")	
	Postcard	128 to 300 g/m ² (34 to 80 lb bond) Thickness 0.15 to 0.4 mm (0.0059 to 0.0157")	
	Business card	128 to 380 g/m ² (34 to 58 lb bond) Thickness 0.15 to 0.45 mm (0.0059 to 0.0177")	
	Card (ISO/IEC compliant)	0.76 mm (0.03") or less Up to 1.4 mm (0.055") for embossed cards	
Document Feeding Method		Automatic	
Scanning Sensor		Contact image sensor	
Light source		LED	
Scanning Side		Simplex/Duplex	
Scanning modes		Black and White, Error Diffusion, 256-level Grayscale, Advanced Text Enhancement II, 24-bit Color	
Scanning resolution		150 x 150dpi/200 x 200dpi/300 x 300dpi/ 400 x 400dpi/600 x 600dpi	
Scanning Speed ^{1) 2)}	Grayscale	Simplex	200 x 200 dpi 8 pages/min. 300 x 300 dpi 8 pages/min.
		Duplex	200 x 200 dpi 16 images/min. 300 x 300 dpi 16 images/min.
	24-bit Color	Simplex	200 x 200 dpi 8 pages/min. 300 x 300 dpi 6 pages/min.
		Duplex	200 x 200 dpi 16 images/min. 300 x 300 dpi 12 images/min.
Interface		Hi-Speed USB 2.0	
External Dimensions (WxDxH)	Document feed tray closed	312.5 x 55.5 x 40 mm (12.30 x 2.19 x 1.57")	
	Document feed tray open	312.5 x 75.5 x 40 mm (12.30 x 2.97 x 1.57")	
Weight		Approximately 600 g (1.3 lb)	
Power Supply		Supply from USB (500mA)	
Power Consumption	When connecting with USB cable	2.5 W	
	Sleep mode	1.5 W or less	
	Power OFF	0.5 W or less	
Noise		Not more than 56 dB	
Operating Environment	Temperature	10°C to 32.5°C (50°F to 90.5°F)	
	Humidity	25% to 80% RH	

¹⁾ Conditions: Core 2 Duo 2.53GHz CPU, 2 GB memory, A4 document size, using USB 2.0 bus power

²⁾ When scanning in duplex mode using only USB 2.0 bus power, power consumption on the scanner may fluctuate depending on the type of document being scanned and the processing load on the scanner. In such cases, the scanning speed may vary.

Canon and the Canon logo are registered trademarks of Canon Inc. in the United States and may also be trademarks or registered trademarks in other countries. imageFORMULA is a trademark of CANON ELECTRONICS INC. Microsoft, Windows and SharePoint are registered trademarks of Microsoft Corporation in the United States and other countries. Apple and Mac OS are registered trademarks of Apple Inc. in the United States and other countries. Other product and company names herein may be the trademarks of their respective owners.



ENERGY STAR and the ENERGY STAR mark are registered U.S. trademarks.

Canon

CANON ELECTRONICS INC.

3-5-10, Shibakouen, Minato-ku, Tokyo 105-0011, JAPAN
www.canon-elec.co.jp

CANON U.S.A. INC.
New York Office/Headquarters: One Canon Park, Melville, NY 11747, U.S.A. Tel: (516) 328-5000
CANON CANADA, INC.
Toronto Office/Headquarters: 6390 Dixie Road, Mississauga, Ontario L5T 1P7, Canada Tel: (905) 795-1111
CANON EUROPA N.V.
Bovenkerkerweg 59, 1185 XB Amstelveen, The Netherlands Tel: (020) 545-8545
CANON LATIN AMERICA, INC.
703 Waterford Way, Suite 400, Miami, FL 33126, U.S.A. Tel: (305) 260-7400
CANON AUSTRALIA PTY. LTD.
1 Thomas Holt Drive, North Ryde, Sydney, NSW 2113, Australia Tel: 13 13 83
CANON NEW ZEALAND LTD.
Akoranga Business Park, Akoranga Drive, Northcote, Auckland, New Zealand Tel: 0800 100 077

CANON SINGAPORE PTE. LTD.
1 Harbour Front Avenue, #04-01 Keppel Bay Tower, Singapore 098632 Tel: (65) 6799-8888
CANON HONGKONG COMPANY LTD.
19th Floor, The Metropolis Tower, 10 Metropolis Drive, Hung Hom, Kowloon, Hong Kong Tel: (852) 3191-2333
CANON (CHINA) CO., LTD.
15F South Tower, Beijing Kerry Centre, 1 Guang Hua Road, Chao Yang District, Beijing 100020, China Tel: (010) 8513-9999
CANON KOREA BUSINESS SOLUTIONS INC.
168-12 Samseong-Dong, Kangnam-ku, Seoul, Korea Tel: (02) 3450-0700
CANON INDIA PVT. LTD.
7th Floor, Tower B DLF Cyber Terraces DLF Phase III Gurgaon - 122002 Haryana, India Tel:0124-4160000

PUB.0171W50601

© CANON ELECTRONICS INC. 2012

PRINTED IN JAPAN
IMPRIMÉ AU JAPON

Canon

imageFORMULA
P-208



The new ultra-compact, mobile scanner

The portability provided by compact scanners often comes at the expense of other features and functions. However, the P-208 document scanner comes in an ultra-compact body, the smallest in Canon's imageFORMULA lineup, while still providing the functionality of a desktop scanner. With features such as the automatic document feeder (ADF) and duplex scanning support housed within a lightweight body, the P-208 delivers true balance between portability and functionality.

Win & Mac Hybrid

**Anytime, anywhere portability for business or personal use.
True mobility with all your standard scanning functions.**

Compact and Portable

Weighing only 600 g and measuring only 12.30 x 2.19 x 1.57" (312.5 x 55.5 x 40 mm) in size, the scanner's ultra-compact body allows convenient portability to your home, office and just about anywhere in one hand.



High-Quality One-Pass Duplex Scanning

The P-208 provides the functionality of a desktop scanner, despite its compact size. Features such as ADF allow you to set up to 10 documents for scanning at one time. One-pass duplex scanning is also supported, in addition to scanning speeds of up to 8ppm/16ipm at 200 dpi for A4/LTR documents.



8 ppm B&W	16 ipm B&W
8 ppm COLOR	16 ipm COLOR

(A4/LTR, 200 dpi)

Plug & Scan

The preinstalled scanning utility, CaptureOnTouch Lite, provides plug-and-scan capabilities. When the feed-tray-power-link function is enabled, simply opening the feed tray turns the scanner on and makes it ready to scan.

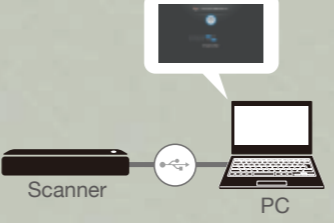

USB Powering

The P-208 draws power from a single USB port, eliminating the need for a dedicated power cable and reducing clutter around the scanner.



Windows and Mac compatibility

Scanner drivers and utilities (CaptureOnTouch, CaptureOnTouch Lite) for both Windows and Mac OS environments are provided, with the same functionality available on both platforms.



Optional Wi-Fi unit

The compact WU10 optional wireless unit with IEEE 802.11b/g/n (2.4Ghz) compatibility is perfectly suited for use with the P-208 scanner. The WU10 unit's built-in battery allows you to use the scanner in locations without a power source. In addition, the Wi-Fi connection the unit provides allows scanning operations without a PC through use of a smartphone or tablet.



actual size of the ultra-compact

Variety of Image Processing Options

Skip Blank Page

When scanning one-sided and two-sided documents at the same time, you can delete images of blank pages to produce scanned images without redundancy. This function is also effective with colored-paper documents that are blank.

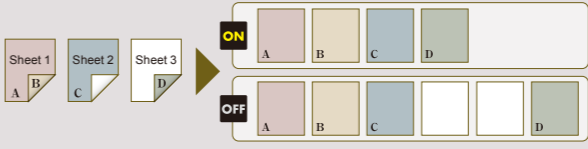

Text Orientation Recognition

When scanning document sheets of varying text orientations, the text can be detected and rotated to the correct orientation automatically in the scanned images, thereby removing the hassle of rotating them manually.

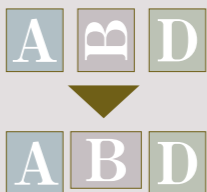

Deskew

The scanner is equipped with two deskew modes. One detects and correctly aligns documents fed at an angle, while the other corrects skews within the scanned image in addition to document alignment. These deskew modes eliminate the need for rescans and ensure smooth, continuous scanning.



Auto Color Detection

The scanner can automatically determine whether to save scanned images in color based on the contents of the document. This eliminates the need to separate documents that contain both color and monochrome pages before scanning.

Picture Mode

Use the picture scanning mode to reproduce gradation in color more accurately in scanned image.

Bundled Software

CaptureOnTouch Lite

The P-208 simplifies the setup process down to merely hooking up the scanner to a PC via a single USB cable and letting the built-in CaptureOnTouch Lite software operate the device, resulting in almost instantaneous scanning and saving of scanned documents into popular formats such as PDF (PDF/A), TIFF, JPEG or PPTX.

Supported file format

PDF	TIFF	JPEG
BMP	PPTX	

CaptureOnTouch

The dedicated CaptureOnTouch software suite adds a wide range of expanded functionality of the P-208. In addition to speedy scanning and saving of scanned documents already made possible with CaptureOnTouch Lite, CaptureOnTouch has a broader selection of output methods, such as sending scanned documents to printers, e-mail, and to bundled application software for added user convenience.

Supported file format

PDF	TIFF	JPEG
BMP	PPTX	

Cloud service plug-ins

The scanner comes bundled with plug-ins for connecting to cloud and ECM services, such as Evernote, Google Docs™, and Microsoft SharePoint. Depending on your environment and needs, you can install the plug-ins for fast, flexible sharing of scanned data.

Full Auto Mode

A Full Auto Mode is available with the color mode, page size, resolution, and text orientation automatically determined based on the contents of the document. This mode allows you to scan documents that contain pages of varying type under conditions that best suit each type. The mode also includes the Skip Blank Page function for efficient scanning of only the necessary pages.