

The default system of this product is Windows.

Quick Start Guide

1 Connect 2.4GHz Receiver

Connect the 2.4GHz receiver to the device USB port.

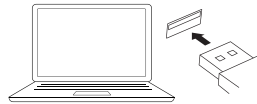

Switch toggle to 2.4GHz mode



G = 2.4GHz

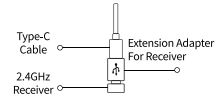

Note: For the best wireless experience, we recommend using the extension adapter for receiver and putting the 2.4GHz receiver somewhere on your desk close to your keyboard for a low rate of latency and fewer signal interferences.

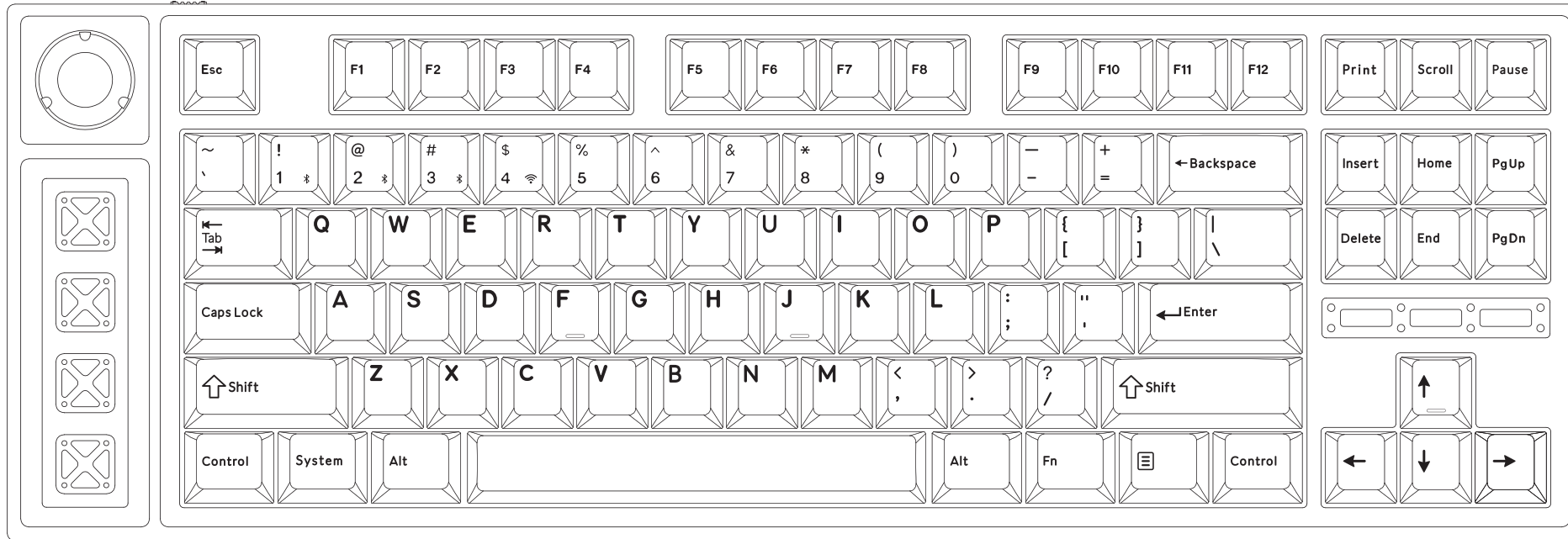

2 Connect Bluetooth

Press Fn + 1 (for 4 seconds) and pair with device named Lemokey L3.



Switch toggle to Bluetooth

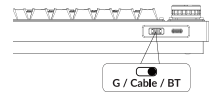

3 Connect Cable



4 The VIA Key Remapping Software

Please visit usevia.app to use the online VIA software to remap the keys.
If the VIA cannot recognize your keyboard, please reach our support to get the instruction.



* The online VIA software can only run on the latest version of Chrome, Edge, and Opera browsers yet.
* VIA only works when the keyboard is connected by wire to the computer.

5 Switch to Mac

Please find the Mac keycaps in the box, and follow the instructions below to find and replace the following keycaps.

Use the online VIA to remap the Windows keys to Mac keys.



+



6 The Backlight

Press Fn + Q to change the lighting effect

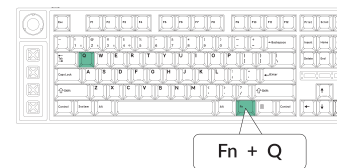

Press Fn + Tab to turn the backlight on/off



7 Adjust The Backlight Brightness

Press Fn + W to increase the backlight brightness

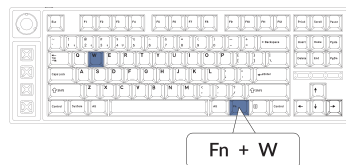

Press Fn + S to decrease the backlight brightness

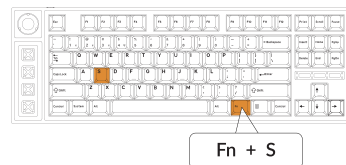

8 Activate Cortana

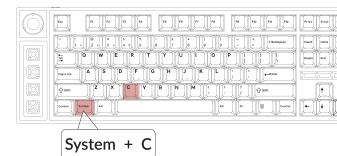

For Cortana on Windows: Select Start > Settings > Cortana and select the shortcut by pressing Windows key + C key.

*Windows Cortana is only available for Windows 10 and above OS. Cortana is only available in certain countries / regions and might not work everywhere.

9 The Key Rollover

Press Fn + N to switch N-key rollover / 6-key rollover

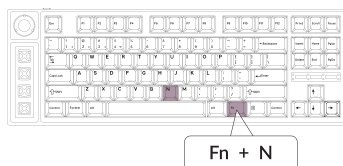

6-key rollover: the keyboard can detect up to 6 simultaneous key inputs.

N-key rollover: the keyboard can detect all key inputs without limit to the number of key presses.

* The keyboard turns on the 6-key rollover by default.

10 Warranty

The keyboard is highly customizable and easy to be rebuilt.
If anything goes wrong with any of the keyboard components of keyboard during the warranty period, we will only replace the defective parts of the keyboard, not the whole keyboard.



11 Watch The Building Tutorial On Our Website

If you are building the keyboard for the first time, we highly recommend you watch the building tutorial video on our website first, then start building the keyboard yourself.



12 Factory Reset



Troubleshooting? Don't know what's going on with the keyboard?

- ① Download the right firmware and QMK Toolbox from our website.
- ② Unplug the power cable and switch the keyboard to Cable mode.
- ③ Remove the space bar keycap to find the reset button on the PCB.
- ④ Hold the reset key first, then plug the power cable into the keyboard.
Release the reset key after 2 seconds, and the keyboard will now enter DFU mode.
- ⑤ Flash the firmware with the QMK Toolbox.
- ⑥ Factory reset the keyboard again by pressing Fn + J + Z (for 4 seconds).

* Step by step guide can be found on our website.