

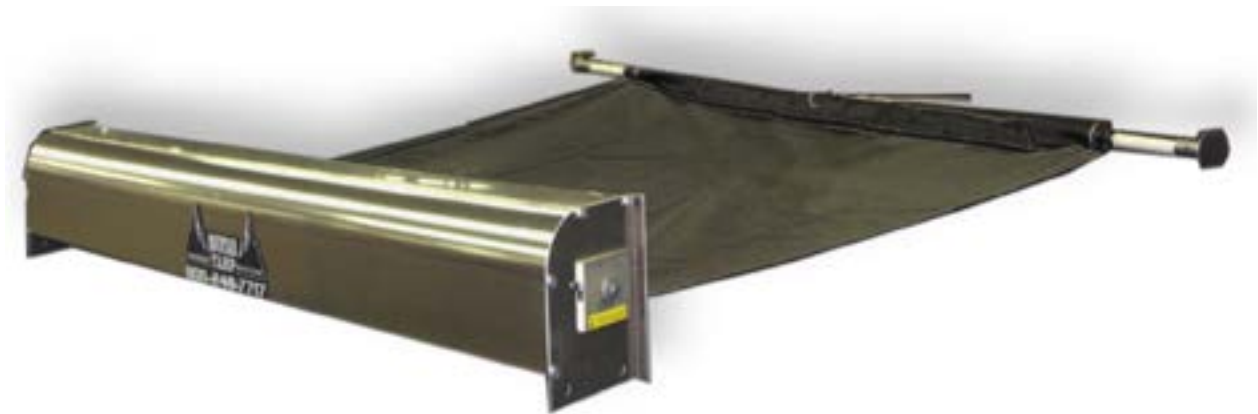

DUMP SHADE SYSTEM

INSTALLATION INSTRUCTIONS



DUMP SHADE INSTALLATION

Congratulations on your purchase of a Mountain Tarp Dump Shade tarping system. With tarping systems for dump bodies, transfer trailers, scrap trailers, landscaping trucks and roll-offs, Mountain Tarp offers the most complete line of tarping systems and parts in the industry.

WARNING:

- **The roller spring may be under pressure.**
- **Do not remove the four allen head screws from inside the driver side endplate.**

Note:

Please read through instructions for entire system and follow instructions thoroughly to ensure your system will work properly. It is important that you inspect your trailer and prepare it for installation by removing any sharp edges or any thing that will cause damage to your tarp.

For further technical assistance, contact our corporate headquarters at (800) 248-7717 or email us at sales@mountaintarp.com. For parts and service, visit us at one of our locations in Kentucky, Texas, or Ohio, or contact one of our many dealers nationwide. To learn more about Mountain Tarp and the products we offer, visit us online at www.mountaintarp.com.

Headquarters	Louisa, KY	Monroe, OH	Ravenna, OH	Houston, TX	San Antonio, TX
PO Box 186 1002 N. 15th St. Middlesboro, KY 40965 800-248-7717	225 Fallsburg Rd. Louisa, KY 41230 606-686-2117	940 Holman Ave. Monroe, OH 45050 513-422-7737	4442 State Rt. 14 Ravenna, OH 44266 330-325-7722	12245 FM 529 Rd, Houston, TX 77041 888-618-8277	78 Harby Dr. San Antonio, TX 78212 888-618-8277

TABLE OF CONTENTS

Step 1: System Installation	3	Step 7: Custom Dump Shade Installation	6
Step 2: Rope Hook Installation	3	Step 8: Decreasing Roller Tube Tension	6
Step 3: Return Ramp Installation	4	Step 9: Removing the Tarp	6
Step 4: Pull Bar Installation	4	Step 10: Reinstalling the Tarp	7
Step 5: Removing the Spring	5	Step 11: Setting Roller Tube Tension	7
Step 6: Replacing the Spring	5	Parts Guide	8

DUMP SHADE INSTALLATION

STEP 1: SYSTEM INSTALLATION

1A:

Mounting the system. First determine where you want to mount the **Dump Shade System**. The system may be mounted on the front of the cab shield, on the rear of the cab shield, or, if you have no cab shield, on top of the bulkhead.

1B:

Securing the system. After choosing the location of the system, bolt or weld the system to the body. If you choose to bolt the system on, place the system on top of the cab shield with the end plates of the system outside the cab shield. Slide the system forward or backward to reach the desired location, then, using a 3/8" drill bit, drill holes in the cab shield to match the four mounting holes in the end plate on each side of the system. Finally, using the 3/8" bolts, nuts and washers provided, fasten the system to the body, *see figure 1*.

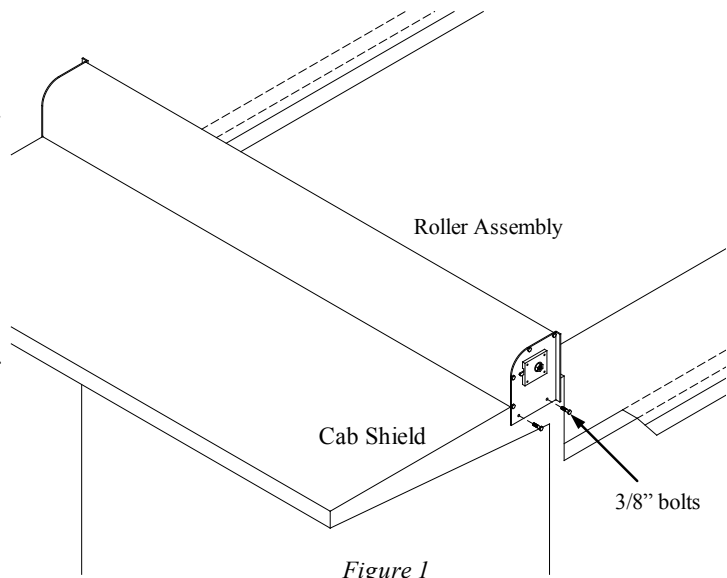

Figure 1

If you choose to weld the system in place, move the system to the chosen location, then weld the system to the body (Note: when welding the system, be sure to protect the tarp from sparks).

STEP 2: ROPE HOOK INSTALLATION

2A:

Mounting the rope hooks. Mount two rope hooks on the driver side of the body as low and as far forward as possible. The rope hooks should be 24" to 36" apart and mounted with the "J" shaped end of the hook in, *see figure 2*. Using the 1/4" x 1-1/4" Tek screws provided, fasten the hooks to the body.

2B:

Following the above step, mount two additional rope hooks on the rear of the body at the bottom center of the tailgate.

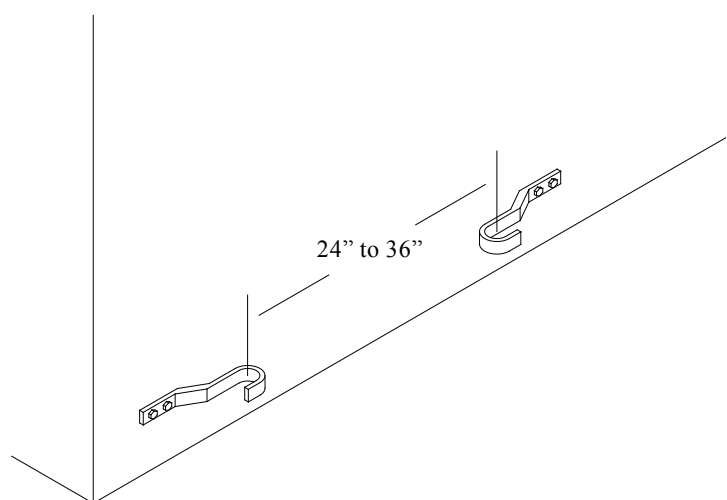

Figure 2

DUMP SHADE INSTALLATION

STEP 3: RETURN RAMP INSTALLATION

3A:

Return ramps should be mounted at the top rear of each side of the tailgate. To install, hold the ramp as high and as far to the outside of the tailgate as possible and weld in place, *see figure 3*.

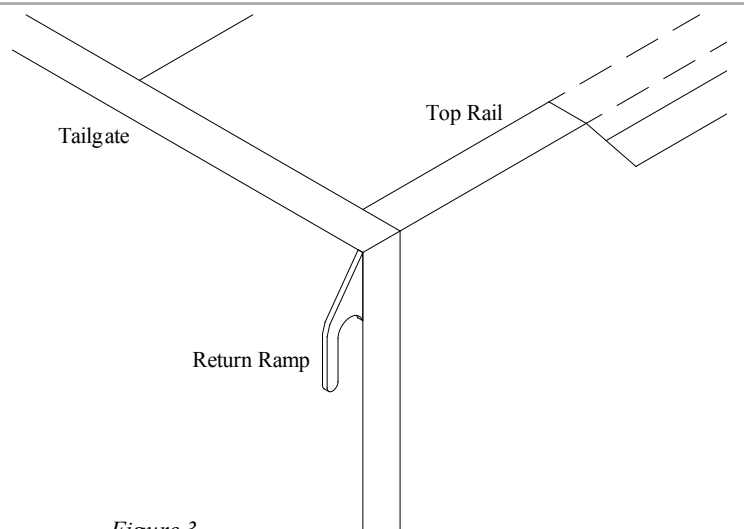

Figure 3

STEP 4: PULL BAR INSTALLATION

4A:
First, cut the bar the length of the widest point of the body. Then, slide the bar into the pocket at the end of the tarp. Next, slide a tarp guide onto each end of the bar and using a 1/4" drill bit, drill a hole in the bar to match the hole in each of the tarp guides. Finally, fasten the tarp guides to the pull bar using the 1/4" x 3/4" allen head screw provided, *see figure 4*.

Note: If you feel you need to increase or decrease tension on your pull-tarp system, contact a Tarpologist at 1-800-248-7717.

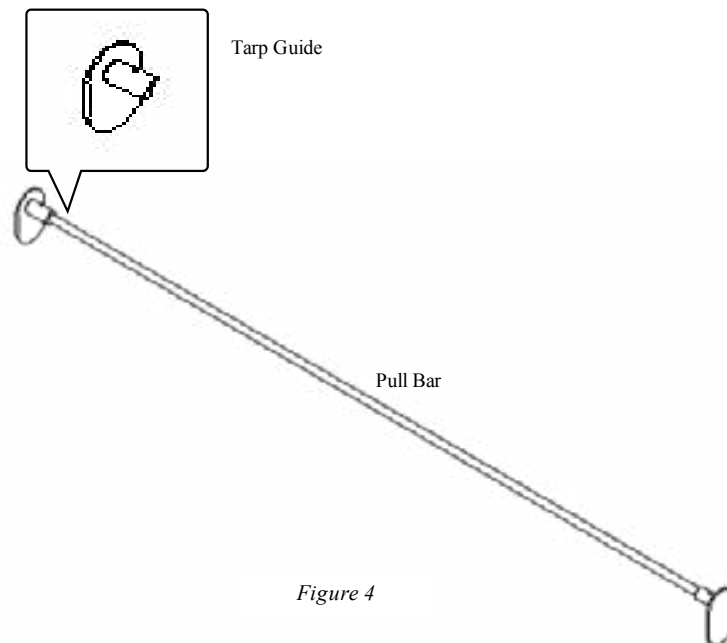

Figure 4

DUMP SHADE INSTALLATION

STEP 5: REMOVING THE SPRING

5A:

First, using a 1-1/8" wrench or socket, hold the nut on the outside of the ratchet housing, driver side. **DO NOT turn this nut.** Turn the shaft counterclockwise until it comes out of the nut. Now pull the roller tube towards you and take off the stud on the passenger side (shaft does not go all the way through the roller tube).

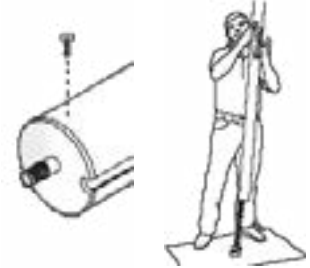

Figure 5

Figure 5a

5B:

Position the end of the roller tube with the shaft sticking out, *see figure 5*, and remove the screw that holds the end cap in place. Turn the roller tube (shaft end) down and jerk tube up and down to remove cap and shaft, *see figure 5a*. To avoid damaging the threads on the shaft, do this on a board in the dirt.

STEP 6: REPLACING THE SPRING

6A:

Remove the roller tube bearing and loosen the two set screws. In order to remove the old spring, you may have to cut the spring off the other end of the shaft, *see figures 6 and 6a*. Take the end of the spring that has no tang on it and screw it on the torque block counter clockwise, *see figure 6b*.

Now slide the spring over and all the way down the shaft. Insert the tang on the spring into the hole on the welded washer and bend the tang 180 degrees. Cut off the any excess. Pull the torque block to the end of the shaft and tighten the two set screws and bearing, *see figure 6c*.

6B:

Refer to Step 5B to reinstall roller tube and next page to install tarp and set tension on the spring.

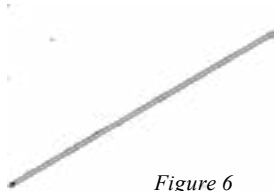

Figure 6

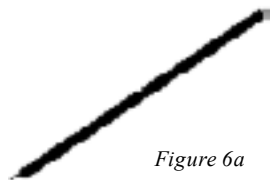

Figure 6a

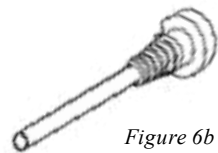

Figure 6b

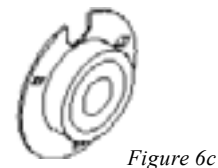
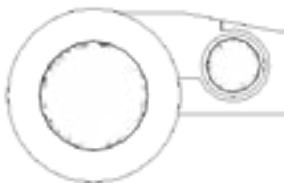

Figure 6c

RATCHET PARTS



Ratchet Housing



Ratchet



Spring



Ratchet Pawl

Please contact a Tarpologist if you need to replace any ratchet parts at 1-800-248-7717.

DO NOT REMOVE THE 4 ALLEN SCREWS TO REMOVE ROLLER TUBE.

DUMP SHADE INSTALLATION

STEP 7: CUSTOM DUMP SHADE SYSTEM INSTALLATION

7A:

Custom system preparation. Before you begin installing your custom Dump Shade system, measure where the system is to be mounted, from the outside driver rail to outside passenger side rail. Also note, if the system is assembled, it must be taken apart prior to installation, but **first make sure the tension is off the roller tube**. See Step 8 for directions on how to remove tension if necessary.

7B:

With the tension removed from the roller tube and your custom Dump Shade system disassembled, remove the six machine bolts. On the driver side turn the shaft counter clock wise to remove the roller tube, making sure to hold the ratchet with a wrench.

WARNING: Do not remove the four Allen head screws from inside the driver side endplate.

7C:

Remove the passenger side end plate. This should give you four main pieces. Then cut the wind guard to necessary measurements. With an 11/32 drill bit, drill out the six holes for the machine bolts (three on each side). Now, from the pass. side of the roller tube (the end without the shaft), cut the tube the same amount as you cut the wind shield. Install both end plates and make sure they are square with the wind guard. Now screw the roller tube into the ratchet and driver side end plate, then put the stud into the other side. Bolt the wind guard to the two end plates.

7D: When finished, proceed to Steps 10 and 11 for directions on how to reinstall the tarp and set the roller tube tension.

STEP 8: DECREASING ROLLER TUBE TENSION

8A:

CAUTION: ROLLER SPRING MAY BE UNDER PRESSURE.

Begin decreasing the roller tube tension by turning the ratchet nut slightly clockwise and inserting a screwdriver above the ratchet stop. Place a box end wrench on the ratchet nut and hold with both hands. Slowly unwind the spring pressure. When the desired tension is achieved, remove the screwdriver, allowing the release lever to re-engage the ratchet gear.

WARNING: Do not remove the four Allen head screws from inside the driver side endplate.

STEP 9: REMOVING THE TARP

9A:

Pull the tarp out as far as possible and tie to the tailgate. Use a piece of 3/8 round stock to hold the roller tube in place.

WARNING: Do not release tension by lifting the ratchet stop.

If it is necessary to release tension from the roller tube, follow the directions above in Step 8. If not, align the slot of the roller tube with the groove in the passenger side end plate and slide the tarp out though the groove. **DO NOT FORCE TARP**. Use warm, soapy water or WD-40 to lubricate tarp.

DUMP SHADE INSTALLATION

STEP 10: REINSTALLING THE TARP

10A:
Slide the front end of tarp through the groove in the passenger side end plate, and into the slot of the roller tube. Lubricate the edge of the tarp with soapy water, allowing the tarp to slide into the roller tube easily. After the tarp is in place, make sure it is centered on the roller tube with an equal amount of space on each end, and that the bead tubing is also equally spaced. Secure the tarp and pull the rod to the tailgate with the pull rope (see Step 11 below for instructions on how to set the roller tube tension). Release the pull rope from the tailgate and cycle the tarp two or three times. This ensures the tarp will roll up straight.

If the tarp consistently rolls off to one side or the other, remove tarp and measure it. If the tarp is not square, contact a Tarpologist at **1-800-248-7717**.

STEP 11: SETTING ROLLER TUBE TENSION

11A:
In order to set the roller tube tension, first pull the tarp out as far as possible and tie it off to tailgate. Turn the ratchet nut clockwise 20 turns. Cycle the tarp two or three times. If the tarp does not wind up completely, add an additional two to three turns to the ratchet nut at a time until tarp fully rolls up.

If the tarp still does not wind up after 25 turns to the ratchet nut, contact a Tarpologist at **1-800-248-7717**.

DUMP SHADE INSTALLATION

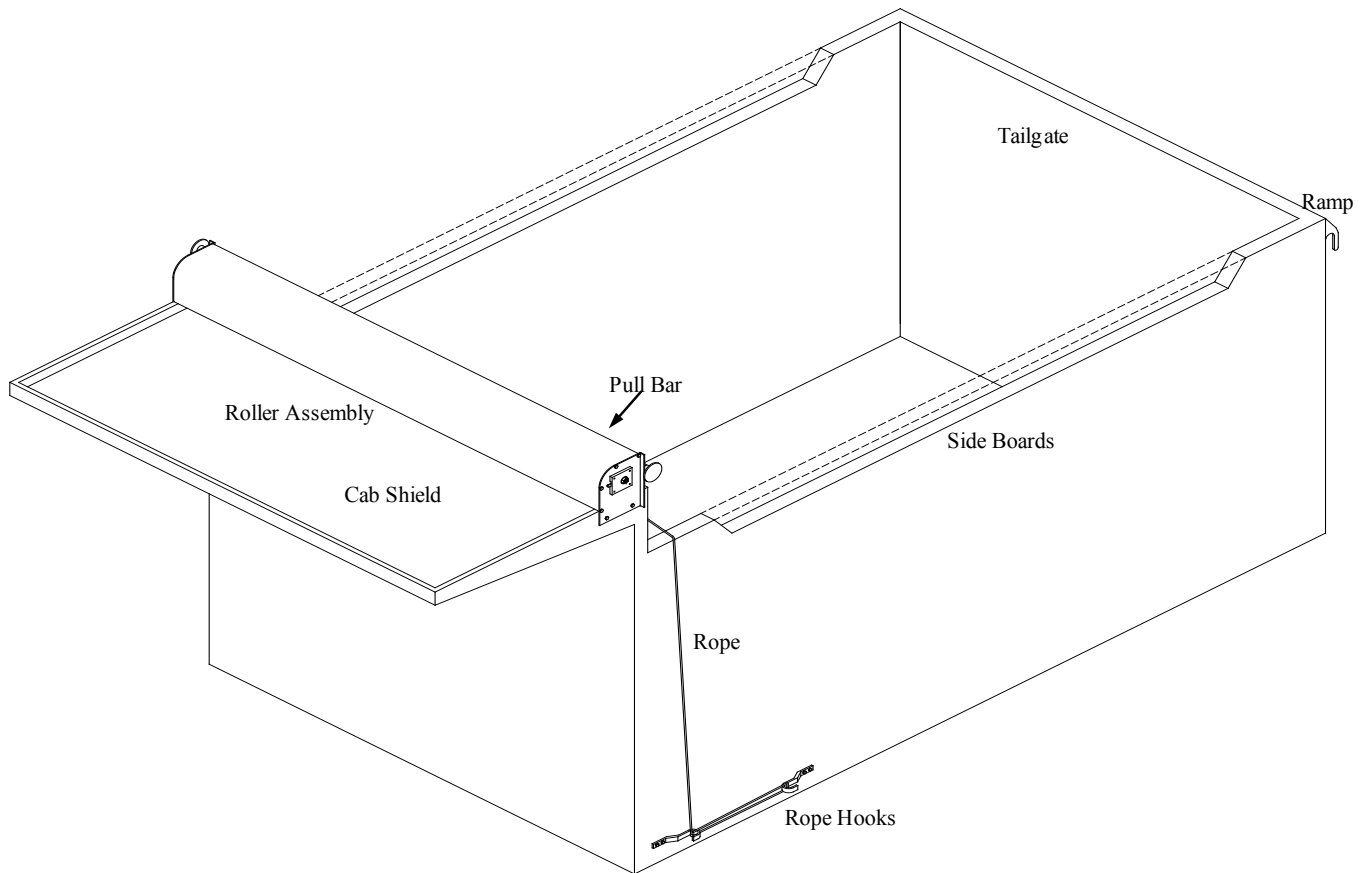

Part #	Description	Part #	Description
PT300	Dump Shade Kit	PT202	Tarp Guide
PT300E	Dump Shade Kit Electric	PT109	Rope
	Roller Assembly 96"	PT218	Rope Hook
	Roller Assembly 102"	PT209	Return Ramp
PT205	Pull Bar		