



Scale Motorsport LLC  
PO Box 1768  
Shelter Island, New York 11964

scalemotorsport.com  
customerservice@scalemotorsport.com

This kit is not a toy, it is designed for the advanced builder or intermediate modeller interested in learning new techniques while expanding their modelling skills. Not safe for children under the age of 12 years.

**Honda Motorcycle #4210**  
For Tamiya sku#: 14082 & 14087

**Production Notes:**  
Thanks for purchasing our Honda motorcycle photoetch set. The motorcycle sets represent our highest degree of design and detail to date. Great care and time went into the design and development of every part, including the set of instructions.

Please make sure to read through the entire instruction sheet provided with this kit. Plan your build carefully, it is not necessary to incorporate every detail in this kit, into your Tamiya build.

We design all our products for the extreme enthusiast, not everyone will be able to use all the details. So, test yourself by pushing your limits, its a great way to improve your craftsmanship!

We recommend that you handle our photo-etch parts with a tweezer (finger prints can create tarnished surfaces over time) and dab a drop of Tamiya Clear over the part after installation. Follow the Tamiya paint scheme, using clear colors to achieve an anodized finish on many of the photoetch parts.

**Build Sequence:**  
Build the Scale Motorsport details along with the build sequence illustrated in the Tamiya instruction booklet.

**27** Parts displayed with this symbol signify rubber backed photoetched details.

Note: Parts are not drawn to scale and slightly altered to prevent copyright theft.

**C6** Designates Tamiya Part

### Honda NSR 500 Photoetch Sheet A

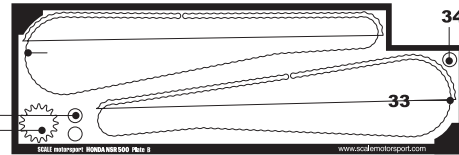
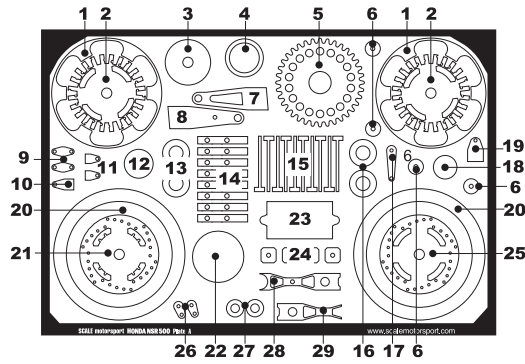

### Honda NSR 500 Photoetch Sheet B

### H Honda NSR 500 Photoetch Sheet R

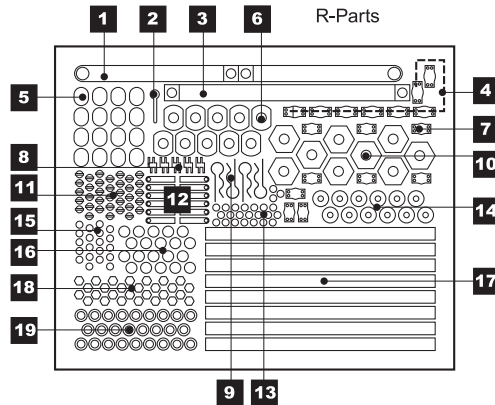

### Sheet A

- 1** Front Brake Disc Detail
- 2** Rear Brake Disc Vents
- 3** Rear Disc Spacer
- 4** Yoke Collar Mounts to Tamiya C9 & C4 Assemb.
- 5** Large Chain Sproket
- 6** Handle Bar Details
- 7** Exhaust Pipe Brackets
- 8** Exhaust Pipe Bracket
- 9** Exhaust Pipe Brackets
- 10** Exhaust Pipe Bracket
- 11** Exhaust Pipe Brackets
- 12** Rear Disk Spacer
- 13** Exhaust End Caps
- 14** Hose Clamps
- 15** Hose Clamps
- 16** Exhaust End Caps
- 17** Exhaust Pipe Bracket

### 18 Gas Cap

- 19** Exhaust Pipe Brackets
- 20** Front Brake Disc
- 21** Rear Brake Disc
- 22** Large Sproket Detail
- 23** Bracket
- 24** Handle Bar Details
- 25** Rear Brake Disc
- 26** Exhaust Pipe Bracket
- 27** Chain Adjuster
- 28** Chain Adjuster
- 29** Chain Adjuster

### Sheet B (Brass)

- 30** Chain
- 31** Small Chain Sproket
- 32** Small Chain Sproket Detail
- 33** Chain
- 34** Small Chain Sproket Detail

### Front Rotor Assembly Build two units

★ A16

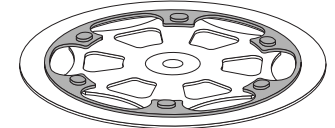

Sand gray area flat, or remove it from Tamiya A16

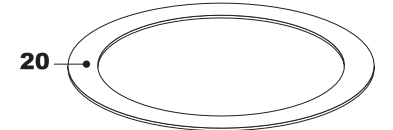
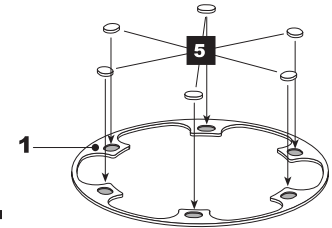
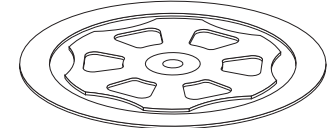

★ A16

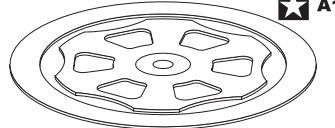

- 1** Exhaust Pipe Brackets
- 2** Speedometer
- 3** Exhaust Pipe Brackets
- 4** Hose Clamp Details
- 5** Front Brake Disc Detail
- 6** Handle Bar Details
- 7** Hose Clamp Details
- 8** Hose Clamp Details
- 9** Cowl Pins
- 10** Handle Bar Details
- 11** Misc. Details
- 12** Exhaust Pipe Brackets
- 13** Misc. Details
- 14** Large Sproket Details

- 15** Misc. Details
- 16** Large Sproket Details
- 17** Exhaust Pipe Brackets
- 18** Front Brake Disc Detail
- 19** Front Brake Disc Detail

### Rear Rotor Assembly

Build one setup to replace **A9**

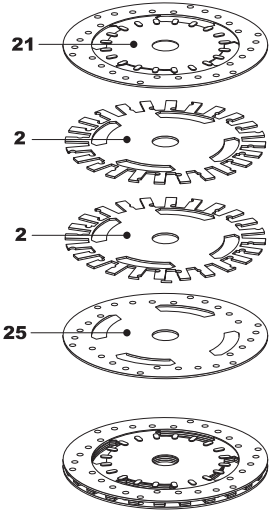

### Chain Link & Sprocket Assembly

#### Step A

You can build the chain two different ways. By sandwiching Tamiya part#: B14 between Scale Motorsport PE#: 30 & 33, you can create a three dimensional chain with sprocket and spacers. If you choose to build the chain this way, make sure to sand Tamiya B14 completely flat, eliminating all surface detailing. Also, you will use the front and rear sprockets on the Tamiya B14, instead of the Scale Motorsport PE sprocket parts.

#### Rear Sprocket

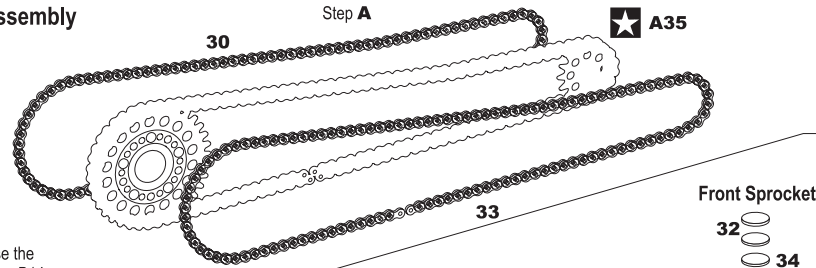
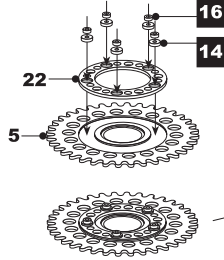

(or) Step B if you choose to build the chain with Scale Motorsport photoetch parts, follow step B below.

#### Front Sprocket



### Hose Clamp Detail Assembly

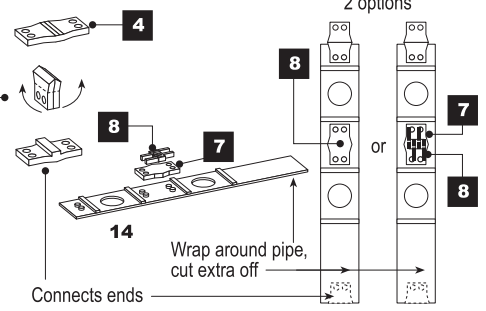

### Old Style Hose Clamp Assembly

Use wherever rubber hoses join to pipes throughout entire build

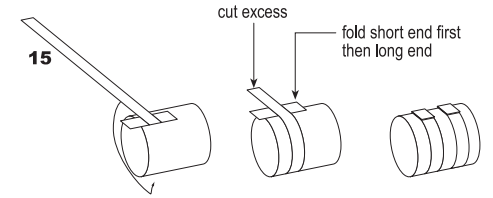

### Handle Bar Detail Assembly

Shave detail off Tamiya A61 to look like the illustration below.

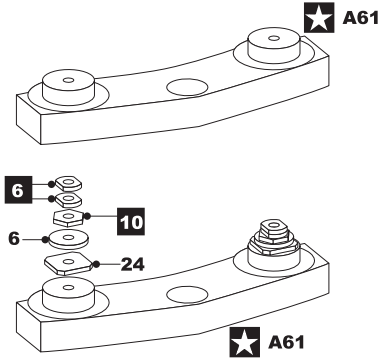
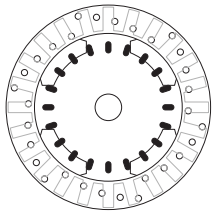

### Exhaust Hanger Detail Assembly

Use a standard straight pin to align holes in parts 9, 17 & 10. Do not use glue until properly aligned with Tamiya B7 and bike frame.

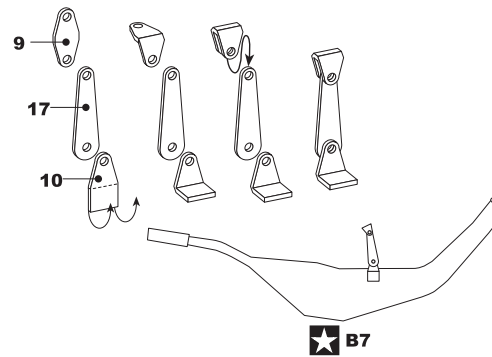

Use a standard straight pin to align holes in parts 26 & 11. Do not use glue until properly aligned with Tamiya A6 & B8 to the bike frame.

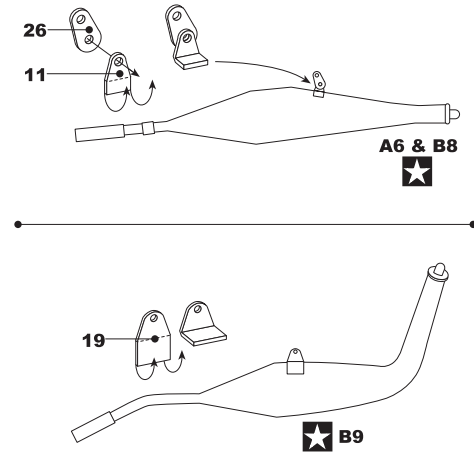

### Chain Link Adjustor Bracket

