



JOHN DEERE

Product Services Information

INSTALLATION INSTRUCTIONS



JOHN DEERE

HPX Attachment Mounting Frame and Control Box

Safety

Read the general safety operating precautions in your machine installation instruction manual for additional safety information.

★ Use only with John Deere approved attachments



Using your Instruction Manual

Read the Installation Manual in entirety, especially the safety information, before operating.

If your Instruction Manual has a section called Preparing the Machine, it means that you will have to do something to your tractor or vehicle before you can install the attachment. The Assembly and Installation sections of this manual provide information to assemble and install the attachment to your tractor or vehicle. Use the Service section to make any needed adjustments and routine service to your attachment.

This product was manufactured by Superior Tech, Inc, a John Deere Licensee, located at 43 Industrial Road, Ephrata, PA 17522. If you have any questions or concerns with the assembly, installation, or operation of this attachment, see your local John Deere dealer or call Superior Tech at 1-888-867-2238 for assistance.

Parts in Kit

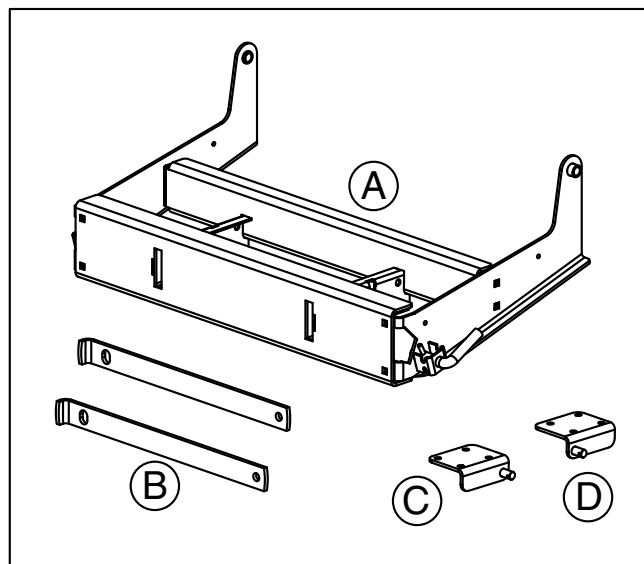

Qty.	Description
1	Frame Assembly (A)
2	Support (B)
1	Bottom Support Left (C)
1	Bottom Support Right (D)

Wiring Kit

Qty.	Description
1	Control Box Assembly
1	Extension Wire Harness- 4 wire, 12 ft
1	Extension Wire Harness- 4 wire, 2 ft
1	Power Relay Wire Harness
5	Push in Cable Clamp
4	#6-32 Screw
1	Control Box Mounting Bracket
1	Control Box Post
10	Wire Ties
1	Blank Connector Plug

Hardware Bag

Qty.	Description
2	1/2" x 2" Clevis Pin
4	3/8" Square U-bolts
4	Bowtie Clip
8	3/8" Flange Nut

Assembly

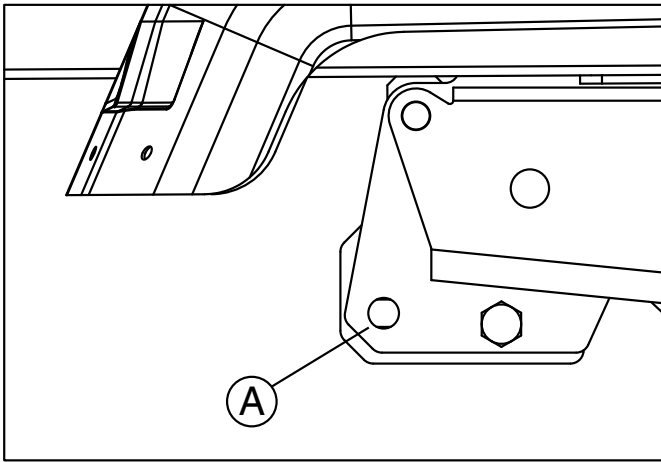

1. At rear of utility vehicle frame, just below where the bed pivots, use 33/64" drill to enlarge hole (A) on both sides of utility vehicle.

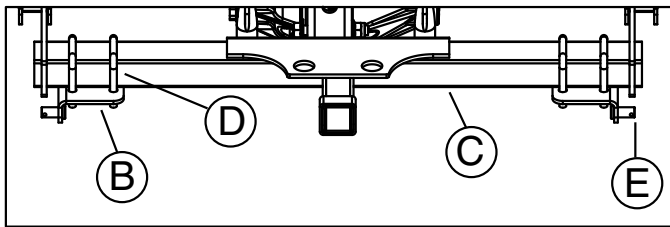

2. Loosely attach the Left and Right Lower Support brackets (B) to the hitch tube (C) as shown using four u-bolts (D) and eight 3/8" flange nuts. Slide the brackets on the tube to line up the end of the pin (E) flush with the outside surface of the plate welded to the hitch tube.

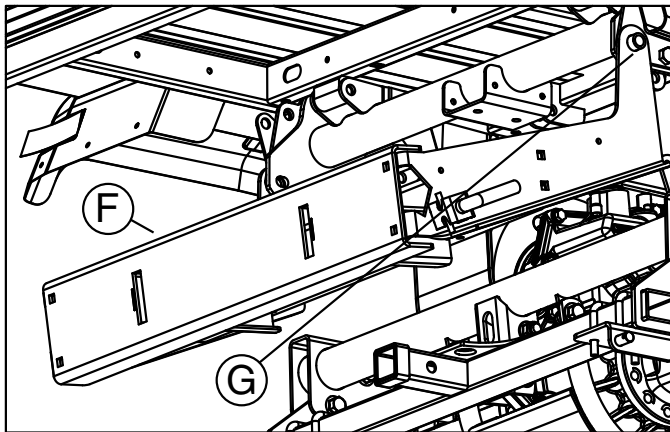

3. Attach Frame Assembly (F) to utility vehicle using two 1/2" x 2" Clevis Pins through holes drilled during step 1 (G). Fasten clevis pins with bowtie clips. (recommend two people do this installation)

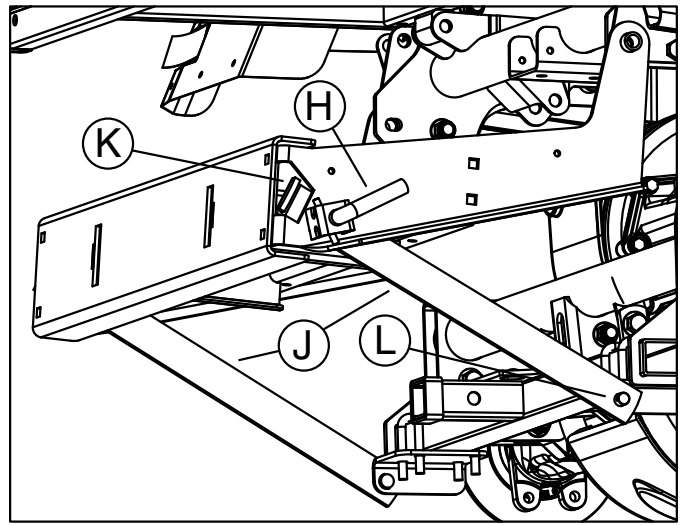

4. With the side pins (H) locked out (pull and turn), slide Supports (J) through the slots in the Frame Assembly at location (K) with the bent end at the top facing towards the outside. Place lower holes over the pins on the Lower Supports (L) and secure with bowtie clips.

5. Release side pins (H) and lift frame until it clicks into place. Be sure the frame is locked in position before mounting attachment.

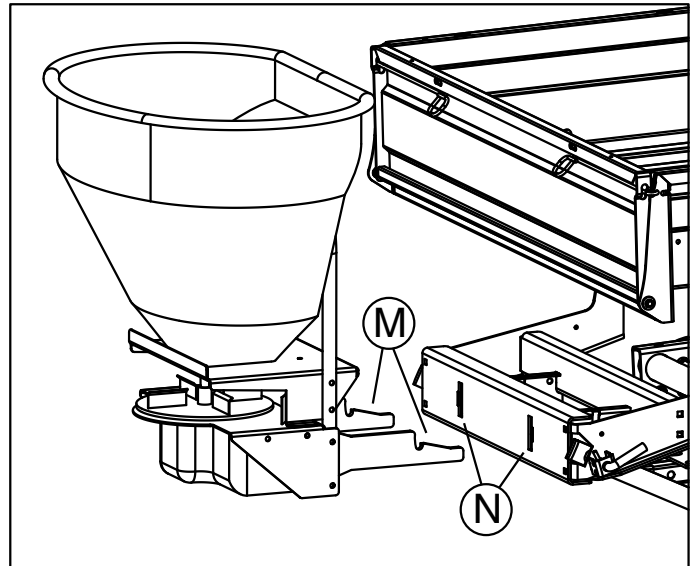

6. Slide receiver arms (M) into the slots (N) until it clicks to lock into place. Be sure the hitch latches securely. Adding grease to the slots makes installation easier. (It is recommended that two people lift the spreader into place)

Control Box Mount and Wiring

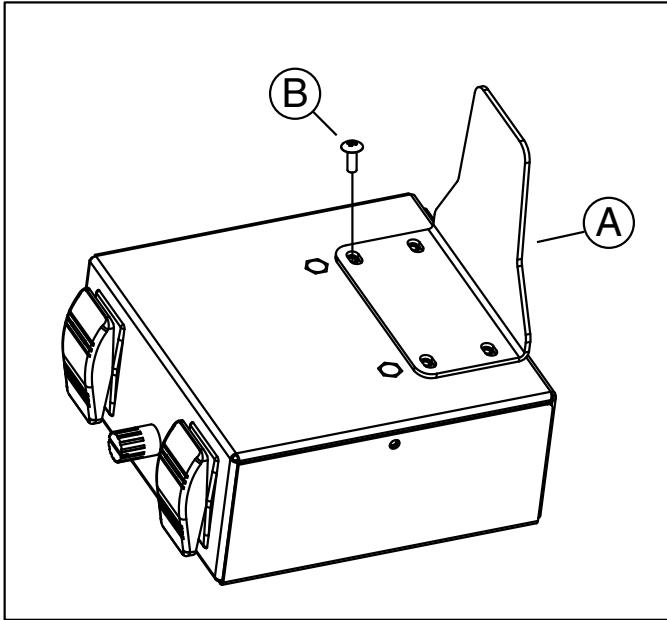

1. Connect Control Box Post (A) to bottom of control box using four #6-32 screws (B) as shown.

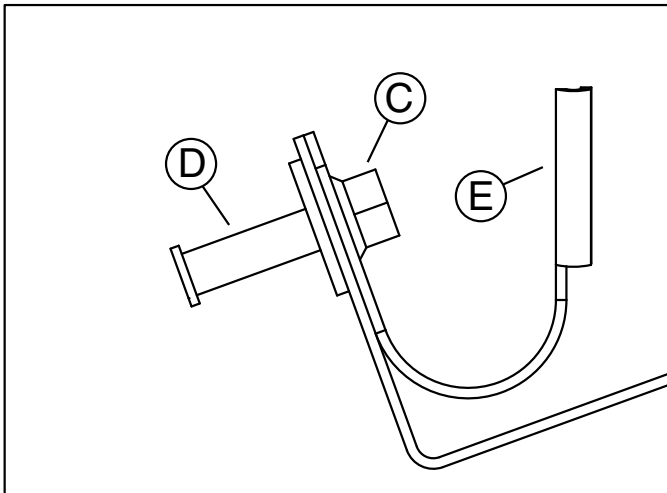

2. Open hood and remove plastic storage tray. Remove the nut (C) from the hood latch pin (D). Attach the Control Box Mounting Bracket (E) to the end of the bolt and replace nut (C). To ensure the hood latches properly, replace bolt in the same position as removed. Mount the control box.

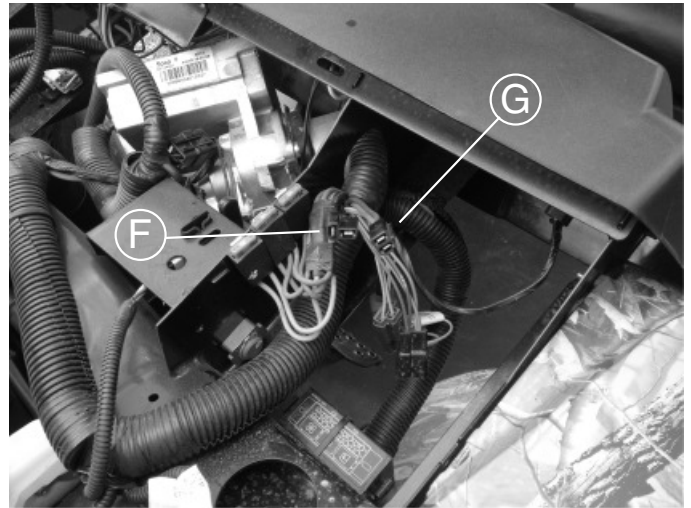

3. Run power wire harness from the control box under the dashboard to behind the steering console. Plug into the two mating plugs (F & G).

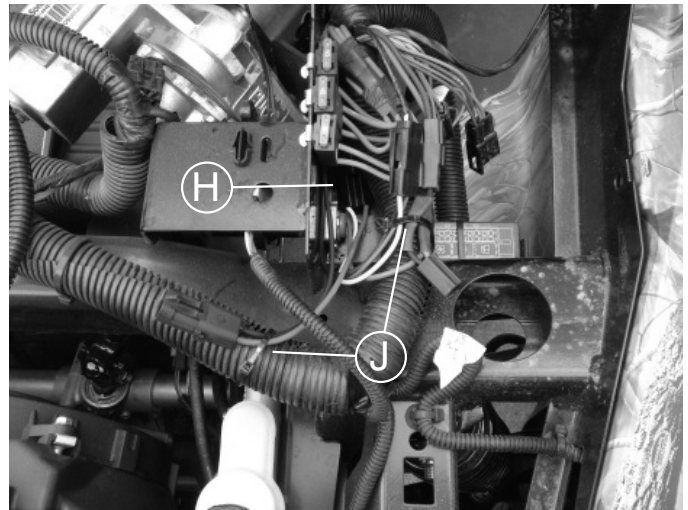

4. Tuck the relay (H) under the bundle of wires and wire tie (J) both ends of the harness to existing conduit.

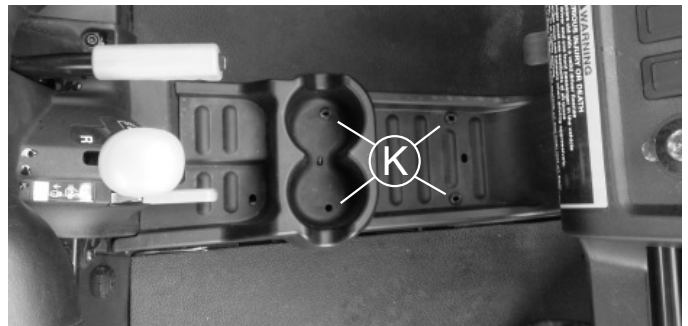

5. Pull the four plastic pins (K) to remove the center console cover.

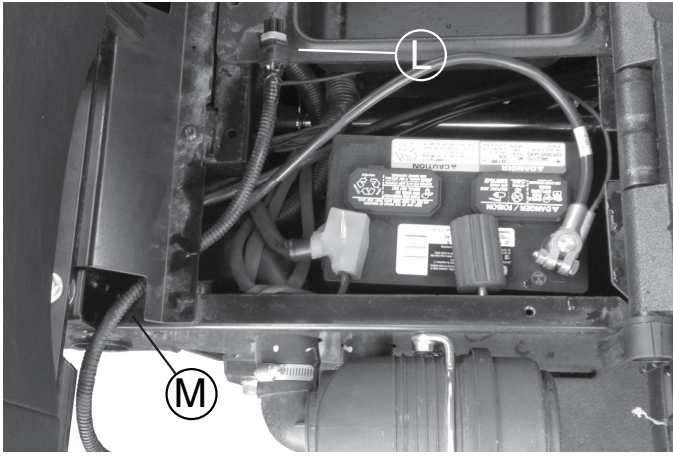

6. Lift the passenger seat to access the battery compartment. Route the male end of the 12 foot extension (L) into the battery compartment through the gap behind the seat (M).

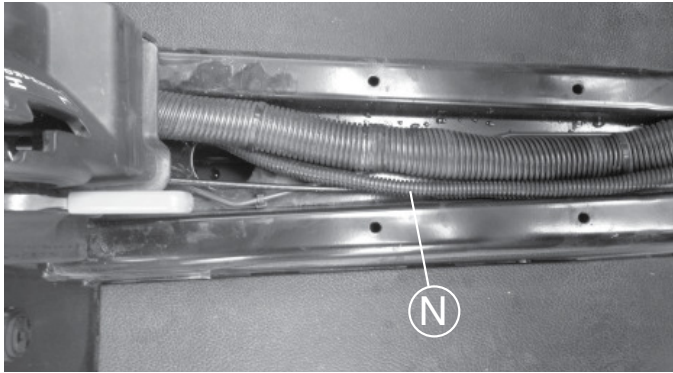

7. Route the 12 foot extension wire (N) from the battery compartment down into the center channel and bring it all the way forward along side the existing larger conduit.

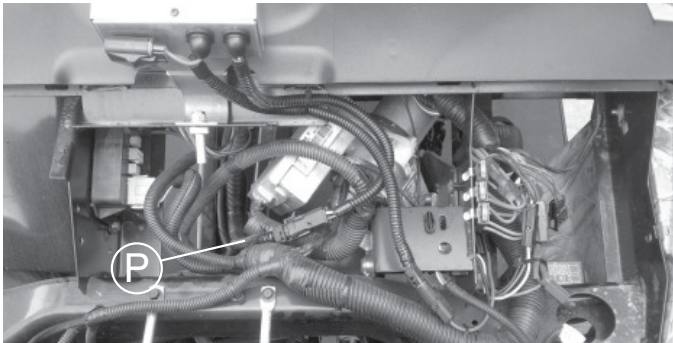

8. Bring the 12 foot extension end (P) up and plug into the control box. Tie the end to the larger conduit in a place where it can be conveniently plugged together and pulled apart.

9. Pull any excess wire rearward and tie off to the larger conduit. Keep the 12 foot extension to the drivers side between the front seats to avoid the shift and parking brake mechanisms. Replace center console covers.

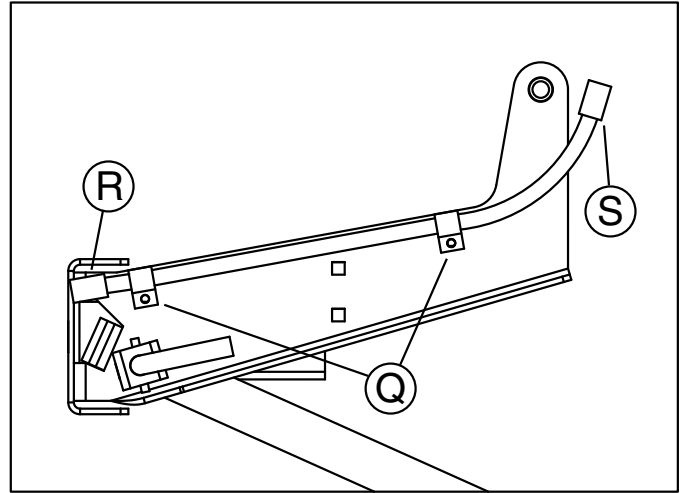

10. Insert two push in cable clamps into the two holes (Q). Plug the female end (R) of the two foot wire extension together with the connector on the spreader. Pull the wire as far forward on the machine as possible and clamp it into place. (Leave enough slack that the connection can be made and pulled apart without too much trouble).

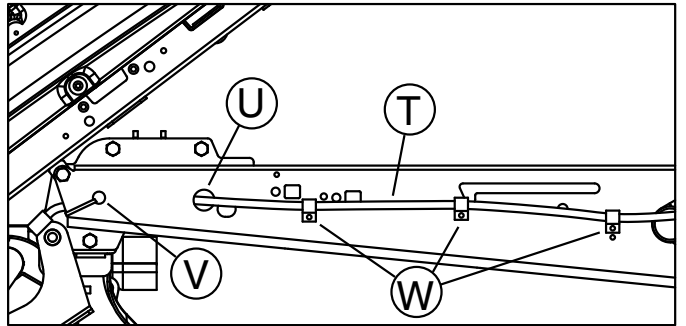

11. From the battery compartment route the 12 foot extension (T) rearward along the outside of the vehicle frame through the large hole (U) and out the end of the frame tube. Connect the end with the free end on the attachment mounting frame (step 10 part (S)) and pull the wire forward as far as possible. Wire tie the wire to the Gator frame through hole (V). (Leave enough wire sticking out the end of the tube that the connection can be made and pulled apart without too much trouble).

NOTE: This wire will remain on the machine when the attachment and frame are removed. Use included connector plug to prevent dirt and debris from getting in the wire end.

12. Install the push in cable clamps into the three holes shown (W) and clamp the wire into place.

13. Wrap up any excess wire in the battery compartment.

Operation

Raising the utility vehicle bed

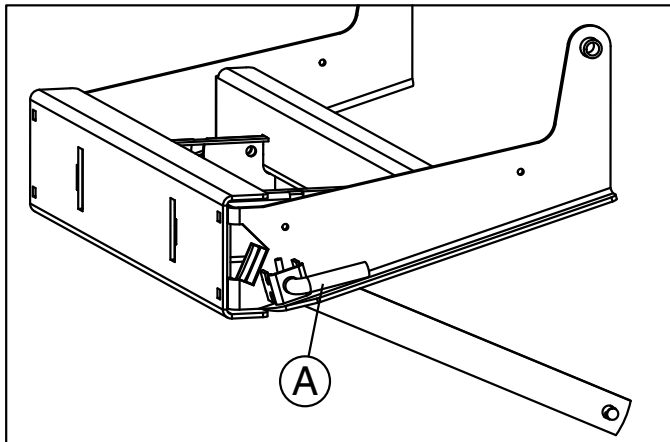

If you wish to raise the bed without removing the attachment mounting frame, it can be folded down by pulling the Pins (A) and turning to lock them out. (Lift up on the frame when pulling the second pin and lower gently to the ground). To put the attachment mounting frame back into position, release the pins and lift the frame until it clicks into position.



Be sure the attachment mounting frame is locked in the up position when operating the vehicle. Driving with the frame folded down may damage the frame or vehicle.

Release attachment

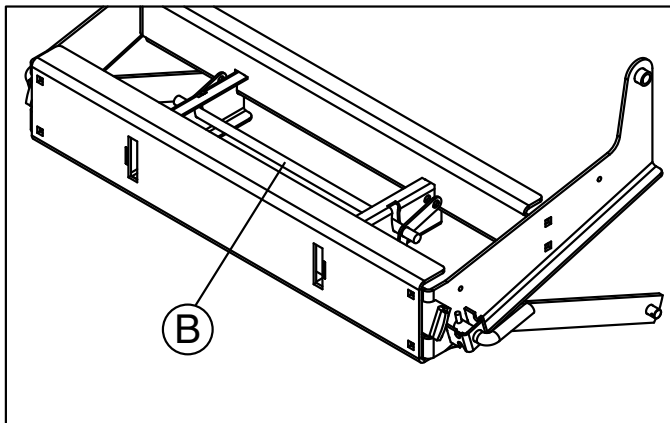

To release an attachment, lift rod (B) and slide the attachment forward slightly. This will unlock it, enabling it to be pulled out.