

COVENTRY

BRASS WORKS LIMITED

Lavatory Set Installation Instructions



LEAVE FOR HOME OWNER

Care Instructions:

The Coventry Brassworks Product you have just purchased is designed to provide you with long lasting beauty and dependability. To ensure your product's longevity, please follow the following care instructions.

When installing, we recommend you lay all parts on a soft cloth or towel to avoid scratching or damaging the product. To care for your fitting, wipe with a clean, soft, damp cloth and blot dry as often as possible. Never use abrasive cleansers, sponges, or acidic cleaning products as these may damage the finish and may VOID THE WARRANTY.

Please read ALL instructions, cautions, and care recommendations before beginning installation.

All Coventry Brasswork products satisfy all ANSI/ASME test requirements for USA.

TESTED TO ASME
A112.18.1M/ASSE 1016

FLOW RATES:
SHOWER HEADS 2.5 GPM/9.5 LPM,
AERATORS 2.2GPM/8.3 LPM

Coventry Brassworks products comply with Section 9 of NSF 61 criteria concerning lead content.

CAUTIONS

- *Take special care to protect all components during the construction and installation.*
- *Before removal of old faucet, always turn off water.*
- *Open the faucets to reduce water pressure and to insure that complete water shut off has been accomplished.*
- *Before faucet installation, carefully flush all water lines.*
- *After faucet installation, remove aerator and flush all water lines again.
FAILURE TO DO SO MAY DAMAGE INTERNAL PARTS!*
- *Plumber's putty is not recommended. Use of caustic substances or acidic curing products for installation purposes may harm the finish or cause the product to not function properly.
Please read the cautions printed on any product purchased for use during installation.*

Note: This fitting has been factory assembled, tested and is ready for installation.

Recommended Installation Instructions:

Read all instructions completely before proceeding!

Step 1:

Disassemble both the four way tee and the plastic nut from the spout shank. Place the shank through the hole in the center of the deck or the plumbing fixture and secure by reapplying the plastic nut to the shank and tightening from the underside.

Step 2:

Reassemble the four way tee to the bottom of the shank as shown in the diagram. Make sure it is secure.

Step 3:

The **BLUE** marked valve is the **COLD** side. The **RED** marked valve is the **HOT** side.

Locate both the hot and the cold lavatory valves. Spin the bottom valve mounting nut all the way down the valve and remove the top nut. Insert valve bodies up through the holes in the deck, then drop on the top mounting nut. Make sure the valve outlets are facing the spout as shown. Thread on the nuts while adjusting the valve so that the valve is 1-5/8" above the surface of the deck.

Step 4:

Test the previous height by temporarily placing the handle pieces over the valve. After you have checked the fitting, test the smooth 1/4 turn feature of the handle first. Remove handle pieces and tighten the mounting nuts with a wrench.

Step 5:

Plumb the inlets of the valves to the water supply using supply tubes and angle stops, supplied by others. Connect each outlet to the connection tee using the stainless steel hoses as depicted in Figure 1. The stainless steel hoses are self sealing, and should not be over tightened.

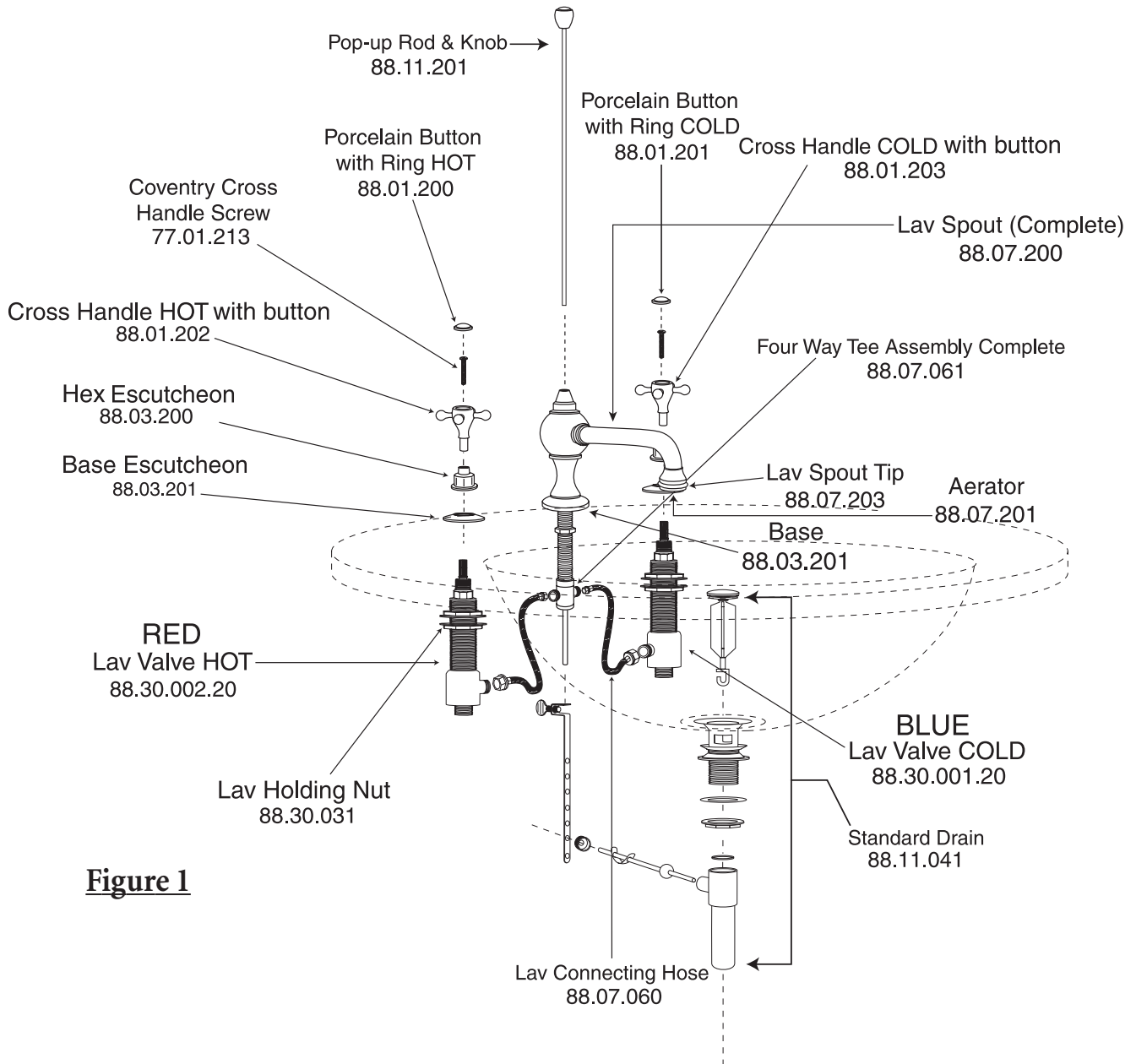

Figure 1

Valve Care:

Your 1/4 turn ceramic valve will provide you with a lifetime of unfailing service, when cared for properly. The most common valve problem is a result of debris in the water line, such as sand, silt, solder, metal shavings, lime deposits, or other foreign particles. Debris can become lodged between the ceramic discs and result in improper functioning of the open and close action of the valve. Particles can even cause cracks in the discs and render the cartridge useless.

SEE ATTACHED CLEANING INSTRUCTIONS.

Step 6:

Disassemble the standard drain parts as shown in Figure 1. Remove all washers and nuts. Place the upper portion of the main drain body through the drain hole, then secure using nuts and washers.

Step 7:

Attach the lower portion of the drain body to the upper portion, making sure the ball rod opening faces the rear of the sink. Carefully insert the ball rod so that it goes through the hook in the plunger. Hand tighten the ball rod nut. Insert the other end of the ball rod through the bottom of the pop-up strap as shown in Figure 2.

Step 8:

After placing pop-up rod through the top of the spout, insert the end into the pop-up strap. Adjust rise and seal of the drain plug before tightening the screw on the strap. When installation is complete, check system for any leaks.

Enjoy your new Coventry faucet!

Figure 2

