



ULTIMA SELECT



ULTIMA SELECT

Thank you for choosing the boAt Ultima Select as your fitness transformation companion.

Allow this manual to guide you through the functioning of your smartwatch. Please read it thoroughly before using it for a smooth sail. You may refer to these instructions for later use as well.



USER MANUAL

Package Contains:

- boAt Ultima Select x1
- USB magnetic charging cable x1
- User Manual x1
- Warranty Card x1

CHARGING THE WATCH

The smartwatch must be charged before initial use. It takes up to 2 hours to be fully charged. Connect and charge the watch with the image below as a reference, using a 5V/2A adapter.

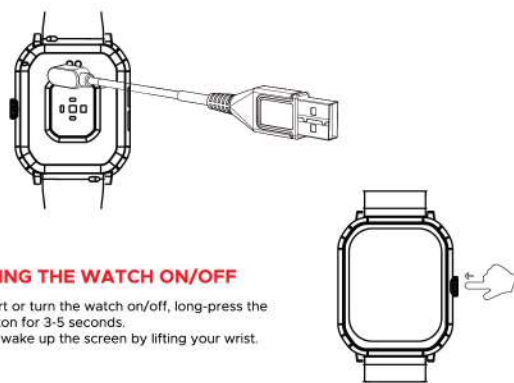

TURNING THE WATCH ON/OFF

To restart or turn the watch on/off, long-press the side button for 3-5 seconds. You can wake up the screen by lifting your wrist.

CONNECTING TO THE APP

1. Download the boAt Wearables app on your phone. Available on both App Store (iOS 12.0 and above) and Google Play Store (Android 7.0 and above)



OR

Scan [QR CODE] (Also available on the watch)

2. Connect the device with the boAt Wearables app; ensure that the phone's Bluetooth, as well as the GPS functionalities, are turned on

3. Select Ultima Select on the app's home screen and click pair to connect.

4. Once connected, you will get an alert to connect with ULTIMASELECT, click pair if need to receive or make calls from the watch

5. To use all your Ultima Select features seamlessly, tap on 'yes' to the 'connection' and 'grant access' system prompt.

6. Disable battery optimization



Note: To ensure connectivity throughout your journey, make sure the app is allowed to always run in the background of your phone.

SYNCING YOUR SMARTWATCH TO THE APP

Data Synchronization

- Open the app on your phone.
- Make sure your Ultima Select is connected to the app.
- Synchronization will start automatically once you enter the app interface.

Note:

Synchronize data at least once a day to avoid data loss in the watch.

NAVIGATING THROUGH THE FUNCTIONS SWIPE RIGHT FOR THE MAIN MENU

Activity

Click on this to check your daily activity data like step count, calories, and distance covered.



Sleep Monitor

Tap on the icon to review the sleep data of the previous night. Once the asleep criteria are met, your smartwatch will start recording from 8 pm at night to 10 am in the morning the next day. Once you lie down and watch detects no movement for 30 minutes, it will start recording, and will stop recording if it detects excessive movement. You can check the data on the app only after the awake criteria is met. You can also track sleep scores on the watch or through the boAt Wearables app.



Note:

*For accurate sleep data recording, the asleep criteria have to be met which includes limited movement, wrist positions and angles, and more. *The awake criteria will be met only after it records some noticeable movement.

Heart Rate Monitor

Wear the watch on your wrist, and measure the heart rate. You can view the detailed data by swiping up or through the app.



Note: Measurements are for reference only and not for medical purposes

Phone call

To use the BT Calling feature, open the boAt app and pair the watch. Once paired you will get the pop-up on the app home screen to connect with the Phone's Bluetooth. Click on "pair" to connect with the phone's Bluetooth. Alternatively, you can go to the phone's Bluetooth settings and pair "ULTIMASELECT_BT" to start the calling feature on your watch. You can save up to 8 contacts.



***Note: Enable call alerts from the setting to get calls on the watch**

Exercise

Choose from multiple sports modes like Walking, Running, Cycling, Skipping, Badminton, Basketball, Football, Swimming, Climbing, Rugby, Golf, and Yoga. You can also add or replace the activities according to your preference through the watch. Only one activity will be replaced on the watch.



Tap on any sport mode to start the activity, and the watch will start recording the duration of the activity. Swipe left or short press the side button to pause or stop the activity. The activity will not be recorded if it is less than 3 mins.

Exercise Records

Sync your smartwatch to the app to get a detailed record of your activities.



SPO2 monitoring

Wear the watch on your wrist, then click on the icon to start measurements. You can view the detailed data by swiping up or through the app.



Note: Measurements are for reference only and not for medical purposes.

Weather

Connect with the boAt Wearables app to get daily weather updates on the watch.



Messages

Tap on this icon to check your messages.



Shutter

Tap on the remote camera icon on your smartwatch and make sure it is connected with the phone's Bluetooth to click a photo from your phone.



Note: Turn the camera on from your phone to use this feature.

Player

Tap on the player icon on your watch to play music from your phone.



Note: Some apps with different protocols might not work.

Voice Assistant

Tap on this and pair the watch with the phone's Bluetooth and give the command from the watch.



Games

Tap on this and start playing built-in game.



SETTING

Display

Tap on this to adjust the brightness, Auto-lock, change watch faces and menu view, and enable the wake gesture.

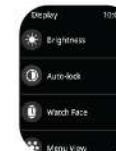

Always on Display

Click on this to enable always on display. You can also select Digital or Analog mode.



Note: The battery will drain quickly once this mode is enabled

Vibration & ring

Tap on this to choose from mute, ring and vibration and Vibration option.



Do Not Disturb

Tap on this to turn on the Do Not Disturb mode.



Eco Mode

Tap on this to enable power-saving mode.

Note: Vibration, wake gesture will be turned off and brightness will be reduced to minimum once this mode is enabled.



Phone Call

Tap on this to enable calling output, media audio and to reset the phone's Bluetooth.



System

Tap on this to restart, power off or reset the smartwatch.



About

Shows the FW Version, BIS information and app download details



MORE

Timer

Tap on this to turn on the timer.



Alarm

Tap on this to set an alarm on your watch.



Stopwatch

Click on this to start the stopwatch on your watch.



Cycle Tracking

Enable and set the details on the boAt Wearables app and get alerts of your period and ovulation dates on the watch.



Flashlight

Tap on this to turn your dial into a flashlight.



Find My Phone

Tap on this icon to find your phone. Once enabled, your phone will start ringing and vibrating. Tap again to stop it.



Swipe down for the shortcut menu

You can access DND, power saving mode, Brightness, Flashlight, E-Card and Settings.



Swipe left to access all data.

You can access activity, sleep, heart rate, SpO2, and weather.



Swipe up to access messages.

You can check all the messages from here.



PRODUCT PARAMETERS:

Model	boAt Ultima Select
Screen type	2.01" AMOLED Display
Battery capacity	280mAh
Net weight	38g
Bluetooth version	Bluetooth 5.2
Working temperature	-20 °C - -40 °C
Charging time	2 Hours
Working time	7 Days
Water Resistance	IP68
Frequency band	2.4-2.48GHz

MAINTENANCE:

Regularly clean your wrist and the strap of the smartwatch, especially after sweating during exercise or being exposed to substances such as soap or detergent, which may get stuck on the other end of the product.

Do not wash the strap with a household cleanser. Please use soap less detergent, rinse thoroughly and wipe with a piece of soft towel or napkin. For spots or stains that are not easy to remove, scrub the area with rubbing alcohol and then follow the above procedure.

FAQ

Search for the app to connect keeps failing.

1. Keep the boAt Wearable app updated to the latest version
2. Close all the programs on the watch → Stop and restart Bluetooth and GPS → Connect again
3. Check and enable the notification functions of your phone and keep the phone and watch in close contact.

Note: Make sure your phone system meets Android 7.0 and above and iOS 12.0 and above.

My Watch Ultima Select is receiving no alerts, texts, or phone calls.

Make sure smart reminders on the app are on and synced to Ultima Select. Also, make sure the notification centre of the phone is displaying messages. Only then will your smartwatch also display those notifications. Make sure app is running in the background and the battery optimization feature on the phone is disabled.

My Bluetooth keeps getting disconnected.

1. Make sure there is not more than 7m distance between Bluetooth on the phone and the watch.
2. There is no obstacle between the watch and the phone.
3. Make sure the app is running in the background.

Which functions of Ultima Select need Bluetooth to work?

Call & Text Notifications, Find My Phone, music control, camera control, weather forecast, cloud and custom watch faces and Bluetooth calling need Bluetooth connectivity to work

Will it be okay to take a bath wearing Ultima Select?

The IP68 water resistance will only work under the following conditions:
 (1) Maximum depth of water: 1m
 (2) Maximum time for exposure to water: 10 minutes
 The watch isn't suitable for hot baths, hot springs, saunas, snorkelling, diving, water skiing and other wading or deep-water activities with high-speed water flow.

SAFETY & PRODUCT INFORMATION

Battery

- Do not disassemble, bore or damage the battery.
- Do not disassemble the built in batteries of non-replaceable battery devices.
- Do not use sharp objects to remove the battery.

Health Warning

If you are wearing a pacemaker or other implanted electronic devices, please consult your doctor before using the heart rate monitor of the watch.

- The optical heart rate sensor will glow green. If you suffer from epilepsy or are sensitive to blinking light sources, please consult your physician before wearing this device.
- The device tracks your daily activities through sensors. This data is intended to tell you about your daily activities such as steps, sleep, distance, heart rate and calories, but may not be completely accurate.
- The device accessories, heart rate sensor, oxygen level monitor, and other relevant data is designed for fitness and not for medical purposes. They are not applicable to the diagnosis, monitoring, treatment or prevention of any diseases or symptoms. The heart rate data is for reference only. We're not responsible for any deviation in data.
- Avoid wearing the watch too tightly. Make sure you keep your skin dry - the area that comes in contact with the watch. If symptoms such as redness or swelling appear on your skin, immediately stop using the watch and consult the doctor.

THINGS TO KEEP IN MIND

- Sync data everyday days to avoid data loss.
- Water Resistance will not work for seawater, acidic and alkaline solutions, chemical reagents & other corrosive liquid. The damage or defects caused by misuse or improper use are not covered by the warranty.
- Sports modes support up to 6 hours of exercise at a time.
- Avoid wearing the watch too tight in daily use. Keep the parts of skin touching the watch dry.
- Keep your arm still while measuring data for accurate measurement.

Disclaimer: This product is an electronic monitoring product and is not intended as a medical reference. We reserve the right to modify or improve any of the functions described in this manual without any prior notice. At the same time, we hold the right to continuously update the product content.

CAUTION

RISK OF EXPLOSION IF BATTERY IS REPLACED BY AN INCORRECT SUBSTITUTE.
 DISPOSE OF USED BATTERIES ACCORDING TO THE INSTRUCTIONS.

Old electrical appliances must not be disposed of together with the residual waste, but have to be disposed of separately. The disposal at the communal collecting point via private persons is for free. The owner of old appliances is responsible to bring the appliances to these collecting points or to similar collection points. With this little personal effort you contribute to recycle valuable raw materials and treatment of toxic substances.

