



## 2.1 SOUNDBAR SPEAKER SYSTEM

### Model No.: Aavante Bar 1250

Bluetooth Name: Aavante Bar 1250



*Thank you for choosing the boAt Aavante Bar 1250 as the audio source for your home. Discover a new level of immersive, cinematic audio experience at home with the boAt Aavante Bar 1250. A powerful 80W total output, a slim sound bar and versatile 2-way subwoofer brings every aspect of your entertainment be it a song, show or movie to life. Drivers at each end of your sound bar deliver a clear mid and high range, while a 40W subwoofer fills in the rumbling lows. The 2.1 channel sound system provides a balanced sound and deep bass for your movies, music and even video games and you can experience cinematic sound that revolves around you. Stay plugged into the sound with Bluetooth® wireless technology, AUX and USB mode. Bring your home to life with the boAt Aavante Bar 1250. We request that this guide carefully for proper use of your purchase.*



boat  
plug into nirvana

## Includes:

- Aavante Bar 1250
- Subwoofer
- Remote Control
- 2 X AAA Batteries
- Owner Manual
- Warranty Card
- AUX cable
- Wall mount Hardware

## Controls and connections

1. Led indicator
2. USB Cable
3. Coaxial Cord
4. DC IN
5. SW OUPUT
6. Standby button
7. Vol +
8. Vol -
9. AUX Cord

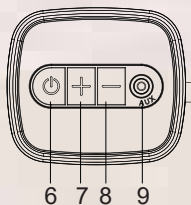
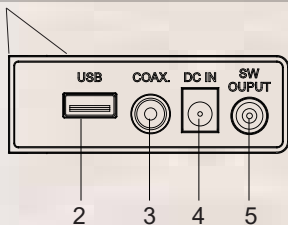
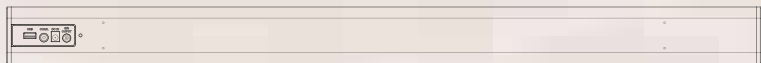
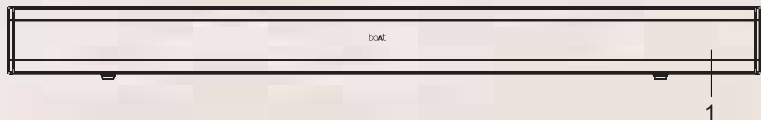
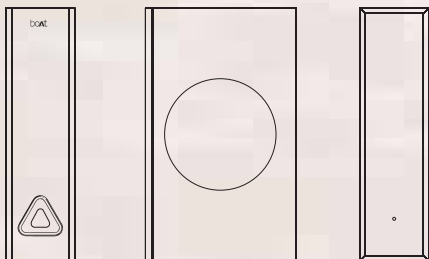

## Remote Control - Control/Functions

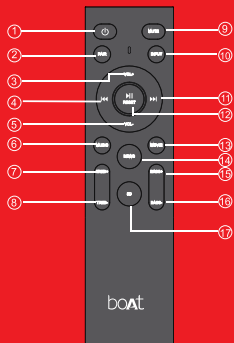

1. : Standby mode for power on/off/Multifunction Button.
2. : PAIR: Connect or disconnect to the pairing device. (Press the button more than 2 seconds).
3. : Volume+ : Master volume up
4. : : Pre button: Previous program (Only work under USB & BT Mode).
5. : Volume - : Master volume down
6. : MUSIC: Select the Music EQ effect.
7. : TR+ : Treble Intensity up.
8. : TR- : Treble Intensity down.
9. : MUTE: Mute mode.
10. : INPUT: Input mode(AUX/USB/HDMI TV(ARC)/OPT/BT).
11. : : Next button: Next program. (Only work under USB and BT mode).
12. : : Play/Pause (Only work under USB and BT mode).
13. : MOVIE: Select the Movie EQ effect.
14. : NEWS: Select the News EQ effect .
15. : Bass + : Bass Intensity Up.
16. : Bass - : Bass Intensity Down.
17. : 3D: Select the 3D EQ effect.

## Remote Control Battery Replacement

Please insert the batteries as indicated below

A: Remove the battery compartment cover



B: Insert 2 AAA batteries according to the markings inside compartment



C: Close the compartment.



## Different Indicators/Modes

To power on the Soundbar, simply plug in the power cord and the red LED indicator will indicate that it is in standby mode. Below are the LED indicators for all modes:

Red: Standby mode

Blue: Bluetooth mode

Yellow: Coaxial mode

Green: AUX mode

Pink: USB mode

To power on/off the Soundbar, simply press and hold the Standby button for up to 3 seconds until the LED light indicator changes.

To change the input mode (Bluetooth, AUX, (USB) tap the Standby button lightly. Each tap will make the mode change once

## Bluetooth Mode

1. Power-on the boAt Aavante Bar 1250 by pressing the Standby button on the Soundbar or on the remote control. The LED indicator will change from red to blue when in Bluetooth pairing mode.
2. Turn on Bluetooth on your phone and search for available devices within range, select "Aavante Bar 1250" from the list of options.
3. If a password is asked for, enter "0000." The blue LED indicator will stop blinking once the pairing has been successful.
4. Playing/pausing tracks, controlling volume and the choosing of tracks can all be done from your connected device; there is no need to interact with the SoundBar. The remote control can be used as well.

## AUX Mode

1. Use a 3.5mm AUX jack to connect any device you intend to use with the boAt Aavante Bar 1250. Use either the buttons on the SoundBar or the "Input" button on the remote to activate AUX mode. A green LED indicator will indicate that AUX mode has been selected.
2. Playback functions (play/pause, tracks, pair) cannot be adjusted through the SoundBar remote when in AUX mode. Other playback functions can be controlled from the buttons on the SoundBar.

## Coaxial Mode

1. Use a coaxial jack to connect the TV you intend to use with boAt Aavante Bar 1250. Use either the buttons on the SoundBar or the "Input" button on the remote to activate Coaxial mode. A yellow LED indicator will indicate that Coaxial mode has been selected.
2. Playback functions (play/pause, tracks, pair) cannot be adjusted through the SoundBar remote when in Coaxial mode. Other playback functions can be controlled from the buttons on the SoundBar.

## USB Mode

1. Plug in your pendrive after switching the SoundBar on, the unit will automatically read through the files and begin playing music. The LED indicator will flash pink when in USB mode.
2. Music playback can be controlled from the buttons on the SoundBar – Volume, Play/pause, change tracks through the remote.
3. Simply remove the USB if you wish to exit this mode. You can also utilize the “Input” button on the Soundbar buttons or use the remote to change the mode.

**Please note: Up 32 GB USB drives containing MP3 file formats are compatible with the SoundBar.**

## MOUNTING INSTRUCTIONS

Please measure the distance between the centre holes on the wall brackets before beginning your work.



- Step 1: Paste 2 pieces of EVA foam (with holes) on the two wall brackets aligning at the hole position of wall brackets.
- Step 2: Remove 4 screws from the rear housing of sound bar, then insert the 4 screws over the wall bracket screw holes aligning (on the side of EVA foam pasted), and then fasten the screws again.
- Step 3: Place the wall mount positioning card against the wall under your TV, mark the 2 bracket holes on the wall with a pencil, then drill two holes on the wall, firstly insert two expansion plastic screws on the wall, then fasten the hanging screws into expansion screw holes.
- Step 4: Then Paste the 2 pieces of EVA foam (without holes) on the two wall brackets downward. Then place the hollow cross in the center of the bracket against the screws on the wall and hang the sound bar on the wall finally.

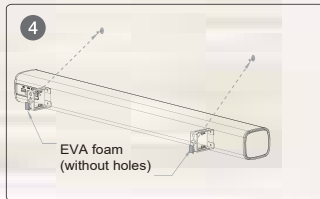
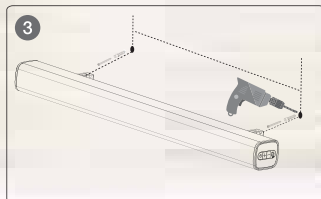
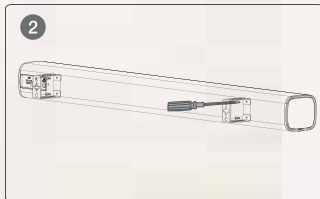
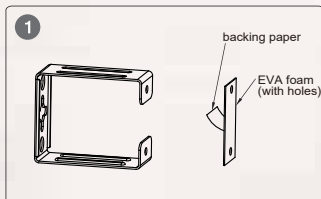

# Important Safety Instructions

## Caution:

To reduce the risk of shock, please do not dismantle the Soundbar and please allow that it does not come into contact with rain or excessive moisture, which can damage the insides. There is no replacement or user-serviceable parts inside, therefore please only contact qualified personnel for reparations.



This symbol indicates a lack of insulation, creating the chance of dangerous voltage release that can shock or harm persons. Please do not use the Soundbar if this symbol appears.



Means that it is of importance, please read the sections wherever it appears carefully, both on the Soundbar and in this Manual.

## Please read this manual before using the boAt Aavante Bar 1250.

As mentioned above, please ensure that any issues with the Soundbar are addressed by persons that have qualifications and experience in the manufacturing/servicing of this product. Please do not attempt to dismantle or service the Soundbar on your own in any fashion. In addition, please only parts that have been provided in the purchase of this product.

- Please do not listen at excessively high volumes for extended periods of time. This can be damaging to one hearing.
- Please do not place apparatus such as vases on the Soundbar
- Please ensure that sources of high temperature are kept away from the Soundbar and that is not exposed to excessive heat through radiators, heaters, stoves, that produce heat.
- Ensure that the voltages on your wall sockets for power output are the same voltage system as the boAt Aavante Bar 1250. Please be careful of the wires, in that they do not cause some to trip and are not pinched and pulled in any way.
- Please keep the device switched off when not in use. Ensure that the plug is always removed directly, never pull on the cord. Further, please plug it in properly before turning on the Soundbar for the first time.
- As mentioned above, please keep away from areas with high moisture.
- Clean the Soundbar with a dry cloth, no chemical solvents or any other cleaning liquids.
- There is a chance of electromagnetic interference between the waves of different devices e.g TV's. Please move such devices away from other if any abnormalities (such as waves appearing on the television) occur.
- The packaging of the product can be useful for further travels, if possible try to store away the packaging during the opening up and placing of the Soundbar.



# TROUBLESHOOTING

| PROBLEM                                       | SOLUTION   |
|---|--|
| No power                                      | <ol style="list-style-type: none"><li>1. Make sure the boAt Aavante Bar 1250 is plugged in and turned on.</li><li>2. Turn off the power switch and wait for a few minutes before trying again</li></ol>  |
| No Sound                                      | <ol style="list-style-type: none"><li>1. Make sure you've selected the proper source</li><li>2. Make sure the volume is set properly on the unit and at the correct playback mode- (Bluetooth, USB or AUX inputs)</li></ol>  |
| Bluetooth pairing fails                       | <ol style="list-style-type: none"><li>1. Check to see that both devices are turned on and that your Bluetooth device is discoverable</li><li>2. Turn both devices off and on again</li><li>3. Make sure you've selected the proper output mode ((Bluetooth, USB or AUX inputs)</li><li>4. Make sure that the Bluetooth is within 5 feet of the unit</li><li>5. Move both devices away from other Bluetooth devices, microwaves, wireless routers, and other electronics</li><li>6. Make sure that the unit is not paired to a previously paired device</li></ol> |
| Flies on USB memory device will not play back | <ol style="list-style-type: none"><li>1. Make sure you've selected the proper source</li><li>2. Make sure that the audio files are in MP3 format.</li><li>3. Make sure that the memory device is no more than 32 Gb</li></ol>  |
| Remote does not work                          | <ol style="list-style-type: none"><li>1. The batteries may have been depleted, attempt placing new ones.</li></ol>   |

## Important Notes

- If connected to a TV via Bluetooth there may be a sound lag between the TV and the device. To solve this, the best option is to connect the TV and Soundbar using an aux output.
- The Soundbar may not be compatible with all Bluetooth capable TV's. In this case, please use an aux output to connect the Tv and Soundbar to one another.

## Specifications

|                    |   |
|--------------------|---|
| Features           | 1,Audio Output: 2.1CH, Wired Subwoofer<br>2,AUX input<br>3,USB input<br>4, Coaxial input<br>5,Wireless Bluetooth connection<br>6,LED indicator<br>7,Plastic case,Digital Amplifier with DSP inside<br>8,Remote controller |
| Power Supply       | SMPS 110V-240V ~ 50/60Hz  |
| Power output       | 20W*2+40W=80W R.M.S.  |
| Driver Unit        | 2.25"*2 SB + 5.25inch SW  |
| Input impedance    | 4Ω*2+6Ω   |
| Frequency Response | 55Hz-20KHz  |
| S/N                | ≥ 72dB  |
| Distortion         | </=1%(1K/1W)  |
| Input Sensitivity  | SB: 800mV±50mV; SW: 400mV±50mV  |
| Dimension(mm)      | Sound bar: 70H*78D*860L mm<br>Subwoofer: 115W*420H*250D mm  |
| Bluetooth Version  | Version: 5.0          Range:up to 10m   |

---



boat  
plug into nirvana

*Hardik Pandya*

Hardik Pandya

## CONNECT WITH US ON



[boAt-lifestyle.com](http://boAt-lifestyle.com)



[facebook.com/boat.nirvana](https://facebook.com/boat.nirvana)



[instagram.com/boat.lifestyle1](https://instagram.com/boat.lifestyle1)

**boAt**  
*plug into nirvana*

**Thank You**