



AIRDOPES 183

AIRDOPES 183

Get ready to immerse yourself in musical bliss with your very own pair of boAt Airdopes 183. Please consider this manual as your guiding map towards the unparalleled shores of musical bliss. Knowledge of Bluetooth and device connectivity is essential for steering this boat and therefore we strongly recommend thorough reading of this manual; also, you may refer to the same at times when you face any sort of difficulty.

PACKAGE CONTENTS

- 1) 1x boAt Airdopes 183
- 2) 1x Charging Case
- 3) 1x Type-C Charging Cable
- 4) 2x Pairs of Additional Earmuffs (Small & Large)
- 5) User Manual
- 6) Warranty Card

OVERVIEW

- 1) CTC (Capacitive Touch Control) / Power Button

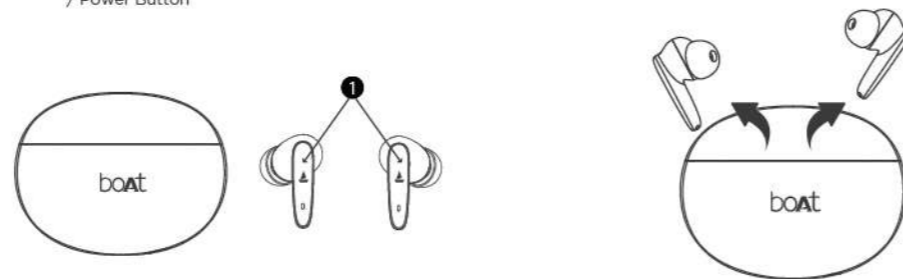

POWER ON (FIRST TIME USER):

Step 1: To switch the earbuds on (Smart Power On) simply open the lid of the charging case (when earbuds are inside). Courtesy our IWP™ technology, the earbuds power on automatically, get connected and enter the connection mode

OR

Long touch the CTC on both earbuds for 3 seconds to manually power on the earbuds

Step 2: After powering on, the earbuds enter into the Connection Mode, indicated by white LED flashes.

CONNECTION MODE:

Step 3: Turn on the Bluetooth functionality on your phone/media device and scan

Step 4: Search for 'Airdopes 183' and pair accordingly.

Congratulations! Your earbuds are now connected successfully via Bluetooth

Note :

- Pairing mode lasts for 3 minutes. If the pairing time is missed, then you will need to reconnect the earbuds and follow the above mentioned procedure
- Airdopes 183 remembers previously connected devices; once switched on, the ear-buds automatically reconnect to the previously connected devices



QUICK GLANCE ON FUNCTIONALITIES

- 3 Seconds: Long touch left CTC for 3 sec to activate voice assistant. Long touch right CTC for 3 sec to activate Beast™ Mode.
- 3 Seconds: Long touch both CTCs for 3 seconds to manually power on
- 8 Seconds: Long touch both CTCs for 8 seconds to manually power off
- 10 Seconds: Long press the Reset button on the charging case when earbuds are inside for factory reset

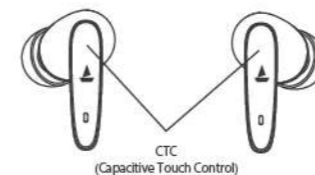

SINGLE EARBUD USAGE

Step 1: Please note that both the earbuds can be used in mono mode. Use Smart / Manual Power On for switching on the desired earbud

Step 2: The selected earbud will automatically enter the connection mode indicated by white LED flashes

Step 3: Turn on Bluetooth on your phone/media device and search for 'Airdopes 183' to connect

Notes:

- To switch to Stereo mode, simply take out the other earbud from the case. It will automatically power on and pair with the previously selected earbud, hence enabling Stereo usage
- You cannot skip tracks or return to the previous tracks in Mono mode

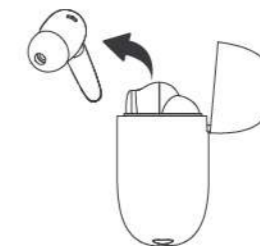

CHARGE THE EARBUDS:

- Step 1: Please insert the earbuds back inside the charging case in correct orientation.
- Step 2: When the case lid gets closed, the case LED stays solid for 5 seconds to indicate that the earbuds are being charged
- Step 3: Once the earbuds are fully charged, the charging case automatically switches off to save power, and the case LED stays off (even while when opened and then closed again)

Note:
 • Before using the earbuds for the first time, it is recommended to fully charge the earbuds. Also, please keep the lid of the charging case closed while charging.
 • If battery is 20% or below then the LED blinks once every 30 seconds to indicate the same along with a low battery prompt.

CHARGE THE CASE:

Step: To charge the case, plug one end of the provided cable into the case and connect the other end to a computer/ wall adapter/ powerbank, etc.

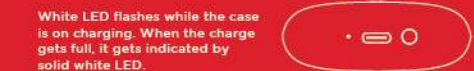

Please note, Whenever the case lid gets opened or closed:

Case Remaining Battery less than 70%	LED flashes thrice
Case Remaining Battery more than 70%	LED stays solid for 3 seconds

BASIC FUNCTIONS:

- Voice Assistant: Long touch the CTC on left earbud for 3 seconds to activate the voice assistant
- Answer: Single tap the CTC on either earbud to answer an incoming call
- Hang Up / Reject Call: Double tap the CTC on either earbud to end or reject call
- Play/Pause Music: Single tap either earbud's CTC to play or pause music
- Next Track: When playing music, double tap the right CTC to skip to the next song
- Previous Track: When playing music, double tap the left CTC to return to the previous song

• BEAST™ Mode: Long touch the right CTC for 3 seconds to switch to Low Latency mode, also known as the BEAST™ Mode. Once switched on, it gets notified via a sound prompt. Long touch the right CTC for 3 seconds to turn it off and return to normal mode. Made for Gamers - By Gamers, BEAST Mode reduces the latency significantly and improves the overall gaming experience.

• ENx Technology: Your Airdopes is equipped with our ENx (Environmental Noise Cancellation) tech by default which helps in producing clear voice delivery across voice calls. Be heard crystal clear on voice calls just as you can be in person.

Note:
 • Volume can only be controlled via the media device

VOICE ASSISTANT:

- Step 1: Long touch the CTC on left earbud for 3 seconds to activate the smart voice assistant
- Step 2: The respective voice assistant screen pops up and you may place your commands at ease

Tips: You may try the following commands,

- What is the weather?
- Play a song
- Set a reminder

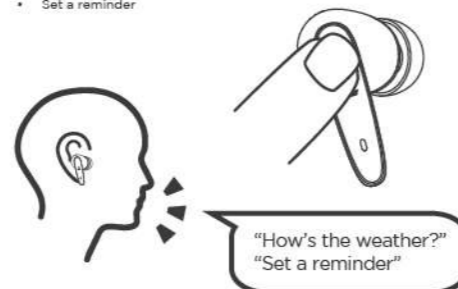

Note: If the voice assistant doesn't get triggered, then the functionality has to be first enabled via your media device settings.

SMART POWER OFF

- Step 1: After usage, remove both the earbuds from your ears
- Step 2: Place the earbuds back into the charging case in correct orientation and close the lid

The earbuds will automatically switch off (and enter into charging mode).



MANUAL POWER OFF

Step 1: Long touch both CTCs for 8 seconds to manually power off

Step 2: Once the earbuds get turned off, place them back inside the case and close the lid.

FACTORY RESET:

Perform the Factory Reset in case you face any difficulty while operating your Airdopes

*NOTE: Before performing reset, clear "Airdopes 183" from pairing device history by forgetting device

Step 1: Place both the earbuds back inside the charging case in correct orientation and let the case lid be remained open

Step 2: Long press the Reset Button on the case for up to 10 seconds to do Factory reset, which gets indicated by the quickly flashing white LED on the charging case

Step 3: Close the case lid; after a few seconds open the same for the earbuds to automatically restart

Congratulations! Your Airdopes 183 has been reset



SPECIFICATIONS

Bluetooth Version	V5.2
Driver Size	10mm*2
Music Playtime	Up to 4HRS per charge; Up to 16HRS additional with Case (at 60% volume)
Standby Time	45H
Transmission Range	10m
ENx Tech (by default)	Yes
Bluetooth Profiles	HFP/ HSP/ A2DP/ AVRCP
Frequency	2402~2480MHz
Battery	300mAh (Case) 35mAh*2 (Earbuds)
Charging Time	45Min-1H (Earbuds) ; 1H-1.5H (Case)
Charging Interface	Type C

Charging norms & Precautionary Guidelines: -

- 1) Charger/Brick/Adapter : 5V 2A
- 2) Cable/Wire : Standard Cable (35 strands @0.10mm diameter/ strand)

Any other accessory can be paired up with the product as long as the specifications are as per above norms.

TROUBLESHOOTING

Potential Problem	Solution
If one earbud is not working	Perform the Factory Reset.
If earbuds are not in connection/scan mode	Perform the Factory Reset.
If earbuds disconnect during phone call	Charge the earbuds or perform the Factory Reset.
If there are other exceptions in usage	Place the earbuds back into the charging case and try using them again or perform the Factory Reset.
If Touch Controls don't seem to respond	After long usage, residual stains & perspiration can affect the touch control area, please use a clean cloth to wipe those areas softly

WARNING:

- Please follow the instructions to operate
- Please don't use the ear-buds in extreme temperatures
- Please don't use the product near water
- Please keep the product away from heat sources, as the heat may damage it
- Don't jam the ports such as charger port, LED port, etc.
- It is recommended to utilize the product below the maximum volume in order to protect hearing and extend the ear-buds' service life

Advisable: The earbuds start at a 100% volume and it may need to be reduced when the earbuds are switched on at first. This can be done by using the phone / media device