

STUDIO

Office Desk

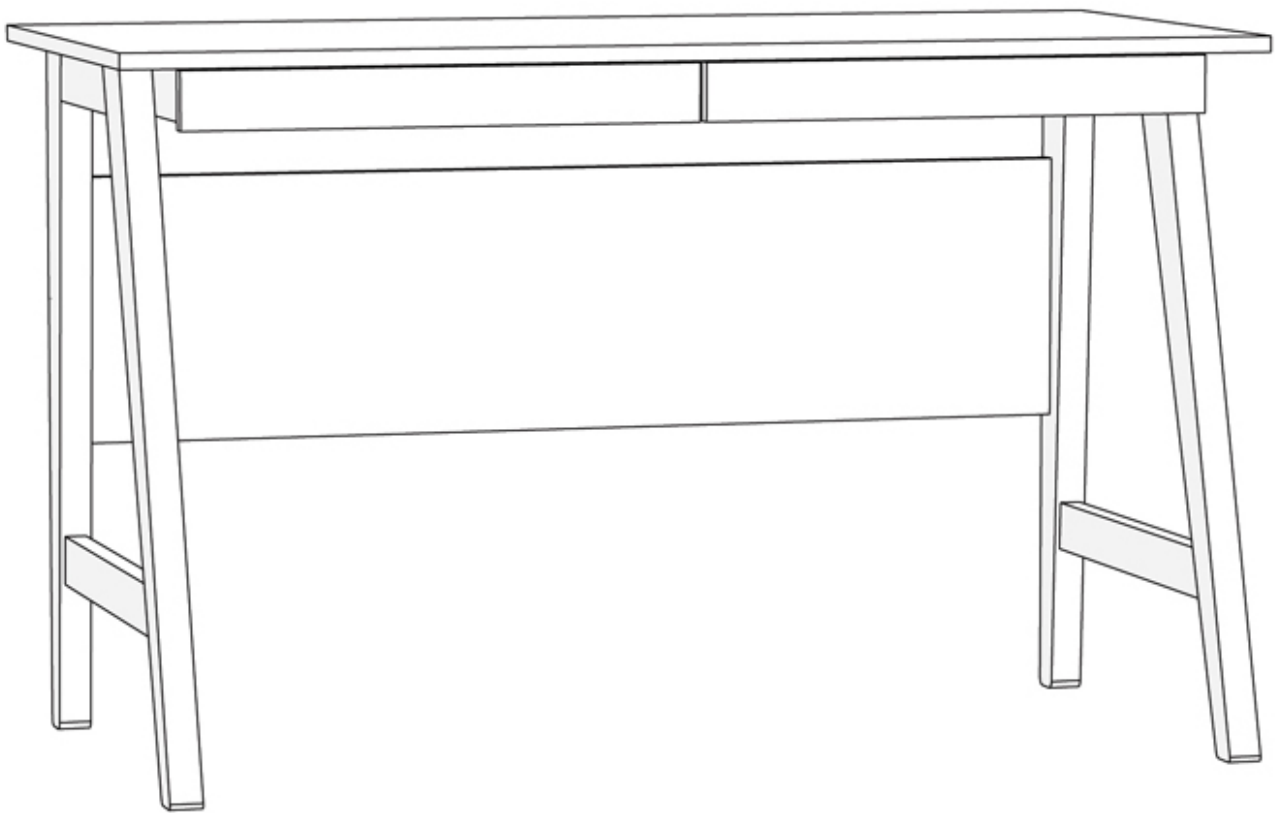

STUDIO

Materials

Top: Laminated MDF/MFC
Legs: Pine wood

Care instructions

Wipe down with a wet cloth and a mild soapy solution then wipe dry with a clean cloth.

Components

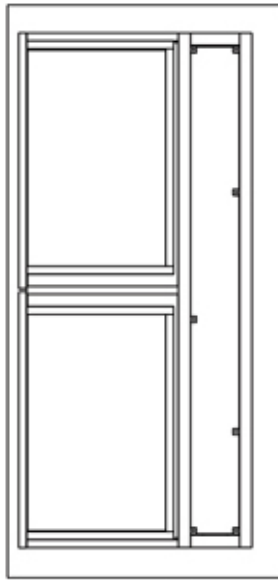

A x 1



B x 1

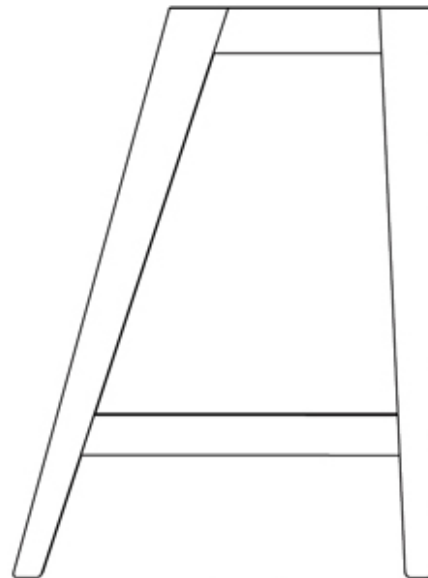

C x 2

Hardware



D x 4



E x 4



F x 4



G x 2

STEP 1

Instructions

Place legs (C) on a soft surface such a carpet to avoid spoiling the polish. Screw the 4 cam bolts (D) into the holes on the side of the legs using a screwdriver (not provided).

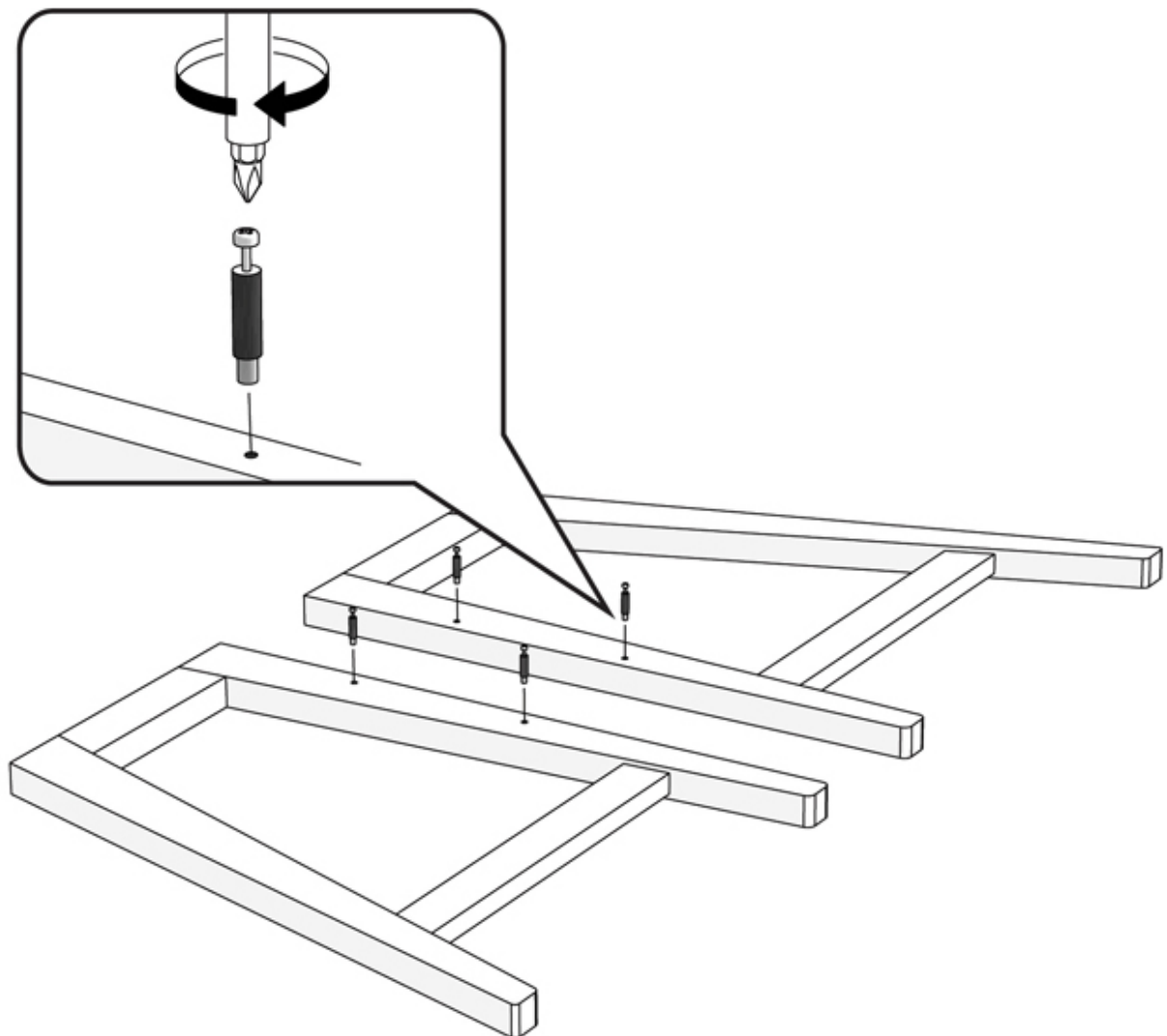

STEP 2

Instructions

Place the top (A) upside down on a soft surface. Position a leg on the top such that the back of the leg is half an inch behind the metal support bracket (Illustration A).

Line the pre-drilled holes in the leg with the holes in the support bracket. Screw the leg to the support bracket using two of the black 2-inch screws (Illustration B).

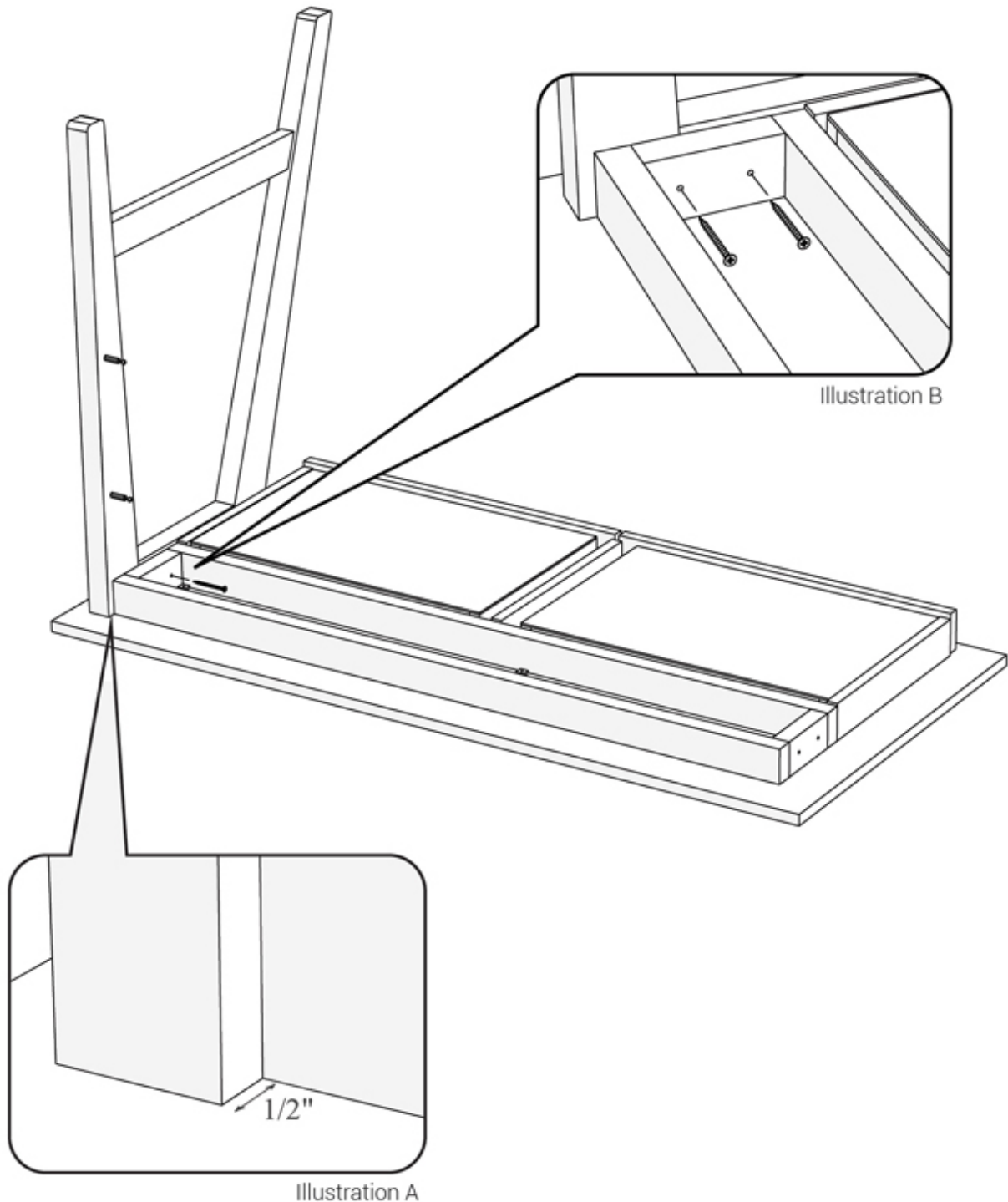

STEP 3

Instructions

Pull out the drawer at least 8 inches to expose the drawer slides. Locate the hole in the slide with a pre-drilled hole behind it and insert a silver 1.5 inch screw (G).

Using the screwdriver, tighten the screw to attach the leg to the side of the drawer.

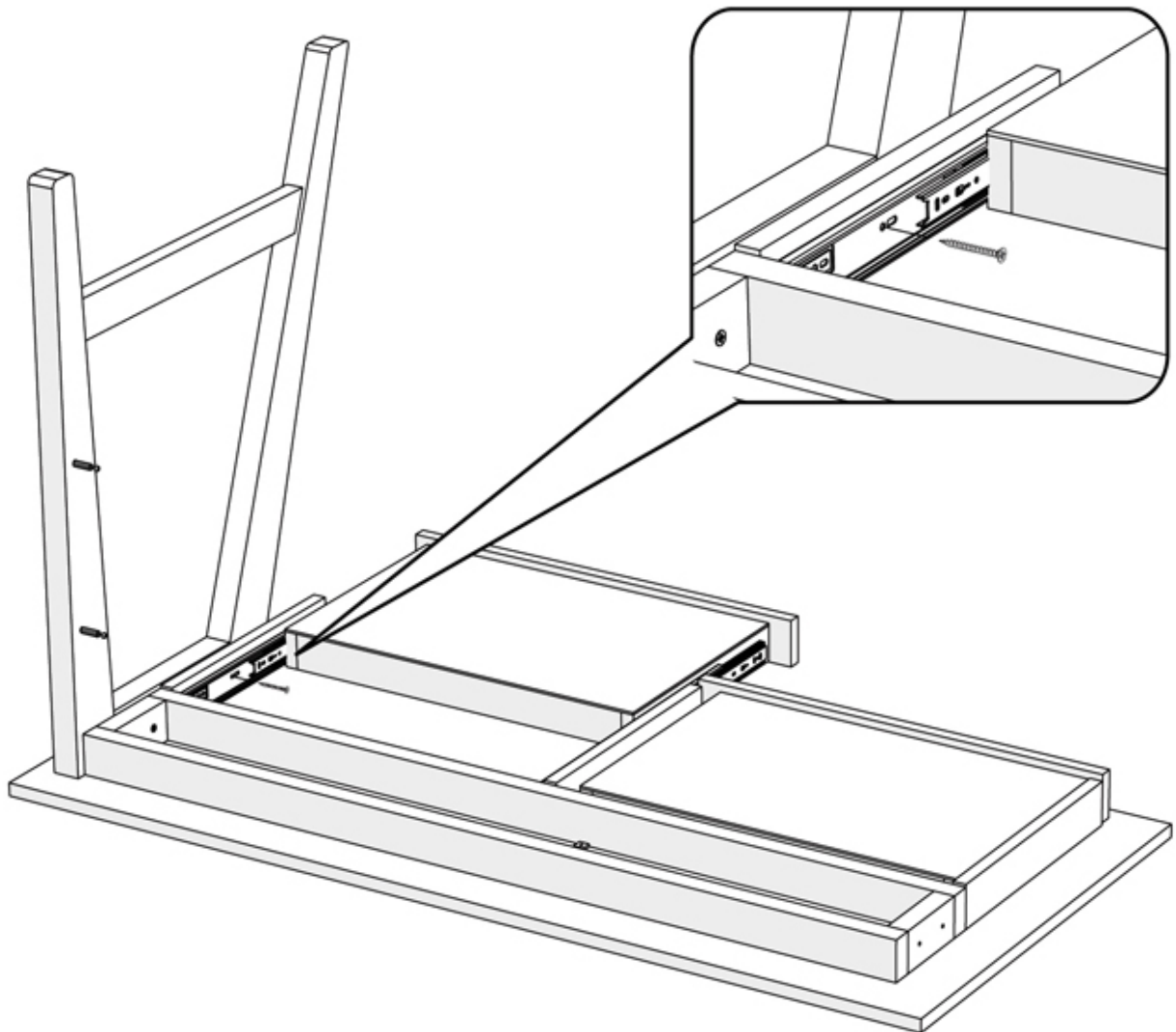

STEP 4

Instructions

Using the help of a second person, slide one end of the support panel (B) onto 2 of the cam bolts that were attached in Step 1.

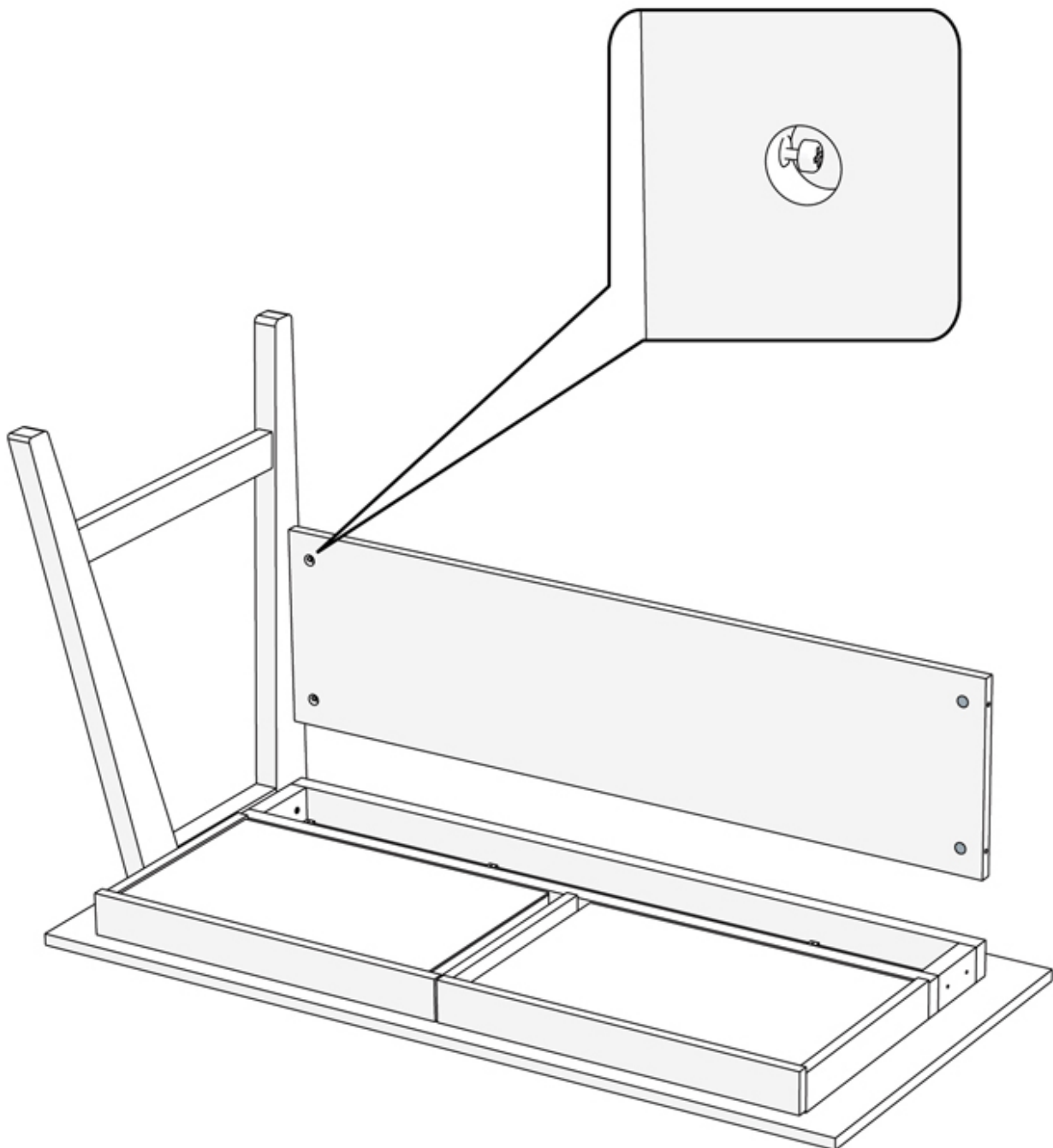

STEP 5

Instructions

Place 2 of the cam locks (E) into the corresponding holes in the support panel, making sure that the arrow on the cam locks is pointing towards the leg.

Tighten the cam locks in a clockwise direction with the help of a screwdriver.

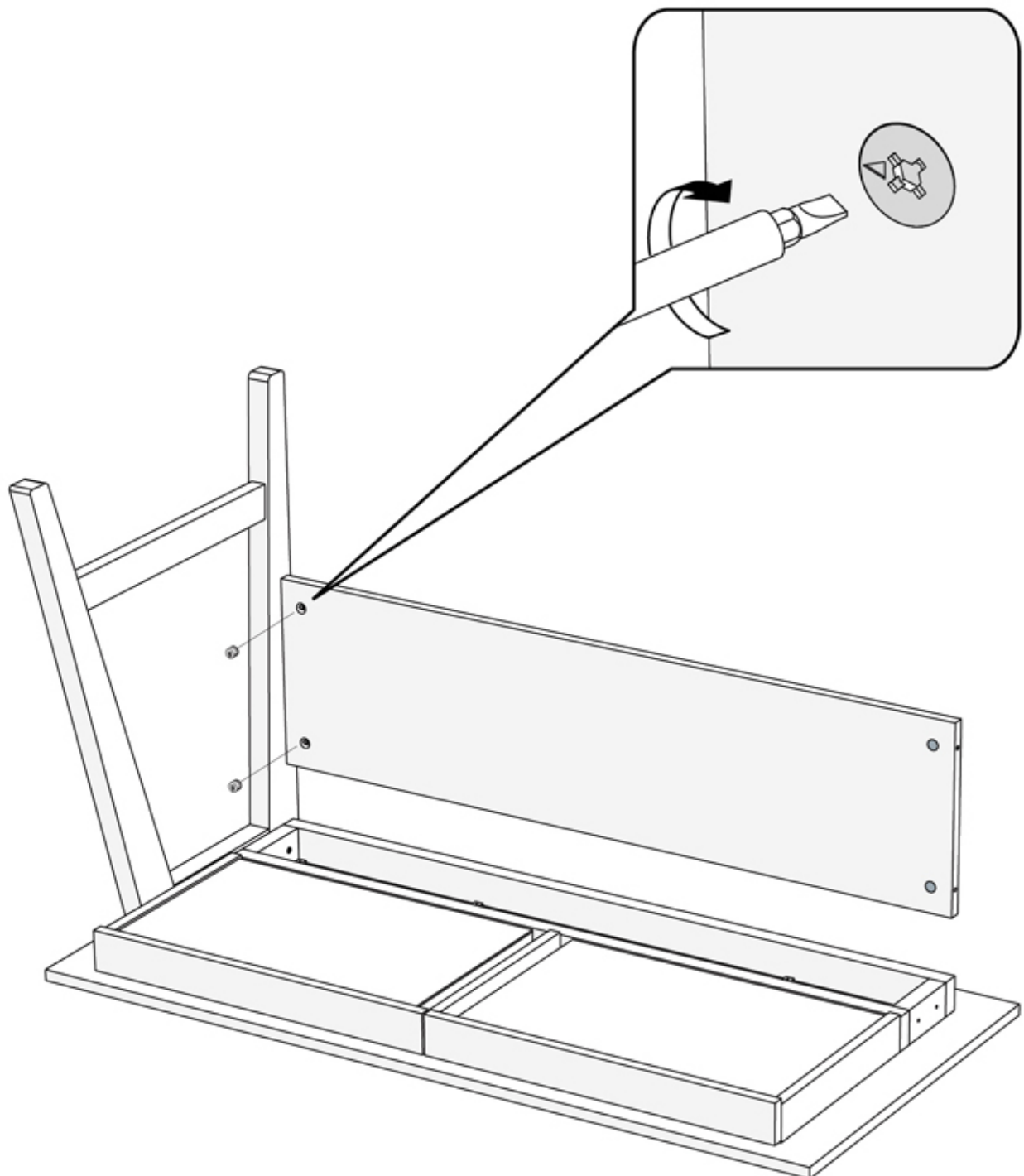

STEP 6

Instructions

Attach the other leg to the table using the remaining screws and bolts.

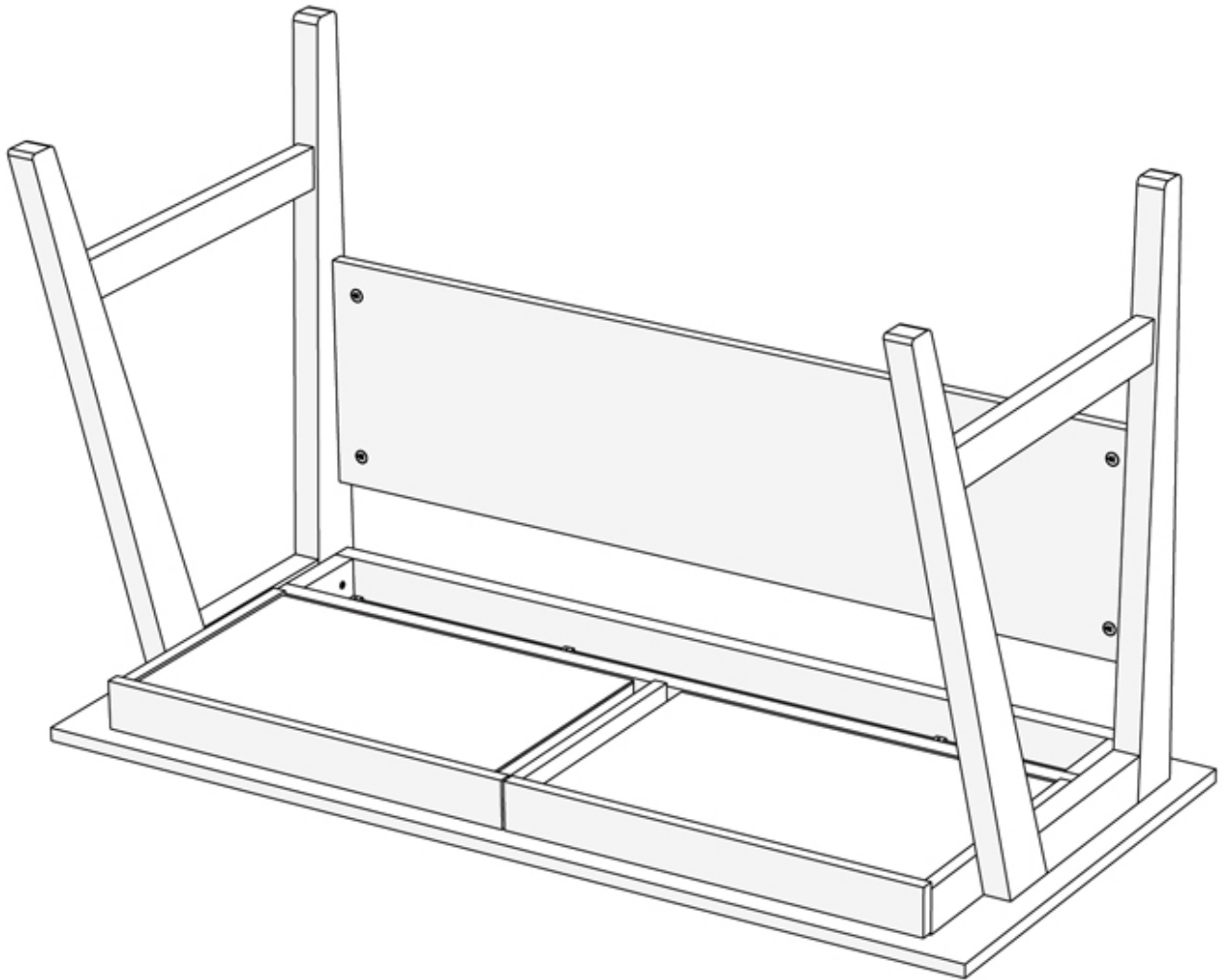

7

In case you require help with these instructions, please contact us via phone/Whatsapp on +92-315-4510439 or email us at info@hex.furniture.