

## Steering switch relocation stay Toyota A1S type

Thank you very much for purchasing our product.

Please read this manual carefully before use.

### Contents of this manual

#### A. Purpose of use/Overview

The purpose of use and overview of the product are described. Please be sure to read this information if you are using the vehicle in which it is installed.

#### B. Contents

All products, accessories, and contents are listed. Please be sure to read this before installation work.

#### C. About installation

This section describes the installation of the product. Please be sure to read this manual if you are performing installation work.

#### D. Precautions

This section contains notes regarding the contents of the product and instruction manual. The user of the vehicle in which it is installed,  
Please be sure to read this.

#### A. Purpose of use/Overview

- Replace Toyota's genuine steering switch with sports type steering wheel and steering wheel.

This is a product that can be moved to the boss and used in conjunction with the ball lock system Rafix series. For this purpose

Please do not use it outside.

- This product is used in conjunction with Works Bell Steering Boss 550 and Rafix series. single

We have not verified that the steering wheel can be attached to a vehicle using this product.

- It cannot be installed on vehicles equipped with steering switch shapes other than those

shown below. - Cannot be used with steering bosses

manufactured by other companies. • This product is compatible with Works Bell ball lock system Rafix (I, II) and Rafix GTC.

We respond. The welded type of Works Bell Rafix Racing cannot be installed directly.

Rafix racing bolt type cannot be installed without using 3-6 hole adapter.

- It is not possible to install quick releases made by other companies or our imitation

products. - Assumes use of a standard sports type 3-spoke steering wheel with a diameter of 350mm or more.

It is designed with. A sports type steering wheel with a smaller diameter or 3 steering wheel

We have not verified the usage of steering wheels other than poke.

- How to remove the genuine steering switch is not described. Vehicle manufacturer or dealer

Please ask.

- For installation of the steering boss, please refer to the instruction manual that comes with the boss.

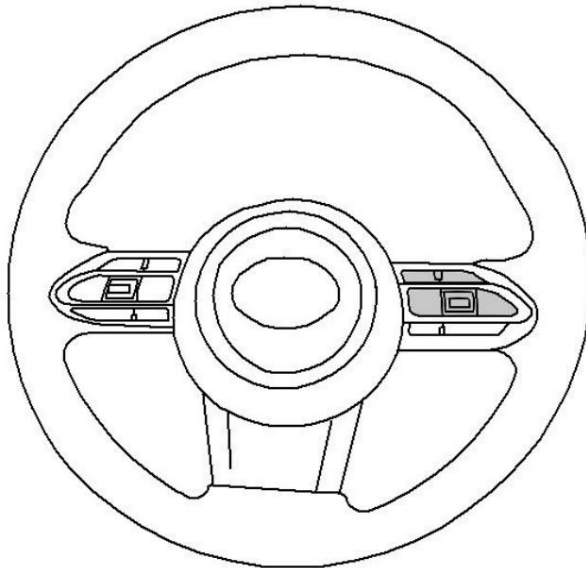

\*The gray part also corresponds to blank (not used) switches.

**B.Contents**

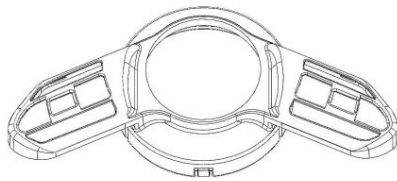

**Switch mount body**

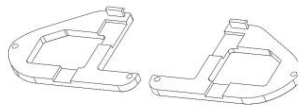

**Back plate (left and right)**

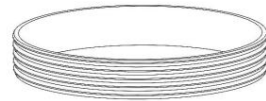

**Lower cover**

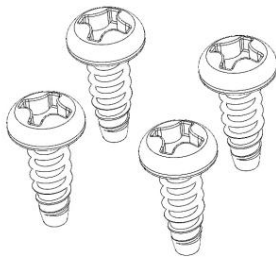

**Tapping screw 3x10-4 pieces**  
12-6 books

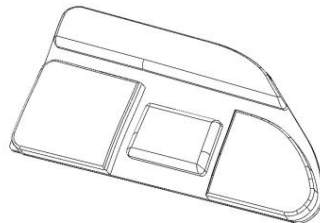

**Blank panel \*1, \*2**

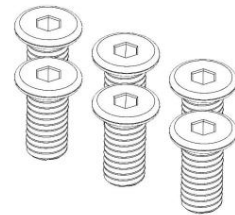

**Extremely low head CAP bolt M6x**

\*1: Not used on vehicles that use all buttons. \*2: It is extremely thin.

**Please never bend it.**

---

### C.About installation

Note: Stop with the steering wheel running straight, and disconnect the battery terminals.

Please remove it before proceeding.

1. From the installed state of Boss 550,  
Steering wheel, horn button, (horn ring)

After removing it, as shown in the figure on the right.

•Boss cover •6

upper mounting bolts •Upper

Remove it and make it as shown in the figure on the right.

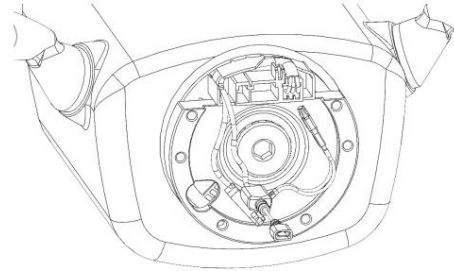
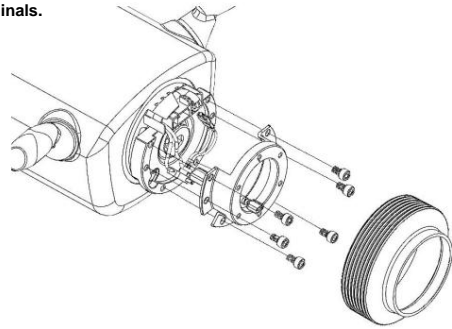

2. From the genuine steering wheel,

•Left and right

switch •Harness Assy

Please remove it. Note:

On some vehicles, the left and right connectors have the same shape.

Check the color and position of each protective tube.

Please remember.

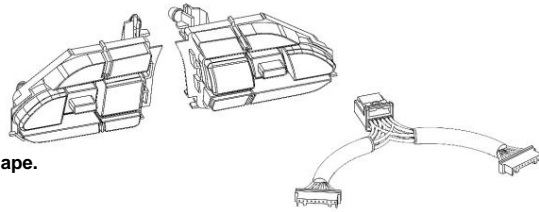

3. From the genuine steering wheel to the switch mount

Install the switch. back plate

Secure with self-tapping screws. bag

The tab of the plate fits into the square hole of the switch mount.

Please enter. Part of the right switch

or blank panels on vehicles that are not in use.

Please attach it between the switch and the mount. Note:

Made of resin. Do not overtighten the screws. Can be broken

There is a possibility.

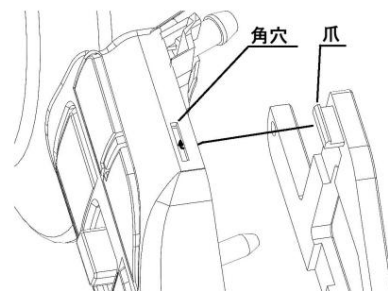
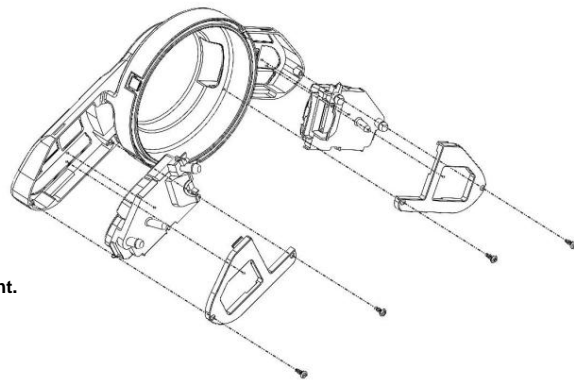

4. Connect the harness assembly connector to the switch

Please insert it.

Note: Please insert the left and right sides correctly.

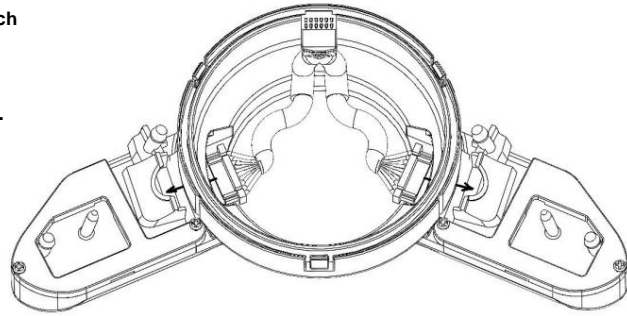

5. Insert the lower cover.

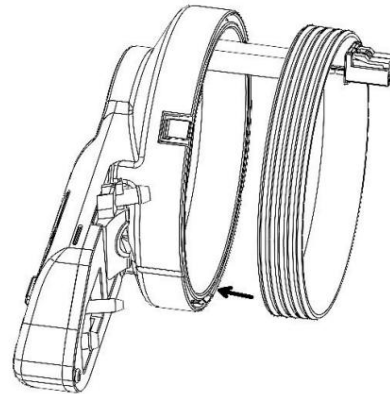

The three claws on the switch mount press against the grooves on the lower cover.

Hold and secure. Shake the cover down to make sure it doesn't fall off.

If so, it is fixed.

Note: Never use a screwdriver to spread the claws outward.

It will break. When removing the cover, hold down the mount and remove the cover.

It will come off if you pull it straight.

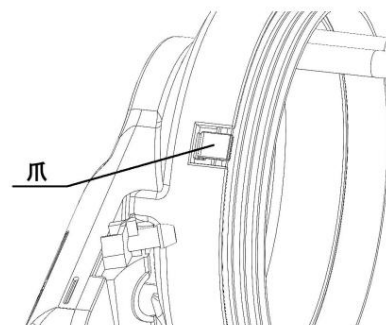

7. Connect the connector at the end of the harness to the spiral cable.

Please connect to the blue.

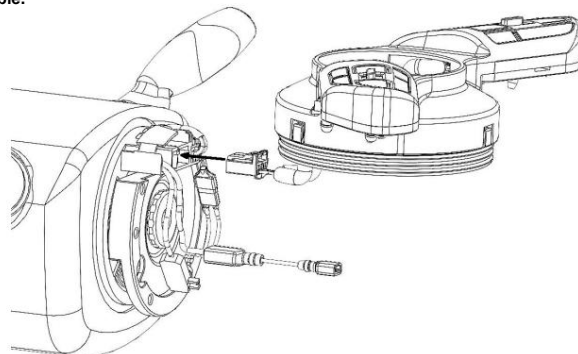

8. Remaining as shown in the diagram above, remove the upper in step 1.

-Please install it. The included bolt is an extremely low head

Please use CAP bolts. Tightening torque

is 9N•m (0.9kgf•m). center horn wiring

Please take it out through the

hole. Note: Be careful not to overtighten.

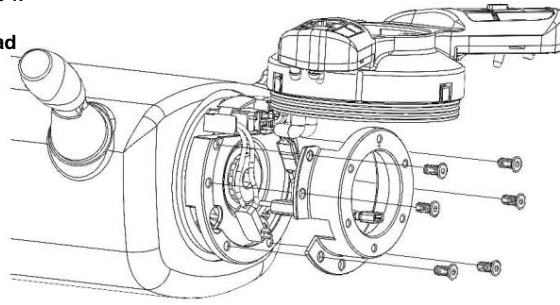

9. Place the switch mount on the upper.

Adjust the wiring so that it runs around the upper.

Please arrange

it. Note: Be careful not to pinch the wires!

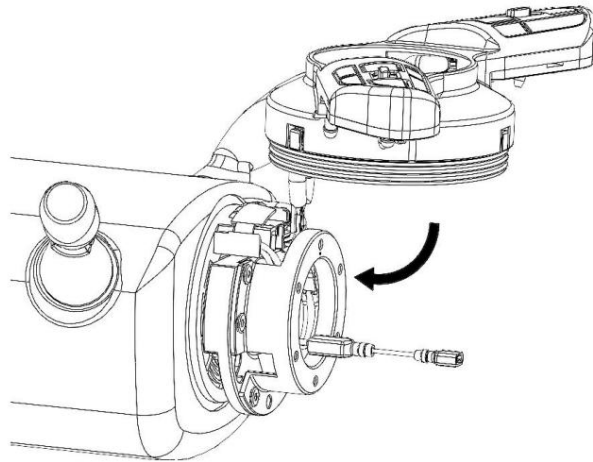

10. Complete. Rafx by adjusting the slope with the boss

Please install the series. The lower cover is here

If it hits the cover, cut the bottom part.

Please cut and adjust. Note:

Please be careful to avoid injury.

Completely equipped with rafx, steering wheel and horn button.

Check that the horn sounds, start the engine, and

Check that there is no problem with steering operation before working.

It's over.

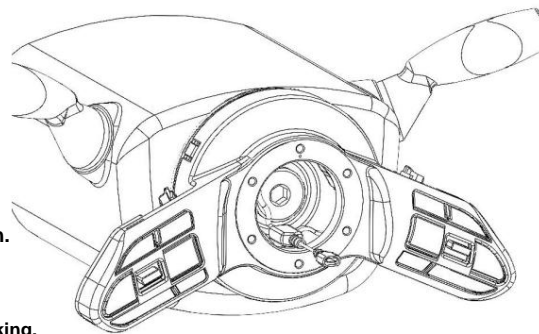

#### D. Precautions

•After installation is complete, operate the steering wheel and check if there are any abnormalities. Correct wiring etc.

If this is not done and the spiral cable on the vehicle side is pushed by wiring, the steering operation becomes difficult.

You may. Also, if you continue to drive in this condition, there is a risk of damage to vehicle parts. Note

Please be considerate.

•Before operating the vehicle, be sure to confirm that the switch mount and switch are secured. luck

If the switch falls off while rolling, you will not be able to operate the steering wheel, which is very dangerous.

- Do not press the blank panel on vehicles using blank panels. Back plate claw, mount

A part of the cover may come off or break.

- Please do not modify or use this product. • Please carefully

store the removed genuine steering wheel and parts. For some reason,

You will need it when returning to the original state. Our company cannot be held responsible for this.

- Our products are carefully inspected and shipped after confirming that there are no defects, but in the unlikely event that the quality

If you have any problems, please contact us. At this time, please send the product to us once.

There may be cases. The genuine parts listed above are required, and if you do not do the work yourself, the labor fee will be extra.

However, we cannot guarantee genuine parts, labor costs, etc.

Thank you for your understanding.

Manufacturer: Works Bell Co., Ltd.

8507 Tamagawa, Chino City, Nagano Prefecture 391-0011

Contact: Works Bell Customer Center

TEL: 0266-70-1477

E- [mailysupport@worksbell.co.jp](mailto:mailysupport@worksbell.co.jp)