

Steering switch relocation stay Toyota A1 type

Thank you very much for purchasing our product.

Please read this manual carefully before use.

Contents of this manual

A. Purpose of use/Overview

The purpose of use and overview of the product are described. Please be sure to read this information if you are using the vehicle in which it is installed.

B. Contents

All products, accessories, and contents are listed. Please be sure to read this before installation work.

C. About installation

This section describes the installation of the product. Please be sure to read this manual if you are performing installation work.

D. Precautions

This section contains notes regarding the contents of the product and instruction manual. The user of the vehicle in which it is installed, Please be sure to read this.

A. Purpose of use/Overview

- Replace Toyota's genuine steering switch with sports type steering wheel and steering wheel.

This is a product to be relocated to the boss. Please do not use it for any other purpose.

- This product is used in conjunction with Works Bell Steering Boss 550. As a single item, the steering wheel
Eel cannot be attached to the vehicle.

- It cannot be installed on vehicles equipped with steering switch shapes other than those shown
below. - Cannot be used with steering bosses manufactured by other companies.

- Assumes use of a standard sports type 3-spoke steering wheel with a diameter of 350mm or more.

It is designed with. A sports type steering wheel with a smaller diameter or 3 steering wheel

We have not verified the usage of steering wheels other than poke.

- How to remove the genuine steering switch is not described. Vehicle manufacturer or dealer
Please ask.

- For installation of the steering boss, please refer to the instruction manual that comes with the boss.

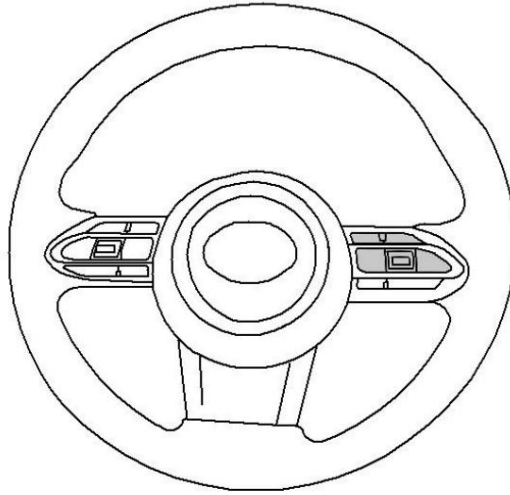

***The gray part also corresponds to blank (not used) switches.**

B.Contents

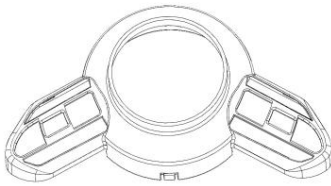

Switch mount body

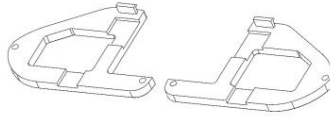

Back plate (left and right)

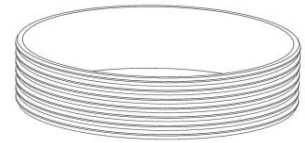

Lower cover

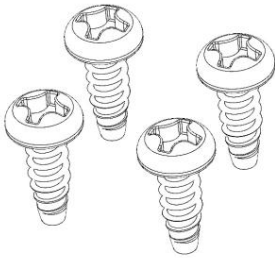

Tapping screw 3x10-4 pieces

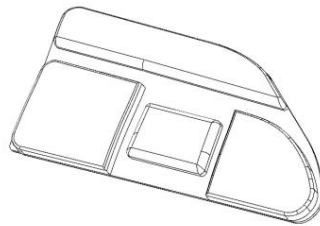

Blank panel *1

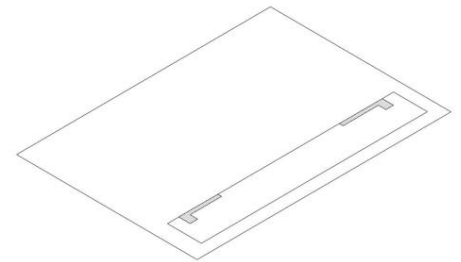

Cover cut template *2

***1: Not used on vehicles that use all buttons. *1: It is extremely thin. Please never bend it.**

***2: Packaged folded.**

C.Installation Note:

Stop with the steering wheel straight ahead, and then turn the battery on.

- Disconnect the terminal before proceeding.

1. From the installed state of Boss 550,

Steering wheel, horn button,

After removing the

- Boss cover
- Upper mounting bolt x 6
- Upper

Remove it and make it as shown in the figure on the right.

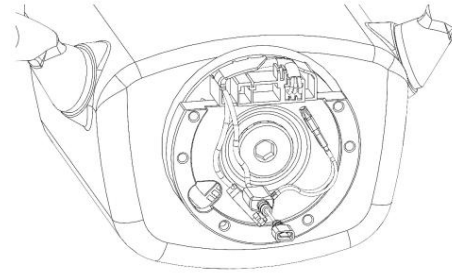
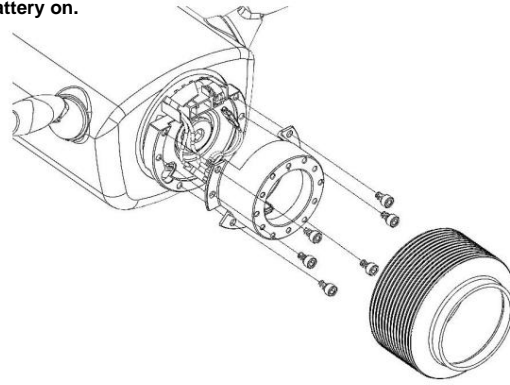

2. From the genuine steering wheel,

- Left and right switch
- Harness Assy

Please remove it. Note:

On some vehicles, the left and right connectors have the same shape.

Check the color and position of each protective tube.

Please remember.

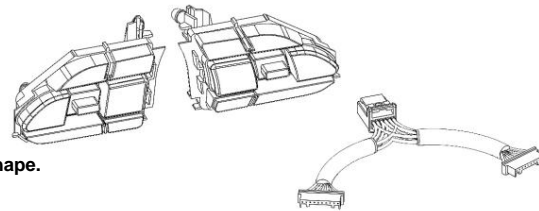

3. Remove from genuine steering wheel to switch mount

Install the switch. Comes with back plate

Secure with self-tapping screws. back

The claw of the plate fits into the square hole of the switch mount.

Please do so. Only part of the right switch is used

For vehicles that do not have a blank panel, use the switch and

Please attach it by sandwiching it between the mounts.

Note: Made of resin. Do not overtighten the screws.

Sai. It may break.

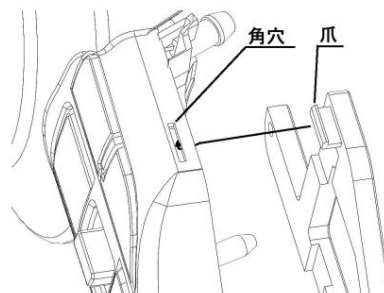
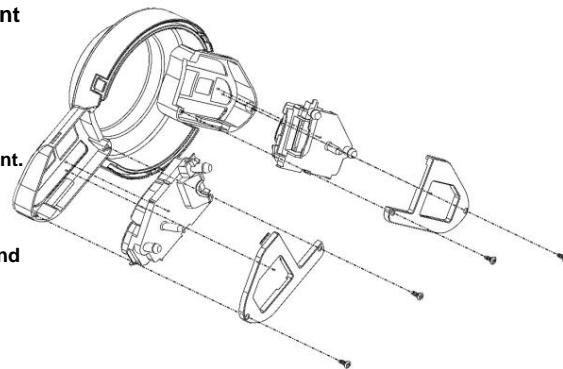

4. Insert the harness assembly connector into the switch

please do it.

Note: Please insert the left and right sides correctly.

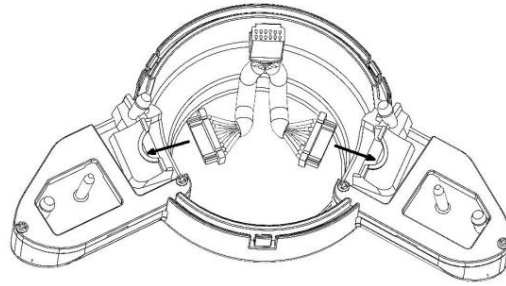

5. Cut out a square frame from the cover cut template

Please.

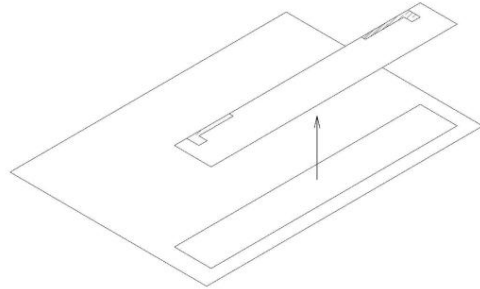

Wrap the cut out template around the lower cover and secure both ends.

Please fix it with tape etc. Lower cover in the shaded area

Cut out the two parts. Note: Please be

careful to avoid injury.

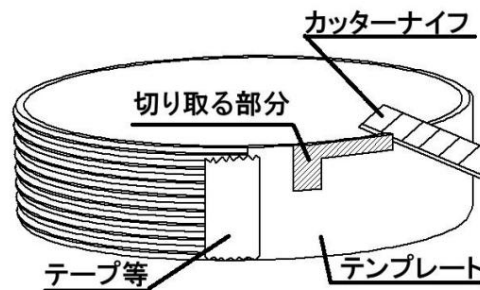

6. Align the cut part with the protrusion on the back of the switch and slide it.

Please insert it into the switch mount.

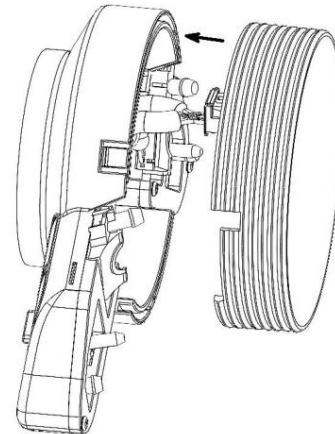

The three claws on the switch mount hold down the grooves on the lower cover.

Fixed. The convex part on the back of the switch interferes and cannot be fixed with the nails.

If not, please open the cover little by little. cover down

Shake it and if the cover does not fall off, it is fixed. Note: Never use

a screwdriver to spread the claws outward. Discount

will appear. When removing the cover, hold the mount and hold the cover straight.

It can be removed by pulling it firmly.

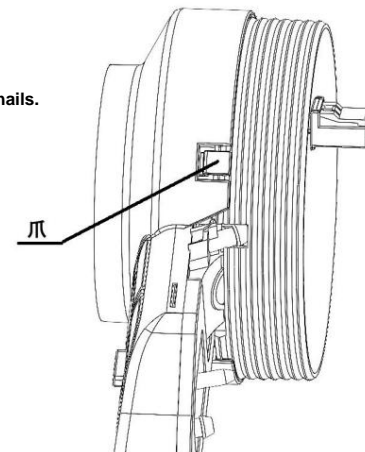

7. Connect the connector at the end of the harness to the spiral cable.

cable.

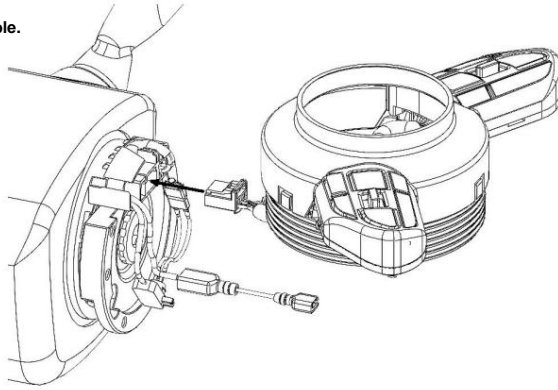

8. While still in the state shown in the diagram above, remove the assembly you removed in step 1.

Please install the bolts. tightening

Torque is 9N•m (0.9kgf•m). horn arrangement

Extend the wire to the outside through the center hole. Note: Be careful not to overtighten.

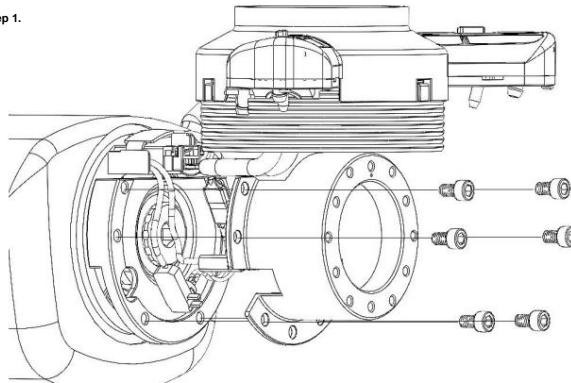

9. Place the switch mount on the upper.

Adjust the wiring to fit around the upper.

please do it.

Note: Be careful not to pinch the wires!

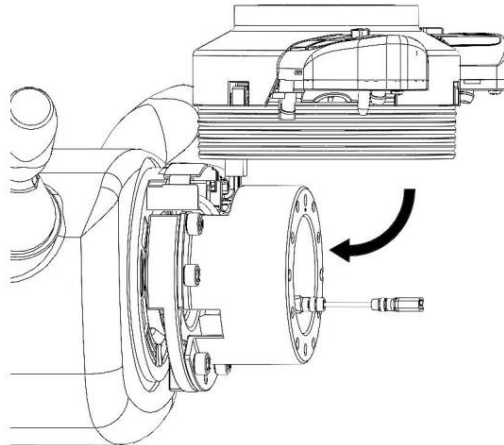

10. Complete. Adjust the inclination with the boss to ring, horn button (horn ring).

Please attach it. Lower cover is column cover

If it gets hit, cut the bottom part with a cutter etc.

Please cut and adjust.

Note: Please be careful to avoid injury.

Return the steering wheel and horn button to turn on the horn

Check for sound, start the engine and turn the steering wheel.

Check that there are no problems with the operation before finishing the work.

It's done.

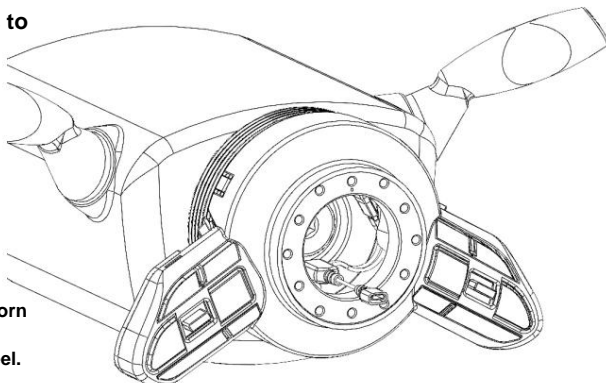

D. Precautions

•After installation is complete, operate the steering wheel and check if there are any abnormalities. Correct wiring etc.

If this is not done and the spiral cable on the vehicle side is pushed by wiring, the steering operation becomes difficult.

You may. Also, if you continue to drive in this condition, there is a risk of damage to vehicle parts. Note

Please be considerate.

•Before operating the vehicle, be sure to confirm that the switch mount and switch are secured. luck

If the switch falls off while rolling, you will not be able to operate the steering wheel, which is very dangerous.

- Do not press the blank panel on vehicles using blank panels. Back plate claw, mount

A part of the cover may come off or break.

- Please do not modify or use this product. • Please carefully

store the removed genuine steering wheel and parts. For some reason,

You will need it when returning to the original state. Our company cannot be held responsible for this.

- Our products are carefully inspected and shipped after confirming that there are no defects, but in the unlikely event that the quality

If you have any problems, please contact us. At this time, please send the product to us once.

There may be cases. The genuine parts listed above are required, and if you do not do the work yourself, the labor fee will be extra.

However, we cannot guarantee genuine parts, labor costs, etc.

Thank you for your understanding.

Manufacturer: Works Bell Co., Ltd.

8507 Tamagawa, Chino City, Nagano Prefecture 391-0011

Contact: Works Bell Customer Center

TEL: 0266-70-1477

E- mailysupport@worksbell.co.jp