



3 year guarantee



RIG

CE 0082

EN 12841 / C
EN 341 / A
EN 15151-1 / 6

ETC TPTC019/
2011

NFPA

Self-braking descender/belay device
Descendeur assureur auto-freinant



WARNING

Activities involving the use of this equipment are inherently dangerous. You are responsible for your own actions and decisions.



- Before using this equipment, you must:
- Read and understand all Instructions for Use.
 - Get specific training in its proper use.
 - Become acquainted with its capabilities and limitations.
 - Understand and accept the risks involved.

FAILURE TO HEED ANY OF THESE WARNINGS MAY RESULT IN SEVERE INJURY OR DEATH.

Warning symbols
Panneaux d'alertes



PETZL.COM



Latest version



Other languages



Technical tips



PPE checking

PETZL
F-38920 Crolles
PETZL.COM

ISO 9001 © Petzl



Sustaining our Community
Au service de la Communauté
FONDATION-PETZL.ORG



100%

Recycled paper

Traceability and markings / Traçabilité et marquage

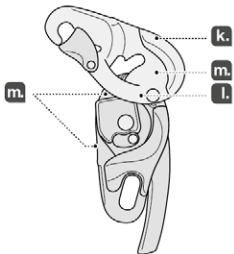
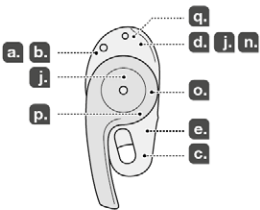

c. Traceability: **datamatrix**

d. Rope diameter and maximum working load

e. Individual number
YY M 0000000 000

f. Year of manufacture

g. Month of manufacture

h. Lot number

i. Individual Identifier

f. Standards

k. Carefully read the instructions for use

l. Model identification

m. Direction of the rope

n. Maximum descent and operating temperature

o. Handle positions

p. NFPA certification body



q. Manufacturer address

a. Body controlling the manufacture of this PPE
APAVE SUDEUROPE SAS
8 rue Jean-Jacques Vermaaza
Z.A.C. Saumaty-Seon - CS 60193
13322 Marseille CEDEX 16
N°0082

CE 0082

b. Notified body that carried out the EU type examination
TÜV SÜD Product Service GmbH
Zertifizierstellen - Ridlerstraße 65
80339 MÜNCHEN
N°0123

NFPA CERTIFICATION FOR RIG D021

MEETS THE DESCENT CONTROL AND BELAY DEVICE REQUIREMENTS OF NFPA 1983, STANDARD ON LIFE SAFETY ROPE AND EQUIPMENT FOR EMERGENCY SERVICES, 2017 EDITION.

EMERGENCY SERVICES DESCENT CONTROL AND BELAY DEVICE IN ACCORDANCE WITH NFPA 1983-2017



Descent control
Belay device
T (TECHNICAL USE)
MEETS NFPA 1983 (2017 ED.)

USE ONLY TECHNICAL USE LIFE SAFETY ROPES, (CORE + SHEATH) DIAMETER BETWEEN 10 MM AND 11,5 MM.

This descent control and belay device has passed the manner of function test and holding load tests using the following rope: [STERLING, 3/8" HTP static, P105, 10mm] and [Bluewater, 7/16" Spec-Static rope, 540700, 11,5mm]

After removing the Instructions for Use from the equipment, make a copy of it and keep the original as part of a permanent record that includes the usage and inspection history for the equipment. Keep the copy of the Instructions for Use with the equipment and refer to it before and after each use. Additional information regarding auxiliary equipment can be found in NFPA 1500, Standard on Fire Department Occupational Safety and Health Program, and NFPA 1983, Standard on Fire Service Life Safety Rope and System Components.

1. Field of application (text part)
 Champ d'application (partie texte)

2. Nomenclature
 Nomenclature

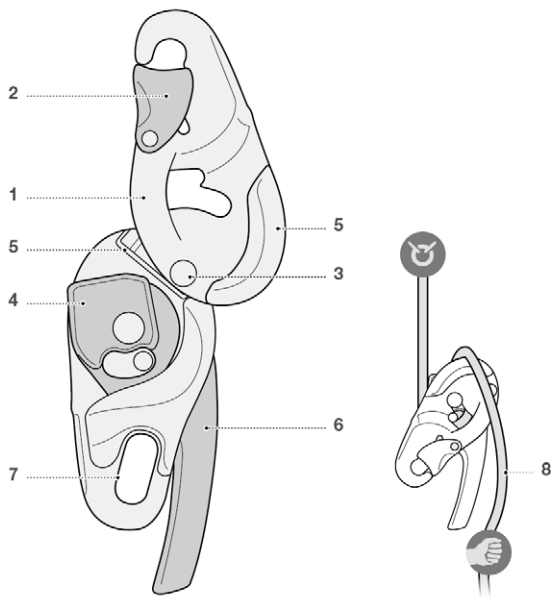

Handle positions
 Positions de la poignée

a. Stop position
 Position d'arrêt

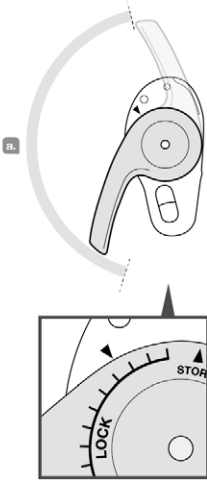

b. Descent
 Descente

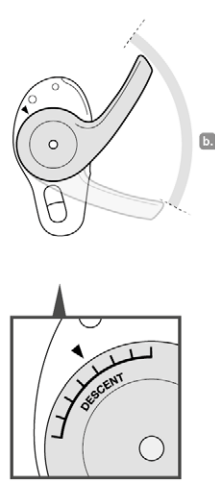

c. Storage
 Rangement

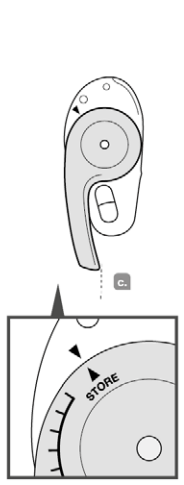

3. Inspection, points to verify
 Contrôle, points à vérifier

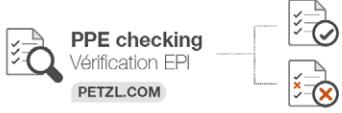

4. Compatibility
 Compatibilité



5. Function principle and test
Principe et test de fonctionnement

Descent
Descente

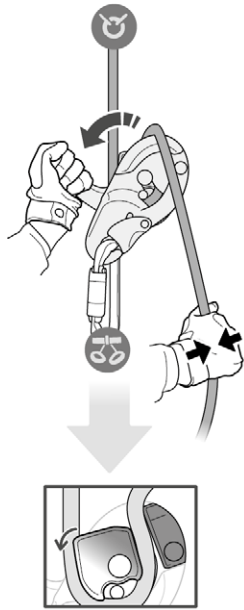

AUTO-LOCK system
Système AUTO-LOCK

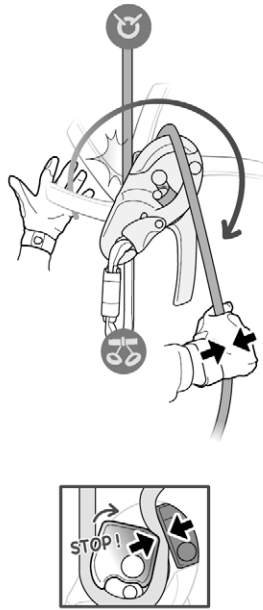

Locking
Blocage

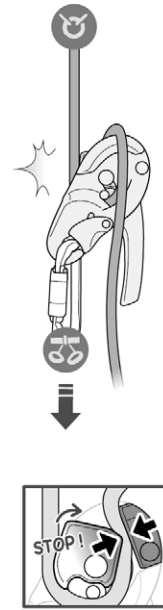

6. Installation
Installation

Device on the harness
Appareil au harnais

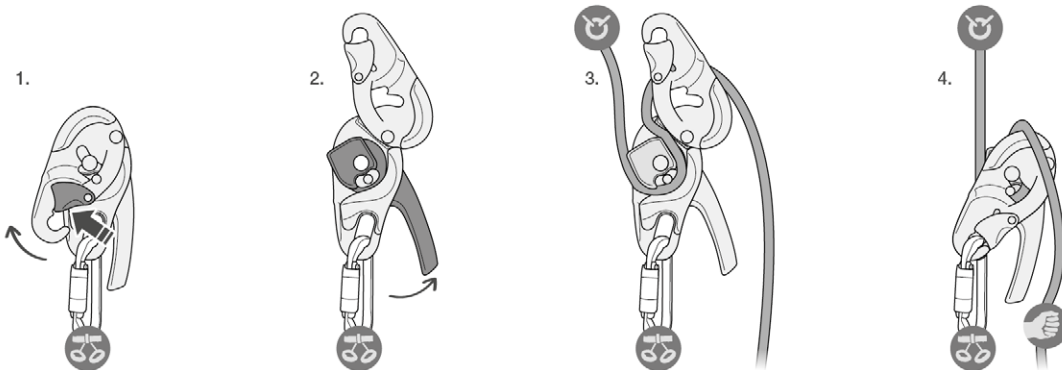

Device on an anchor
Appareil à l'ancrage

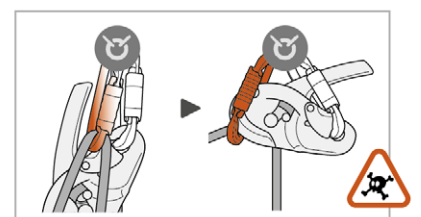
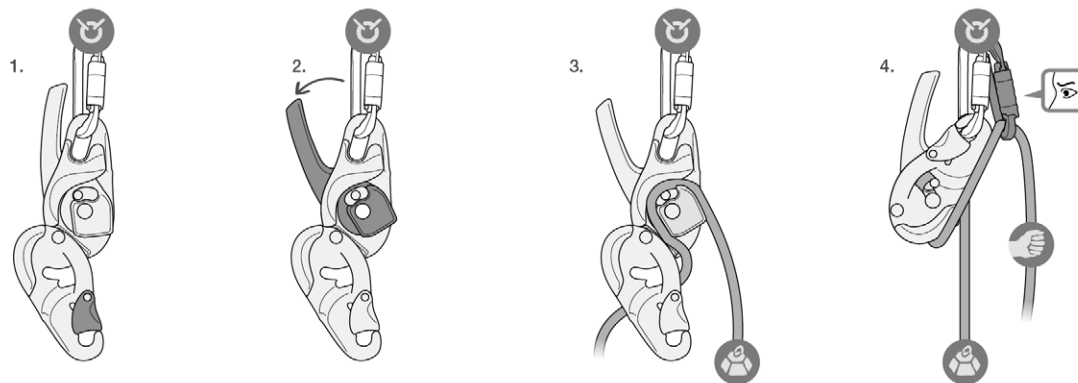

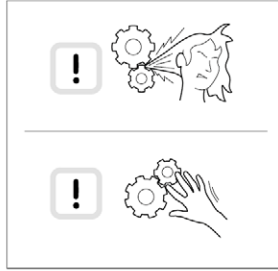
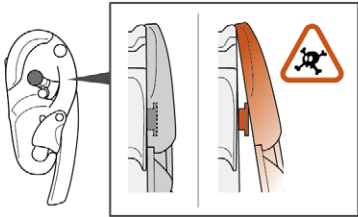
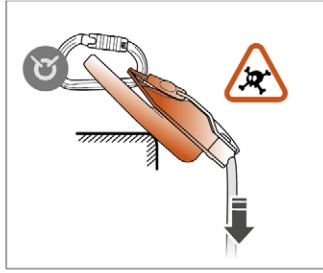
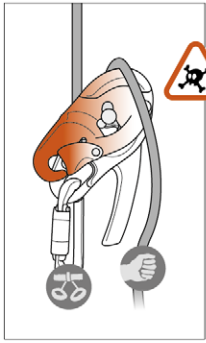

7. EN 12841 type C - Rope access
EN 12841 type C - Accès sur corde



2 m/s max.

10 $\leq \varnothing \leq 11,5 \text{ mm}$
EN1891 A



150 kg max.



200 kg max. RESCUE

8. EN 341 class A - Rescue descender
EN 341 class A - Descendeur pour secours



2 m/s max.

Maximum descent energy 7,5 MJ
Energie de descente maximum 7,5 MJ

Rope Corde	Working load limit (EN341) Charge d'utilisation maxi (EN341)	Maximum descent Descente maximum
---------------	---	-------------------------------------

Petzl PARALLEL 10,5 mm 120 kg 200 m

Petzl AXIS 11 mm 120 kg 200 m

Rope specifications
Performances des cordes testées



Petzl PARALLEL 10,5 mm

Petzl AXIS 11 mm

	Petzl PARALLEL 10,5 mm	Petzl AXIS 11 mm
1. Sheath slippage (%) Glissement de la gaine (%)	1	1,3
2. Elongation (%) Allongement (%)	3,4	3
3. Mass of the sheath (%) Masse de la gaine extérieure (%)	45	41
4. Mass of the core material (%) Masse du matériau de l'âme (%)	55	59
5. Mass per unit length (g/m) Masse par unité de longueur (g/m)	75	82
6. Shrinkage (%) Rétractation (%)	2	2

9. EN 15151-1 Type 6 Belay-rappel device
EN 15151-1 Type 6 Assureur descendeur



9 $\leq \varnothing \leq 11 \text{ mm}$
EN1891 A / B
EN892

10. Usage on a harness
Utilisation au hamais

10a. Descending
Descente

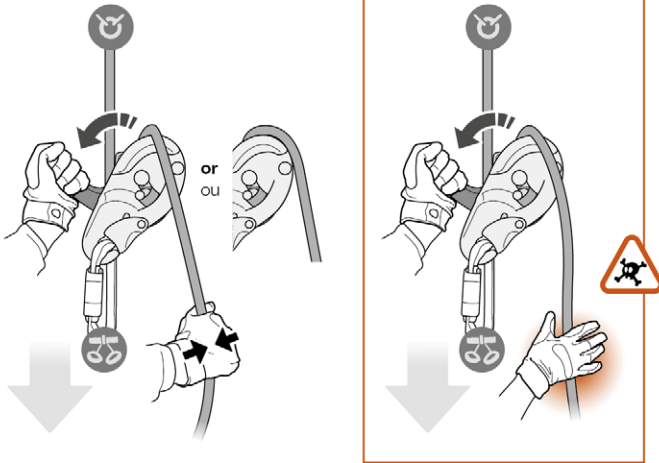

10b. Extra friction
Ajout de freinage

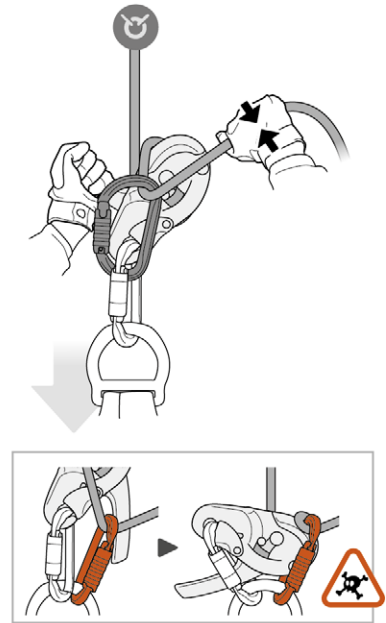

10c. Stop position
Position d'arrêt



10d. Occasional ascent
Remontée occasionnelle

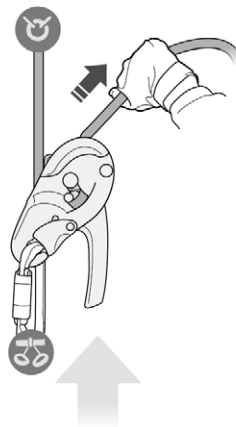

10e. Always hold the brake-side rope when the climber is moving.
Tenez toujours la corde côté freinage lors des déplacements du grimpeur

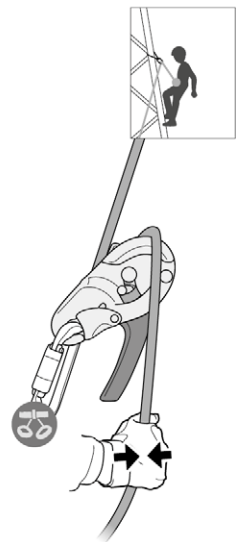

10f. Giving slack
Donner du mou

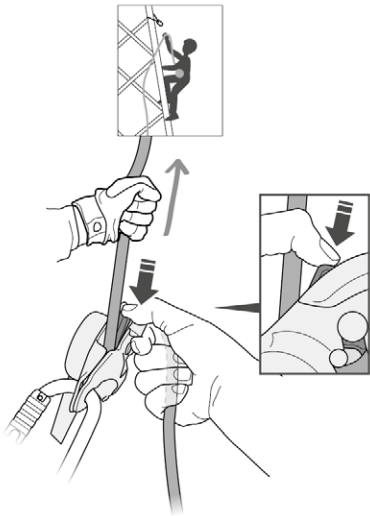

10g. Lowering
Faire descendre

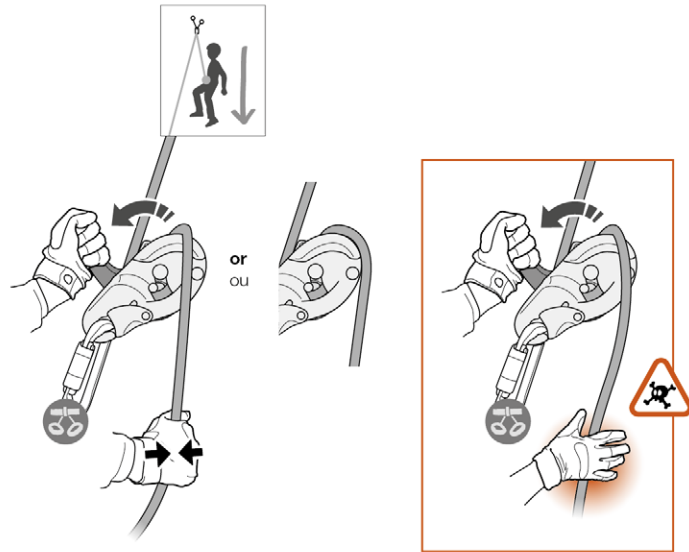

11. Usage on an anchor
Utilisation à l'ancrage

11a. Lowering
Faire descendre

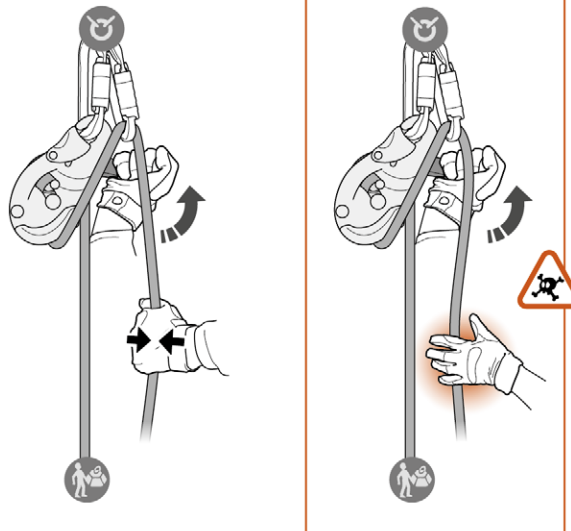

11b. Giving slack
Donner du mou

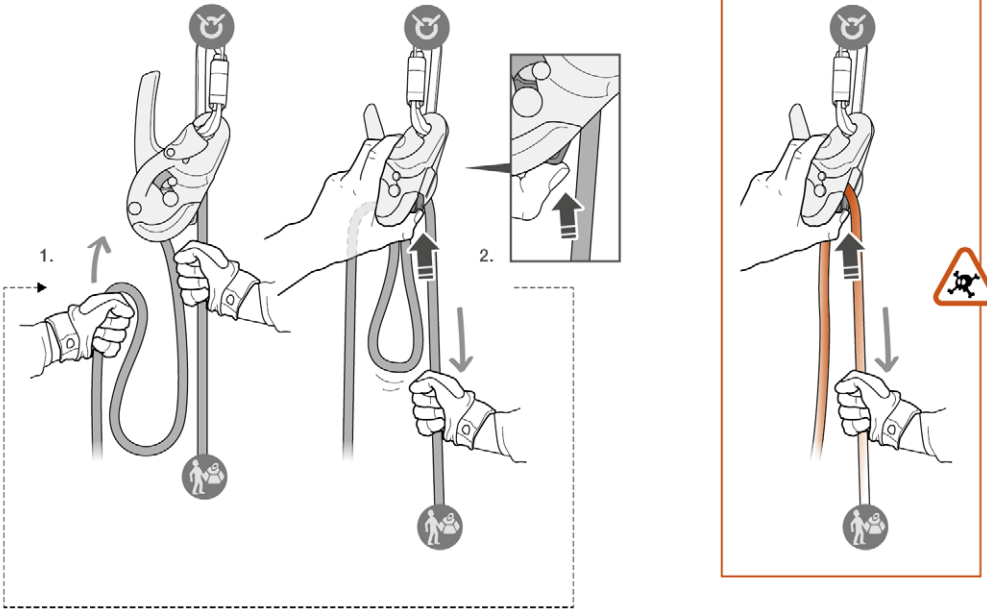

11c. Stop position
Position d'arrêt



12. Additional information
Informations complémentaires

A. Lifetime / Durée de vie

unlimited
illimitée

B. Acceptable T° / T° tolérées

- 80°C / + 176°F
- 40°C / - 40°F

C. Precautions for use / Précautions d'usage



D. Cleaning / Nettoyage

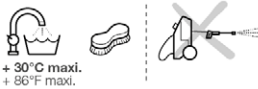

E. Drying / Séchage



F. Storage - Transport / Stockage - transport



G. Maintenance



H. Modifications - Repairs
Modifications - Réparations



I. FAQ - Contact
Questions - Contact



