

Bowaters

MODELS

specialising in distinctive 16mm models

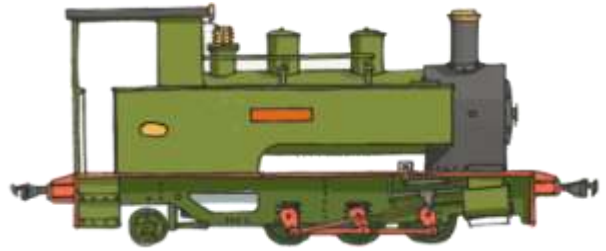

Bowaters Models – BMF Series Instructions Ffestiniog Railway Coach 122 Body Shell



Requires

- Nothing

Required Tools

- Fine Sandpaper/Emery paper or boards
- Small Files
- PVA Glue
- Super Glue
- Sharp Craft Knife

Prototype Information

Coach 122 came about as a result of the Ffestiniog Railway looking for a fleet of coaches to allow operation across the entire FR&WHR network once connected. Coach 122 was built as a prototype for this and run mostly on the FR for testing. This design was ultimately not used as the Superbarn coaches eventually filled this role. As a one off, it has always been a odd ball but now lives on the Welsh Highland Railway being considered a contemporary of Coach 2060.

About the Kit

The kit is a wooden kit comprising of a set of laser cut wooden parts and 3D printed sections.

Chassis Fitting

This kit is designed for the Bowaters Models FR Coach Bogies. This is assembled as per the instructions.

Couplings

This kit is designed to make use of Accucraft Z1 Chopper Couplings which are to be mounted in the prototypical location.

Instruction notes

With these instructions, there are images which show various stages of the construction of one of the kits. They are of the Digital Test Build which may not be representative of the kit you have brought. They are for reference purposes only.

Painting

For painting, it is recommended you refer to prototype images to ensure the models are in the condition that you model.

Please Turn over

Please read though these instructions before beginning to assemble your
kit.

Note – These instructions only cover the Body Shell assembly. For the interior, please refer to other FR Corridor Coach instructions as they all share the same core construction.

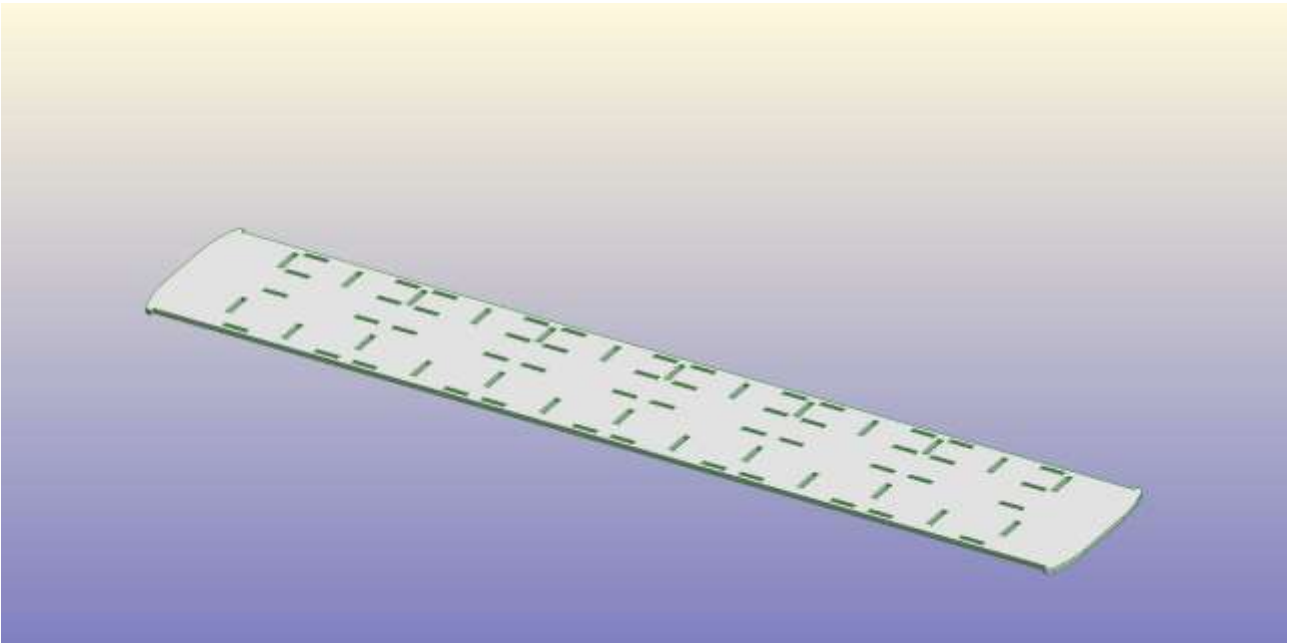

Start by assembling the interior the same as other FR Coaches. We recommend using the Barn instructions for this.

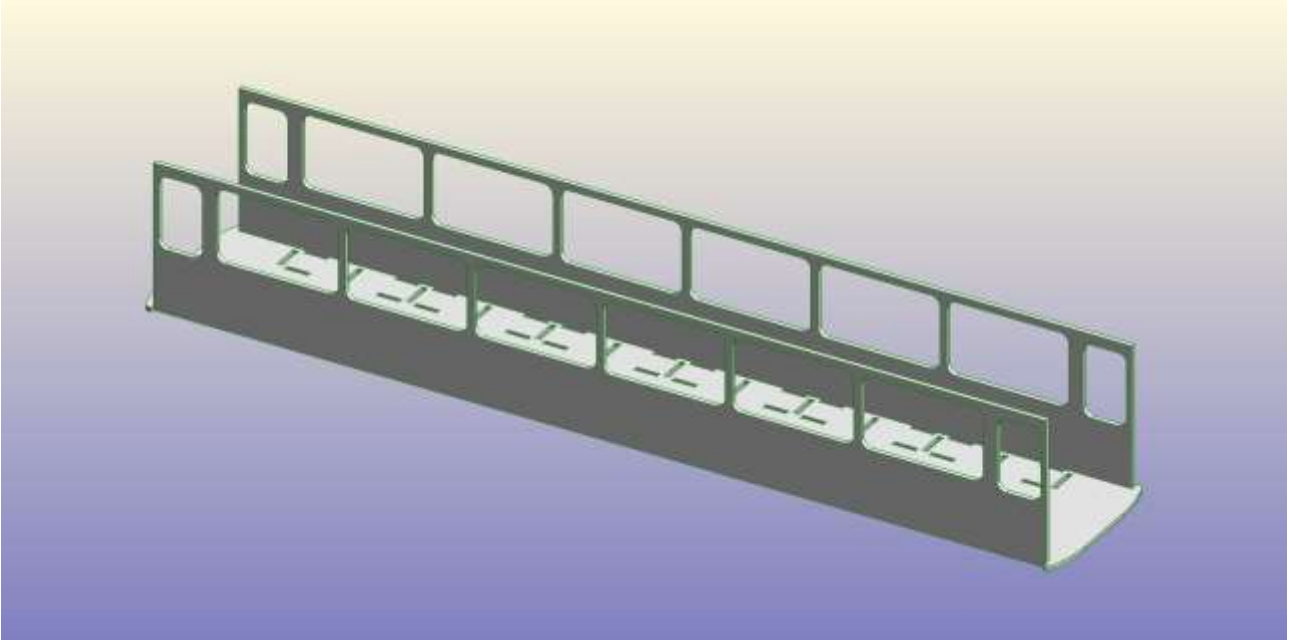

The glue the inner sides to the floor unit.

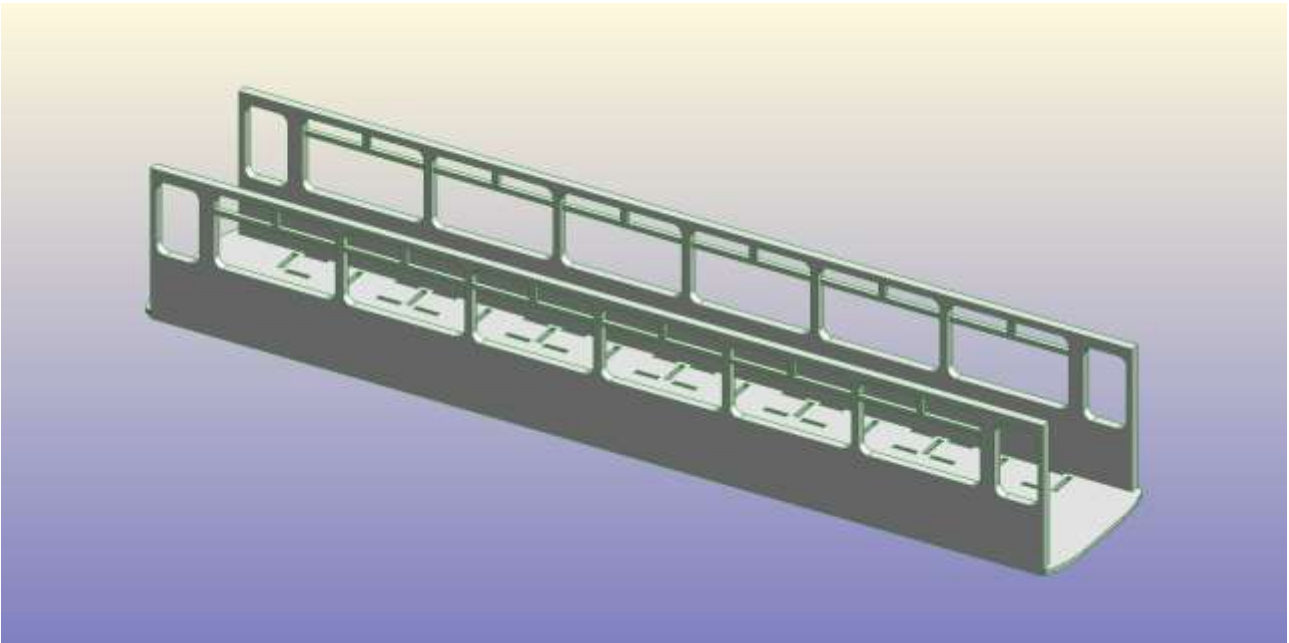

Next, glue into place the outer walls making sure they fit into the slots in the floor.

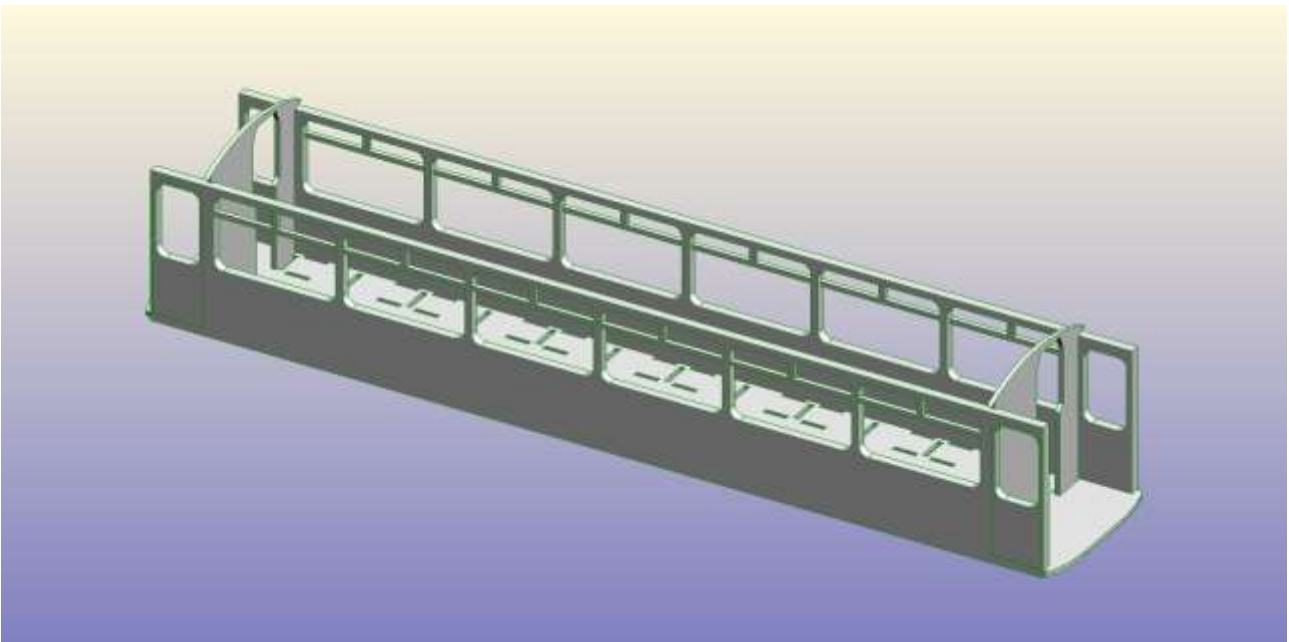

Now, glue into place the internal partitions in the end of the coach onto the back of the seating areas.

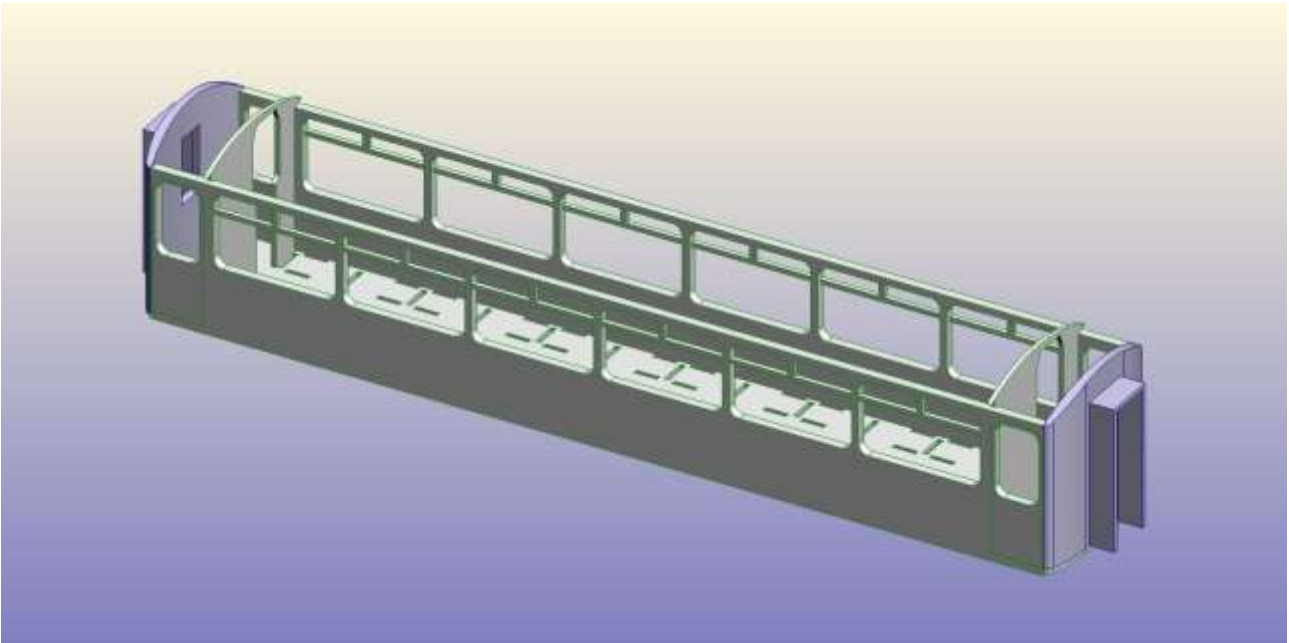

Now, glue into place the curved end panels onto the floor.

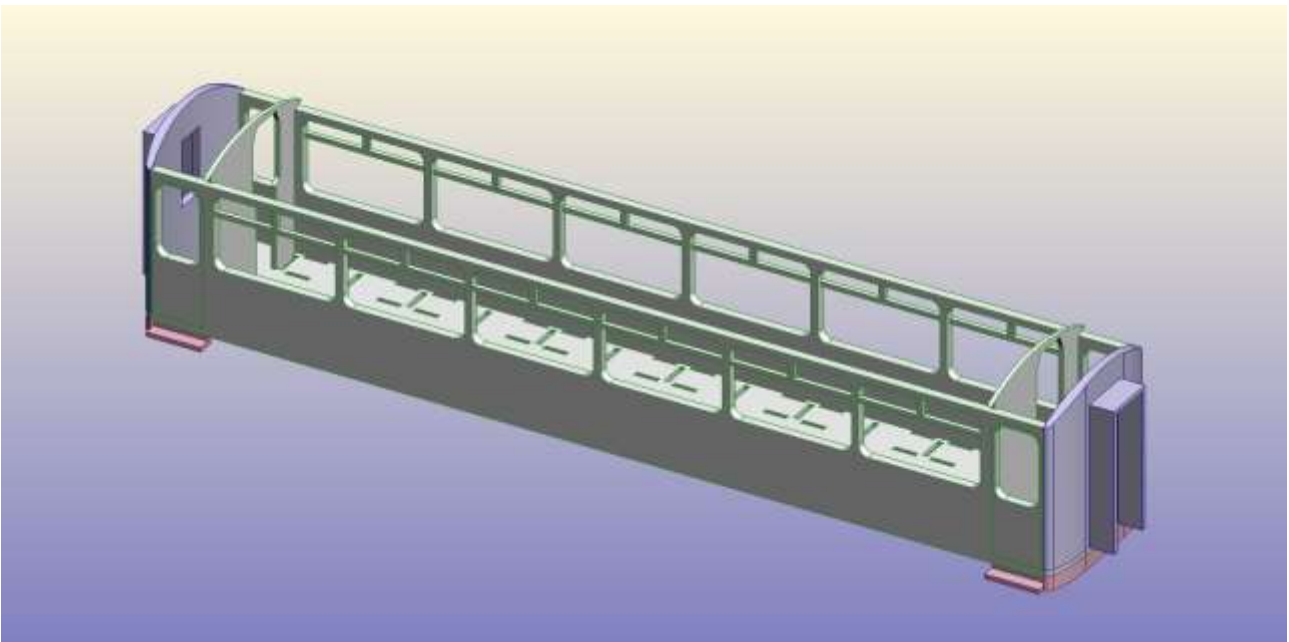

Next step is to glue into place the roof and the buffer beams. You can do these in either order. The buffer beams are glued underneath the ends of the coaches. The roof strips are glued across the top of the model. You will also have roof supports to place. These are placed as per your requirements but we recommend in line with the window pillars.

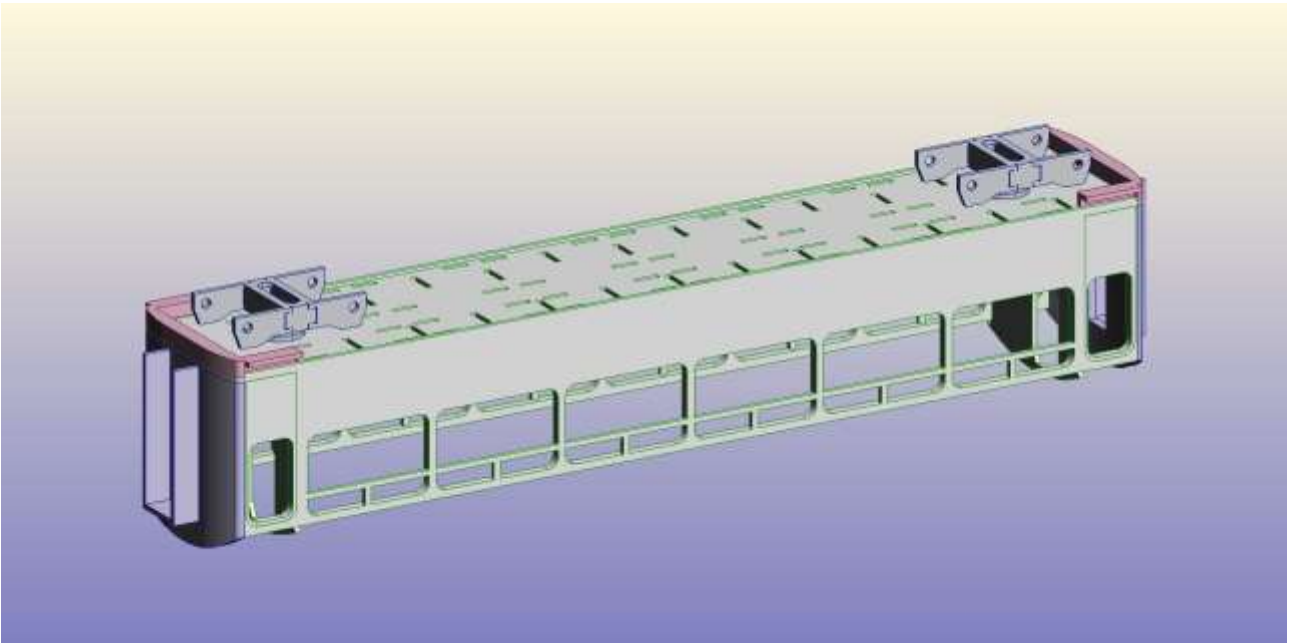

To start to complete the model, glue into place the bogies into their correct positions. These can be moved as needed to suit your garden railway.

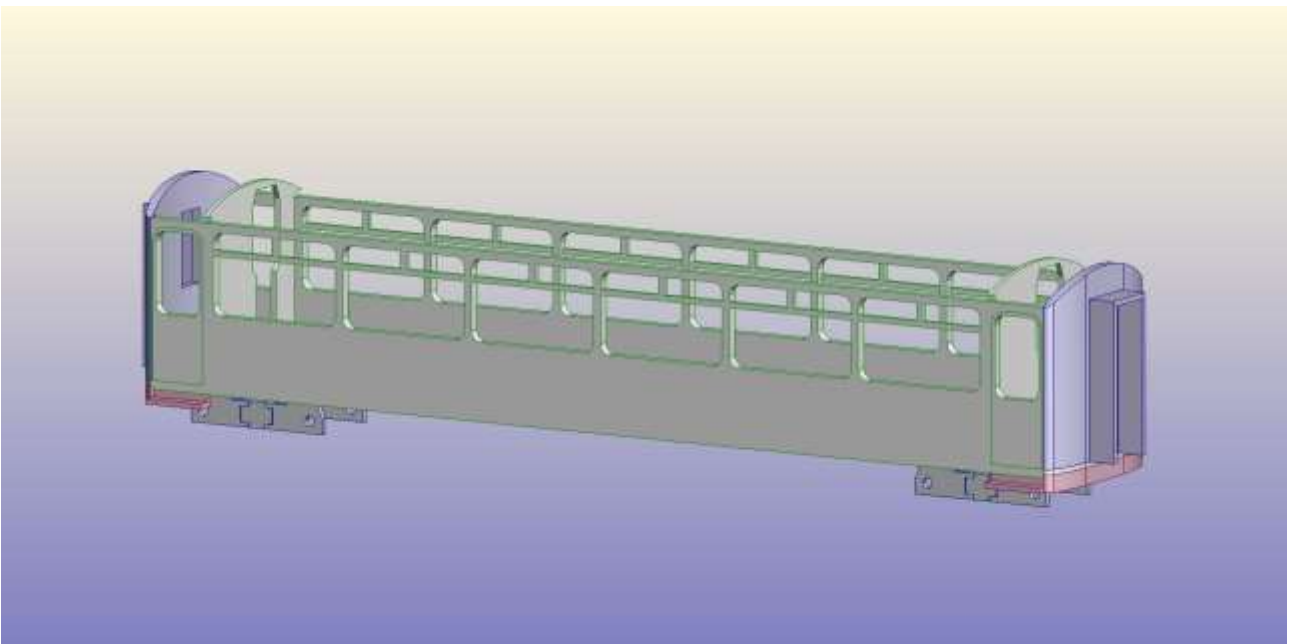

Your model is now complete.



We hope you enjoy your Bowaters Models kit! If you have any questions, don't hesitate to contact us on info@bowatersmodels.co.uk

We thank you for your custom.