



## **XP Turbo/S Air to Air Intercooler Kit**

**SKU(s): 100FP0190**

### **INCLUDED PARTS**

(1) XP Turbo/S Air to Air Intercooler
(1) Charge Tube Kit, Black
(1) Intercooler Install Kit
(optional) BOV

### **REQUIRED TOOLS**

Screw Driver
Metric Sockets
Clamps
Torx Sockets
Flashlight



**Step 1:** Make sure the vehicle is cold. You can either remove the rear fascia, exhaust and heat shields or remove the bed. For these instructions we removed the bed for photos. Both options work well.

**Step 2:** Locate the plenum. Spray the plenum boots with brake cleaner. Remove the charge tube, unplug both map sensors, unplug the coils, remove the fuel line.



Figure 1

**Step 3:** You may need to remove the plenum from the vehicle to remove the intercooler. Sometimes you can sneak the intercooler around the frame, but you may ruin the intercooler fins in the process. For these instructions we removed the plenum.

**Step 4:** Pinch both coolant lines off, going to the intercooler. Remove the hoses from the intercooler. Plug the intercooler for less mess.



Figure 2



Figure 3

**Step 5:** Remove the 13mm bolt on bottom of the plenum/transmission mount.



Figure 4

**Step 6:** Remove the intake plenum V-band clamps on the runners, remove the plenum from vehicle.

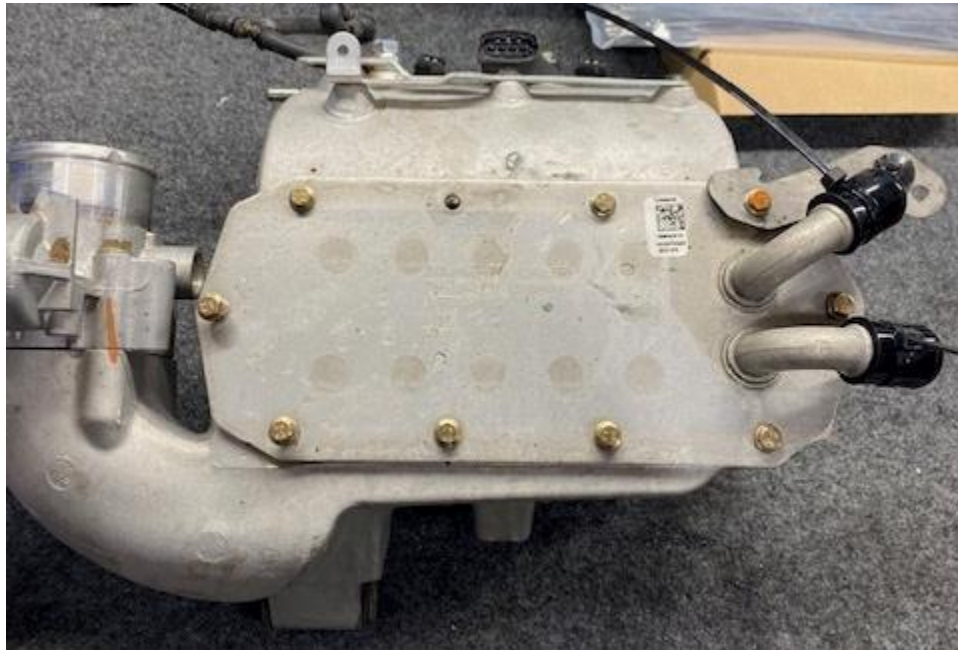

Figure 5

**Step 7:** With a 8mm socket, remove (10) screws holding the intercooler into the plenum. Remove the plenum and look for oil/coolant in the bottom of your plenum. Clean any debris that is found in the plenum, the OEM intercoolers are prone to leaking.



Figure 6

**Step 8:** Install the supplied intercooler block off plate, re-use OEM hardware and bracket.

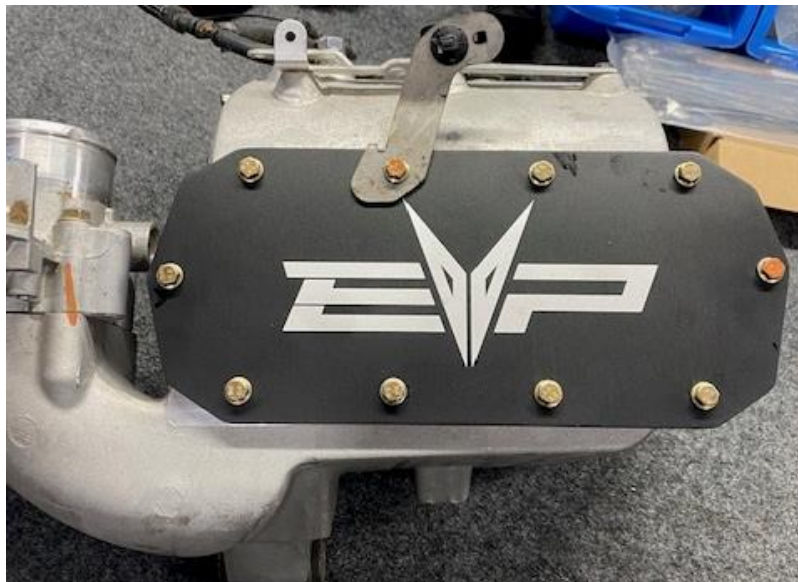

Figure 7

**Step 9:** Reinstall the plenum into the vehicle. Reconnect everything except the charge tube.



Figure 8

**Step 10:** This step is totally up to the customer. You can install the supplied 5/8" 90-degree hose barb and tie the coolant hoses together, if you think you may go back to the OEM intercooler at some point. Or you can remove all the soft/hard lines going up to the radiator and remove the radiator.

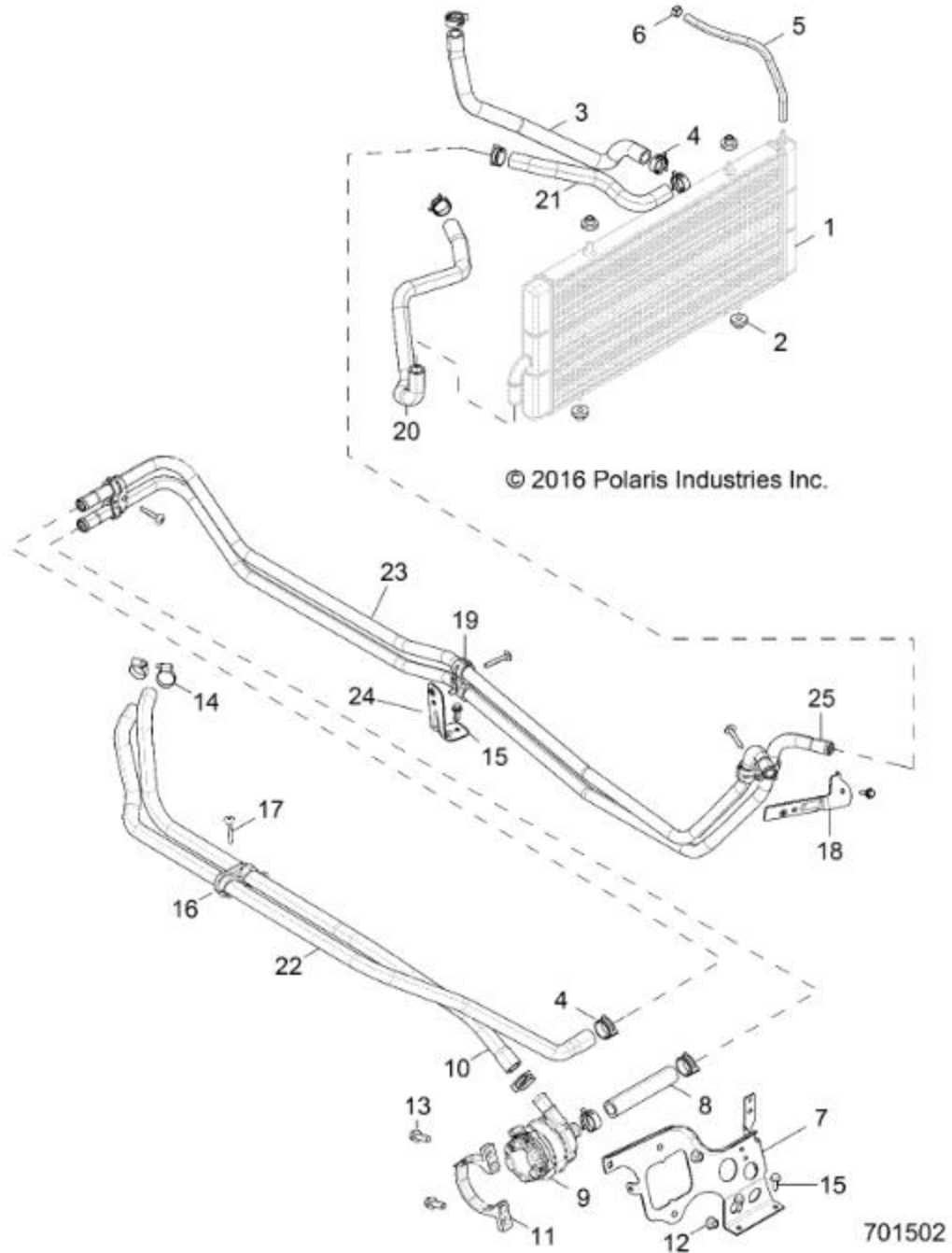

Figure 9

**Step 11:** With the bed/body reinstalled, install the turbocharger to intercooler charge tube.

**NOTE:** You may need to loosen the coil pack and turn it so the charge tube fits correctly.



Figure 10

**Step 12:** Move your map sensor over to the new charge tube. Aluminum plate is provided. Install the intercooler to throttle body charge tube.



Figure 11



**Step 13:** Remove (4) cage bolts and nuts. Install the intercooler onto the cage and re-torque all (4) bolts.

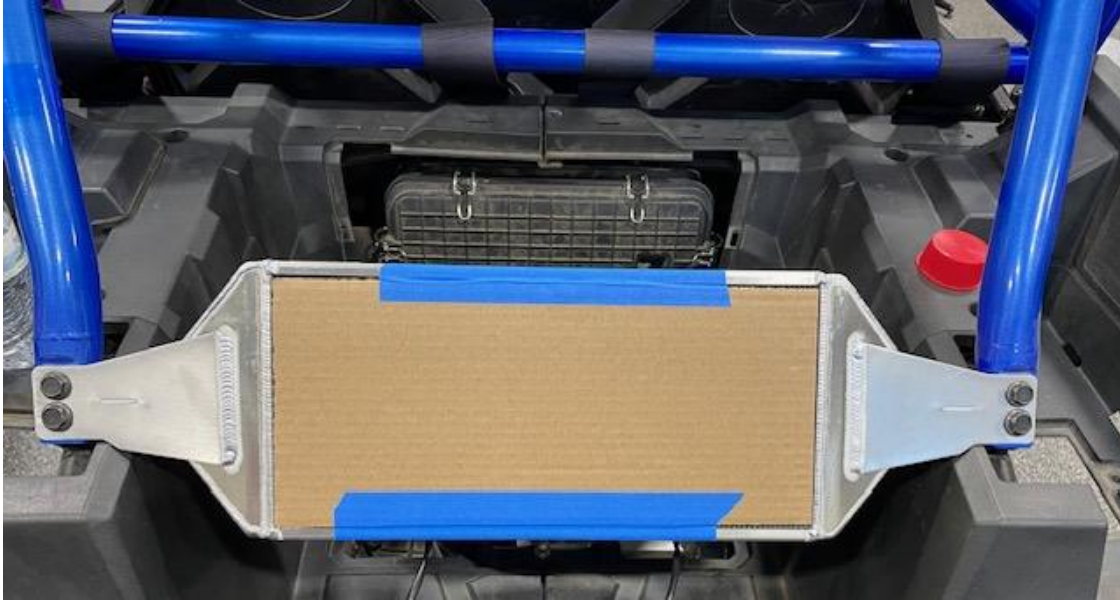

Figure 12

**Step 14:** Install the charge tubes to the intercooler. Use supplied T-bolt clamps.



Figure 13

**Step 15:** Install a blow off valve or plug into the throttle body charge tube. Run the vacuum line up to the plenum hose barb.



Figure 14

**Step 16:** Intercooler wire harness below.

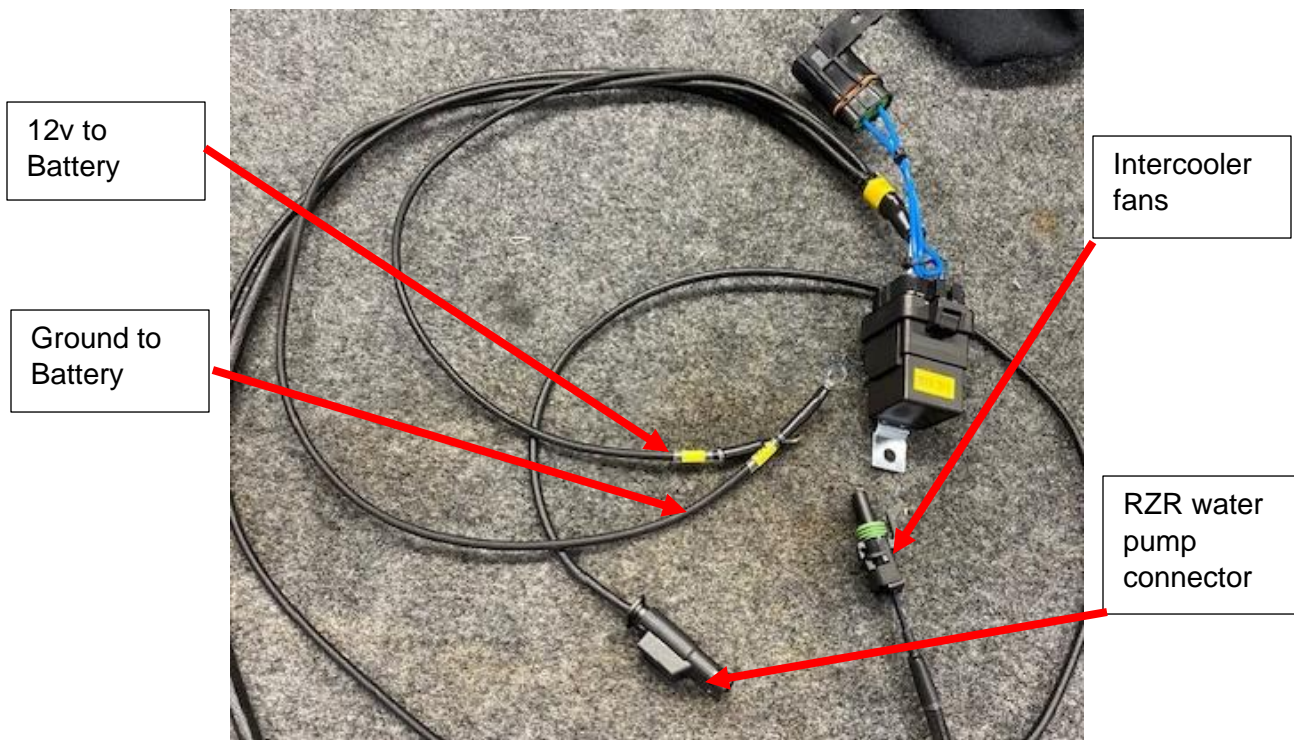

Figure 15

**Step 17:** Underneath the driver seat (rear passenger if 4 seater), mount the relay harness to the frame. Connect both positive and negative to the battery. Route the intercooler fan and water pump connector through the firewall.



Figure 16

**Step 18:** Remove the water pump connector from the OEM harness and plug in the intercooler harness.



Figure 17

**Step 19:** Key the vehicle on and make sure your intercooler fans turn on. Make sure the fans are pulling air through the intercooler, NOT pushing.





## INSTALLATION INSTRUCTIONS

Thank you for choosing Evolution Powersports products. If you require further assistance, please call our Tech Support @ (715) 247-3862

**Note:** This product is exempt from the emission standards and related requirements of 40 C.F.R. § 1051 as provided by 40 C.F.R. § 1051.620, and California law [e.g., vehicle code §§ 27156 and 38391]. This product is sold only for use in connection with EPA certified, purpose-built, nonroad vehicles used solely for closed course, nonroad competition/racing and not used for any recreational purpose or on public highways or right of ways maintained by and open to the public. This product is sold only in connection with machines that do not fall under state and/or federal noise or emission standards/regulations. Purchasers who/that purchase this product represent and warrant that the product is purchased only in connection with EPA -certified, emission-regulations-exempt and noise-regulations-exempt competition/racing vehicles as interpreted under applicable state and/or federal law. Questions: Call Evolution Powersports at (715) 247-3862.

WE'D LOVE TO HEAR FROM YOU - LEAVE A REVIEW & STAY CONNECTED!   