

Q109A-CK1/2 Conversion Kit

April 2022

The Q109A-CK1 Conversion Kit converts (1) Q109 to (1) Q109A.

The kit includes a Q109A panel that is already half populated, Q109A PCB, knobs, and all LED's installed.

Simply move the components from (1) Q109 over to the unpopulated section of the Q109A, connect the PCB, and start patching.

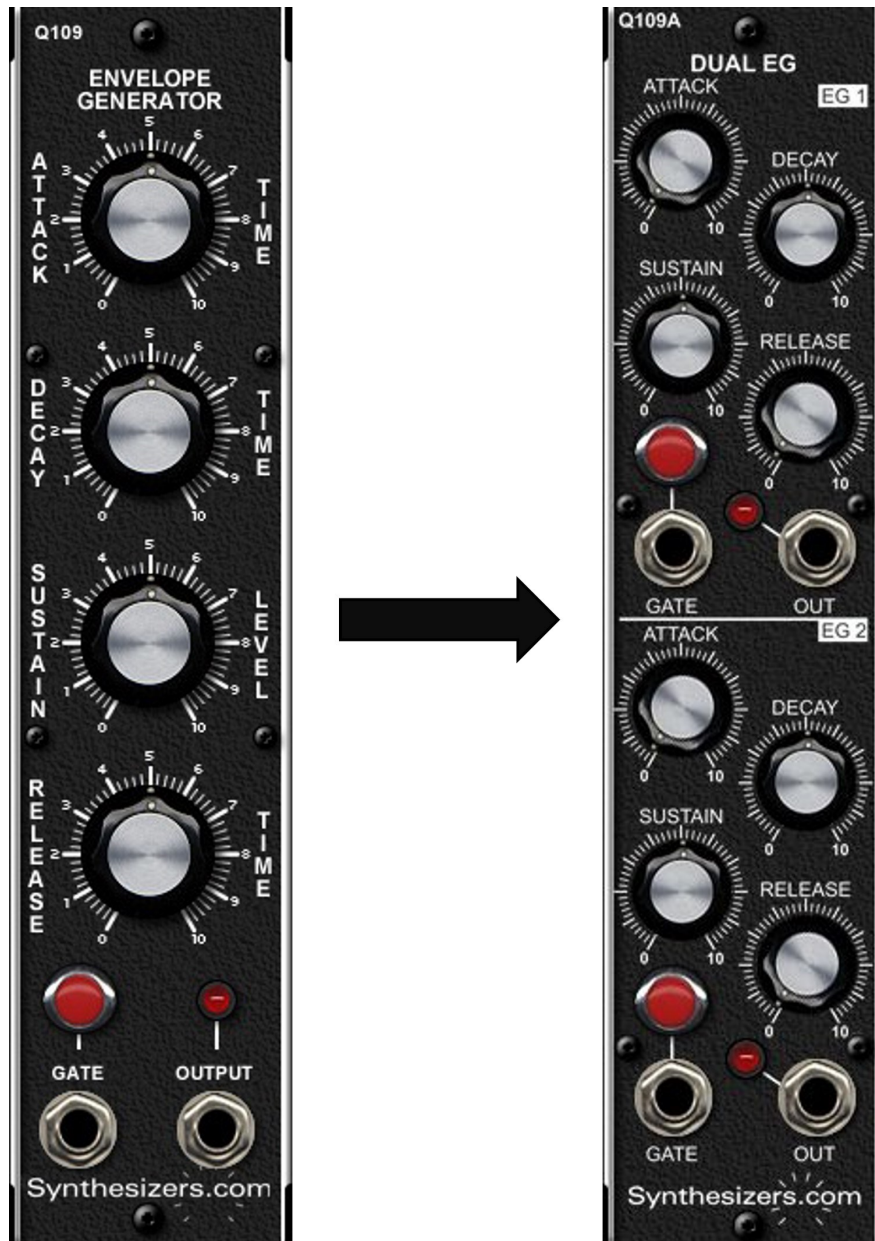

Q109A-CK1/2 Conversion Kit

April 2022

The Q109A-CK2 Conversion Kit converts (2) Q109 to (1) Q109A.

The kit includes a Q109A panel with all LED's installed, new knobs, and the Q109A pcb.

Simply move the components from your (2) Q109 over to the Q109A panel, connect the PCB, and start patching.



Q109A-CK1/2 Conversion Kit

April 2022

Start with your existing Q109 modules.
(1 for Q109A-CK1 or 2 for Q109A-CK2)

Tools required

- Small flat head screw driver
- Phillips head screw driver
- Pliers

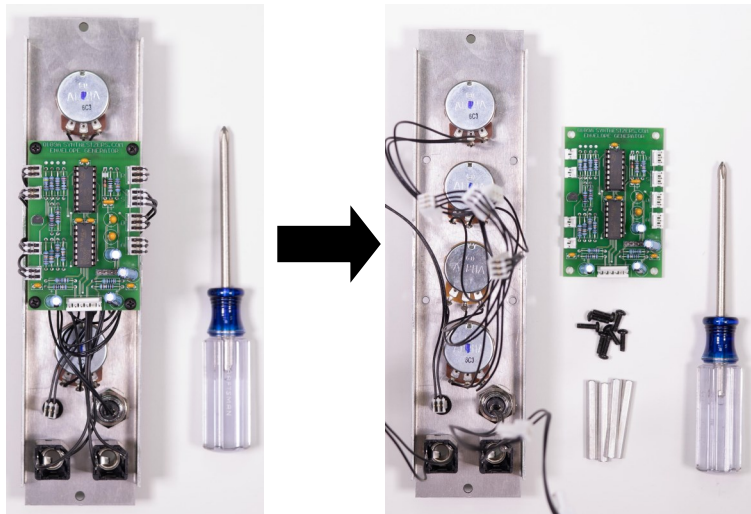

Use the phillips head screw driver to remove the PCB and spacers.

Do NOT discard.

Use the flat head screw driver to remove the knobs

Do NOT discard.



Q109A-CK1/2 Conversion Kit

April 2022

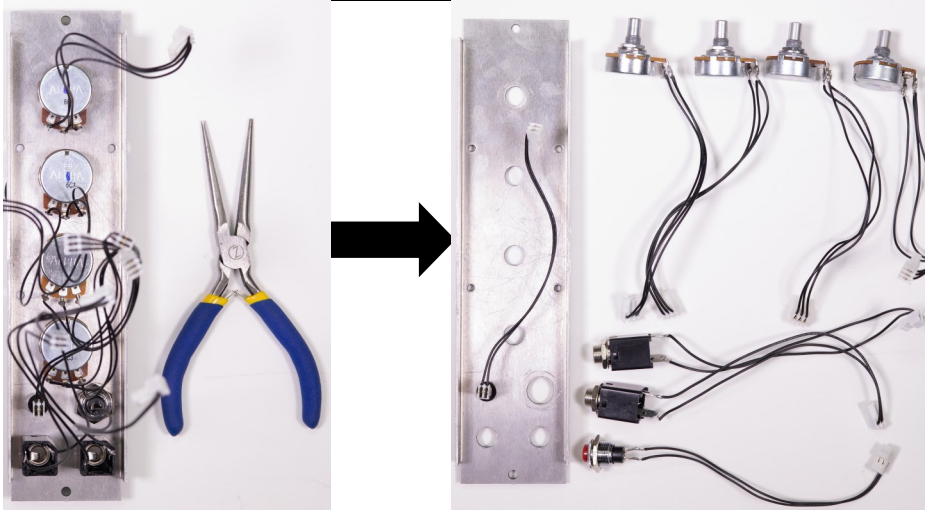

Note the pot locations. Attack, Decay, and Release pots have dots on the back

Use the pliers to remove the Pots, Jacks, and Switch.

Do NOT discard.

Note the pot locations. Attack, Decay, and Release have dots on the back.

Use the pliers to install the Pots, Jacks, and Switch.

Make sure Pots do not short to one another or the panel.

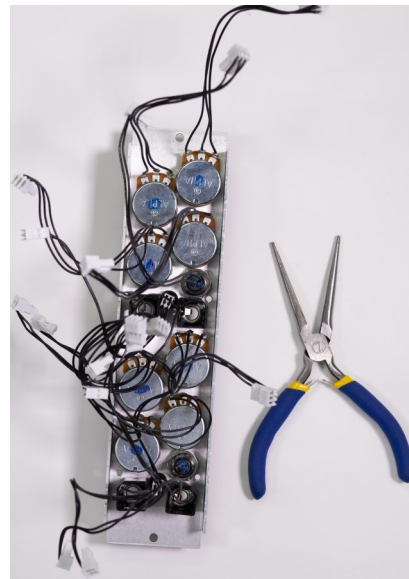

Use the Flat head screw driver to install the knobs.

Loosen and adjust the pots if needed to center knobs.

Q109A-CK1/2 Conversion Kit

April 2022

Troubleshooting

- Check LED Orientation
- Check Pot locations. Attack, Decay, and Release pots have marks on the back.
- Check for shorts between pots.

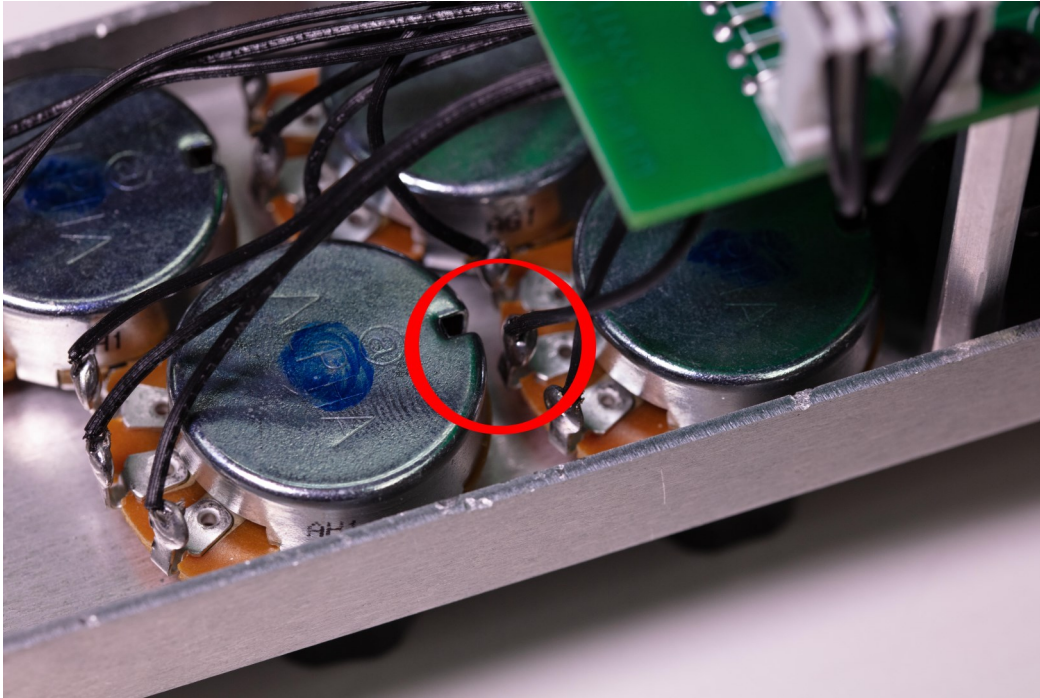

Patcher Jack

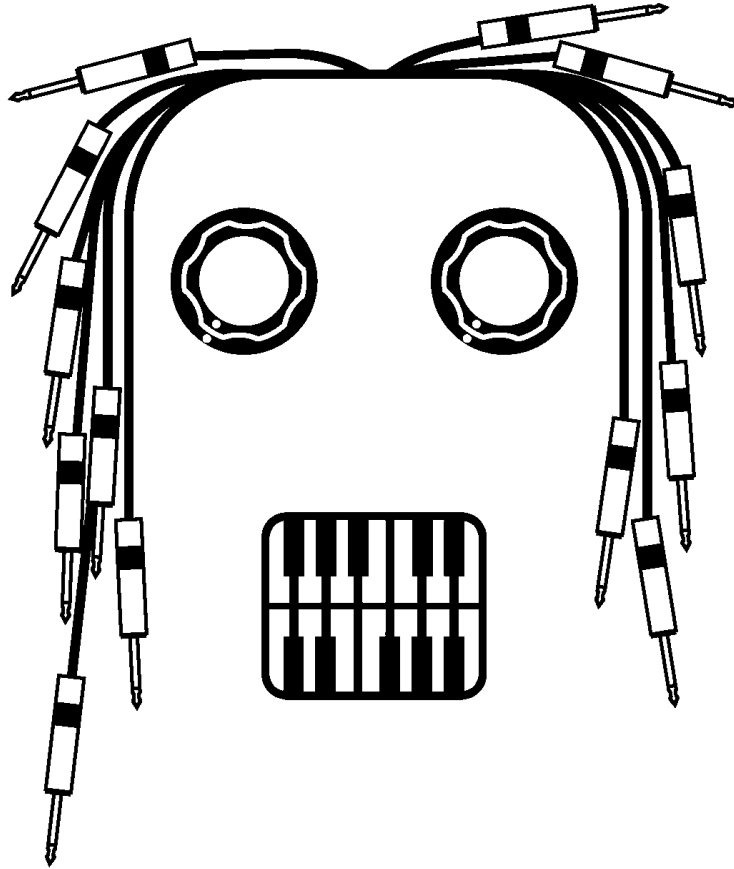

Synthesizers.com