

Byron

TX-31

Wirefree Doorbell Transmitter

Battery Installation

Push button unit

1. Push button unit is operated by 2 x 3 volt Lithium batteries (CR2032 - *included*).
2. Remove the back of the case by pushing in the tab on the bottom with a small, flat screwdriver.
3. 2 x 3 volt Lithium batteries (CR2032) have been installed. Simply pull off the isolating strip that allow the battery to make electrical contact.
4. Snap the front cover of push button back on, then it is ready to use.

Replacing the batteries. Remove the locking screw from the battery fastener of the battery compartment. Insert 2 x 3 volt Lithium batteries (CR2032 - *included*) in the battery compartment, ensuring the battery polarity match the internal markings, then tighten the screw on the battery fastener to hold the batteries firmly in it's compartment.

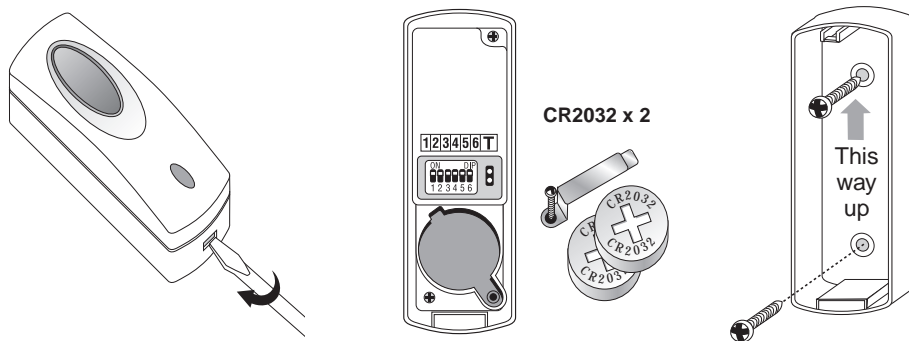

Installation Guide

Bell Push Unit: Using the two holes on the back of push button as a template, mark the fixing position for the unit.

Drill holes and fit wall plugs and secure the Bell Push Unit with screws (self-tapping N3 x 16mm screws) in position, or by the double-sided self-adhesive pad (includee), onto your front door or the position nearby.

When mounting to masonry, fit wall plugs. When mounting to wooden doorframe wall plugs are not necessary.

Important: Munting the Push Button unit on the metal doorframes or UPVC doorframes will seriously reduce the broadcasting range.

Melody Selection

The Melody selector is located inside the push button unit, a small switch on the top right corner of battery compartment marked with "T". When a jumper switch is removed, the tone will change from "Westminster" tone to "Ding-Dong". The push button is pre-set to "Westminster" therefore, if no change is required, it should not be adjusted.

Channel Selection

The unit comes from the factory on a pre-set radio frequency channel. However, should your door chime activate intermittently for no reason at all, it is possible that a similar unit is operating nearby on the same frequency. The encoded frequency of the Push Button (transmitter) and Door Chime (receiver) can be changed to avoid this problem.

1. Bell Push: Remove the back of case by pushing in the tab on the bottom with a small, flat screwdriver.
Door Chime Unit: Slide open the battery compartment.
2. There is 6 position dip switch marked 1,2,3,4,5 & 6, use a small screw driver to alter the dip switch levers to the "On/Off" position, which can be altered to achieve total sixty-four (64) possible channels.
3. In any combination ensuring it is set to the same code on both Push Button and Doorbell units.
4. Test to ensure correct operation before final installation.

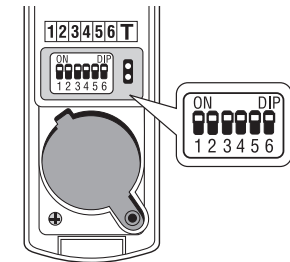

Door Chime Operation

Press the button on the Push Button unit once, the LED indicator will light up during signal transmission for 1 second, and Door Chime unit will sound. For repeat sound, press the button again. Holding the button in will **NOT** repeat the sound.

Important

1. Do not mount the Push Button unit onto any metal surface or metal doorjamb.
2. Do not expose the unit directly to rain or immerse in water.
3. Do not expose the unit to high temperatures or close to fireplace.
4. Do not use different type of batteries, or mix up old and new batteries.
5. Do not leave exhausted batteries in the unit.
6. Please dispose of old, defective batteries in and environmentally friendly manner in accordance with the relevant legislation.
7. Make sure that no naked flame sources, such as lighted candles, should be placed on the unit.
8. The unit should not be exposed to dripping or splashing and that no objects filled with liquids, such as vases, shall be placed on the unit.
9. Replace only with the same or equivalent type recommended by the manufacturer.
10. There are no serviceable parts in the unit, do not attempt to repair it.

Specification

Push Button unit

- Power : 2 x 3volt Lithium batteries (CR2032 - included)
Consumption : 3.0mA - ON
0.003mA - OFF
Operating Temperature: -10°C to +40°C
Operating Distance : 200 metres (640 feet approx.) in open field
Selectable Tone : "Westminster" & "Ding-Dong"
Selectable Channel : Total sixty-four (64) possible channels