

# Byron

SX-30

## Wirefree Doorbell Transmitter

### Battery Installation

#### Push button unit

1. Push button unit is operated by 2 x 3 volt Lithium batteries (CR2032 - included).
2. Remove the back of the case by pushing in the tab on the bottom with a small, flat screwdriver.
3. 2 x 3 volt Lithium batteries (CR2032) have been installed. Simply pull off the isolating strip to allow the batteries to make electrical contact.
4. Snap the front cover of push button back on and it is ready to use.

**Replacing the batteries.** Remove the locking screw from the battery fastener in the battery compartment. Insert 2 x 3 volt Lithium batteries (CR2032 - included) in the battery compartment, ensuring the battery polarity match the internal markings, then tighten the screw on the battery fastener to hold the batteries firmly in place.

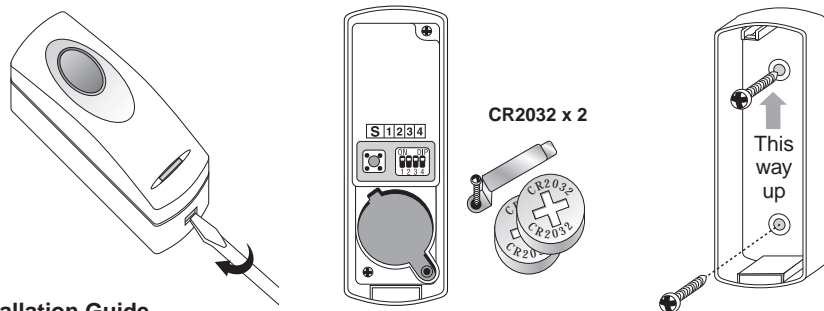

### Installation Guide

**Bell Push Unit:** Using the two holes on the back of push button as a template, mark the fixing position for the unit.

Drill holes and fit wall plugs and secure the Bell Push Unit with screws (self-tapping N3 x 16mm screws) in position, or by the double-sided self-adhesive pad (includee), onto your front door or the position nearby.

When mounting to masonry, fit wall plugs. When mounting to wooden doorframe wall plugs are not necessary.

**Important:** Mounting the Push Button unit onto UPVC doorframes or metal surfaces will seriously reduce the broadcasting range.

### Melody Selection (On selected Models)

The Melody selector is located inside the push button unit, a small switch on the top left corner of battery compartment marked with "S". Press the switch once, the melody will change to the next one on the list, there are total 8 melodies for selection. The push button is pre-set to "Westminster" therefore, if no change is required, it should not be adjusted.

- |                          |                       |
|--------------------------|-----------------------|
| 1) Westminster - 8 notes | 5) Banjo on my knee   |
| 2) Ding-Dong - Repeat    | 6) Twinkle, Twinkle   |
| 3) Telephone Ring        | 7) It's a small world |
| 4) Circus Theme          | 8) Dog Barking        |

### Channel Selection

The unit comes from the factory on a pre-set radio frequency channel. However, should your door chime activate intermittently for no reason at all, it is possible that a similar unit is operating nearby on the same frequency. The encoded frequency of the push button (transmitter) and Door Chime (receiver) can be changed to avoid this problem.

1. Bell Push: Remove the back of the case by pushing in the tab on the bottom with a small, flat screwdriver.  
Door Chime Unit: Slide open the battery compartment.
2. There is a 4 position dip switch marked 1,2,3,4. Use a small screwdriver to alter the dip switch levers to the "On" or "Off" position, which can be altered to achieve total sixteen (16) possible channels.
3. In any combination ensuring it is set to the same code on both Push Button and Doorbell units.
4. Test to ensure correct operation before final installation.

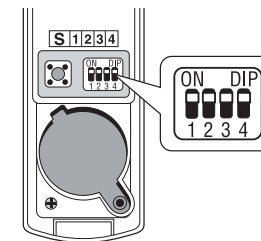

### Door Chime Operation

Press the button on the push button unit once, the LED indicator will light up during signal transmission for 1 second and the Door Chime unit will sound as the Ultra Light will flash. The sound and light will stop as soon as the melody ends. For repeat sound, press the button again. Holding the button in will **NOT** repeat the sound.

### Important

1. Do not mount the Push Button unit onto any metal or UPVC doorframe as this will reduce the operating range.
2. Do not immerse either unit in water.
3. Do not expose either unit to high temperatures or close to fireplace.
4. Do not use different type of batteries, or mix up old and new batteries.
5. Do not leave exhausted batteries in either unit. If leaving the doorbell for a long period of time, remove the batteries from all compartments to prevent leakage.
6. The chime unit is designed for internal use only.
7. Please dispose of old, defective batteries in an environmentally friendly manner in accordance with the relevant legislation.
8. The unit should not be exposed to or placed near sources of water or direct heat.
9. Replace batteries only with the same or equivalent type recommended by the manufacturer.
10. Do not place near a P.I.R. which may interfere with your chime.

### Specification

#### Push Button unit

Power	: 2 x 3volt Lithium batteries (CR2032 - included)
Consumption	: 3.0mA - ON 0.003mA - OFF
Operating Temperature	: -10°C to +40°C
Operating Distance	: 100 metres (320 feet approx.) in open field
Selectable Tone	: 8 melodies
Selectable Channel	: Total sixteen (16) possible channels