

**DE** Optional features **DE** Optionale Funktionen **FR** Options disponibles **NL** Opties  
**FI** Valinnaiset ominaisuudet **UK** Valgfnrie funktioner **IT** Funzionalità opzionali **ES** Opciones disponibles  
**PT** Funções opcionais **GR** Προαιρετικές λειτουργίες πρόσθετων **SE** Möjliga funktioner

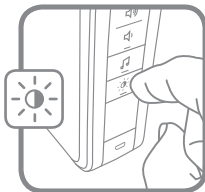

	Hello	Ding Dong	Westminster	Marimba	Piano	Bell	Telephone	Soft Alert
	•	•					•	•
	•	•	•	•			•	•
	•	•	•	•	•	•	•	•

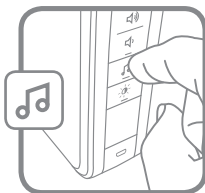
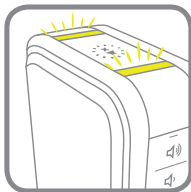

**GB** Trouble shooting **DE** Fehlerbehebung **FR** Dépannage **NL** Probleemoplossing  
**FI** Vianmääritys **UK** Problemlösning **IT** Risoluzione dei problemi **ES** Solución de  
 problemas **PT** Resolução de problemas **GR** Αντιμετώπιση προβλημάτων **SE** Felsökning

**livewell.honeywell.com**



32310682-001 Rev.B

GB Contents **05** Inhalt **06** Contenu **07** Inhoud  
 F Sisältö **08** Inhold **09** Contenido  
 ES Contenido **10** Conteúdo **11** Περιεχόμενα  
 SE Innehåll

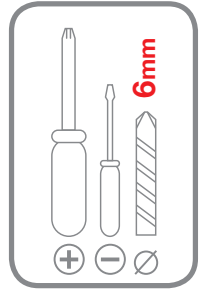
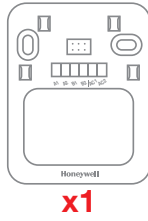

GB Getting started **05** Erste Schritte **06** Démarrage **07** Aan de slag  
 F Aloituspäät **08** Kom i gång **09** Operazioni preliminari **10** Para empezar  
 ES Para comenzar **11** Πρώτα βήματα **12** Kom igång

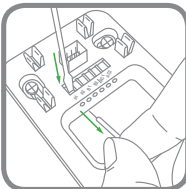
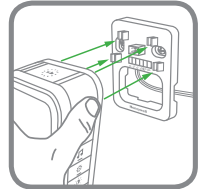
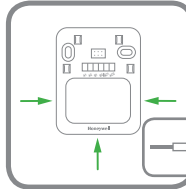
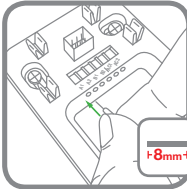
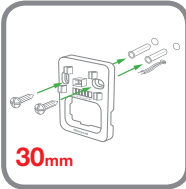
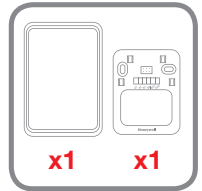
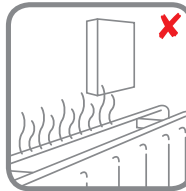
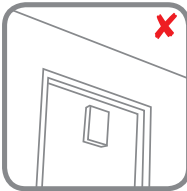
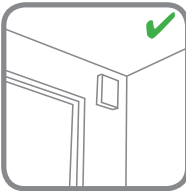

66 Wired push with batteries 69 Verdrahteter Drucktaster mit Batterien 68 Bouton poussoir avec piles 71 Bekabälde drukknoop met batterijen  
 67 Johdotettu painike paristoilla 70 Kabel tryk med batterier 7 Pulsante cabliato con batterie 65 Pulsator cableado con baterías 7 Boão com fios com pilhas  
 68 Καλωδιωμένο ωστήριο με μπαταρίες 69 Trådbunden tryckknapp med batterier

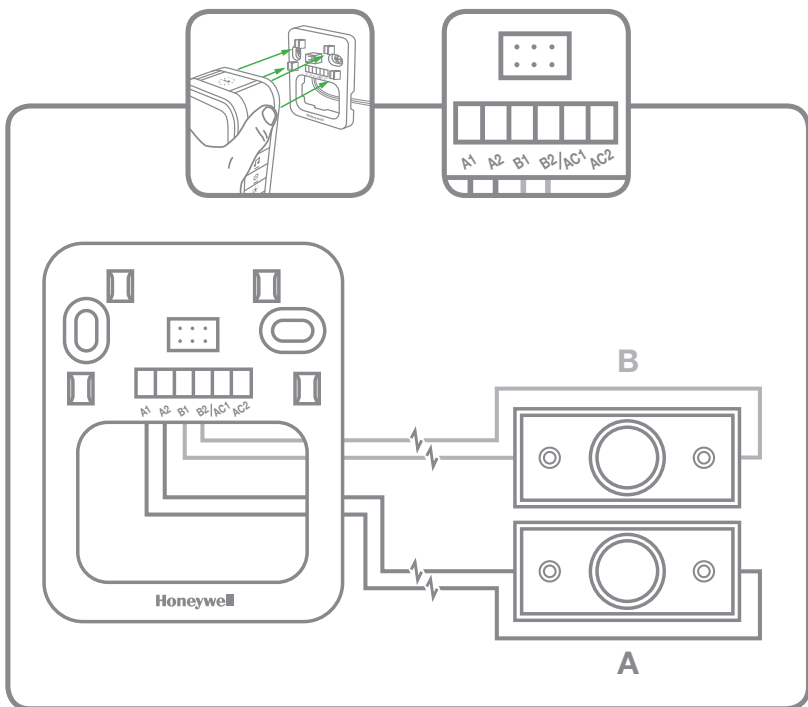
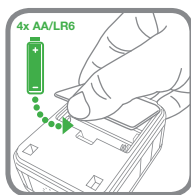
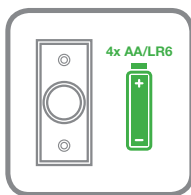

03 Wired illuminated push with transformer 04 Verdrahteter Druckknaster mit Beleuchtung und Transformator 05 Bouton poussoir éclairé avec transformateur  
 06 Verlichte bekabelde drukknop met transformator 07 Johdotettu valaistu painike muuntajalla 08 Kabieł belysyt tryk med transformier  
 09 Pulsante cablato illuminato con trasformatore 10 Pulsador iluminado cableado con transformador 11 Botão iluminado com fios com transformador  
 12 Καλωδιωμένο ωστήριο με μετασχηματιστή 13 Trådbunden upplyst tryckknapp med transformator

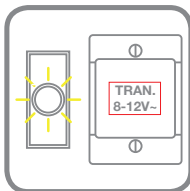

03 Always ensure the main supply is disconnected before installation, follow Transformer Instructions.

04 Immer daran denken, die Hauptversorgung vor der Installation abzuschalten. Dazu die Transformatoranweisungen befolgen.

05 Assurez-vous toujours que l'alimentation principale est déconnectée avant l'installation. Respectez les consignes concernant le transformateur.

06 Zorg er altijd voor dat de hoofdtoevoer afgesloten is voordat er met de installatie begonnen wordt, volg de instructies voor de transformator.

07 Varmista aina, että päävirransyöttö on katkaistuna ennen asennusta, ja noudata muuntajan ohjeita.

08 Sørg alltid for, at strømmen er afbrudt før installation. Følg Transformer instruktionerne.

09 Assicurarsi sempre che l'alimentazione principale sia scollegata prima di procedere con l'installazione. Seguire le istruzioni relative al trasformatore.

10 Asegúrese siempre de que el suministro eléctrico está desconectado antes de la instalación, siga las instrucciones del transformador.

11 Certifique-se sempre de que a fonte de alimentação principal é desligada antes da instalação e siga as instruções do transformador.

12 Να βεβαιώνετε πάντοτε ότι η κύρια παροχή είναι αποσυνδεδεμένη πριν από την εγκατάσταση, τηρείτε τις Οδηγίες για τον Μετασχηματιστή

13 Se alltid till att elnätet är bortkopplat innan installationen och följ transformatorns instruktioner.

