

PARTS DESCRIPTION

**NEEDED TO START (EXCL.)**

6mm

**BOX CONTENT**

1.	2.	3.	4.	5.	6.	7.	8.	9.
1x	1x	1x	2x	1x	1x	1x	1x	2x 2x 2x

**DOORBELL**

- Camera Image Sensor
- Infrared LED
- Microphone
- WiFi Signal Indicator
- Call button
- TF Card Slot
- RESET Button
- USB Slot
- Speaker

INSTALLATION

**MOUNTING THE DOORBELL**

A: Preparing the mounting plate with a screwdriver.

B: Drilling a hole in the wall with a 6mm drill.

C: Inserting a wall plug (2x).

D: Inserting screws into the wall plugs.

E: Attaching the mounting plate to the wall.

F: Connecting the doorbell to an 8V - 24V Power supply.

G: Inserting the doorbell into the mounting plate.

H: Tightening the screws to secure the doorbell.

**ELECTRICAL INSTALLATION**

min 8v- max 24v transformer (not included)

**PAIRING A DBY COMPATIBLE DOORCHIME (OPTIONAL, EXCLUDED)**

A: Plugging the doorbell into a power outlet. **DBY COMPATIBLE**

B: Pressing the call button for **within 20 sec**. **DING DONG**

**CHANGING MELODY INDOOR CHIME (NOT INCLUDED)**

A: **Long press** the call button.

B: Selecting a melody from the chime options.

**REPLACE ELECTRICAL INSTALLATION**

Existing situation

New situation

BYHOME APP

APP INSTALLATION

Android



or

iOS



Byhome

Open the App Store (iOS) or Google Play (Android) on your mobile device. Then search for and install the "ByHome" APP, or scan the QR-code.

CREATING AN ACCOUNT

1



Byhome

Open the app

2

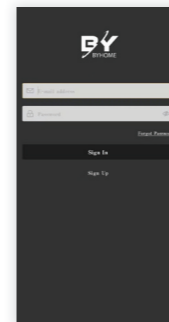

Choose sign up

3

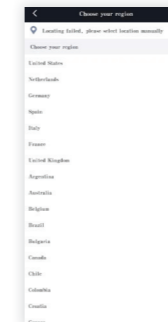

Select your region and choose Next.

4



Enter your information to create an account. Mark the two boxes and choose Sign Up

5



Activate your account through email

6

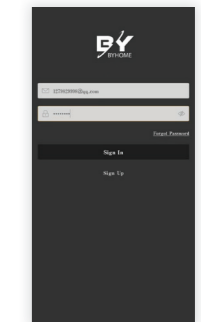

Sign in to your account

ADD A DEVICE

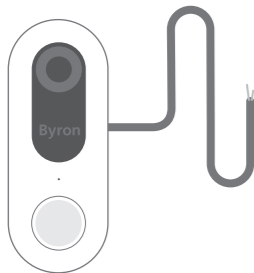

When the doorbell is powered, wait for 30 seconds before proceeding in the app.



Byhome

Open the app

5

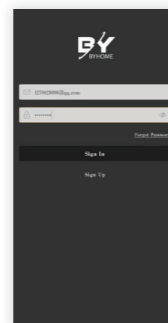

Sign in to your account

6



Choose the "+" icon

7

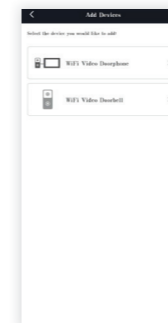

Choose the doorbell



Press the reset button until the voice prompts it is restoring factory settings. After 30 seconds it will prompt: waiting to configure Wifi.

8

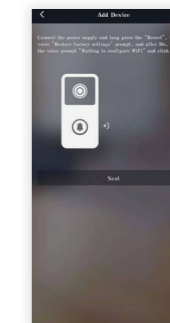

Choose Next

9

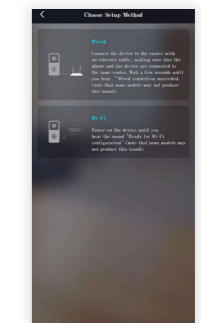

Choose WiFi

ADD A DEVICE

10

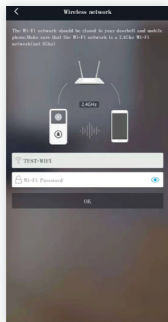

Enter your password and choose Next. (If your WiFi is 5GHz, set it to 2,4 GHz first)

11



Choose configure Wifi connection

12



Get the QR code in the app

13



Use the camera to scan the QR code

14

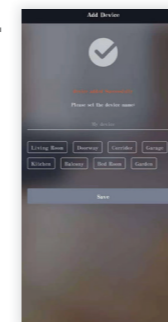

Set the device name and choose Save

15

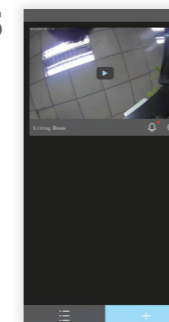

Choose the monitoring area

16

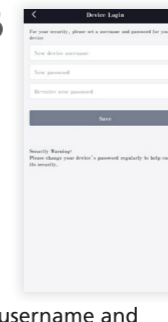

Set a username and password for your camera and choose Save

17

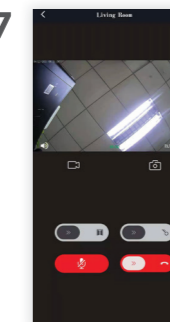

Device is added successfully

18



TROUBLESHOOTING



Press the reset button until the voice prompts it is restoring factory settings.

CONTACT INFORMATION

WWW.CHBYRON.EU



Find us on  
**YouTube**

Or contact us directly:

EU address: <b>smartwares Europe</b> Jules Verneweg 87 5015 BH Tilburg The Netherlands <a href="http://www.chbyron.eu">www.chbyron.eu</a>	UK address: <b>smartwares Safety and Lighting Ltd.</b> Meriden House, 6 Great Combow Halesowen, West Midlands, B63 3AB United Kingdom
--	--

Conforms to all relevant European Directives.

SPECIFICATIONS

**Wired Wi-Fi Video Doorbell DIC-23712**  
Power: 8-24V  
Radio frequency: 2,4 GHz.  
IP44 Weather Resistant

Works with 2,4GHz WiFi ONLY

