

brackets, handrail couplings & crank



ČČEĚT	TRIPLE CORNER BRACKET 1 1/2" X 1"	RED	M	7.55
133B	TRIPLE CORNER BRACKET 1 1/2" X 1"	ZINC	M	2.20
133C	CORNER BRACKET OBTUSE	ZINC	M	2.20
134	CRANK SHAFT 1" STROKE	ZINC	M	3.95
136	HANDRAIL SUPPORT	BRASS	A	
136A	HANDRAIL COUPLING	BRASS	A	

wheel flange, tyres, flanged bracket



ČČX	WHEEL FLANGE	ZINC	M	5.65
139	FLANGED BRACKET RIGHT	ZINC	A	13.25
139A	FLANGED BRACKET LEFT	ZINC	A	13.25
140	UNIVERSAL COUPLING	ZINC	A	NO STOCK
140Y	4 HOLE COLLAR FOR UNIVERSAL	BRASS	A	5.256
140Z	SHOULDER BOLT FOR UNIVERSAL	BRASS	A	14.55
142	RUBBER RING FOR 3" PULLEY	WHITE	A	18.95
142BL	TYRE BALLOON FOR 3" PULLEY	BLACK	A	31.20
142C	MOTOR TYRE 1" FOR 1" PULLEY	BLACK	M	5.40
142H	MOTOR TYRE FOR 1 1/2" PULLEY	BLACK	M	19.90
142L	MOTOR TYRE HEAVY TREAD FOR 3" PUL	BLACK	A	86.75
142M	MOTOR TYRE HEAVY TREAD FOR 2" PUL	BLACK	A	58.00

circular parts, dog clutch

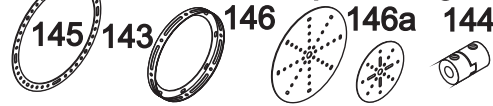

ČČC	CIRCULAR GIRDER	BLUE	A	
144	DOG CLUTCH	BRASS	A	25.20
145	CIRCULAR STRIP 7 1/2"	BLUE	M	
146	CIRCULAR PLATE 6"	BLUE	A	
146A	CIRCULAR PLATE 4"	BLUE	A	

pawls, ratchet wheel, pointer & fan

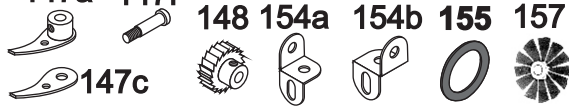

ČČDĚ	PAWL WITH BOSS	ZINC	A	1.75
147B	PIVOT BOLT	NICKEL	A	5.45
147C	PAWL WITHOUT BOSS	ZINC	M	5.00
147D	ALLEN HEAD PIVOT BOLT 8 MM	ZINC	M	.75
147F	ALLEN HEAD PIVOT BOLT 12 MM	ZINC	M	.85
147G	ALLEN HEAD PIVOT BOLT 14 MM	ZINC	M	.95
148	RATCHET WHEEL	BRASS	A	43.85
154A	CORNER ANGLE BRACKET (RIGHT)	ZINC	A	5.85
154B	CORNER ANGLE BRACKET (LEFT)	ZINC	A	3.50
155	RING FOR 1" PULLEY	BLACK	M	1.70
155W	RING FOR 1" PULLEY	WHITE	A	1.20
157	FAN 2" DIA	BLUE	A	



ČČC	SINGLE SHEAVE PULLEY BLOCK	RED	A	
152	TWO SHEAVE PULLEY BLOCK	RED	A	
153	THREE SHEAVE PULLEY BLOCK	RED	A	

brackets & channels

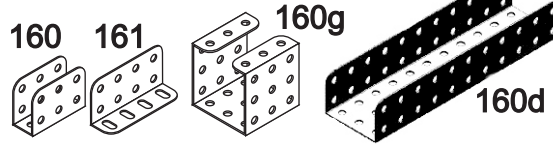

ČČC	CHANNEL BEARING	YELLOW OR	ZINC	M	9.60
160D	CHANNEL 5 1/2" X 1 1/2" SQUARE	GREY	M	32.35	
160G	CHANNEL 1 1/2" SQUARE	GREY	M	NO STOCK	
161	GIRDER BRACKET	YELLOW OR	ZINC	M	9.60

cylinders, flanged ring. 167a

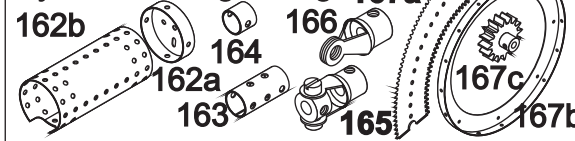

ČČCĚ	BOILER END 2 1/16" DIA	ZINC	A	39.40
162B	BOILER WITHOUT ENDS	BLUE	A	27.45
163B	SLEEVE PIECE 1 1/2" X 11/16"	BLUE	A	12.85
163Z	SLEEVE PIECE 1 1/2" X 11/16"	ZINC	M	5.25
164	CHIMNEY ADAPTOR 5/8" X 1/2"	ZINC	A	20.30
165	SWIVEL BEARING	ZINC	A	75.00
166	END BEARING	ZINC	A	21.70
167A	LARGE TOOTH QUADRANT	BLACK	A	
167AB	GEARED ROLLER BEARING PLATE	BLUE	A	NO STOCK
167B	FLANGED RING 9 7/8" DIA	BLUE	A	
167C	LARGE TOOTH QUADRANT PINION	BRASS	A	

ball race bearing, socket coupling, rod 168a 168b 168c socket, steering wheels.

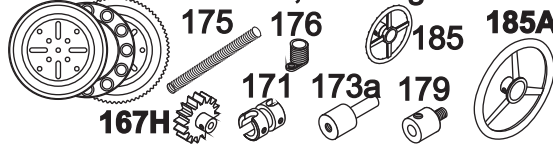

ČČDĚ	RACE FLANGED DISC 3 3/4"	BLACK OR	BLUE	M&A	39.75
168B	RACE TOOTHED DISC 73T 4"	BLACK	A		79.50
168BP	RACE TOOTHED DISC FOR PINION	BLUE	A		60.00
168C	THRUST RACE BALL CAGE	ZINC	A		57.50
168D	BALL BEARING 3/8" DIA	ZINC	A		1.40
168H	PINION FOR 168BP	BRASS	A		
171	SOCKET COUPLING	BRASS	A		
173A	ADAPTOR/SCREWED ROD	BRASS	L		6.00
175	FLEXIBLE COUPLING	ZINC	A		11.90
176	ANCHORING SPRING FOR CORD	ZINC	A		1.70
179	ROD SOCKET	BRASS	A		11.55
180	GEAR RING 95 TEETH INNER, 133 OUTER	BLACK	M		
185	STEERING WHEEL 1 3/4"	BLACK	M		9.00
185A	STEERING WHEEL 2 1/2"	BLACK	M		

driving bands

ČDĚ	DRIVING BAND 2 1/2" (LIGHT)	BLACK	A	1.60
186A	DRIVING BAND 6" (LIGHT)	BLACK	M	2.25
186B	DRIVING BAND 10" (LIGHT)	BLACK	A	7.30
186C	DRIVING BAND 10" (HEAVY)	BLACK	A	17.30
186D	DRIVING BAND 15" (HEAVY)	BLACK	A	7.70
186E	DRIVING BAND 20" (HEAVY)	BLACK	A	20.85
186F	DRIVING BAND (LIGHT) 6 1/2"	YELLOW	M	2.10
186G	DRIVING BAND 20" (LIGHT)	BLACK	M	1.80
186K	DRIVING BAND (LIGHT) 5 3/4"	BLACK	M	1.80
186J	DRIVING BAND (LIGHT) 3 1/8"	GREY	M	2.20

180 Conical disc, gear ring.

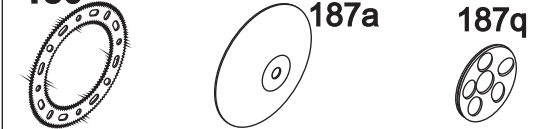

ČDĚĚ	CONICAL DISC 1 7/8"	RED	M	8.95
187	ROAD WHEEL PLASTIC 2 «"	GREY/BLUE	A	
187Q	HUB CAP 22 MM	ZINC	M	1.20

flexible plates

ČDĚD	FLEXIBLE PLATE 2 1/2" X 1 1/2"	YELLOW	A	4.65
189	FLEXIBLE PLATE 5 1/2" X 1 1/2"	YELLOW	A	15.90
190	FLEXIBLE PLATE 2 1/2" X 2 1/2"	YELLOW	A	9.15
190A	FLEXIBLE PLATE 3 1/2" X 2 1/2"	YELLOW	A	15.90
190AR	FLEXIBLE PLATE 3 1/2" X 2 1/2"	RED	M	5.10
191	FLEXIBLE PLATE 4 1/2" X 2 1/2"	YELLOW	A	19.25
192	FLEXIBLE PLATE 5 1/2" X 2 1/2"	YELLOW	A	13.50

transparent & plastic plates

ČĚC	TRAN/FLEX PLATE 2 1/2 X 1 1/2	CLEAR	M	3.10
193A	TRAN/FLEX PLATE 2 1/2 X 2 1/2	CLEAR	M	4.00
193C	TRAN/FLEX PLATE 4 1/2 X 2 1/2	CLEAR	M	6.45
193D	TRAN/FLEX PLATE 5 1/2 X 1 1/2	CLEAR	M	5.25
193E	TRAN/FLEX PLATE 5 1/2 X 2 1/2	CLEAR	M	7.00
194	PLASTIC PLATE 2 1/2" X 1 1/2"	BLUE	M	2.75
194A	PLASTIC PLATE 2 1/2" X 2 1/2"	BLUE	M	3.15
194C	PLASTIC PLATE 4 1/2" X 2 1/2"	BLUE	M	3.50
194D	PLASTIC PLATE 5 1/2" X 1 1/2"	BLUE	M	3.20

flexible, hinge & gusset plates

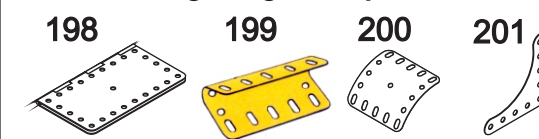

ČĚD	STRIP PLATE 7 1/2"	YELLOW	A	34.35
196	STRIP PLATE 9 1/2"	YELLOW	A	37.70
197	STRIP PLATE 12 1/2"	YELLOW	A	45.55
198	HINGED PLATE 4 1/2 X 2 1/2	YELLOW	M	40.00
199	CURVED PLATE 'U' SECTION	YELLOW	A	6.75
200	CURVED PLATE 1 11/16" RAD	YELLOW	A	10.55
201	FLEXIBLE GUSSET PLATE	YELLOW	A	10.85
201R	FLEXIBLE GUSSET PLATE	RED	M	7.00