

70	FLAT PLATE 5 1/2" X 2 1/2"	YELLOW	A	22.35
72	FLAT PLATE 2 1/2" X 2 1/2"	YELLOW	A	14.55
73	FLAT PLATE 3" X 1 1/2"	YELLOW	A	10.35
73AY	FLAT PLATE OBTUSE 2 1/4" X 1 1/2"	YELLOW	M	12.45
73AP	FLAT PLATE OBTUSE 2 1/4" X 1 1/2"	PINK	M	12.45
74R	FLAT PLATE 1 1/2" X 1 1/2"	RED	M	9.95
74Z	FLAT PLATE 1 1/2" X 1 1/2"	ZINC	M	6.30
74Y	FLAT PLATE 1 1/2" X 1 1/2"	YELLOW	M	7.35
76	TRIANGULAR PLATE 2 1/2" X 2 1/2"	YELLOW	A	14.85
77R	TRIANGULAR PLATE 1"	RED	M	11.15
77Y	TRIANGULAR PLATE 1"	YELLOW	M	11.15
77Z	TRIANGULAR PLATE 1"	ZINC	M	11.15

screwed rods



78	SCREWED ROD 11 1/2"	BRASS	A	23.75
79	SCREWED ROD 8"	BRASS	A	21.40
79A	SCREWED ROD 6"	BRASS	A	12.75
80	SCREWED ROD 5"	BRASS	A	11.10
80A	SCREWED ROD 3 1/2"	BRASS	A	7.75
80B	SCREWED ROD 4 1/2"	BRASS	A	9.65
80C	SCREWED ROD 3"	BRASS	A	6.95
81	SCREWED ROD 2"	BRASS	A	4.60
82	SCREWED ROD 1"	BRASS	A	3.20

curved strips

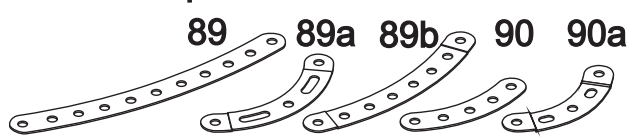

89	CURVED STRIP 5 1/2"	ZINC	M	7.60
89A	CURVED STRIP 3"	ZINC	M	4.25
89B	CURVED STRIP 4" STEPPED	ZINC	M	7.60
90	CURVED STRIP 2 1/2"	ZINC	M	3.80
90A	CURVED STRIP 2 1/2" STEPPED	ZINC	M	4.45

sprocket wheels & chain

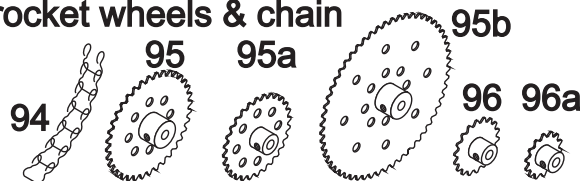

94	SPROCKET CHAIN 1 METRE	ZINC	A	NO STOCK
95	SPROCKET WHEEL 36 TEETH 2"	BLACK	A	30.65
95A	SPROCKET WHEEL 28 TEETH 1 1/2"	BLACK	A	25.50
95B	SPROCKET WHEEL 56 TEETH 3"	BLACK	A	36.50
96	SPROCKET WHEEL 18 TEETH 1"	BLACK	A	19.00
96A	SPROCKET WHEEL 14 TEETH 3/4"	BLACK	A	18.75

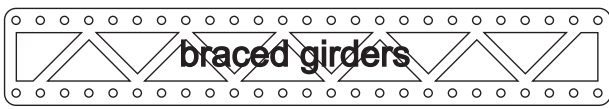

99	BRACED GIRDER 12 1/2"	CLOSED END	ZINC	M	20.65
99Y	BRACED GIRDER 12 1/2"	OPEN ENDED	YELLOW	M	20.65
99Z	BRACED GIRDER 12 1/2"	OPEN ENDED	ZINC	M	20.65
100	BRACED GIRDER 5 1/2"		YELLOW	M	17.50

flat girders

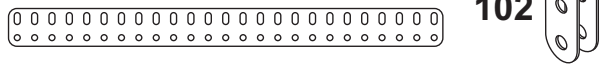

102	SINGLE BENT STRIP		ZINC	A	4.55
103	FLAT GIRDER 5 1/2"		ZINC	A	11.40
103A	FLAT GIRDER 9 1/2"		ZINC	A	14.20
103B	FLAT GIRDER 12 1/2"		ZINC	A	15.70
103C	FLAT GIRDER 4 1/2"		ZINC	A	11.45
103D	FLAT GIRDER 3 1/2"		ZINC	A	9.95
103E	FLAT GIRDER 3"		ZINC	A	8.00
103F	FLAT GIRDER 2 1/2"		ZINC	A	7.00
103G	FLAT GIRDER 2"		ZINC	M	5.35
103H	FLAT GIRDER 1 1/2"		ZINC	M	4.70
103K	FLAT GIRDER 7 1/2"		ZINC	A	12.80
103L	FLAT GIRDER 1"		ZINC	M	4.00
103R	FLAT GIRDER 24 1/2"		ZINC	A	
103S	FLAT GIRDER 18 1/2"		ZINC	A	

wood rollers, face plate, rack strips.

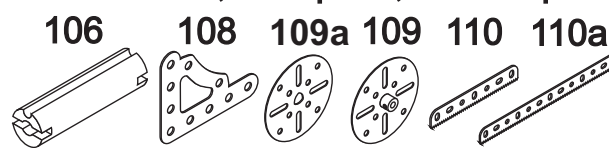

106	ROLLER BEECH 4" LM		WOOD	L	12.50
107	DESIGNING TABLE WITH BUSH WHEEL ATTACHED. 3/8" X 6 1/2" X 6 1/2"		PLYWOOD	L	20.00
108	CORNER GUSSET 2" X 2 1/2"		ZINC	A	10.45
109	FACE PLATE		BLUE	A	19.45
109A	FACE PLATE NO BOSS 2 1/2"		BLUE	A	17.15
110	RACK STRIP 3 1/2"		BLACK	A	13.28
110A	RACK STRIP 6 1/2"		BLACK	A	23.45

long bolts, hinge, threaded pins.



111	BOLT CHEESEHEAD 3/4"		NICKEL	A	.75
111A	BOLT CHEESEHEAD 1/2"		NICKEL	A	.65
111C	BOLT CHEESEHEAD 3/8"		NICKEL	A	.55
111D	BOLT CHEESEHEAD 1 1/8"		NICKEL	A	.90
111AH	BOLT ALLEN HEAD 3/4"		ZINC	M	.75
111AAH	BOLT ALLEN HEAD 1/2"		ZINC	M	.85
111CAH	BOLT ALLEN HEAD 3/8"		ZINC	M	.65
111DAH	BOLT ALLEN HEAD 1 1/8"		ZINC	M	.75
111EAH	BOLT ALLEN HEAD 1"		ZINC	M	.75

B111	BRASS BOLT CHEESE HEAD 3/4"	BRASS	A	.50
B111A	BRASS BOLT CHEESE HEAD 1/2"	BRASS	A	.85
B111C	BRASS BOLT CHEESE HEAD 3/8"	BRASS	A	.70
B111D	BRASS BOLT CHEESE HEAD 1 1/8"	BRASS	A	1.85
B111E	BRASS BOLT CHEESE HEAD 1"	BRASS	A	1.50
113	GIRDER FRAME	ZINC	A	
114	HINGE	ZINC	A	8.85
115	THREADED PIN SHORT 5/8" SQ NUT	ZINC	A	5.95
115A	THREADED PIN LONG 1 3/8" SQ NUT	ZINC	A	7.90
115D	THREADED PIN WITH SHOULDER 1 1/8"	ZINC	M	2.25
115N	SHORT THREADED PIN WITH SQ NUT	ZINC	A	5.00

fork piece, springs, hub disc.

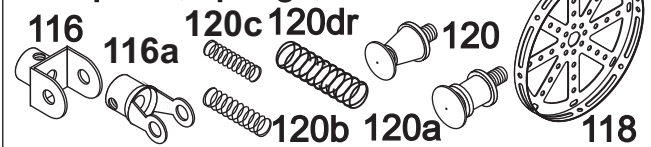

116	FORK PIECE LARGE	ZINC	A	13.00
116A	FORK PIECE SMALL	ZINC	A	18.90
118	HUB DISC 5 1/2"	BLUE	A	
120	BUFFER SOLID	BRASS	A	11.80
120A	SPRING BUFFER	BRASS	A	
120B	COMPRESSION SPRING 9/16"	ZINC	M	1.00
120C	COMPRESSION SPRING 19.5 MM	ZINC	M	.25
120D	SHOCK ABSORBER COMPLETE	ZINC	M	5.25
120DR	SHOCK ABSORBER SPRING	BLACK	M	.85

brackets, bell crank, rack segment.

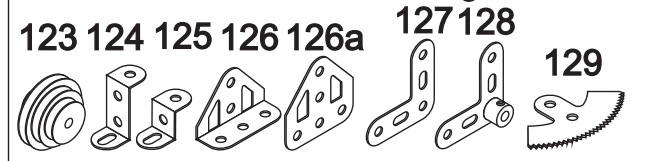

123	CONE PULLEY 1 1/4 1 3/4 L/M	BRASS	A	
124	REVERSE ANGLE BRACKET 1"	ZINC	M	4.45
125	REVERSE ANGLE BRACKET 1/2"	ZINC	A	2.85
126	TRUNNION	YELLOW	A	4.60
126Z	TRUNNION	ZINC	M	5.20
126AZ	FLAT TRUNNION	ZINC	A	4.60
127	BELL CRANK WITHOUT BOSS	ZINC	A	10.10
128	BELL CRANK WITH BOSS	ZINC	A	15.60
129	RACK SEGMENT	ZINC	A	

eccentrics, brackets, cam, flywheel

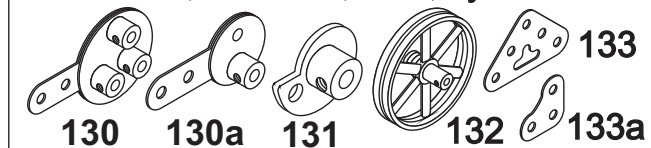

130	TRIPLE THROW ECCENTRIC	RED	A	
130A	SINGLE THROW ECCENTRIC	RED	A	
131	CAM	ZINC	A	
132	FLYWHEEL 2 1/2" BLACK, BLUE, RED		L	
133	CORNER BRACKET 1 1/2"	ZINC	M	10.40
133A	CORNER BRACKET 1"	ZINC	M	2.25