

## Poetic Charm



PC2314 Instruction Manual

## NOTICE OF ASSEMBLE

## Tips for assembling

1. Because this product contains small parts, children need to use this product with an adult to avoid accidental ingestion and cause suffocation hazard. There are sharp objects in the product, be careful not to pierce people to avoid injury.
2. After all the materials are used in the required amount in the operation steps, put the remaining materials back into the original bag until the installation is completed. (Avoid losing materials during the installation process)
3. The unit of dimension marked in the step diagram is "cm".
4. Tips for making template paper: Put the template on the back of the material, fix it with some small double-sided tape, and then cut out the material to prevent the cloth or template from moving in the cutting process, or causing errors in the cut material. Or lead to insufficient materials.
5. According to the "Parts Rule Example" at the bottom of this page, refer to the parts on the part number drawing, find the actual product and compare it with the bill of materials, and then install it after confirming that it is correct. (Wooden parts only)
6. It is not advisable to apply too much glue, so as not to wait for a longer time to dry, and overflow will affect the effect of the finished product.
7. There are unavoidable small deviations in the color of wood, fabric, and beads of different batches, without notice, thanks for understanding.

## Tips for Assembling Wood



Find the corresponding block number, use a knife in the connection point gently press, you can take out the wood.

Use a knife to smooth out the burr.

Or use sandpaper to smooth out the burr

## Testing on LED function

Be sure to test the LED lights before making the lighting, note that the LED white wire to the negative, gray wire to the positive reference to the following figure operation test.

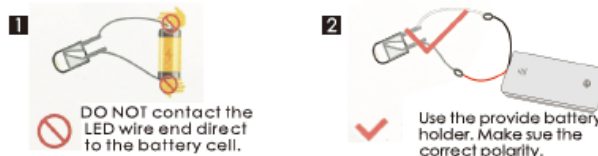

DO NOT contact the LED wire end direct to the battery cell.

Use the provide battery holder. Make sue the correct polarity.

## How to assemble the battery holder

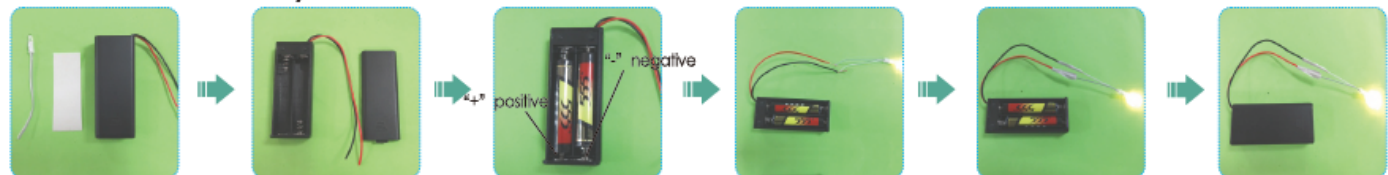

1. Material and tools needed:  
- Battery holder, LED bulb, tape, screw driver and 2 pieces AAA size battery(not provided)

2. Use screw driver and take the lid off from the battery holder.

3. Insert the battery take notes on the polarity.

4. Connect the red wire to grey wire, Connect the black wire to white wire.

5. Wrap the exposed wire with the tapes.

6. Place the box lid and fastness with screw driver.

## Examples of parts rule:

A01: The parts are directly in the box; B01: The parts are in the B bag; C01: The parts are in the C bag, and so on. (Note: The printing paper A24 is displayed in the step, and the part number is A24-1; In the step, the template paper A25-J01 is displayed, A25 is the template paper, J01 is the cutting template used for the corresponding material, J01-1, J01-2 are the part numbers for the parts, the printing paper and the template paper are directly placed in the box)

Accessory name	Related Materials Bag
Printing Paper	A24, A25 in Bag A (all of Printing paper and Template are in A24, total 3 sheets of A3 Printing paper, 1 sheet of A3)
Horse head wall + outer frame	A Bag + E Bag + J Bag + Printing paper + Template <span style="float: right;">Page 3-5</span>
Livingroom wall light + second floor wall light	H Bag + J Bag + Template <span style="float: right;">Page 6</span>
Bathroom wall light + bathroom chandelier	H Bag + J Bag + K Bag + M Bag + Template <span style="float: right;">Page 6</span>
Chandelier	H Bag + M Bag + Printing paper <span style="float: right;">Page 6-7</span>
Outdoor chandelier + outdoor floor lamp	H Bag + J Bag + M Bag + Printing paper + Template <span style="float: right;">Page 7-8</span>
Wall cabinet + range hood	G Bag + H Bag + K Bag + Printing paper <span style="float: right;">Page 8</span>
Bathroom cabinet + mirror	A Bag + F Bag + J Bag + K Bag + Printing paper + Template <span style="float: right;">Page 8-9</span>
Outdoor small wall lamp + outdoor large wall lamp	H Bag + M Bag + Printing paper <span style="float: right;">Page 9</span>
Outer frame assembly	A Bag + B Bag + E Bag + Printing paper <span style="float: right;">Page 10-11</span>
Staircase	A Bag + C Bag + K Bag + Printing paper <span style="float: right;">Page 11-12</span>
Front fence	A Bag + E Bag + Printing paper + Template <span style="float: right;">Page 12-13</span>
Small sofa + pillow	G Bag + J Bag + Printing paper + Template <span style="float: right;">Page 13-15</span>
Large sofa + stool	G Bag + J Bag + Template <span style="float: right;">Page 15-17</span>
End table + side table	G Bag + H Bag + J Bag + K Bag + Printing paper <span style="float: right;">Page 17</span>
Bed + bedside table	F Bag + J Bag + K Bag + Printing paper + Template <span style="float: right;">Page 18-19</span>
Antique frame + outer frame	A Bag + B Bag + F Bag + J Bag + K Bag + Printing paper + Template <span style="float: right;">Page 20-23</span>
Chessboard	H Bag + K Bag + Printing paper <span style="float: right;">Page 23</span>
Cabinet + kitchen chandelier	G Bag + H Bag + J Bag + K Bag + M Bag + Printing paper <span style="float: right;">Page 24-25</span>
Dining table + cushions	A Bag + G Bag + H Bag + J Bag + K Bag + Printing paper <span style="float: right;">Page 25</span>
Lantern	J Bag + K Bag <span style="float: right;">Page 26</span>
Pavilion	A Bag + D Bag + Printing paper + Template <span style="float: right;">Page 27</span>
Small bridge + outer frame	A Bag + D Bag + K Bag + L Bag + Template <span style="float: right;">Page 28-29</span>
Battery box installation	M Bag <span style="float: right;">Page 29</span>
Production of dust cover	M Bag + Z Bag <span style="float: right;">Page 30</span>

Thumbnail of material list (reference only)



Thumbnail of printing paper & template paper (reference only)

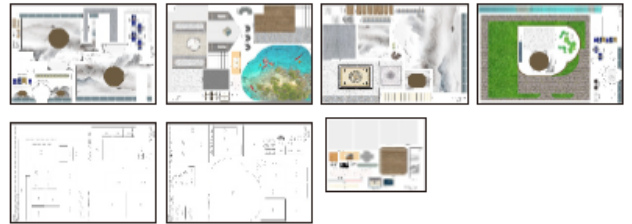

Symbol description used

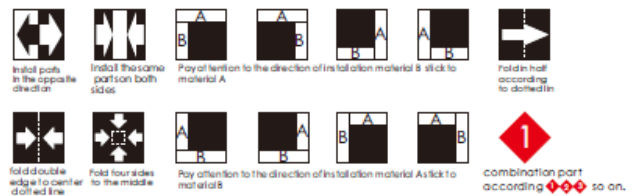

Tips:

When pasting the plane printing paper, a piece of waste bank card or telephone card can be used to wipe evenly after the glue is smeared on the wood board, and then the printing paper is pasted to squeeze out the air inside.

Types of glue:

White latex: Used for adhering soft materials, such as wood and paper.  
Alcoholic Glue: Used for adhering hard materials such as cloth, plastic, beads, wire, dust cover, etc.

Method for using glue:  
1. After applying the glue, let it dry for a few seconds before pasting.  
2. Fix it slightly with your hands, and finally put it aside to dry;

Horse head wall

1 As shown, glue the printing paper to A05

2 A05(Front)

3

4 A24-31 A05(Back)

5 A05 As shown, glue the printing paper

6 A05

7 Cut the printing paper and movement holes out of the window

**Upgraded Accessories (Need To Purchase Separately)**

N01 Clockwork Movement (1 piece)

N02 Movement Handle (1 piece)

N03 Movement Screws (3 pieces)

1 (Front) N01

As shown, install the movement

2 (Back) N02 N03

8

9 5mm A18 A19

10 A18 A19

9 A19

10 E09 E09

11 E02 E05 E05

3

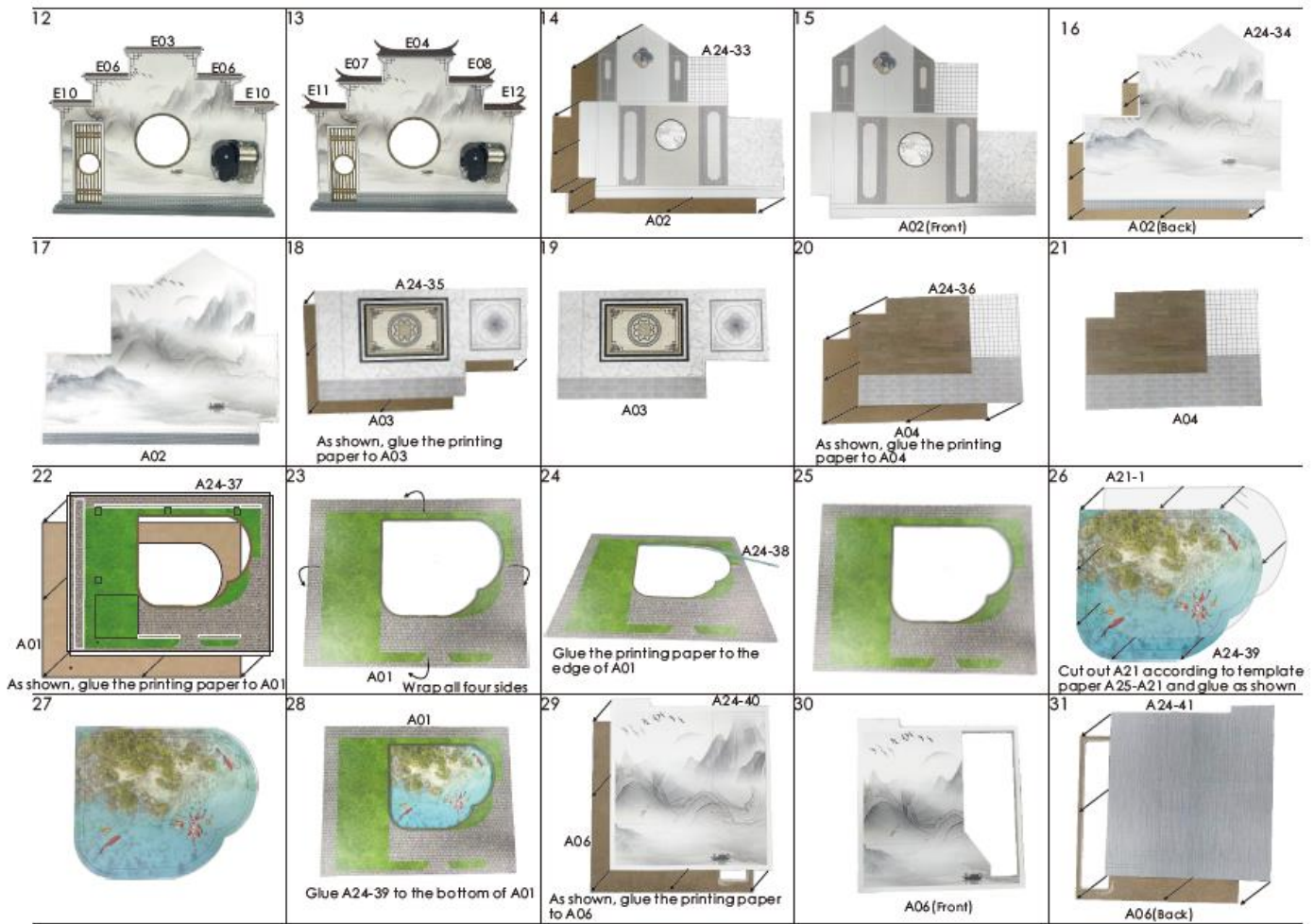

4

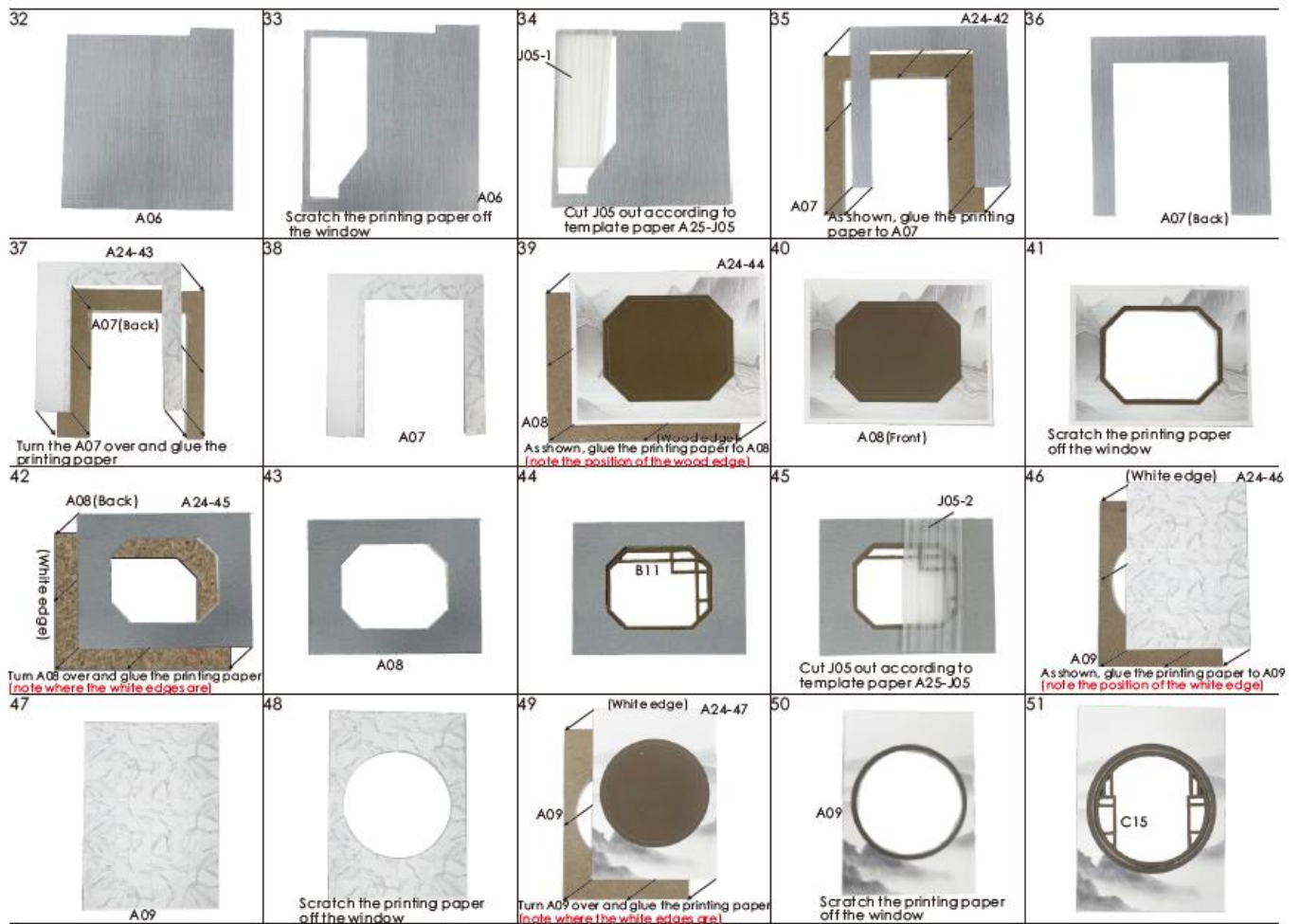

5

**Living room wall light**

Before making, cut out H15 and cut out J08 according to template paper A25-J08

H15-1 H15-1  
J12:3cm J12:3cm  
H15-2 H15-2  
H15-3 H15-3  
H15-4 H15-4  
J08-1 J08-1  
J15 J15

1 Wrap the H15-3 with the J08-1

2

3 H15-2  
H15-4

4 H15-1

5 J12:3cm  
J15  
Put J12 through J15

6 H15-1  
J15  
Tie J15 with wire J12 as shown

7 (need 2 pieces)

**Second floor wall light**

Before making, cut out H18 and cut out J08 according to template paper A25-J08

H18-1 H18-1  
H18-2 H18-2  
H18-3 H18-3  
H18-3 H18-3  
J08-2 J08-2  
J08-2 J08-2

1 H18-1  
H18-3

2 H18-2  
6mm 5mm

3 H18-2  
H18-2

4 H18-3

5 6.5mm 6mm 6.5mm  
J08-2

6 As shown, fold J08-2

7 (need 2 pieces)  
Paste as shown

8 H18-2  
H18-2  
H18-3  
H18-3  
M01

9 Slick H15 together as per the second floor wall lamp

10 H07-4

11 Stick J08-2 in the same way

**Bathroom wall light**

Before making, cut out H15 and cut out J08 according to template paper A25-J08

H18-1 H18-1  
H18-2 H18-2  
H18-3 H18-3  
H18-3 H18-3  
J08-2 J08-2  
M01

1 H18-1  
H18-3

2 H18-2  
H18-2  
H18-3  
H18-3  
M01

3 Slick H15 together as per the second floor wall lamp

4 H07-4

5 Take the H07 out before you make it

6 H12:3cm  
J15  
Put J12 through J15

7 H07-4  
J15  
Tie J15 with wire J12 as shown

8 H07-4

9 K13  
K14  
K14

10 As shown, glue the chandelier

**Bathroom chandelier**

1 H12:3cm  
J15  
Put J12 through J15

2 H07-4  
J15  
Tie J15 with wire J12 as shown

3 H07-4

4 K13  
K14  
K14

5 As shown, glue the chandelier

**Chandelier**

Before making, remove the H18

H18-4  
H18-5  
H18-6  
H18-6  
A24-1  
M01  
J15  
J15  
J12:3cm  
J12:3cm

6

1 A24-1  
H18-4  
Wrap the H18-4 with the A24-1

2

3 H18-4

4 H18-5  
H18-5  
H18-6  
(need 8 pieces)

5 H18-5  
H18-5  
H18-6

6

7

8 H12:3cm  
J15  
Put J12 through J15

9 M01  
Tie wire J12 to M01 as shown

10 (need 2 pieces)

**Outdoor chandelier**

Before making, remove the H15

H15-5  
H15-6  
A24-2  
H15-6  
M01  
H17

1 H15-5  
H15-6

2 H15-5

3 H15-5  
H15-5  
H15-5  
H15-5

4 H17

5 M01  
Go through led light M01

6

7 A24-2

8 Glue A24-2 as shown

9

**Outdoor floor lamp**

Before making, first cut out H15 and J08 according to the template paper

H15-7 H15-7  
H15-8 H15-8  
H15-9 H15-9  
H15-10 H15-10  
H15-12 H15-12  
H15-13 H15-13  
J08-3 J08-3  
J08-3 J08-3  
H15-11  
M01  
M01

1 7mm 7mm 7mm 7mm  
J08-3

2 J08-3  
H15-13  
Wrap H15-13 with J08-3

3

4 H15-12  
H15-11

5 H15-7

6 H15-8

7

8 H15-8

9 H15-7

7

10	11	12	13	14	15
Wall cabinet		1	2	3	4
5	6	7	8	9	
6					
7					
8					
9					
10					
11					
12					
13					
14					
15					
16					
17					
18					
19					
20					
21					
22					
23					
24					
25					
26					
27					
28					
29					
30					
31					
32					
33					
34					
35					
36					
37					
38					
39					
40					
41					
42					
43					
44					
45					
46					
47					
48					
49					
50					
51					
52					
53					
54					
55					
56					
57					
58					
59					
60					
61					
62					
63					
64					
65					
66					
67					
68					
69					
70					
71					
72					
73					
74					
75					
76					
77					
78					
79					
80					
81					
82					
83					
84					
85					
86					
87					
88					
89					
90					
91					
92					
93					
94					
95					
96					
97					
98					
99					
100					

7	8	9	10	11	12
13	14	15	16	17	18
Mirror	1	2	3	4	5
Outdoor small wall lamp	1	2	3	4	5
Outdoor large wall lamp	1	2	3	4	5
6	7	8	9	10	11
12	13	14	15	16	17
18	19	20	21	22	23
24	25	26	27	28	29
30	31	32	33	34	35
36	37	38	39	40	41
42	43	44	45	46	47
48	49	50	51	52	53
54	55	56	57	58	59
60	61	62	63	64	65
66	67	68	69	70	71
72	73	74	75	76	77
78	79	80	81	82	83
84	85	86	87	88	89
90	91	92	93	94	95
96	97	98	99	100	

**1** Outer frame assembly  
A02  
G17  
Glue G17 as shown

**2** Living room wall light  
Attach the living room wall lamp as shown

**3** Bathroom wall light  
As shown, attach the bathroom wall lamp and pass the lamp wire through panel A02

**4** Second floor wall light  
As shown, glue the wall lamp on the second floor

**5** Wall cabinet  
Glue the wall cabinet as shown

**6** Range hood  
Attach the range hood as shown

**7** Mirror  
Glue the mirror as shown

**8** Bathroom cabinet  
As shown in figure bathroom cabinet

**9** A24-10  
B01  
As shown, glue the printing paper to B01

**10**

**11** B01  
Cut off the excess printing paper

**12** B02  
Glue the B02

**13** E09

**14** E10

**15** E12

**16** Horse head wall  
A01  
As shown, glue the horse head wall

**17** A02  
As shown, glue A02

**18** B01  
As shown, glue B01

**19** B20  
As shown, glue B20 to the reference position of A01

**20** B20

10

**21** A24-11  
A10  
As shown, glue the printing paper to A10

**22** A10

**23** A24-12  
A11  
As shown, glue the printing paper to A11 (Note: A11 is aligned with the top of the printing paper)

**24** A24-12  
A11  
Wrap the edges

**25** A10  
A11  
As shown, glue A10 and A11

**26** A03(Back)  
B21  
B21  
As shown, glue B21 to the back of A03

**27** A03

**28** L09  
Cut L09 and glue the picture

**29** L04  
Glue the pebbles on at will

**30** A06  
Glue on the A06

**Staircase**

Before making, cut out A20

A24-13  
A24-13  
A24-13  
A24-13  
A24-13  
A24-13  
A24-13  
A24-13  
A24-14

K09  
K14  
K14  
C07

C08  
C09  
C10  
C12  
C12  
C12  
A20-1  
A20-1  
A20-1  
A20-1  
A20-1  
A20-1  
A20-3  
C13  
C11  
A24-16  
A24-15  
A24-17

**1** A24-13  
A20-1  
As shown, glue the printing paper to A20-1 (Note: top left corner aligned)

**2** Wrap the sides

**3**

**4** A20-1  
(need 7 pieces)

**5** A24-14  
A20-3  
As shown, glue the printing paper to A20-3 (Note: top left corner aligned)

**6** Wrap the sides

**7** A20-3

**8** (need 2 pieces)  
K14  
Cut K14 in half as shown (A total of 4 halves, reserve one spare)

**9** Half of K14  
Half of K14  
C07  
Glue C08 on C07

**10** C08  
C07

**11** C11

**12** C10

11

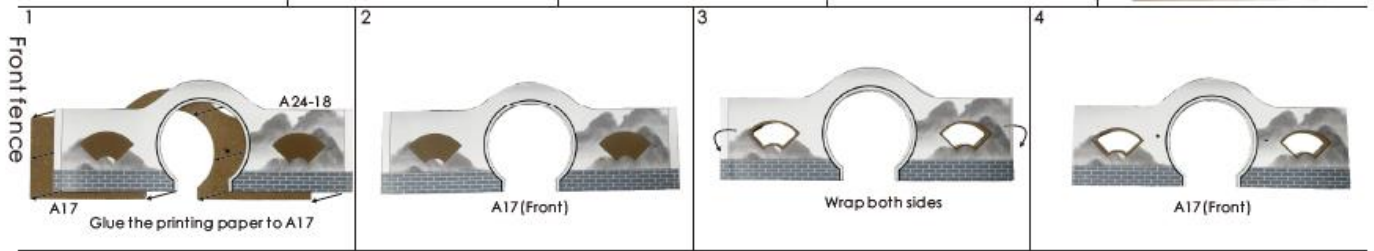
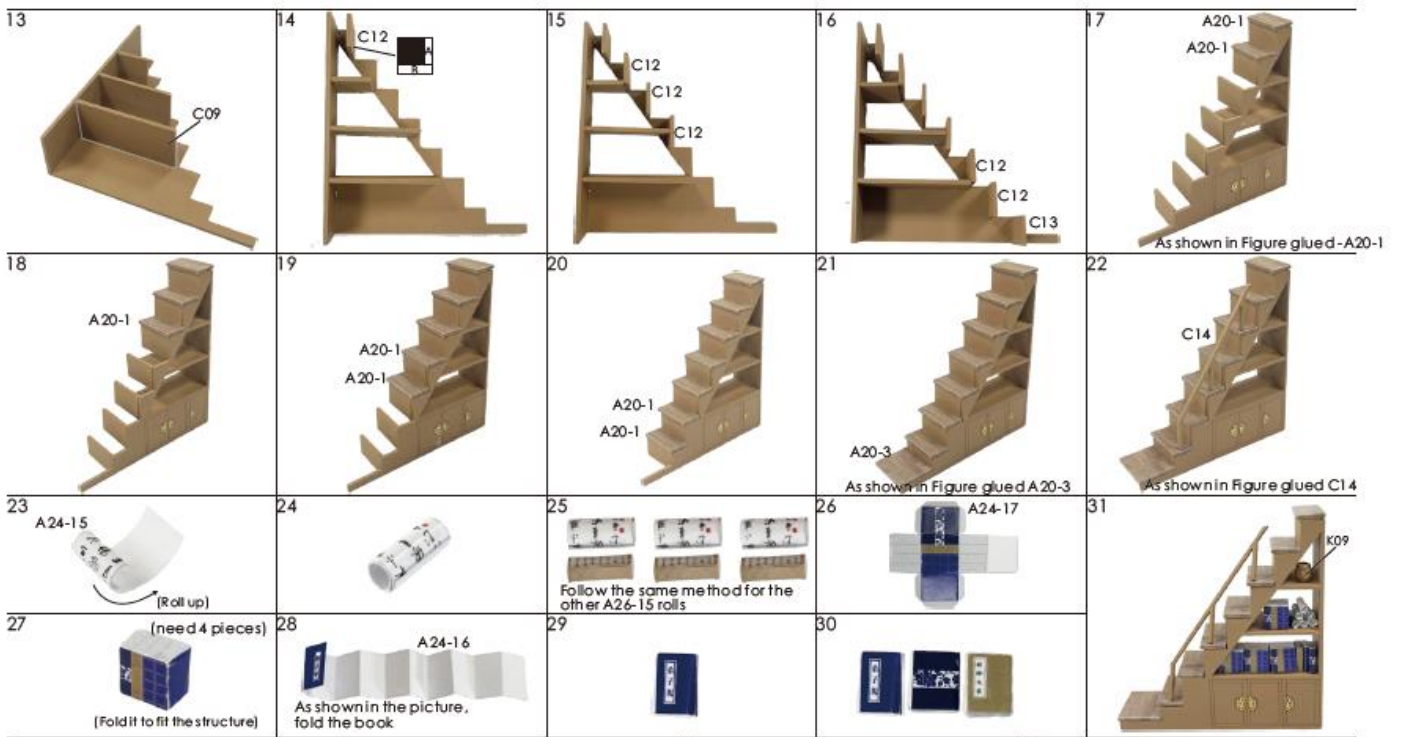

12

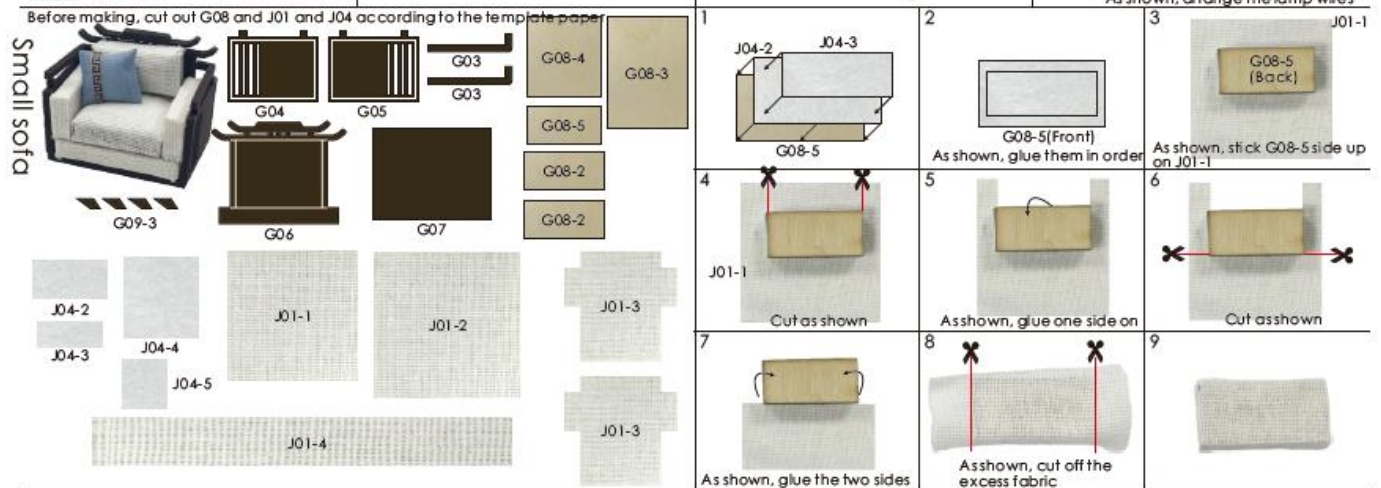
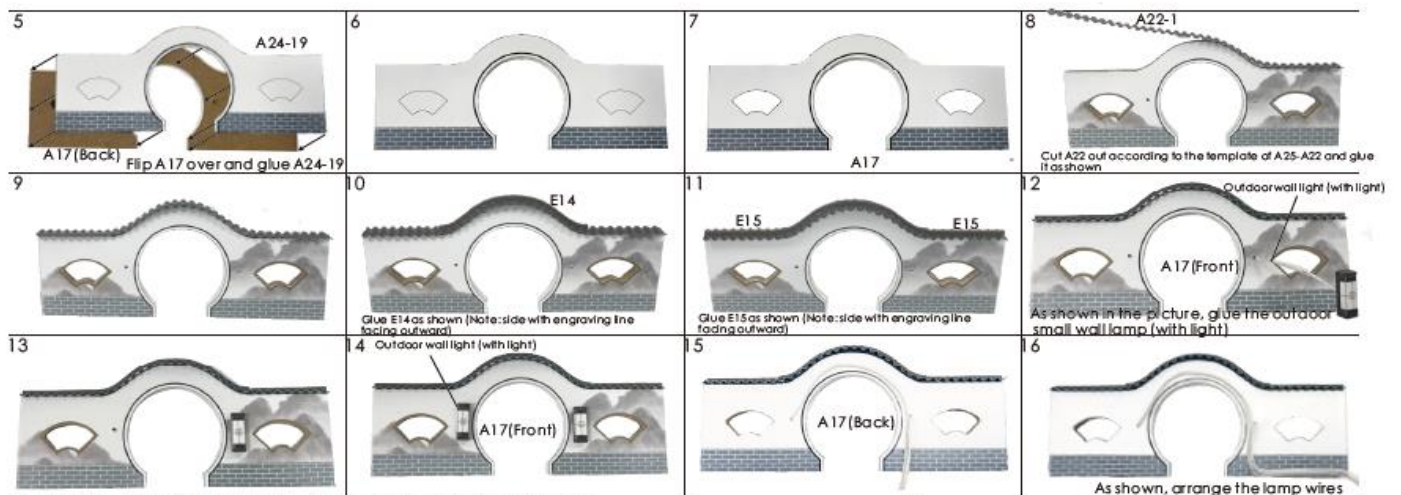

13

10	11	12	13	14	15
G08-5	J01-3 G08-2	As shown, glue the two sides	As shown, glue one side on	Wrap G08-2 as shown	G08-2 (need 2 pieces)
16	17	18	19	20	21
G08-3 J01-4 Glue G08-3 to J01-4 as shown	G08-3 J01-4	As shown, cut the fabric (both sides are needed)	As shown, cut the fabric (both sides are needed)	As shown, glue the fabric (both sides are needed)	J04-5 J04-4 G08-4
22	23	24	25	26	27
As shown, glue them in order	G08-4 (Front)	As shown, glue the two sides	As shown, cut the fabric	As shown, glue the two sides	G08-4
28	29	30	31	32	33
G05 G07	G06	G06	G06	G03	G03
34	35	36	37	38	39
G09-3 (bottom) G09-3 G09-3 G09-3 Glue G09-3 as shown	G08-3	G08-2	G08-2	G08-5 2.3cm G08-4	G08-5
Before making, cut out J02 and J03 according to the template paper					
Pillow					
A24-20 A24-21					
J02-1 J02-1 J03-1 J03-1					
J06					
J02-1 Fold in 5mm					
Stick as shown					

3	4	5	6	7	8
2cm 2cm Stick as shown	Glue the gap on one side	Tuck cotton into the gap in the pillow	Glue the notch	Glue the printing paper to the pillow	Do the same for the other pillows
Before making, first cut out G08 and J01 and J04 according to template paper					
Large sofa					
G04 G05 G03 G09-3 G08-1 G08-1 G08-2 G08-2 G08-2 G08-2					
G01 G02					
G08-8					
J04-6 J04-6 J04-7 J04-7 J04-8 J04-8 J04-9 J04-9					
J01-5 J01-5 J01-6 J01-6 J01-7 J01-7					
J01-3					
4	5	6	7	8	9
J01-5 Cut as shown	As shown, glue one side on	Cut as shown	As shown, glue the two sides	As shown, cut off the excess fabric	J01-5
10	11	12	13	14	15
G08-2 (need 2 pieces)	J01-3 G08-2	As shown, glue the two sides	As shown, glue one side on	Wrap G08-2 as shown	J01-3 (need 2 pieces)



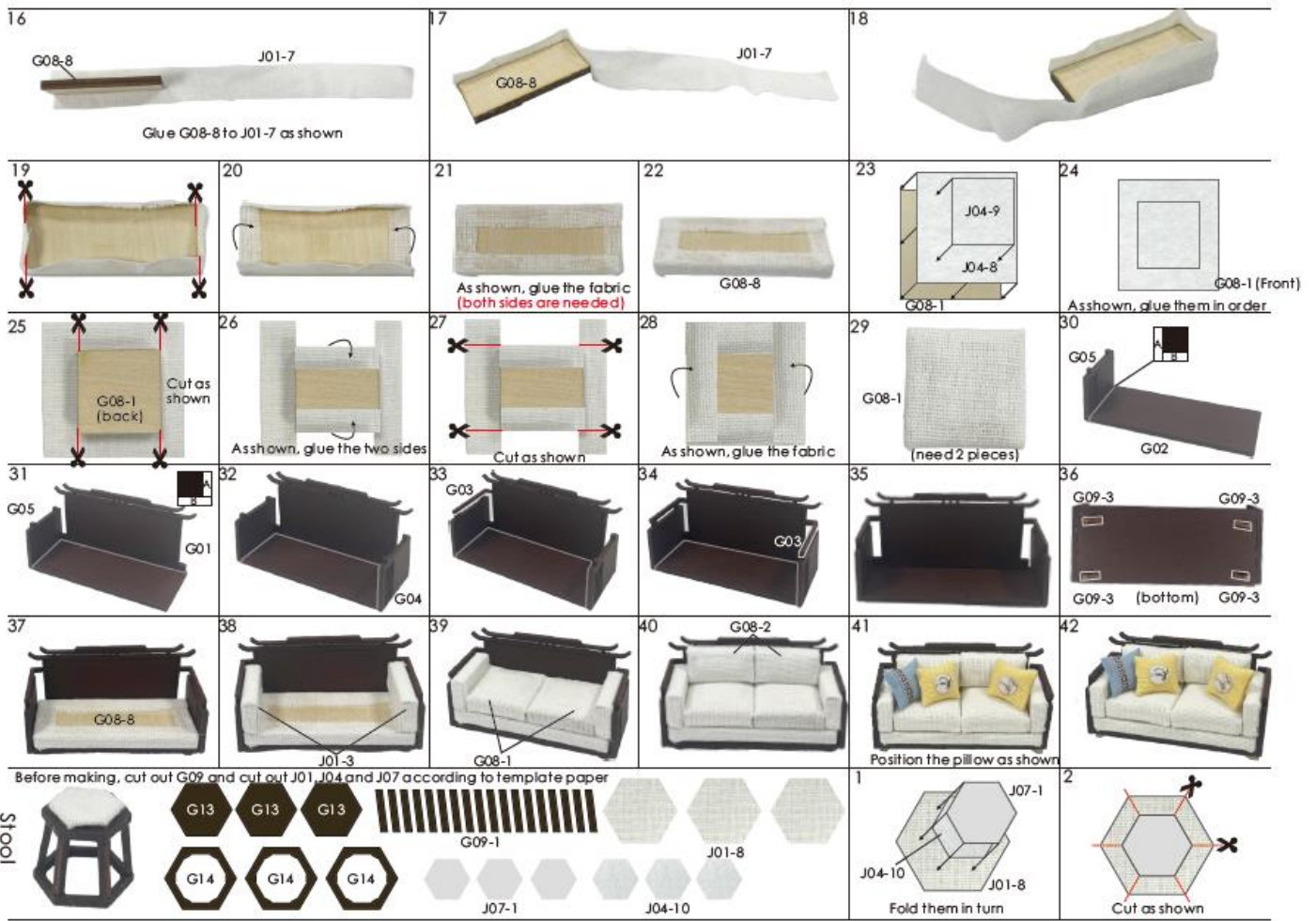

16

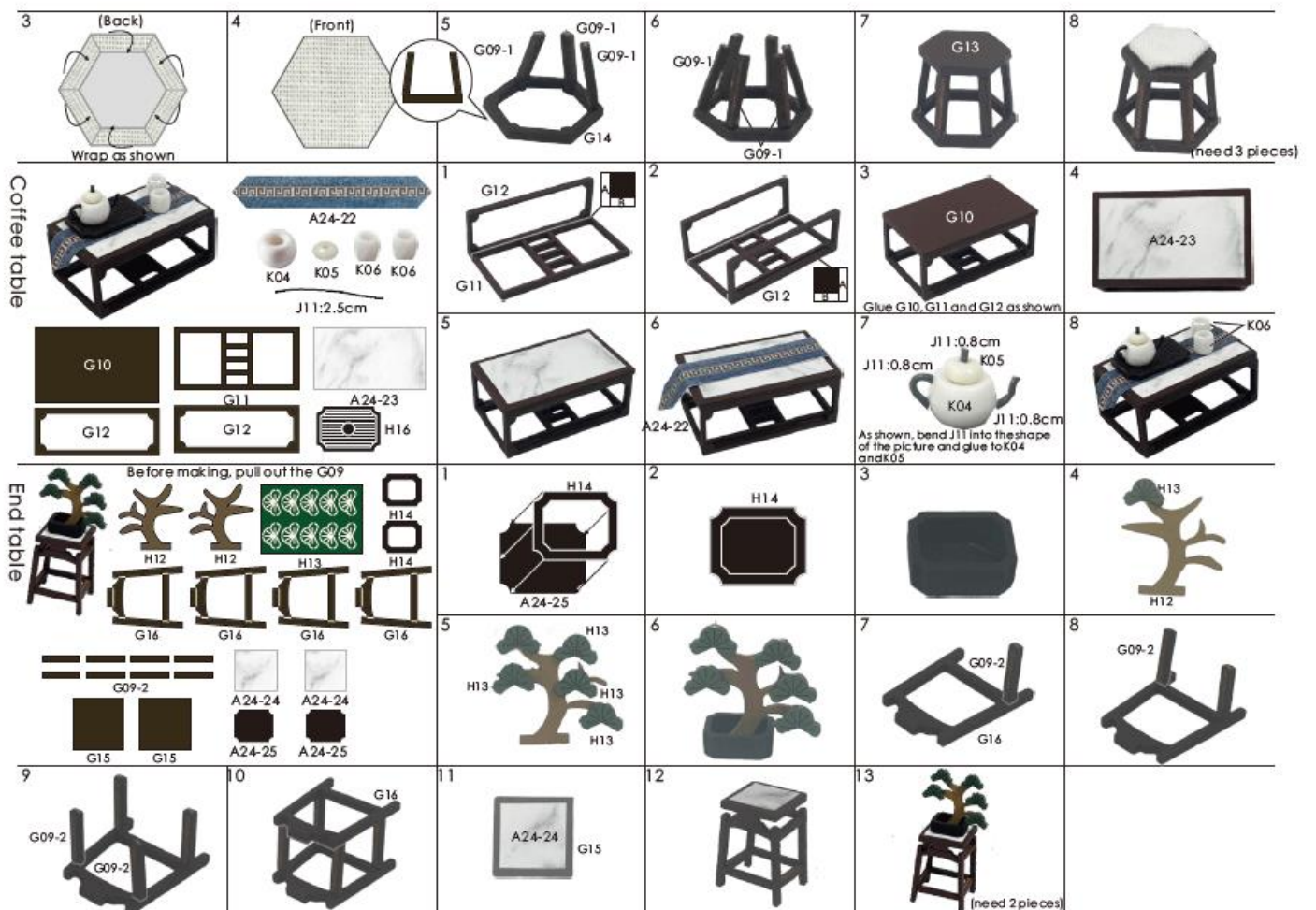

17



Before making, first cut out A20 and cut out J01, J02, J03 and J07 according to template paper



18

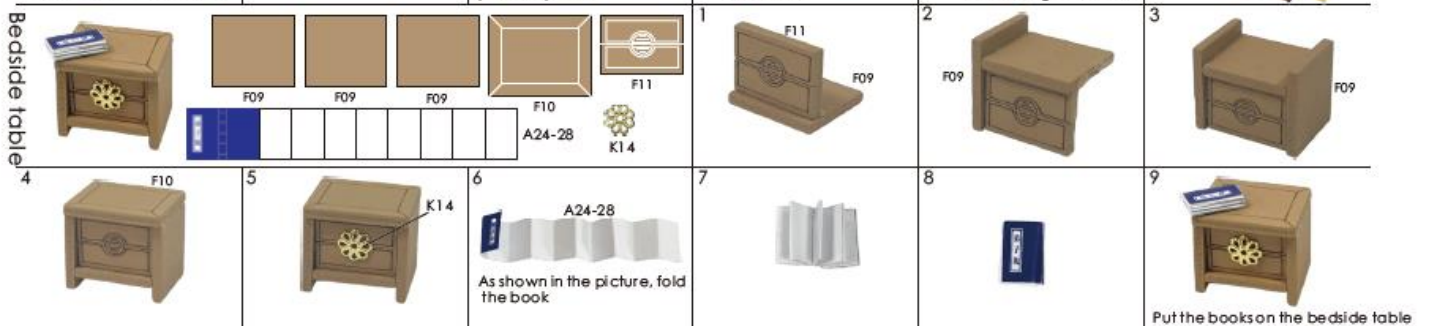
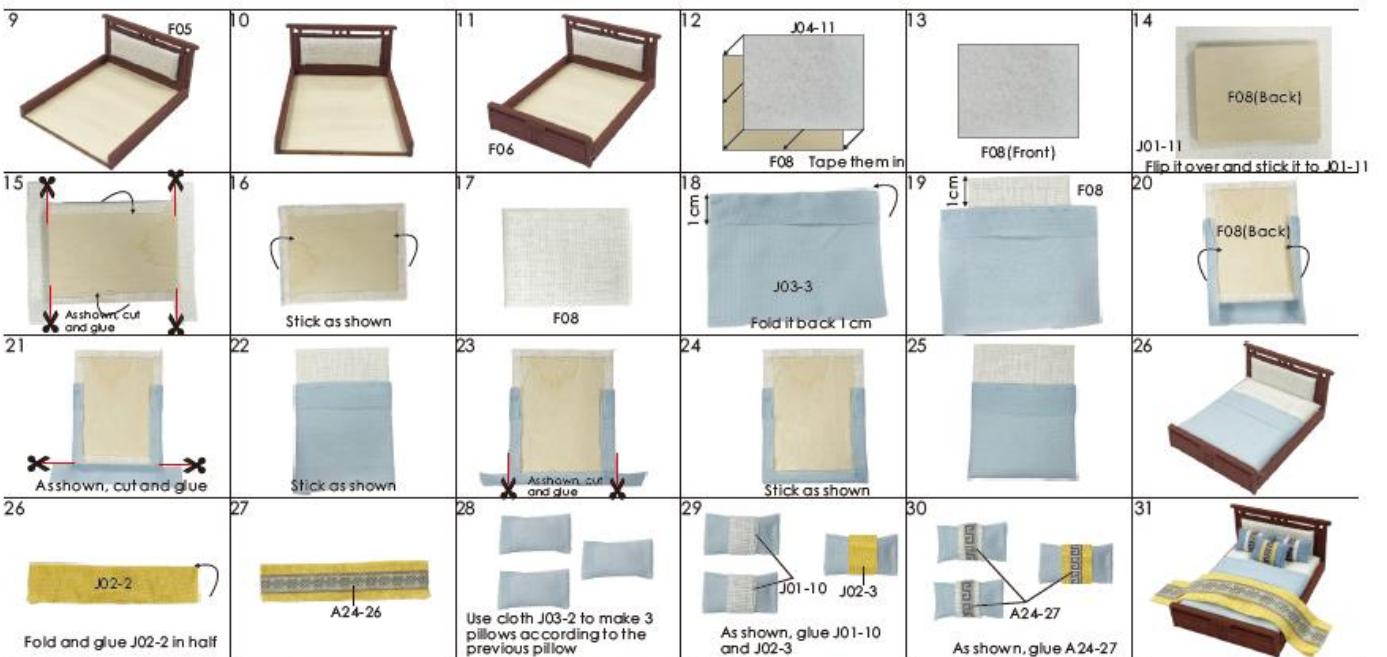

19

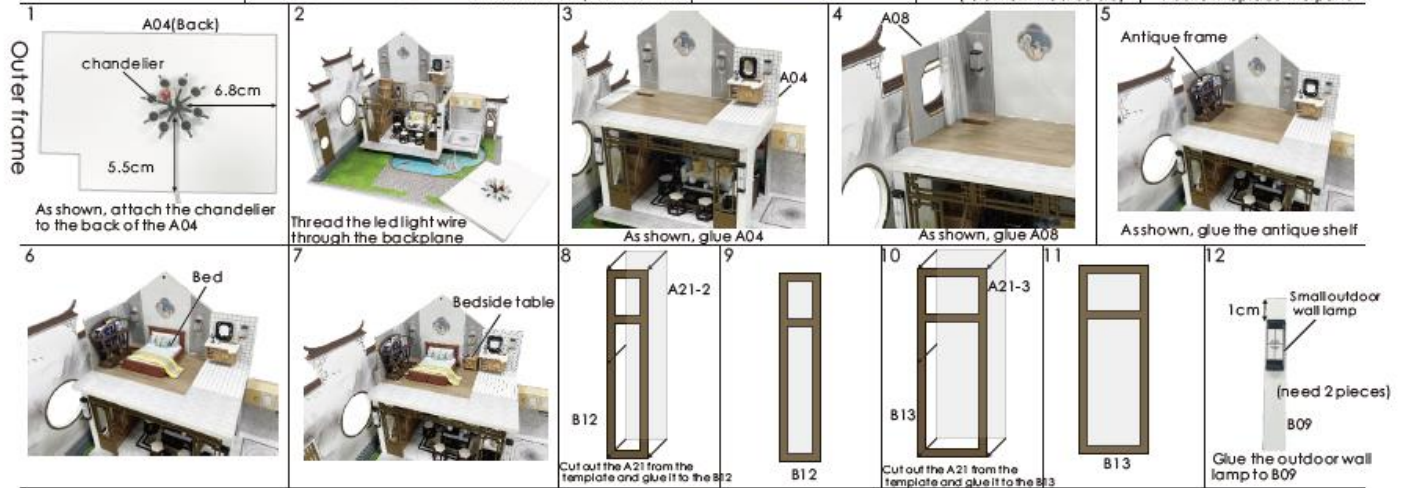
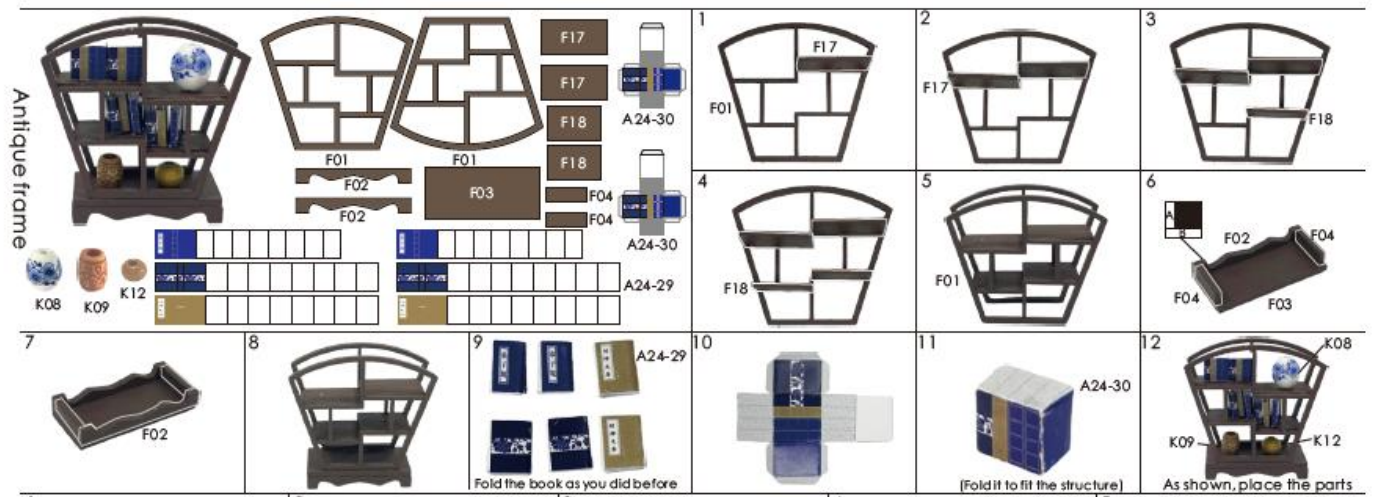

20

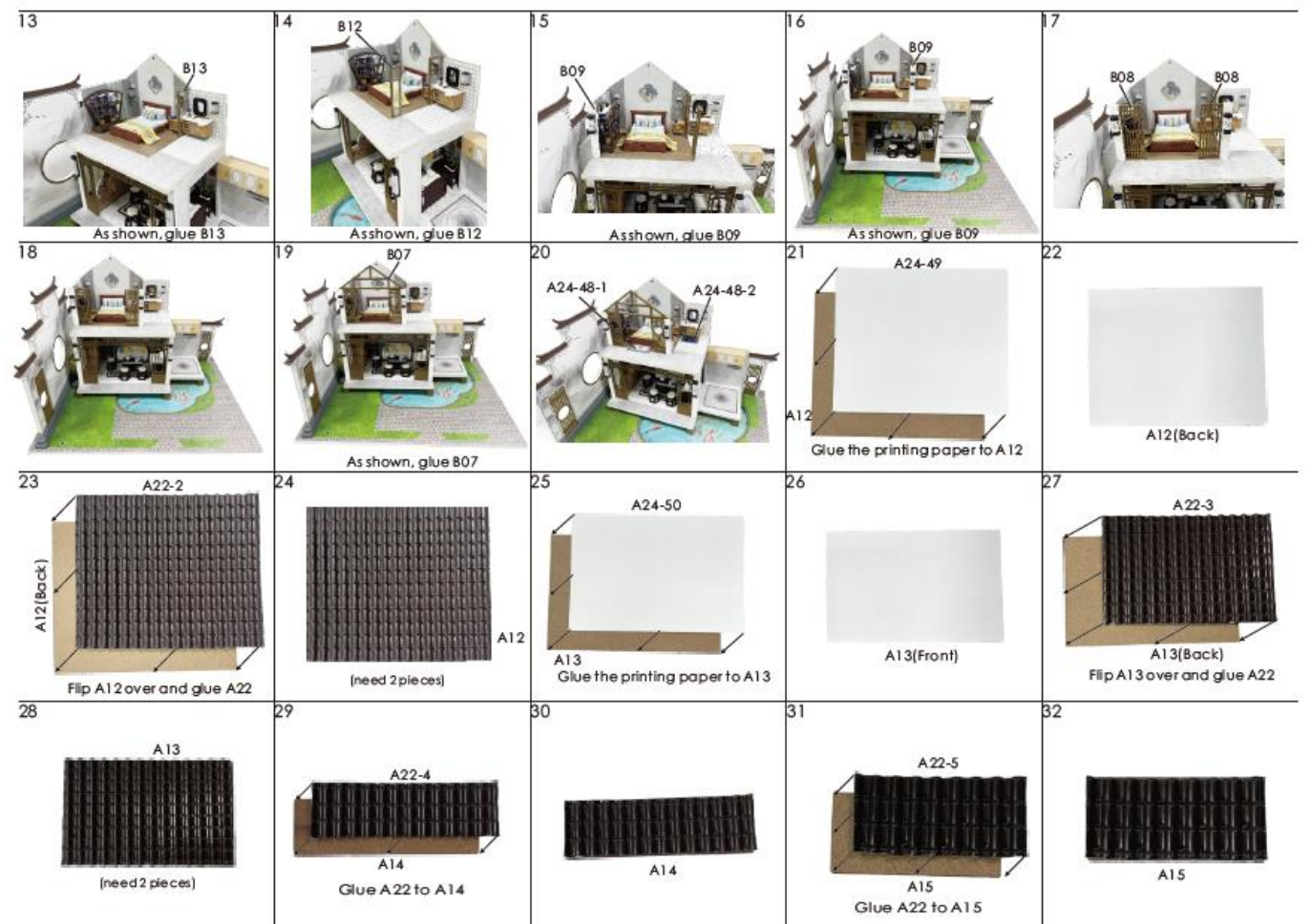

21

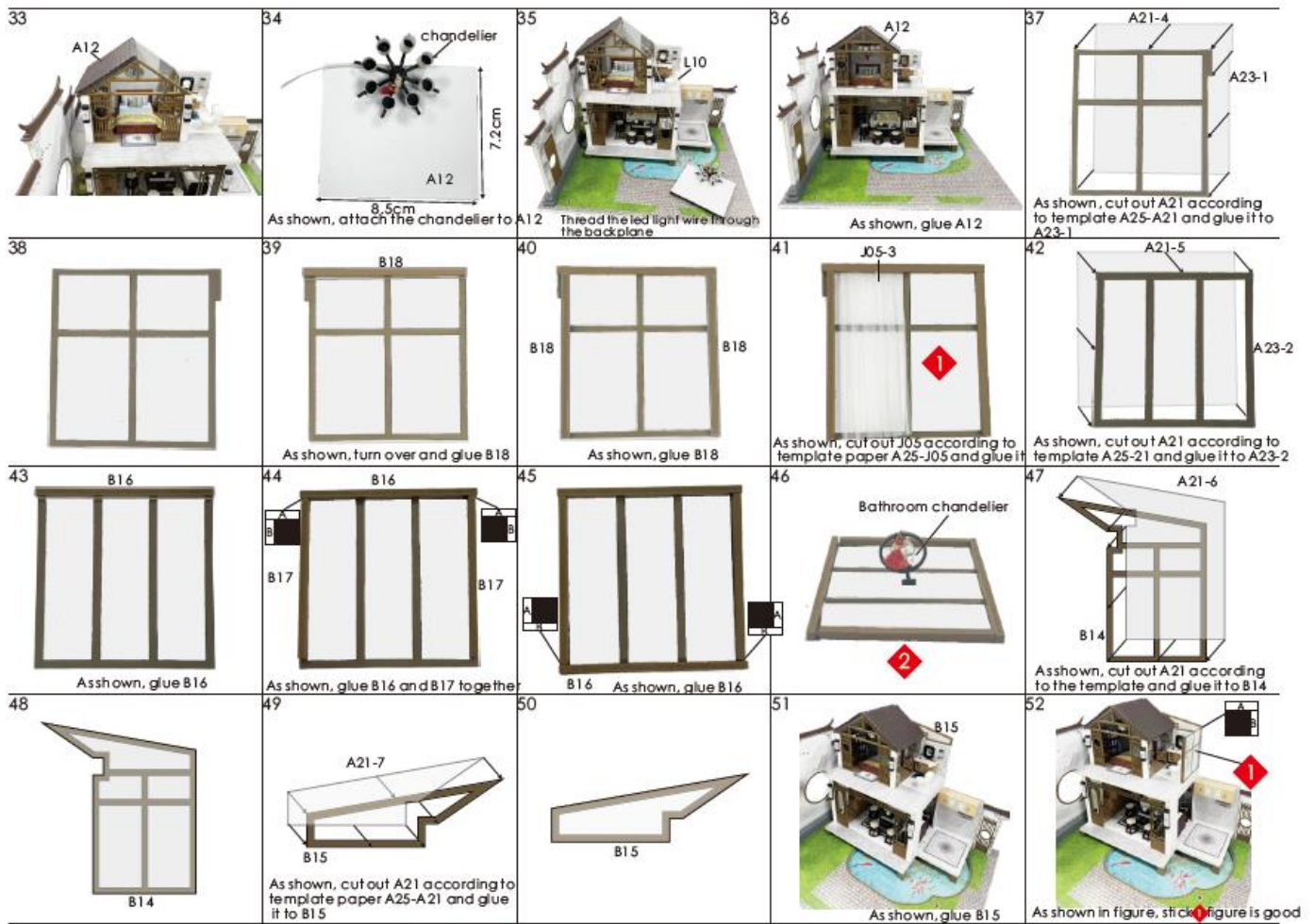

22



23



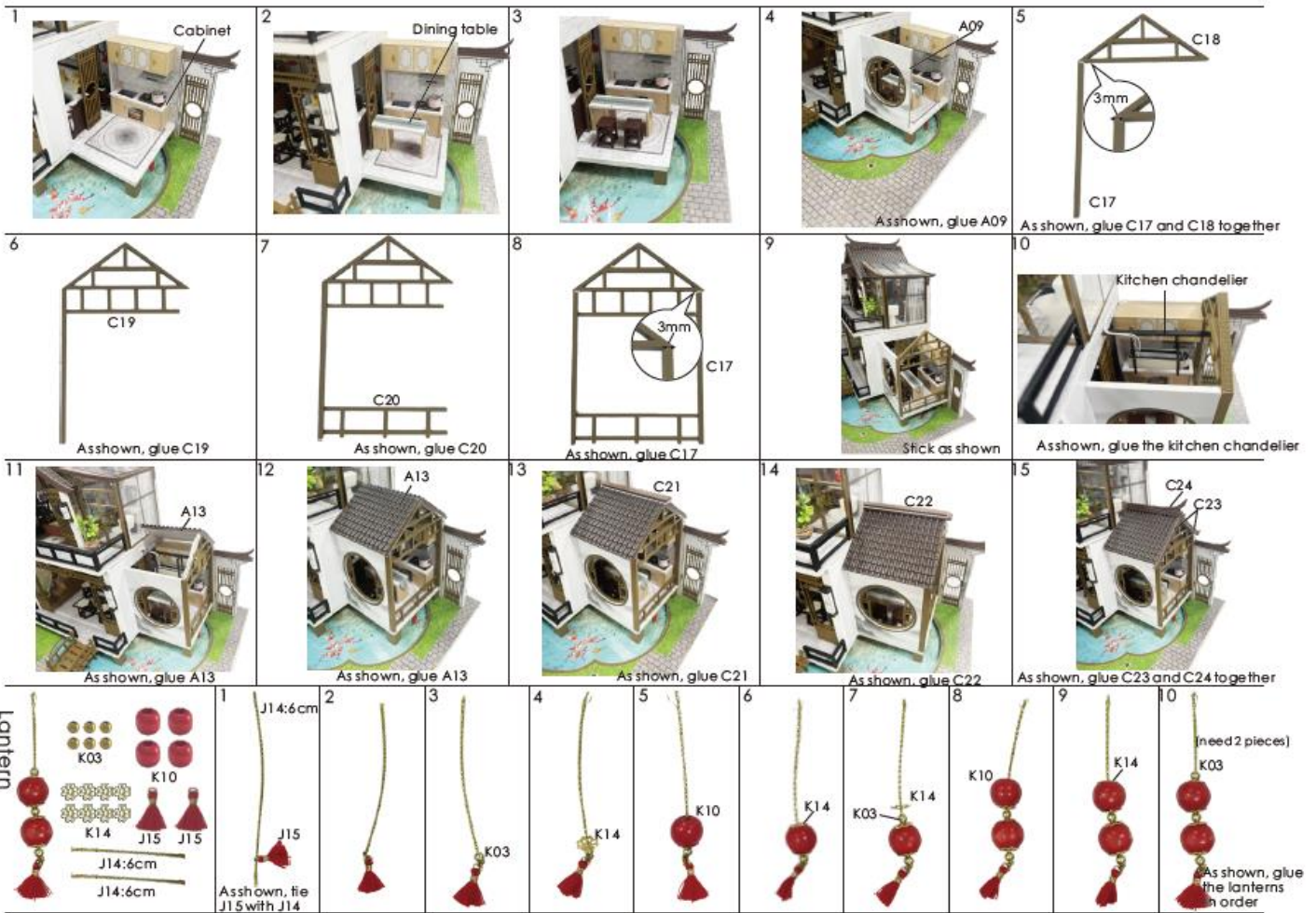

26

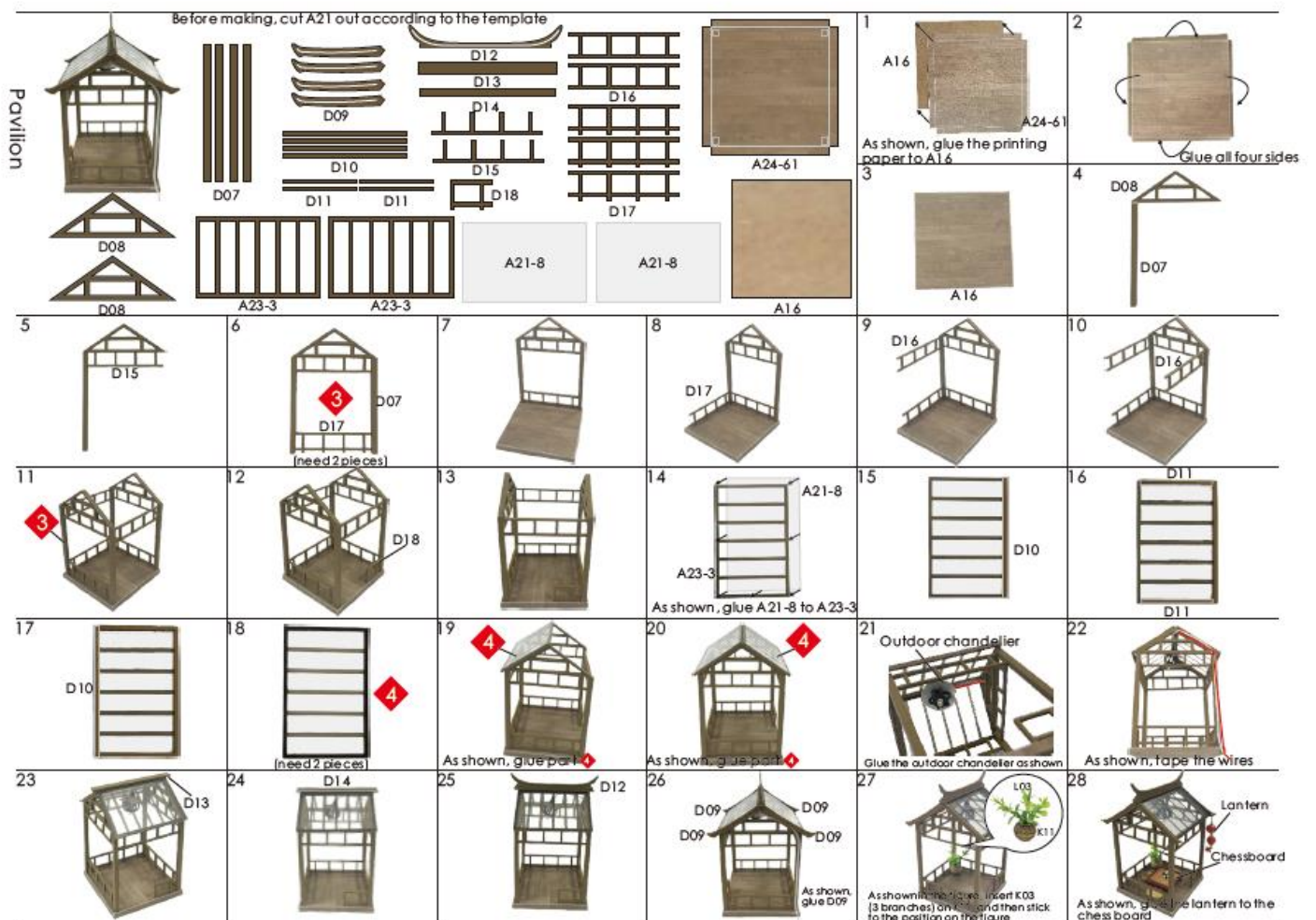

27

**Small bridge**

1 As shown, glue the lantern

2 As shown, glue L08

3 As shown, glue the pavilion in place

4 As shown, glue the outdoor floor lamp

5 As shown, glue the outdoor floor lamp

6 As shown, glue the outdoor floor lamp

7 As shown, glue the fence in front of the door

8 Glue the light line according to the red dotted line

9 Insert the L05 into the hole in the floor

10 Cut L08 2 sections and glue as shown

11 Cut L08 2 sections and glue as shown

12 A24-62  
Cut the L02 figure and glue it on

13 J10-1  
Cut out J10 according to the template paper and glue it

14 J10-2  
Glue J10 as shown

15 Roll it up to form a flower

16 L01  
(need 3 pieces)  
Cut out a flower core L01 and glue it in the middle

17 As shown, glue the lotus

18 Insert the L06 into the hole in the floor

28

19 As shown, place L04 randomly under the tree

20 Glue L03 and L08 as shown

21 As shown, glue A15

22 As shown, glue E13

23 As shown, glue L09

24 L07

**Disclaimer: This wire cannot be plugged into the output socket**

**Installation Of Battery Box**

- Can use two AAA batteries
- The positive and negative poles of the battery are aligned and the battery is installed
- Non-rechargeable batteries, cannot be charged
- Rechargeable batteries can only be charged under adult supervision
- Rechargeable batteries should be removed from the toy before charging
- Different types of batteries or old and new batteries cannot be mixed
- Batteries should be inserted with correct polarity
- Exhausted batteries should be removed from the toy
- The power terminal must not be short-circuited

1 Cut the wire to the same size

2 Peel the rubber off the end of the light wire and wrap the same color light wire together

3 Connect the gray line of the led light with the red line of the battery box, and the white line with the black line of the battery box











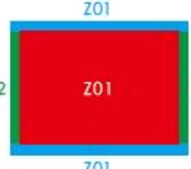
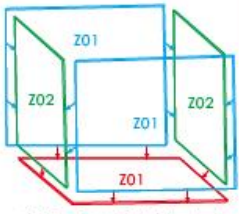

4 Finally, wrap the exposed wires with adhesive paper M04

5

29

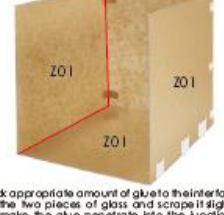
# Installation of dust cover

**Dust cover**  
(Upgrade version accessories need to be purchased separately)

 <p>ratio:1:10 Z01 plexiglass (transparent) 32*25*0.18cm (3 pieces)</p>	 <p>ratio:1:10 Z02 plexiglass (transparent) 25*24.64*0.18cm (2 pieces)</p>	<p>1</p>  <p>stick Z01 and Z02 on Z01</p>	<p>2</p>  <p>stick five pieces of plexiglass dust cover as shown</p>	<p>3</p>  <p>Ripped one side of kraft paper, leaving one side of kraft paper</p> <p>Take out the plexiglass and tear off the kraft paper with text on each piece of plexiglass</p>
<p>4</p>  <p>The kraft paper that has been ripped off faces inward, and the kraft paper that has not been ripped out faces outward.</p>	<p>5</p>  <p>Use M03 to fix the junction of two pieces of plexiglass. (use transparent tape to replace M03)</p>	<p>6</p>  <p>The junction of every two pieces of plexiglass needs to be fixed with M03 (to prevent the plexiglass falling off)</p>	<p>7</p>  <p>stick appropriate amount of glue to the interface of the two pieces of glass and scrape it slightly to make the glue penetrate into the junction of the two pieces of glass (the red line is the plexiglass interface)</p>	<p>8</p>  <p>The junction of two pieces of plexiglass needs to be fixed with M03 (to prevent the plexiglass falling off)</p>
<p>9</p>  <p>stick appropriate amount of glue to the interface of the two pieces of glass and scrape it slightly to make the glue penetrate into the junction of the two pieces of glass (the red line is the plexiglass interface)</p>	<p>10</p>  <p>The junction of two pieces of plexiglass needs to be fixed with M03 (to prevent the plexiglass falling off)</p>	<p>11</p>  <p>stick appropriate amount of glue to the interface of the two pieces of glass and scrape it slightly to make the glue penetrate into the junction of the two pieces of glass (the red line is the plexiglass interface)</p>	<p>12</p>  <p>The dust cover need to be glued 8 interfaces</p>	<p>13</p>  <p>Leave it for 1 hour. After the glue dries out, tear off a layer of kraft paper outside the plexiglass</p>