

秋の追忆 杂货店

M914



Memories Of Autumn Grocery Store

M914 Instruction manual

NOTICE OF ASSEMBLE

Tips for assembling

1. Pictures shown on the package may be slightly different from the actual product.
2. All the materials are taken in the operation step, put the remaining materials back into the original pocket until the installation is completed. (Avoid material loss during installation)
3. The dimensions indicated in the step diagram are "cm".
4. If there have template paper material, please cut the material according to the template to avoid mistakes..
5. According to the part rule example at the bottom of this page, refer to the part on the part number drawing, find the material object and compare with the material list, confirm and install. (Wooden parts only)
6. Glue should not be applied too much, so as not to dry longer, overflow will affect the effect of the finished product.
7. Part shapes may differ from the photographs depending on the production batch

Testing on LED function

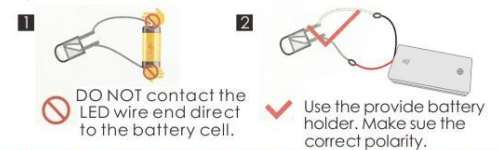

Be sure to test the LED lights before making the lighting, note that the LED white wire to the negative, gray wire to the positive reference to the following figure operation test.



Product comes with tool:

- | | | | | | | |
|---|--|---|---|--|---|--|
| 1  | 2  | 3  | 4  | 5  | 6  | 7  |
| White glue: It dries slowly and can paste materials firmly without trace. Can be used to paste wallpaper and printed paper. | Ruler: For measuring materials to identify the number of materials so as to enhance work efficiency. | Scissors: Can be used to cut printed paper, cloth, etc. | Cutter knife: For peeling off power wire skin and cutting off materials. | Alcohol gel: It dries fast and can paste materials firmly, but may leave some trace. Can be used to paste small metal materials and small components of furniture. | Tweezers: For holding small materials and rolling up iron wire. | Screw Driver: For fixing screws, mostly can be used to install doors and music components. |

Bring your own tools:

- | | |
|---|---|
| 1  | 2  |
| Drill: Can be used to drill holes in timbers, roll up hard iron wire or fix screws. | Needle-nose pliers: For cutting, bending wire, folding harder material |

How to assemble the battery holder

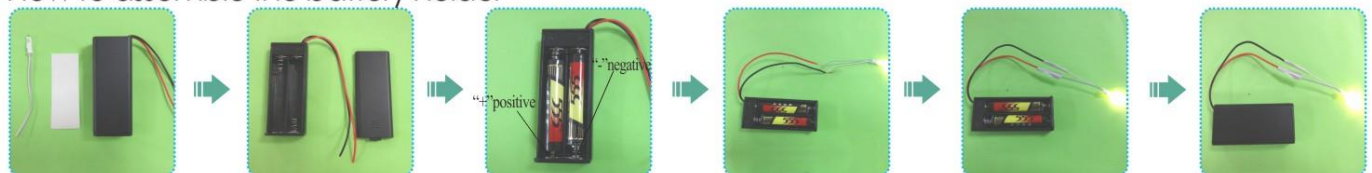

1. Material and tools needed: - Battery holder, LED bulb, tape, screw driver and 2 piece AAA size battery (not provided)
2. Use screw driver and take the lid off from the battery holder.
3. Insert the battery take notes on the polarity.
4. Connect the red wire to grey wire, Connect the black wire to white wire.
5. Wrap the exposed wire with the tapes.
6. Place the box lid and fastness with screw driver.

Example of parts rule:

A01: The parts are directly in the box.; B01: parts in bag B; C01: part in bag C, and so on.
(Note: display the printing paper A09-01 in the step: the printing paper is placed directly in the box, part number is A09-01)

details of miniature kit

| Name | Material package | Name | Material package |
|----------------|---|---------------------------|--|
| printing paper | Bag A-A09 (All printing and template papers are shown on A09 paper, total 4 pieces of A4) | electric pole and lantern | E bag + F bag + printing paper |
| bubble bottle | B bag + printing paper | floor tile | E bag + printing paper |
| tea bag | printing paper | signboard | E bag + printing paper |
| candy jar | F bag + printing paper | sunshade | C bag + printing paper |
| food pot | F bag + printing paper | door | C bag + F bag |
| rice bag | F bag + G bag + printing paper | outer frame | A bag + B bag + G bag + printing paper |
| box | G bag + printing paper | decoration | B bag + printing paper |
| mask | printing paper | battery holder | G bag |
| tea table | D bag + F bag | | |
| seat cushion | D bag + F bag + G bag | | |
| round stool | D bag | | |
| sweets | F bag + G bag | | |
| rice basket | G bag + printing paper + template paper | | |
| gift box | D bag + F bag + printing paper | | |
| cookie bag | printing paper | | |
| book | D bag + F bag + printing paper | | |
| business card | D bag + printing paper | | |
| postbox tube | E bag + printing paper | | |



Welcome to the little DIY world, now come with me

Thumbnail of material list (reference only)



Thumbnail of printing paper & template paper (reference only)



Symbol description used

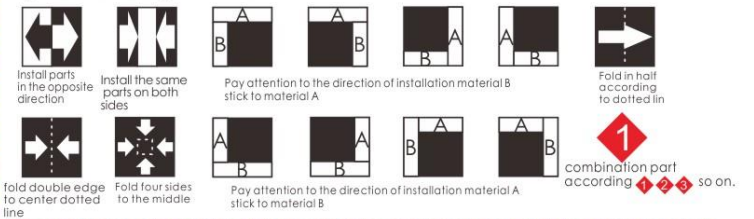

1

Bubble Bottle



Tea Bag

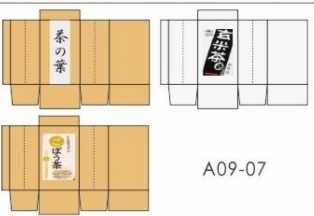

Candy Jar



Food Pot



2





Seat cushion



Before making, cut out 2 pieces of F12 according to the template.



Round Stool

In the same way, 2 pieces are made.

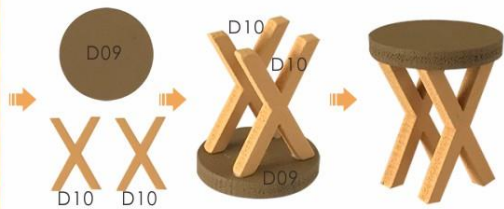

Sweets

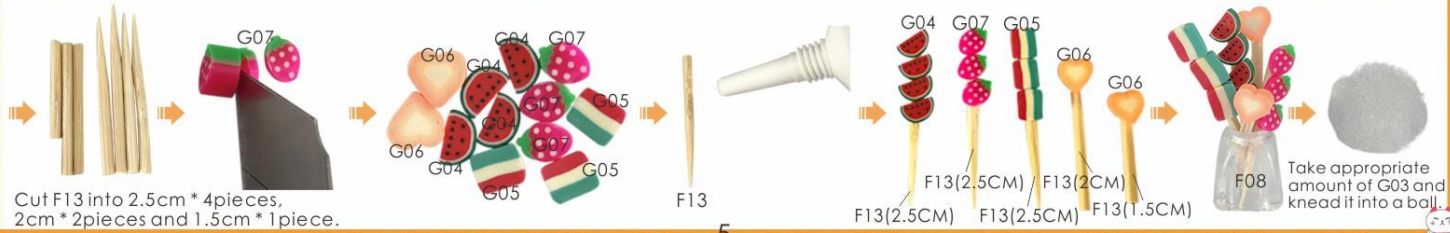
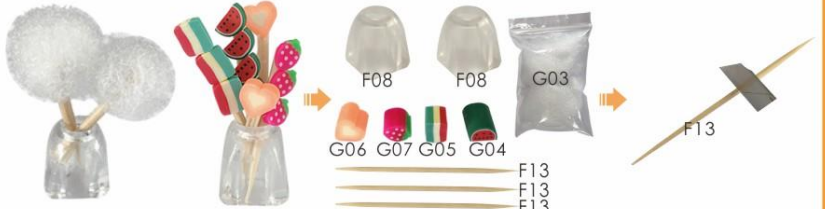

Cut F13 into 2.5cm * 4pieces, 2cm * 2pieces and 1.5cm * 1piece.

Take appropriate amount of G03 and knead it into a ball.



Rice Basket



Before making, cut out the G01 basket on the template paper.

In the same way, 2 pieces are made.



(Use the other strip G01 from the front packing box here.)

Fill the basket with more than half of the G02 (to avoid dropping the G02, you can add some glue inside first)

Cut G01 out by 2.5cm.



Gift Box



Before making, cut out 4 pieces of F15 according to the template.

Tear off the backing paper.



Cookie bag

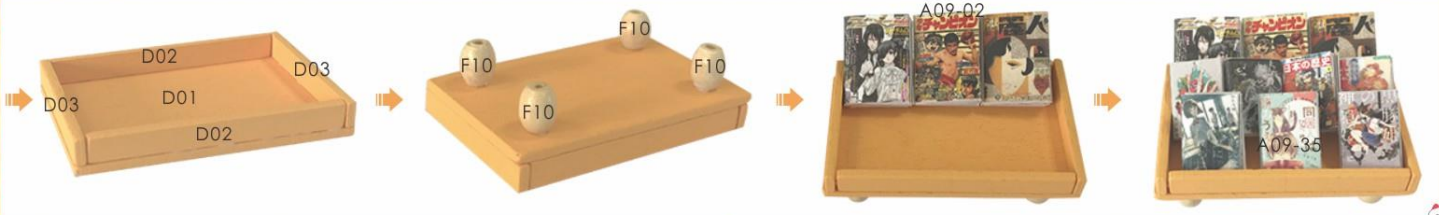
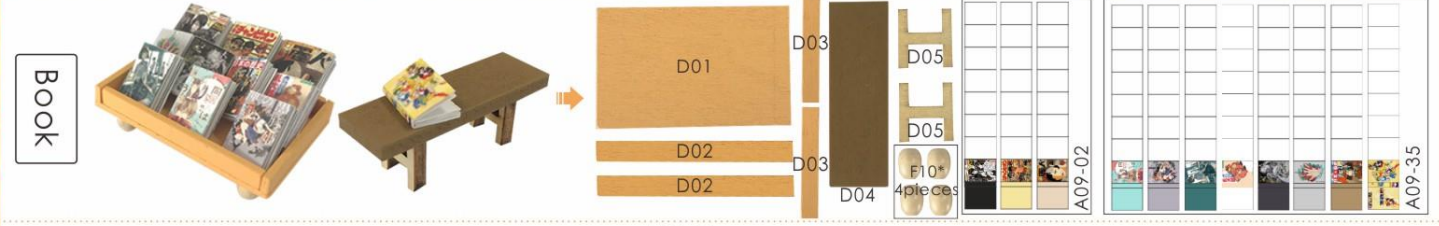

7

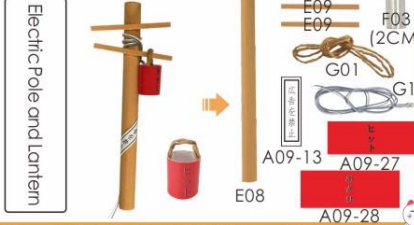
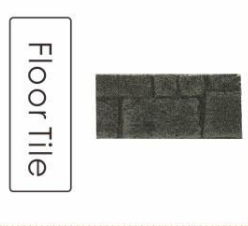
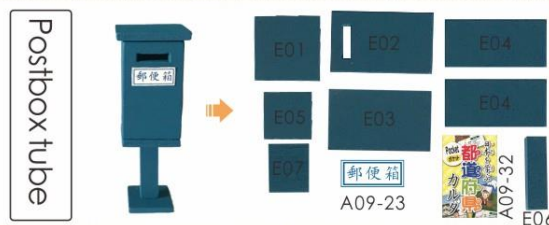

8

A09-27 Cut out 2.5CM from G01 and use it to make small lantern hanging rope; Cut out 3CM to make hanging rope for big lantern.

A09-28 Cut G01 out to 7cm around.

A09-29 (Make two marks with tweezers.)

A09-10 Signboard

A09-11 Signboard

A09-12 Signboard

A09-13 Signboard

A09-14 Signboard

A09-15 Signboard

A09-16 Signboard

A09-17 Signboard

A09-18 Signboard

A09-19 Signboard

A09-20 Roof

A09-21 Roof

A09-22 Roof

A09-23 Roof

A09-24 Roof

A09-25 Roof

A09-26 Roof

A09-27 Roof

A09-28 Roof

A09-29 Roof

A09-30 Roof

A09-31 Roof

A09-32 Roof

A09-33 Roof

A09-34 Roof

A09-35 Roof

A09-36 Roof

A09-37 Roof

A09-38 Roof

A09-39 Roof

A09-40 Sunshade

A09-41 Sunshade

A09-42 Sunshade

A09-43 Sunshade

A09-44 Sunshade

A09-45 Sunshade

A09-46 Sunshade

A09-47 Sunshade

A09-48 Sunshade

A09-49 Sunshade

A09-50 Door

A09-51 Door

A09-52 Door

A09-53 Door

A09-54 Door

A09-55 Door

A09-56 Door

A09-57 Door

A09-58 Door

A09-59 Door

A09-60 Door

A09-61 Door

A09-62 Door

A09-63 Door

A09-64 Door

A09-65 Door

A09-66 Door

A09-67 Door

A09-68 Door

A09-69 Door

A09-70 Door

A09-71 Door

A09-72 Door

A09-73 Door

A09-74 Door

A09-75 Door

A09-76 Door

A09-77 Door

A09-78 Door

A09-79 Door

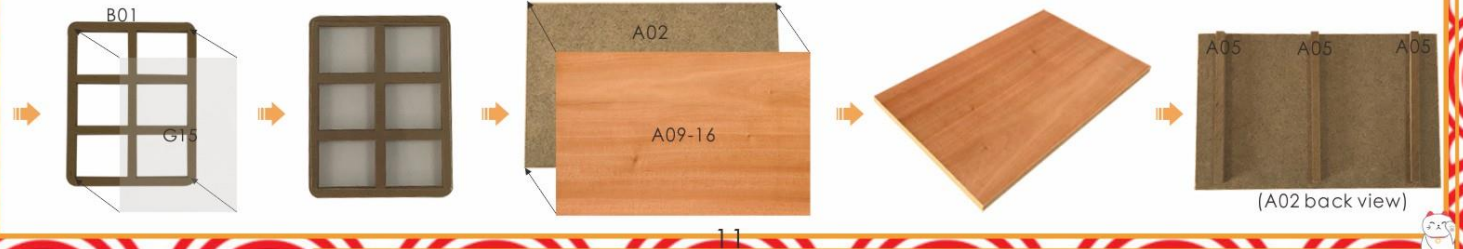
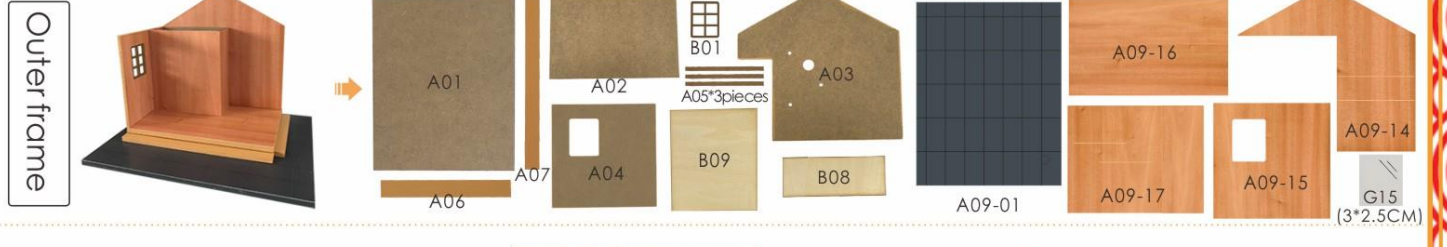
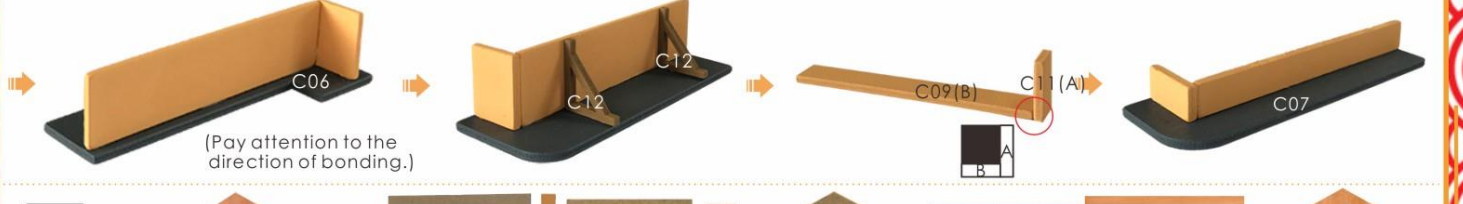
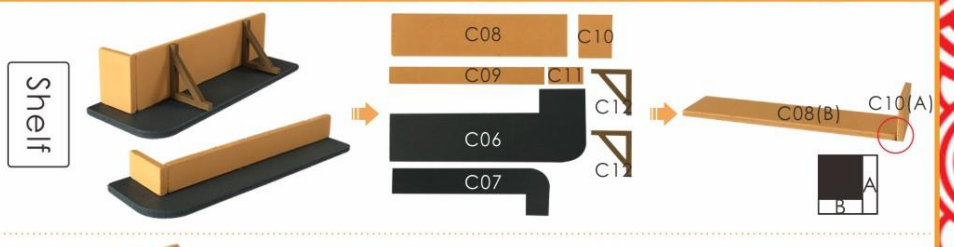
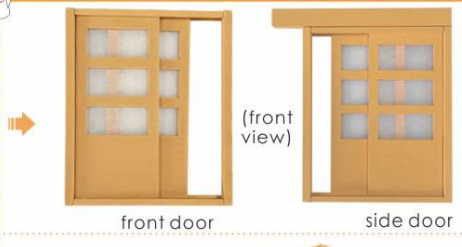

11

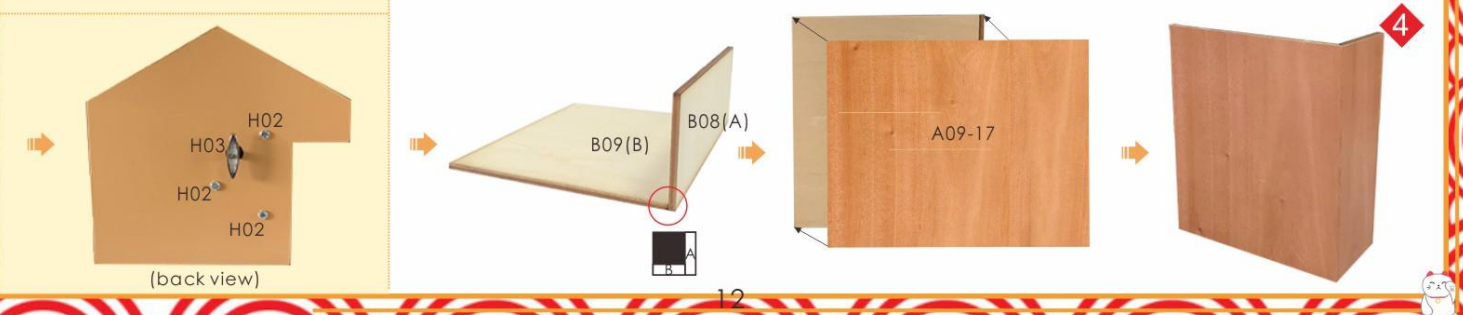
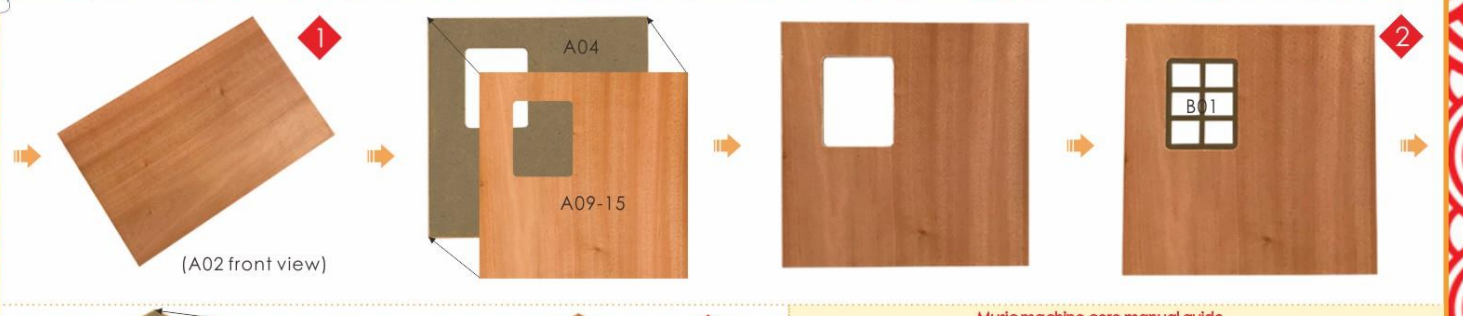

12

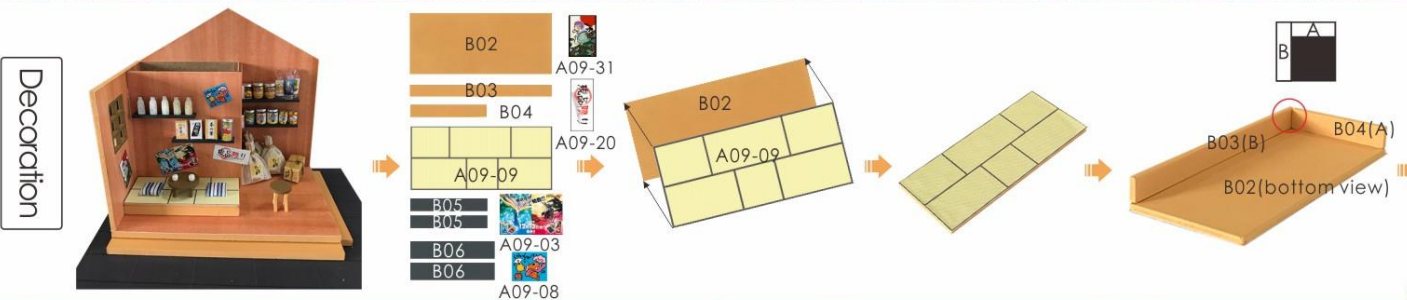
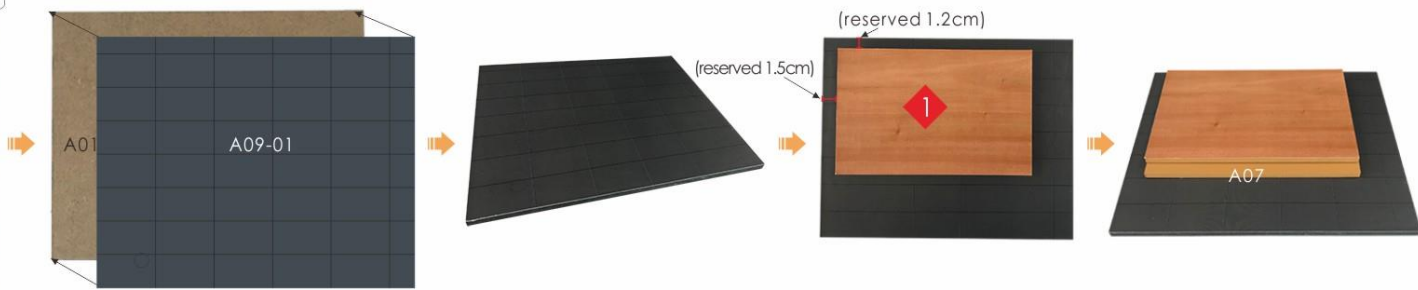

13

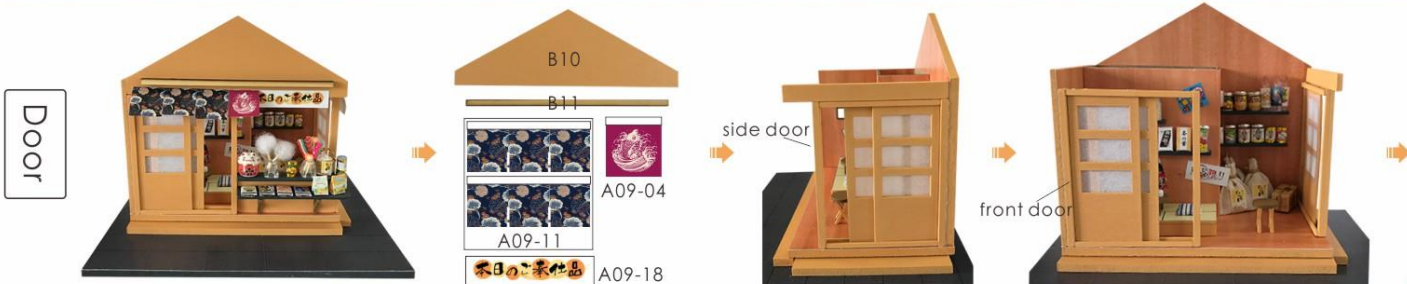

14



15



How to assemble the battery holder

1. Trim all the LED wiring to the same length.
2. Use a craft blade to carefully skim over the plastic to bare the copper wire. Twist the same color wire together.
3. Twist the following wire together:
 - (I) BLACK wire from the battery box with the WHITE wire from LED bulb.
 - (II) RED wire from the battery box with the GREY wire from LED bulb.
4. Roll and seal the duly twist copper with the white tape G13 provided.

Statement: the lamp wires cannot be inserted into the output socket.

- - Can use 7 batteries
- - Please notice the place of anode and cathode when pit in the batteries
- - Rechargeable batteries are not blunt electricity
- - Rechargeable batteries can only be charged under adult supervision
- - Rechargeable batteries should be removed from the toy before charging
- - Different types of batteries cannot mix; Do not mix new batteries in use with semi-used batteries.
- - Run out of battery should be removed from the toy.
- - The power shall not be short circuit.

16



Installation of dust proof cover
 (For updated version, the parts need to be purchased separately)



scale 1:7
 H04 Transparent cover
 16*19*0.15cm (2pieces)



scale 1:7
 H05 Transparent cover
 14.7*16*0.15cm(2pieces)



scale 1:7
 H06 Transparent cover
 15*19*0.15cm(1piece)



1. Tear off kraft paper of each piece of transparent cover.

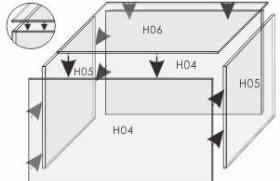

2. Paste H04, H05 and H06 together to complete the dust proof cover as shown.

Attention: Please keep the instruction for future enquires after installation.

| | | | | | | | |
|--|---|---|---|---|--|--|--|
| Bag A | scale 1:7 A01board(dark grey edge) 19*15*0.5(1piece) | scale 1:5 A02board(earthy yellow edge) 14.3*9.2*0.5(1piece) | scale 1:7 A03board(earthy yellow) 14*13.1*0.5(1piece) | scale 1:5 A04board(earthy yellow) 9.2*9.1*0.3(1piece) | scale 1:3 A05board(wood color) 8.8*0.5*0.5(3pieces) | scale 1:3 A06board(earthy yellow) 8.9*1.1*0.5(1piece) | scale 1:5 A07board(earthy yellow) 14.3*1.1*0.5(1piece) |
| A08 corrugated paper (black) 14*14(2pieces) | Bag B | scale 1:2 B01wood(brown) 3.3*2.6*0.3(1piece) | scale 1:3 B02wood(earthy yellow) 7.8*3.5*0.2(1piece) | scale 1:3 B03wood(earthy yellow) 7.8*0.7*0.2(1piece) | scale 1:2 B04wood(earthy yellow) 3.3*0.7*0.2(1piece) | scale 1:2 B05wood(dark grey) 4.5*0.8*0.2(2pieces) | scale 1:2 B06wood(dark grey) 4.7*1.2*0.2(2pieces) |
| scale 1:1 B07wood(wood color) 1.3*0.5*0.2(5pieces) | scale 1:3 B08wood(dark color) 9.1*3.5*0.2(1piece) | scale 1:4 B09wood(wood color) 9.1*7.8*0.2(1piece) | scale 1:5 B10board(earthy yellow) 14*4.9*0.3(1piece) | scale 1:5 B11wood(wood color) 12*0.4*0.5(1piece) | Bag C | scale 1:3 C01wood(earthy yellow) 8.1*3.5*0.15(4pieces) | scale 1:3 C02wood(earthy yellow) 6.9*0.3*0.15(4pieces) |
| scale 1:3 C03wood(earthy yellow) 6.2*0.3*0.15(4pieces) | scale 1:3 C04wood(earthy yellow) 8.2*0.4*0.3(4pieces) | scale 1:3 C05wood(earthy yellow) 8.4*0.9*0.3(1piece) | scale 1:3 C06wood(dark grey) 7.5*2.8*0.2(1piece) | scale 1:3 C07wood(dark grey) 6.7*2*0.2(1piece) | scale 1:3 C08wood(earthy yellow) 6.8*1.7*0.2(1piece) | scale 1:2 C09wood(earthy yellow) 5.9*0.7*0.2(1piece) | scale 1:1 C10wood(earthy yellow) 1.7*1.3*0.2(1piece) |
| scale 1:1 C11wood(earthy yellow) 1.3*0.7*0.2(1piece) | scale 1:1 C12wood(brown) 1.7*1.4*0.2(2pieces) | scale 1:1 C13wood(brown) 2.2*0.8*0.2(4pieces) | Bag D | scale 1:2 D01wood(earthy yellow) 3.9*2.5*0.15(1piece) | scale 1:2 D02wood(earthy yellow) 3.5*0.4*0.15(2pieces) | scale 1:1 D03wood(earthy yellow) 2.5*0.4*0.15(2pieces) | scale 1:2 D04wood(brown) 4*1.3*0.3(1piece) |
| scale 1:1 D05wood(wood color) 1.1*1*0.3(2pieces) | scale 1:2 D06wood(brown) 2.2*2.2*0.2(1piece) | scale 1:1 D07wood(brown) 1.4*0.8*0.2(2pieces) | wood 1:1 D08wood(wood color) 1.3*1.3*0.15(2pieces) | scale 1:1 D09wood(brown) 1.5*1.5*0.2(1piece) | scale 1:1 D10wood(earthy yellow) 1.5*1.1*0.2(2pieces) | scale 1:1 D11wood(wood color) 1.2*0.9*0.15(4pieces) | scale 1:3 D12wood(brown) 3.4*2.5*0.2(2pieces) |

| | | | | | | | |
|---|--|---|--|--|---|--|---|
| Bag E | scale 1:1 E01wood(dark blue) 1.8*1.8*0.2(1piece) | scale 1:1 E02wood(dark blue) 2.5*1.5*0.2(1piece) | scale 1:1 E03wood(dark blue) 2.5*1.5*0.2(1piece) | scale 1:1 E04wood(dark blue) 2.5*1.2*0.2(2pieces) | scale 1:1 E05wood(dark blue) 1.6*1.5*0.2(1piece) | scale 1:1 E06wood(dark blue) 1.7*0.5*0.3(1piece) | scale 1:1 E07wood(dark blue) 1.4*1.2*0.15(1piece) |
| scale 1:4 E08 round wood (earthy yellow) 0.9*0.9*12(1piece) | scale 1:2 E09wood(earthy yellow) 4.5*0.3*0.15(2pieces) | scale 1:2 E10wood(wood color) 4.8*1.5*0.2(1piece) | scale 1:1 E11wood(dark grey) 2*0.9*0.15(5pieces) | scale 1:5 E12board(black edge) 10*8.9*0.5(2pieces) | scale 1:1 E13wood(black) 1*1*0.3(2pieces) | scale 1:4 E14 round wood(black) 0.4*0.4*10.1(1piece) | Bag F |
| F01 rubber hose (transparent) length=12(1piece) | F02 rubber hose (transparent) length=10(1piece) | F03 rubber hose (transparent) length=2(1piece) | F04 iron bead (silver) (7pieces) | F05 plastic bead (transparent) (3pieces) | F06 plastic bead (color) (32pieces) | F07 plastic bead (white) (2pieces) | F08 plastic bead (transparent) (2pieces) |
| F09 plastic bead (transparent) (1piece) | F10 wooden bead (wood color) (4pieces) | F11 cloth (beige) 10*7(1piece) | F12 cloth (bluen/white) 6*6(1piece) | F13 toothpick (wood color) (3pieces) | F14 paper (golden) 7*2(1piece) | F15 paper (silver) 6*6(1piece) | F16 paper (white) 8*7(2pieces) |
| Bag G | G01 paper rope (light brown) length=60(1piece) | G02 foam ball (white) (some) | G03 cotton (白色) (some) | G04 polymer clay (red/green) length=1(1piece) | G05 polymer clay (red/yellow/green) length=0.5(1piece) | G06 polymer clay (orange) length=0.5(1piece) | G07 polymer clay (green/rose red) length=0.5(1piece) |
| G08 dry moss (green) (some) | G09 stone (color) (some) | G10 lucky cat (1piece) | G11 LED lamp with wire (2pieces) | G12 battery holder (black) (1piece) | G13 adhesive paper (1piece) | G14 sand paper (1piece) | G15 PVC film (transparent) 3*2.5(1piece) |