

M913

DIY mini house kits - Star Takoyaki



M913 Instruction manual

NOTICE OF ASSEMBLE

Tips for assembling

1. Pictures shown on the package may be slightly different from the actual product.
2. All the materials are taken in the operation step, put the remaining materials back into the original pocket until the installation is completed. (Avoid material loss during installation)
3. The dimensions indicated in the step diagram are "cm".
4. If there are template paper material, please cut the material according to the template to avoid mistakes..
5. According to the part rule example at the bottom of this page, refer to the part on the part number drawing, find the material object and compare with the material list, confirm and install. (Wooden parts only)
6. Glue should not be applied too much, so as not to dry longer, overflow will affect the effect of the finished product.
7. Part shapes may differ from the photographs depending on the production batch

Testing on LED function

Be sure to test the LED lights before making the lighting, note that the LED white wire to the negative, gray wire to the positive reference to the following figure operation test.

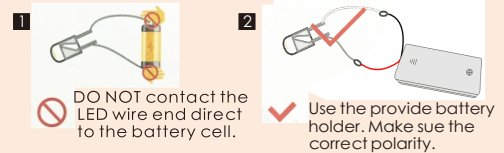

Product comes with tool:



Bring your own tools:

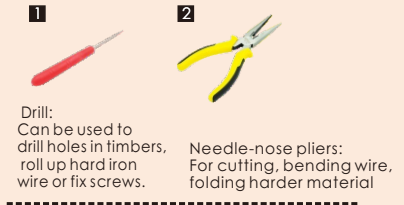

How to assemble the battery holder

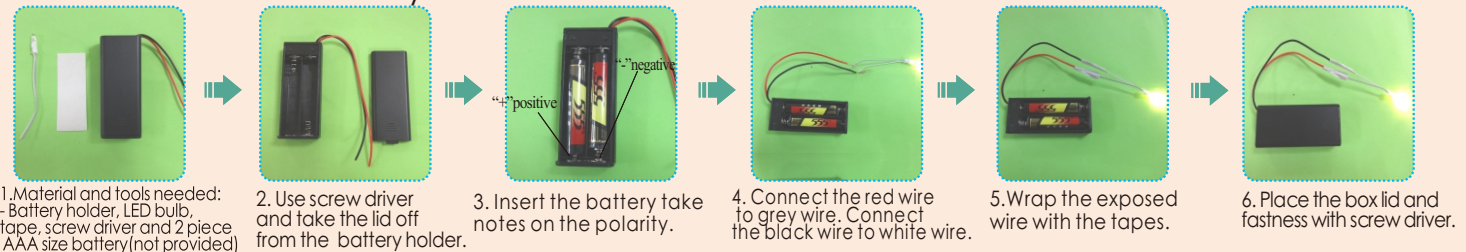

Example of parts rule:

A01: The parts are directly in the box.; B01: parts in bag B; C01: part in bag C, and so on.
(Note: display the printing paper A10-01 in the step: the printing paper is placed directly in the box, part number is A10-01)

details of miniature kit

Name	Material package
printing paper	Bag A-A11 (All printing and template papers are shown on A11 paper, total 3 pieces of A4)
octopus ball machine	B bag +E bag+ printing paper
takoyaki rack	B bag +E bag
microwave oven	B bag + F bag + printing paper
stuff table	B bag +E bag+ F bag + printing paper
food rack	B bag +E bag+ printing paper
barstool	C bag
round stool	C bag
paper parts	D bag+ E bag+printing paper
bicycle	C bag+ F bag
vending machine	D bag +E bag+ F bag + printing paper
plant	E bag+ F bag + printing paper
table and dining table	D bag +E bag+ F bag + printing paper
bar table	B bag +C bag+ F bag + printing paper
lights	D bag +E bag+ F bag+ printing paper
outer frame	A bag + printing paper



Welcome to the little DIY world, now come with me

Thumbnail of material list (reference only)

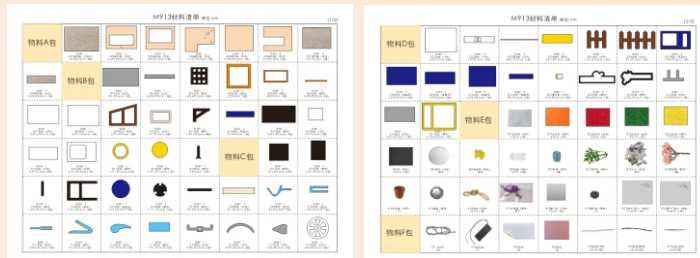

Thumbnail of printing paper & template paper (reference only)



Symbol description used



Install parts in the opposite direction



Install the same parts on both sides



Pay attention to the direction of installation material B



Pay attention to the direction of installation material A



Pay attention to the direction of installation material B



Pay attention to the direction of installation material A



Fold in half according to dotted line



fold double edge to center dotted line



Fold four sides to the middle



Pay attention to the direction of installation material B



Pay attention to the direction of installation material A



Pay attention to the direction of installation material B



Pay attention to the direction of installation material A



combination part according to 1 2 3 so on.

Octopus Ball Machine

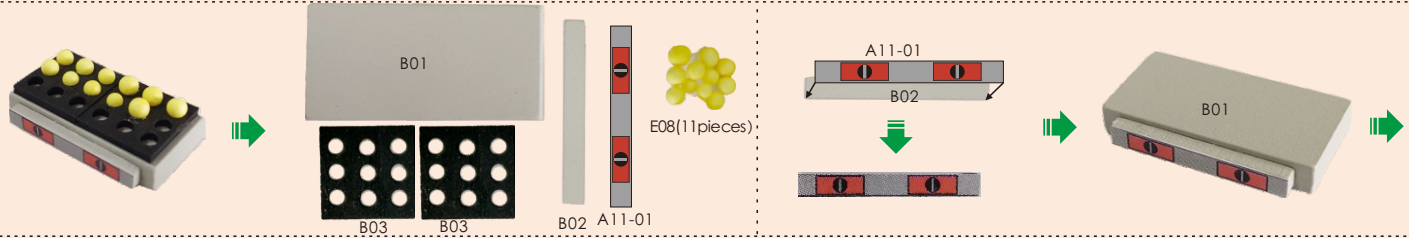

Takoyaki Rack

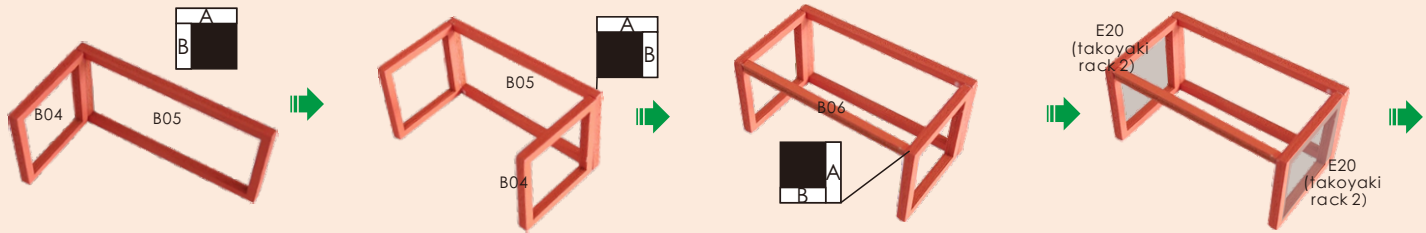
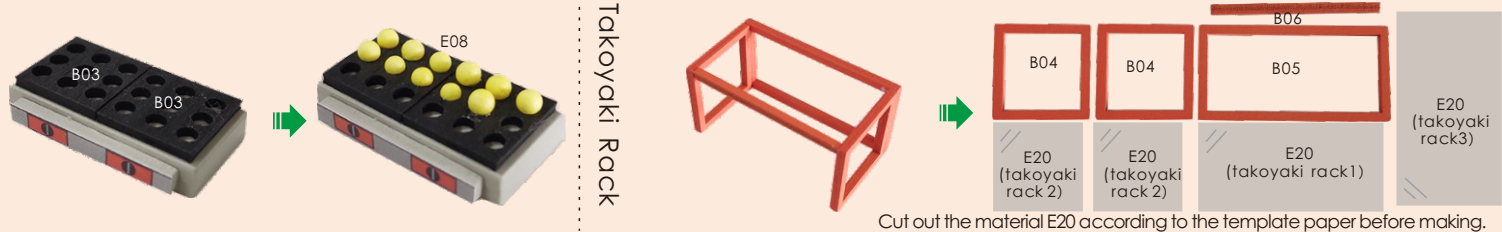

Microwave Oven



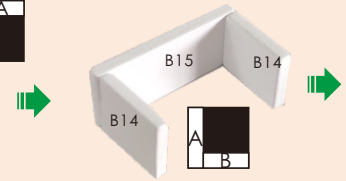
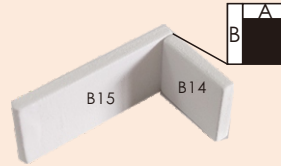
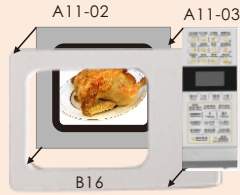

Bend as shown in the figure.

Stuff Table

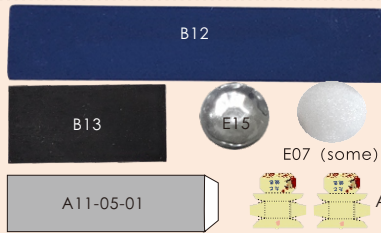

F06(3.5cm)

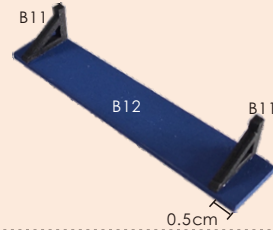

E08(10pieces)
E07 (some)

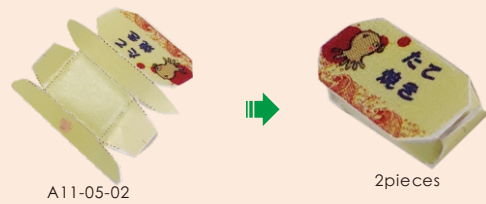
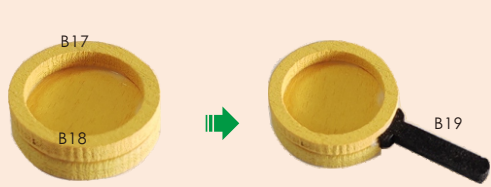

Food Rack

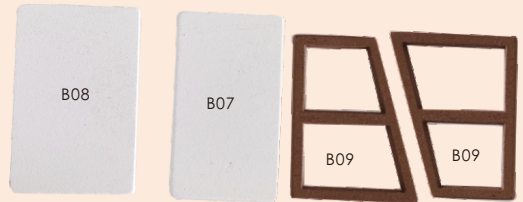

Cut out the material E01,E02,E03,E04,E05,E06 and E20 according to the template paper before making.

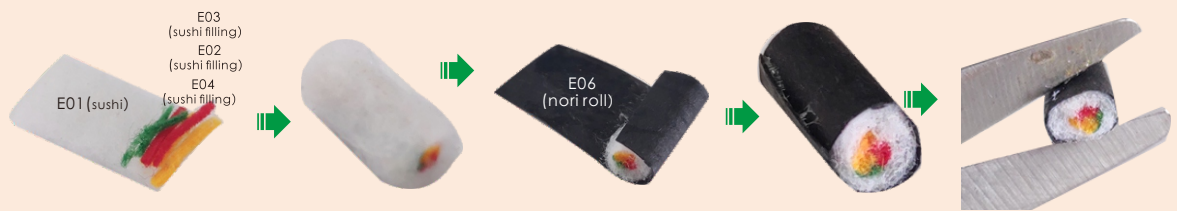

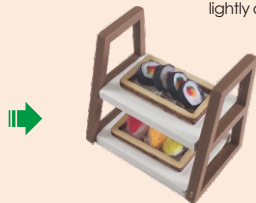
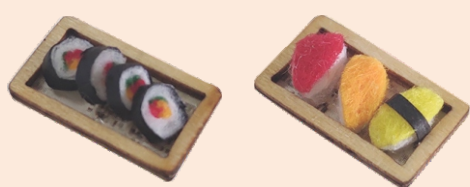
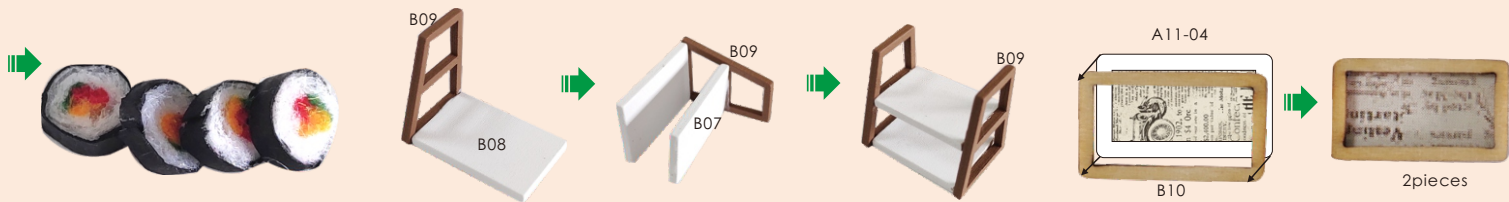

Use a knife in the red line. (Note: The dotted line of the template paper), lightly draw a straight line, and fold and paste the line.

E20 (food rack)

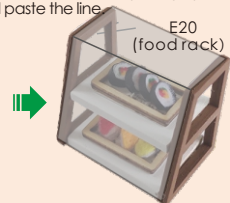

Barstool

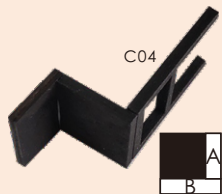
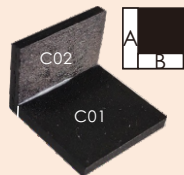
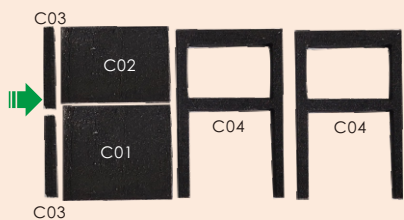

Round Stool

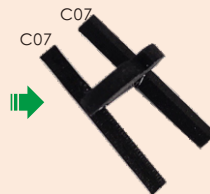
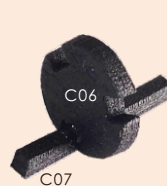

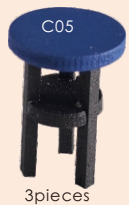

3pieces

Paper Parts

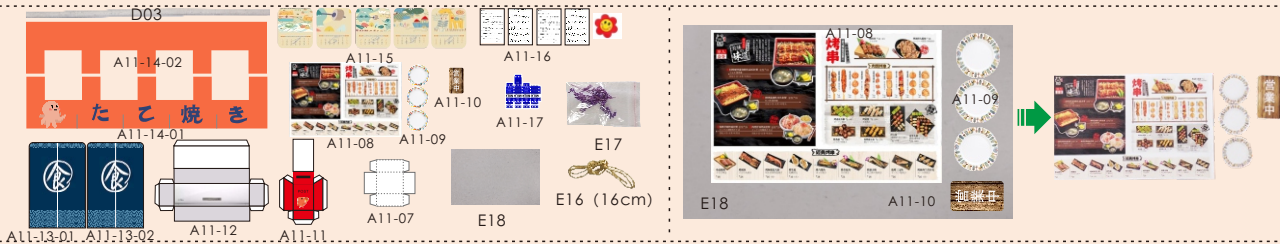

A11-07



E16



E17



A11-15

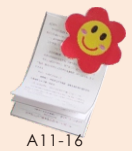

A11-16



A11-12



A11-11



A11-17



A11-13-02

A11-13-01



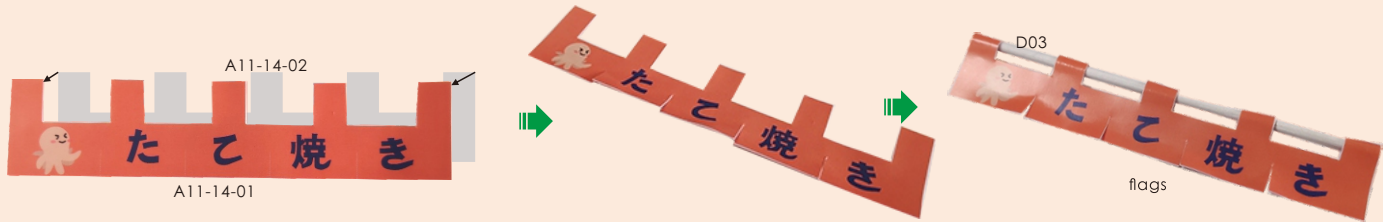

Bicycle

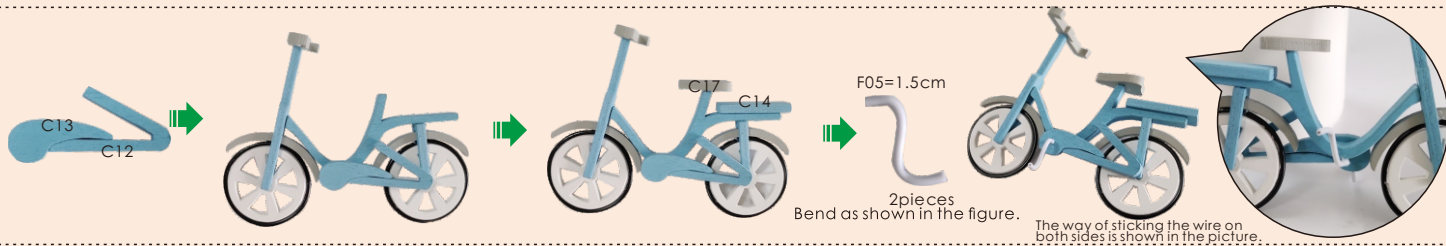
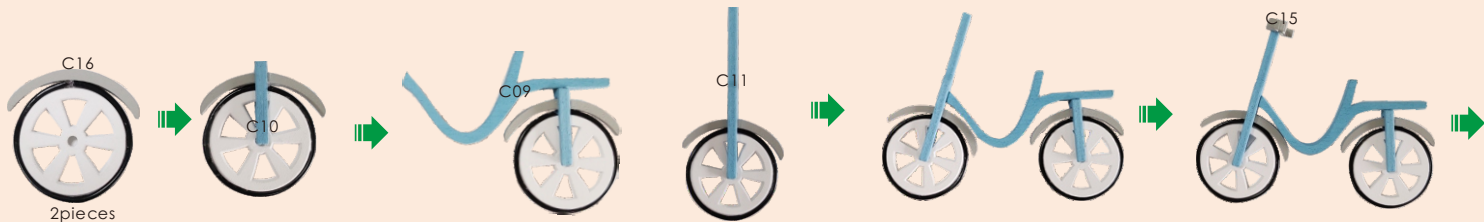
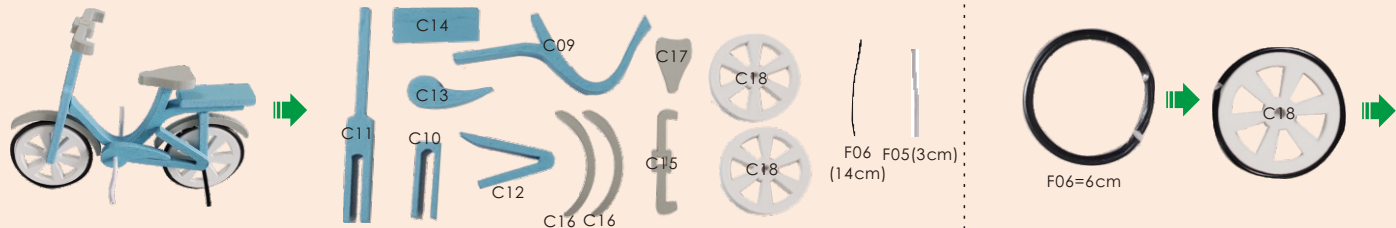

F06=1.3cm

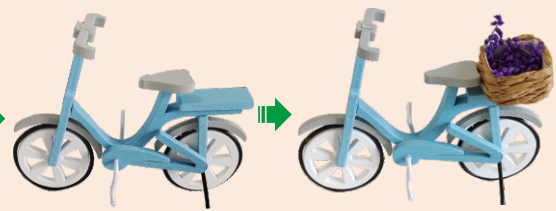

Vending Machine

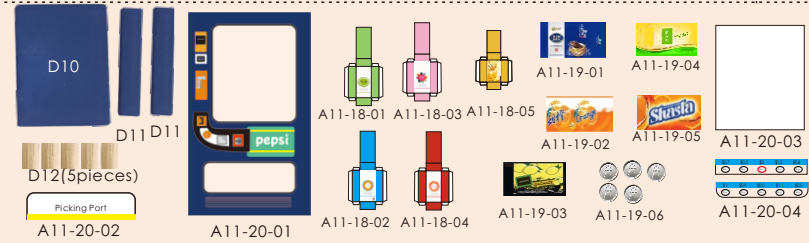

Cut out the material E20 and E21 according to the template paper before making.

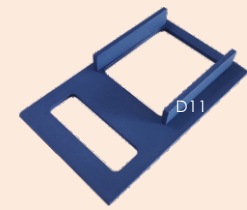
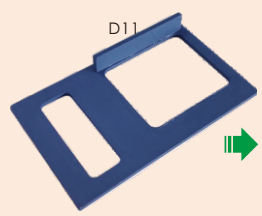
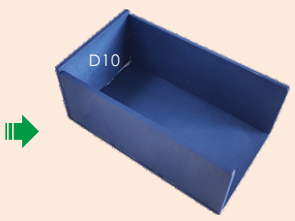
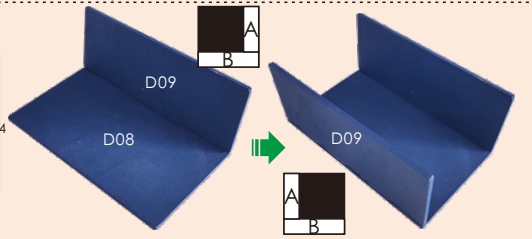
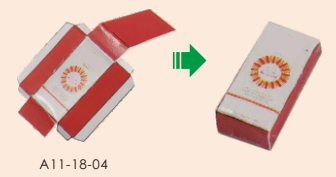
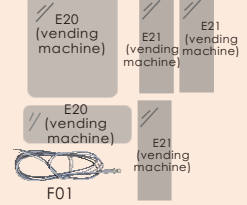

One side of the E21 can tear out a sheet of film.

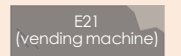

3pieces

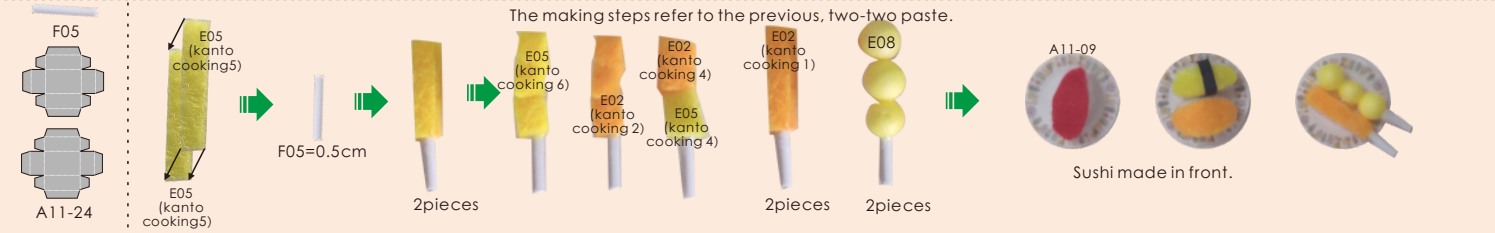
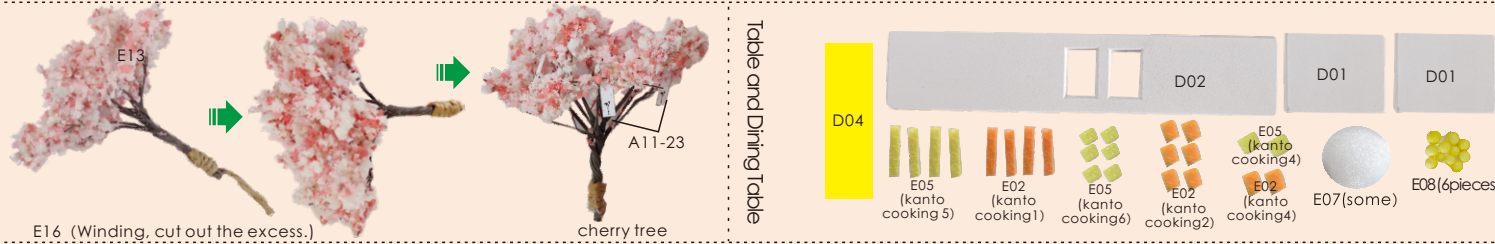
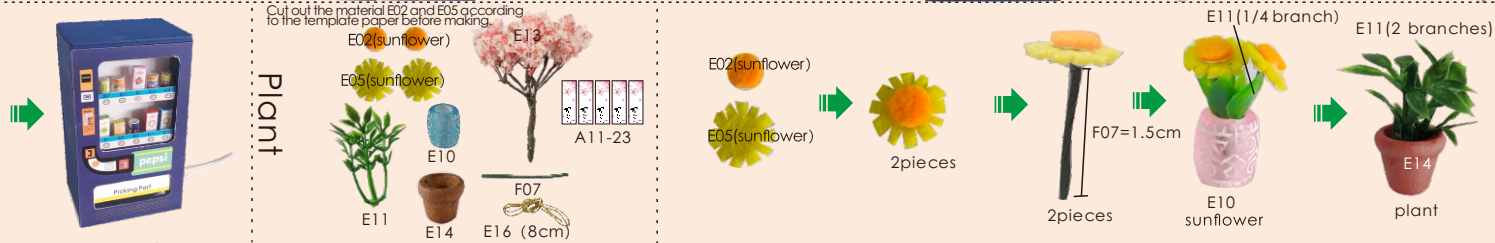
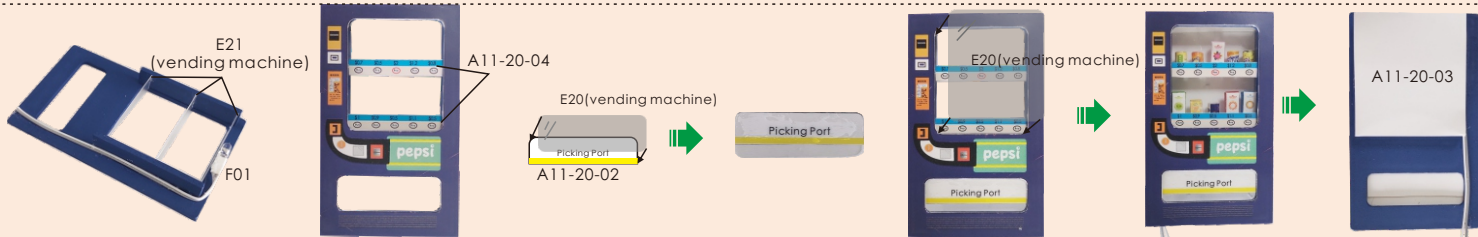

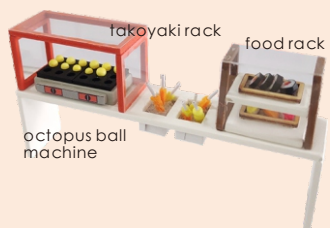
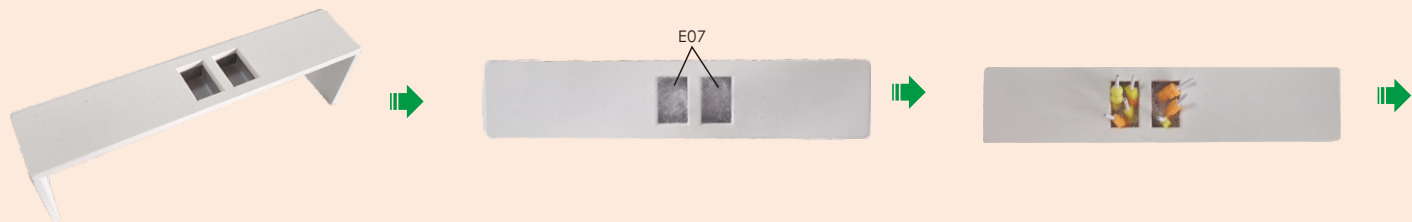
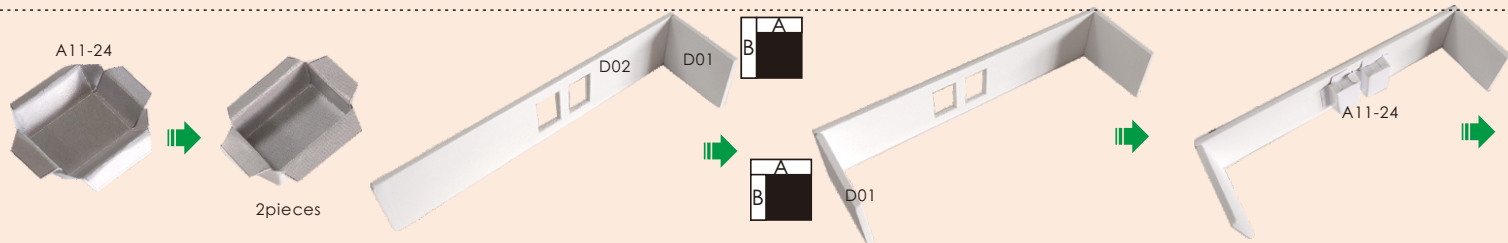

Bar Table

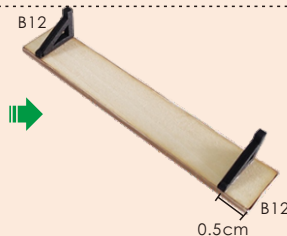
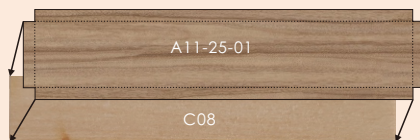

Roll up the printing paper A11-25-02 and put it into the rubber hose.

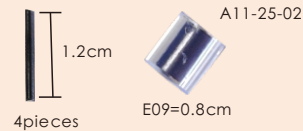



Lights

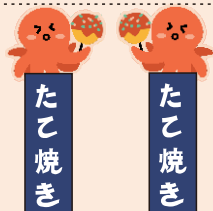

A11-21-01

A11-21-02



A11-22-01

A11-22-02



D14

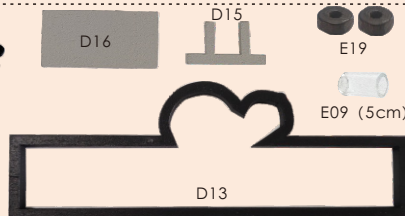

D13

D16

D15



E19



E09 (5cm)



F01



A11-21



E19

F01



A11-21



E19



lantern



D14



Use a knife to cut out a position in the middle to allow the wire to pass through, so as to facilitate the subsequent wiring.

E09=1.5cm

F01



A11-21-02



A11-21-01



たこ焼き



D15



D16

light box



D13

Please refer to the previous steps for making the signboard lights.



A11-22-01



signboard

A11-22-02

Outer frame

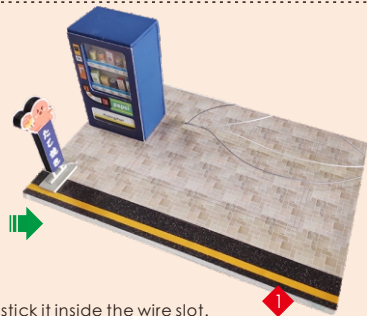
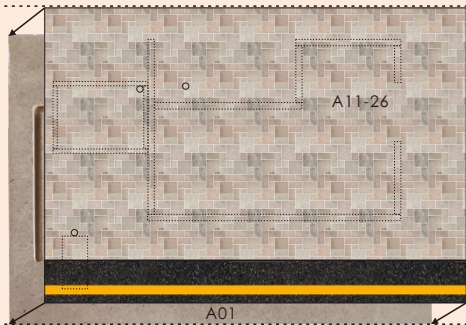

If D17 fails to engage in A03, rub the edges with sand paper.

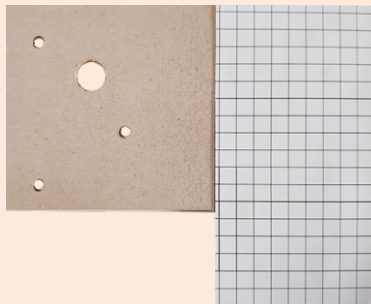
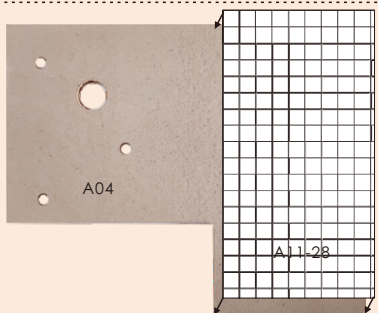
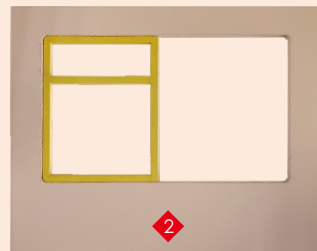
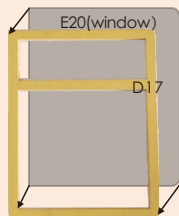
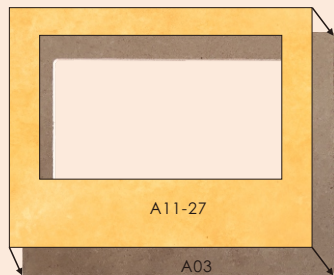

Music machine core manual guide
(If you have purchased the music machine core, please fix it firstly)

 <p>G01 Music machine core 1piece</p>	 <p>G02 Screw 3pieces</p>	 <p>G03 Music machine core handle 1piece</p>
---	--	---

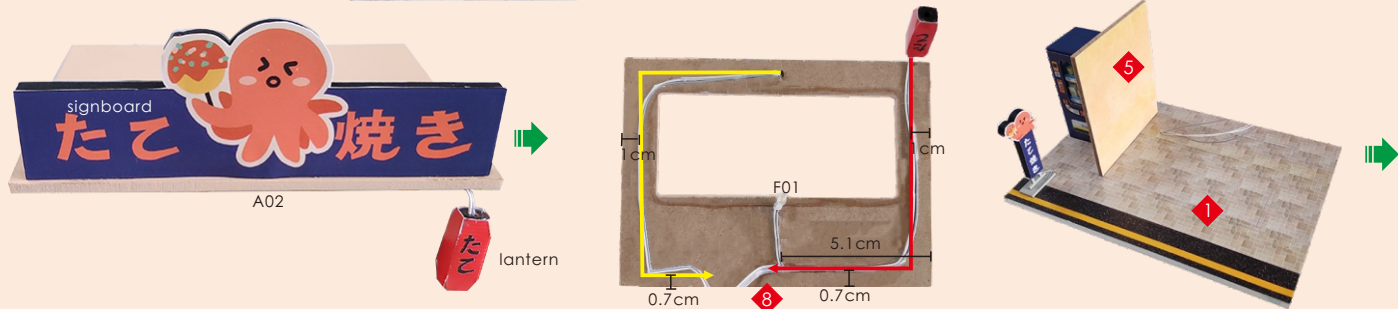
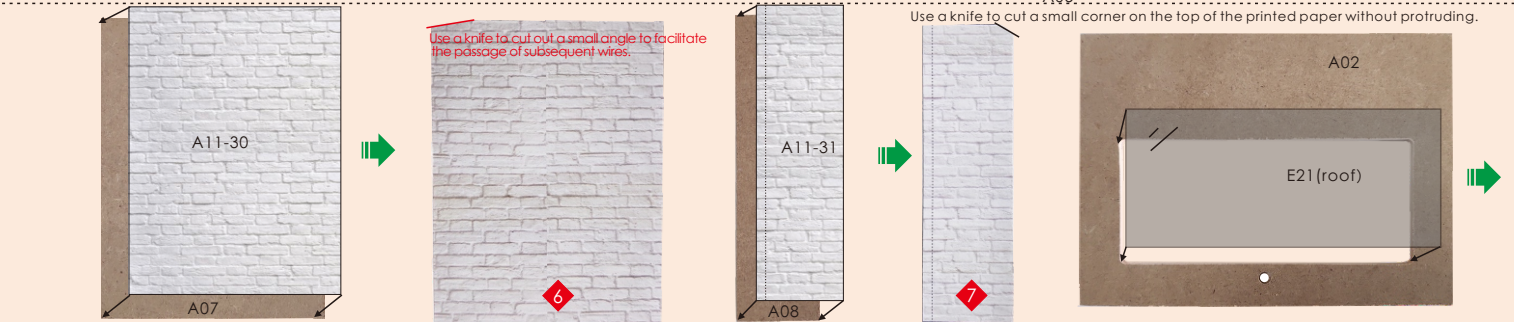
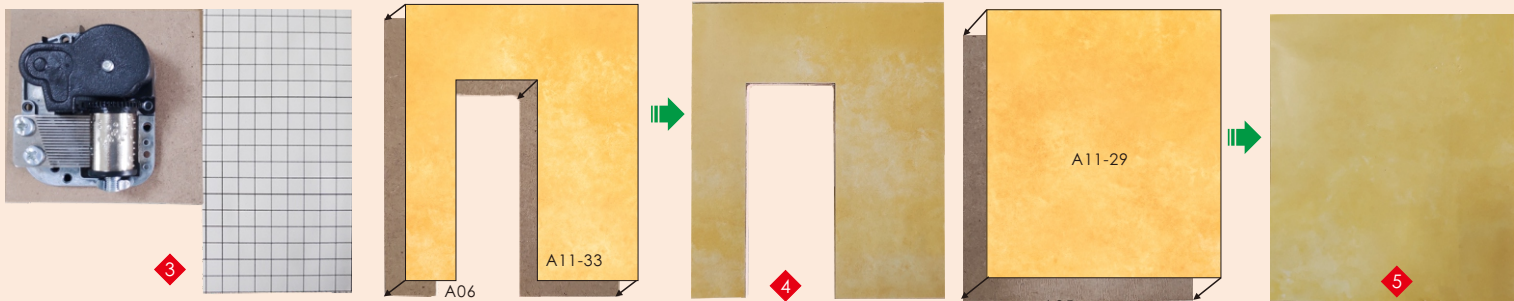

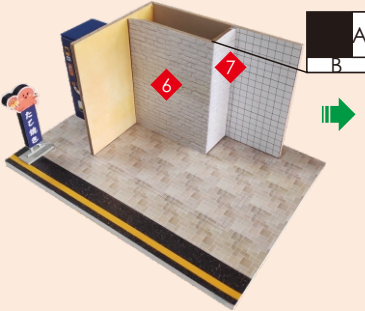
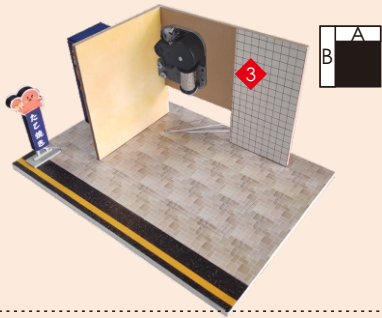

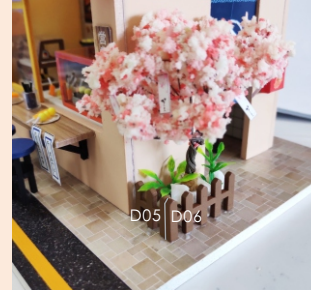

How to assemble the battery holder

Statement: the lamp wires cannot be inserted into the output socket.

- - Can use two 7 batteries
- - Please notice the place of anode and cathode when put in the batteries
- - Rechargeable batteries are not blunt electricity
- - Rechargeable batteries can only be charged under adult supervision
- - Rechargeable batteries should be removed from the toy before charging
- - Different types of batteries cannot mix: Do not mix new batteries in use with semi-used batteries.
- - Run out of battery should be removed from the toy
- - The power shall not be short circuit



Trim all the LED wiring to the same length.
Use a craft blade to carefully skim over the plastic to bare the copper wire.
Twist the same color wire together.



Twist the following wire together:

- (I) BLACK wire from the battery box with the WHITE wire from LED bulb.
- (II) RED wire from the battery box with the GREY wire from LED bulb.

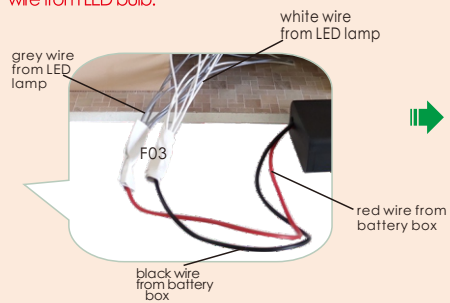

Roll and seal the duly twist copper with the white tape F03 provided.



Installation of dust proof cover
(For updated version, the parts need to be purchased separately)



scale 1:4
G04 Transparent cover
20*15*0.18cm
2pieces



scale 1:4
G05 Transparent cover
15*13.64*0.18cm
2pieces



scale 1:4
G06 Transparent cover
20*14*0.18cm
1piece

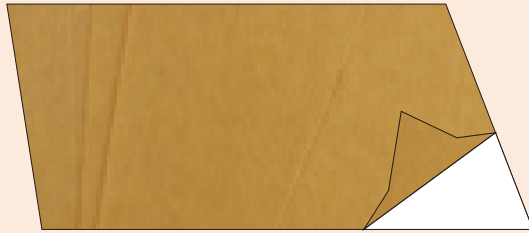

1. Tear off kraft paper of each piece of transparent cover.

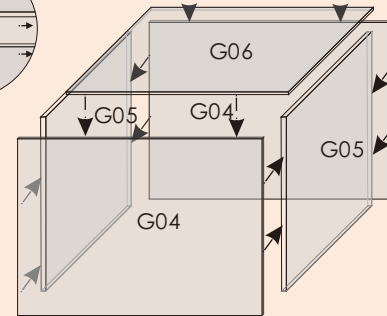
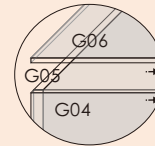

2. Paste G04, G05 and G06 together to complete the dust proof cover as shown.

Photo of Dust proof cover



Attention: Please keep the instruction for future enquires after installation.