

M906

# DIY mini house kits - Rainbow cafe



M906 Instruction manual

## NOTICE OF ASSEMBLE

### Tips for assembling

1. Pictures shown on the package may be slightly different from the actual product.
2. All the materials are taken in the operation step, put the remaining materials back into the original pocket until the installation is completed. (Avoid material loss during installation)
3. The dimensions indicated in the step diagram are "cm".
4. If there have template paper material, please cut the material according to the template to avoid mistakes.
5. According to the part rule example at the bottom of this page, refer to the part on the part number drawing, find the material object and compare with the material list, confirm and install. (Wooden parts only)
6. Glue should not be applied too much, so as not to dry longer, overflow will affect the effect of the finished product.
7. Part shapes may differ from the photographs depending on the production batch.

### Testing on LED function

Be sure to test the LED lights before making the lighting, note that the LED white wire to the negative, gray wire to the positive reference to the following figure operation test.

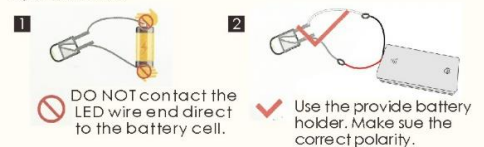

### Product comes with tool:

- |   |  |   |  |  |   |  |
|---|--|---|--|--|---|--|
| <b>1</b><br>  | <b>2</b><br>   | <b>3</b><br>  | <b>4</b><br>   | <b>5</b><br>   | <b>6</b><br>  | <b>7</b><br>   |
| <b>White glue:</b><br>It dries slowly and can paste materials firmly without trace. Can be used to paste wallpaper and printed paper. | <b>Ruler:</b><br>For measuring materials to identify the number of materials so as to enhance work efficiency. | <b>Scissors:</b><br>Can be used to cut printed paper, cloth, etc. | <b>Cutter knife:</b><br>For peeling off power wire skin and cutting off materials. | <b>Alcohol gel:</b><br>It dries fast and can paste materials firmly, but may leave some trace. Can be used to paste small metal materials and small components of furniture. | <b>Tweezers:</b><br>For holding small materials and rolling up iron wire. | <b>Screw Driver:</b><br>For fixing screws, mostly can be used to install doors and music components. |

### Bring your own tools:

- |   |  |
|---|--|
| <b>1</b><br>  | <b>2</b><br>   |
| <b>Drill:</b><br>Can be used to drill holes in timbers, roll up hard iron wire or fix screws. | <b>Needle-nose pliers:</b><br>For cutting, bending wire, folding harder material |

### How to assemble the battery holder

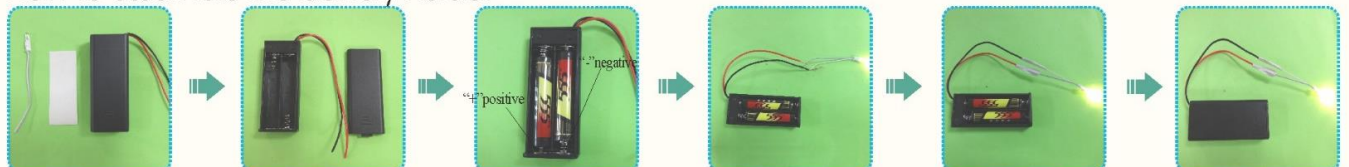

1. Material and tools needed:  
- Battery holder, LED bulb,  
tape, screw driver and 2 piece  
AA size battery (not provided)

2. Use screw driver  
and take the lid off  
from the battery holder.

3. Insert the battery take  
notes on the polarity.

4. Connect the red wire  
to grey wire. Connect  
the black wire to white wire.

5. Wrap the exposed  
wire with the tapes.

6. Place the box lid and  
fastness with screw driver.

### Example of parts rule:

A01: The parts are directly in the box.; B01: parts in bag B; C01: part in bag C, and so on.  
(Note: display the printing paper A10-01 in the step: the printing paper is placed directly in the box, part number is A10-01)



## details of miniature kit

Name	Material package
Printing paper	Bag A-A10 (All printing and template papers are shown on A10 paper, total 5 pieces of A4)
small bookcase	bag B+printing paper
small desk	bag B
display board	bag B+printing paper
steps	bag B
square table	bag B+bag G+bag J+bag H+printing paper
flower shelf	bag C+bag G+bag H+printing paper
cash register	bag C+bag J+printing paper
food cabinet	bag C+bag G+bag H+bag H+printing paper
sofa	bag C+bag G
long table	bag C+bag G+bag H
small round stool	bag D
rocking chair	bag D+bag G+bag J+printing paper
piano	bag D+bag G+bag J+bag H+printing paper
triangular light	bag E+bag J
music stand and video recorder	bag E+bag J+bag H+printing paper
cello	bag E+J bag
long chair	bag E+bag G+bag J+bag H+printing paper
small table	bag D+bag F+bag G+printing paper
door	bag F+bag J+bag H+printing paper
left window	bag F+bag H
lights	bag C+bag J+bag H
plant	bag H+bag J+printing paper
front outer frame	bag F+bag G
outer frame	bag A+printing paper

the material of H14 transparent film and G19 corrugated paper in the bag of instructions and printing paper.



Welcome to the little DIY world, now come with me

## Thumbnail of material list (reference only)

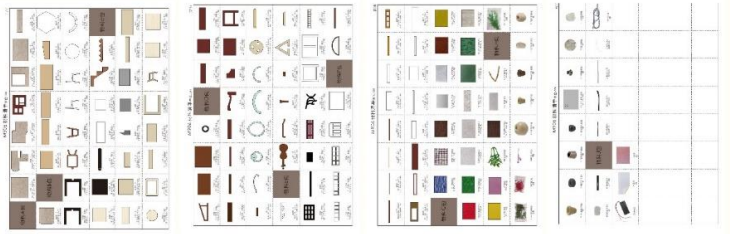

## Thumbnail of printing paper & template paper (reference only)



## Symbol description used

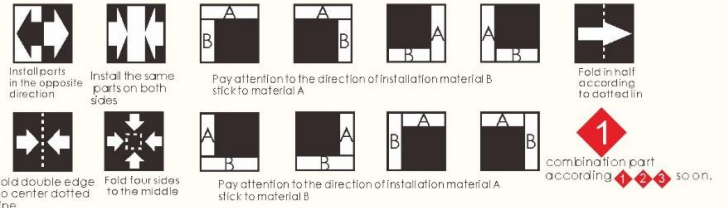

2

Small Bookcase

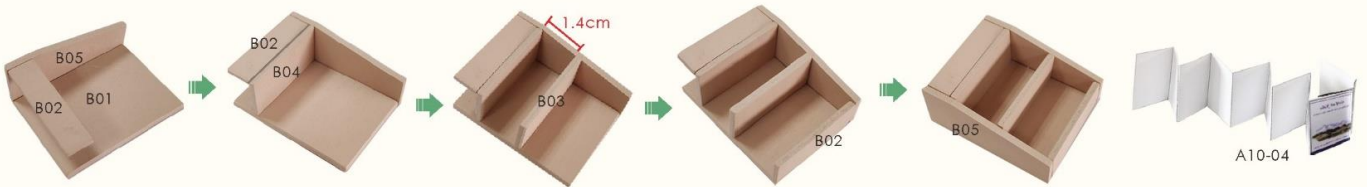
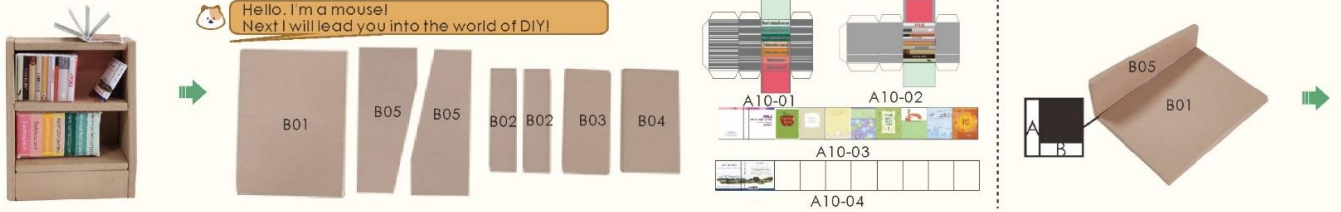

Complete the book shown above by folding the previous book.



Small Desk

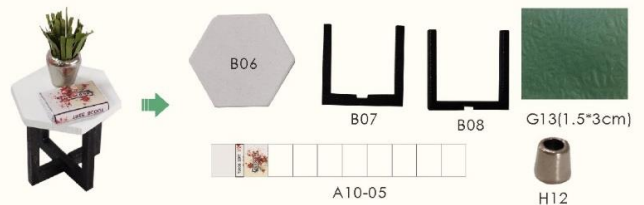

3

Cut equally spaced (0.1-0.2cm) using scissors



Display Board

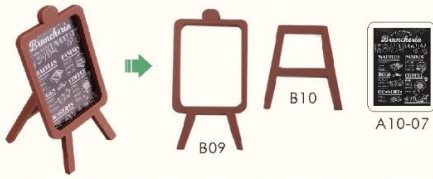

Come on!  
You can do it.

Chair

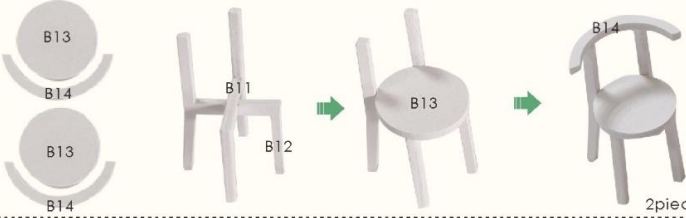
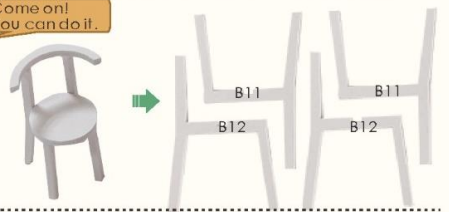

Steps

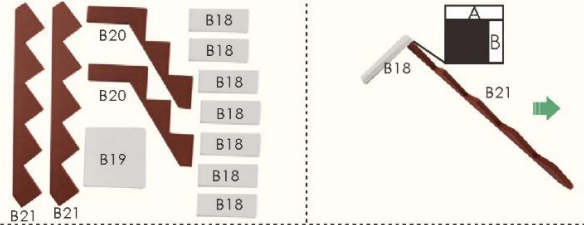

4

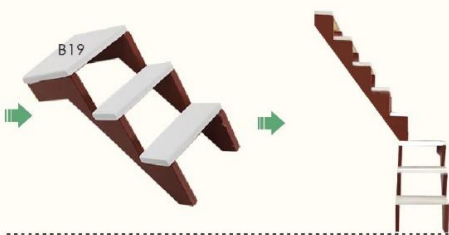

Square table



Cut out the material G04, G06, G07, G08 and G14 according to the template paper before making.

- G07 (sandwich)
- G06 (meat1)
- G08 (tomato)
- G14 (leaves)
- J01 (7cm)



Paste the printing paper on the G04 (decoration) card paper as shown, and cut out.

Paste the non-woven fabric in the order shown and cut out diagonally.



As shown in figure G15, trim the edges of the two ends according to the red line, and then fold them as shown in figure.

5



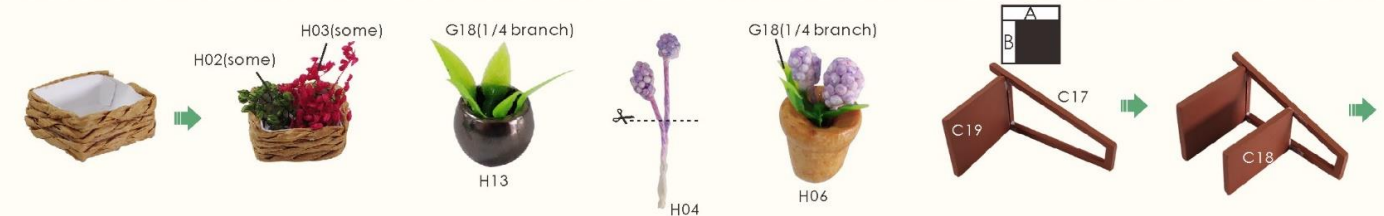
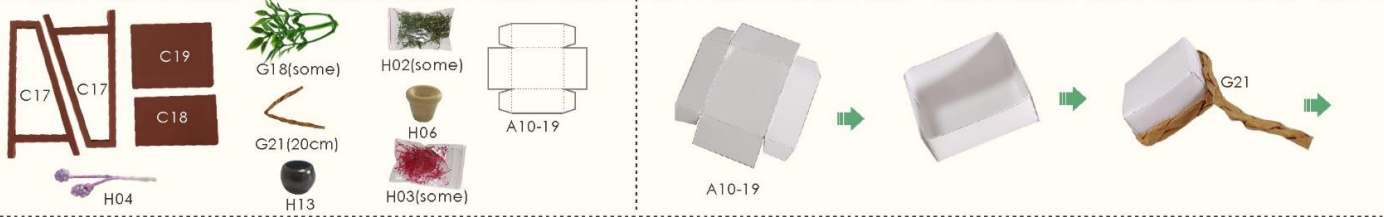
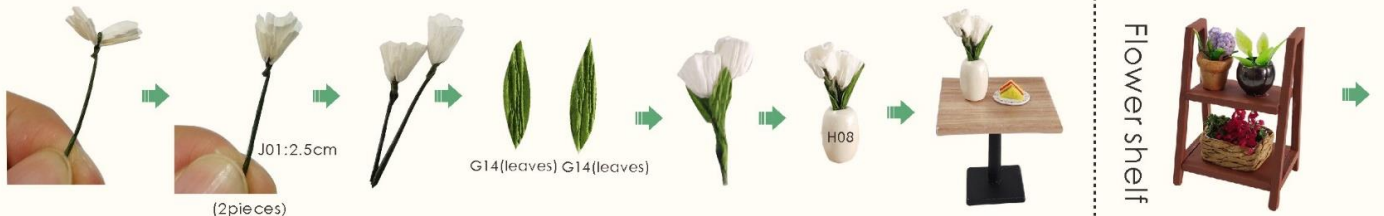

6

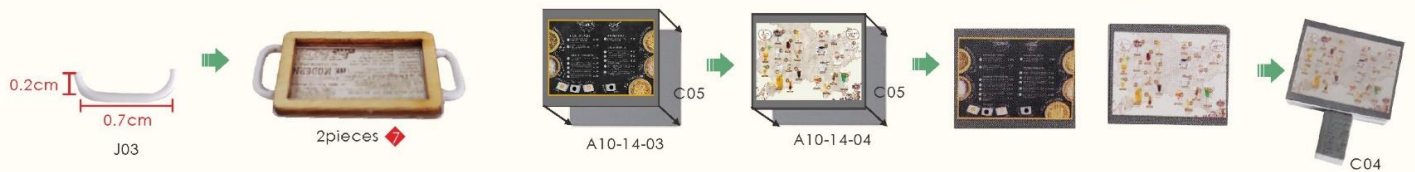
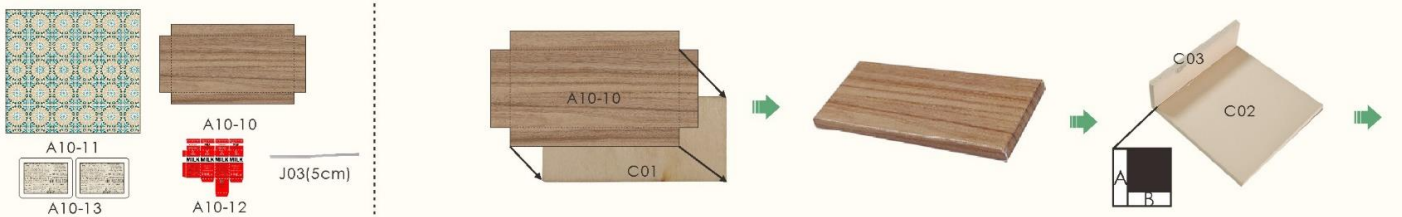

7

# Food Cabinet

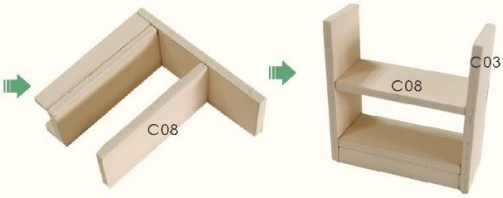
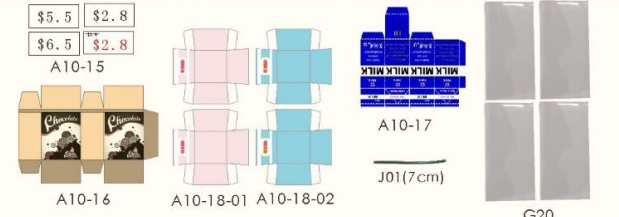
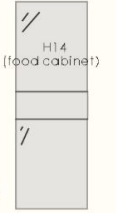

Paste the non-woven fabric in the order shown and cut out diagonally.



Cut G08, G09 into small pieces and stick them together.



Cut the G09 into small strips and stick them together.

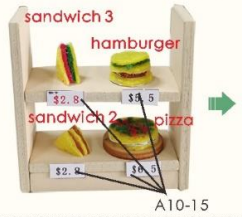

Use a knife on the red line. At the dotted line of the template paper, gently draw a straight line and fold the line to paste.

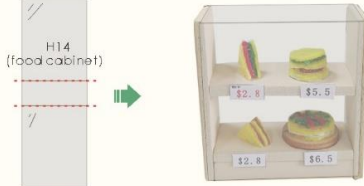

Using tweezers, put the box into the G20 bag, then wrap it with J01 wire and cut off the excess.



# Sofa

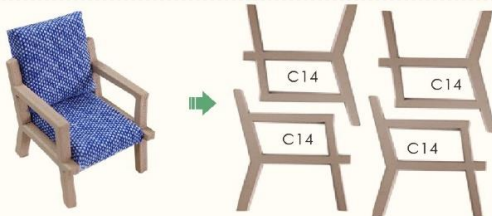

Cut out the material G01, G05 according to the template paper before making.

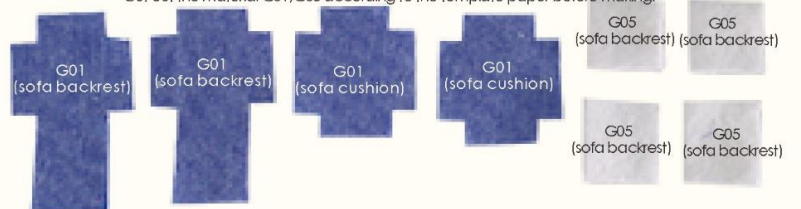



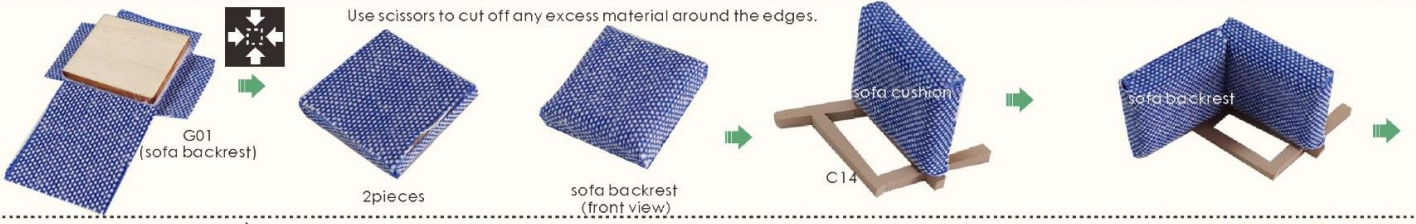

Long Table

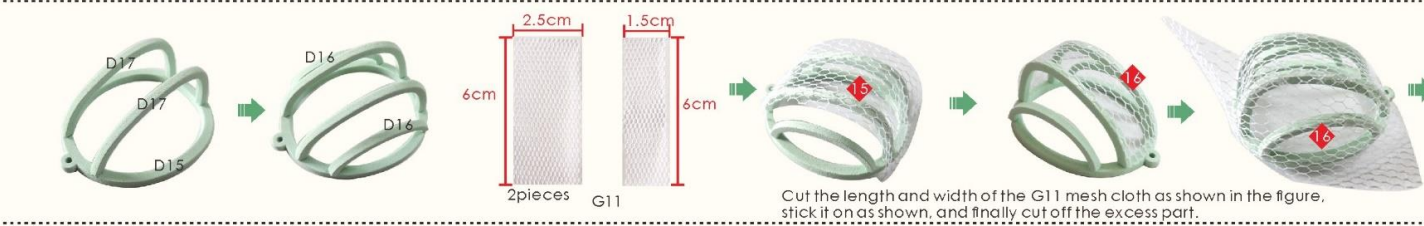
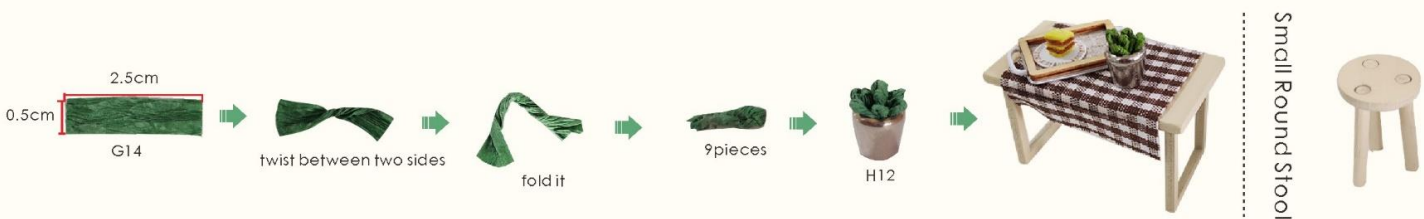

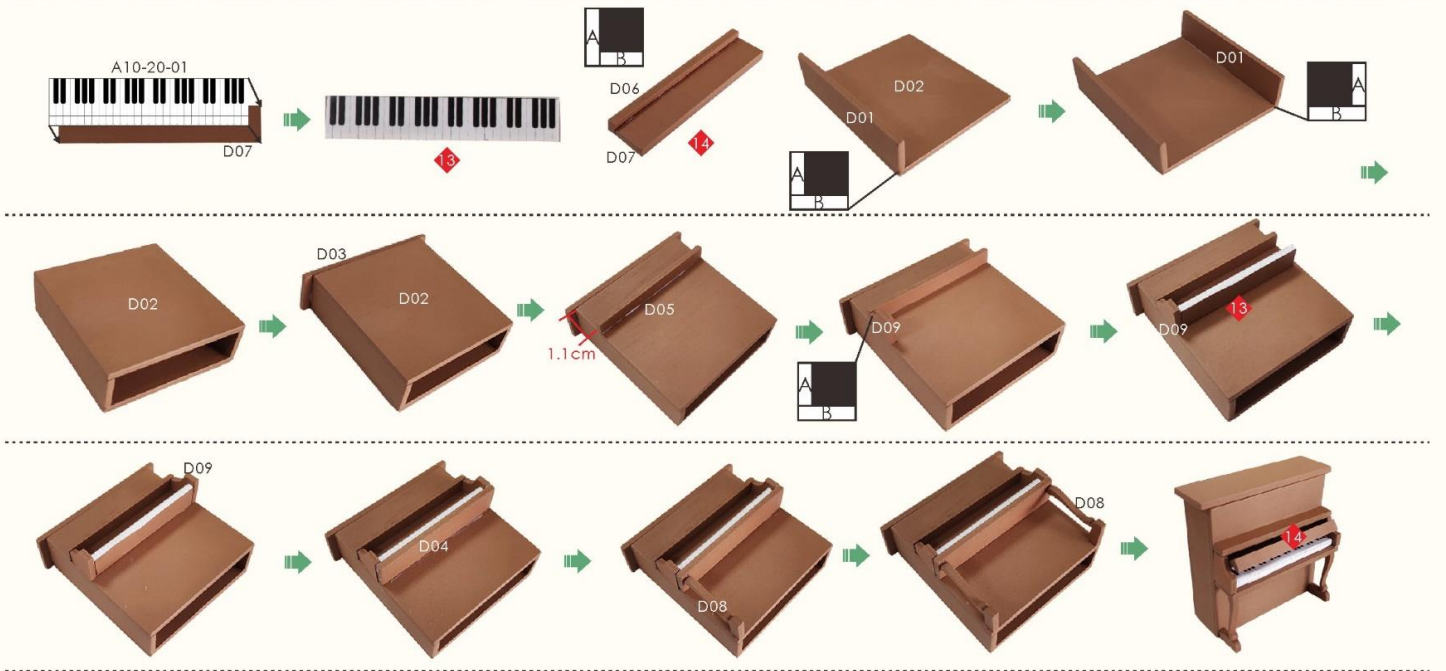
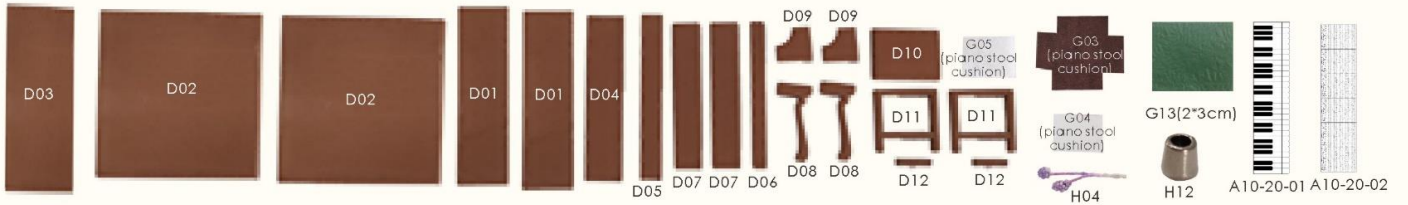

12



Please refer to page 3 for the method of making green plants.

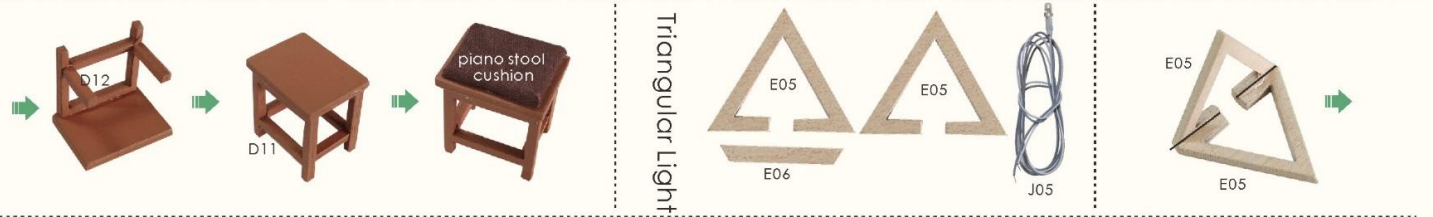

Triangular Light

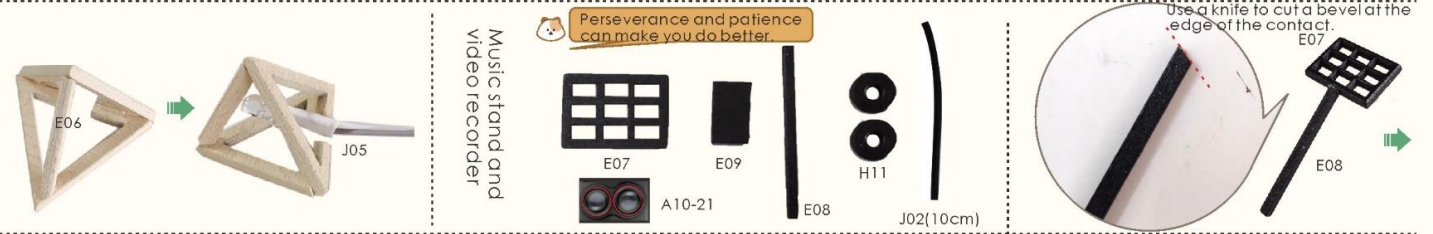

Perseverance and patience can make you do better.

Use a knife to cut a bevel at the edge of the contact.



13



Cello

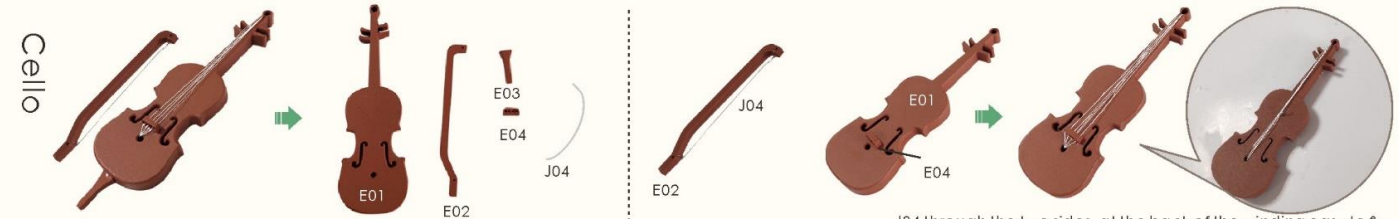

J04 through the two sides, at the back of the winding easy to fix.

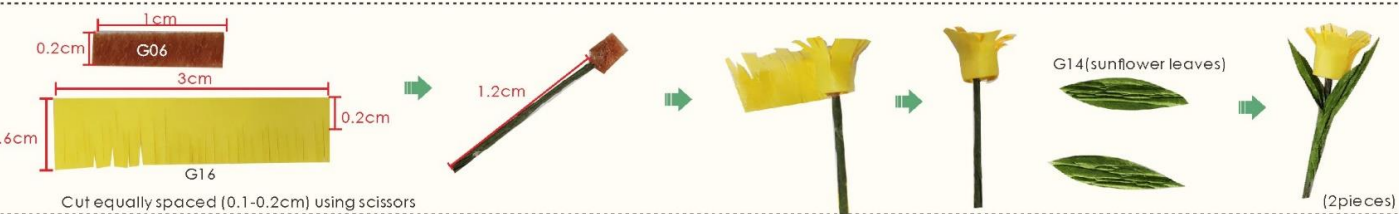
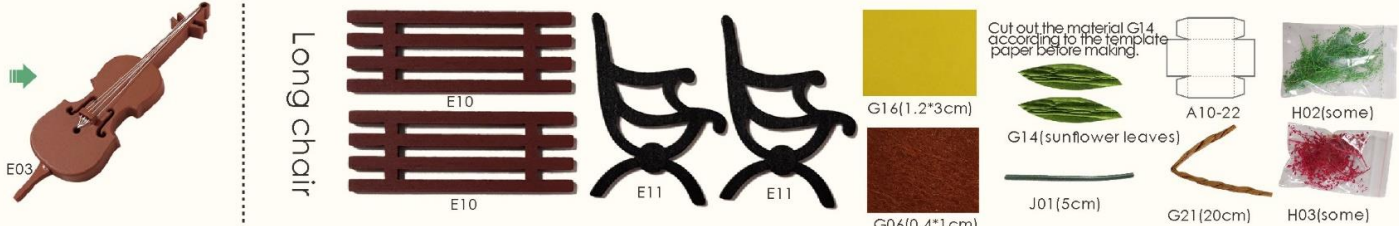

Please refer to page 6 above for the production of small basket.



Come on! Don't be discouraged! Victory is just around the corner.



Pasting H14 on the back of the door will make it more beautiful.

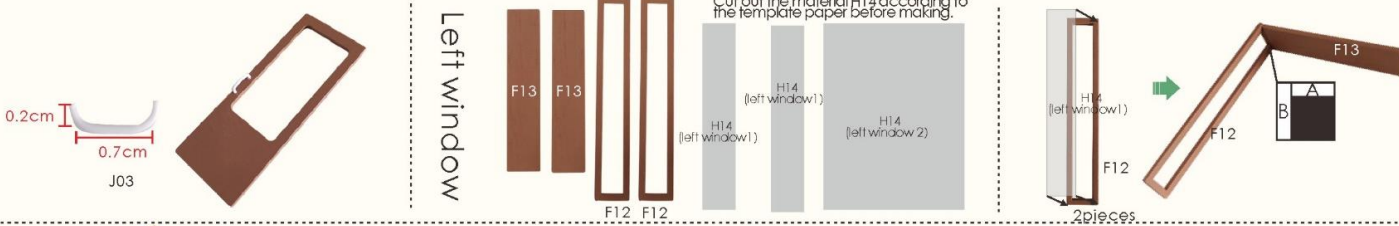



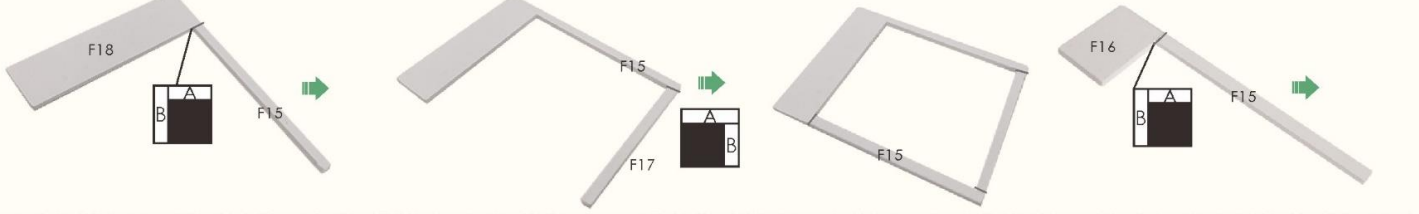
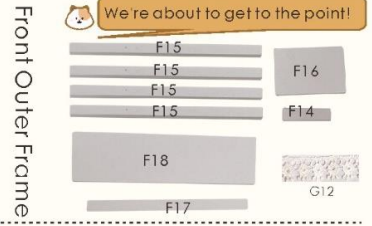
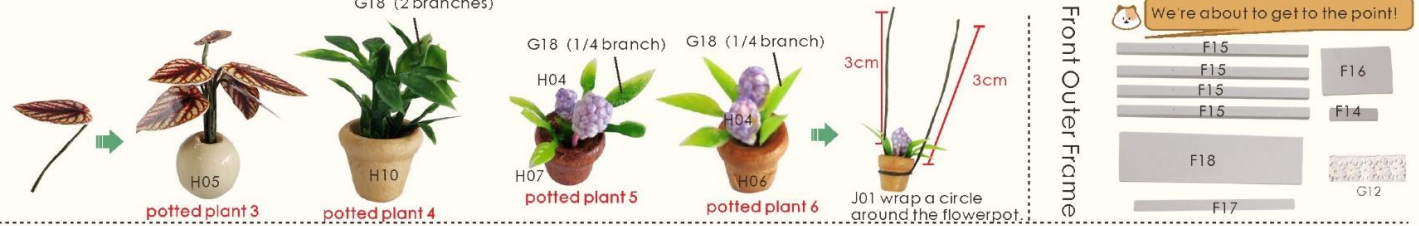
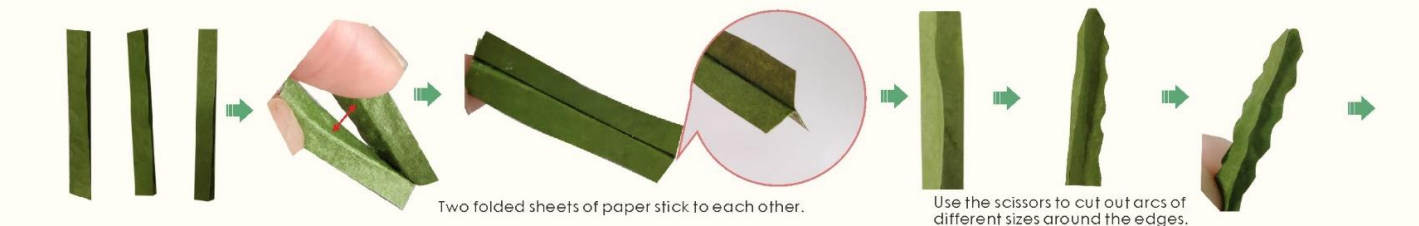
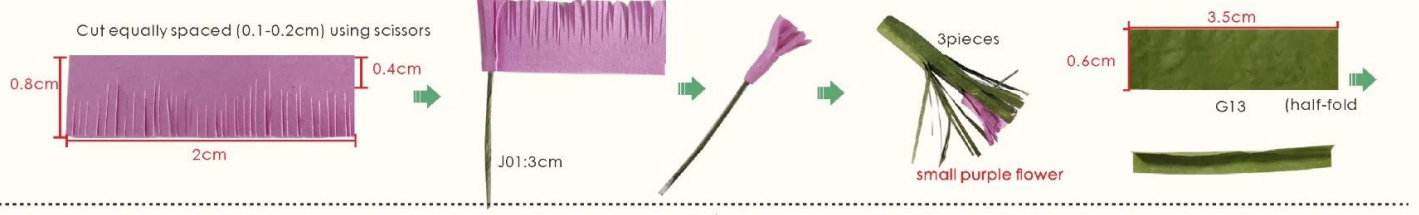
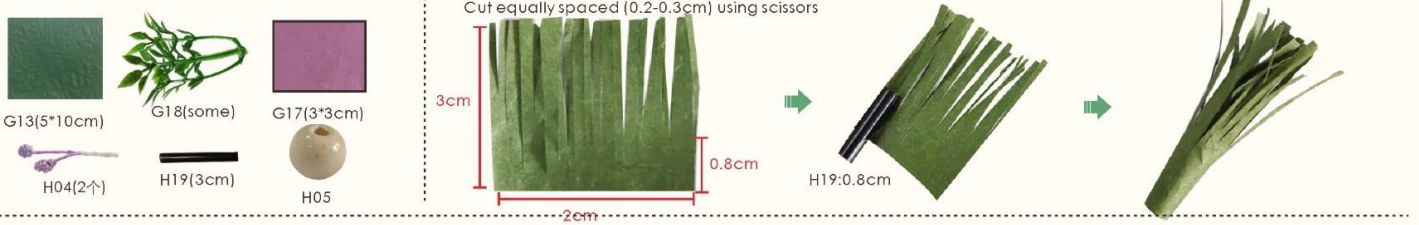
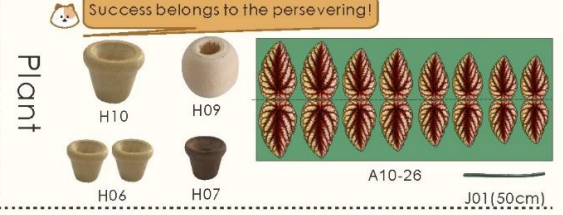
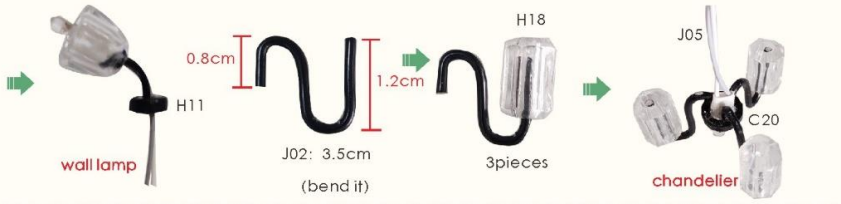



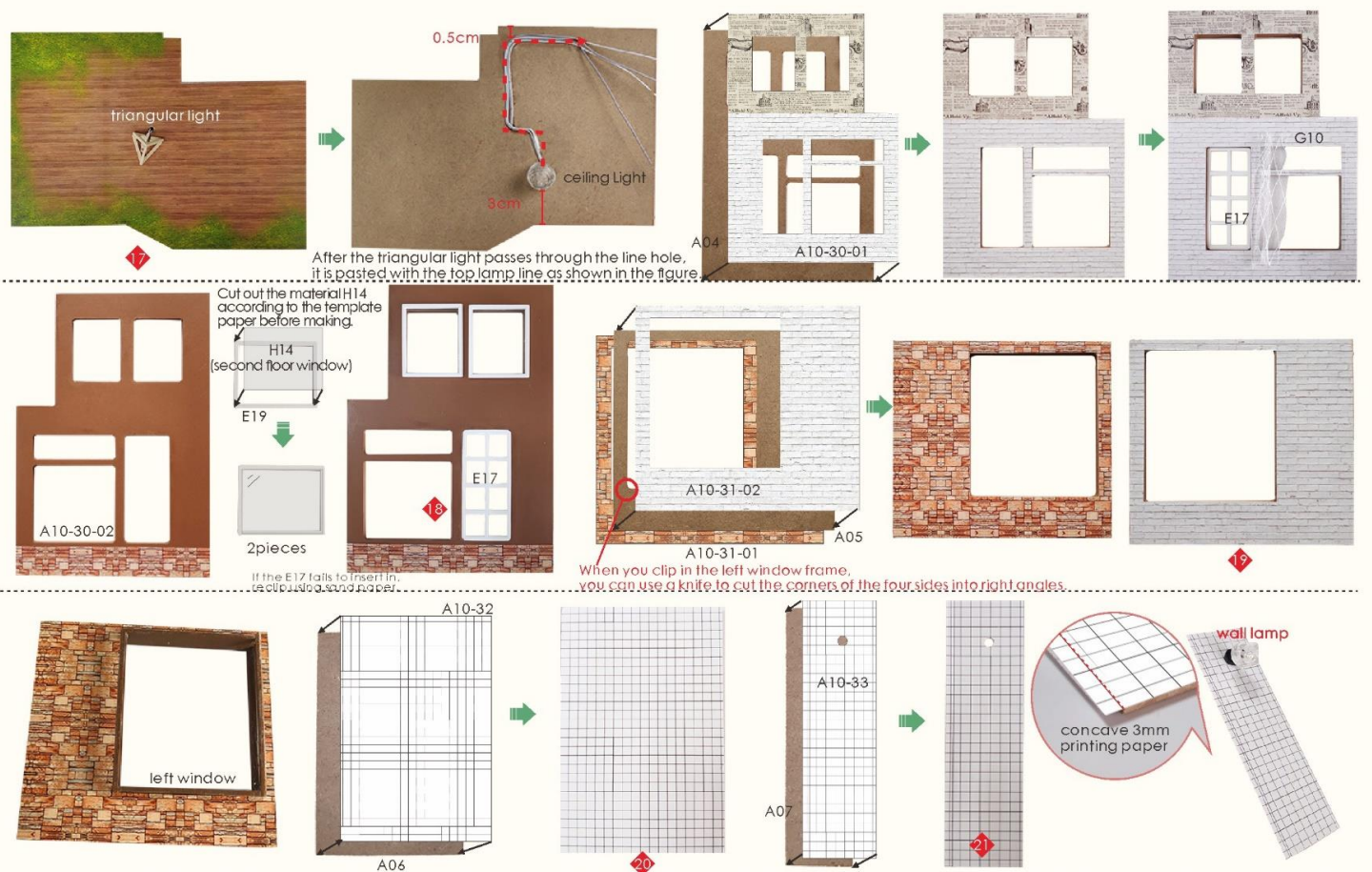
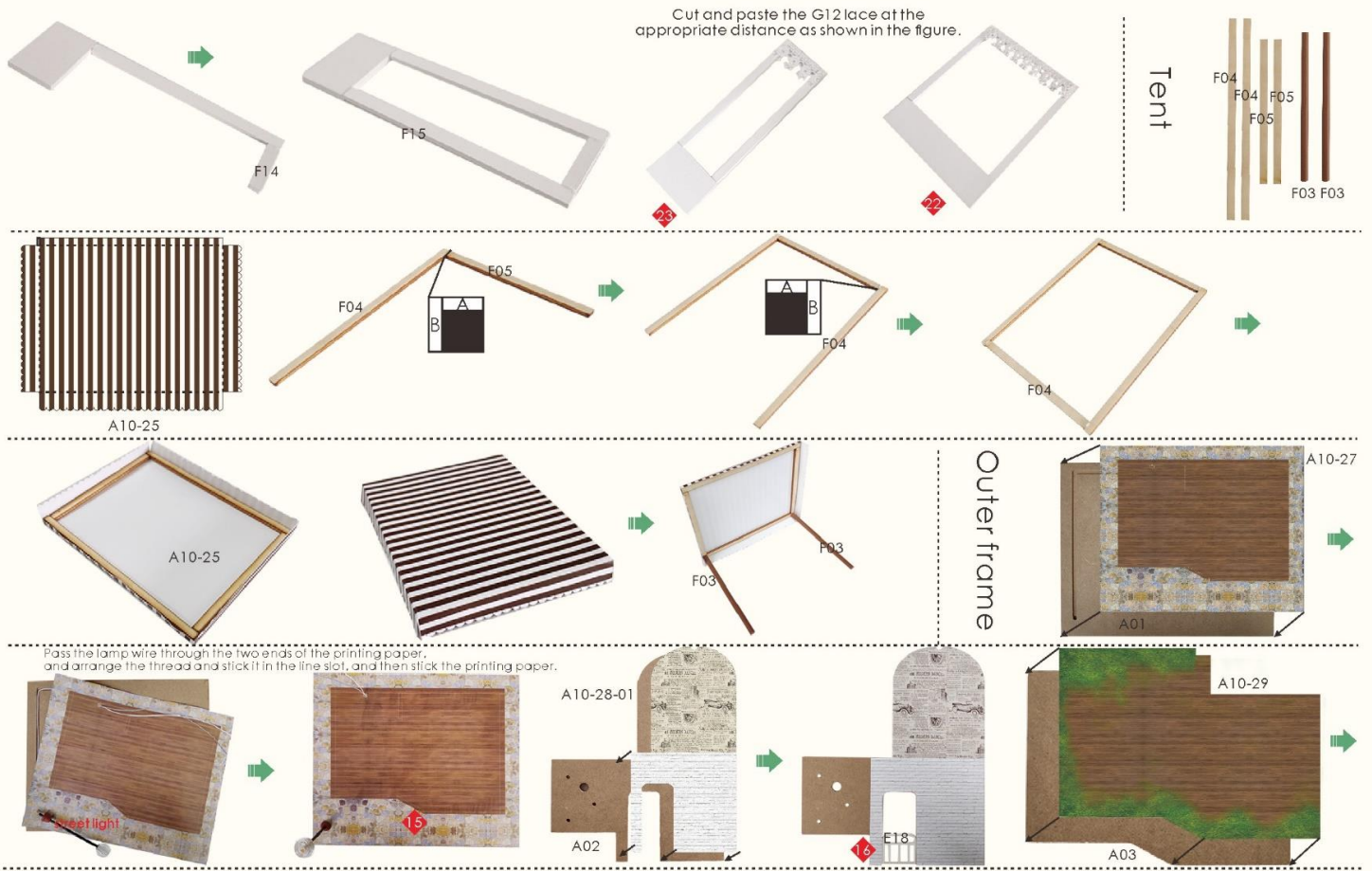



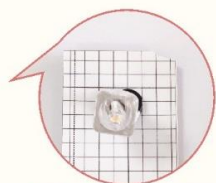

Note: Cut a small corner with a small knife on the printed paper that is not recessed.



back view



A10-34-02



**Music machine core manual guide**  
(If you have purchased the music machine core, please fix it firstly)

K04 Music machine core 1 piece	K05 Screw 3 pieces	K06 Music machine core handle 1 piece

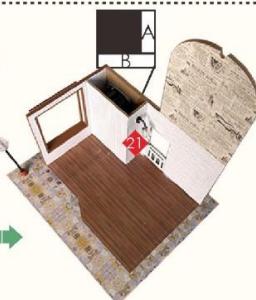

A10-35

left window



A10-37



G19(10.5\*12.3cm)

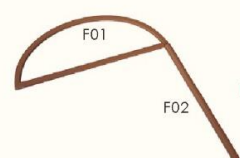

chandelier



Use dried flowers H01, H02, H03, properly pasted on fence and roof.



potted plant 3

small purple flower



After the chandelier passes through the line hole, the line on the back is as shown in the figure.



How to assemble the battery holder

**Statement: the lamp wires cannot be inserted into the output socket.**

- - Can use 7 batteries
- - Please notice the place of anode and cathode when put in the batteries
- - Rechargeable batteries are not blunt electricity
- - Rechargeable batteries can only be charged under adult supervision

- - Rechargeable batteries should be removed from the toy before charging
- - Different types of batteries cannot mix
- - Do not mix new batteries in use with semi-used batteries.
- - Run out of battery should be removed from the toy
- - The power shall not be short circuit



Trim all the LED wiring to the same length. Use a craft blade to carefully skim over the plastic to bare the copper wire. Twist the same color wire together.

Twist the following wire together:  
 (I) BLACK wire from the battery box with the WHITE wire from LED bulb.  
 (II) RED wire from the battery box with the GREY wire from LED bulb.

Roll and seal the duty twist copper with the white tape J07 provided.

**Installation of dust proof cover**  
 (For updated version, the parts need to be purchased separately)

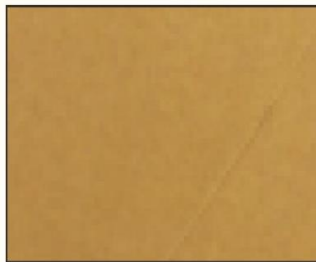

scale 1:5  
 K01 Transparent cover  
 21\*17.8\*0.15cm  
 1piece



scale 1:6  
 K02 Transparent cover  
 23\*21\*0.15cm  
 2pieces

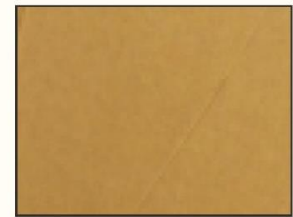

scale 1:4  
 K03 Transparent cover  
 23\*17.5\*0.15cm  
 2pieces



1. Tear off kraft paper of each piece of transparent cover.

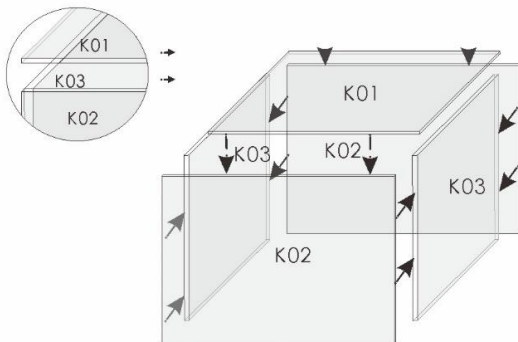

2. Paste K01, K02 and K03 together to complete the dust proof cover as shown.

**Photo of Dust proof cover**



**Attention: Please keep the instruction for future enquires after installation.**



# M906 Material list unit:cm

<b>Bag A</b>	scale: 9 A01 board (brown edge) 21.8*17.8*0.5cm (1piece)	scale: 9 A02 board (brown edge) 21.7*17.8*0.5cm (1piece)	scale: 7 A03 board (brown edge) 17.8*13*0.5cm (1piece)	scale: 8 A04 board (brown) 18.3*12.5*0.5cm (1piece)	scale: 5 A05 board (brown edge) 11.5*10.5*0.5cm (1piece)	scale: 4 A06 board (wood color) 10.5*7*0.3cm (1piece)	scale: 4 A07 board (wood color) 10.5*2.7*0.3cm (1piece)
scale: 4 A08 board (wood color) 7.5*7.2*0.3cm (1piece)	<b>Bag B</b>	scale: 2 B01 wood (dark apricot) 4.2*3*0.2cm (1piece)	scale: 1 B02 wood (dark apricot) 3*0.9*0.2cm (2pieces)	scale: 1 B03 wood (dark apricot) 3*1.1*0.2cm (1piece)	scale: 1 B04 wood (dark apricot) 3*1.5*0.2cm (1piece)	scale: 2 B05 wood (dark apricot) 4.2*1.7*0.2cm (2pieces)	scale: 1 B06 wood (white) 2.6*2.2*0.2cm (1piece)
scale: 1 B07 wood (black) 2*2*0.2cm (1piece)	scale: 1 B08 wood (black) 2*2*0.2cm (1piece)	scale: 2 B09 wood (brown) 4.5*2.4*0.2cm (1piece)	scale: 2 B10 wood (brown) 2.7*2.5*0.2cm (1piece)	scale: 2 B11 wood (white) 3.3*2.3*0.2cm (2pieces)	scale: 2 B12 wood (white) 3.3*2.3*0.2cm (2pieces)	scale: 1 B13 wood (white) 1.7*1.7*0.2cm (2pieces)	scale: 1 B14 wood (white) 2.4*1*0.2cm (2pieces)
scale: 2 B15 wood (wood color) 3.2*3.2*0.2cm (1piece)	scale: 1 B16 wood (black) 1.8*1.8*0.2cm (1piece)	scale: 1 B17 round wood (black) Φ=0.4*2.7cm (1piece)	scale: 1 B18 wood (white) 2.5*1*0.2cm (7pieces)	scale: 2 B19 wood (white) 2.5*2.5*0.2cm (1piece)	scale: 2 B20 wood (brown) 4.5*4.1*0.2cm (2pieces)	scale: 3 B21 wood (brown) 8.4*1.2*0.2cm (2pieces)	<b>Bag c</b>
scale: 2 C01 wood (wood color) 3.9*1.8*0.2cm (1piece)	scale: 2 C02 wood (light apricot) 3.6*3.5*0.2cm (1piece)	scale: 2 C03 wood (light apricot) 3.6*1.4*0.2cm (4pieces)	scale: 1 C04 wood (grey) 1.2*0.5*0.4cm (1piece)	scale: 1 C05 wood (grey) 1.5*1.3*0.2cm (2pieces)	scale: 1 C06 wood (grey) 2*1.3*0.2cm (1piece)	scale: 1 C07 wood (light apricot) 3*0.5*0.2cm (2pieces)	scale: 1 C08 wood (light apricot) 3*1.4*0.2cm (2pieces)
scale: 1 C09 wood (wood color) 1.3*1.3*0.15cm (1piece)	scale: 1 C10 wood (light apricot) 2*1.5*0.15cm (2pieces)	scale: 2 C11 wood (light apricot) 4.5*1*0.2cm (1piece)	scale: 2 C12 wood (light apricot) 4.3*2.3*0.2cm (1piece)	scale: 1 C13 wood (light apricot) 2.3*2*0.2cm (2pieces)	scale: 2 C14 wood (dark apricot) 2.4*2.4*0.2cm (4pieces)	scale: 1 C15 wood (wood color) 1.7*1.7*0.2cm (2pieces)	scale: 1 C16 wood (wood color) 1.9*1.7*0.2cm (2pieces)

# M906 Material list unit:cm

scale: 2 C17 wood (brown) 4.2*2.2*0.2cm (2pieces)	scale: 1 C18 wood (brown) 2.5*1.5*0.2cm (1piece)	scale: 1 C19 wood (brown) 2.5*2*0.2cm (1piece)	scale: 2 C20 wood (black) 0.8*0.8*0.2cm (1piece)	<b>Bag D</b>	scale: 2 D01 wood (brown) 4.8*1.1*0.2cm (2pieces)	scale: 2 D02 wood (brown) 4.8*4.6*0.2cm (2pieces)	scale: 3 D03 wood (brown) 5.2*1.5*0.2cm (1piece)
scale: 2 D04 wood (brown) 4.6*1*0.2cm (1piece)	scale: 2 D05 wood (brown) 4.6*0.5*0.2cm (1piece)	scale: 2 D06 wood (brown) 4.1*0.4*0.2cm (1piece)	scale: 2 D07 wood (brown) 4.1*0.8*0.2cm (2pieces)	scale: 1 D08 wood (brown) 2.2*1*0.2cm (2pieces)	scale: 1 D09 wood (brown) 1*1*0.2cm (2pieces)	scale: 1 D10 wood (brown) 2*1.5*0.2cm (1piece)	scale: 1 D11 wood (brown) 1.8*1.8*0.2cm (2pieces)
scale: 1 D12 wood (brown) 1*0.2*0.2cm (2pieces)	scale: 3 D13 wood (mint green) 6.5*2*0.2cm (1piece)	scale: 2 D14 wood (mint green) 2.8*2.4*0.2cm (1piece)	scale: 2 D15 wood (mint green) 4.2*3.5*0.2cm (1piece)	scale: 1 D16 wood (mint green) 2.8*1*0.2cm (2pieces)	scale: 2 D17 wood (mint green) 3.7*1.7*0.2cm (2pieces)	scale: 1 D18 wood (light apricot) 1.6*1.6*0.2cm (1piece)	scale: 1 D19 round wood (light apricot) Φ=0.3*2.3cm (3pieces)
scale: 4 D20 wood (white) 8.8*2.3*0.2cm (1piece)	<b>Bag E</b>	scale: 2 E01 wood (brown) 6*2*0.4cm (1piece)	scale: 2 E02 wood (brown) 4.4*0.8*0.2cm (1piece)	scale: 1 E03 wood (brown) 1*0.4*0.2cm (1piece)	scale: 1 E04 wood (brown) 0.5*0.3*0.2cm (1piece)	scale: 1 E05 wood (light apricot) 2*1.7*0.15cm (2pieces)	scale: 1 E06 wood (light apricot) 1.7*0.2*0.15cm (1piece)
scale: 1 E07 wood (black) 1.8*1.3*0.2cm (1piece)	scale: 1 E08 wood (black) 3*0.2*0.2cm (1piece)	scale: 1 E09 wood (black) 1.1*0.7*0.4cm (1piece)	scale: 2 E10 wood (dark brown) 4.4*1.6*0.2cm (2pieces)	scale: 2 E11 wood (black) 3.6*2.7*0.2cm (2pieces)	scale: 1 E12 wood (white) 2*2*0.2cm (1piece)	scale: 1 E13 wood (white) 2.7*2*0.2cm (1piece)	scale: 5 E14 wood (white) 11.1*2*0.2cm (1piece)
scale: 3 E15 wood (white) 7*2*0.2cm (1piece)	scale: 3 E16 wood (white) 8.2*2*0.2cm (1piece)	scale: 3 E17 wood (white) 6.9*2*0.2cm (1piece)	scale: 2 E18 wood (white) 3.2*3*0.2cm (1piece)	scale: 2 E19 wood (white) 4.5*3.6*0.2cm (2pieces)	<b>Bag F</b>	scale: 4 F01 wood (brown) 9*3.3*0.2cm (1piece)	scale: 3 F02 round wood (brown) Φ=0.4*7.3cm (1piece)

M906 Material list unit:cm

(3/4)

scale1: 3 F03 roundwood (brown) Φ=0.4*8cm (2piece)	scale1: 4 F04 wood (wood color) 10*0.4*0.2cm (2piece)	scale1: 3 F05 wood (wood color) 7.2*0.4*1.2cm (2piece)	scale1: 4 F06 roundwood (brown) Φ=0.4*10.3cm (1piece)	scale1: 3 F07 wood (white) 6.5*2*0.3cm (1piece)	scale1: 3 F08 wood (white) 6.5*1*0.2cm (1piece)	scale1: 2 F09 wood (dark yellow) 6.8*0.6*0.2cm (2pieces)	scale1: 3 F10 wood (dark yellow) 6.5*1.5*0.2cm (1piece)
scale1: 3 F11 wood (khaki) 6.8*2.6*0.2cm (2pieces)	scale1: 3 F12 wood (brown) 7.7*1.3*0.2cm (2piece)	scale1: 2 F13 wood (brown) 6.2*1.3*0.2cm (2pieces)	scale1: 1 F14 wood (white) 2.1*0.5*0.3cm (1piece)	scale1: 3 F15 wood (white) 8.4*0.5*0.3cm (4pieces)	scale1: 1 F16 wood (white) 3.1*2.1*0.3cm (1piece)	scale1: 3 F17 wood (white) 7*0.5*0.3cm (1piece)	scale1: 3 F18 wood (white) 8*2.1*0.3cm (1piece)
Bag G	G01 cloth (blue) 11.8*4.7cm(1piece)	G02 check cloth (brown) 4*4cm(1piece)	G03 cloth (brown) 3.3*2.5cm(1piece)	G04 cardboard (white) 9.7*6cm(1piece)	G05 non-woven fabric (white) 4.6*4cm(1piece)	G06 non-woven fabric (brown) 3.6*2cm(1piece)	G07 non-woven fabric (yellow) 6.4*3cm(1piece)
G08 non-woven fabric (red) 2*1.2cm(1piece)	G09 non-woven (green) 1.2*1cm(1piece)	G10 creased cloth (white) 8*5cm(1piece)	G11 reticulated cloth (white) 8*5cm(1piece)	G12 lace (white) 10.2cm(1piece)	G13 paper (green) 10*7cm(1piece)	G14 paper (green) 5.5*2.4cm(1piece)	G15 paper (white) 3.2*3cm(1piece)
G16 paper (yellow) 4*2cm(1piece)	G17 paper (purple) 3*3cm(1piece)	G18 artificial plant (green) 2pieces	G19 corrugated paper (dark brown) 12.5*11cm(1piece)	G20 plastic bag (transparent) 4pieces	G21 paper rope (brown) 50cm(1piece)	Bag H	H01 dried flower (green) some
H02 dried flower (dark green) some	H03 dried flower (red) some	H04 flower bud (purple) 4pieces	H05 big wooden bead (wood color) 1piece	H06 wooden bead (wood color) 4pieces	H07 wooden bead (brown) 2pieces	H08 wooden bead (wood color) 1piece	H09 wooden bead (white) 1piece

M906 Material list unit:cm

(4/4)

H10 wooden bead (wood color) 1piece	H11 wooden bead (black) 3pieces	H12 Iron bead (silver) 3pieces	H13 iron bead (silver) 1piece	H14 transparent film 20*12cm(1piece)	H15 eyelet (silver) 3pieces	H16 plastic bead (transparent) 2pieces	H17 plastic bead (transparent) 1piece
H18 plastic bead (transparent) 3pieces	H19 plastic hose (black) 13cm(1piece)	Bag J	J01 iron wire (green) 65cm(1piece)	J02 iron wire (black) 25cm(1piece)	J03 iron wire (white) 15cm(1piece)	J04 line (white) 60cm(1piece)	J05 led lamp with wire 5pieces
J06 battery holder 1piece	J07 adhesive paper 1piece	J08 sand paper 1piece					