

M903

DIY mini house kits – Houguang studio



M903 Instruction manual

NOTICE OF ASSEMBLE

Tips for assembling

1. Pictures shown on the package may be slightly different from the actual product.
2. All the materials are taken in the operation step, put the remaining materials back into the original pocket until the installation is completed. (Avoid material loss during installation)
3. The dimensions indicated in the step diagram are "cm".
4. If there have template paper material, please cut the material according to the template to avoid mistakes..
5. According to the part rule example at the bottom of this page, refer to the part on the part number drawing, find the material object and compare with the material list, confirm and install. (Wooden parts only)
6. Glue should not be applied too much, so as not to dry longer, overflow will affect the effect of the finished product.
7. Part shapes may differ from the photographs depending on the production batch

Testing on LED function

Be sure to test the LED lights before making the lighting, note that the LED white wire to the negative, gray wire to the positive reference to the following figure operation test.

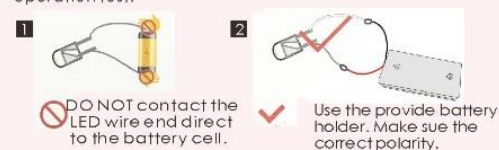

Product comes with tool:



Bring your own tools:



How to assemble the battery holder

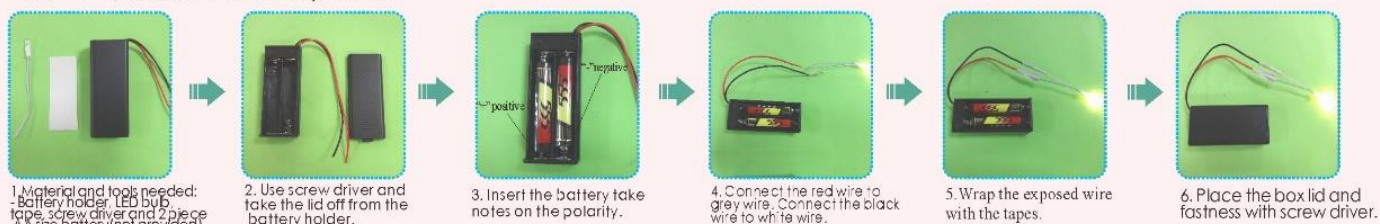

Example of parts rule:

A01: The parts are directly in the box.; B01: parts in bag B; C01: part in bag C, and so on.
(Note: display the printing paper A10-01 in the step: the printing paper is placed directly in the box, part number is A10-01)

details of miniature kit

Name	Material package
printing paper	Bag A-A10(All printing and template papers are shown on A10 paper, total 3 pieces A4)
Decoration	G bag + printing paper
Bass guitar	B bag + F bag + printing paper
Roof light	B bag + F bag + G bag + H bag
Table	B bag + F bag + printing paper
Radio & Earphone	B bag + F bag + G bag + printing paper
Tambourine	B bag + printing paper
Sofa	B bag + F bag + G bag
Big flower pot	B bag + F bag + G bag + printing paper
Steps	B bag
Fence	B bag
Small chair	C bag
Audio	C bag + F bag + G bag + printing paper
Cabinet	C bag + F bag + G bag + printing paper
Rack drum	C bag + F bag + printing paper
Flower pot	C bag + F bag + G bag
Round stool	D bag
Microphones and signs	D bag + F bag + printing paper
Box and small table	D bag + F bag + G bag + printing paper
Door and window	D bag + F bag + printing paper
Bay Window	E bag
Lintel	E bag
White french window	E bag
Outer frame	A bag + D bag + E bag
Outer frame	A bag + E bag
Plant	F bag + G bag + H bag
Light	F bag + G bag + H bag
Guzheng	D bag + F bag + G bag + printing paper
Battery holder	H bag
Dust cover	J bag

Thumbnail of material list (reference only)

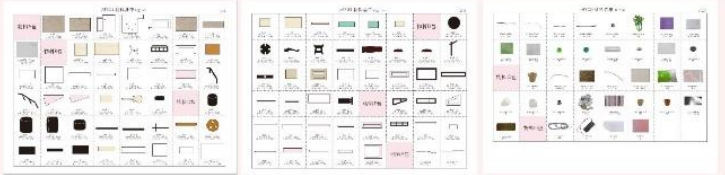

Thumbnail of printing paper & template paper (reference only)

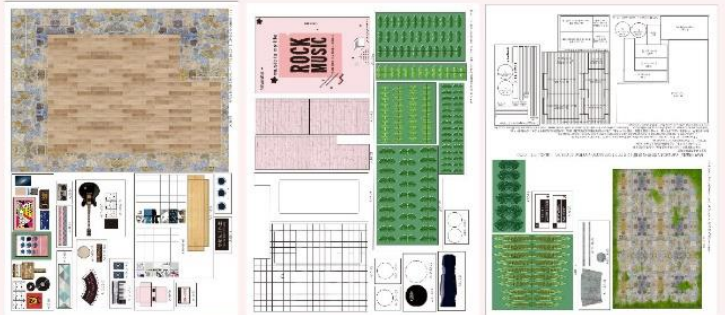

Symbol description used

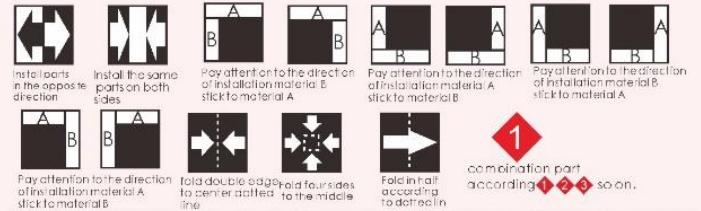

2

Decoration



Bass guitar

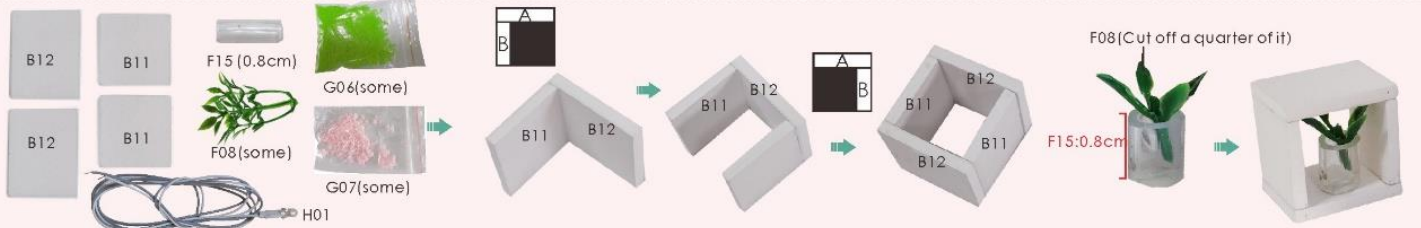

3

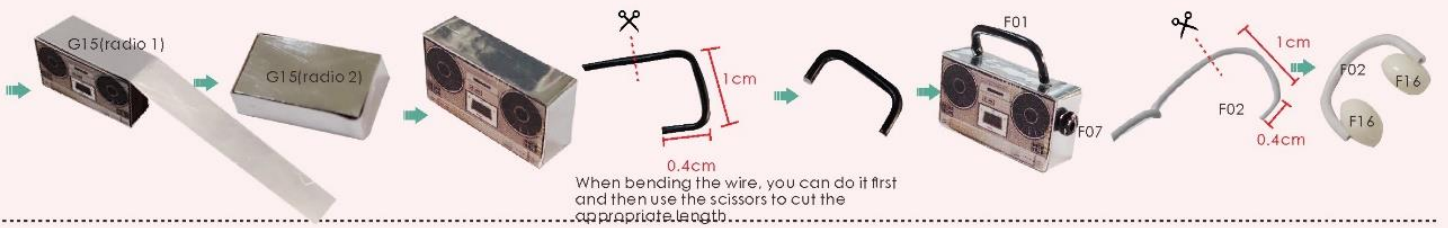

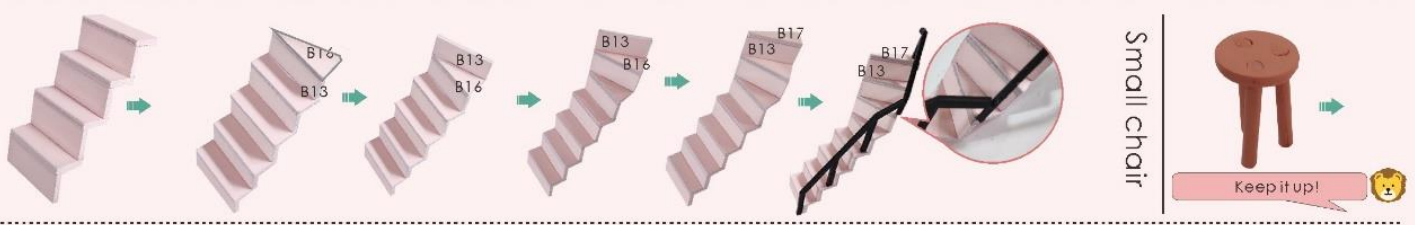
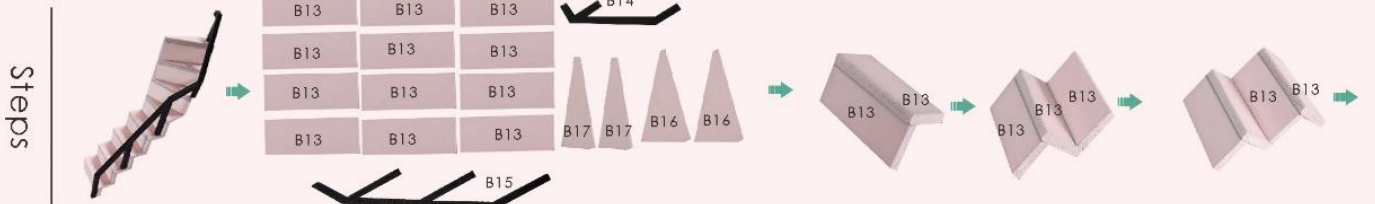
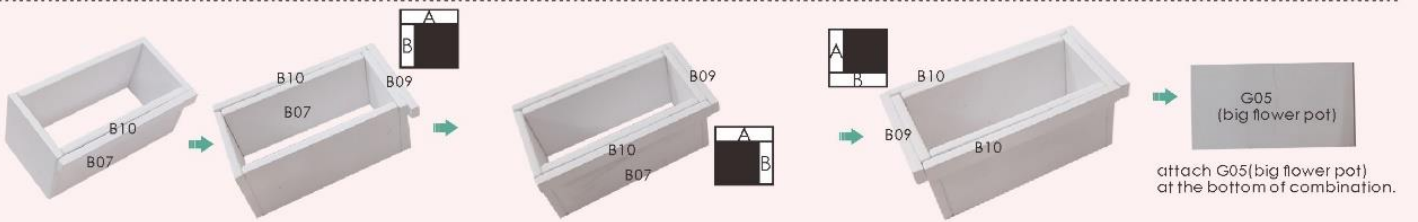
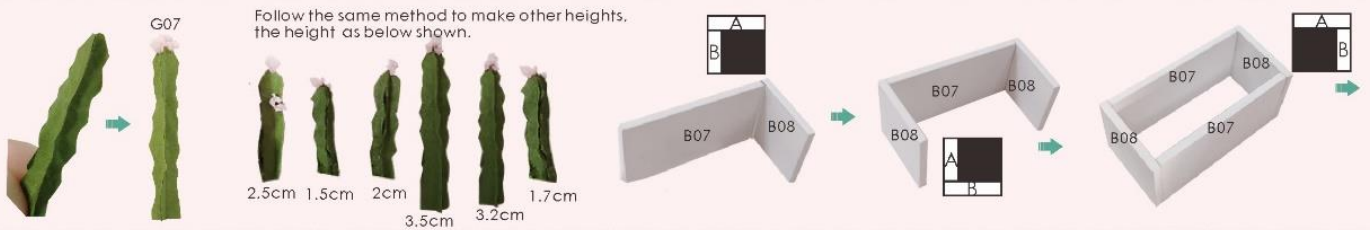
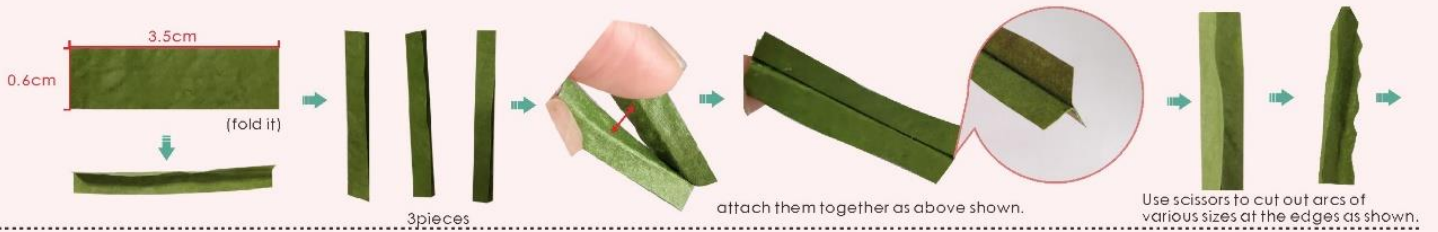



Cabinet

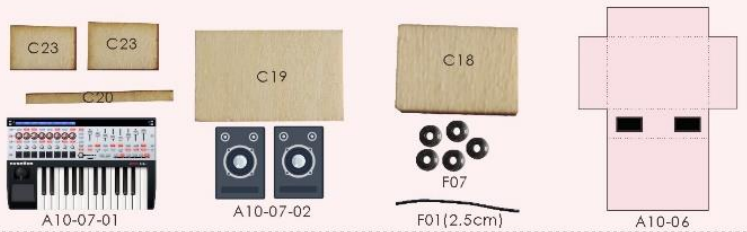

A10-07-01

A10-07-02

F01(2.5cm)

A10-06

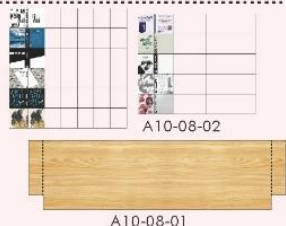
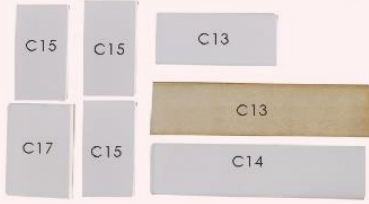

2pieces



A10-07-01

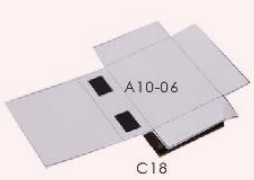

A10-06



A10-07-02



F01



F07

F07



F07



8

fold A10-08-02 in a "Z" form according to the line

If the wire doesn't fit into the bead hole, glue it together

Glue the inside of the book.



Cut the book along the line



A10-08-01



C14

C15

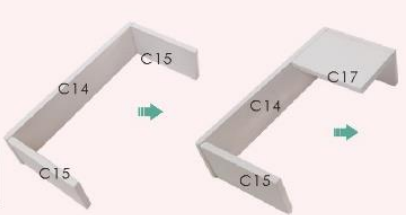

C14

C15

C17

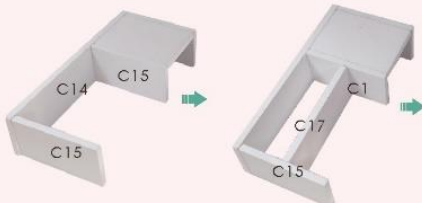

C14

C15

C17

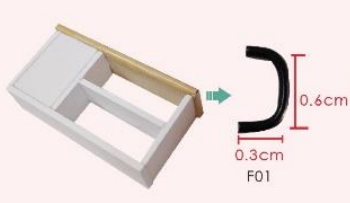

F01



Rack drum

Patience and perseverance can help you do better!

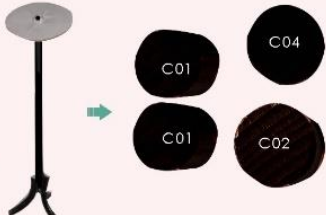

Cut out the material G15 according to the template paper before making.

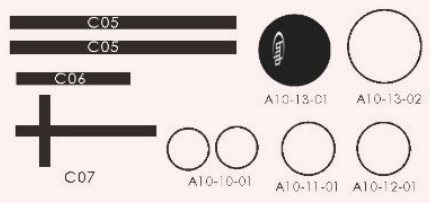

A10-10-01



G15 (small drum)

two pieces



A10-12-01

C04



G15 (middle drum 1)



A10-11-01

C02

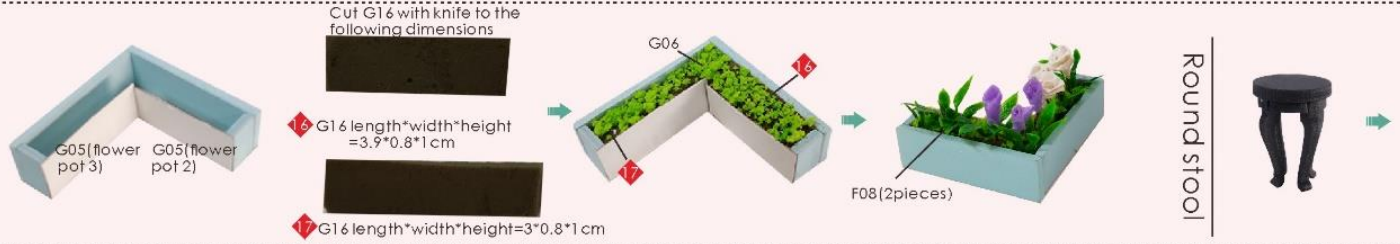
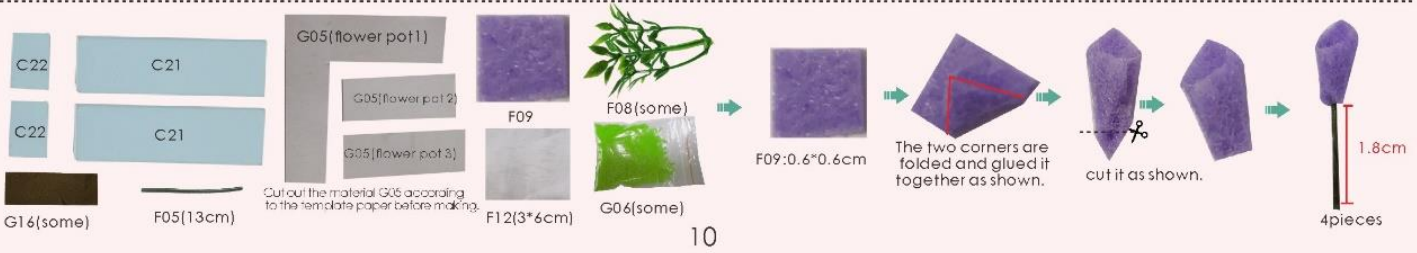

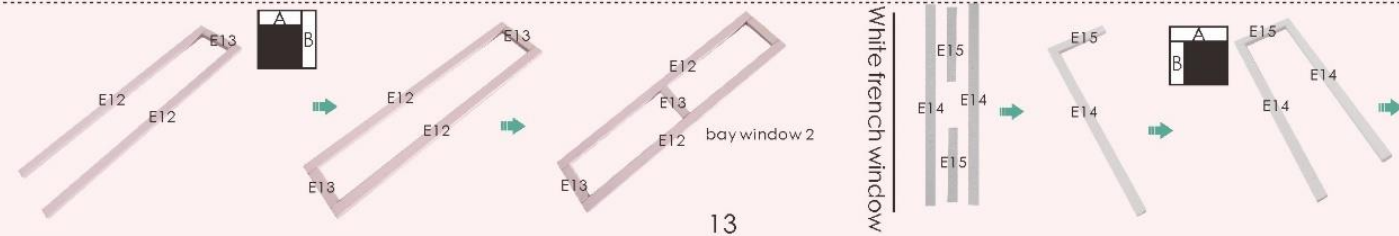
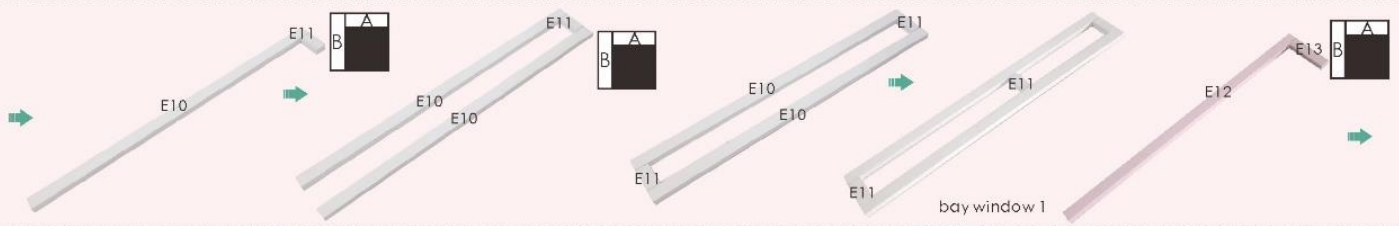
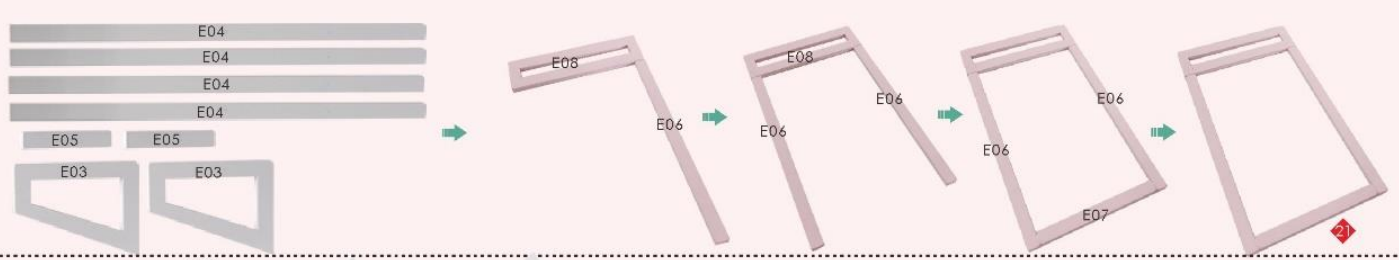
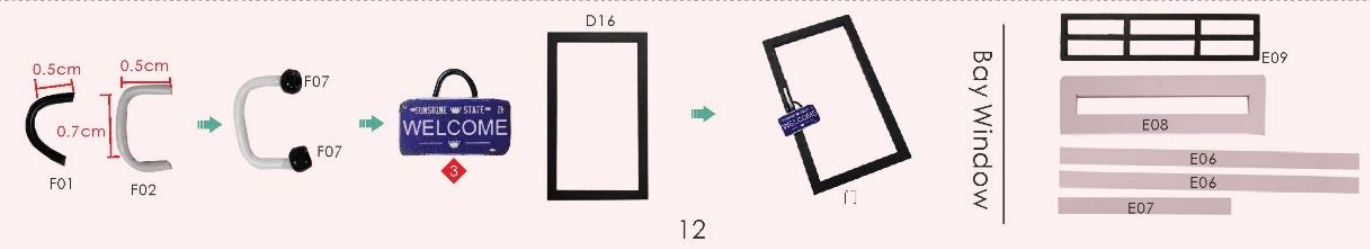
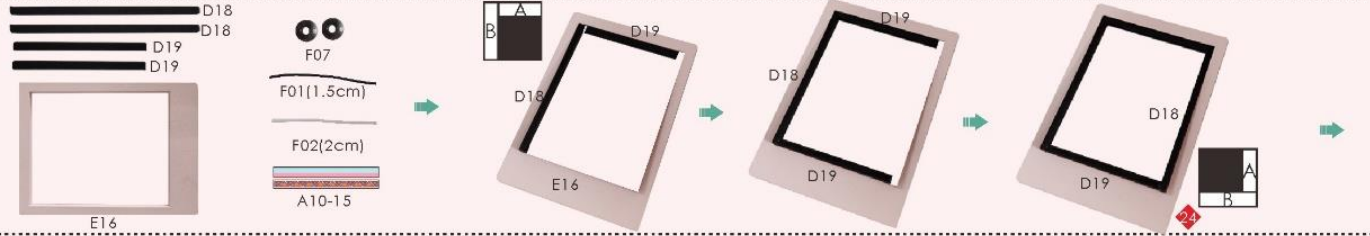
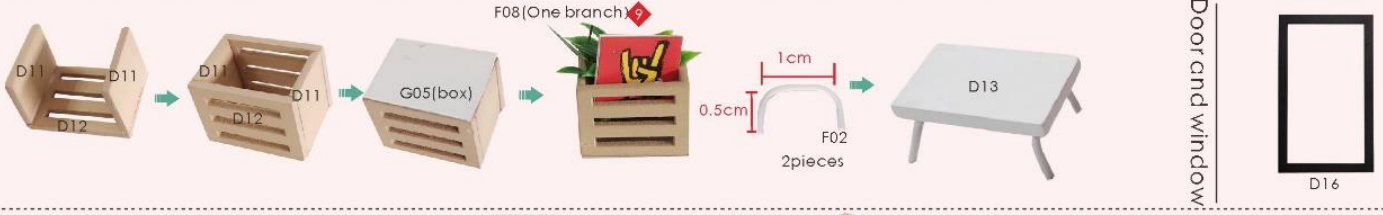
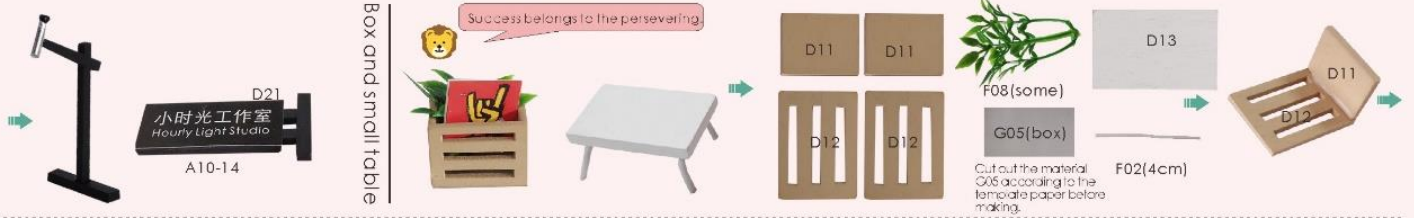



Outer Frame Component

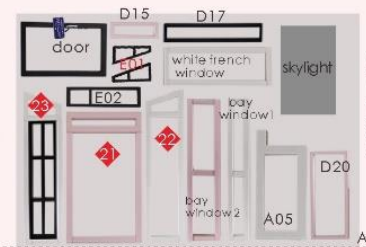
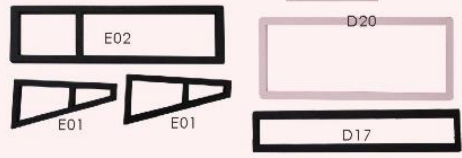

A part that has been partially made (Please refer to page 17 for the production of A05), as shown on the A08 PVC film, then cut out with scissors.

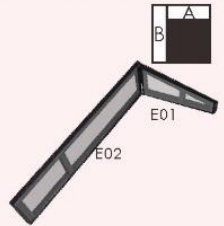

Light

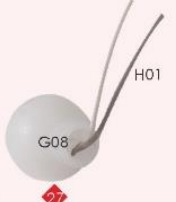

Wrap the wire around the hose twice, then cut the wire.

Plant

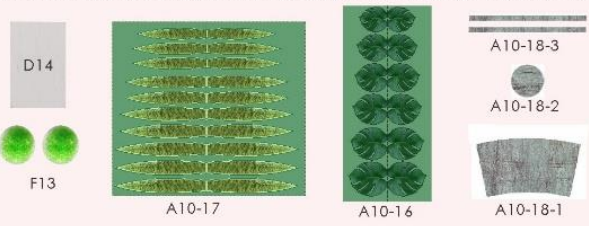

14

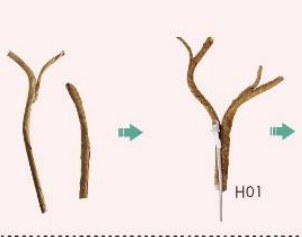
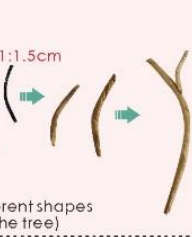
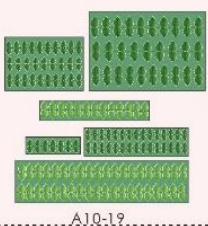

The wire is bent as shown in the picture

Use G03 around the wire

The wire can be bent into different shapes (depending on the shape of the tree)

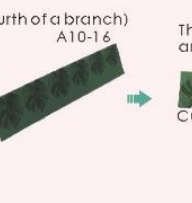

Use G02 to wrap hose

use G02 around it

F08 (Cut out one fourth of a branch) A10-16

Thread the wire over the notches, glue the print, and finally cut the leaves out.

Cut a notch in half

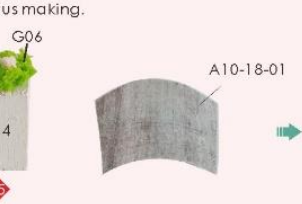

A10-17

Please refer to page 3 for cactus making.

the method as same.

Please refer to page 10 for purple flowers

Please refer to the previous section for the production of flowers.

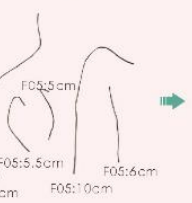
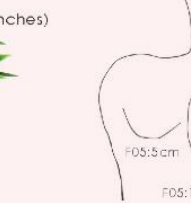

A10-18-03

F08 (2 Branches)

A10-19

F05:5cm

For leaf making, please refer to the previous section.

A10-18-02

F05:6.5cm

F05:7cm

F05:10cm

F05:5cm

F05:1.7cm

15

The wire is bent as shown in the picture



Vine

Gu zheng



Come on! It's almost finished!!



A10-20



A10-20

Note: When pulling the string, you can straighten the wire and glue it after twisting the back.



A10-20



Outer frame



A10-21



16

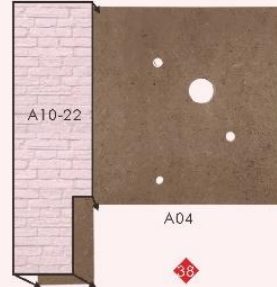

A10-22



A10-23



Note: When linking the eaves, there is a gap that can be cut at right angles with a cutting tool.



A10-27



A10-24

A05



T40



A10-25

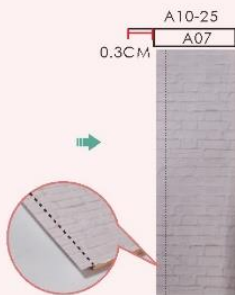

0.3CM

A10-25

Note: Use a cutting tool to cut an angle on each side of the paper that does not protrude.

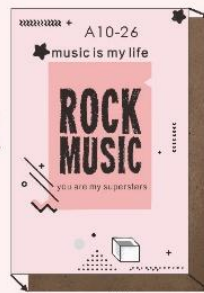

A10-26

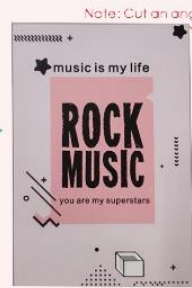

Note: Cut an angle with a cutting tool



A10-29



A10-29

17

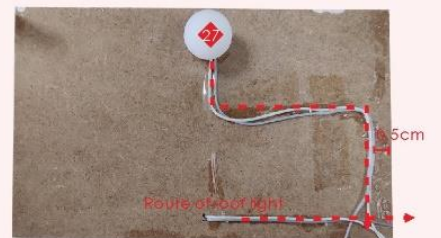

Route of root light

The direction in which the wire is running

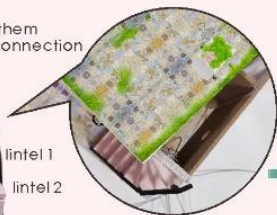
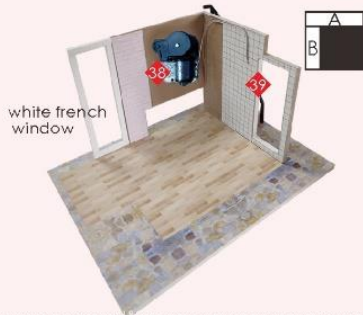



Statement: the lamp wires cannot be inserted into the output socket.

- Can use 7 batteries
- Please notice the place of anode and cathode when put in the batteries
- Rechargeable batteries are not blunt electricity
- Rechargeable batteries can only be charged under adult supervision
- Rechargeable batteries should be removed from the toy before charging
- Different types of batteries cannot mix; Do not mix new batteries in use with semi-used batteries.
- Run out of battery should be removed from the toy
- The power shall not be short circuit



20



Twist the following wire together:
 (I) BLACK wire from the Battery box with the WHITE wire from LED bulb.
 (II) RED wire from the battery box with the GREY wire from LED bulb.

Roll and seal the duly twist copper with the white tape H03 provided.

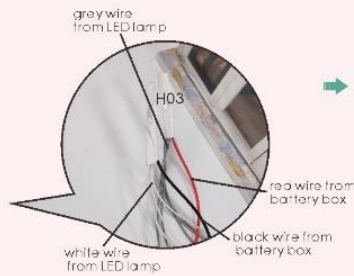

Place the battery box in the allocated space.

Installation of dust proof cover
 (For updated version, the parts need to be purchased separately)

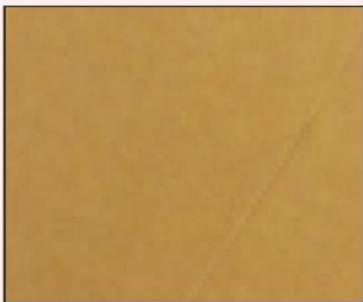

scale 1:4
 J04 Transparent cover
 20*16.5*0.15cm
 2pieces

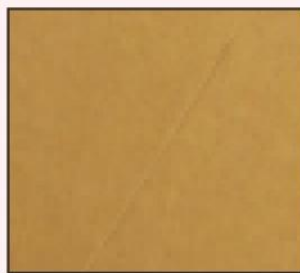

scale 1:4
 J05 Transparent cover
 16.5*14.7*0.15cm
 2pieces



scale 1:4
 J06 Transparent cover
 20*15*0.15cm
 1piece



1. Tear off kraft paper of each piece of transparent cover.

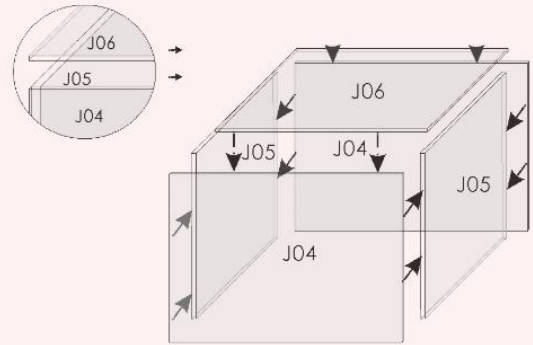

2. Paste J04, J05 and J06 together to complete the dust proof cover as shown.



Photo gallery

22

Photo of Dust proof cover



Photo gallery



Attention: Please keep the instruction for future enquires after installation.