

M032

DIY handmade goods— Blue Coast



Instruction Manual

NOTICE OF ASSEMBLE

Making tips

1. LED wiring indication:
White=Positive; Grey=Negative.
2. Use a craft blade to carefully skim over the plastic to bare the copper wire.
3. For LED wiring extension, please refer to the below steps:

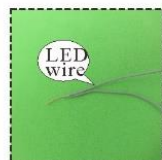
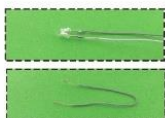

Twist the copper of both LED wire and extension wire together.

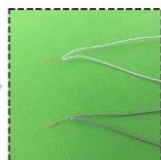

Do the same on the white wire.
Remarks: Tie a knot at the end of the grey wire to differentiate the polarity.

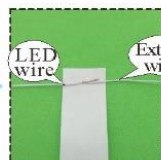

Place the duly twist wire on the tapes provided.



Roll and wrap the wire.



Place another wire next to it.
Remarks: DO NOT contact both copper wire to avoid short circuit.

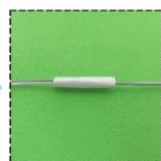

Roll and wrap it together.

Warnings

- The product is not suitable for children under 14 years old. The should be under custody of adults when playing with the product.
- There are small parts, please do not swallow them for avoiding dangerous accidents.
- Please also pay attention to the sharp-pointed materials to avoid injuries.

Tips for assembling

1. Pictures shown on the package may be slightly different from the actual product.
2. Please use the provided tracing paper for cutting purpose to achieve the best outcome.
3. Product designs and specification maybe subject to change without advance notice for purpose of making improvement.
4. Testing on LED function:



DO NOT contact the LED wire end direct to the battery cell.



Use the provide battery holder.
Make sue the correct polarity.

How to assemble the battery holder



1. Material and tools needed:
- Battery holder, LED bulb, tape



2. Twist the following wire together:
(I) GREY wire from the battery box with the WHITE wire from LED bulb.
(II) WHITE wire from the battery box with the GREY wire from LED bulb.



3. Wrap the exposed wire with the tapes.



Insulating film



5. Toggle the black button to the "ON" position.



6. Complete the connection of the battery box.

Product information



2

Sofa

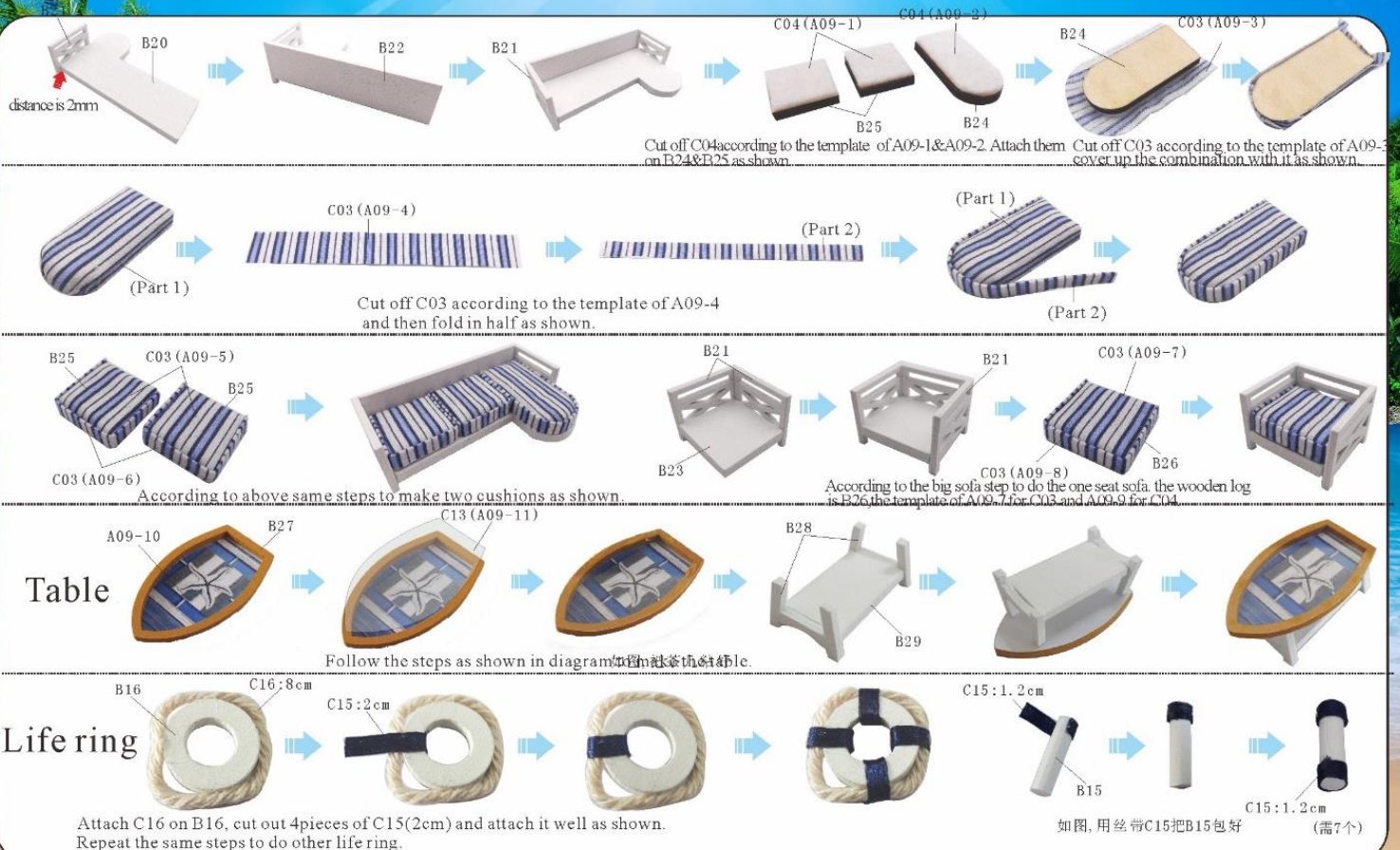

3

Telescope



According to above same steps to fix C24 to C27 together as shown.

Cut out a piece of C43(6cm) and bend it as shown.

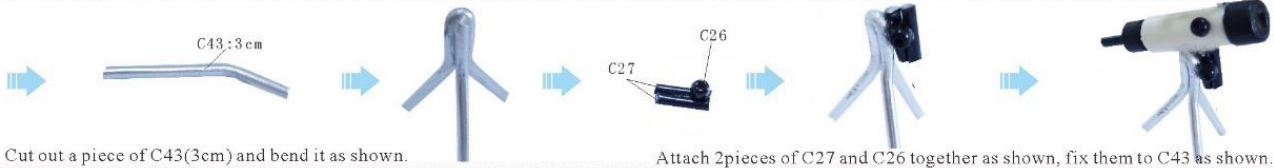

Cut out a piece of C43(3cm) and bend it as shown.

Attach 2pieces of C27 and C26 together as shown, fix them to C43 as shown.

Lighthouse deco



Cut off A09-12 and fold it as shown.

Attach C48 on C17 and fix the power wire as shown. Use the knife and cut a gap on A09-12-2, the power wire trough the gap as shown. Then paste B34 and A09-12-1 on it as shown.

Droplight



Follow the steps as shown to make droplight.

Paddle

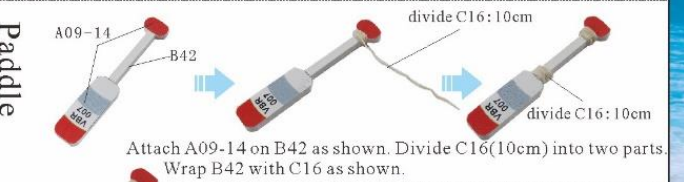

Attach A09-14 on B42 as shown. Divide C16(10cm) into two parts. Wrap B42 with C16 as shown.

Chandelier



cut off A09-13 and fold and fix it as shown. Follow the steps as shown to make chandeliers.

(2pieces)

Small boat

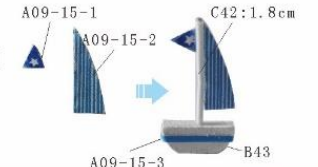

4

Bed

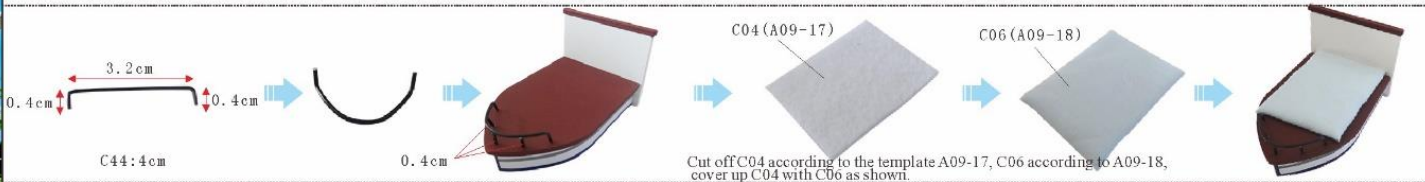
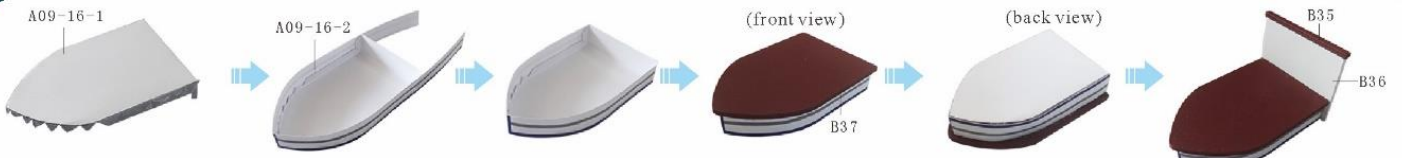

Cut off C04 according to the template A09-17, C06 according to A09-18, cover up C04 with C06 as shown.

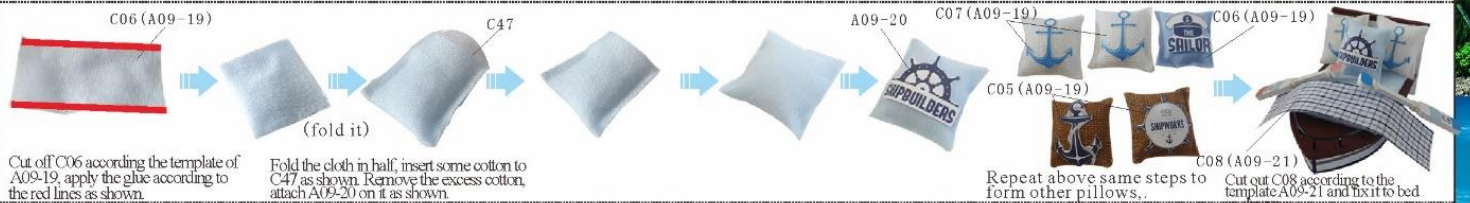

Cut off C06 according the template of A09-19, apply the glue according to the red lines as shown.

Fold the cloth in half, insert some cotton to C47 as shown. Remove the excess cotton, attach A09-20 on it as shown.

Repeat above same steps to form other pillows.

Cut out C08 according to the template A09-21 and fix it to bed as shown.

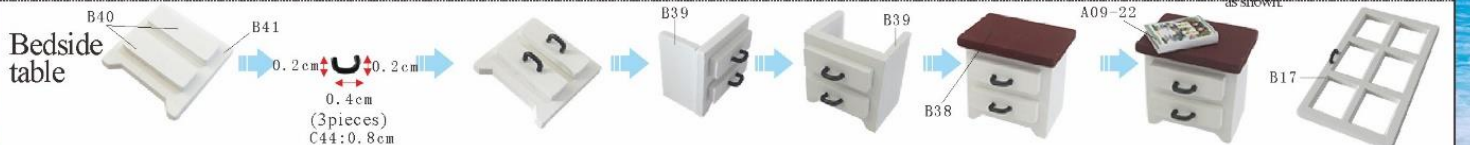

Bedside table

0.2cm
0.4cm
C44: 0.8cm
(3pieces)

Plant

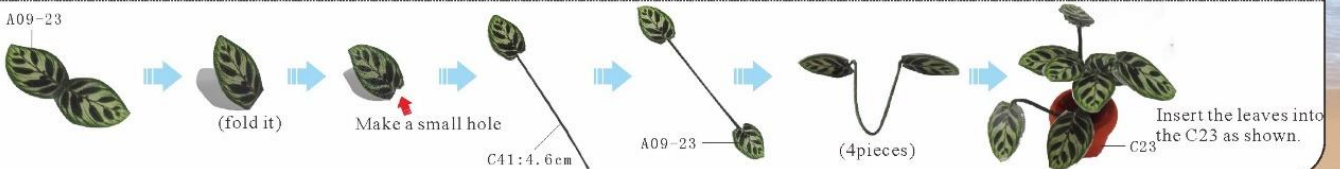

Insert the leaves into the C23 as shown.

5

Flower shelf



Steps

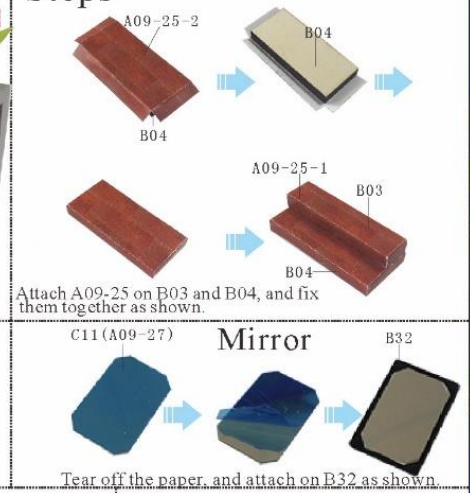

Pillow



Plant

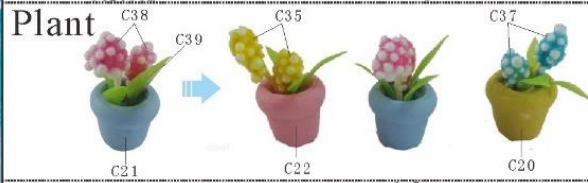

window

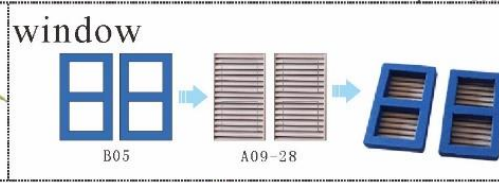

Beach chair

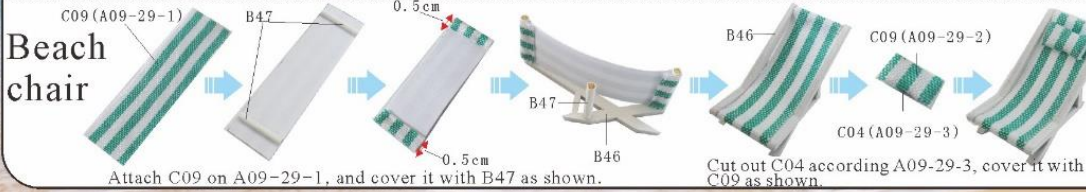

Stair

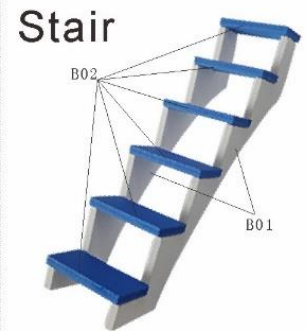

6

Outer frame

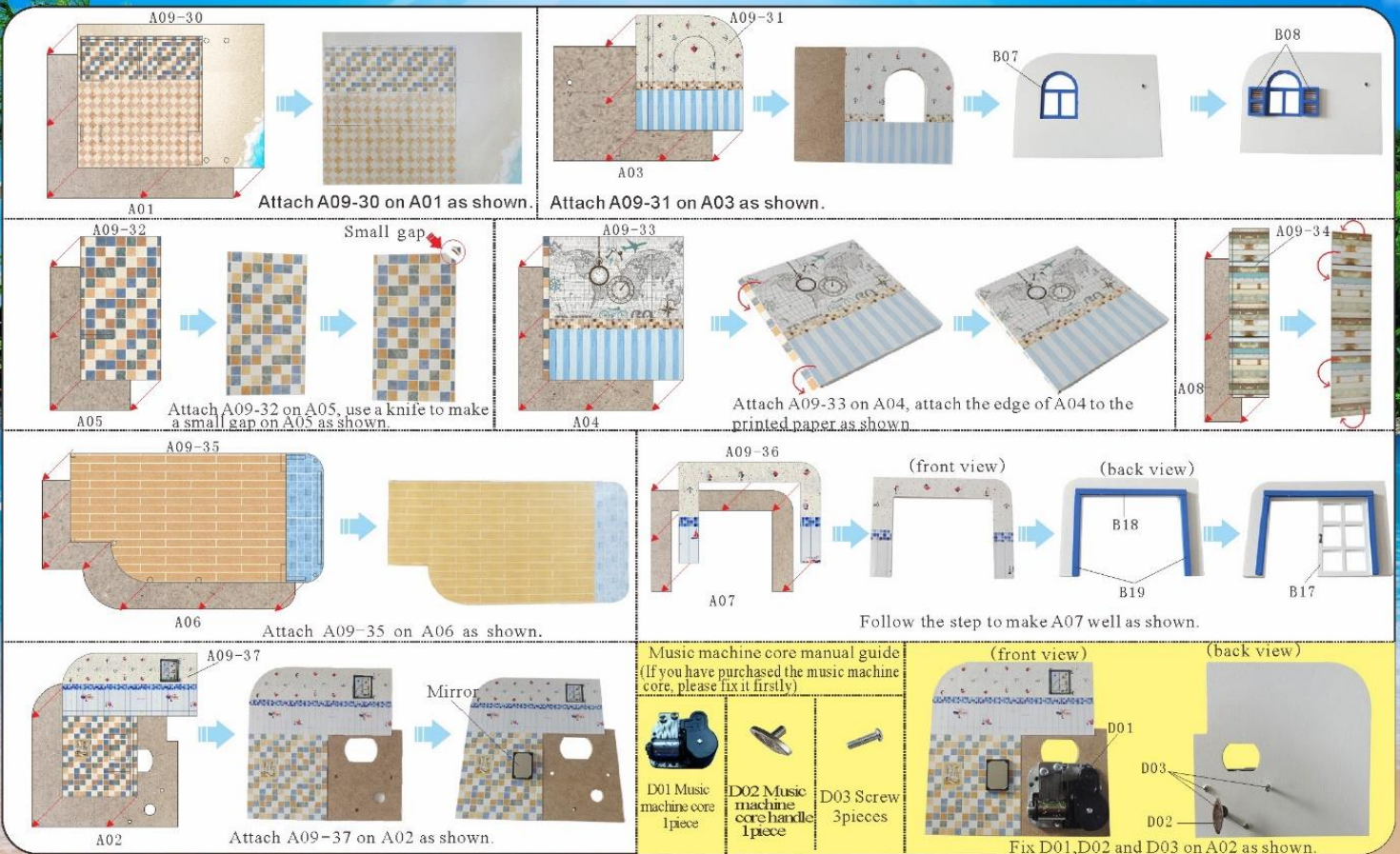

7

Outer frame

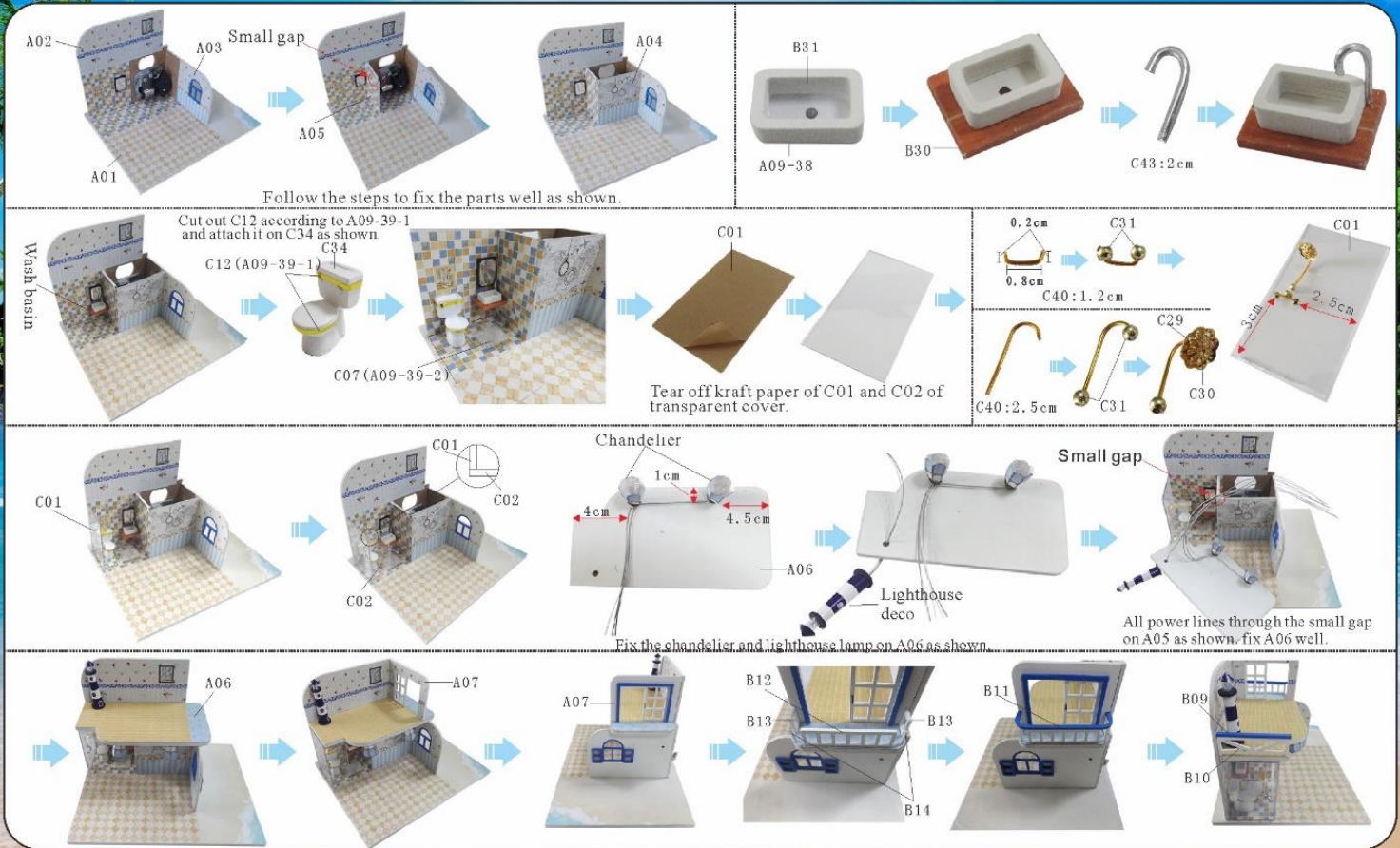

8

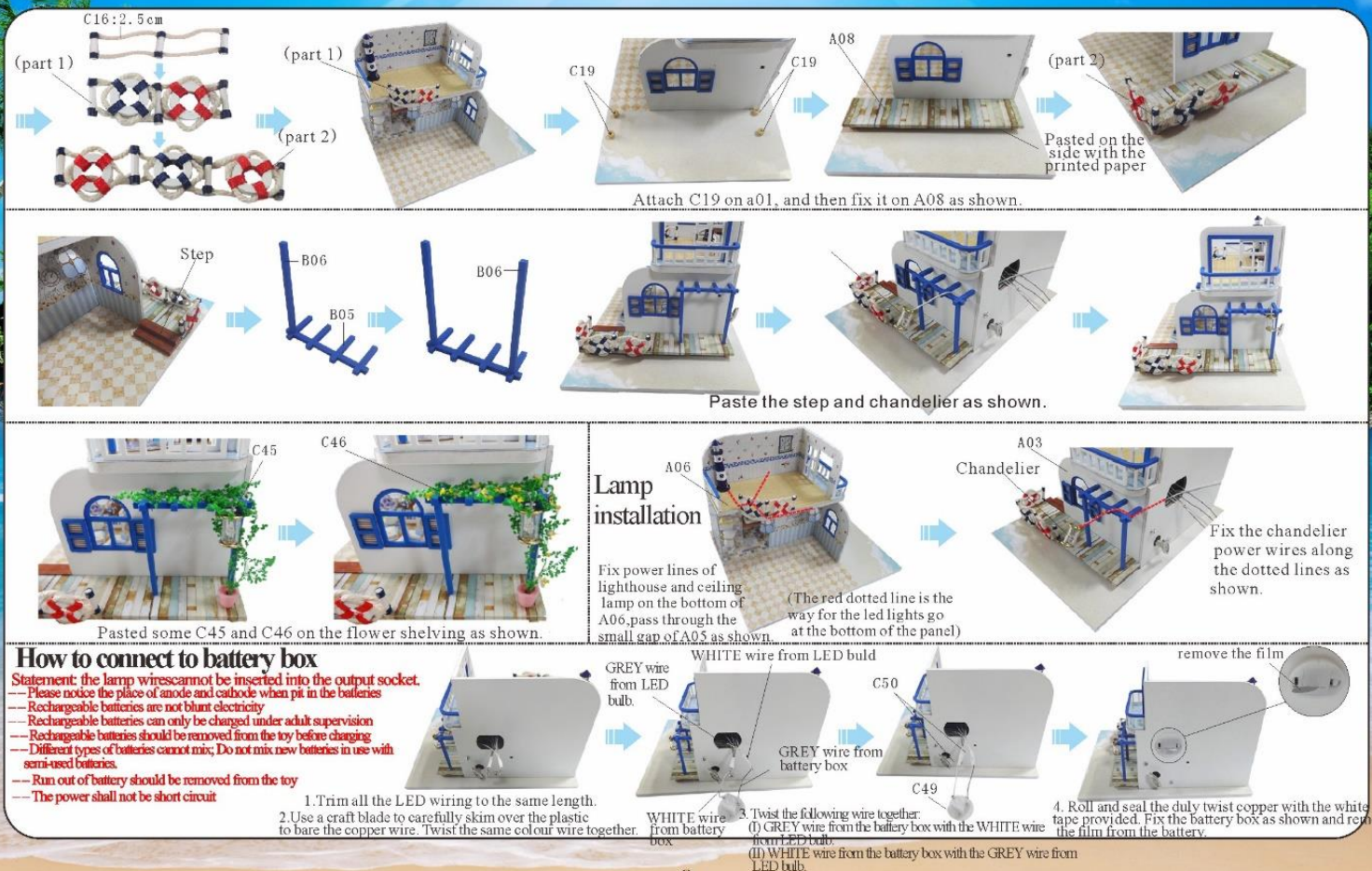

9

Potted plant

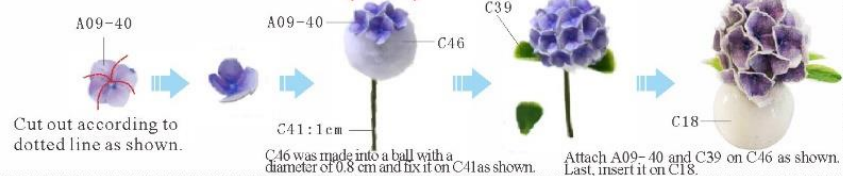

10

Installation of dust proof cover (For updated version, the parts need to be purchased separately)



D04 Transparent cover
0.15*15*19.5(1piece)



D05 Transparent cover
0.15*12.5*19.5(2pieces)



D06 Transparent cover
0.15*2.5*14.7(2pieces)



1. Tear off kraft paper of each piece of transparent cover.

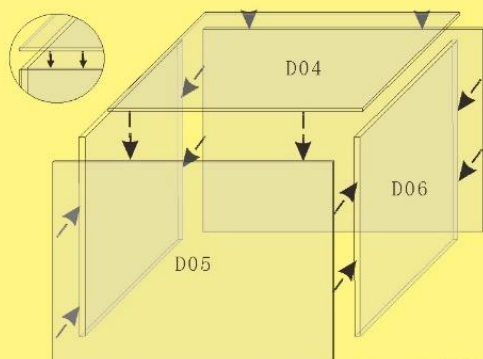

2. Paste D04, D05, and D06 together to complete the dust proof cover as shown.

Photo of Dust proof cover

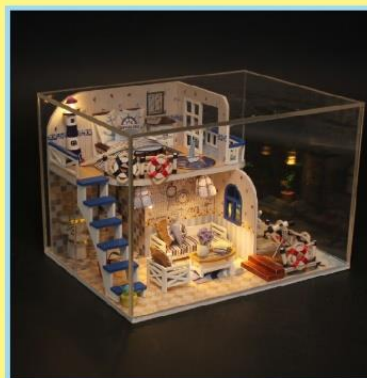

Photo Gallery



Attention: Please keep the instruction manual for future enquires after installation.