

DIY mini house kits – A Splendid Family



L905 Instruction manual

NOTICE OF ASSEMBLE

Tips for assembling

1. Pictures shown on the package may be slightly different from the actual product.
2. All the materials are taken in the operation step, put the remaining materials back into the original pocket until the installation is completed. (Avoid material loss during installation)
3. The dimensions indicated in the step diagram are "cm".
4. If there have template paper material, please cut the material according to the template to avoid mistakes..
5. According to the part rule example at the bottom of this page, refer to the part on the part number drawing, find the material object and compare with the material list, confirm and install. (Wooden parts only)
6. Glue should not be applied too much, so as not to dry longer, overflow will affect the effect of the finished product.
7. Part shapes may differ from the photographs depending on the production batch

Testing on LED function

Be sure to test the LED lights before making the lighting, note that the LED white wire to the negative, gray wire to the positive reference to the following figure operation test.

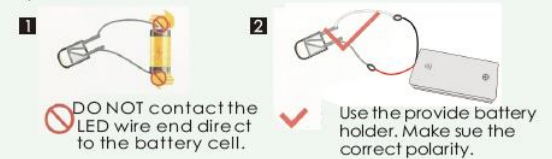

How to assemble the battery holder

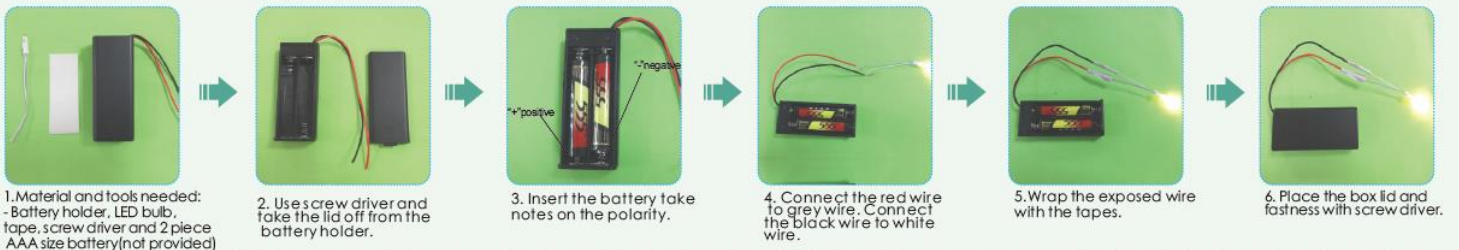

Example of parts rule:

A01: The parts are directly in the box.; B01: parts in bag B; C01: part in bag C and so on. (Note: display the printing paper A08-01 in the step: the printing paper is placed directly in the box, part number is A08-01)

Installation of dust proof cover (For updated version, the parts need to be purchased separately)



details of miniature kit

Name	Material package
printing paper	Bag A-A25 (All printing and template papers are shown on A25 paper. total 2 pieces A3 and 2 pieces A4)
lantern	F bag+M bag
wooden dummy	F bag
big lantern	F bag+M bag+L bag+ template paper
small chandelier	F bag+M bag
outdoor light	F bag+printing paper
living room chandelier	F bag+N bag+printing paper
chessboard table	F bag+printing paper
mahjong table and chair	F bag+L bag+template paper +printing paper
sofa	G bag+L bag+M bag+template paper
first floor chandelier	F bag+L bag+M bag
round stool	G bag+L bag+ template paper
chinese zither	G bag+L bag+K bag+template paper
floor lamp	G bag+M bag
table	G bag+L bag+template paper
bagu rack	H bag+M bag
dining table and chair	H bag+L bag+template paper
cupboard	H bag+L bag+template paper +printing paper
call cabinet	H bag+ printing paper
kitchen ventilator	H bag +printing paper
picture scroll	printing paper
bookcase	J bag+printing paper
chair	J bag+L bag+template paper
desk	J bag+printing paper
bed	J bag+L bag+template paper
zhong ruan	J bag+printing paper
steps	J bag+printing paper
coat hanger	K bag+L bag+template paper
washing table	K bag+L bag+template paper
bathtub	A bag+K bag+M bag+template paper +printing paper
wooden basin	K bag+L bag+printing paper
closetool	N bag+printing paper
waterwheel	K bag

stairs	C bag+template paper+printing paper
little house	A bag+D bag+L bag+printing paper +template paper
gate	A bag+D bag+L bag+printing paper +template paper
lotus pond	A bag+B bag+printing paper +template paper
spa pool	A bag+B bag+printing paper +template paper
outer frame	A bag+B bag+C bag+D bag +template paper
roof	A bag+B bag+printing paper +template paper
battery holder	M bag

Thumbnail of material list (reference only)



Thumbnail of printing paper & template paper (reference only)

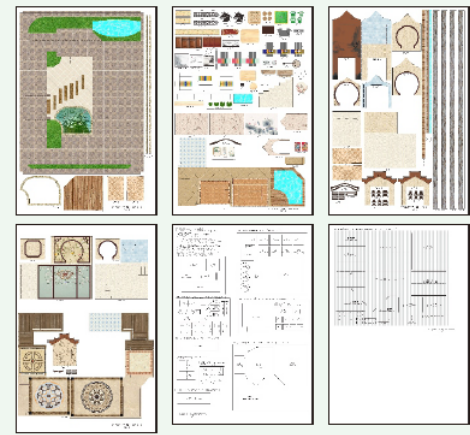

Symbol description used

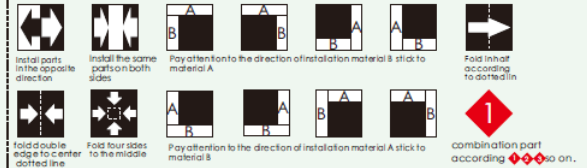

Mahjong table and chair

1 2 3 4 5 6

F18 F18 F18 F18 F14 L02 (mahjong chairs)
 F16 F16 F16 F16 F15 L02 (mahjong chairs)
 F17 F17 F17 F17 L02 (mahjong chairs)
 F19 F19 F19 F19 L02 (mahjong chairs)
 L08 (mahjong chairs) L02 (mahjong chairs)
 L03 (mahjong chairs) L02 (mahjong chairs)
 L03 (mahjong chairs) L02 (mahjong chairs)
 L03 (mahjong chairs) L02 (mahjong chairs)

7 8 9 10 11

F16 F18 F19 F17

(need 4 pieces)

Before making, cut out L02, L03 and L08 according to the template.

1 2 3 4 5 6 7 8

A25-5-1 F14 A25-5-2 A25-5-2 A25-5-2

(need 4 pieces)

Sofa

1 2 3 4 5

G08 G12 L08(sofa)
 G10 G12 L03(sofa)
 G10 G11 G11 L02(sofa)
 G13 G13
 G09 G13 G13
 G15 G14 M10 M10
 G14

6 7 8 10

G12 L03(sofa) L08(sofa) L02(sofa)

Before making, cut out L02, L03 and L08 according to the template.

1 2 3 4 5 6 7 8 10

G15 G14 M10 M10
 G14 G13 G13 G14 G14 M10 M10

Round stool

1 2 3 4

G02 G01 L02(stool)
 G02 G01 L02(stool)
 G02 G01 G03(15pieces)
 L08(stool) L08(stool) L03(stool) L03(stool) L03(stool)
 L02(stool) L02(stool)

5 6 7 8 9

L03(stool) L08(stool) L02(stool) L02(stool) L02(stool)

(need 3 pieces)

Before making, cut out L02, L03 and L08 according to the template.

Chinese zither

1 2 3 4 5

G04 A25-6 G04
 G05 G05
 L10:2.1cm
 L10:1.2cm L10:1.5cm
 2.1cm 2.2cm
 2.5cm 2.6cm
 2.7cm 2.7cm
 2.8cm 2.8cm

6 7 8 9

G05 G05 G05

10 11

Floor lamp G06 G06 M04 M04 M05 M05
 G07 G07 G07

12 13

M04 M05 M05

(need 2 pieces)

Table

1 2 3 4 5 6

G17 G16 A25-7-1 G16 G17 G18 G18 G17 G18

7 8 9 10 11 12 13 14 15

L01(sofa) L01(sofa) G19 A25-7-2 L10:0.5cm L10:0.6cm L10:0.8cm M12 M11 M10 M10

Before making, cut out L01 according to the template.

Bogut Rack

Parts: H01, H02, H03, H04, H05, M20, M22, M03.

Assembly steps: 1. H01, 2. H03, 3. H04, 4. H01, 5. H01, 6. M03, 7. Final assembly with M20 and M22.

Dining table and chair

Parts: H06, H07, H08, H09, H10, H11, H12, L02, L03, L08, M06, M07, M14, M16, M19, M21.

Assembly steps: 1-6. Chair parts (L03, L02, H11, H12). 7-12. Table parts (H10, H08, H07, H07, H07, H06). 13-22. Final assembly and accessories (M28, M29, M08, M13, M14, M20, M06, M19, M16, M21).

Before making, cut out L02, L03 and L08 according to the template.

Cupboard

Parts: H13, H14, H15, H16, H17, H18, H19, H20, H21, H22, H23, L08, L09, A25-8-2, A25-9, A25-10.

Assembly steps: 1-7. Cabinet body parts (L09, H20, H19, H21, H21, H20). 8-11. Cabinet doors and drawers (H17, H18, H17, H18).

Before making, cut out L08 and L09 according to the template.

6

Assembly steps: 12-18. Cabinet top and accessories (H17, H18, L09, L08, L10, L12). 19-21. Cabinet with sink and gas cooker (M17, M18, M09, M13, M28, M08). 22-24. Gas cooker details (L10, L12, M09, M18, M13, M28).

Wall Cabinet

Parts: H13, H14, H15, H16, H17, H18, H19, H20, H21, H22, H23, A25-10, A25-11, A25-12-1, A25-12-2, A25-12-3, A25-12-4, A25-12-5.

Assembly steps: 1-6. Wall cabinet parts (H13, H14, H15, H16, H17, H18).

Kitchen ventilator

Parts: H23, A25-8-1, A25-8-2, H22, A25-12-1, A25-12-2, A25-12-3, A25-12-4, A25-12-5.

Assembly steps: 1-6. Ventilator parts (H23, A25-8-1, A25-8-2, H22, A25-12-1, A25-12-2, A25-12-3, A25-12-4, A25-12-5).

Book case

Parts: J01, J02, J03, A25-13, A25-14, A25-15, A25-16.

Assembly steps: 1-6. Bookcase frame (J01, J02, J03). 7-11. Bookcase with shelves and books (A25-13, A25-14, A25-15, A25-16).

7

Wooden Basin

1 A25-22-1 K03
L13:5cm
L13:5cm
L13:5cm
L03(wooden basin)
Before making, cut out L03 according to the template.

2 K03 L13:5cm
L13:5cm
L13:5cm
Tie K03 with 2 lengths of L13.3cm long.

3 A25-22-1

4 L03(wooden basin)

Closetool

1 N01 A25-22-2

2

3 A25-22-2

4

Waterwheel

1 K12 K16 K14 K15 K15

2 K12 K13 K13

3 K13 K13 K13 K13

4 K12 K13 K13

5 K15

Upgrade procedure

6 P03 K14 K14

Stairs

C03 C03 C03 C03 C03 C03 C03 C02

L08(stair hanging picture)

1 A25-23-1 C01

2 C01

3 A25-23-2 L08(stair hanging picture)

4

5 L08(stair hanging picture)

6 C03 C03 C03 C01

7 C03 C03 C03 C02

8 C04 C04 C04 C04 C04 C04 C04 C04

9 C04 C04 C04 C04 C04 C04 C04 C04

Before making, cut out L08 according to the template.

Small house

D03 D03 D06 D07 D06 D06

1 A24 (small house roof) D06

2 (back view) D06

3 (front view) D06

4 D06

5 A25-24-1 D03

6 D03

7 (need 2 pieces)

8 A24 (small house roof)

9 D04

10 D05

11 A25-24-2 D05

12 D05

13 D05

14 A25-24-3 D01

15 A25-24-4

16 A25-24-4 D02

Before making, cut out A24 according to the template.

15

16

17

18

19 N11

20

21 Steps E17 E18 E19 E20 E16 E17 L01 (small steps) L01 (big steps)

22

23

Glue a led lamp N11 on the roof as shown.

Before making, cut out L01 according to the template.

Gate

D08 D09 D10 D11 D11 D12 D12 D12 D16 D16 D19 L08 (door sticker) L08 (door sticker) L01 (gate)

1 A24 (gate roof) D17 D17 D18 D18

2 (back view) A24 (gate roof)

3 (front view) A24 (gate roof)

4 Fold it along the fold.

5 D17

6 D19 D17

7 D18

8 D09 D10

9 D08

10 L01 (gate)

Before making, cut out L01, L08 and A24 according to the template.

11 D11

12 D11

13 D16

14 D16 D14

15 D16

16 D12 D12

17 D12 D12

18 A25-24-5 L08 (door sticker) 0.5cm 0.5cm L13:1.5cm L13:1.5cm D15 D15

19

20

Lotus Pond

1 A25-25-1 B19

2 A25-25-2

3

4 A25-25-2

5

6

7 A23 (lotus pond)

8 A23 (lotus pond)

9 N02

10 N10

11 N10

12 N03 N03

13 A25-26

Cut out A23 according to the template and stick it on the underside.

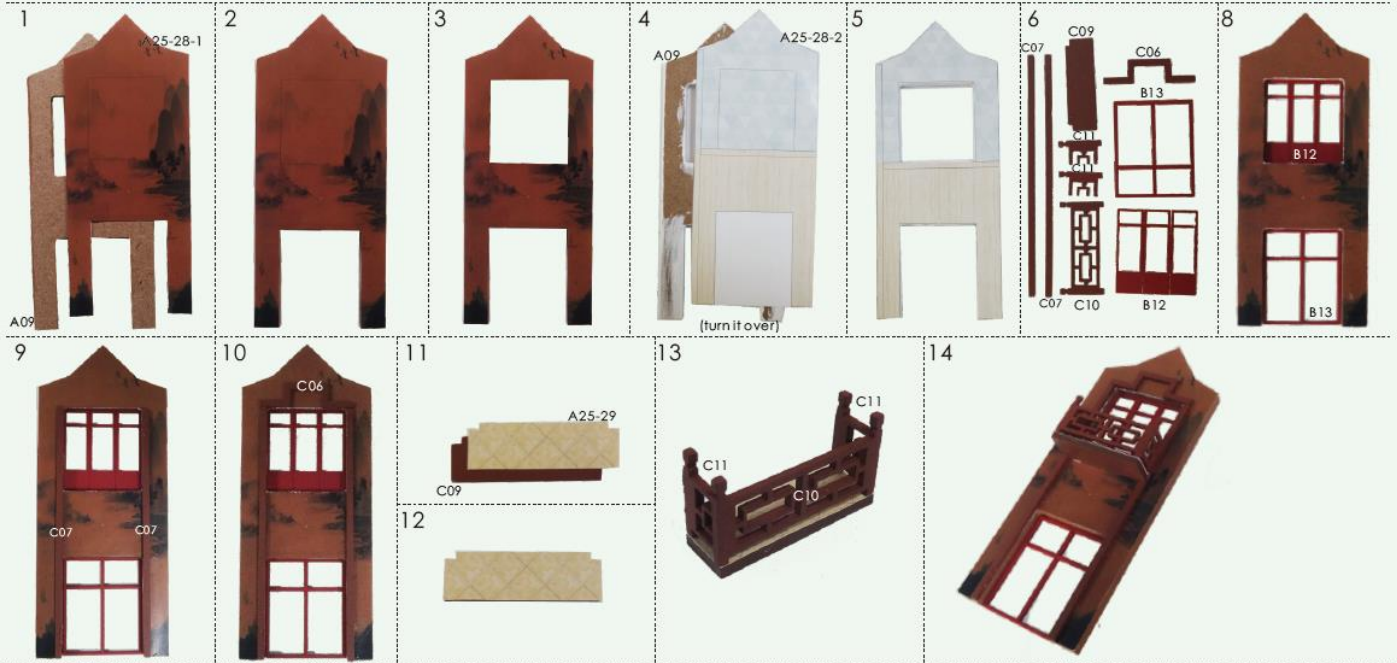
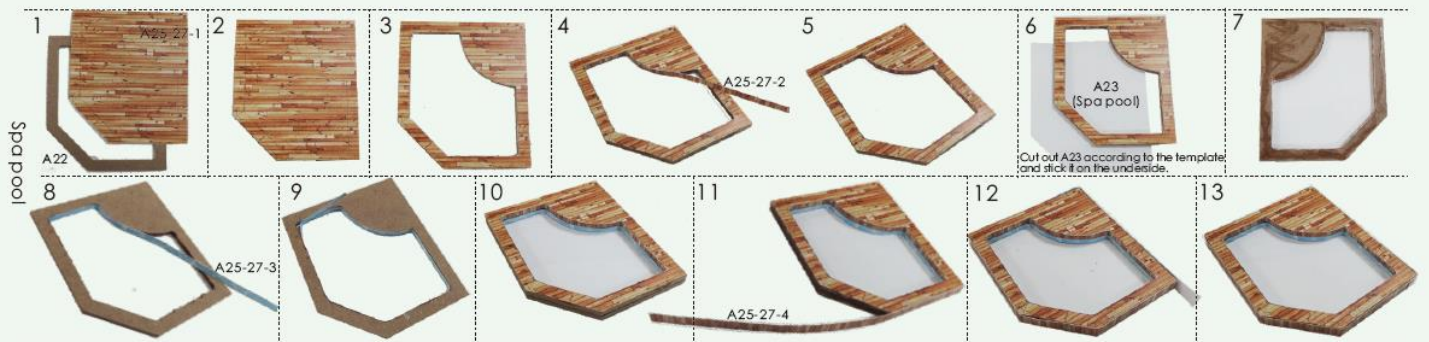

12

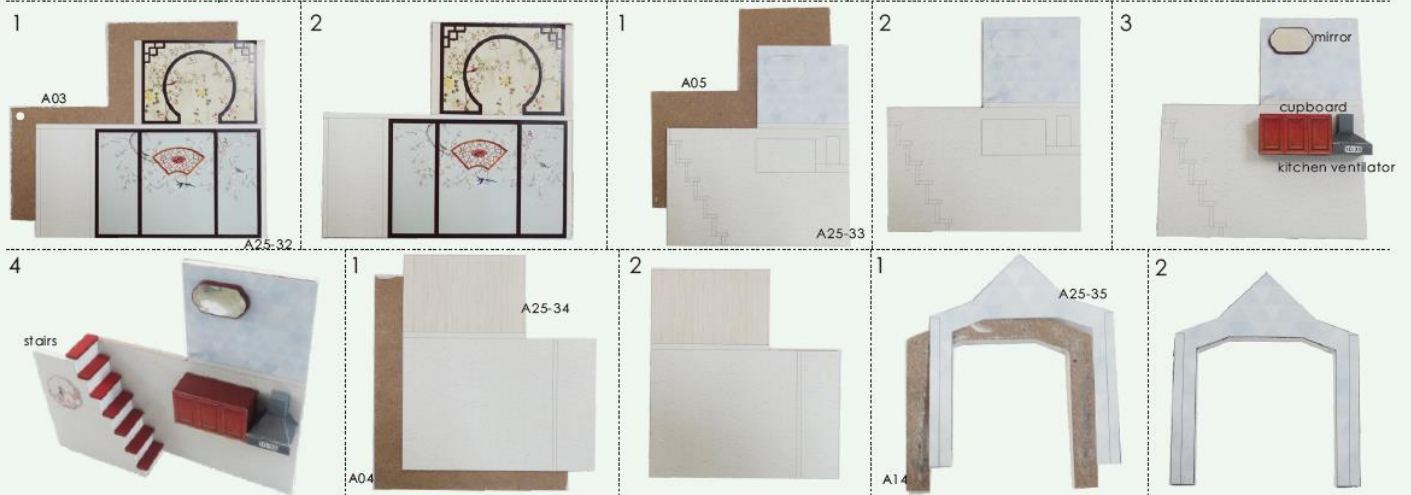
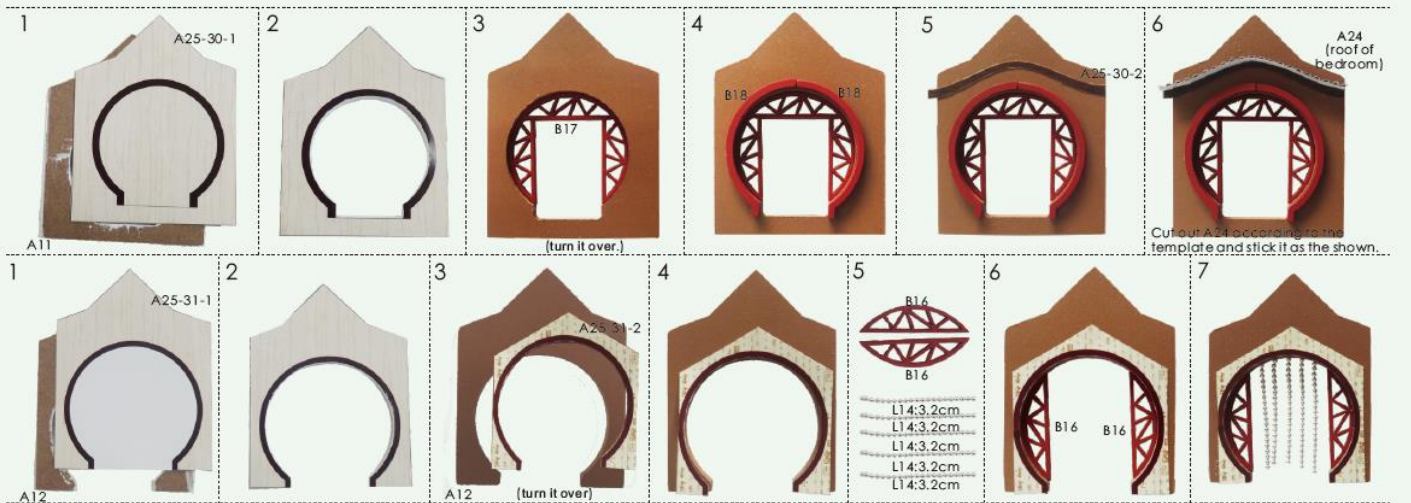

13

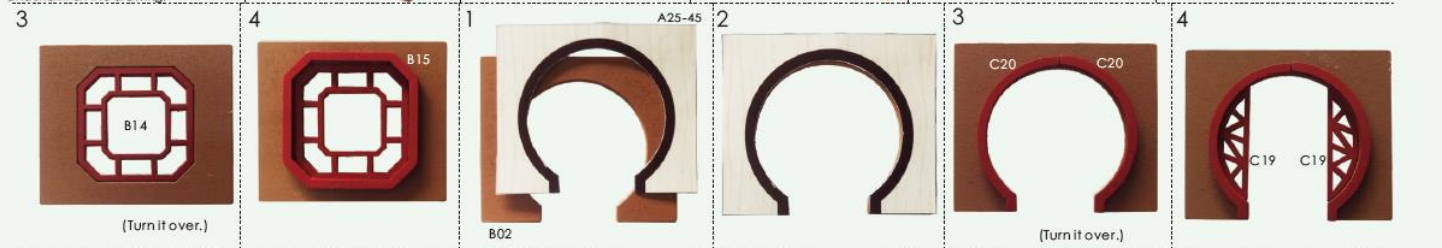
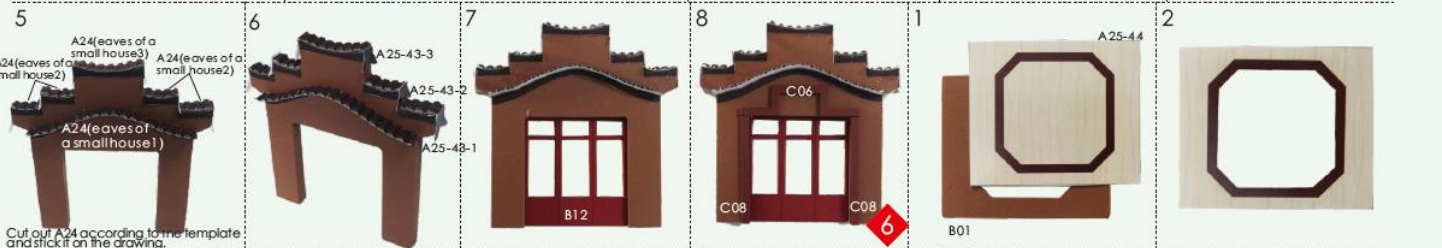
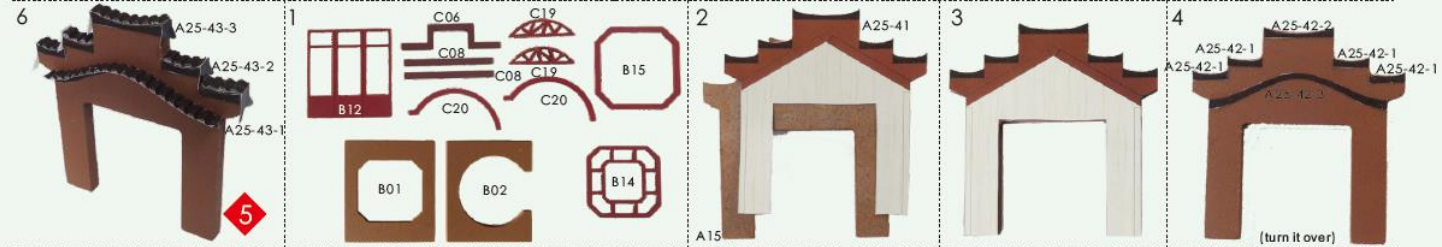
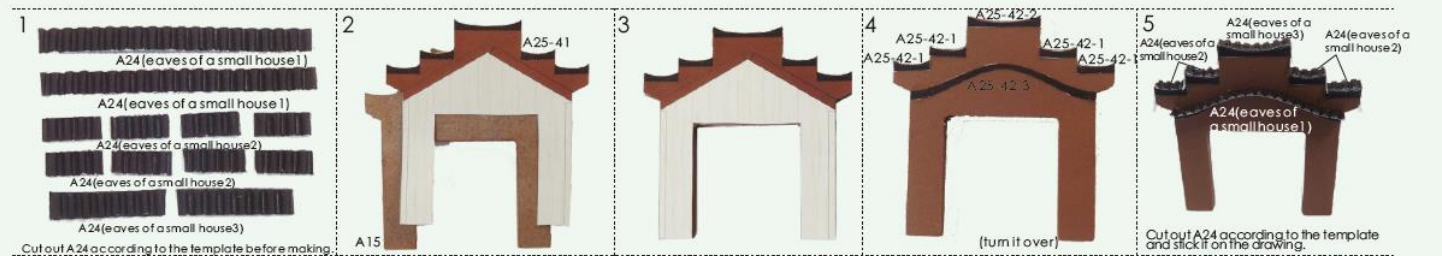
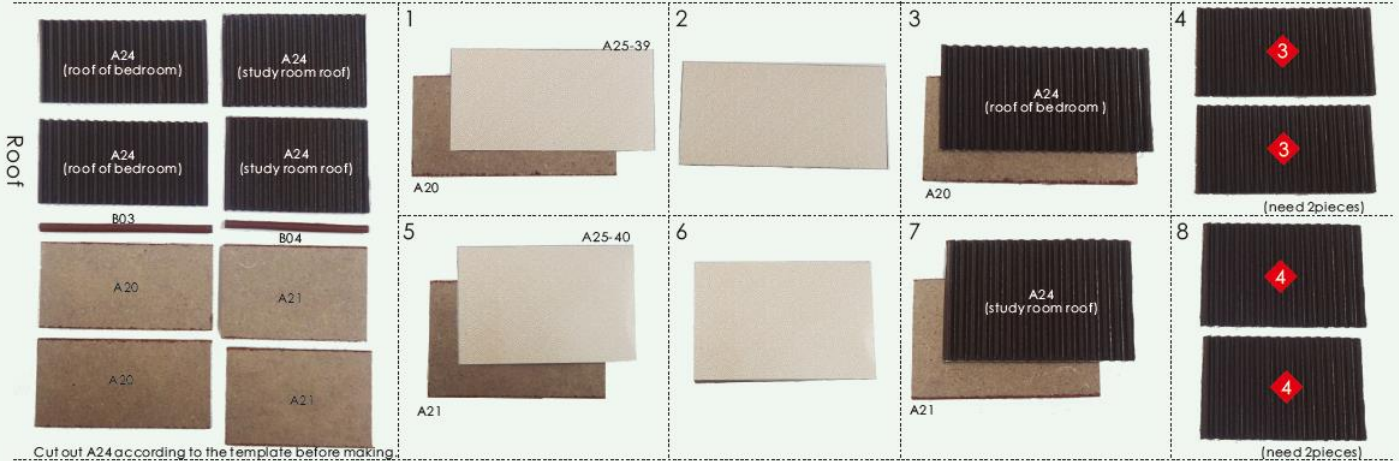
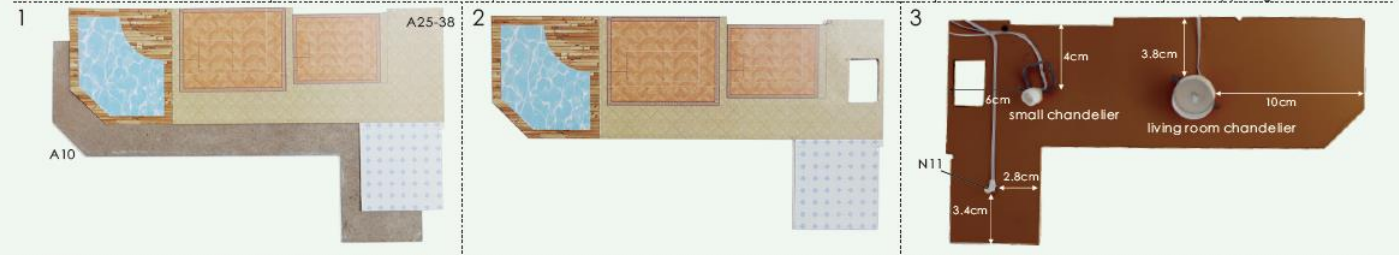

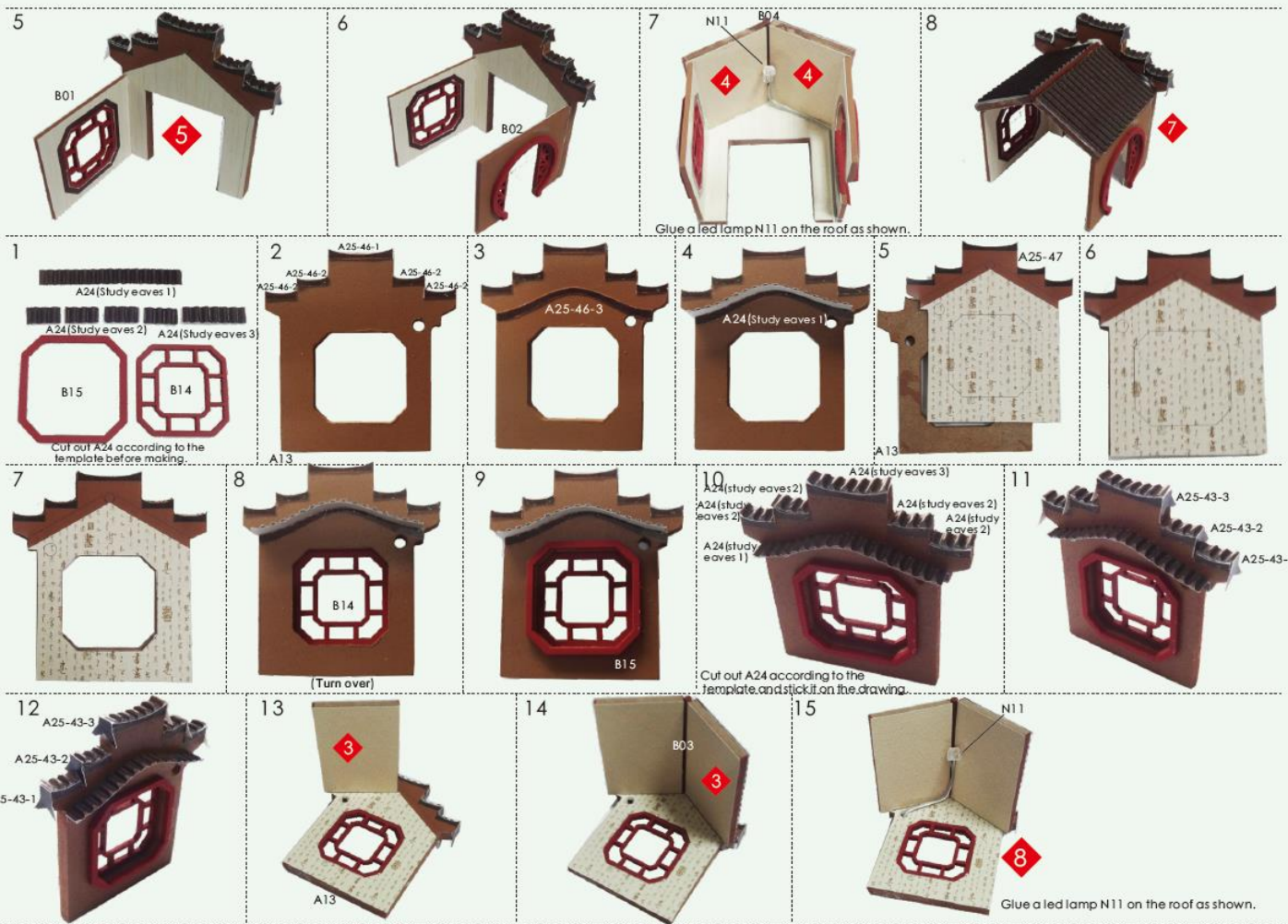

16

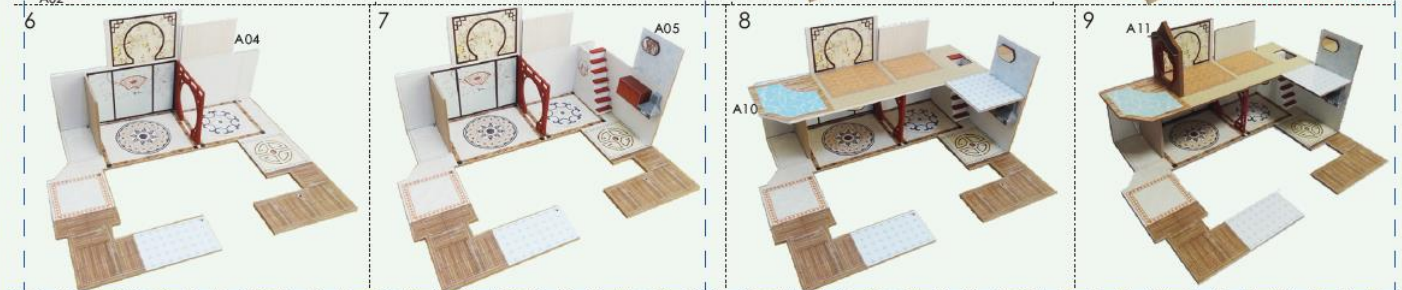
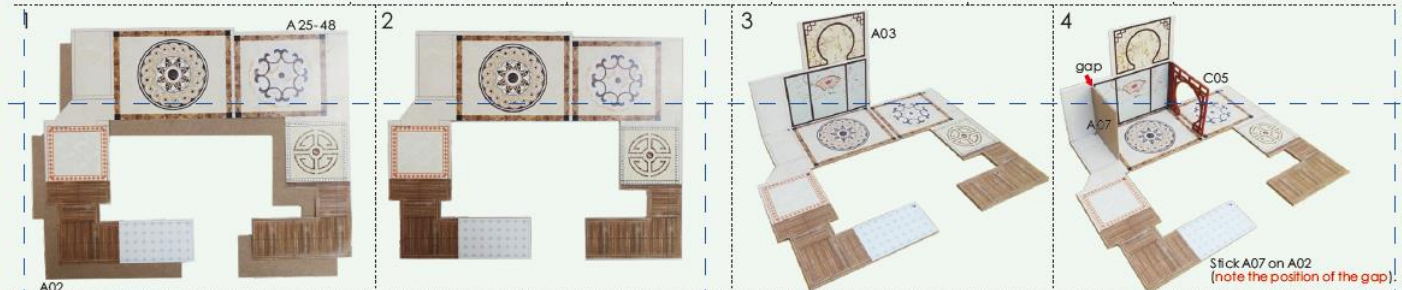
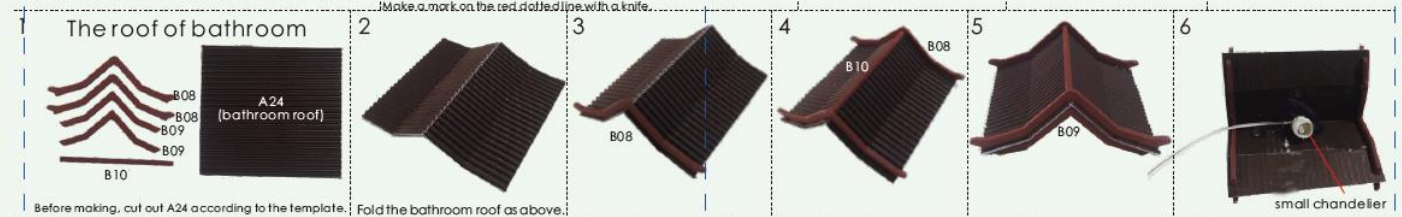
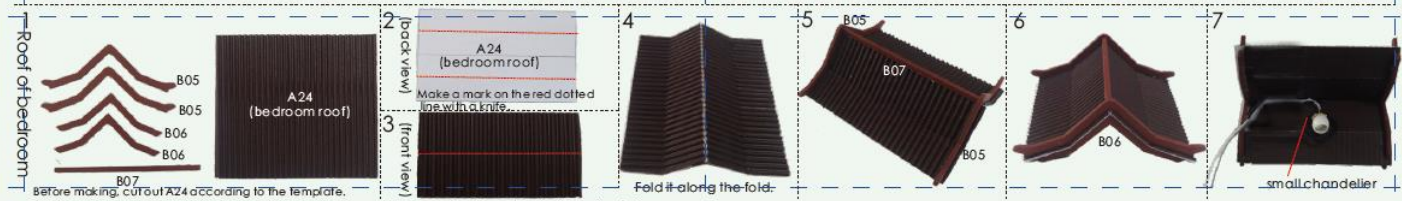

17



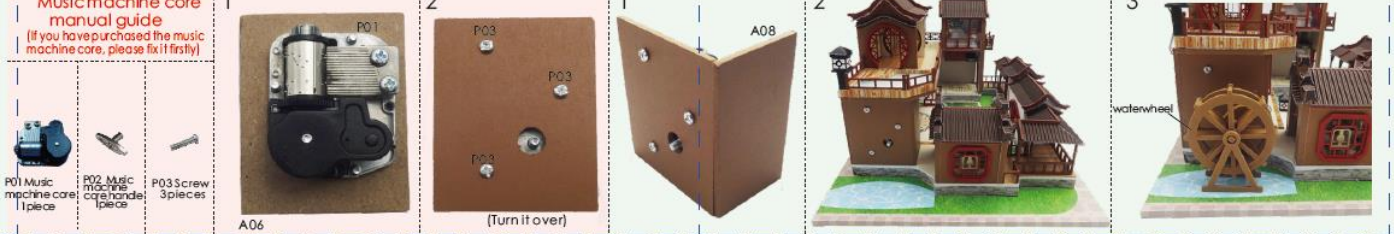
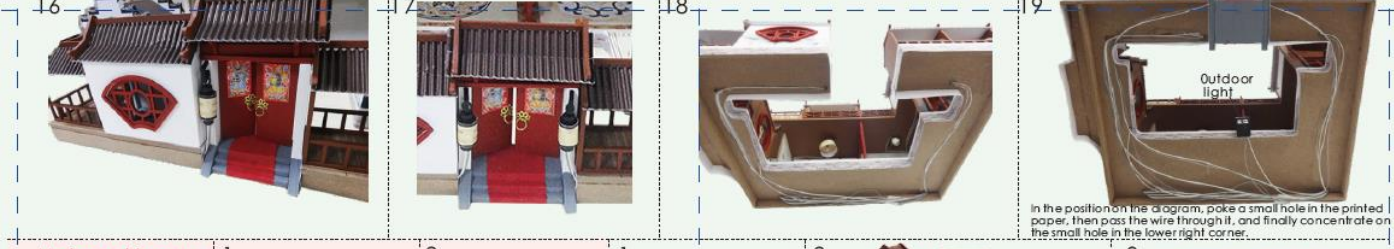
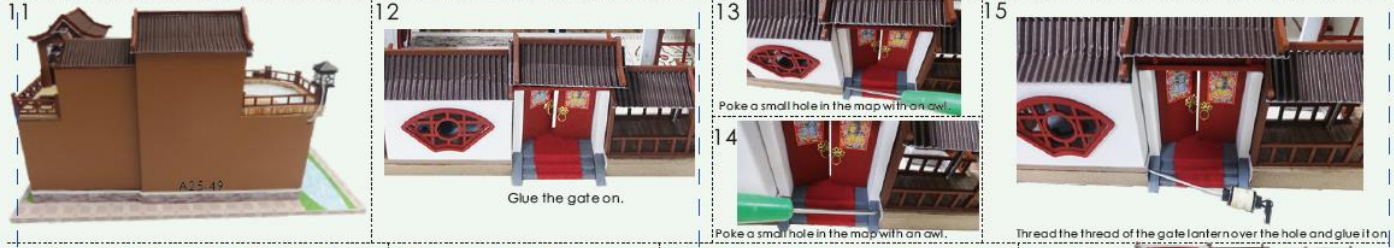
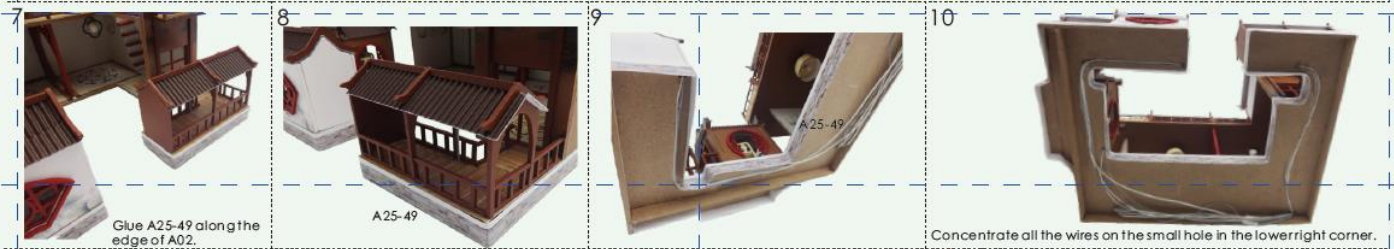
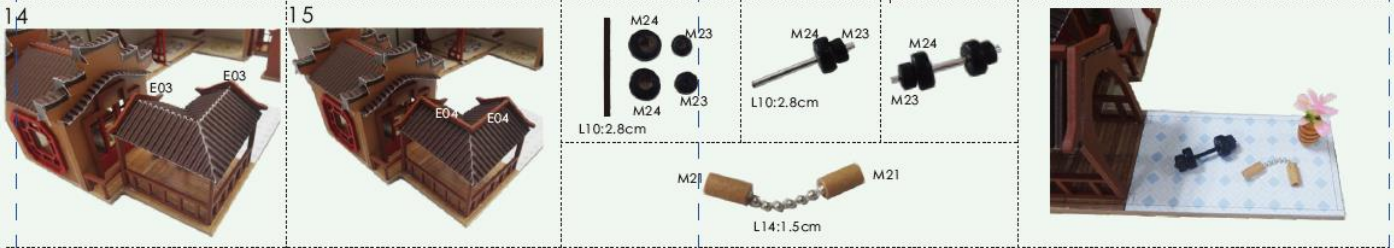
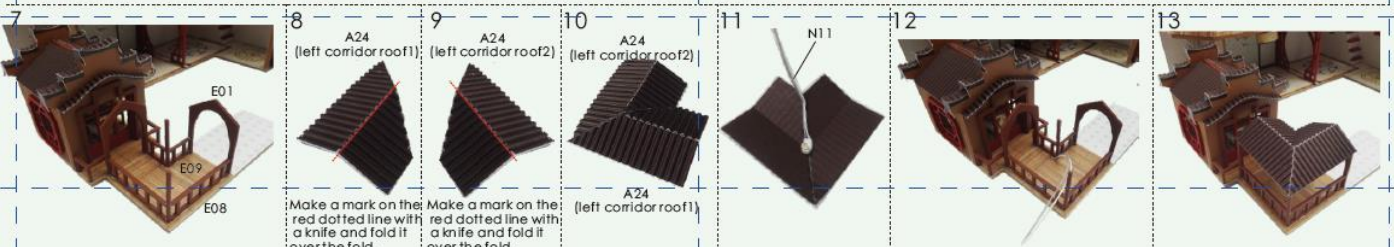

How to assemble the battery holder

- Statement: the lamp wires cannot be inserted into the output socket.
- Can use 7 batteries
 - Please notice the place of anode and cathode when put in the batteries
 - Rechargeable batteries are not blunt electricity
 - Rechargeable batteries can only be charged under adult supervision
 - Rechargeable batteries should be removed from the toy before charging
 - Different types of batteries cannot mix
 - Do not immerse batteries in use with sensitive batteries
 - Run out of battery should be removed from the toy
 - The power shall not be short of cut

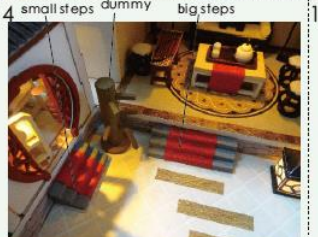
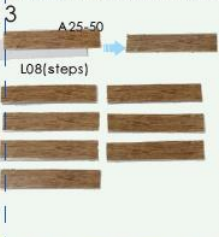
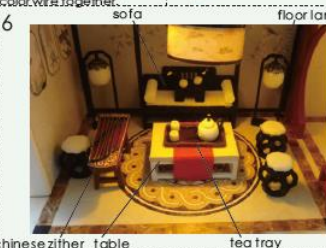
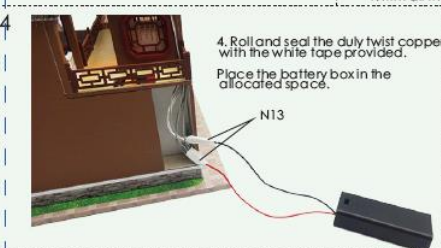
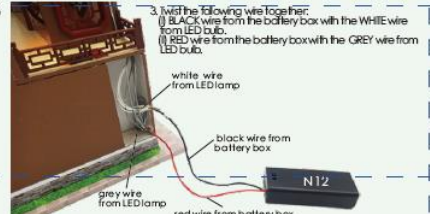

22

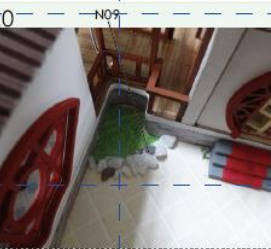

Attention: Please keep the instruction for future enquires after installation.