

C007

# DIY handmade goods -- Cocoa's fantastic ideas



Instruction Manual

# NOTICE OF ASSEMBLE

## Making tips

1. LED wiring indication:  
White=Positive; Grey=Negative.
2. Use a craft blade to carefully skim over the plastic to bare the copper wire.
3. For LED wiring extension, please refer to the below steps:

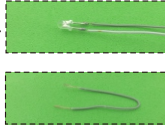

Twist the copper of both LED wire and extension wire together.

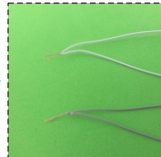

Do the same on the white wire.  
Remarks: Tie a knot at the end of the grey wire to differentiate the polarity.

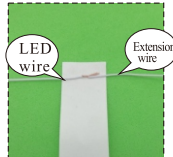

Place the duly twist wire on the tapes provided.



Roll and wrap the wire.

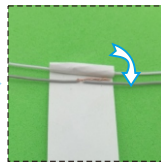

Place another wire next to it.  
Remarks: DO NOT contact both copper wire to avoid short circuit.

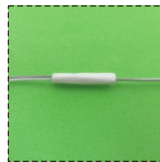

Roll and wrap it together.

## Warnings

- The product is not suitable for children under 14 years old. The should be under custody of adults when playing with the product.
- There are small parts, please do not swallow them for avoiding dangerous accidents.

## Tips for assembling

1. Pictures shown on the package may be slightly different from the actual product.
2. Please use the provided tracing paper for cutting purpose to achieve the best outcome.
3. Product designs and specification may be subject to change without advance notice for purpose of making improvement.
4. Testing on LED function:

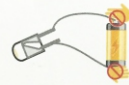

DO NOT contact the LED wire end direct to the battery cell.

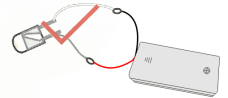

Use the provide battery holder. Make sue the correct polarity.

## How to assemble the battery holder



1. Material and tools needed:  
- Battery holder, LED bulb, tape.



2. Twist the following wire together:  
(I) WHITE wire from the battery box with the GREY wire from LED bulb.  
(II) GREY wire from the battery box with the WHITE wire from LED bulb.



3. Wrap the exposed wire with the tapes.



4. Tear off the rubber paper

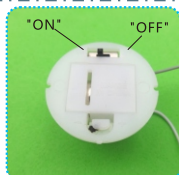

5. Set the black key on the battery box to one side of "ON" as shown.



6. Turn on the power and complete the installation.

**Statement: the lamp wires cannot be inserted into the output socket.**

- Please notice the place of anode and cathode when pit in the batteries
- Rechargeable batteries are not blunt electricity
- Rechargeable batteries can only be charged under adult supervision
- Rechargeable batteries should be removed from the toy before charging
- Different types of batteries cannot mix; Do not mix new batteries in use with semi-used batteries.
- Run out of battery should be removed from the toy
- The power shall not be short circuit

# Product information



Chocolate tray



Chocolate lollipop



Chocolate



Chocolate biscuit



Chocolate sauce



Flower pot



Chair



Gift box

# Cabinet

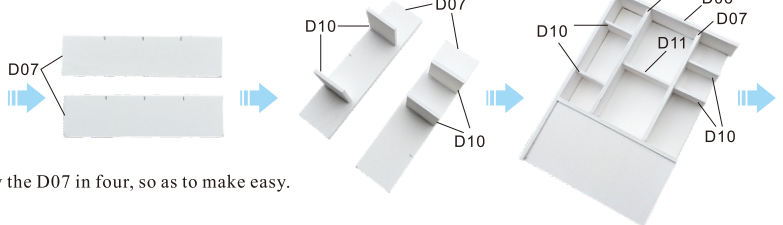
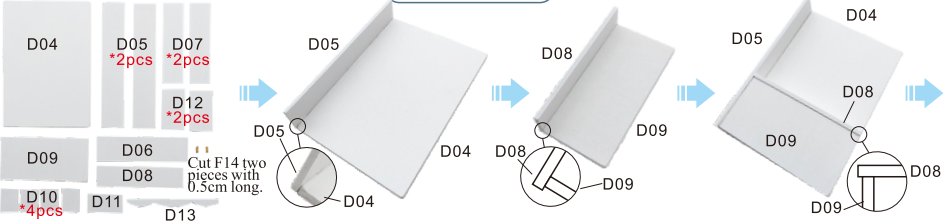

Use a pencil to draw the D07 in four, so as to make easy.

D13 (it is recommended that the A09-03 and A09-06 be put in the cabinet and then glued on D13 as shown.)

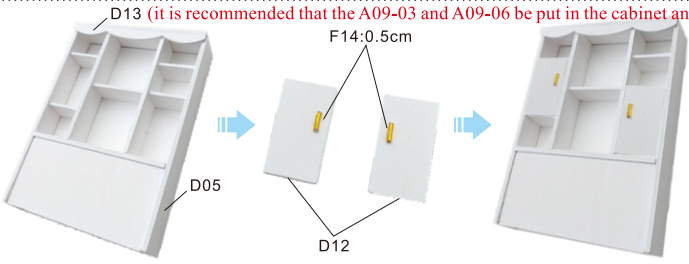

# Chocolate A

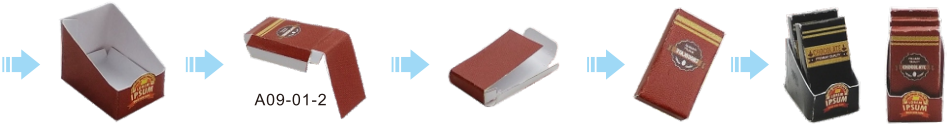
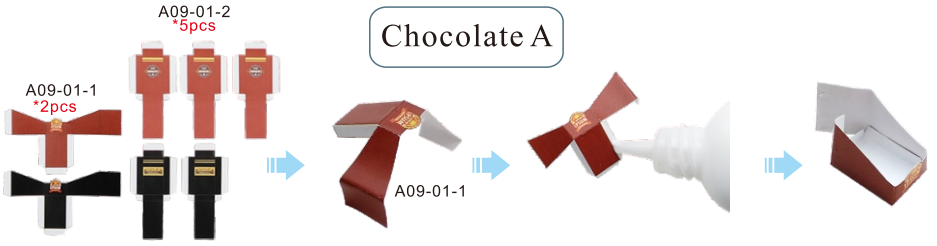

# Chocolate B



# Chocolate cup

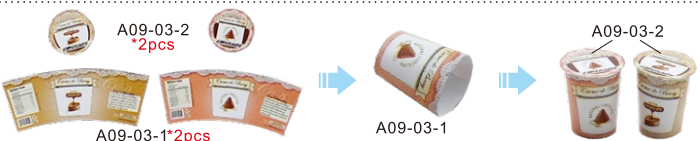

## Chocolate sauce



## Circular gift box



## Gift box

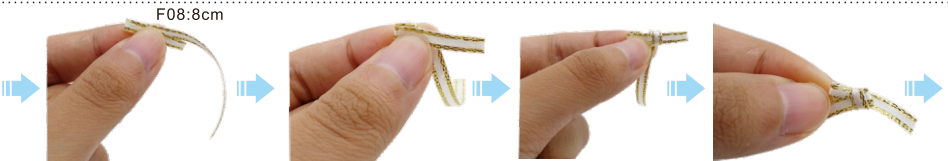
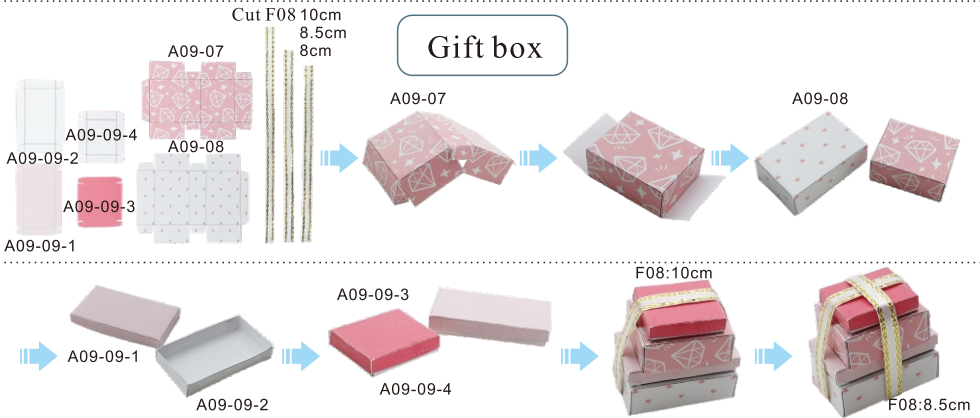

## Display cabinet

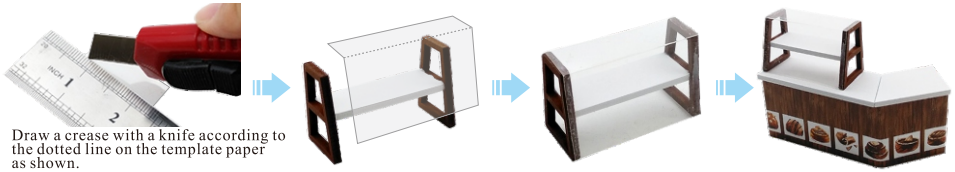
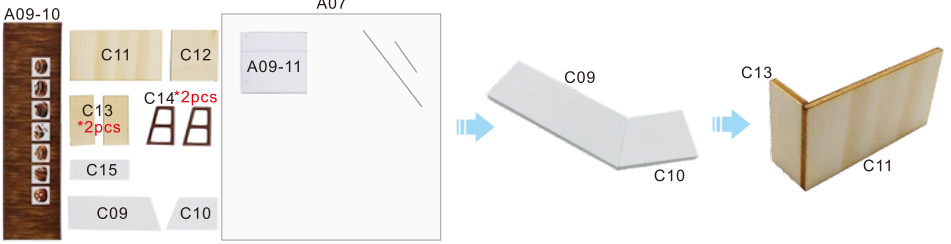

## Chocolate cake

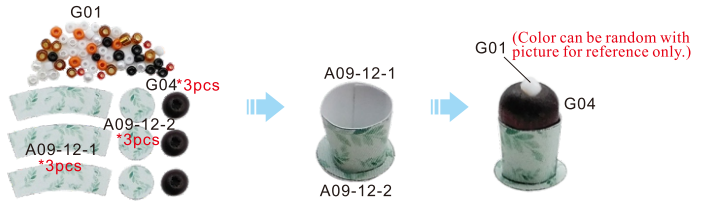

## Chocolate C

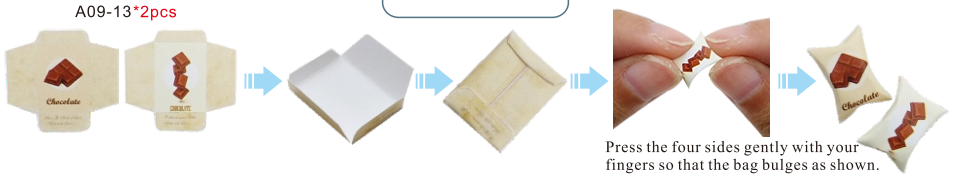

## Chocolate biscuit

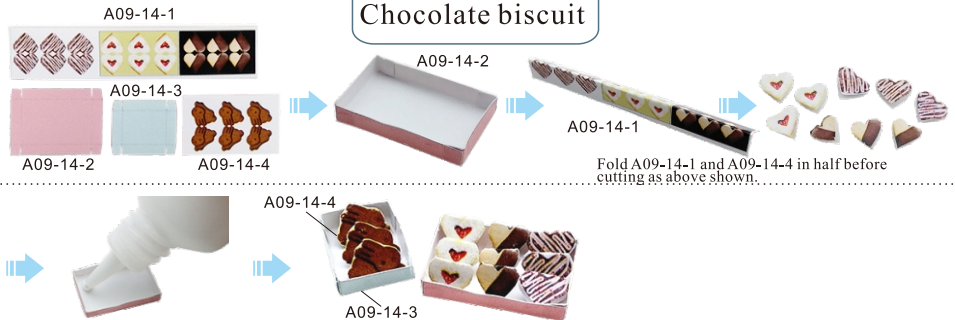

## Chocolate platter

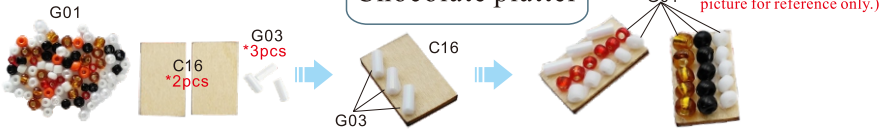

## Chocolate lollipop

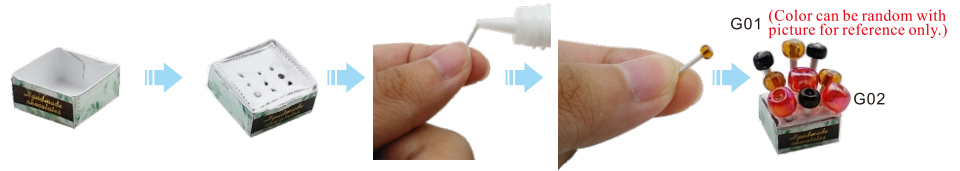

## Chocolate box



## Little flag

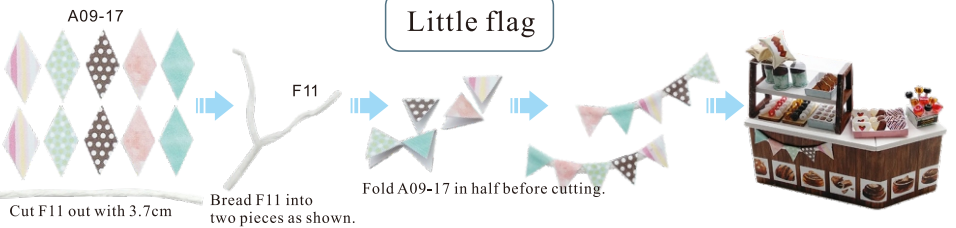

## Cart

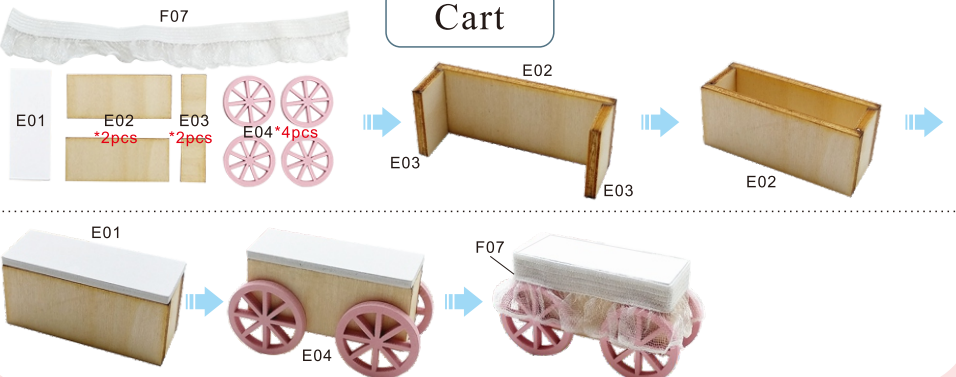

## Heart chocolate

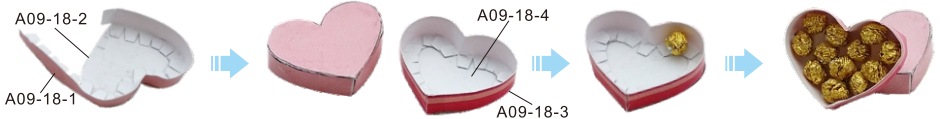
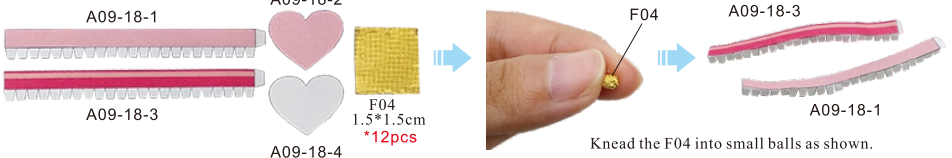

## Chocolate tower

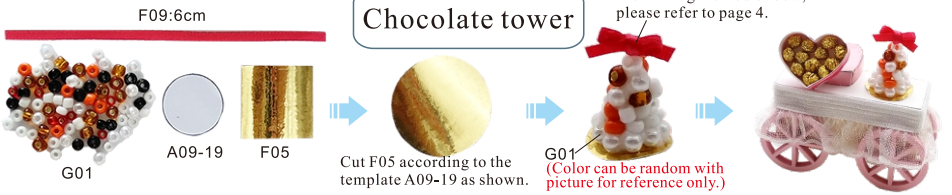

## Counter

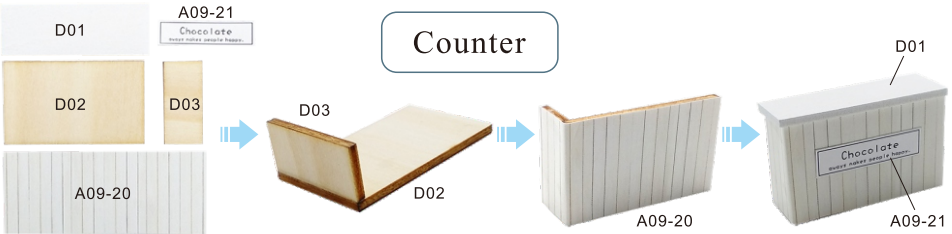

## Chocolate D



## Chocolate tray



## Sunshade





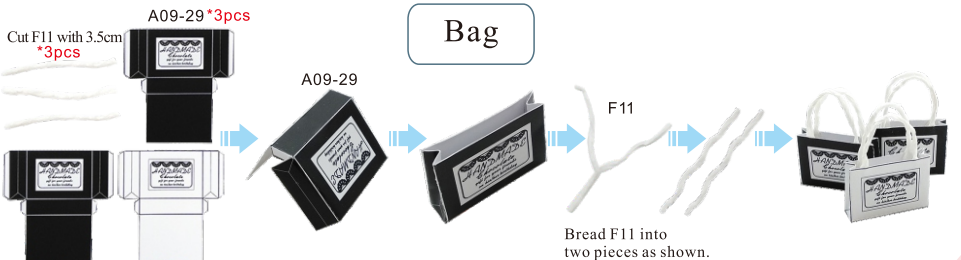
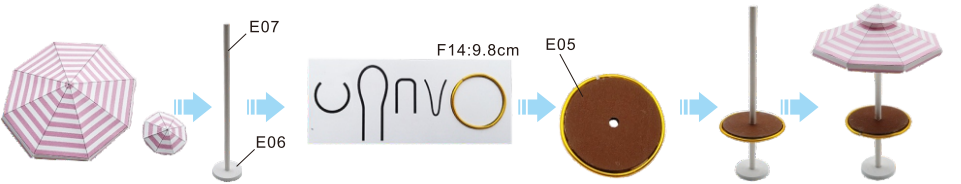
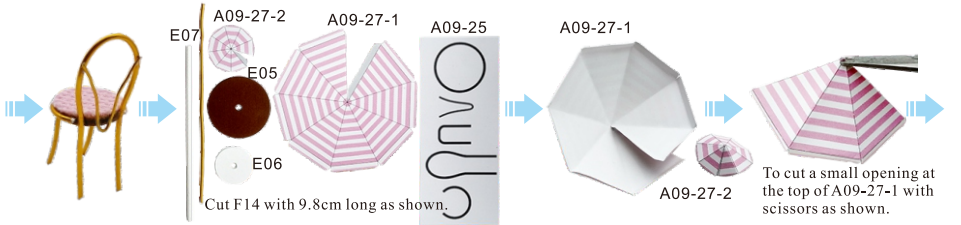
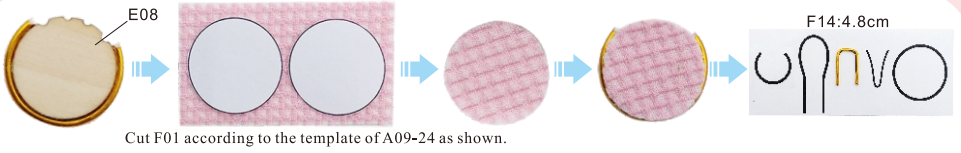

## Tulips

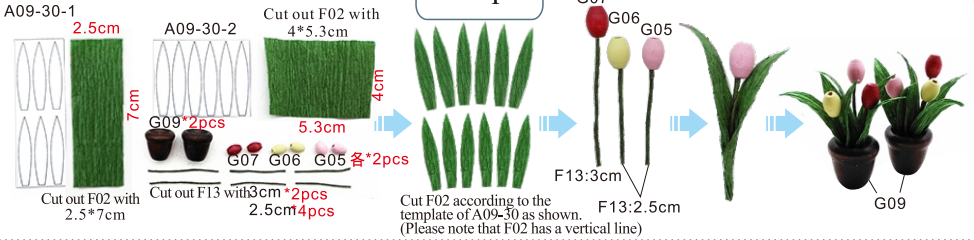

## Flower

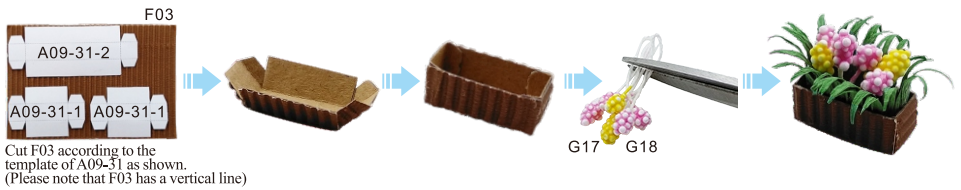

## Sign



## Floor sign



## Window

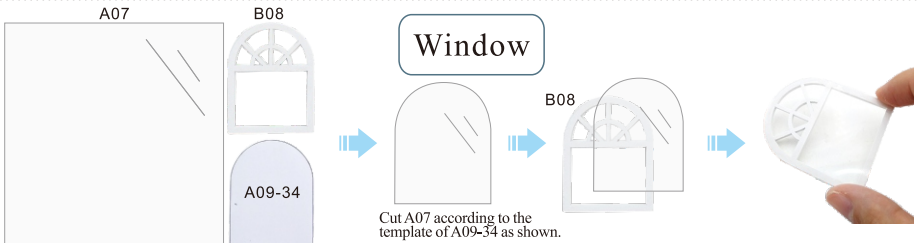

## Wall deco



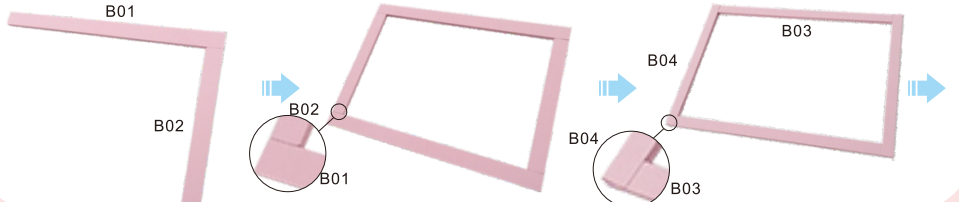
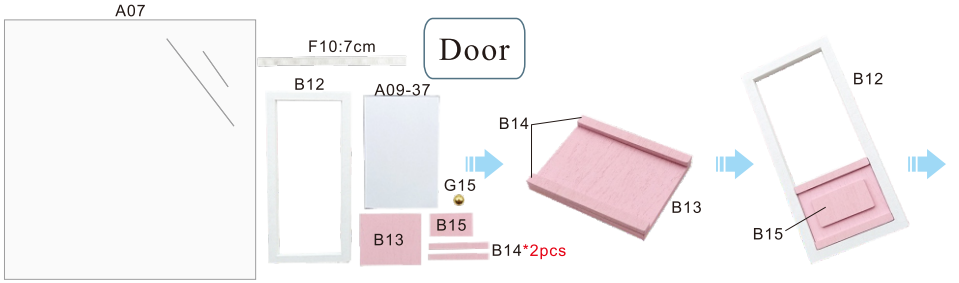
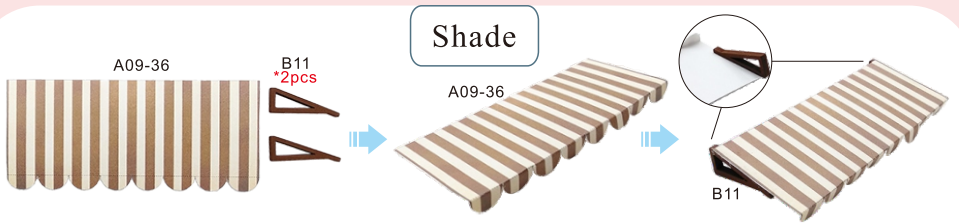

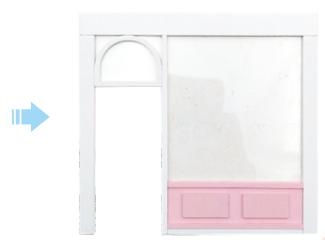
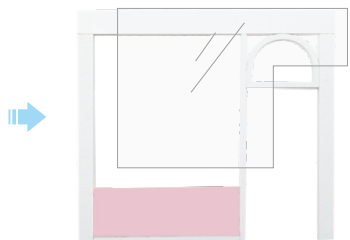
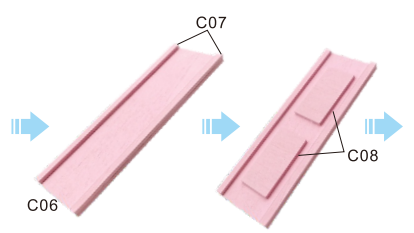
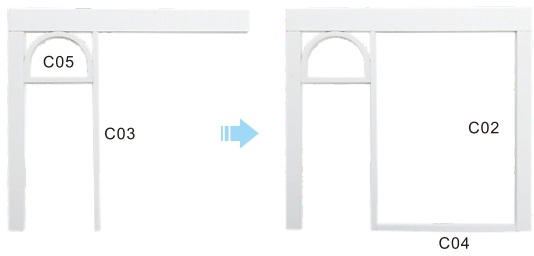
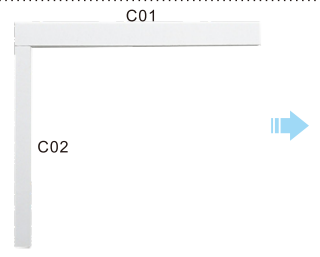
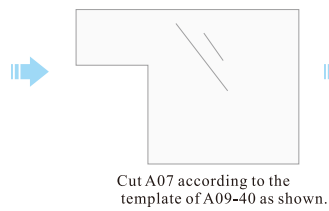
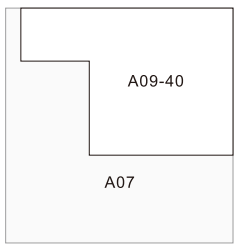
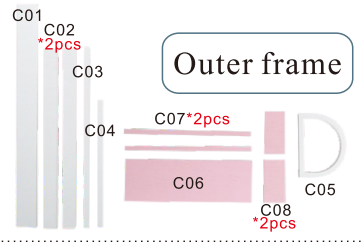
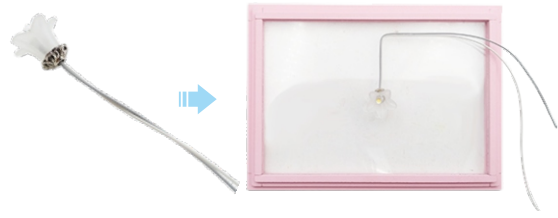
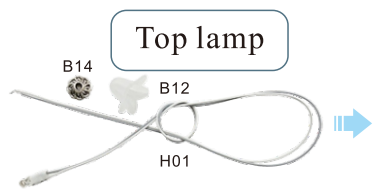
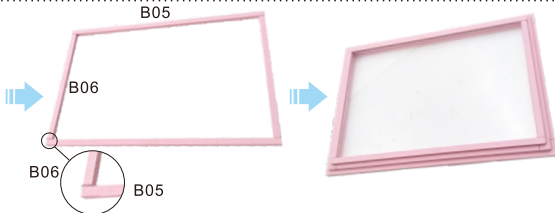
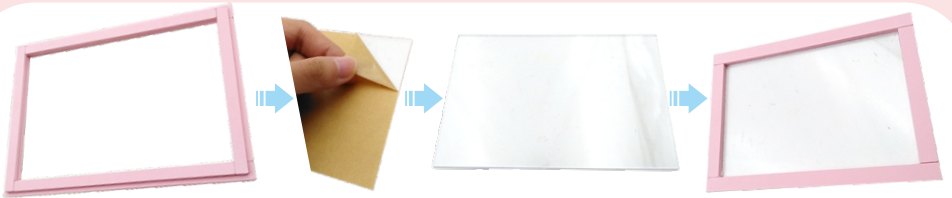

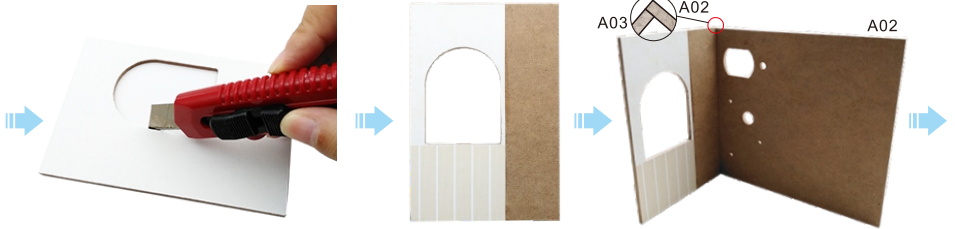
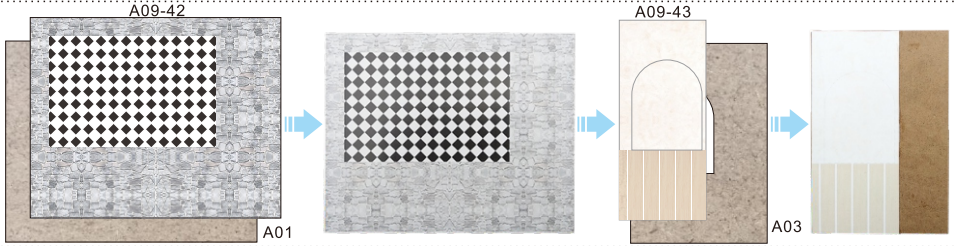
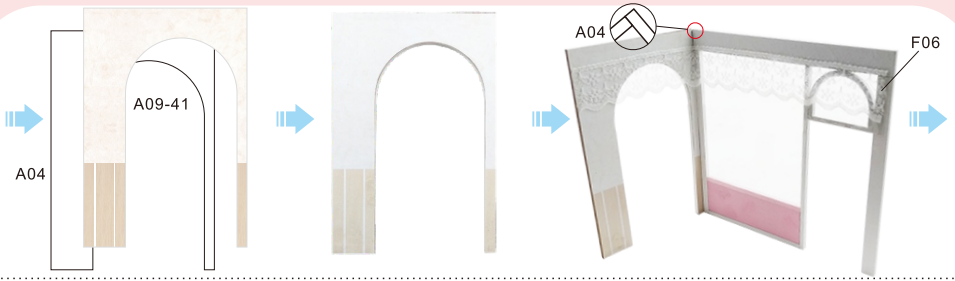

Music machine core manual guide  
(If you have purchased the music machine core, please fix it firstly)



(front view)

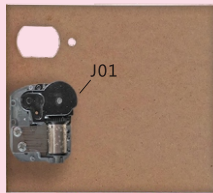

(back view)

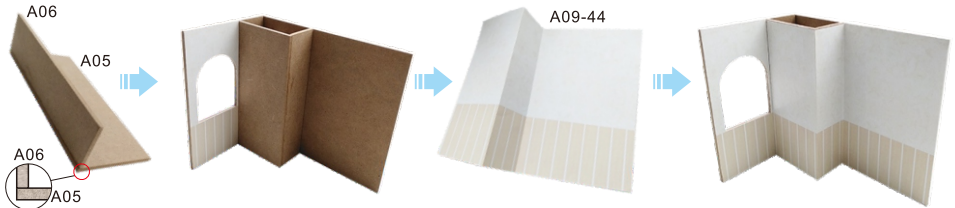
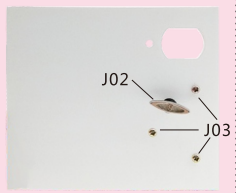

Shop sign

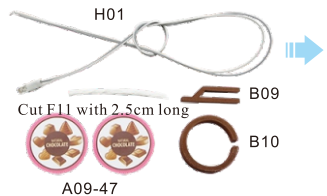



Break the F11 into two pieces.

A09-47

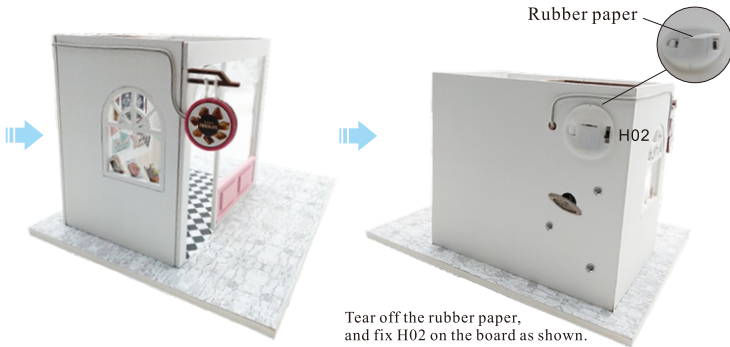

Rubber paper

H02

Tear off the rubber paper, and fix H02 on the board as shown.

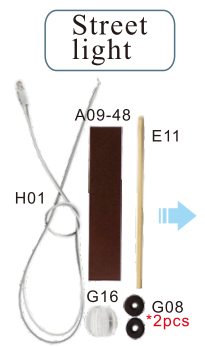

Street light

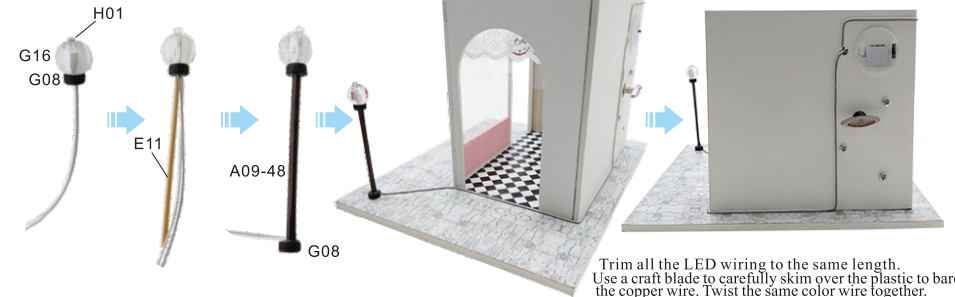

Trim all the LED wiring to the same length. Use a craft blade to carefully skim over the plastic to bare the copper wire. Twist the same color wire together.

Twist the following wire together:

- (I) WHITE wire from the battery box with the GREY wire from LED bulb.
- (II) GREY wire from the battery box with the WHITE wire from LED bulb.

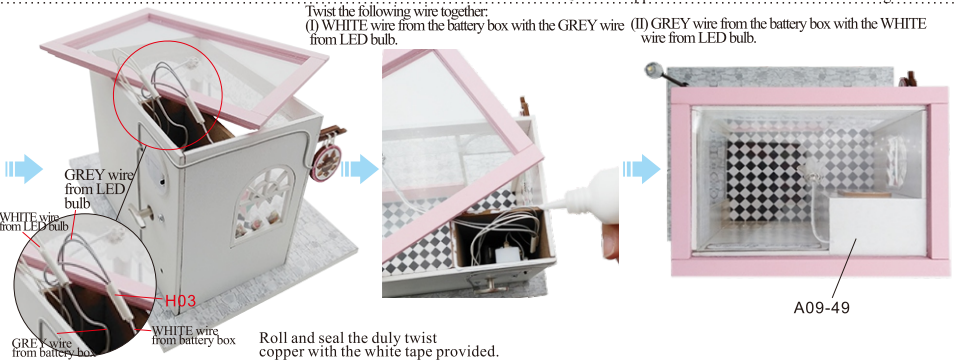

Roll and seal the duly twist copper with the white tape provided.

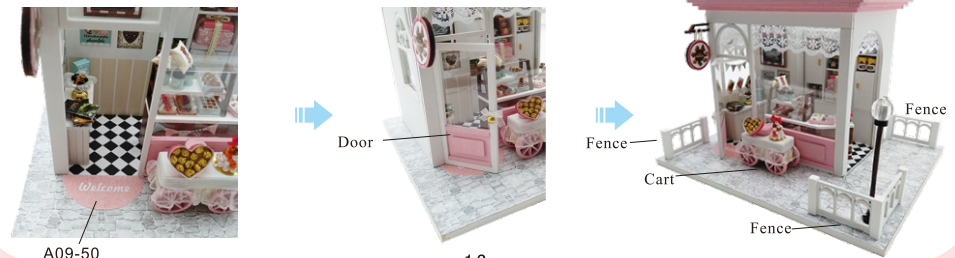



**Installation of dust proof cover**  
**(For updated version, the parts need to be purchased separately)**



J04 Transperent cover  
 0.15\*16\*20 (3pieces)



J05 Transperent cover  
 0.15\*15.7\*16(2pieces)



1. Tear off kraft paper of each piece of transparent cover.

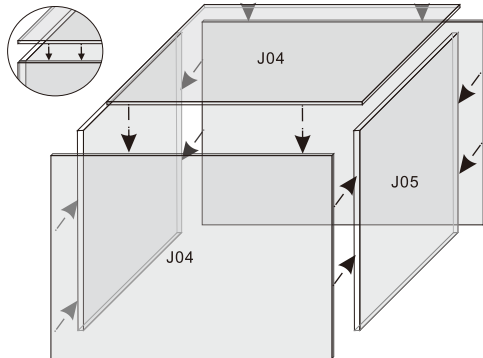

2. Paste J04 and J05 together to complete the dust proof cover as shown.

**Photo of Dust proof cover**



**Photo Gallery**





**Attention: Please keep the instruction manual for future enquires after installation.**