

1:14 Electric 4WD Climbing car

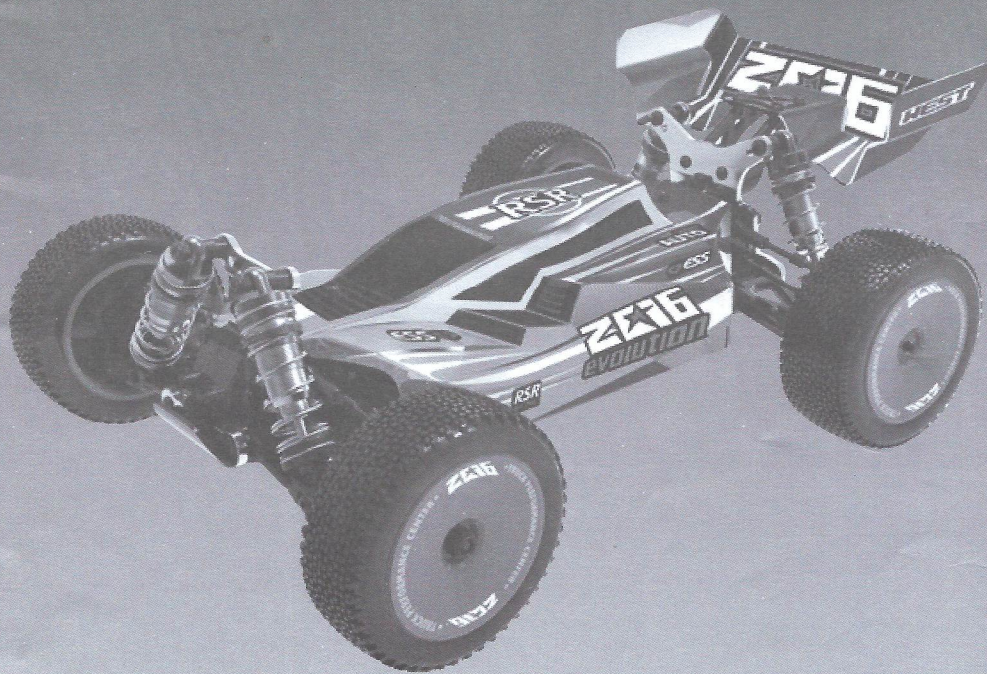

Caution: This model is not a toy, It is designed for user over 14 years of age.

Please use this instruction and the R/C system instruction at the same time.

The instruction is suitable for a type of model whose number is 144001

Safety and caution	1-2
Troubleshooting • Product introduction	2-3
Instruction of common tools and installation the electronic part...	4
Practice and maintenance.....	5
Assemble exploded view	6-14
Fittings view	15-19

Safety and Cautions

- *Never run the model on public roads or streets, as it could endanger traffic.
- *Never run the model in crowded areas, near or toward people or animals, to prevent property damage and/or personal injury.
- *Never run the model near rivers, ponds or lakes as to prevent R/C car from dropping into the water.
- *Make sure that no one else is using the same frequency as yours in your running area. Using the same frequency at the same time, whether it is driving, flying or sailing, can cause loss of control with R/C model, resulting in serious accidents.
- *To avoid a runaway R/C model or loss of control, always follow the procedure below:
 1. Fully extend transmitter antenna.
 2. Switch on transmitter.
 3. Switch on R/C model.
- *Follow reverse procedure to shut down.
- *Never touch or hinder rotating tire.
- *Never run R/C model in the rain or let run over puddles, as water may cause trouble with R/C model.
- *Motor and battery get very hot after running. Take care when handle them.
- *Retract transmitter antenna when not in use.
- *Remove the batteries from model and transmitter when they are not in use.

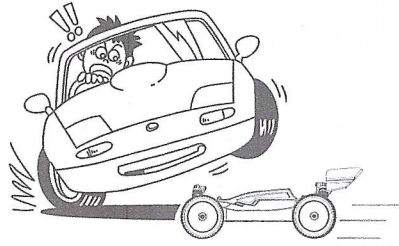

Cautions when handling batteries

- *Do not dismantle the battery or charger and do not cut any battery cables. This may cause short-circuit and/or damage to the product.
- *Change battery with compatible charger following proper procedure that is called out in the instructions. Do not modify charger or charge battery in improper way.
- *Do not recharge battery that is still warm from use as it may damage the battery. Allow the battery to cool off prior to recharging.
- *Make sure to disconnect charger cables from R/C model and electric outlet when not in use.
- *Remove transmitter battery when not using it for a long time as it may leak and damage transmitter when left for a long period.
- *Never incinerate used batteries, as they can explode causing serious accidents.



Safety precautions

Do not operate the model on public roads, in crowded places or near infants, it may cause accidents or injury.

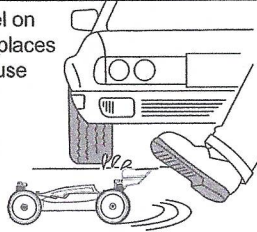

As the product includes small and sharp parts, assemble and store this product only in places out of the reach of children.



As the front end of the antenna may be dangerous, do not aim it toward faces.



During the car running and after, the motor will be hot. Please do not touch it until it has had time to cool down.

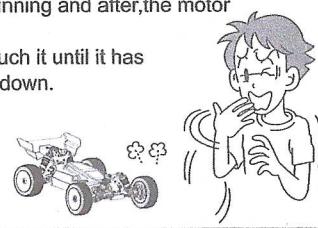

Don't use the same frequency with others at the same time. Or the car will lose control or even lead to serious accidents.

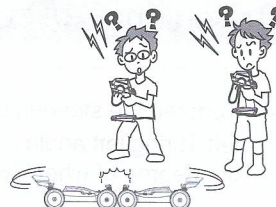

Troubleshooting

Description	Cause	Solution
The car does not operate at all.	Transmitter or receiver is off.	Turn on both transmitter and receiver.
	Batteries are not placed properly in the transmitter.	Place batteries in the transmitter properly.
	The drive battery is not charged enough.	Charge the drive battery.
The car does not follow your operation and control distance not enough long.	Someone else is using the same radio frequency as you are using.	Change your radio frequency to the one no one else is using, wait until the driver using the same radio frequency finishes driving, or drive your car at a different place.
	There is not enough power in the transmitter or receiver batteries.	Replace the transmitter batteries with new ones and charge the drive battery.
	Not tighten antenna on the transmitter/not fully extend antenna.	Make sure insert antenna into the transmitter and fully extend antenna.



CAUTION

- * Please observe the operation manual or packing explanation to install and use, and some parts should be installed by adults.
- * The product contains small parts, it may cause swallow or choke.
- * Never run an R/C model in the seep or rain, moisture areas, or it may cause the parts malfunction.
- * Please throw the wrapper in time to avoid danger for the children.
- * Regularly examine for damage to the charge, wire, plug, bodyshell or other parts. In the event of any damage, it must not be used until the damage has been repaired.
- * The charge, battery box and battery must insert with the appointed power source of product symbol same.
- * This product must only be used with the original collocation charger.
- * The product is contains the functional outshoots are may be dangerous to the children.

Proportional R/C Using Instruction

- ① Turn left the steering wheel, the car will turn left. Turning left angle can be adjusted by the degree of wheel twisting.

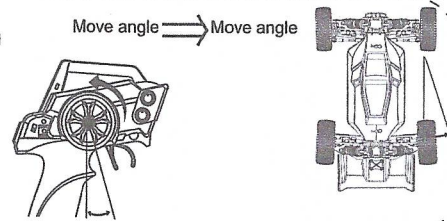

- ② Turn right the steering wheel, the car will turn right. Turning right angle can be adjusted by the degree of wheel twisting.

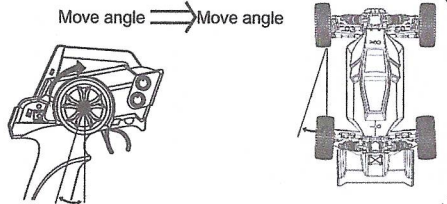

- ③ Pull the throttle trigger backward, the car will forward. Adjusting the angle of throttle trigger can adjust forward speed of the car. During the car forward, quickly push the trigger forward to stop it.

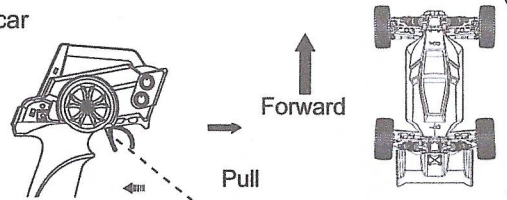

- ④ Loosen the trigger to make it return the neutral position when brake. Push the throttle trigger forward, the car will backward. Adjusting forward angle of throttle trigger adjust backward speed of the car.

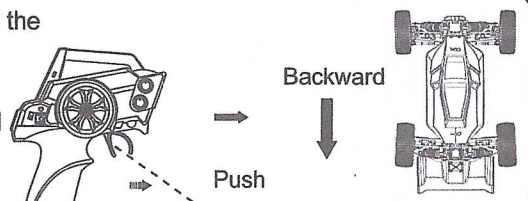

Introduce the common tools and assemble the electron parts

Tools needed for assembly

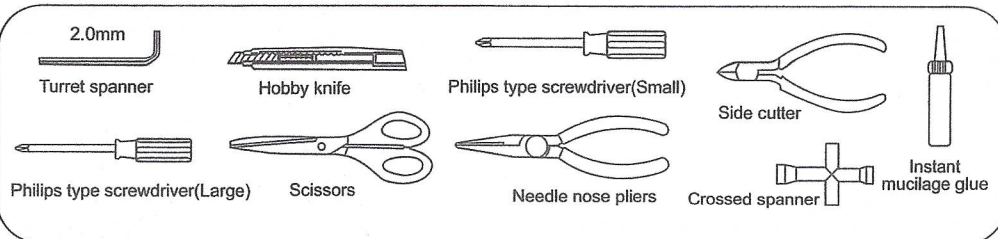

Operating program

1. Turn on the power switch ① on the remote and make sure the power indicator ② flashes red, then turn on the model car's power switch.
2. The model car on the shelf, gently hook remote control on the trigger ③ to observe whether the car can move forward and backward.
3. Turn the remote control steering wheel ④ to the left or right and make sure that the front wheel's steering follows the command.
4. The model car on the ground, and standing behind the model car, gently hook the remote control throttle trigger ③, if the model car does not go straight, rotate the remote control front wheel trim ⑤, the model car to the right side, the front wheel Turn the trim to the left, the model car leans to the left, and the front wheel trims to the right to rotate until the model car can go straight.
5. Throttle speed adjustment ⑥ can adjust the model car speed, rotate to the right, hook the trigger model car speed becomes faster, turn left, hook the trigger model car speed becomes slower.
6. OK, ready to run.

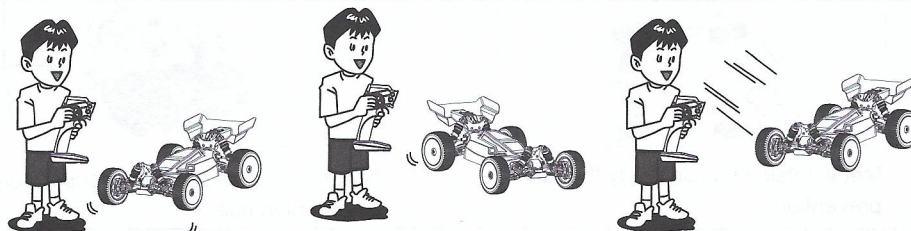
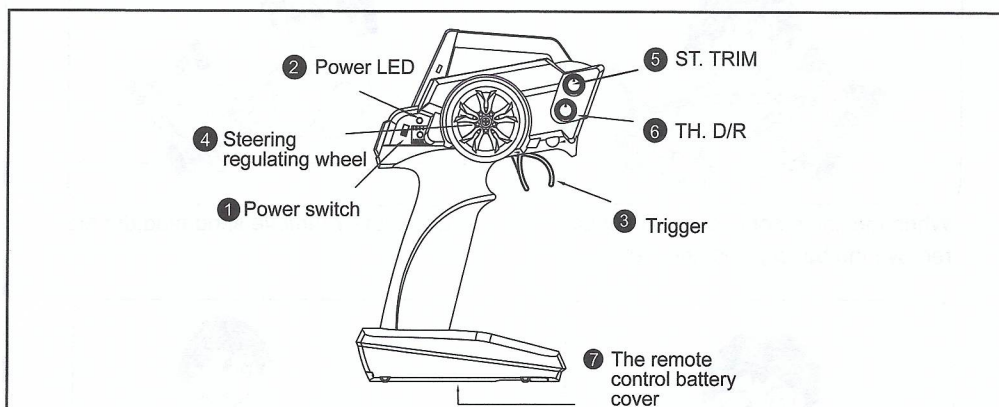

Practice

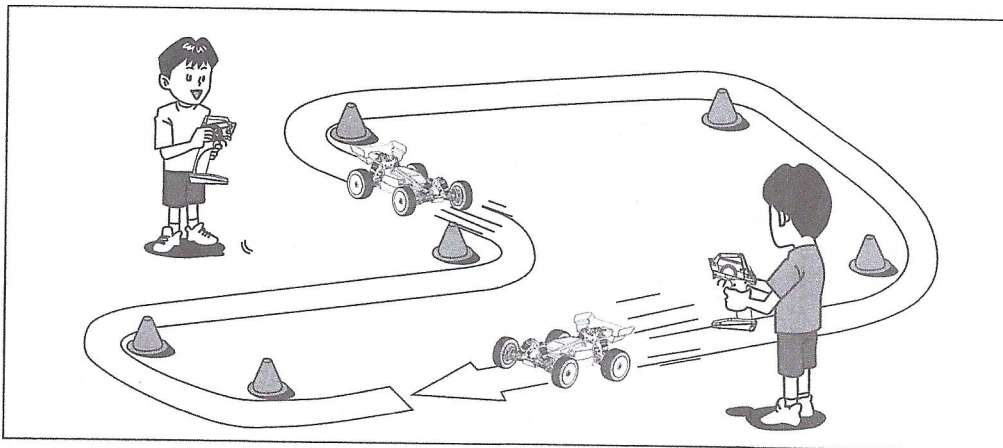

Let's practice! Make R/C car circuit at a wide and safe location using corner pylons (separately available), empty cans or such. Running fast at straight section and slow down at curved section is a basic speed control technique useful when driving R/C car.

Maintain

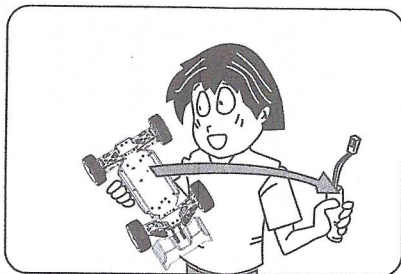

When the car is not in use, you should remove the battery from the car.

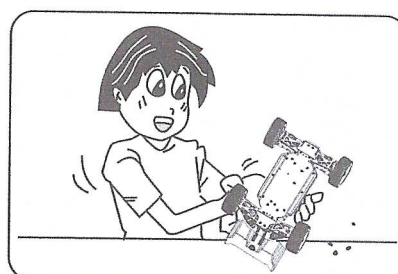

Completely remove sand, mud, dirt etc.

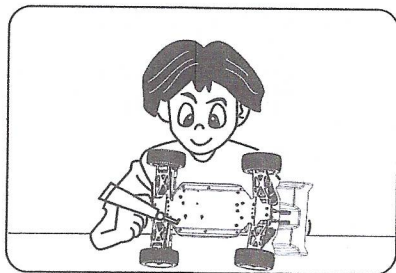

Metal outside should apply the rust prevention oil.

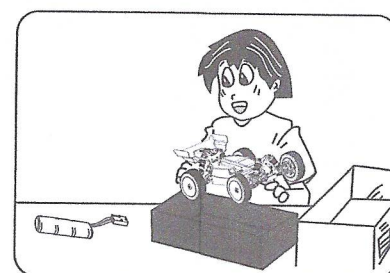

Store the car and batteries separately when not in use.

Assembly Exploded Diagram

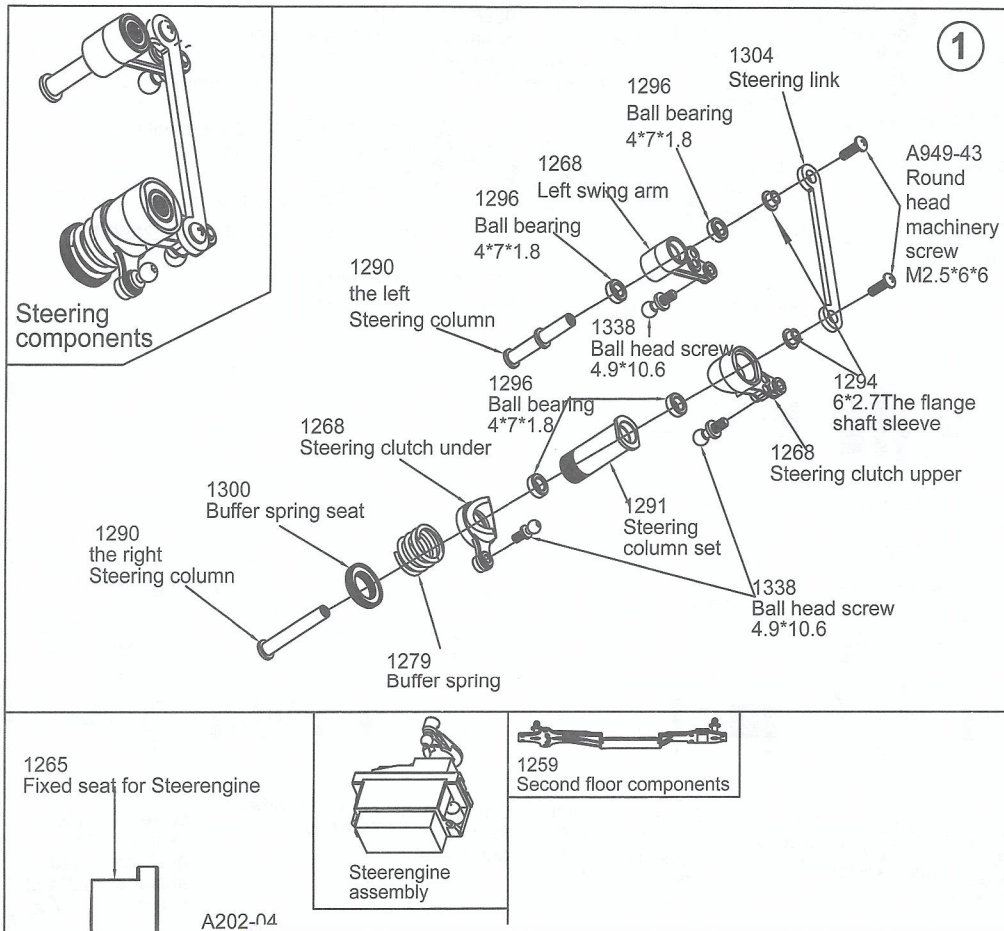

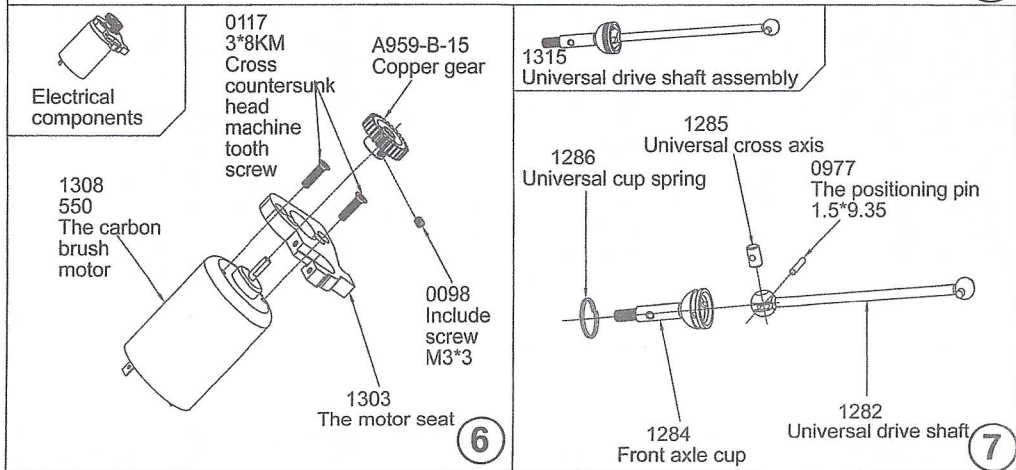
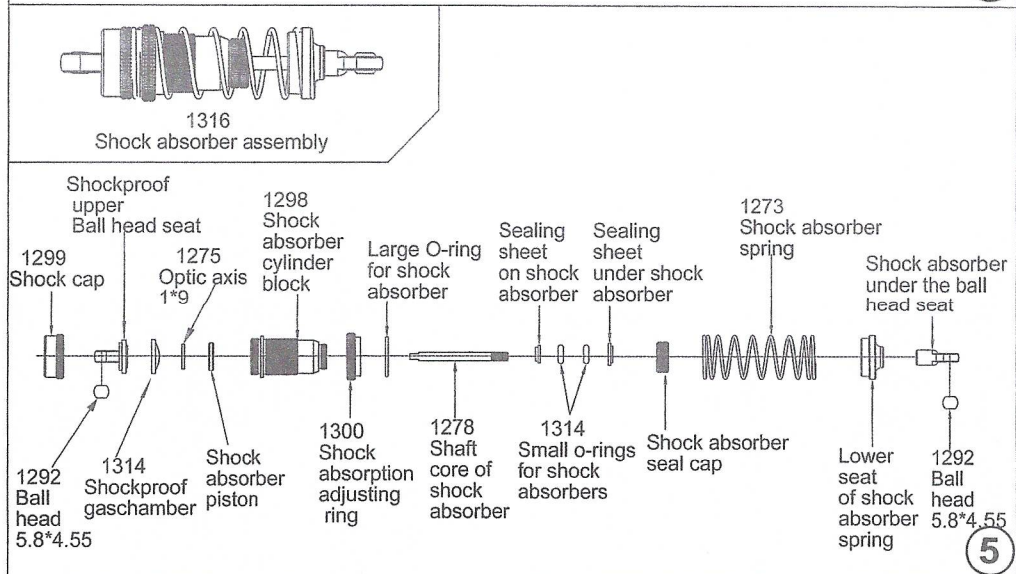
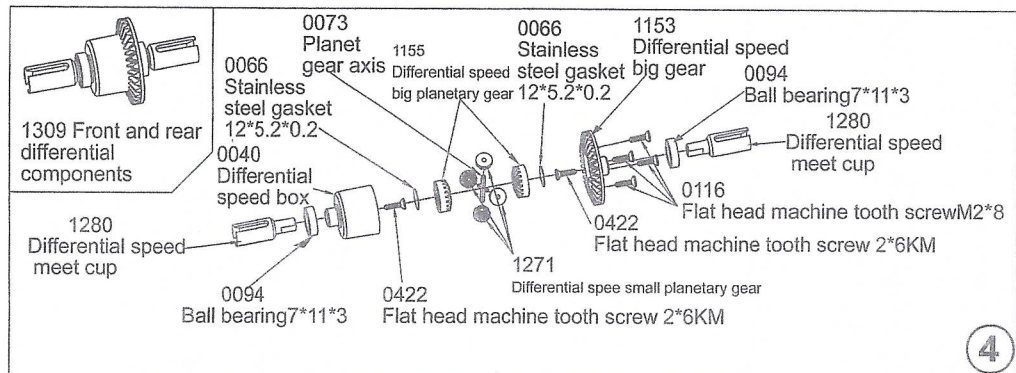

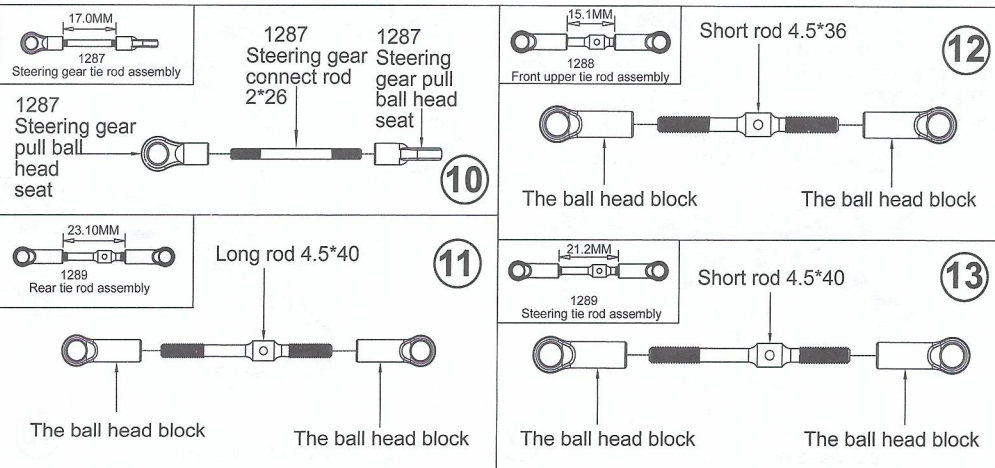
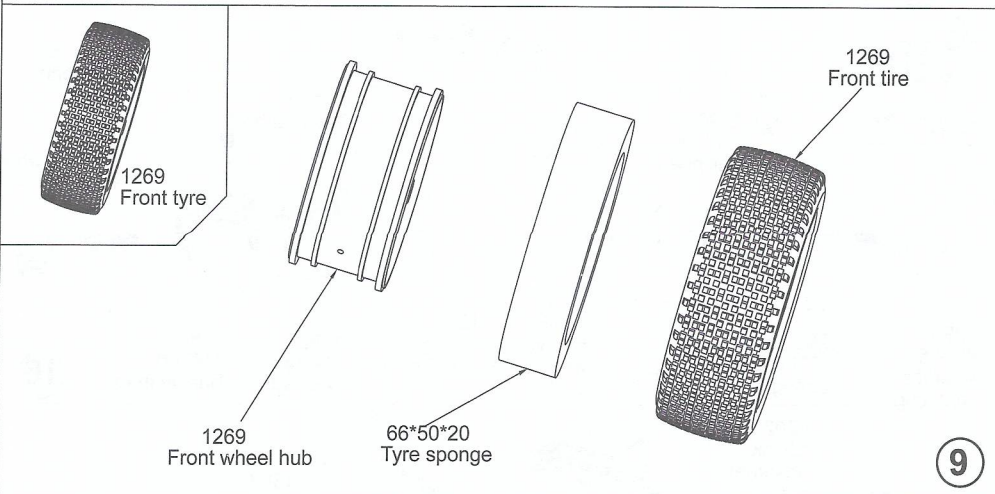
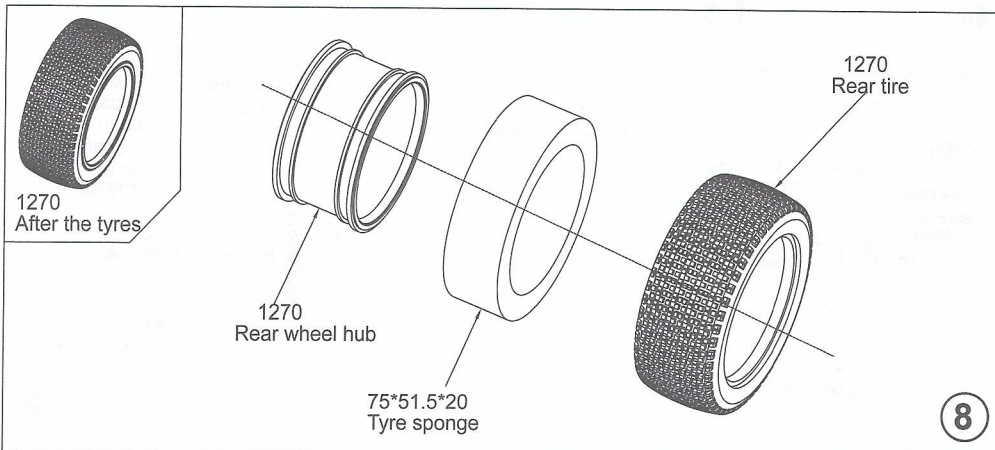

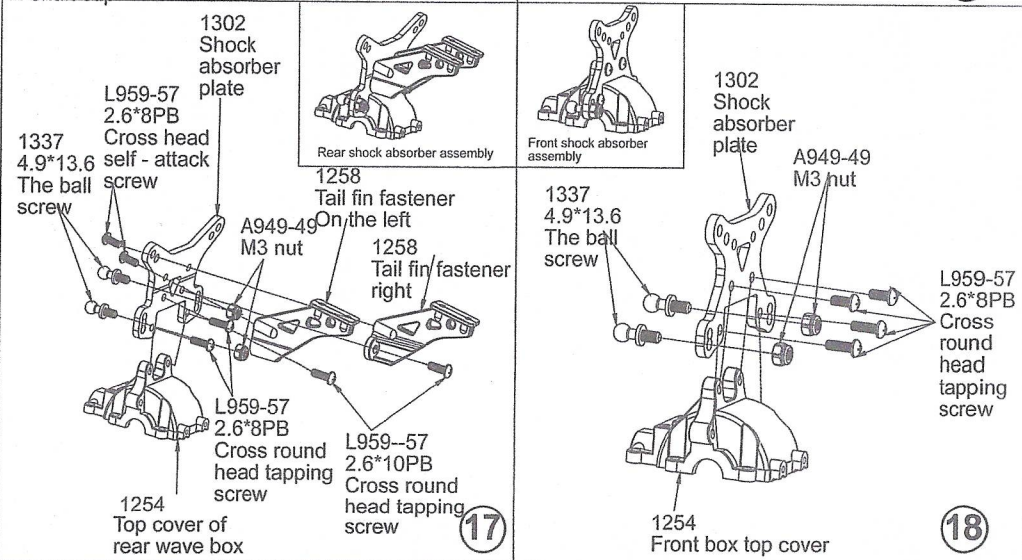
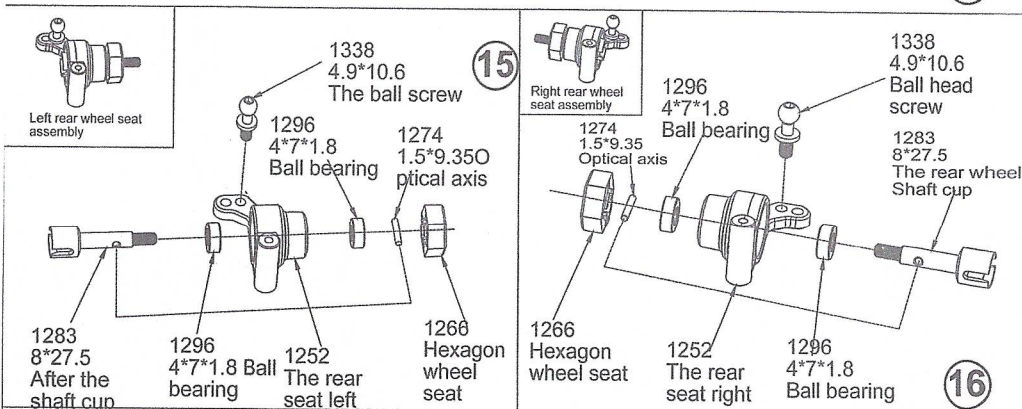
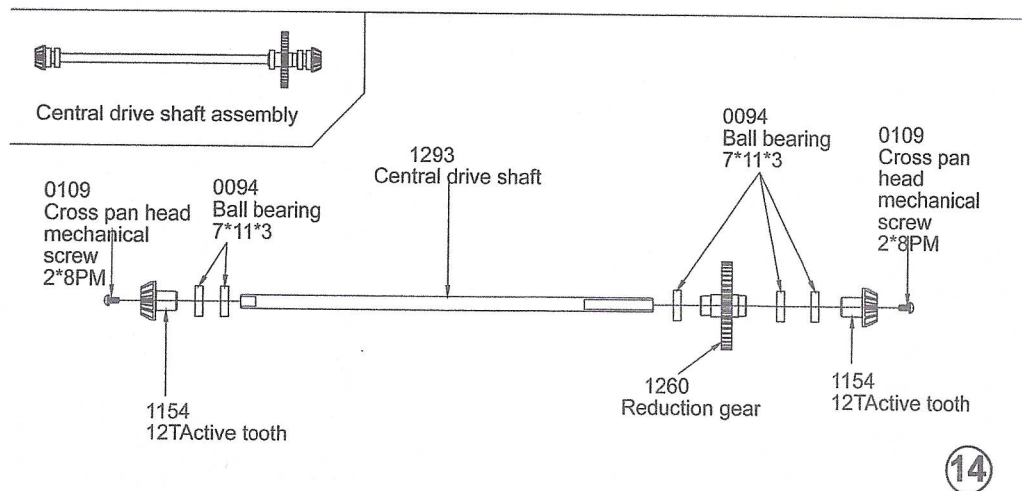

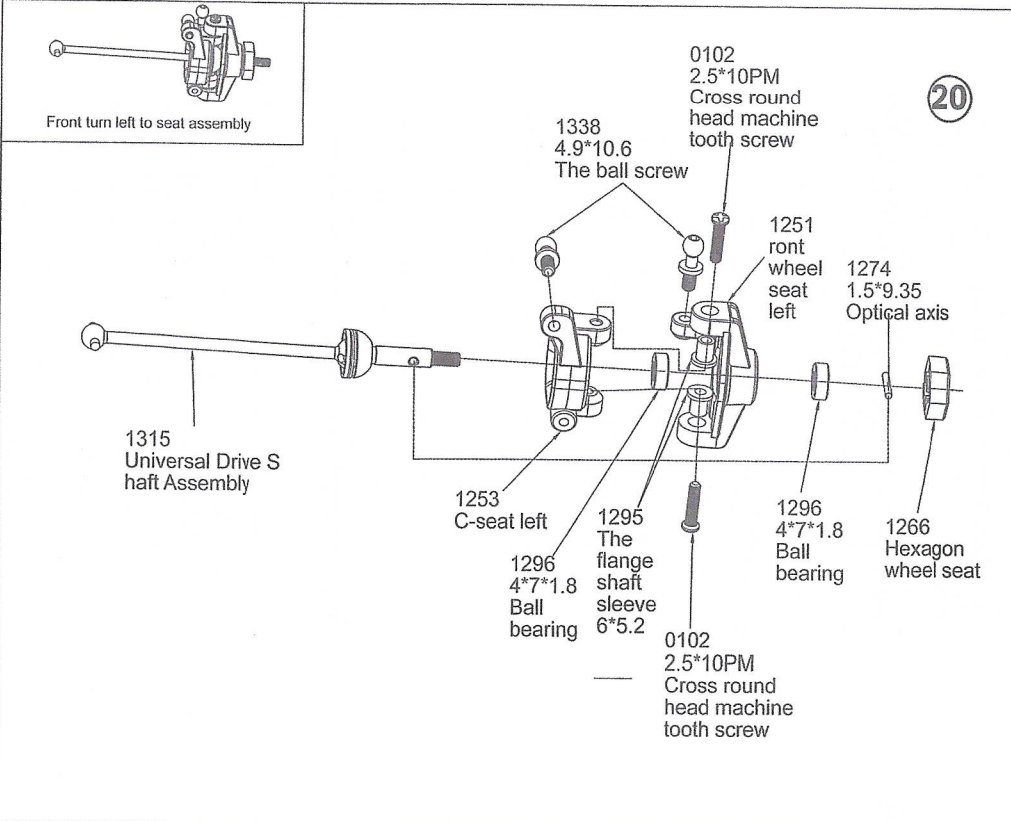
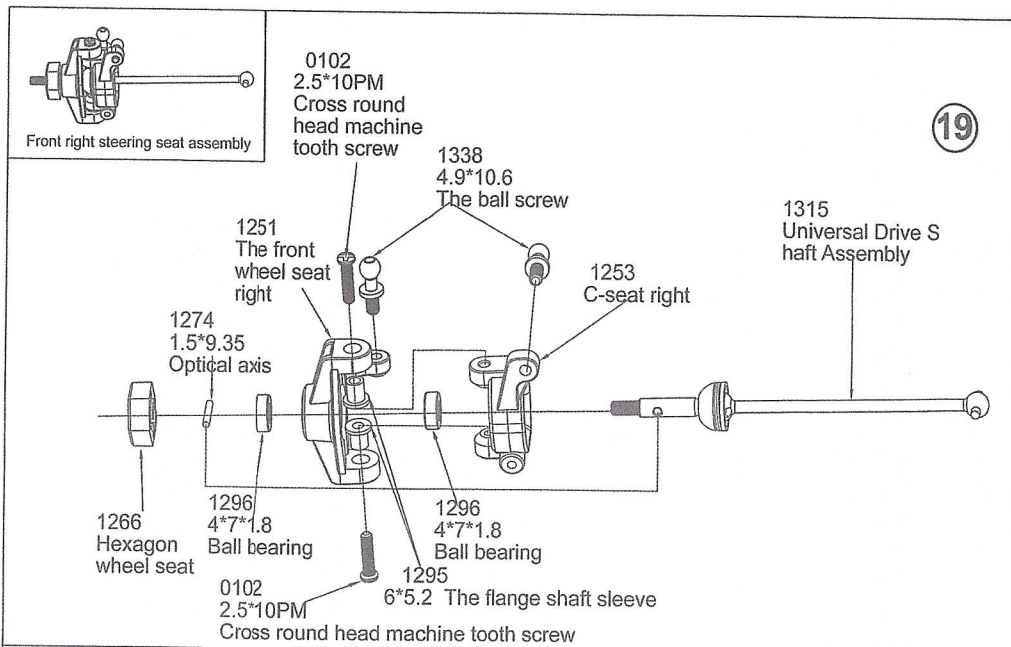

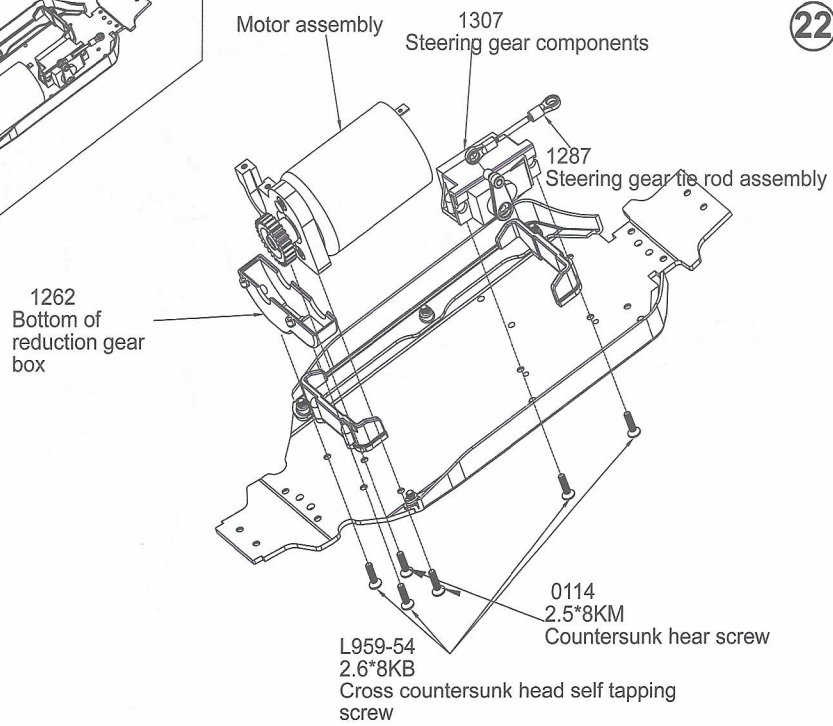
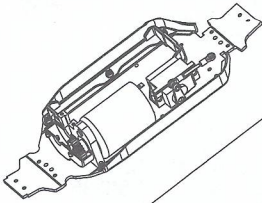
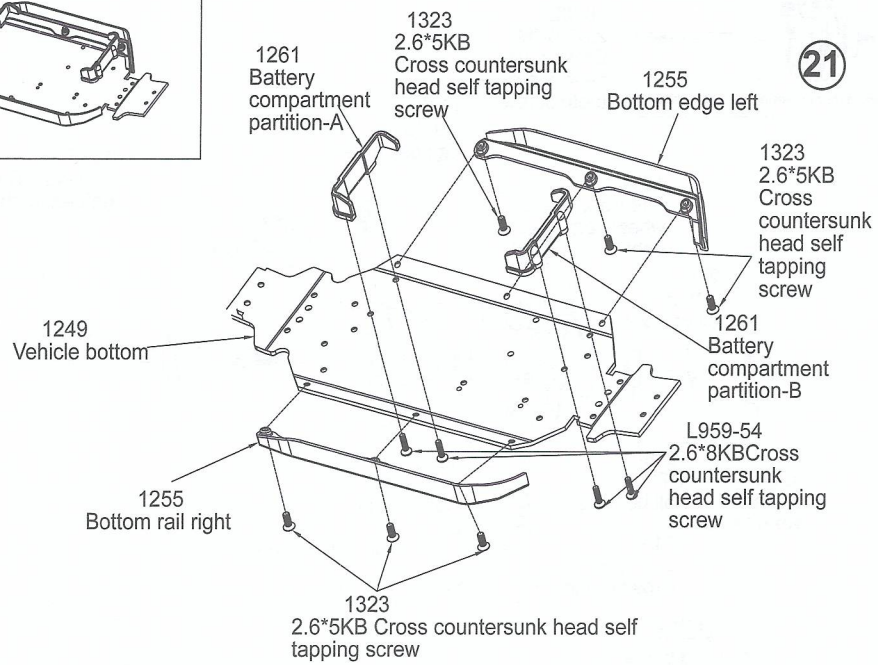
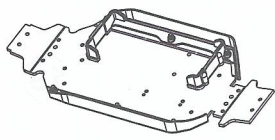

Rear wave box assembly

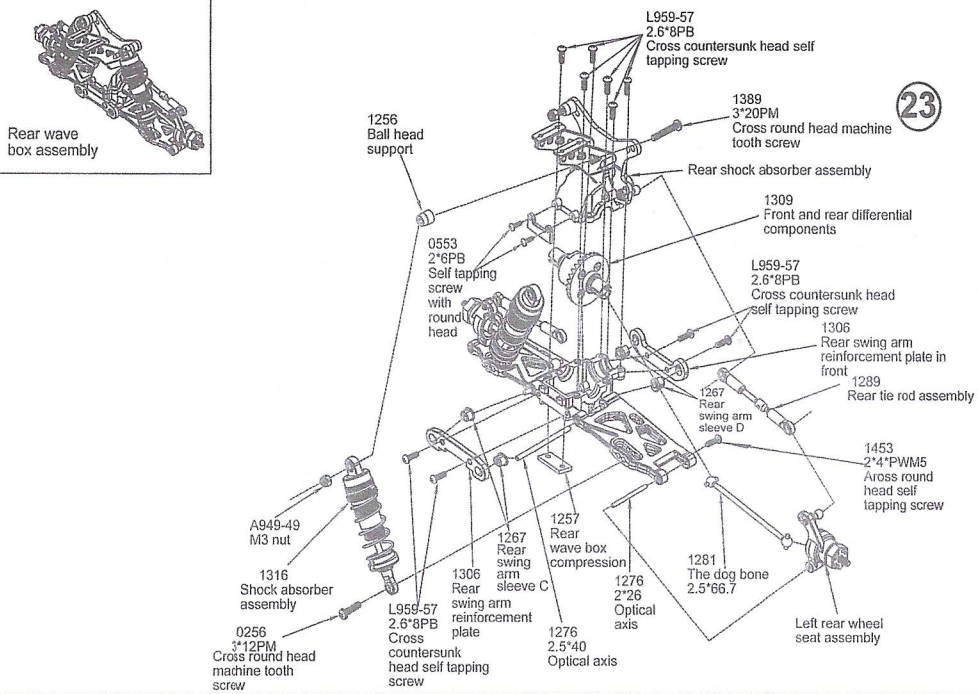

Front wave box assembly

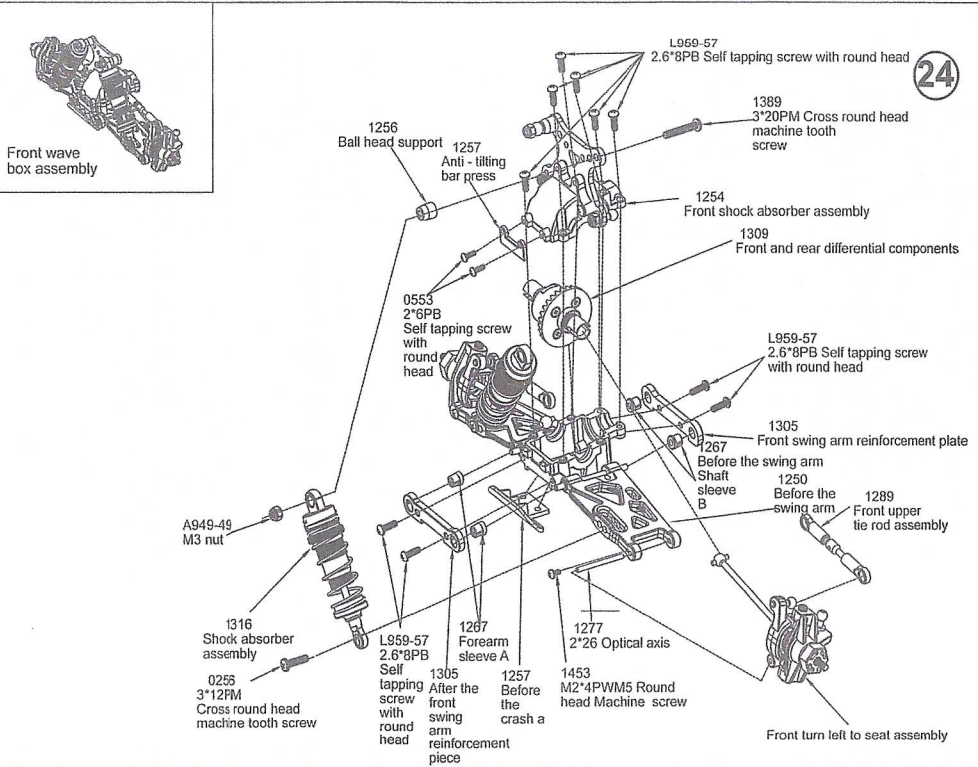

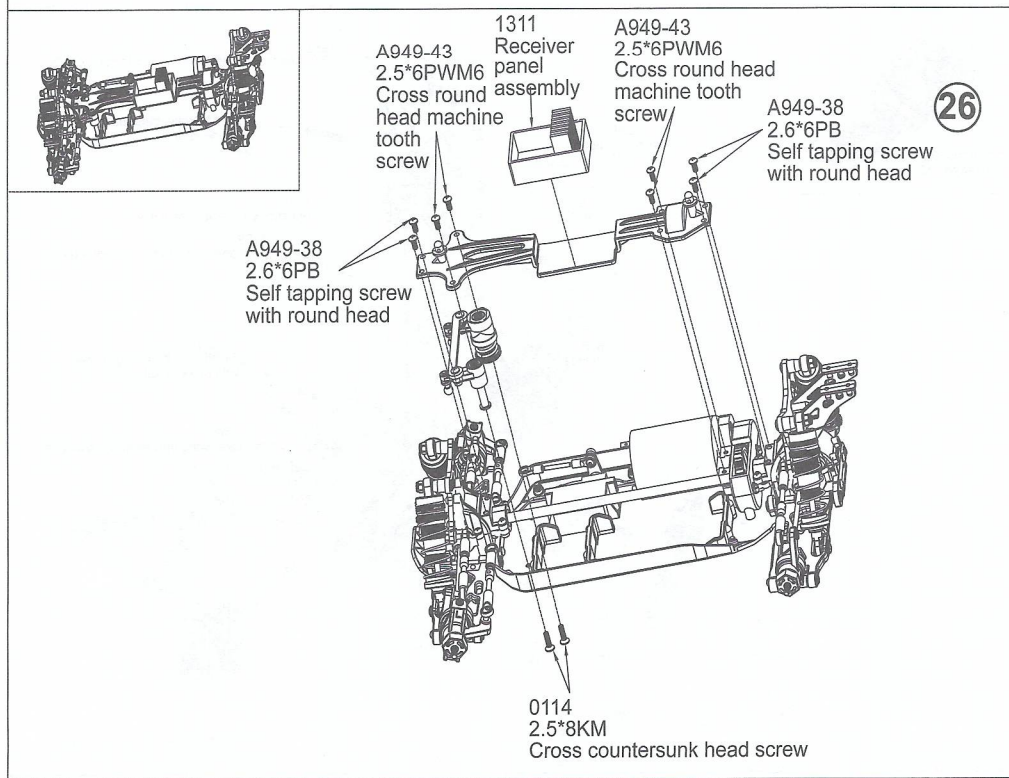
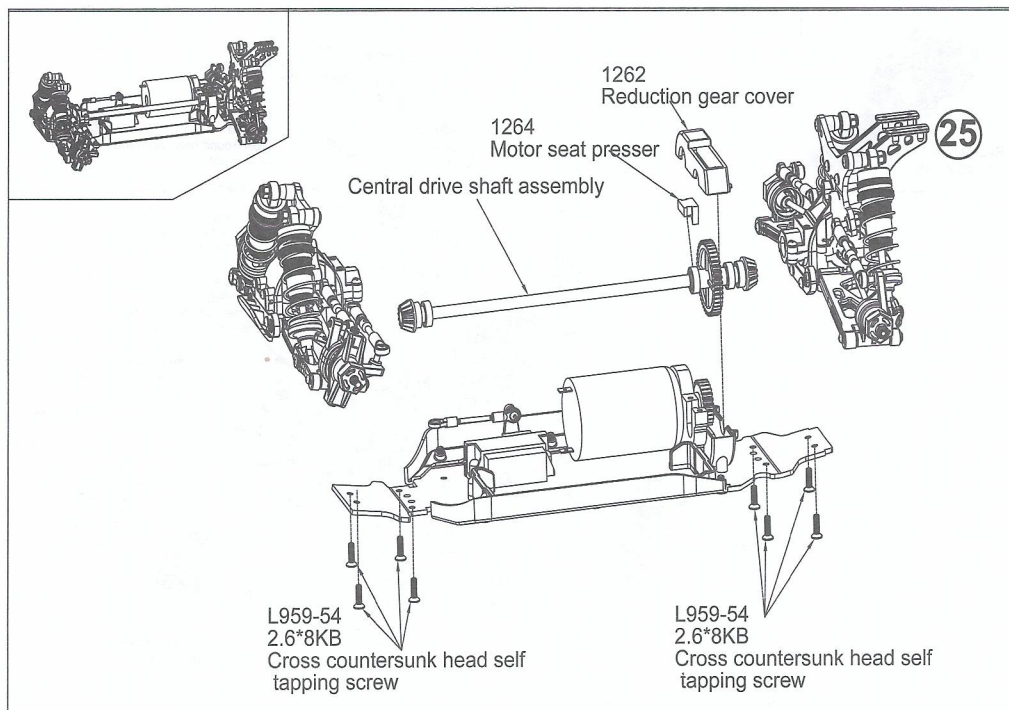

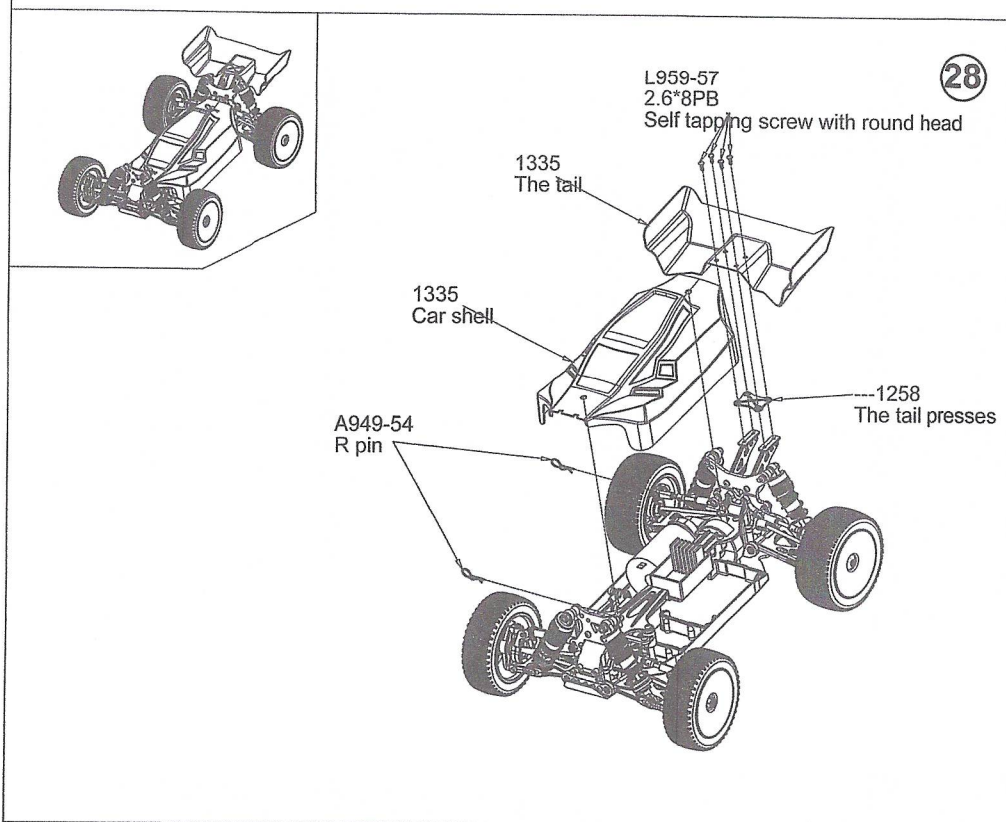
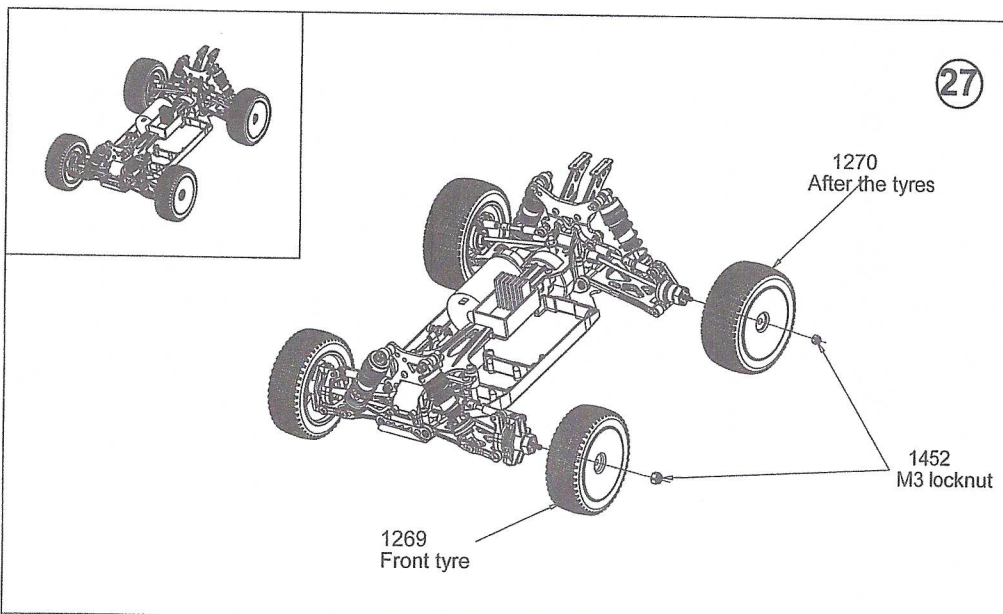

Sale parts view

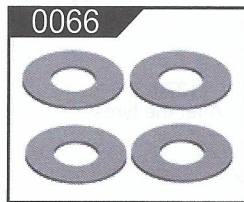

0066
12 * 5.2 * 0.2 gasket
set assembly

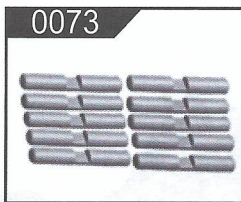

0073
Differential shaft
assembly

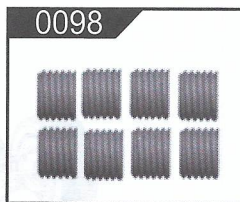

0098
M3*3 Inner hexagonal
screw assembly

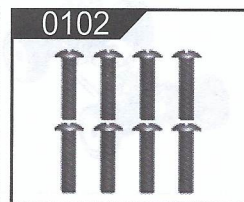

0102
2.5*10PM screw
assembly

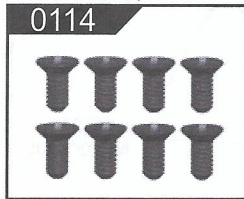

0114
2.5*8KM screw
assembly



0117
3*8KM screw assembly

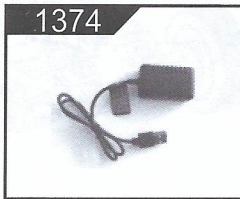

1374
USB charging line

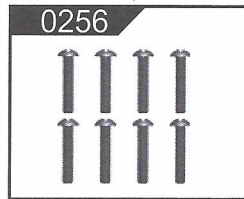

0256
3*12PM screw assembly



1669
V2-144001
Remote controller



0422
2 * 6KM screw
assembly



0553
2 * 6PB screw assembly



0582
ST2*7PB screw
assembly



1153
30T Differential Large
Teeth(Hardware)
Component



1154
12T Active
Teeth(Hardware) Group



1155
24T Differential Large Planetary
Teeth(Hardware) Group

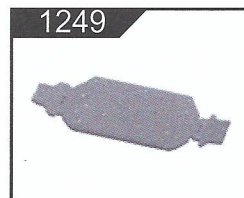

1249
car body assembly



1250
Front and rear arms

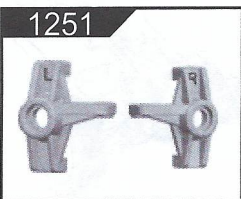

1251
Front seat assembly



1252
Rear seat assembly



1253
Type C Block
Component

Sale parts view

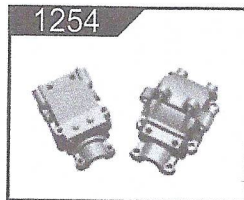

1254 Wave Box Component

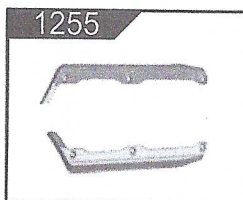

1255 Bottom side guard assembly

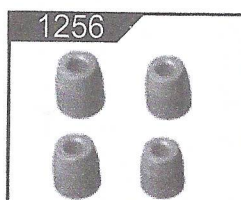

1256 Ball head support assembly

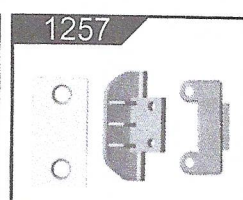

1257 Anti-collision accessories components



1258 Final-end firmware component



1259 Second floor panel components

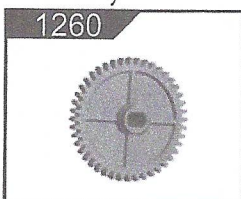

1260 Slow down large tooth assembly



1261 Battery partition assembly



1262 Speed gear upper and lower cover assembly



1263 Tiller arm assembly

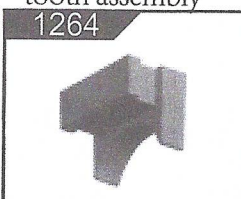

1264 Motor seat press component



1265 Steering seat press assembly

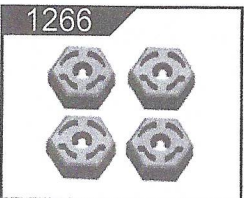

1266 Hexagonal seat assembly

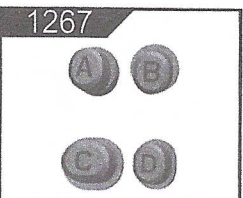

1267 Front and rear arm sleeve



1268 Switch to clutch component

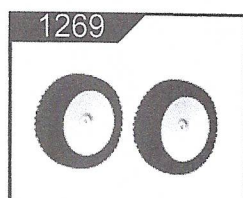

1269 Front tire assembly

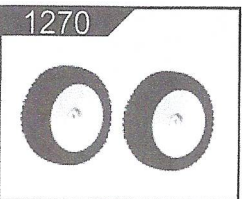

1270 Back tire assembly

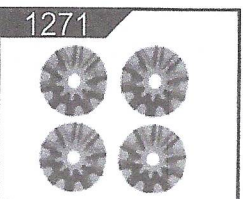

1271 10T Differential Asteroid Teeth(Hardware) Group

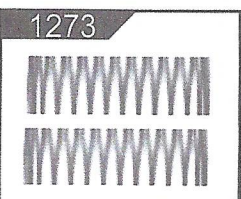

1273 Shock absorber spring assembly

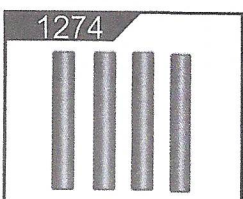

1274 1.5*9.35 Optical axis

Sale parts view

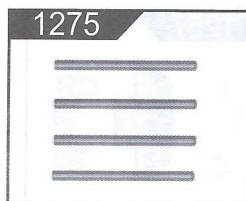

1275
1*9 Optical axis

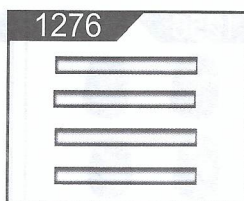

1276
2.5*40 Optical axis

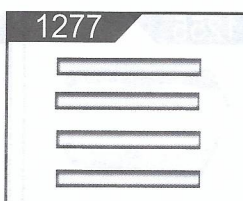

1277
2*26 Optical axis

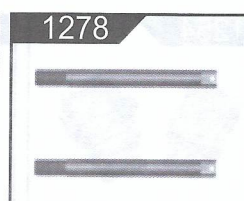

1278
Shock absorber shaft component



1279
Buffer spring assembly



1281
Dog bone assembly



1282
Universal drive shaft assembly

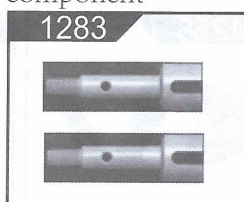

1283
Rear Wheel Cup Component

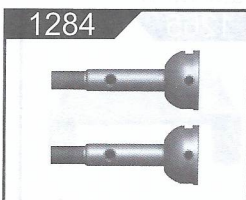

1284
Front Wheel Cup Component

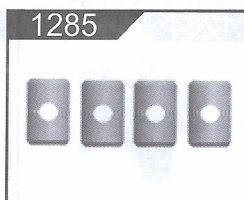

1285
Cross shaft assembly



1286
Universal cup spring assembly

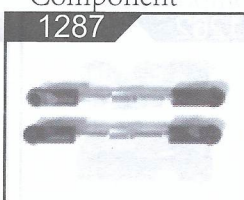

1287
Steering gear lever assembly

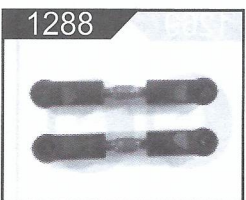

1288
Short pull bar assembly

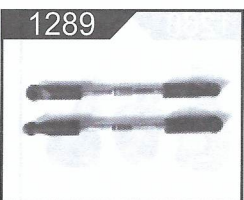

1289
Long pull bar assembly

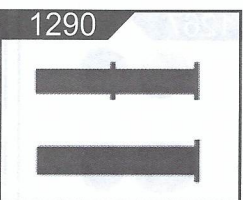

1290
Steering column assembly



1291
Steering column sleeve component

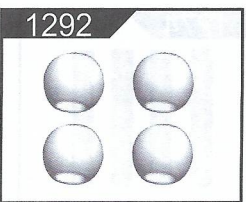

1292
Ball Head Component



1293
Central Transmission Axis Component

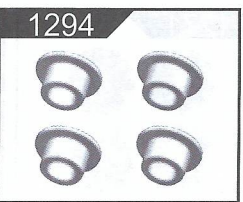

1294
6 * 2.7 flange sleeve assembly

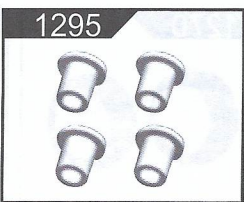

1295
6 * 5.2 flange sleeve assembly

Sale parts view

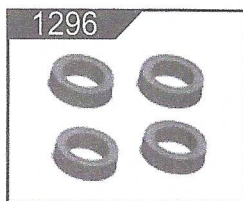

Ball bearing assembly

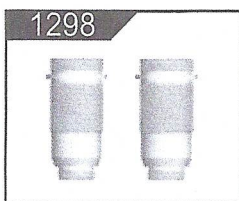

Shock absorber
cylinder assembly

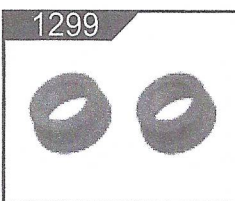

Shock absorber
cap assembly

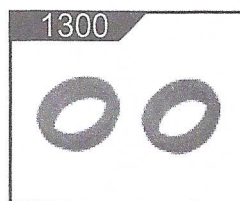

Regulate Ring
Component

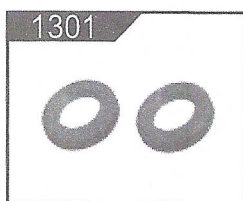

Spring seat assembly



Shock absorber
assembly

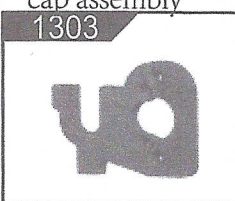

Motor Block
Component



Steering connecting
rod assembly

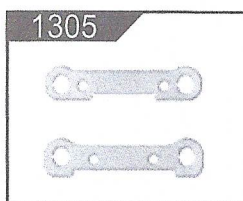

Front swing arm
reinforcement module

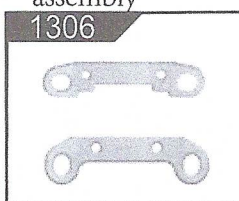

Backswing arm
reinforcement module



Rudder assembly

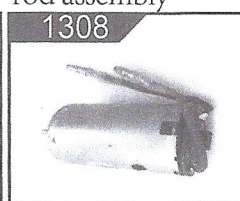

Motor components



Differential

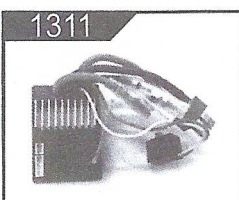

Receiver board
assembly

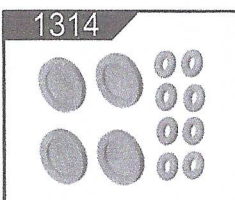

Type 0 assembly

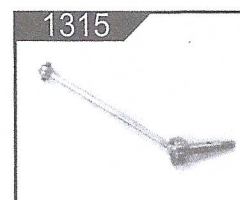

Coaxial component

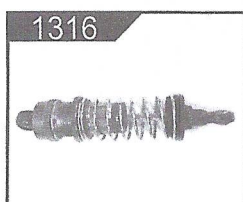

Shock absorbers

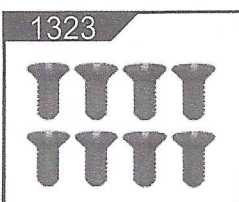

ST2.6*5KB screw
assembly

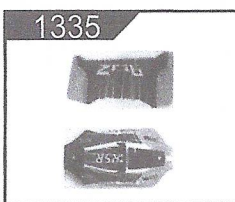

Car shell components

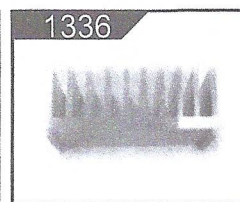

Heat Discharge Group

Sale parts view

1337



4.9*13.6Ball Head
screw assewibly

1338



4.9*10.6Ball Head
screw assembly

A202-04



4.0*9.5Ball Head
screw assewibly

A202-15



ST2*8KB screw
assembly

A303-39

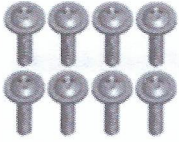

ST2.6*6PWB6 screw
assembly

A929-86



M3*5 Inner hexagonal
screw assembly

A949-22



Magic paste group

A949-35



Ball bearings 7 * 11 * 3
groups

A949-38



ST2.6*6PB screw
assembly

A949-43

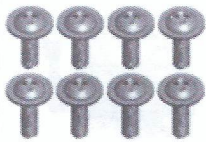

2.5*6PWM6 Screw
assembly

A949-49

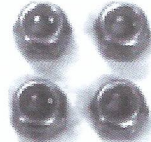

M3 Loose nut
assembly

A959-B-15



Motor teeth 27T group

A959-B-23



Battery assembly

L959-54

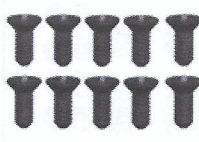

ST2.6*8KB screw
assembly

L959-57



ST2.6*8PB screw
assembly

L959-58

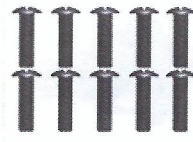

ST2.6*10PB screw
assembly

1452

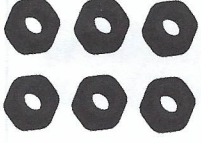

M3 flange nut

1389

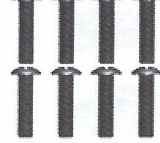

3 * 20pm Cross
round head
machine screw

1453

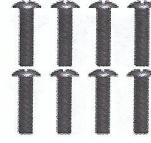

2*4PWM5
Cross round head
machine screw

1656



2.5*8PWM6
Cross round head
machine screw

