

User Manual

2.4G Wireless USB+Type C + Bluetooth
Rechargeable Mouse

MV09D

Product Features

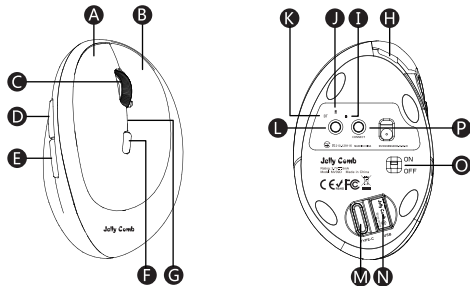

- A** Left click
- B** Right click
- C** Scroll wheel
- D** Forward
- E** Backward
- F** DPI Button
- G** Low battery indicator / Charging indicator / DPI Switch Indicator
- H** Micro charging port
- I** Type C connection indicator
- J** USB connection indicator
- K** Bluetooth indicator
- L** USB/TYPE-C/Bluetooth mode switch button
- M** Type C receiver
- N** USB receiver
- O** Power switch
- P** Bluetooth Connection button

2.4G Wireless Connection with USB Receiver

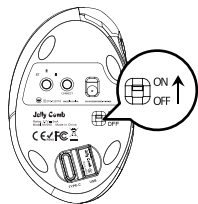

Turn on the mouse

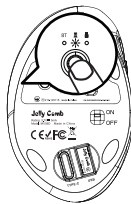

Press mode switch button till
White light turn on.

Open the battery cover and take
out the USB receiver.

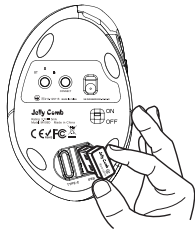

Insert the USB receiver into
your computer's USB port, and
the mouse will connect
automatically.

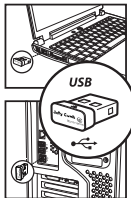

Bluetooth Connection

For WINDOWS 10

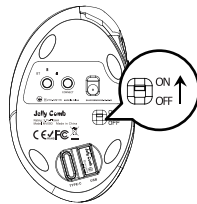

Turn on the mouse

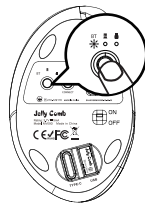

Press Mode Switch button till
"BT" white light turned on.

Long press Connection Button
for 3-5S till white light flashes
quickly.

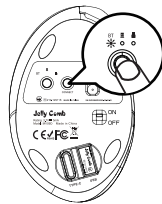

Open the "Bluetooth Device "
in your Windows computer(Below
is the example of Window 10).

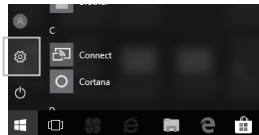

5 Click "Add Bluetooth Device"



6 Your computer will automatically find "BT4.0+2.4G Mouse", and then click "Pair"

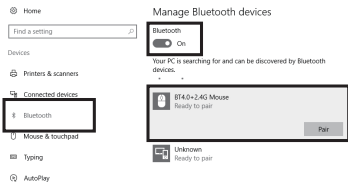

7 You can use your mouse after pairing complete.

Your PC is searching for and can be discovered by Bluetooth devices.

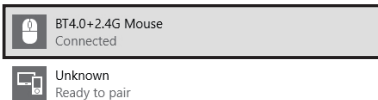

For Mac OS

- 1 Press Mode Switch button till "BT" white light turned on.
Long press Connection Button for 3-5S till white light flashes quickly.
- 2 Open up system preferences on your PC.



3 Then click "Bluetooth".



4 Searching and discovering by Bluetooth devices named "BT4.0+2.4G Mouse", click to connect. After connected, the mouse is ready to use.



2.4G Wireless Connection with Type-C Receiver

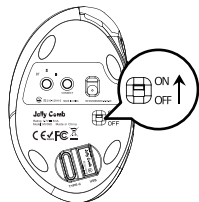

Turn on the mouse

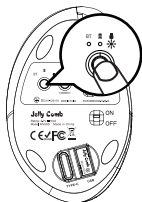

Press mode switch(1-2 times)
till  White light turn on.

Open the battery cover and take
out the type-c receiver.

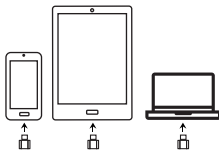
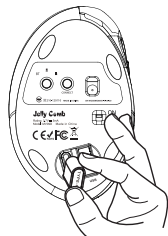

1 2
3 4

Insert the type c receiver into the
type c port of a cellphone,
laptop, or computer, and the
mouse will connect automatically
with your device.

How to Switch Connection Mode

After Bluetooth, Type C and USB wireless mode is connected, press
USB/TYPE-C/Bluetooth mode switch button to switch between different devices.
One press can only switch mode once. You may need to press it twice to get the
mode you want.

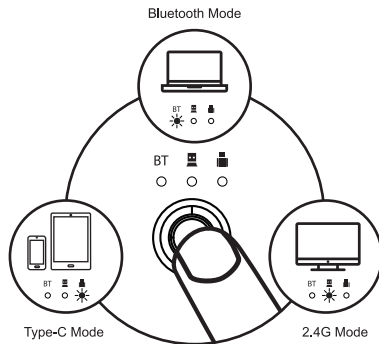

Press USB/TYPE-C/Bluetooth mode switch button

How to Charge the Mouse

- 1 When the battery power is low, please charge the mouse with the included USB charging cable (by inserting the USB charging cable into USB port of the computer).

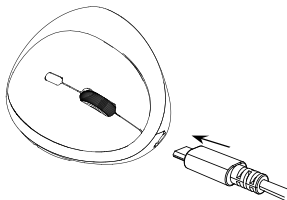

Note: Best to use original data transmission cable.

- 2 While charging, power indicator turns blue. And it needs about 1-2 hours to be fully charged. The blue indicator will turn off when fully charged. Also, when the battery power is too low (around 3.4V), the red indicator will flash. Red indicator will flash once when switch one DPI level.

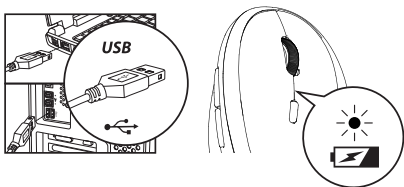

Specifications

Basic Parameter:

Chip: Nordic NRF51802
Engine: optics
Li-ion Battery: 300mAh
DPI level: 1000-1600-2400DPI
Click life: more than 3 million times
Dimension: 104 x 67 x 58mm
Weight: 82.5g

Bluetooth Connection Parameter:

Bluetooth version: 4.0
Working distance: 10m
Voltage: 3.7V
Current: 4mA
Report rate: 90Hz
System requirement:
Bluetooth-enable device
Windows 8, Windows 10
Mac OS X 10.10 or higher version
Android 4.3 or higher version

2.4G Wireless Connection Parameter:

Working distance: 10m
Voltage: 3.7V
Current: 5.5mA
Frequency: 125Hz
System requirement:
Device with USB port
Windows XP, Window 7, Windows 8, Windows 10;
Mac OS X 10.10 or higher version

Package List

- ▶ 1 x Wireless Mouse
- ▶ 1 x USB charging cable
- ▶ 1 x USB receiver
- ▶ 1 x Type C receiver
- ▶ 1 x User manual