

封面

BH-M9 Mono Bluetooth Headset

User Manual

Contents:

| | |
|-------------------------------------|---|
| 1. Product Overview | 2 |
| 2. Basic Operation | 3 |
| 3. Bluetooth Pairing and Connection | 4 |
| 4. Connection with Two devices | 5 |
| 5. LED Indicator | 6 |
| 6. Charging | 6 |
| 7. Product Specification | 8 |
| 8. Attention and Q & A | 8 |

1

1. Product Overview

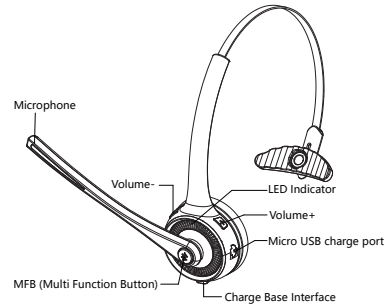

Package Contents:

- A. Bluetooth Headset BH-M9 x 1
- B. Charge Base x 1
- C. Micro USB charging cable x 1
- D. User manual x 1

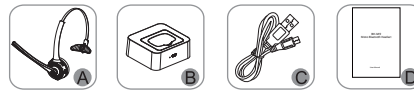

2

2. Basic Operation

| Button | Function | Operation Instruction |
|----------|-------------------------|--|
| MFB | Power On | In 'OFF' status, long press for 1-4 seconds to power on (When powered on, it will automatically reconnect to the last paired device if there is pairing record.) |
| | Power Off | In on status, Long press for 5 seconds to power off |
| | Enter into Pairing Mode | Long press 5-8 seconds to enter pairing mode in 'OFF' status, I, or double press the MFB to pair under unconnected / reconnecting status |
| | Play/Pause | Short press when play music |
| | Redial a call | Double press to dial the last call after connected |
| | Reconnect | Power on to automatically reconnect when there is pairing record. Or short press MFB to reconnect. |
| | Voice Dialing | Long press for 1 second |
| | Audio Switch | Long press for 1 second to switch between phone and headset during a calling |
| | Answer a call | Short press |
| | Hang up a call | Short press |
| Volume + | Next Song | Long press for 1 second |
| | Volume Up | Short press |
| Volume - | Volume Down | Short press |
| | Previous Song | Long press for 1 second |

3

3. Bluetooth Pairing and Connection:

- A. In 'OFF' status, long press 5-8 seconds to enter pairing mode with Blue & Red indicator light flashing alternately.
- B. Search and click to connect 'BH-M9' on your phone Bluetooth list, and blue indicator flashes after successfully connected. That means that you can play music from the headset at this time.
- C. Press MFB/ volume+/ volume- on the Bluetooth headset to control the answer/hang up a call and play/ pause of the music, next/ previous song, volume up/ down.

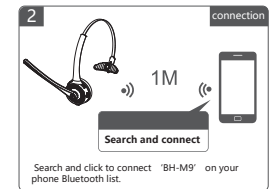
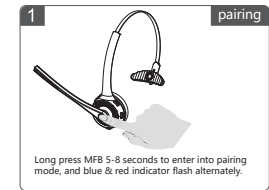

4

4. Connection with Two devices:

- A. After successfully connected with Phone #1 according to Section 3, please turn off the Bluetooth function of Phone #1.
- B. Set headphones to pairing mode again- In unconnected standby status, double press MFB to enter pairing mode with red & blue indicator flashing alternately.
- C. Search and click to connect 'BH-M9' in the Bluetooth list of Phone #2, and blue indicator flashes slowly after connected.
- D. Turn on Bluetooth function of Phone #1, and click to reconnect 'BH-M9' on Bluetooth list. Headset is connected with two phones now.



Notes:

Music plays from one phone only under two connections. Please pause or stop the music of the previous phone if you want to play music from another phone. The same operation during talking status.

5

5. LED Indicator

| Mode | LED Indicator |
|--------------------------|--|
| Power on | LED Blue flashes for 1 second |
| Power off | LED Red flashes for 1 second |
| Pairing mode | LED Red & Blue flash alternately |
| Unconnected standby mode | LED Blue flash once every 2 seconds |
| Connected standby mode | LED Blue flash once every 5 seconds |
| Playing Music | LED Blue flash once every 5 seconds, |
| Talking | LED Blue flash once every 5 seconds |
| Delete paired record | Blue and Red LED flash once at the same time |
| Charging | Solid LED Red |
| Full charged | LED Red turns off |
| Low battery | Red LED flashes |

6. Charging

Please charge the BH-M9 at once when the Red LED flashes. Charging time takes about 2 hours. There will be solid and continuous LED Blue when full charged.

Charge Connections

Please connect the BH-M9 charging port via the Micro USB charging cable. The charger can be used as car charger, travel charger, computer USB, etc.

6

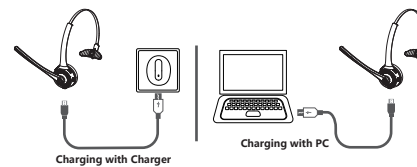

Use of charge Base

Please place the BH-M9 on the charging base correctly, then connect the charging base to USB charger through the Micro USB cable for charging.

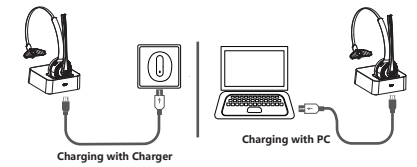

Notes:

- 1. Pls charge the BH-M9 at least one time every 3 months when not in use.
- 2. Charging when the item powered on, the headset will be automatically reset and powered off.

7

7. Product Specification:

| | |
|------------------------|-----------------------------|
| Bluetooth Version | V5.0 |
| Bluetooth Chipset | CSR8615 |
| Operation Range | 10 meters |
| Bluetooth Protocols | HSP, HFP, AVRCP, A2DP |
| CODEC Code | SBC |
| Battery Capacity | 180mAh/3.7V |
| Charging Time | About 2 hours |
| Stand-by Time | 200 hours |
| Working Time | About 15 hours (50% volume) |
| Headset Net Weight | About 47.5g |
| Charge Base Net Weight | About 245g |
| Headset Dimension | 158.07*148.32*51mm |
| Charge Base Dimension | 83.5*83.5*30mm |

Notes: *Actual use time will differ from environment and music

8. Attentions and Q & A:

A. How to reconnect and operate when failed to reconnect?

A: After BH-M9 connected with your mobile phone successfully, it will search and reconnect the paired device automatically when powered on. If failed, please pair and connect again.

B. How to Delete paired records?

A: In 'Power-ON' status, long press the MFB and the volume-button for 5 seconds to clear the pairing record. The indicator

8

Blue and Red flash once at the same time, which means the pairing record has been cleared and the headset will not reconnect to the connected device at this time. When there are various connection problem, try clearing the pairing record. (NOTE: Please restart the headset when clearing the records. The headset will not cut connection when clearing records in connected status.)

C. What's the password for pairing?

A: Some connection devices require password for pairing, pls try 0000

D. What devices could charge for the headphone?

A: Any car charger, power bank, or PC that meets DC 5V or charging current $\geq 500\text{mA}$ could be used for this item.

E. Three-way calling function operation

A: I. When new call coming during a call

1. Short press the MFB to answer the new call and hang up the current call;

2. Double press the MFB to answer the new call and keep the current call;

3. Long press the MFB for 1 second to reject a new call.

II. When you are on a three-party call, double press the MFB to switch audio between the current call and the standby call.

F. How to mute the microphone

A: Put the microphone up to head to mute, and put it down to cancel the mute during a call.

G. How to reset the headphone

A: Press MFB and plug the charge cable when powered on, the headset will be reset and powered off.

9

SIZE:65x95mm 128克双铜纸双面印刷 折叠 (手风琴式)