

Qi™ Wireless Charger User Manual

Step 1:

Connect one end of the included cable to the wireless charger.

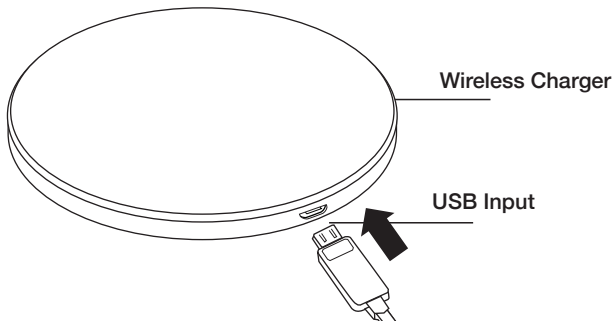

Step 2: Connect the other end of the included cable to a wall adaptor. Plug the wall adaptor into a wall outlet (wall adaptor not included).

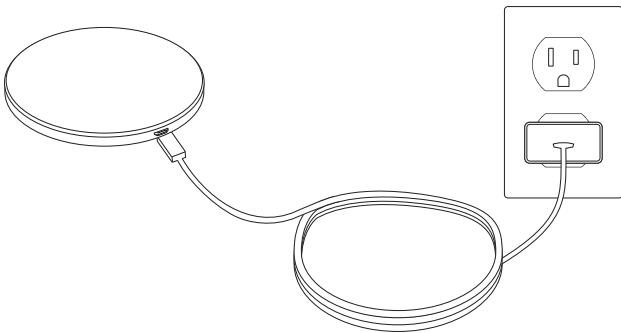

Step 3: Place your Qi-enabled device on top of the wireless charger. An LED light will power on to indicate the phone is charging.

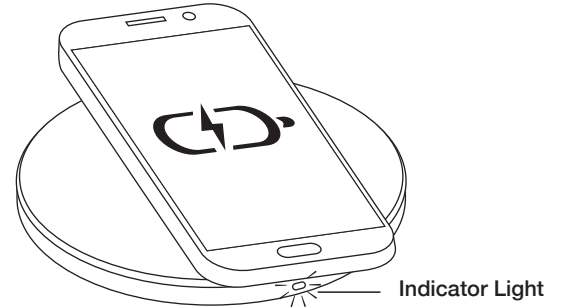

Important Safety Information

- Protect the Qi Charger from extreme heat or cold.
- Protect the Qi Charger from liquids or excessive humidity.
- Use the Qi Charger only as intended.
- Do not use Qi Charger if it is damaged.

This device complies with Part 15 of the FCC Rules. Operation is subject to the following two conditions: (1) this device may not cause harmful interference, and (2) this device must accept any interference received, including interference that may cause undesired operation.

Please note that changes or modifications not expressly approved by the party responsible for compliance could void the user's authority to operate the equipment.

NOTE: This equipment has been tested and found to comply with the limits for a Class B digital device, pursuant to part 15 of the FCC Rules. These limits are designed to provide reasonable protection against harmful interference in a residential installation. This equipment generates, uses and can radiate radio frequency energy and, if not installed and used in accordance with the instructions, may cause harmful interference to radio communications. However, there is no guarantee that interference will not occur in a particular installation. If this equipment does cause harmful interference to radio or television reception, which can be determined by turning the equipment off and on, the user is encouraged to try to correct the interference by one or more of the following measures:

- Reorient or relocate the receiving antenna
- Increase the separation between the equipment and receiver
- Connect the equipment to an outlet on a circuit different from that to which the receiver is connected.
- Consult the dealer or an experienced radio or TV technician for help.

REV 072019