

Milly + Coup

Milo2

Second Rule of Parent Club: always read your

manual

IMPORTANT! READ CAREFULLY
AND KEEP FOR FUTURE REFERENCE

Safety First

Thanks for choosing Milly + Coup.

We bet you can't wait to meet Milo2, but before you do, please ensure you carefully read your manual and all safety information.

Milo2 complies with both mandatory and voluntary Australian and New Zealand Safety Standards, however if you're not using it correctly or are not aware of the safety features, serious accidents can occur.

Wishing you many fun, happy and safe adventures out and about with Milo2!

Contents

- 4.** Safety warnings
- 7.** Parts checklist
- 8.** Setting up your frame
- 9.** Setting up your seat
- 10.** Removing your seat
- 11.** Setting up your canopy
- 12.** Using the harness
- 13.** Setting up your bassinet
- 14.** Attaching and removing the bassinet
- 15.** Using your bassinet
- 16.** Folding the stroller
- 17.** Using your Milo2
- 18.** Using Milo2 with a car capsule
- 20.** Accessories
- 22.** Milo2 maintenance
- 24.** Cleaning instructions
- 25.** Spare Parts
- 25.** Warranty

Tips to avoid tears

Safety Warnings

Milo2 is designed and tested to comply with AS 2088:2022, Consumer Protections Notice No. 8 of 2007 and AS/NZS ISO 8124-3.

WARNING

- FOLLOW THE MANUFACTURER'S INSTRUCTIONS.
- PUT ON ALL THE BRAKES WHENEVER YOU PARK THE STROLLER.
- DO NOT LEAVE CHILDREN UNATTENDED.
- DO NOT CARRY EXTRA CHILDREN OR BAGS ON THIS STROLLER.
- MAKE SURE CHILDREN ARE CLEAR OF ANY MOVING PARTS IF YOU ADJUST THE STROLLER, OTHERWISE THEY MAY BE INJURED.

WARNING

- USE THE HARNESS AT ALL TIMES.

WARNING

- USE THE TETHER STRAP TO STOP THE STROLLER ROLLING AWAY.

WARNING

- DO NOT USE THIS SEAT WITH ANY OTHER MODELS OF STROLLER.

WARNING

- DO NOT USE THIS BASSINET ONCE THE CHILD CAN SIT UP UNAIDED

WARNING

- DO NOT USE FOR UNSUPERVISED SLEEPING

Weight limits

- Maximum weight for a child in the seat is 22kg.
- Maximum weight for a baby in the bassinet is 9kg.
- Maximum weight for items in the basket is 10kg.
- Maximum weight that can be hung from the handlebar:
 - Seat facing parent: 2kg
 - Seat world facing: 4kg
- Maximum weight for the toddler board (sold separately) is 20kg
- Maximum weight limited for the handlebar bag is 2kg.

Baby (0–6 months) specific

- Do not use the bassinet once the child can sit up unaided (typically 4–6 months).
- Seat must be reclined to the flattest position for use with babies under 6 months of age until they can sit-up unaided and support their head. Without this neck strength there is a risk their head could fall forward and block oxygen flow.
- The harness must be used at all times when your baby or child are in the seat.

General Safety

- Never use the stroller in a manner for which it is not designed.
- Do not allow your child to climb, stand on or play with the stroller.
- Always ensure that the frame and the seat/ bassinet/car capsule are correctly engaged before using the product.
- Do not use parts or accessories that are not approved for use with the Milo2 range. Doing so may be unsafe and may also void your warranty.
- Ensure you carefully explain usage and safety features to new carers before they use the pram.

Unsafe Conditions

- Remove your child and take care when going up or down stairs or escalators.
- We recommend you take your child out of the stroller when travelling by bus, tram, or train. Even with the brake engaged, the stroller may slide when the vehicle brakes suddenly or is travelling on an incline/ decline.

- This stroller is designed for use on flat or gently sloping surfaces and may be unstable or even tip over on higher sloping and uneven surfaces.
- Do not use or leave the pram near open fire or an exposed flame.
- Not suitable for running, rollerblading or skating.
- Never leave rain covers or other covers over the stroller indoors, in a hot atmosphere or near a heat source.
- Ensure that the frame lock is engaged before lifting or carrying the stroller.
- Always remove the bassinet or car capsule and adaptors prior to folding and carry separately.
- Take care when folding and unfolding the stroller as there is potential for fingers or other body parts to be injured.

Carrying & transporting your stroller

- Do not lift or carry the stroller when fully assembled or when occupied by your child. Only lift and carry after folding.
- Make sure the stroller and all parts are secured when being transported in a vehicle.

Accessories

- Milo2 is compatible with the Milly + Coup Toddler Board, sold as a separate accessory. The maximum weight of a child on the toddler board is 20kg.
- Milo2 is only compatible with select car capsule models using the compatible capsule adaptors (both capsule & adaptors sold separately). Refer to our website for full compatibility.

You're now ready to set up your Milo2!

Meet Milo2!

Parts Checklist

Please check that you have all of the parts and accessories that you have ordered.

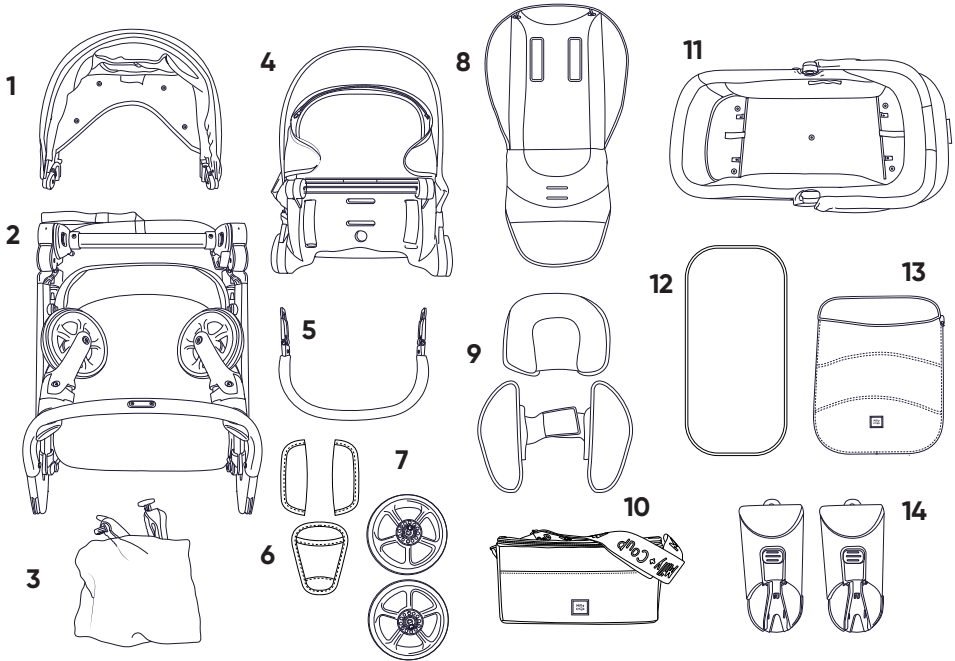

- 1 Canopy
- 2 Frame, Basket + Front Swivel Wheels
- 3 UV/Sleep cover
- 4 Seat
- 5 Belly Bar

- 6 3 x Harness Covers
- 7 2 x Rear Wheels
- 8 Seat Liner
- 9 Infant support set
- 10 Handlebar bag

Bassinet set only

- 11 Bassinet
- 12 Bassinet mattress
- 13 Bassinet cover
- 14 Bassinet adaptors

Setting up your frame

+ Release the black plastic frame lock on the left of the frame and lift the handlebar up until it clicks into place.

+ To adjust the handlebar, unclip the black plastic locks on each side and pull or push to the desired height.

Handy hint: the handlebar needs to sit within the grooves on the frame. If the locks won't close, give the bar a jiggle to ensure it's within a groove.

+ Insert the rear wheels into both ends of the brake axle until you hear a click.

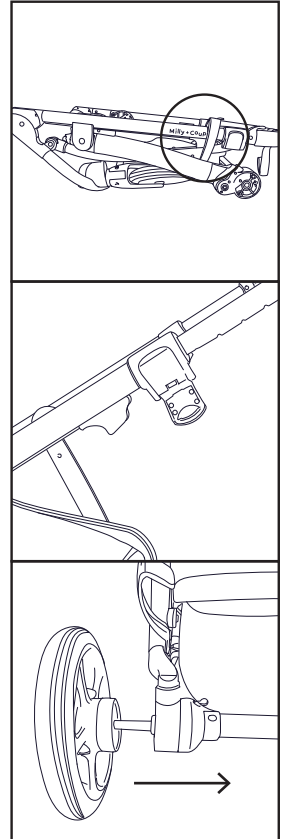

Setting up your seat

- +** The seat can be used in a forward or parent facing position.
Line up the round seat connectors on the seat with the frame connectors and lower the seat onto the frame. Push the leg-rest down and seat back backwards into the normal seated position.
- +** To adjust footrest, simultaneously press both round buttons on the sides of the footrest and adjust down to the desired position. To raise the footrest, simply lift it up into position (no need to push the buttons).
- +** To recline the seat, fully lift the latch on the back of the seat and adjust the seat forward or back as required.
- +** Insert the belly bar into the belly bar slots on the seat frame.
Note: To remove from one side or both, press the button on the side you want to release, and pull the belly bar out.

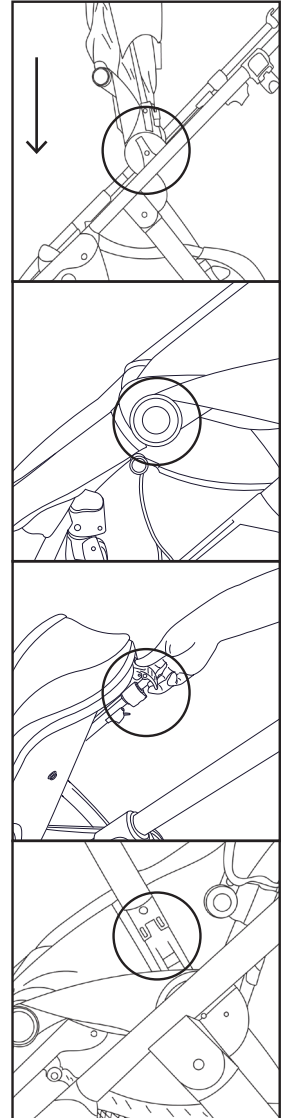

Removing your seat

- + Lift the foot rest and seat base up to meet the seat back, simultaneously lifting the seat recline latch and moving the seat back to the fully upright position.



- + Lift the entire seat unit directly up and out of the frame connectors.

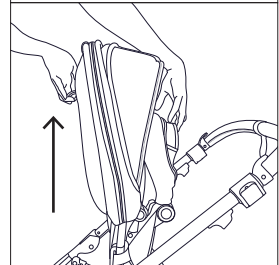

Tips to avoid tears

The strap hanging from your handlebar is a wrist tether strap. Please ensure you slip your hand through here whenever you're using the stroller. It's designed to prevent the stroller rolling away and is a requirement of the safety standards for all prams and strollers.

Using Milo2 with a baby under 6 months

- The seat must be fully reclined to the flattest position. (An upright or semi reclined seat can increase the risk of your child's head tilting/falling forwards resulting in reduced airflow which can lead to serious injury or even death)
- Always use the harness with all 5 straps secured.
- The seat can be used with or without the newborn attachments provided.

Setting up your canopy

- + Ensure the seat is in the parent facing position to give you enough room away from the frame.
(**Tip:** The canopy connectors are deliberately tight. The easiest way to attach the connectors is to first lay the stroller on its side.)
- + Attach the canopy connectors onto the sides of the frame.
(**Tip:** gently pull both sides out to widen the connector gap.)
- + Press the button on the back of the canopy connectors and slide the connectors up the frame until they click into the second position.
- + Secure the press studs on the back of the canopy fabric to the seat.
- + To create extra sun and wind protection for your little one, simply undo the zip and extend the canopy.
- + For additional air flow, simply open the peek-a-boo flap on the canopy.

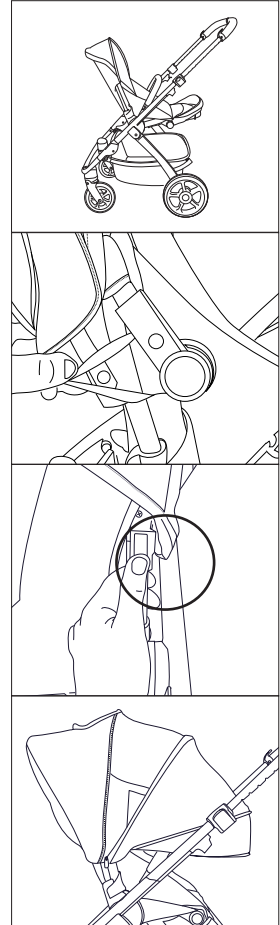

Using the harness

+ To secure the harness

Insert each of the four harness prongs into the central buckle.

Adjust the length of each strap to ensure it fits nice and snug.

To release, press the button in the middle of the buckle.

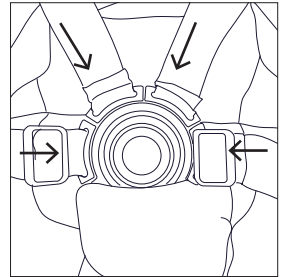

+ To adjust the length of the shoulder straps

To lengthen or shorten the shoulder straps, simply pull the adjuster buckle on the lower half of the shoulder strap, and adjust to the desired position.

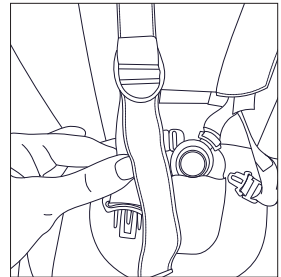

+ To adjust the length of the waist straps

Simply adjust the adjuster buckle

+ To adjust the height of the shoulder straps

Slide the buckle that is secured to the seat back up or down to the desired position for your child.

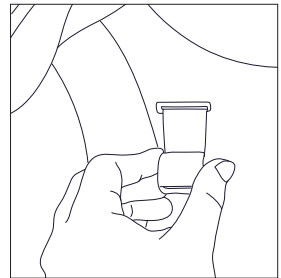

Tips to avoid tears

- Ensure that your child always wears the fitted and adjusted safety harness with all 5 straps secured.

⚠ WARNING

- Never leave the harness buckled when not fitted to the child in the stroller. The harness can form loops which may cause a strangulation hazard.

Setting up your bassinet (if purchased)

+ Using the fabric straps, pull the frame support rods towards the ends of the bassinet until they lock under the 4 plastic clips. **Tip:** if they don't insert easily, simply lift the clip up to help guide the rods into place.

+ Whilst pressing down on the bassinet body, lift and pull the bassinet canopy up until it clicks into place.

+ Insert the bassinet mattress. **Tip:** many parents like to wrap their mattress in a muslin cloth or similar to make cleaning easier.

+ Attach the bassinet cover to the bassinet by zipping it on.

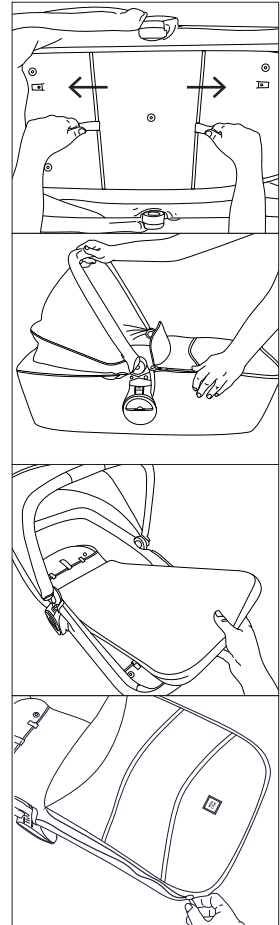

Attaching and removing the bassinet

For safety reasons, we recommend removing your baby prior to attaching or removing your bassinet.

- + Ensure the brake is engaged and attach the bassinet adaptors.
- + Hover the bassinet over the bassinet adaptors and push down until you hear a click. Pull up on the canopy handle to ensure the bassinet has securely locked into place.
- + To remove the bassinet, lift the release lever at the back of the canopy all the way up and use the handle to lift the bassinet up and off the frame.
- + To remove the bassinet adaptors simply press the buttons in the middle of the adaptors and lift up.

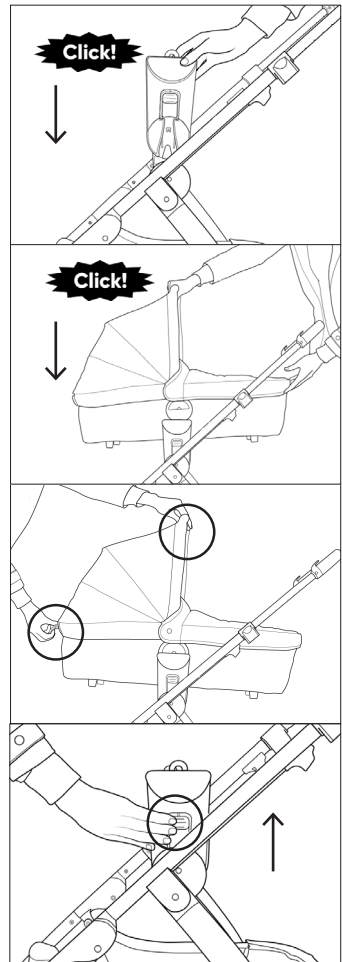

Using your bassinet

+ To adjust the canopy, press the two buttons on the inside sides and lower the canopy to the desired position (**Note:** there are 2 canopy positions).

+ To raise the canopy simply lift it back up; no need to push the buttons.

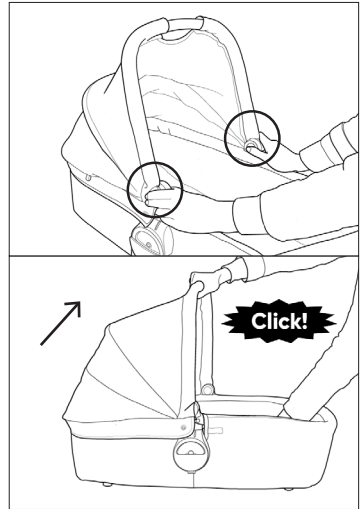

Folding the stroller

Note: The stroller can be folded with the seat on and facing in either direction. Always take care of fingers and body parts around moving parts to avoid injury.

- + Before folding, ensure that the front wheels are unlocked.
- + Adjust the handlebar to the lowest position and ensure that the locks are securely closed.
- + Lift the primary lock up with your forefinger (located on the right frame release lever) before simultaneously pulling both frame release levers up towards you as far as they go.
- + Push downwards on the handlebar and the frame will collapse onto the floor.
- + **Seat forward facing:** Pull the foot rest section to sit flat against the seat.
- + **Seat parent facing:** Lift the seat recline latch up before pulling the seat back to meet the footrest section.
- + Ensure the frame lock has engaged before lifting and carrying by the handlebar. Always bend from your knees when lifting.

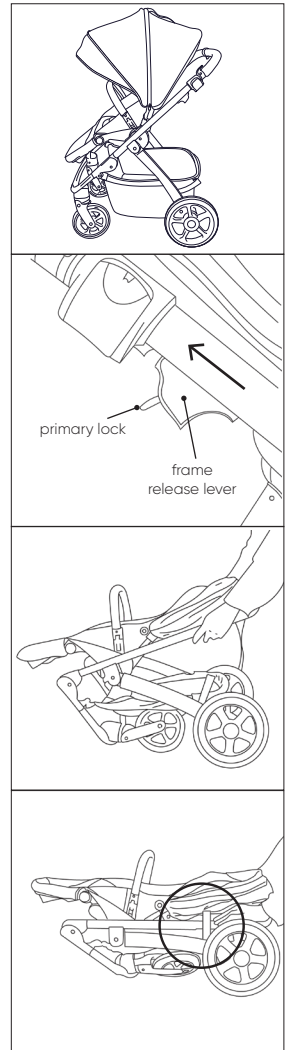

Using your Milo2

Rear brake

- + When stopped, always use the brake by pressing down on the bottom of the red brake paddle with your foot until you feel it click into place.

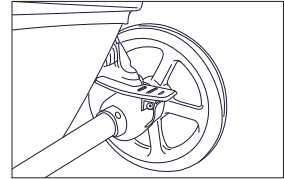

OFF

- + To start travelling again press down on the top of the red paddle with your foot to disengage the brake and off you go!

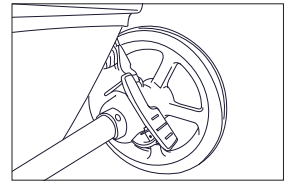

ON

Front wheel locks

- + When travelling fast along straight surfaces or across uneven terrain, the front wheels may spin or cause what's known as "wheel shudder".
- + To lock the front wheels into place, slide to engage the wheel lock buttons (located on the back of the front wheel sockets).

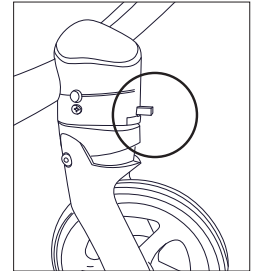

Basket

- + The Milo basket has been tested to hold 10kg. Overloading the basket with more weight may cause the basket to break.

Using Milo2 with a car capsule

Connect a compatible car capsule to your Milo2 Stroller using our **Milo2 Capsule Adaptors**.

NOTE: Milo2 Capsule Adaptors are sold separately to your Milo2 stroller.

The following car capsules are compatible with the Milo2 Capsule Adaptors. Please refer to our website for the most current compatibility list.

- Maxi-Cosi Mico AP (*manufactured from 2013 onwards*)
- Maxi-Cosi Mico Plus
- Maxi Cosi Mico 6
- Maxi-Cosi Mico AP limited edition
- Maxi-Cosi Citi (*adaptors purchased after 01/14/2022 only*)
- Cybex Cloud Q
- Nuna KLIK Plus
- Nuna Pipa KLIK
- Bugaboo Turtle by Nuna
- Joie i-Gemm

To attach your capsule

1. Apply the brake and remove the seat/bassinet from your stroller.
2. Attach the two capsule adaptors to the corresponding connector points on the stroller frame where you would normally attach the seat.

Note: when standing behind the handlebar (as if you were pushing the stroller), the "L" labelled adaptor goes on your left.

3. Attach the car capsule onto the adaptors with the capsule facing the stroller handlebar ensuring it clicks in securely.

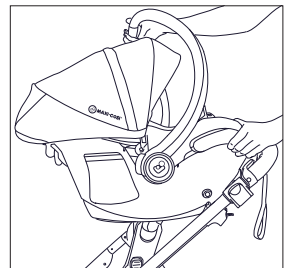
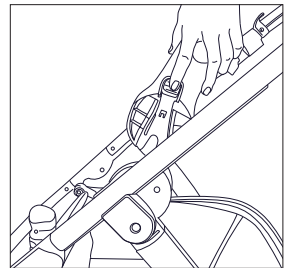

To remove your capsule

1. Press the release buttons **on the capsule.**
2. While pushing the buttons, lift the capsule off the adaptors.
3. Push the release buttons on the adaptors to remove them from the frame.

Tip: Because the capsule adaptors are designed to fit a range of capsules, they may feel tighter or looser with different models. Rest assured they have been rigorously tested and this is normal.

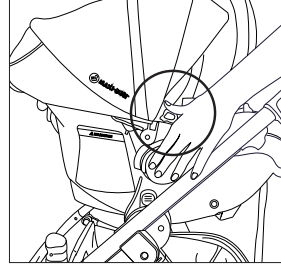

⚠️ WARNING

- FOLLOW THE CAR CAPSULE MANUFACTURER'S INSTRUCTIONS CAREFULLY TO PREVENT INJURY OR EVEN DEATH.
- READ MANUFACTURER'S MAXIMUM USAGE TIME THAT BABIES CAN REMAIN IN YOUR SPECIFIC CAPSULE FOR. THIS IS GENERALLY BETWEEN 90-120 MINUTES.
- DO NOT USE Milo2 CAPSULE ADAPTORS WITH ANY CAPSULE NOT AUTHORISED BY MILLY + COUP.
- NEVER LIFT THE STROLLER OR CAPSULE WHILE THE TWO ARE ATTACHED.
- NEVER PLACE THE CAR CAPSULE IN THE CAR WHILE ADAPTORS ARE ATTACHED.
- DO NOT PLACE OR HANG ANY ACCESSORIES ON THE CAPSULE WHILE ON THE STROLLER. THIS MAY CAUSE YOUR STROLLER TO TIP.

Milo2 Accessories

Use Milo2 your way with our compatible accessories that make travels on-the-go with baby easy. From extra SPF protection to keeping your newborn cosy, our accessories have you covered.

Rain cover - seat

- + Pull the rain cover over the top of the canopy and then over the footrest as shown.

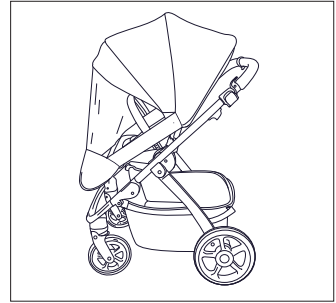

Rain cover - bassinet

- + Pull the rain cover over the canopy of the bassinet, securing it underneath the release latch. Pull the opposite end over the foot end of the bassinet to secure in place.

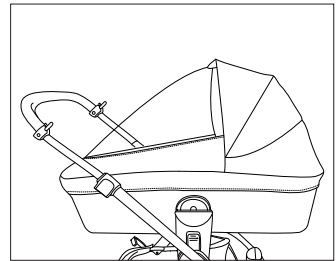

Tips to avoid tears

- Never leave the stroller covered indoors, in very hot weather or near a heat source.
- Always supervise and monitor your child regularly while the stroller is covered.

Newborn UV/Sleep cover - seat

- + With the seat in the parent facing position and fully reclined for newborn use, you can attach the UV cover to provide greater protection for your little one. Simply loop the elastic loops around the plastic hooks on the handlebar.

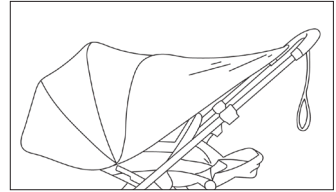

- + Cover the other end over the fully extended canopy and do up the toggles below the canopy connectors on the seat frame.

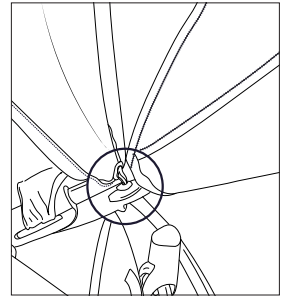

Newborn UV/Sleep cover - bassinet

- + Place the UV cover over the canopy of the bassinet, securing the elastic loops around the plastic hooks on the handlebar.
- + Attach the toggles on the opposite end of the UV cover to the elastic loops located on the back of the canopy.

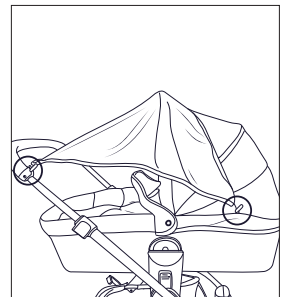

Milo2 Accessories cont.

Infant Support Set

The infant support set is designed to be used with the seat liner to provide a cosy space for your little one.

+ Attach the head cushion by threading the Velcro straps through the seat liner and securing behind.

+ Attach the side cushions by threading the Velcro tab through the waist slots of the seat liner. Secure behind the seat liner.

+ Adjust the harness and attachments as necessary to the height of your child.

+ These attachments can be used for as long as your child finds them comfortable.

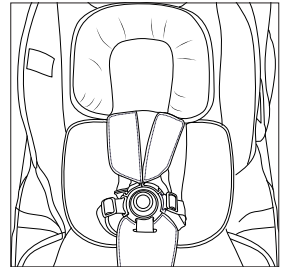
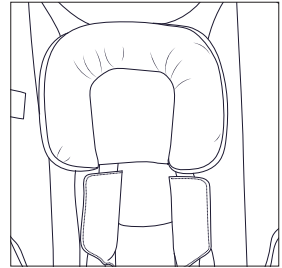

Handlebar Bag

+ Adjust the strap of the handlebar bag to the desired length and slip over the handlebar.

+ Position the bag behind the hooks on either side of the handlebar to keep it in place.

+ Maximum weight limit is 2kg. Be careful carrying liquids – hot liquids may burn you or your child.



Seat liner

- + Attach the seat liner by threading the harness straps from the seat through the corresponding slot.
- + Secure the seat liner to the seat by threading the plastic toggles through the slots in the top of the seat and secure through the elastic loops.

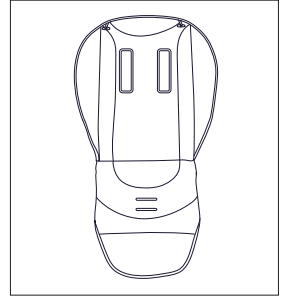

**Get ready to
rock 'n stroll!**

Milo2 maintenance

Please use and treat Milo2 with respect and care. Your stroller will need to be given regular maintenance to remain safe and in good condition. Please be gentle, don't overload it, avoid excessive off-road use and be sure to follow the maintenance instructions below to keep your stroller looking and feeling newer for longer!

Regular maintenance:

- Inspect the locking devices, levers, joints, buttons, brakes, wheels, safety harness and fixtures to ensure they are secure, moving freely and in fully working order.
- If your front wheels or any parts of the stroller have become stiff, difficult to operate or begin to squeak, first ensure that dirt is not the cause and give them a good clean with a damp (not wet) cloth. Then try a light application of a sprayable silicone lubricant, ensuring that it penetrates between the components.
- We recommend WD-40 SPECIALIST Silicone Lubricant or SCA Silicone

Spray available from Supercheap Auto, Bunnings and most hardware stores.

- Follow our cleaning instructions on page 26.

WARNING

**POISONOUS, TOXIC SUBSTANCE.
USE WITH CARE.**

- ENSURE CHILDREN ARE NOT PRESENT WHEN APPLYING SILICONE LUBRICANT OR ALLOWING IT TO DRY.
- ALWAYS SPRAY OUTSIDE OR IN A WELL-VENTILATED AREA.
- ENSURE YOU USE MINIMAL PRODUCT AND WIPE AWAY EXCESS SOLUTION BEFORE USE.

Correct use:

Milo2 has been designed for urban living and weekend adventures which means it's ideal for walking on sealed footpaths, in shopping centres, cafes and down at your local park.

Taking Milo2 off-road or over uneven terrain will clearly place more stress on the frame and wheels and cause the stroller to wear out faster. For this reason, we recommend "weekend adventures" and not regular off-road use.

Correct storage:

Do not leave Milo2 in direct sunlight for prolonged periods of time to avoid colour fade.

Do not leave Milo2 in your car on days of extreme heat or near any heat source or fire.

Do not store Milo2 with heavy items on top of it, this may misalign the frame. Store Milo2 in a dry, well-ventilated, and safe place.

Preventing rust and mould:

After exposure to wet or damp conditions (especially trips to the beach, snow or in the

rain), leave Milo2 fully open in a warm, well ventilated environment to prevent rust and mould.

You may need to dry the stroller with a soft, lint free cloth. Left damp it will encourage mildew, mould or rust to form causing damage.

Try to store your stroller in a dry, well-ventilated room inside your house. Ventilation is key.

Note: mould is an environmental issue caused by excess moisture in the air. If you live in a humid climate, please keep this in mind and take extra care to prevent mould.

Cleaning instructions

To keep your stroller looking and functioning like new, we recommend a deep, comprehensive clean every 6 months.

For a full guide on how to clean your pram, please refer to our website.

DO NOT

- Do not immerse the seat or canopy in water, sponge clean only.
- Do not clean with abrasive materials or using ammonia, bleach, solvents, caustic or spirit-based cleaners.
- Do not press or iron.
- Do not rub or wring fabric.
- Do not tumble dry.
- Do not dry clean.

Tips to avoid tears

- Do not clean your stroller with children around.
- Do not remove, dismantle, or alter any part of the folding mechanisms, frame, brake axle or wheels for cleaning or any other reason.
- Do not use if any part is broken, torn, or missing. Replacement parts are available from our website or by contacting us.

Failing to adhere to these maintenance and cleaning instructions could damage or affect the safety of your stroller and may void your warranty.

Spare parts

The wheels are subject to normal wear and tear and should be replaced if necessary.

Spare parts are available for purchase on the Accessories and Spare Parts page of our website (millyandcoup.com). If the part you require is not listed, please email us for a quote at au.support@millyandcoup.com or nz.support@millyandcoup.com

Warranty information

Milo2 comes with a 3 year defects warranty to cover against faults in materials and workmanship when your stroller is used under normal conditions, according to our user manual and technical specifications.

Our goods come with guarantees that cannot be excluded under the Consumer Law in the country of purchase. You are entitled to a replacement or refund for a major failure and for compensation for any other reasonably foreseeable loss or damage. You are also entitled to have the goods repaired or replaced if the goods fail to be of acceptable quality and the failure does not amount to a major failure.

For full warranty terms and conditions or to make a claim, please visit the Warranty page of our website for details.



Contact Us:

au.support@millyandcoup.com | nz.support@millyandcoup.com

Model: Milo2 **Version:** 1 - August 2022

Information subject to change. Please see website for current version.

millyandcoup.com