



The Original

HUNTSMAN™

SMART KETTLE KAMADO

POWERED BY THE SPIDER GRILLS™ VENOM CONTROLLER

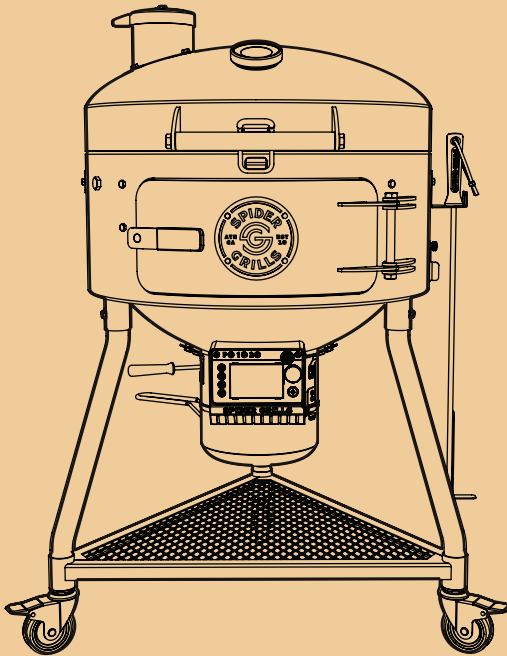

OWNER'S MANUAL

MANUAL CODE: SGHU22-240327



INDEX

Safety Info	-----	2
Parts	-----	7
Hardware	-----	8
Assembly	-----	9
Hinge Adjustment	-----	18
Startup	-----	19
Maintenance	-----	22
Warranty	-----	23
Contact Info	-----	26
Grilling Notes	-----	27



SAFETY INFO

A MAJOR CAUSE OF FIRES IS FAILURE TO MAINTAIN REQUIRED CLEARANCES (AIR SPACES) BETWEEN COMBUSTIBLE MATERIALS.

IT IS OF UTMOST IMPORTANCE THAT THIS PRODUCT BE INSTALLED ONLY IN ACCORDANCE WITH THESE INSTRUCTIONS.

IMPORTANT: RETAIN FOR FUTURE REFERENCE. READ CAREFULLY.

READ ALL INSTRUCTIONS BEFORE INSTALLING AND USING THE APPLIANCE.

IF YOU ARE ASSEMBLING THIS UNIT FOR SOMEONE ELSE, PROVIDE THIS MANUAL FOR THE OWNER TO READ AND SAVE FOR FUTURE REFERENCE.

Please read this entire manual before installation and use. Failure to follow these instructions could result in property damage, bodily injury, or even death. Contact local building or fire officials about restrictions and installation inspection requirements in your area.



SAFETY INFO

Carbon Monoxide Hazard

As with all grills and cooking appliances, any time you burn a material (whether it be wood, gas, or charcoal), organic gases are formed during the cooking process. One gas that can be particularly harmful in concentrated quantities is carbon monoxide. In an outdoor, open-air environment, carbon monoxide should naturally dissipate and not harm you.

WARNING! Follow these guidelines to prevent this colorless, odorless gas from poisoning you, your family, your pets, or others.

- Know the symptoms of carbon monoxide poisoning: headache, dizziness, weakness, nausea, vomiting, sleepiness, and confusion. Carbon monoxide reduces the blood's ability to carry oxygen. Low blood oxygen levels can result in loss of consciousness and death.
- See a doctor if you or others develop cold- or flu-like symptoms. Carbon monoxide poisoning, which can easily be mistaken for a cold or flu, is often detected too late.
- Alcohol consumption and drug use increase the effects of carbon monoxide poisoning.
- Carbon monoxide is especially toxic to mother and child during pregnancy, infants, the elderly, smokers, and people with blood or circulatory system problems, such as anemia or heart disease.
- Only use your Spider Grills® product outside on a non-combustible floor and away from combustible materials.
- Never use gasoline, gasoline-type lantern fuel, kerosene, charcoal lighter fluid, or flammable liquids to start or “freshen up” a fire in this appliance. Keep all flammable materials, liquids and gas well away (at least 10 feet) from this appliance when in use.



SAFETY INFO

Electrical Hazard

- Hazardous voltage is present, which can shock, burn, or cause death. Disconnect the power cord before servicing the grill unless otherwise noted in this Owner's Manual.
- Do not use in a wet location and avoid touching the power adapter and electrical cord if wet.
- Only use with provided power adapter and electrical cord.

For North American Consumers:

- Plug into an appropriate 3-prong outlet.
- An electrical supply with GFCI protection is required to protect against shock hazard. Locate a grounded 3-prong receptacle in reach of the 6' (1.8-m) power cord. When installing the receptacle, follow the National Electrical Code and local codes and ordinances.

For Consumers in the European Union:

- Plug into an appropriate earthed outlet.
- Do not remove earth prong or modify plug in any way. Do not use an adapter or extension cord.

Burn Hazard

- Many parts of the grill will become very hot during operation. Care must be taken to avoid burns, both during operation and afterwards, while the grill is still hot.
- Never leave the grill unattended when young children are present.
- Never move the grill when it is operating.
- Let the grill cool thoroughly before moving or attempting to transport.



SAFETY INFO

Fire Hazard

- When operating your grill, maintain a MINIMUM distance of 18 inches (45.7 cm) from the grill to combustibles.
- When operating your grill under overhead combustibles, a MINIMUM of 40 inches (102 cm) is required.
- Always keep a fire extinguisher nearby while operating a grill.
- Gases that build up inside a grill can ignite when exposed to oxygen, resulting in burns. Use caution when opening the grill.
- Powered fans can create higher temperatures than natural draft. Always monitor your grill and use caution when opening.

Air Contaminant Hazard

- Assemble and operate your grill ONLY per the instructions in the Owner's Manual.
- Your grill is intended for OUTDOOR USE ONLY.

Equipment Failure

- Equipment failure may result in fire or electrical shock. Inspect all probes, wires, and power adapters for visible signs of damage before use.
- Do not open or make unauthorized modifications to this device. This can cause hazardous conditions.

Venom Installation Hazard

- Never use the Venom when not attached to your Huntsman grill. Failure to do so could result in injury or fire.



SAFETY INFO

General Warnings

- Keep the grill clean. See the cleaning instructions in this Owner's Manual.
- Do not use accessories not specified for use with your grill.
- Even if there is ample room in the grill, be cautious of loading excessive amounts of food that can release large quantities of flammable grease (for example, more than a pound of bacon) especially if the grill has not been well-maintained. If your previous cooks have produced large quantities of flammable grease, it is highly recommended that the grease be cleaned from the grill before using it again.
- Never try to extinguish a grease fire using water. If a grease fire occurs, close all vents on the grill to smother the fire.
- Do not grill in high winds, which may cause the grill to tip over or blow sparks into the surrounding area.
- This appliance is not intended for use by persons (including children) with reduced physical, sensory, or mental capabilities, or lack of experience and knowledge, unless they have been given supervision or instruction concerning use of the appliance by a person responsible for their safety.
- Children should be supervised to ensure they do not play with the appliance.

SAVE THESE INSTRUCTIONS



PARTS

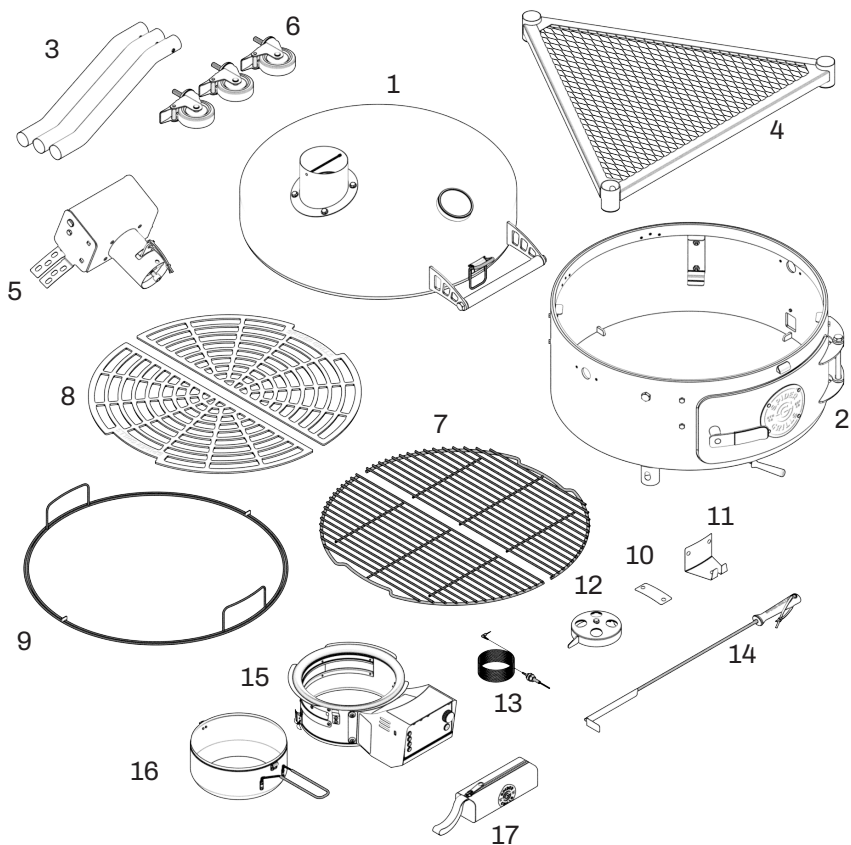

- | | | |
|-----------------------|--------------------------|--|
| 1. Huntsman Lid | 8. Cook Surface (2) | 15. Venom Controller |
| 2. Huntsman Base | 9. Spin Rack | 16. Venom Ash Bucket |
| 3. Legs | 10. Port Cover | 17. Tool Bag |
| 4. Frame | 11. Port Cover/Tool Rest | 18. Hardware Package
(not pictured) |
| 5. Hinge | 12. Chimney Cap | |
| 6. Caster Wheels (3) | 13. Threaded Pit Probe | |
| 7. Charcoal Grate (2) | 14. Charcoal Tool | |



HARDWARE

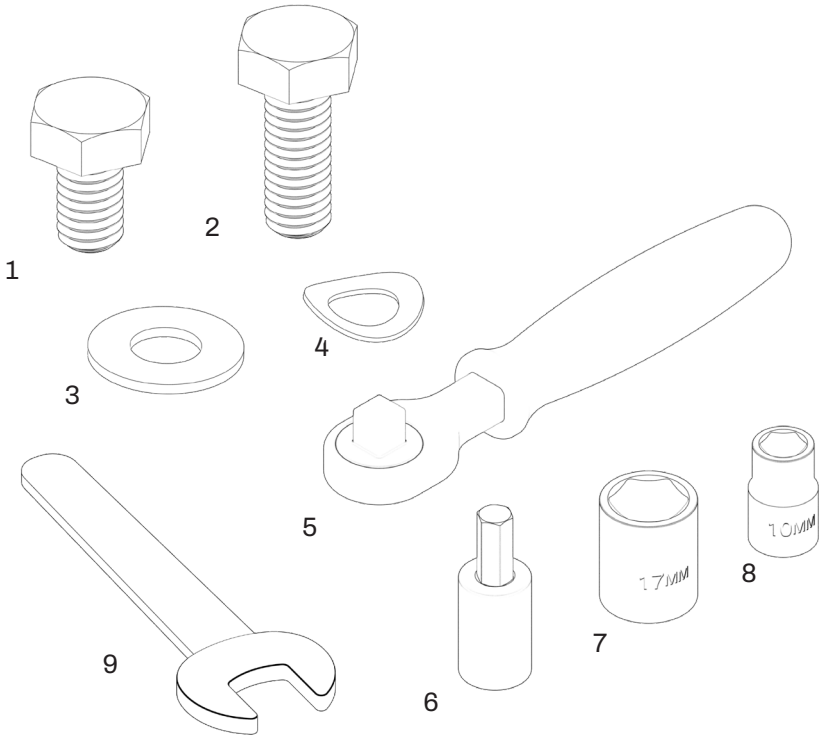

- | | |
|--------------------------|-------------------|
| 1. M6x10 | 6. 8mm Hex Driver |
| 2. M6x16 | 7. 17mm Socket |
| 3. M6 Washer | 8. 10mm Socket |
| 4. M6 Spring Lock Washer | 9. Caster Wrench |
| 5. Mini Socket Wrench | |



ASSEMBLY

WARNING: Read these instructions carefully and follow them closely. Failure to do so could result in damage to your grill and void your warranty.

Pre-Assembly

Once all of the contents are removed from the Huntsman base, carefully flip the base upside down onto a padded surface as pictured below (have a second person assist you while lifting the grill).

Be careful not to stress or bend the attached Lower Vent Handle.

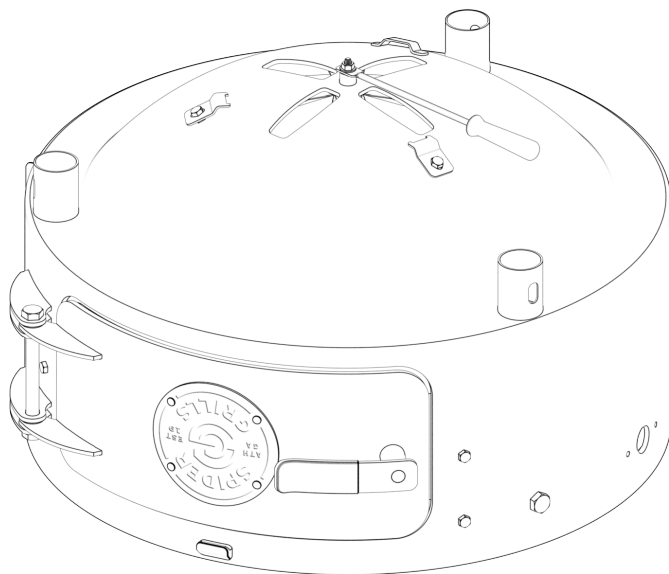



ASSEMBLY

Step 1

Open the draft door on the **Venom** and feed the lower vent handle through.

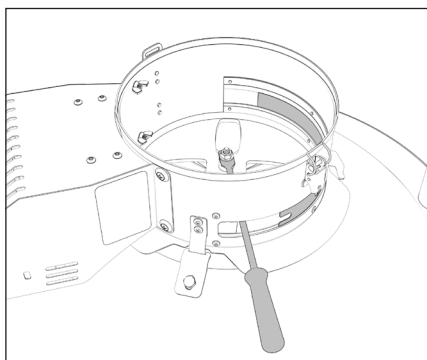

Install the **Venom** by first inserting the fixed tab on the back of the **Venom** into the fixed bracket at the rear of the grill.

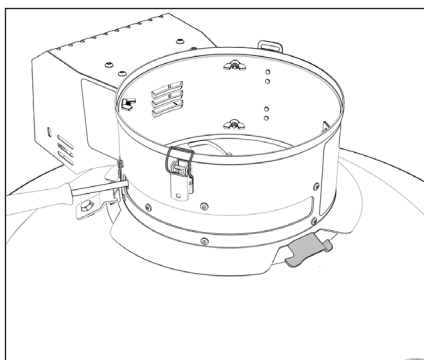

Step 2

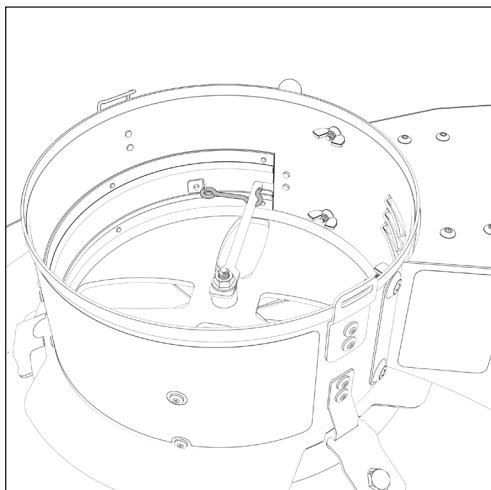

Finish installing the **Venom** by tightening down the other two clips using the provided wrench with 10mm socket and clipping the hook on the inside of the draft door onto the lower vent handle.



ASSEMBLY

Step 3

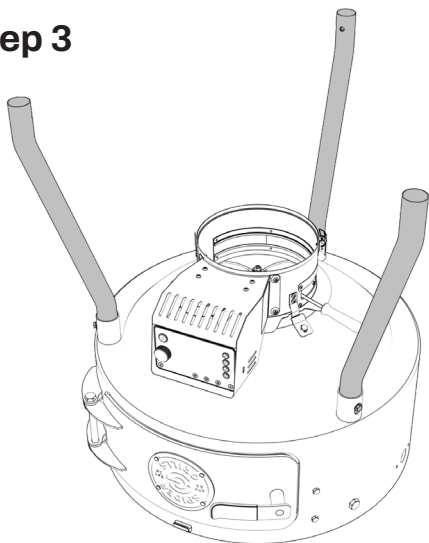

Insert each leg as shown. The legs are identical, but the bends should be facing outwards, and the pre-drilled bolt holes should align. Once the legs are positioned, use an M6x10 hex bolt with a washer to secure each leg, and hand-tighten the bolts.

Note: Do not fully tighten the bolts until after the next step.

Step 4

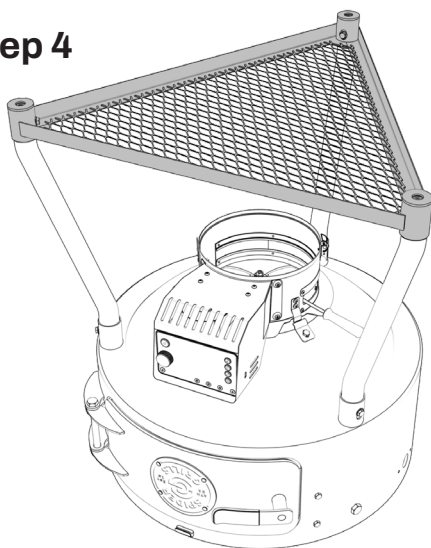

Position the frame onto the legs and align the bolt holes with the corresponding holes on the legs. Once the frame is aligned, use three M6x10 hex bolts with washers to secure the frame.

You may now tighten down all hardware using the provided 10mm socket.



ASSEMBLY

Step 5

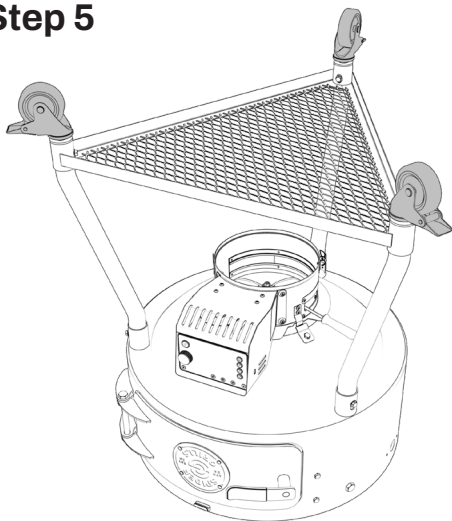

Install the caster wheels onto the bottom of the frame by locking the wheels and screwing them into the legs and tightening with included caster wrench.

CAUTION: Be sure the wheels are in the locked position before proceeding to the next step.

Step 6

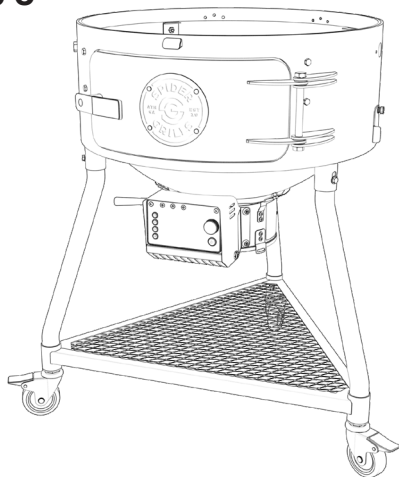

With another person, carefully flip your fully-assembled lower half upright, taking care not to strain the legs, casters, or the body of the grill.



ASSEMBLY

Step 7

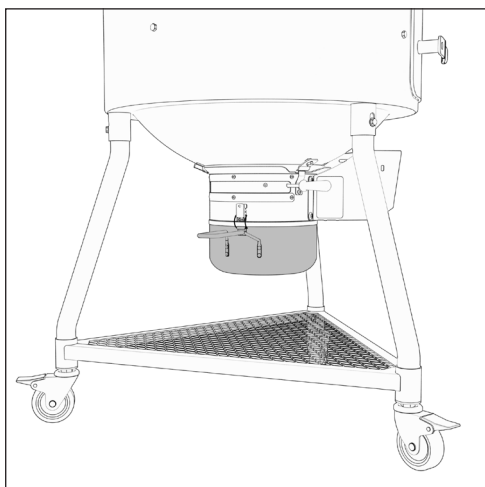

You may now install the ash bucket onto the Venom.

Step 8

Grab the hinge for the next steps.

WARNING: Do not remove the hinge-locking bracket before the grill is completely assembled.

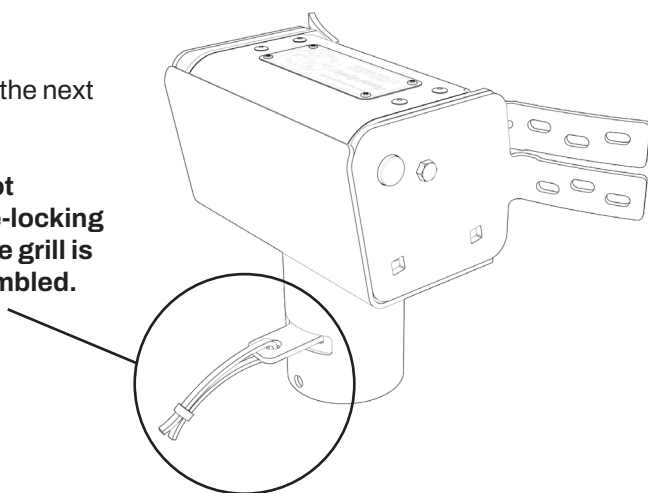



ASSEMBLY

Step 9

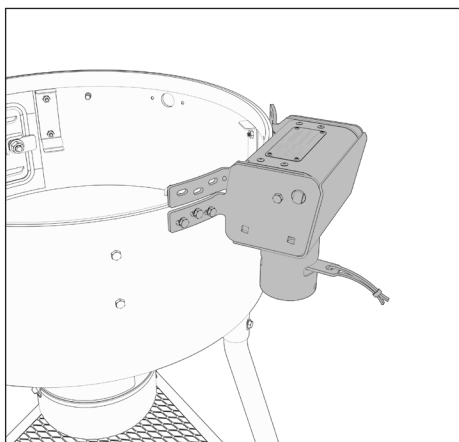

Using the longer M6x16 bolts and spring washers, attach the bottom bracket of the hinge to the Huntsman base, hand tightening the bolts into the pre-drilled holes.

Note: Do not fully tighten the bolts until after the next step.

Step 10

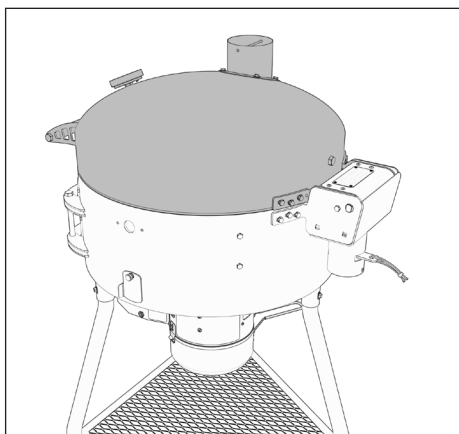

With the help of another person carefully lift the lid into position and align the pre-drilled holes with the top bracket of the hinge. Use the same hardware as the previous step to attach the lid.

Make sure the front latch is aligned properly (pictured right) and fully tighten all screws using the 10mm socket.

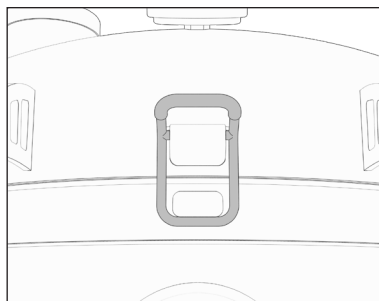



ASSEMBLY

Step 11

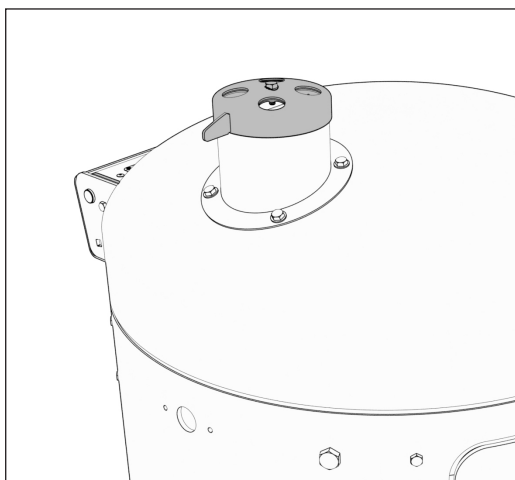

Place the chimney cap onto the chimney.

Make sure the cap is aligned with the crossbar inside the chimney.

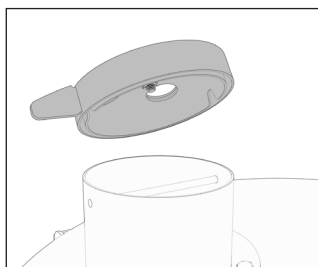

Step 12

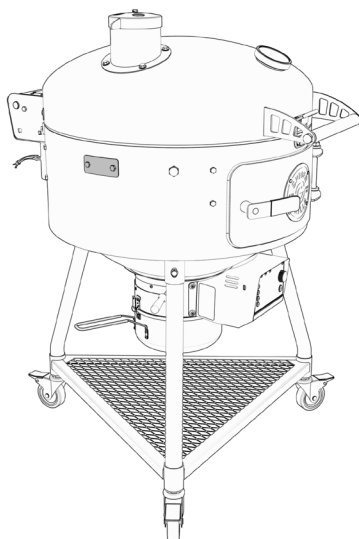

Install the two port cover plates using the shorter M6x10 bolts and the 10mm socket wrench.

You can decide which side of the grill the charcoal tool hangs on, depending on which plate you use.



ASSEMBLY

Step 13

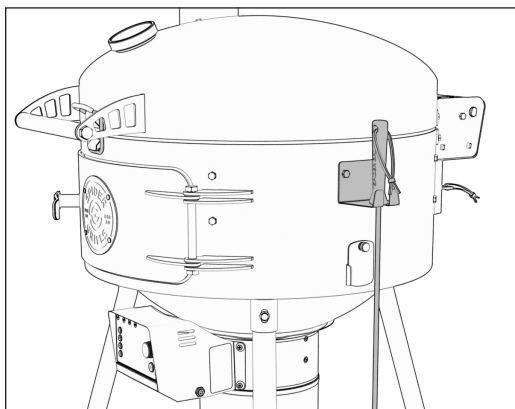

Install the other port cover plate, and hang your charcoal tool.

Step 14

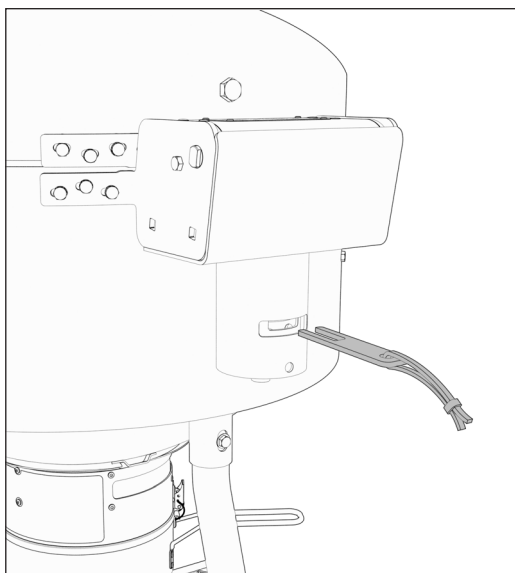

With the lid latched down, you may now remove the hinge-locking bracket to engage the hinge.

Note: Keep your hinge tool after removing. Store the hinge tool in your tool bag in the event you need to lock your lid.



ASSEMBLY

Step 15

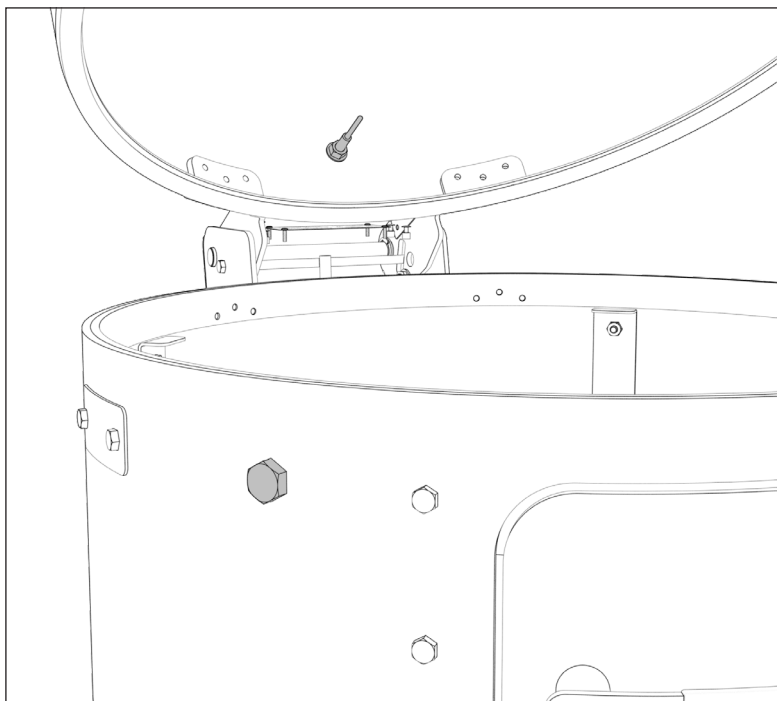

Your Huntsman has two pit probe ports; one on the dome and one on the base (to the left of the front door).

Install your threaded pit probe in either location, by first removing the bolt covering the probe port, and then securing the probe with the included nut.

Note: The threaded pit probe can handle high temps but should not exceed 850°F.

CAUTION: The Venom controller will also include a pit probe. This pit probe can still be used, but only for cooks under 500°F.



HINGE ADJUSTMENT

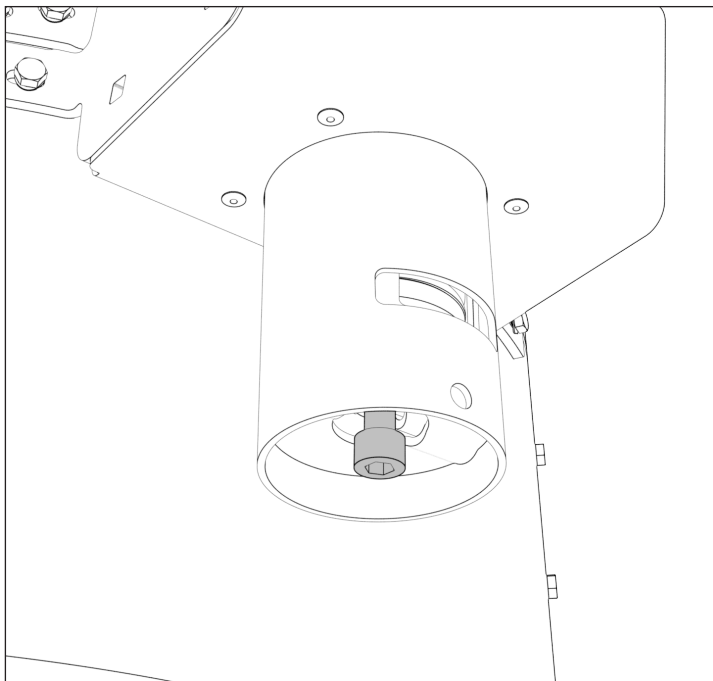

If your lid is not staying up, or is opening too quickly, slowly adjust the screw on the underside of the hinge using the provided 8mm Allen key socket.

Tightening: Allows the lid to raise easier.

Loosening: Allows the lid to lower easier.



STARTUP

Before your first cook, use the provided seasoning kit on the inside surfaces of your grill (highlighted grey and pictured below).

After coating the areas, add lit charcoal, and set the grill to 480°F for 1 hour.

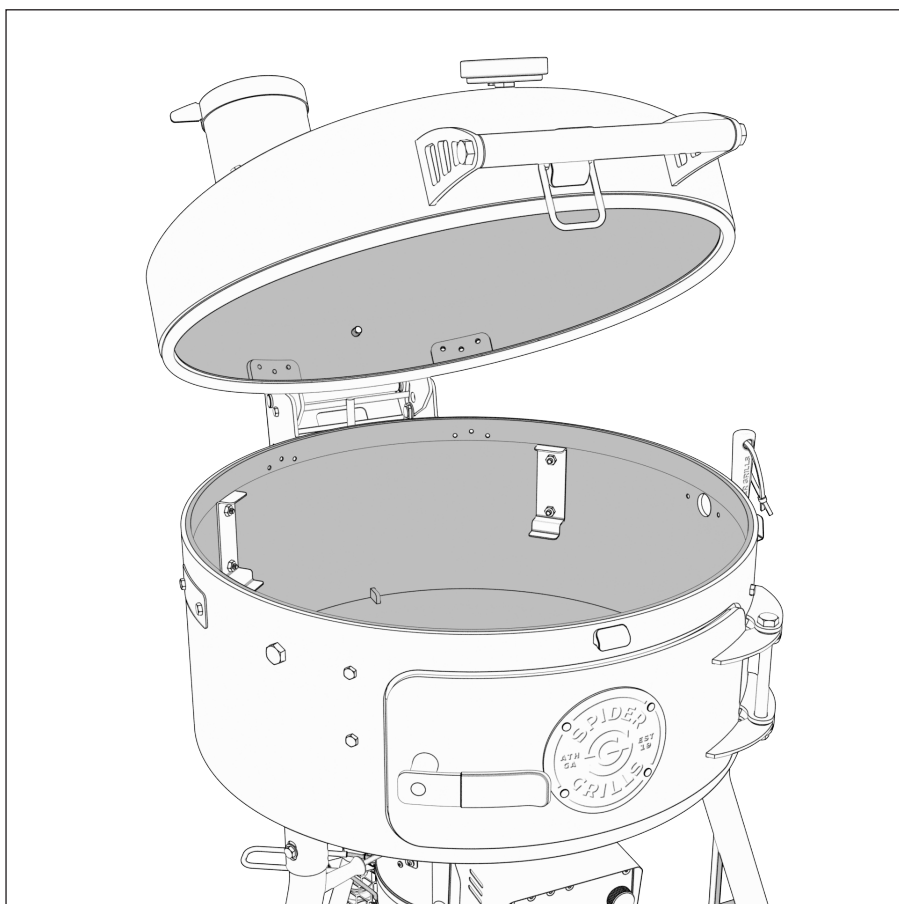



STARTUP

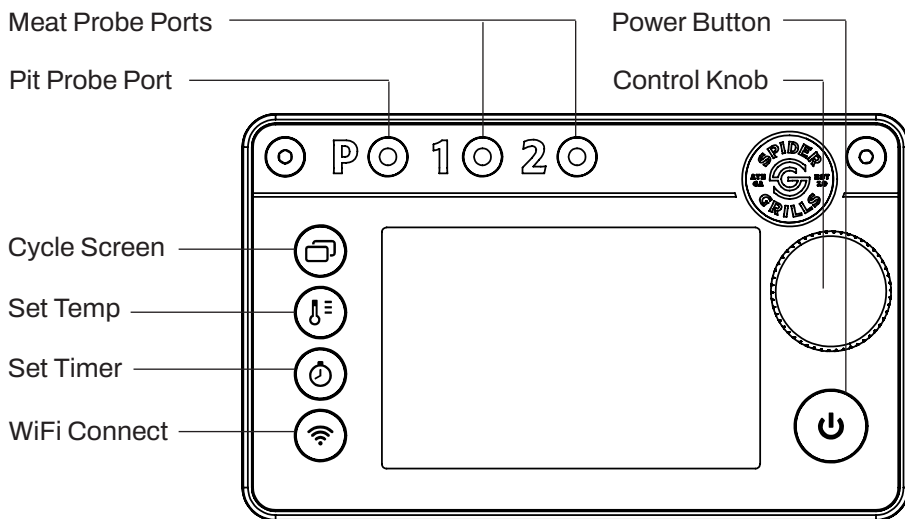

Plugging-In and Powering-On:

Plug the provided temperature probe into the **Pit Probe Port**. *The Venom will not operate without a pit probe plugged in. If you see ER P on start up, confirm your probe is properly plugged in and restart the Venom.* The temperature probe itself should be attached to your cooking surface approximately 2" (50 MM) from any food. Plug in the unit with the provided power cord and press the **Power** button to turn on. The Venom will now begin to monitor the temperature of the Pit Probe, as well as any Meat Probes that are plugged in.

Get Connected:

Download the Spider Grills App and follow the on-screen instructions to connect your Venom and monitor/control your grill from your phone.

Note: The Venom is still 100% functional without the use of the app.



STARTUP

Graph Screen and Meat Probes:

At any time, press the **Screen Cycle** button to switch to graph view where you can see a visual log of your probe temperatures. Additional button presses will switch to any active Meat Probes, the Timer if one has been set, and then back to the main screen.

Setting your Temperature:

Once your grill has a full bed of charcoal fired up, press the **Set Temp** button and select a target temperature. Press the button again to confirm. Make sure to close the draft door on the side of the Venom and adjust the top vent of the grill based on the image displayed on the controller.

To set a target temperature for your meat probes, press the **Screen Cycle** button to navigate to the desired meat probe. Then press the **Set Temp** button and follow the same steps as above. An alarm will sound when your meat probe has reached the desired temp.

Setting a Timer:

Press the **Set Timer** button, select the desired duration, and press the button again to set a count-down timer. An alarm will sound when the count-down has finished.

Long-press the **Set Timer** button and press the button again to begin a count-up timer. If a timer has already been set, a long press of the **Set Timer** button will clear all timer settings.

Degrees Fahrenheit or Celsius:

Long press the **Power** button to access an option to change temperature units.

Manual Pause:

The Venom fan can be paused during a cook for purposes like adding charcoal or tending to food. This pause feature can be found in the app control screen or enabled directly from the control board by holding down the “screen cycle” button until the unit beeps and the words “system paused” are displayed on the control board. Repeat this step to disable the pause and resume normal system function. If the Venom is left paused for several minutes without being restarted, an alarm will sound to alert you to resume your cook



MAINTENANCE

Maintenance should always be performed with unit unplugged from any power source and completely cool.

Maintaining the Inside the Grill

- Once every six months, or if you have noticed rust or oxidation buildup, season your grill using the included seasoning kit.

Cleaning the Outside

- The Venom should be turned off and unplugged when cleaning the outside of the Huntsman.
- Clean outside of unit with a lift free rag or cloth dampened with warm soapy water. Do not use oven cleaner, abrasive cleaners, or abrasive cleaning pads on the outside of the unit.

Storage

- Make sure to unplug the unit when not in use. If the unit is stored outside in rainy or humid conditions it is recommended that you use a grill cover.

Ash Clean-out

- Empty the ash bucket on the Venom after every cook to prevent overflow which may negatively affect performance.
- Ash may fall within the moving track inside of the Venom. Make sure to periodically clean the ash out from inside the unit (and your grill) to keep things running smoothly.
- Ashes should be placed in a metal container with a tight-fitting lid. The closed container of ashes should be placed on a noncombustible floor or on the ground, well away from all combustible materials, pending final disposal. When all cinders have cooled thoroughly, the ashes can be disposed of by burial in soil or otherwise locally dispersed.



WARRANTY

Spider Grills LLC (“Spider Grills” or “we”) warrants to the original purchaser (“purchaser” or “you”) of The Huntsman outdoor grill (“The Huntsman”) that it is free from defects in materials and workmanship under normal use and maintenance for a period of three (3) years from the date of original purchase (“Limited Warranty Period”).

Coverage: This limited warranty covers manufacturing defects and parts failures of The Huntsman under normal use and maintenance during the Limited Warranty Period. Spider Grills’ obligation shall be limited to replacement of covered components or parts that have failed under proper and normal use. Spider Grills will repair or replace parts returned by the customer for a warranty claim, freight prepaid, if they are found to be defective by Spider Grills upon examination. Spider Grills shall not be liable for transportation charges, shipping fees, labor costs, or export duties.

Exclusions:

- The Venom grill and its accessories are covered under a separate warranty. Please see spidergrills.com for more information.
- Spider Grills shall not be liable for any incidental or consequential damages, including but not limited to, loss of materials or goods, loss of use of the product or associated equipment, cost of substitute equipment, or downtime.
- Damages incurred from failure to maintain The Huntsman properly are not covered under this warranty.
- Damages incurred from operating the grill at temperatures over 700°F.

Void Warranty: This warranty is void if any of the following conditions occur:

- The Huntsman is not assembled or operated according to the instructions provided.
- The unit is resold or traded to another owner.
- Accessories or fuels not compatible with The Huntsman have been used.
- The user has abused, modified, or otherwise failed to maintain the unit.

Proof of Purchase: Proof of purchase may be required to process a warranty claim. Please retain purchase records.



WARRANTY

Cosmetic Wear and Tear: Normal cosmetic wear and tear are to be expected over time. This warranty does not cover damage from normal wear and tear from the use of the product (for example, scratches, dents, dings, and chipping) or changes in the appearance of the grill that do not affect its performance. This limited warranty does not cover rust or oxidation for any reason.

Contact Information: If you have questions about assembly, use, or maintenance, or if you find Spider Grills did not deliver on our promise, please reach out to us at Info@spidergrills.com, and we will do our best to assist you within the terms of our warranties and policies as we are able.

Limitation of Liability for Personal Injury:

Notwithstanding any other provisions of this warranty, Spider Grills specifically disclaims any and all liability for any direct, indirect, incidental, consequential, or special damages or injuries, including but not limited to death, bodily harm, or health-related issues arising directly or indirectly from the use, misuse, or inability to use The Huntsman outdoor grill, whether arising out of breach of warranty, breach of contract, tort, negligence, strict liability or any other legal theory.

This limitation applies to damages or injuries incurred from the use of The Huntsman, including, but not limited to:

- Injuries or death resulting from exposure to fire, heat, smoke, or chemicals released during the cooking or cleaning process.
- Health impacts or conditions arising from the consumption of food prepared using The Huntsman.
- Injuries or damages resulting from the failure to follow safety instructions and warnings provided with The Huntsman.



WARRANTY

Safety and Use Disclaimer:

The purchaser acknowledges that grilling and cooking involve inherent risks of fire, burns, and exposure to harmful chemicals or by-products. By purchasing, assembling, and using The Huntsman, you assume all responsibility for the safe operation of the grill and for following the safety instructions and guidelines provided by Spider Grills. You further acknowledge that failure to comply with safety instructions, improper use, or modifications to The Huntsman could result in serious injury or death.

Spider Grills advises all users to exercise caution and to familiarize themselves with the safety features and operational guidelines of The Huntsman before use. Spider Grills is committed to providing high-quality and safe products but cannot control the conditions under which The Huntsman is used or the practices of the users.

This limitation of liability for personal injury is in addition to and not in lieu of any other disclaimers and limitations contained within this warranty. This provision does not affect any statutory rights that cannot be lawfully excluded or limited.

This limited warranty gives you specific legal rights, and you may also have other rights that vary from state to state or country to country.

This warranty is effective as of the original date of purchase and is subject to change without notice.



CONTACT INFO

Further information about the Spider Grills
product line-up may be found at:

www.spidergrills.com

All inquiries may be sent to:

info@spidergrills.com



SPIDER GRILLS® and the associated logo/design are each trademarks of SPIDER GRILLS®, LLC.

© 2024 SPIDER GRILLS, LLC.

Weber is a trademark of Weber-Stephens Products, LLC. Spider Grills® are not affiliated or associated with Weber-Stephens Products, LLC or its products in any way.

