



wall mounted aluminum shelving

**WAL series**

## WAL24

24" wide wall mounted shelving

Satin Anodized Aluminum Uprights with Satin anodized adjustable aluminum shelves. Single unit mounts with six screws to any wall. Add more units to fill an entire wall.

applications

Home: office, storage and display, closet, audio visual

Commercial: schools, hospitals, offices, libraries, retail stores, businesses and more.

materials

Uprights and shelves are made of extruded anodized aluminum and powder coated when color is specified.

dimensions

24"W X 24"H X 6.5"D

24"W X 24"H X 10.5"D

24"W X 24"H X 12.5"D

load capacity

80 lbs per Shelf

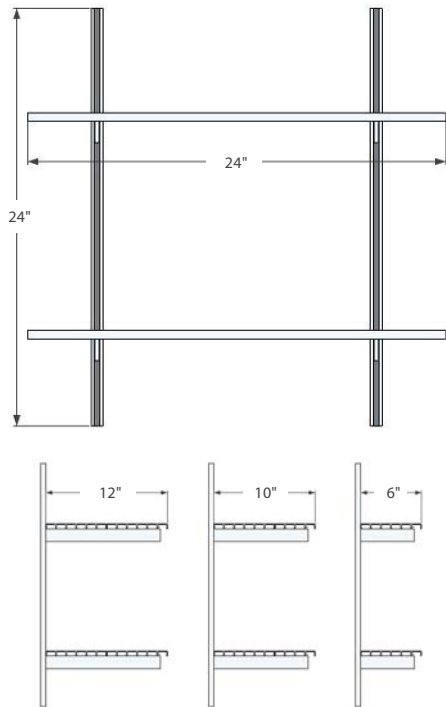

shelf color	shelf depth	sku
satin	6 inches	WAL2406-SS
white	6 inches	WAL2406-WHS
black	6 inches	WAL2406-BLS
orange	6 inches	WAL2406-ORS
rust	6 inches	WAL2406-RUS
satin	10 inches	WAL2410-SS
white	10 inches	WAL2410-WHS
black	10 inches	WAL2410-BLS
orange	10 inches	WAL2410-ORS
rust	10 inches	WAL2410-RUS
satin	12 inches	WAL2412-SS
white	12 inches	WAL2412-WHS
black	12 inches	WAL2412-BLS
orange	12 inches	WAL2412-ORS
rust	12 inches	WAL2412-RUS

aluminum colors



**designed in california. shipped worldwide.**

To place an order, visit [modernshelving.com](http://modernshelving.com) or contact us by phone at 1.877.477.5487

For trade inquires or product questions please email [sales@modernshelving.com](mailto:sales@modernshelving.com).

modern shelving

san clemente, california | 877.477.5487 | [info@modernshelving.com](mailto:info@modernshelving.com)