

**INSTRUCTIONS FOR USE**

"CAUTION--Investigational device. Limited by Federal (or United States) law to investigational use."

**Reusable Applicator**

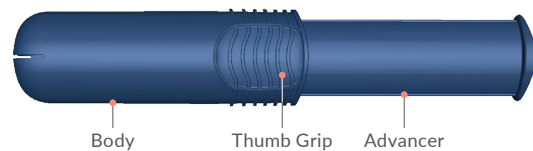

**Reusable Bladder Support**



(Not Drawn to Scale)

The Revive™ bladder support shape is designed to fit naturally in the vaginal tract.

- The Revive bladder support is intended for **temporary management** of urine leakage caused by stress urinary incontinence (SUI) in women, 18 years and older.
- **Does not cure incontinence.**

**12** The Revive bladder support can be worn up to 12 hours per day and reused for up to 31 uses.

**DO NOT USE IF**

- You are pregnant, or have given birth within the last 3 months.
- In the past 3 months you have had a miscarriage (spontaneous or induced), vaginal surgery, perineal surgery, or uterine surgery.
- In the past 6 months you have had an intrauterine device (IUD) placement.
- You have difficulty, pain, or burning sensation when emptying bladder.
- You are currently experiencing an active vaginal or urinary tract infection.
- You are wearing an intravaginal device, such as a tampon or menstrual cup.
- You are currently experiencing any vaginal bleeding, such as menstruation.
- The packaging is damaged.

**WARNING**

If you develop a fever of 102°F and any of the following symptoms, you may have **Toxic Shock Syndrome (TSS)**:

- Achy muscles and joints
- Rash
- Redness in eyes
- Vomiting
- Sore throat
- Diarrhea
- Weakness, fainting or dizziness

While TSS is a rare disease, it is very serious and can potentially cause death if you do not receive treatment right away. Immediately remove the Revive bladder support and call your doctor.

**YOUR KIT CONTAINS**



- Ready to Use Applicator (Bladder Support Pre-loaded)
- 1-Month Strings Supply Pouch
- Travel Case

**NOTE:** Refer to these instructions for proper use and cleaning of the components.

**CONSULT A PHYSICIAN IF**

- You have difficulty inserting or wearing intravaginal devices, such as tampons.
- You experience vaginal dryness.
- You have a history of Toxic Shock Syndrome.

**POTENTIAL SIDE EFFECTS**

- Mild vaginal discomfort or irritation.
- Mild vaginal spotting or bleeding.
- Increased vaginal discharge.
- Inability to urinate or to fully empty the bladder (**remove the Revive bladder support if this occurs**).

**Stop using the Revive bladder support and call your doctor if you experience any of the following symptoms:**

- Difficulty, pain, or burning sensation while urinating, which are signs of a urinary tract infection.
- Vaginal pain, itching, irritation, or foul-smelling discharge which are signs of a vaginal infection.
- Worsening of incontinence symptoms, which may be an indication of pelvic organ prolapse. Revive may not be effective if you have been diagnosed with prolapse.

**INSERTION**

1. Wash your hands thoroughly with soap and warm water.
2. Get into a comfortable seated or standing position (similar to how you would position yourself if inserting a tampon).
3. Hold the applicator with the thumb grip facing up **(A)**.

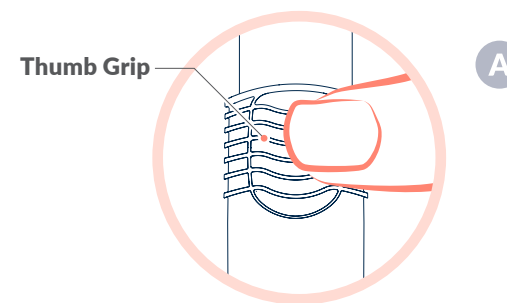

4. Place your index finger on the end of the applicator advancer and your thumb and middle finger at the neck of the applicator, on the thumb grip **(B)**.

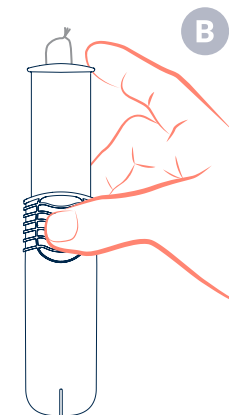

5. Insert the applicator tip into your vagina and gently push the applicator until you feel resistance, similar to a tampon.

**NOTE:** A water-based lubricant may be used if necessary for more comfortable insertion.

6. Push the advancer all the way until the advancer stops (similar to a tampon applicator) **(C)**.

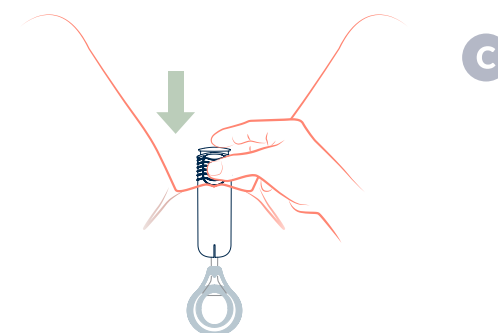

7. Pull out the applicator and check to see that the Revive bladder support is comfortable and the string is hanging outside of your body **(D)**.

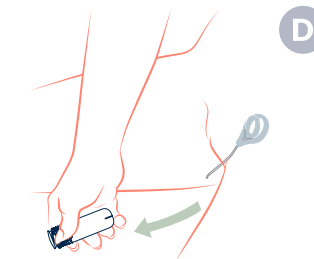

**NOTE:** If the Revive bladder support is uncomfortable after inserting, try to reposition using your finger.

8. Wash applicator and properly store until next use (see cleaning instructions).

**NOTE:** The Revive bladder support is a proper fit if:

- The device feels comfortable during use.
- The device maintains position.
- You can void normally.
- You experience some relief of SUI symptoms.

**Revive may not work for everyone.**

**12** Remove after 12 hours.

**REMOVAL**

1. Wash your hands thoroughly with soap and warm water.
2. Gently pull on the string at a downward angle and remove the Revive bladder support (similar to tampon removal) **(A)**.

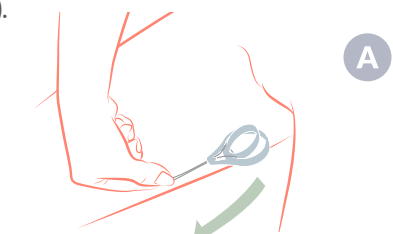

3. Separate string from bladder support. Remove the string and discard in trash.

**NOTE:** Do not reuse strings with the Revive bladder support.

4. Wash bladder support immediately and store in case until next use (see **Cleaning Instructions** on the next page).

## CLEANING INSTRUCTIONS

**NOTE:** You must disassemble prior to washing. Applicator and Revive Bladder Support must be **thoroughly** cleaned before **reuse**.

**1a.** To clean the applicator, remove the advancer from the back of the applicator body by gently pulling out the advancer. If you feel resistance, gently press on the advancer behind the thumb grip **(A)**.

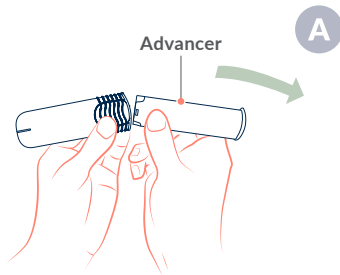

**1b.** To clean the Revive bladder support, first remove the string and discard the string into the trash **(B)**. **Do not reuse string.**

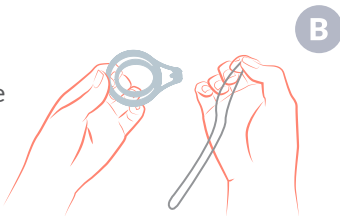

**2.** Hand wash and soak in warm water while using a mild fragrance-free soap for 20 seconds **(C)**. Pay close attention to hard to reach spots, such as inside the applicator.

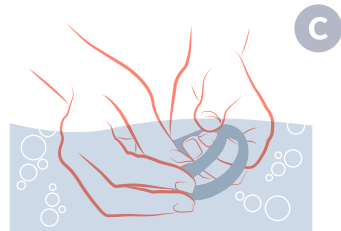

**3.** Rinse under running water **until no soap bubbles are visible** and pat dry with a clean towel or air dry. Inspect the Bladder Support and applicator, including inside the applicator, for any visible soil. If you see any visible soil, repeat the cleaning instructions. Store in provided case until next use **(D)**.

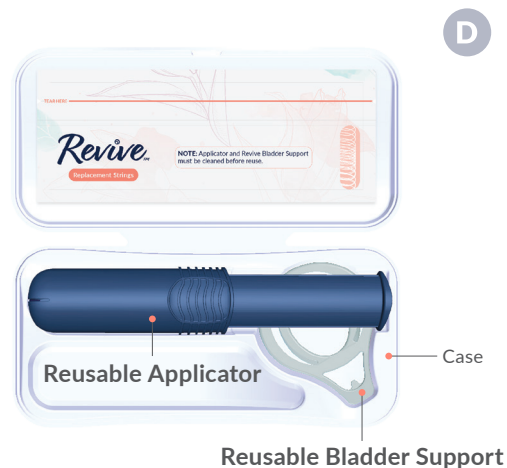

## RELOADING FOR NEXT USE

1. Ensure the applicator and bladder support are clean.
2. Remove a new string from the pack and loop the string around the inner ring of the Revive bladder support and feed string behind the tab **(A)**.

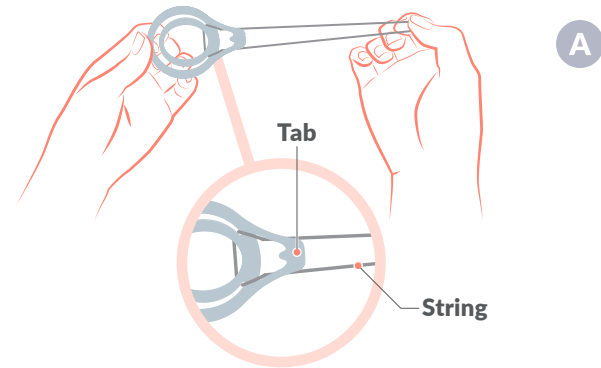

3. Hold the bladder support so that the inner ring is pointing up **(B)**.

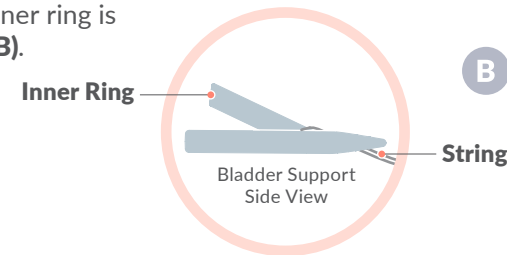

**NOTE:** Inner ring should be pointing up when loading into applicator.

4. Pinch inward to compress the sides together **(C)**.

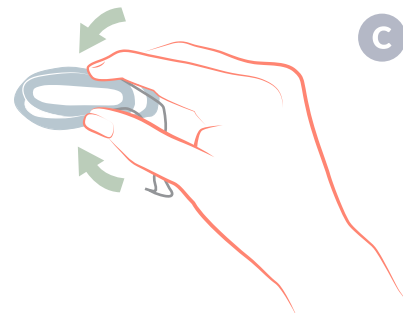

5. Insert into the open end of the body of the applicator **(D)**. The tab should be partially sticking out of the end **(E)**.

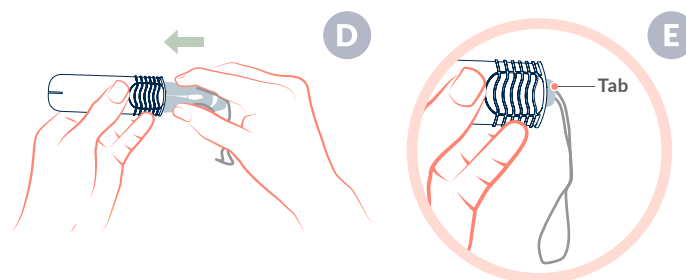

6. Feed the string into the open tube of the advancer **(F)**.

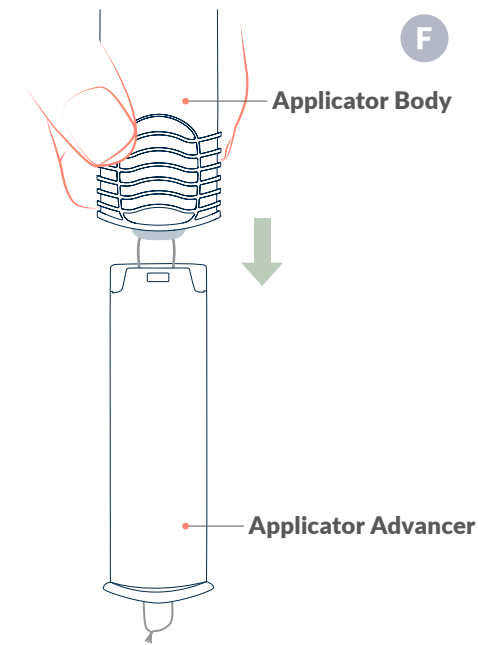

7. Fit the advancer into the back of the applicator body. You should feel a click once the advancer is inside **(G)(H)**.

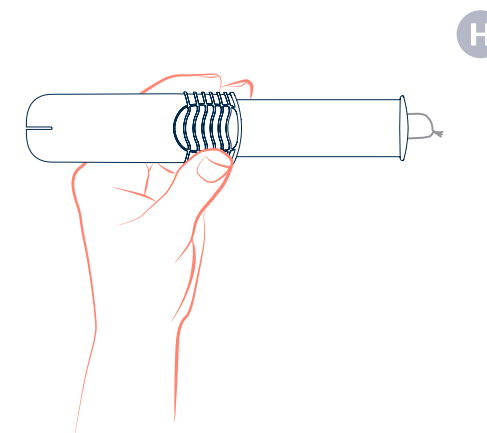
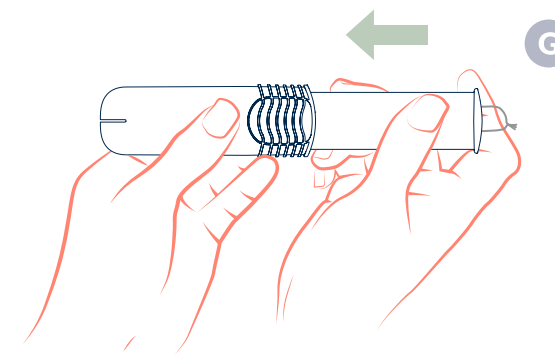

8. Insert the applicator using the instructions for **Insertion** on the previous page.

300 Oxford Drive, Suite 330  
Monroeville, PA 15146  
+1 (412) 200-7996  
[www.revivelbl.com](http://www.revivelbl.com) | [info@revivelbl.com](mailto:info@revivelbl.com)  
© Rinovum Subsidiary 2, LLC

Store at room temperature.  
Keep dry.