

# Jabees®

Love Life Love Music

## Beeing

### Quick Reference Guide

[www.jabees.com](http://www.jabees.com)

Jabees Beeing is the V5.0 Bluetooth True Wireless Stereo Earbuds supporting Auto Power On/Off Technology, Voice Assistant, Voice Prompts, and other features specified in this QRG.

#### OVERVIEW of Beeing

- (1) LED Light
- (2) MF Button (Multifunction Button)
  - Power Saving Mode/Wake Up
  - Play/Pause Music
  - Answer/Reject the Call
  - Transfer the Call
  - Language Selection
  - Next Song (Left Earbud)
  - Previous Song (Right Earbud)
  - Voice Assistant (Left Earbud)
  - Volume Down (Left Earbud)
  - Volume Up (Right Earbud)
- (3) Microphone
- (4) Charging Contact Points
- (5) Speaker

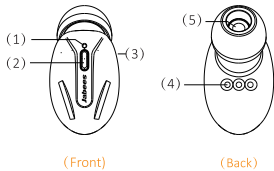

#### INTRODUCTION

Thank you for purchasing Jabees Beeing True Wireless Stereo Earbuds.

This manual will help you understand the operation of your Bluetooth headphones. You should also familiarize yourself with the Bluetooth function of your mobile phone or other devices before using the Beeing Bluetooth headphones.

#### CHARGING THE EARBUDS

1. Place the Beeing earbuds into the charging slots of the Charging Case individually. The earbuds start to get charged automatically.
2. Long press 'ON/ OFF' button on the Charging Case to stop charging the Beeing.
3. The LED light of the Charging Case will be turned on in green, and the red LED light of the earbuds will show when charging.
4. When the earbuds are fully charged, the LED lights of earbuds and Charging case will be turned off around 16 seconds.

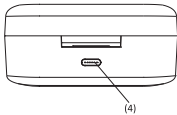
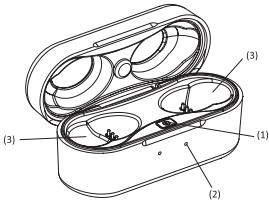

- (1) ON/OFF for charging
- (2) LED Indicators of Battery Status
- (3) Earbuds Charging Slots
- (4) USB Type-C Charging Port

#### WHEN THE BATTERY IS LOW

You will hear the voice prompt 'Battery Low'. At this point please charge the Beeing.

You can also refer to the Battery Meter on iPhone and other iOS devices.

#### Remarks:

The Battery Meter only shows the remaining battery capacity of the Left Channel Earbud. So if the Right Channel earbud is running out of power, it won't be reflected on the Battery Meter.

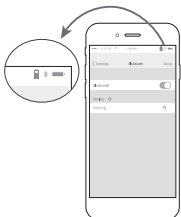

Jabees Beeing is the V5.0 Bluetooth True Wireless Stereo Earbuds supporting Auto Power On/Off Technology, Voice Assistant, Voice Prompts, and other features specified in this QRG.

## OVERVIEW of Beeing

- (1) LED Light
- (2) MF Button (Multifunction Button)
  - Power Saving Mode/Wake Up
  - Play/Pause Music
  - Answer/Reject the Call
  - Transfer the Call
  - Language Selection
  - Next Song (Left Earbud)
  - Previous Song (Right Earbud)
  - Voice Assistant (Left Earbud)
  - Volume Down (Left Earbud)
  - Volume Up (Right Earbud)
- (3) Microphone
- (4) Charging Contact Points
- (5) Speaker

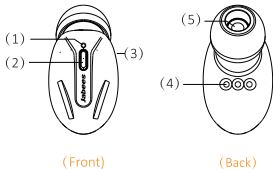

## INTRODUCTION

Thank you for purchasing Jabees Beeing True Wireless Stereo Earbuds.

This manual will help you understand the operation of your Bluetooth headphones. You should also familiarize yourself with the Bluetooth function of your mobile phone or other devices before using the Beeing Bluetooth headphones.

## CHARGING THE EARBUDS

1. Place the Beeing earbuds into the charging slots of the Charging Case individually. The earbuds start to get charged automatically.
2. Long press 'ON/ OFF' button on the Charging Case to stop charging the Beeing.

3. The LED light of the Charging Case will be turned on in green, and the red LED light of the earbuds will show when charging.

4. When the earbuds are fully charged, the LED lights of earbuds and Charging case will be turned off around 16 seconds.

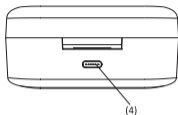
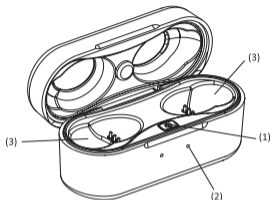

- (1) ON/OFF for charging
- (2) LED Indicators of Battery Status
- (3) Earbuds Charging Slots
- (4) USB Type-C Charging Port

### WHEN THE BATTERY IS LOW

You will hear the voice prompt 'Battery Low'. At this point please charge the Beeing.

You can also refer to the Battery Meter on iPhone and other iOS devices.

### Remarks:

The Battery Meter only shows the remaining battery capacity of the Left Channel Earbud. So if the Right Channel earbud is running out of power, it won't be reflected on the Battery Meter.

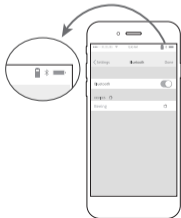

## IMPORTANT

- Charge Beeeing before your first use.
- You should recharge Beeeing if it has not been used for more than 12 months.
- Use only the authorized charger to charge up Beeeing.

## CHARGING THE CHARGING CASE

The Charging Case has a built-in 500mAh battery. It provides approximately 3 additional charges for 2 earbuds. Please charge the charging case when the green LED light flashes.

1. Plug one end of the USB Type-C charging cable into the charging port of the Charging Case, and put the other end into your computer or AC charger with USB port. You can also put the Beeeing Charging Case on the Qi-enabled charger devices to charge directly.
2. When the Charging Case is being charged, the LED indicator will flash in red; when the Charging Case is fully charged, the LED indicator will turn on in solid red.
3. It takes about 2.5 hours to fully charge the Charging Case via a USB Type-C cable, while it takes 3 hours to fully charge the Charging Case via a Qi-enabled charger device.

## MULTIFUNCTION BUTTON

Power Saving/Wake Up; Answer/End/Reject/Redial/Transfer Calls; Volume Up (Right)/Volume Down (Left); Next Song (Left); Previous Song(Right); Play/Pause Music; Voice Assistant (Left); Language Selection; Factory Reset; Pairing.

## TURNING Beeeing ON/OFF

### **To turn Beeeing on:**

Take out the earbuds from the Charging Case. The blue LED light flashes with a voice prompt. The earbuds are now turned on automatically.

### **To turn Beeeing off:**

Put the earbuds into the Charging Case and the earbuds are turned off automatically.

## **NOTE:**

When the 2 earbuds enter in-sync mode, putting the left earbud into the charging case will turn the right earbud into pairing mode if it hasn't been connected to your phone before. If you place the Right Earbud into the Charging Case, the Left Earbud will stay connected to the mobile phone.

## **POWER SAVING SOLUTION**

Beeing supports Auto Power On/Off, so it can only be turned on and off via the Charging Case. If you are not carrying the Charging Case but want to manually turn off the earbuds to save the power, you can follow the below Power Saving Solution:

### **To turn on the Power Saving mode:**

When the earbuds are connected and not in music mode, press and hold the MF button of either earbud for about 5 seconds, the left earbud will flash in blue and red, then the earbuds are disconnected and the power saving mode turns on.

### **To wake up the earbuds:**

Short press the MF button of either earbud to wake them up, and they will automatically connect to your phone.

## **NOTE:**

- 1.If the earbuds fail to connect to your phone in 5 mins, they will turn into power saving mode automatically.
- 2.The earbuds will turn into power saving mode if two earbuds are not connected to each other. For example, the earbuds will loss the connection after factory reset. Under this circumstance, you will have to pair and connect two earbuds manually. Please refer to the 'FACTORY RESET' in this manual.

## **USE Beeing AS A PAIR**

### **STEP 1. In-sync wireless stereo connection with mobile phone.**

- 1) Take out the earbuds from the Charging Case. The LED light flashes in blue, now two earbuds are switched on and connected to each other automatically after 3 seconds.
- 2) The left earbud will flash in red and blue, and turns into pairing mode for a mobile phone.

## NOTE:

If two earbuds fail to connect to each other automatically when taking them out from the Charging Case, you will need to press and hold the MF Buttons of both earbuds for about 2 seconds until you see the LED flashes in red and white, then the earbuds go into pairing mode. If this doesn't help, please refer to the Factory Reset.

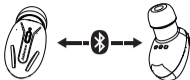

## STEP 2. Connecting with Mobile Phone or Other Bluetooth Devices.

- 1) Turn on the Bluetooth function of your mobile phone or other Bluetooth devices, start searching for the Bluetooth devices on your mobile phone. Select 'Beeing' to complete the connection.
- 2) If your phone asks for passkey or PIN-code, confirm with '0000'(4-zero).

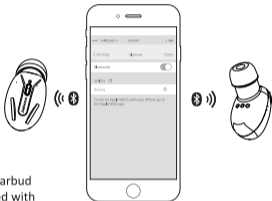

## NOTE:

1. When the Left Earbud is out of power, the Right Earbud will turn into pairing mode if it hasn't been connected with your phone before. If the Right Earbud has been paired and connected with your mobile phone before, it will be connected with your mobile phone automatically.
2. When the Right Earbud is out of power, the Left Earbud will remain connection to the mobile phone so you can use the Left Earbud individually.

## USE Beeing INDIVIDUALLY

You may need to repeat the pair and connect Beeing procedure with your mobile phone or other Bluetooth devices if you want to use each earbud individually.

### 1. How To Pair And Connect With The 1st Mobile Phone.

- 1) Take out one earbud from the Charging Case to turn on Beeing, the LED light flashes in blue, then

double click MF button, the LED lights flash in red and blue, the earbud enters into pairing mode and the LED light flashes in blue after pairing.

2) Turn on the Bluetooth function of your mobile phone or other Bluetooth devices, start searching for the Bluetooth devices on your mobile phone. Select 'Beeing' and follow the instruction. If your phone asks for passkey or PIN-code, confirm with '0000'(4-zero).

3) When Beeing and your mobile phone are paired and connected, you will hear the voice prompt.

**NOTE:** If no pairing is possible for a period of time (approximately 5 minutes), the earbud will go into power saving mode automatically.

## **2. How To Pair And Connect With The 2nd Mobile Phone.**

Beeing support Multipoint Technology for 2 phones when the connection is used for individual earbuds.

1) Pair and connect Beeing with the 1st mobile phone. (Please refer to the ' 1. How To Pair And Connect With Mobile Phone.')

2) Turn off Beeing.

3) Turn off the Bluetooth function of the 1st mobile phone.

4) Turn on Beeing, pair and connect the earbud with the 2nd mobile phone.

5) Turn off Beeing once the connection completed, and turn on again.

6) Turn on the Bluetooth function of the 1st mobile phone, the earbud will be connected with both mobile phones automatically.

**NOTE:** When Beeing enter in-sync mode they do not support Multipoint connection for 2 phones.

## **MAKING CALLS**

Once Beeing is successfully connected to your mobile phone, you can use it to make and receive calls. Please consult your mobile phone's manual for more information.

### **Normal Dialing**

Enter and dial the number on your mobile phone as you normally do. Once the call has been set up, the sound will be transmitted to your earbuds automatically.

### **Redial**

When the earbuds are not in music mode, double click the MF button of the Right Earbud to redial the last number you called.

## ANSWERING/ENDING/REJECTING CALLS

When the earbuds are turned on, and there is an incoming call, you will hear a musical tone.

-Press MF button to answer the call.

-Press MF button to end the call.

-Long press MF button for 2 seconds to reject the call.

## PUT THE CALL ON HOLD

Press and hold the MF-button for 2 seconds to put the current call on hold and accept the call waiting.

Short press the MF Button to hang up current talk and resume to the first call.

## VOICE BROADCAST FUNCTION

Beeing supports voice prompts and reading incoming number.

## TRANSFERRING CALLS

To transfer a call from Beeing back to your phone, double click the MF-button. The blue LED light will flash with a 'beep'. If you want to transfer the call back to Beeing, double click MF-button again. More procedures may be involved for some mobile phones.

## ADJUSTING THE VOLUME

You can increase/decrease the volume by MF button on two earbuds or your mobile phone.

**Increase Volume:** Press and hold the MF button on the Right Channel Earbud

**Decrease Volume:** Press and hold the MF button on the Left Channel Earbud.

**NOTE:** When use Beeing individually, you will need to increase/decrease the volume through your mobile phone.

## PLAYING/PAUSING MUSIC

**Playing Music:** Short press the MF button.

**Pausing Music:** Short press the MF button.

**Next Song:** Double click the MF button on the Left Channel Earbud to play the next song when playing music.

**Previous Song:** Double click the MF button on the Right Channel Earbud to play the previous song when



## VOICE ASSISTANT

Double click the MF button of the Left Channel Earbud to activate Siri or Google Assistant.

- NOTE:** 1.The Voice Assistant cannot be activated when making calls or listening to music.  
2.You may encounter the problem to wake up Google Assistant from lock screen or when the screen is off. If so, please unlock the screen and try again.

## LANGUAGE SELECTING

Beeing supports voice prompt in English and Chinese.

- 1)Turn off the Bluetooth function of the connected mobile phone if any. Take out one earbud from the Charging Case, it will turn on and turn into Power Saving Mode automatically.
- 2)Short press the MF Button to wake it up, and it will turn into pairing mode.
- 3)Double click the MF Button of the earbud, the language will be switched to another one.

You will need to repeat this procedure to change the language of the second earbud.

## CONNECTING WITH A PC OR PDA

You can connect Beeing with a Bluetooth-enabled PC or PDA that supports headphones or hands free profiles. Please refer to the user manual of your Bluetooth-enabled PC or PDA for setup information.

## WITH BUILT-IN WIRELESS CHARGING RECEIVER

Beeing charging case is compatible with almost all Qi-enabled charger devices. Simply place the charging case on the Qi-enabled charger devices to charge, no plugging or unplugging of cables required.

## FACTORY RESET

To restore the earbuds to factory setting, put the earbuds back into the charging case and make sure they are being charged. Double click the MF Buttons on both earbuds, the LED lights flash in red and blue twice, then the factory reset is successful.

### **NOTE:**

After the factory reset, you will have to pair and connect two earbuds manually:

1. Take out the earbuds from Charging Case and they will be turned on automatically.
2. Press and hold the MF button of each earbud for 2 seconds, the LED light flashes in red and blue, they are now in pairing mode.
3. When the connection is successful, the left earbud will flash in red and blue, while the right earbud flashes in blue.

## **GUARANTEE**

Jabees is a registered trademark of FreeTek International Co, Ltd. Other brands and product names are trademarks of their respective owners. Jabees warrants this product against all defects in material and workmanship for a period of twelve (12) months from the date of original purchase of the product. The conditions of this guarantee and the extent of responsibility of Jabees under this guarantee can be read in the Warranty Card.

## **WARNING**

Permanent hearing loss may result from long-term exposure to sound at high volumes. Use as low a volume as possible and avoid prolonged use of the earphone at excessive levels. Please read the safety guidelines below prior to using this earphone.

### **Prior to using this product follow these steps**

1. Before putting on the earphone, turn the volume control to its lowest level.
2. Put the earphone on, and then slowly adjust the volume control to a comfortable level.

### **During the use of this product**

1. Keep the volume at the lowest level as possible.
2. If increased volume is necessary, adjust the volume control slowly.
3. If you experience discomfort or ringing in your ears, immediately discontinue using the earphone. With continued use at high volume, your ears may become accustomed to the sound level, which may result in permanent damage to your hearing without any noticeable discomfort.

## **SAFETY INFORMATION**

1. If you have a cardiac pacemaker or other electronic medical equipment, you should consult your physician before using this product.
2. This product contains small parts that may be hazardous to children. Keep out of the reach of children. The bags themselves or the many small parts they contain may cause choking if ingested.
3. Never attempt to disassemble the product yourself, or push other objects into this product, as this may

cause a short circuit, which could lead to fire or electrical shock.

4. None of the components can be replaced or repaired by users. Only an authorized dealer or service center may open the product.

**REMEMBER:**

Drive safely, avoid distractions and follow local laws.

**NOTE:** This equipment has been tested and found to comply with the limits for a Class B digital device, pursuant to part 15 of the FCC Rules. These limits are designed to provide reasonable protection against harmful interference in a residential installation. This equipment generates uses and can radiate radio frequency energy and, if not installed and used in accordance with the instructions, may cause harmful interference to radio communications. However, there is no guarantee that interference will not occur in a particular installation. If this equipment does cause harmful interference to radio or television reception, which can be determined by turning the equipment off and on, the user is encouraged to try to correct the interference by one or more of the following measures:

- Reorient or relocate the receiving antenna.
- Increase the separation between the equipment and receiver.
- Connect the equipment into an outlet on a circuit different from that to which the receiver is connected.
- Consult the dealer or an experienced radio/TV technician for help

Changes or modifications not expressly approved by the party responsible for compliance could void the user's authority to operate the equipment. This device complies with Part 15 of the FCC Rules. Operation is subject to the following two conditions:

- (1) this device may not cause harmful interference, and
- (2) this device must accept any interference received, including interference that may cause undesired operation.

FCC ID:ALE12018