

Jabees[®]

Love Life Love Music

NBees

Quick Reference Guide

www.jabees.com

NBees is a V4.1 Bluetooth Neckband Headphone supporting multipoint connection and voice prompts in English.

OVERVIEW of NBees

- | | |
|--------------------------------------|---------------------------------|
| (1) Right Earbud | (7) Volume Down / Next Song |
| (2) Left Earbud | (8) LED Light |
| (3) Magnetic Lock Earbuds | (9) Micro USB Charging Contact |
| (4) On/Off Switch | (10) Microphone |
| (5) Volume Up / Previous Song | (11) Detachable Battery Capsule |
| (6) MF Button (Multifunction Button) | |

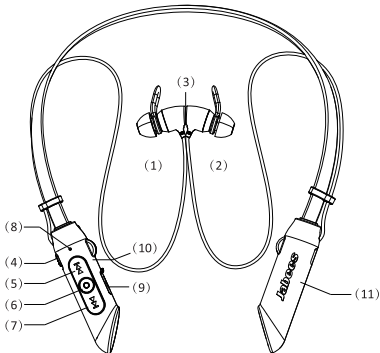

INTRODUCTION

Thank you for purchasing Jabees NBees Bluetooth Neckband Headphone. This manual will help you to accurately operate NBees, but you also should familiarize yourself with the Bluetooth function of your mobile phone or other devices before using the Bluetooth headphones NBees.

CHARGING UP NBees

1. Plug the USB charging cable into the right side USB charging port of NBees.
2. When charging begins, the LED indicator light will be red.
3. When the battery is fully charged, the LED indicator light will be blue.

WHEN THE BATTERY IS LOW

When you hear the voice prompt "Battery Low", please charge your NBees Bluetooth Neckband Headphones. Battery meter on iPhone and other iOS devices.

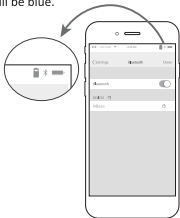

IMPORTANT

- Charge NBees before your first use.
- You should recharge NBees if it has not been used for more than 12 months.
- Use only the included USB charging cord to charge NBees.

MULTIFUNCTION BUTTON

Answer/End/Reject/Transfer calls; Mute; Play/Pause Music; Redial; Factory Reset.

TURNING NBees ON/OFF

To turn NBees on:

Slide down ON/Off Switch. The blue LED light flashes with a voice prompt. The headphones are now turned on.

To turn NBees off:

Slide up ON/Off Switch. The red LED light flashes with a voice prompt. The headphones are now turned off.

PAIRING NBees WITH A MOBILE PHONE

1. After turning on the NBees, the LED light flashes in red and blue with a voice prompt "Pairing" in about 10 seconds. NBees is now in pairing mode. Or manually press MF button for 5 seconds after turning on NBees, until LED light flashes in red and blue with a voice prompt "Pairing".
2. Activate Bluetooth function on your mobile phone.
3. Set your phone to discover NBees.
4. If password or PIN-code is required, confirm with 0000.

PAIRING NBees WITH THE SECOND MOBILE PHONE

NBees supports multipoint technology, which means that it can be paired and connected with two Bluetooth-enabled mobile phones and use at the same time.

1. Activate Multipoint function:

When NBees is turned on and not connected with any devices, short press the MF button and Volume Down button simultaneously.

2. Pair and connect NBees with the first mobile phone.
3. Turn off the Bluetooth function of the first mobile phone and NBees.
4. Turn on NBees and pair with the second mobile phone.
5. Turn off NBees.
6. Turn on the Bluetooth function on first mobile phone.
7. Turn on NBees again and it will automatically connect to the first mobile phone, then manually connect the NBees with second mobile phone (some mobile phones can be automatically connected).

NOTE: If you need to disable the Multipoint function, please short press the MF button and Volume Up button simultaneously.

MAKING CALLS

Once NBees is successfully connected to your mobile phone, you can use it to make and receive calls. The headphones can be used with voice dialing if your mobile phone supports this feature. Please consult your mobile phone's manual for more information.

1. Voice Dialing

Press MF button about 2 seconds and dial by speaking contact's name after hearing the voice prompt "Voice Dial".

2. Normal Dialing

Enter and dial the number on your mobile phone as you normally do. Once the call has been set up, the sound will be transmitted to your headphones automatically.

3. Redial

Double click MF button to redial the last number you called.

ANSWERING/ENDING/REJECTING CALLS

When the headphones are turned on and connected with the mobile phone, and there is an incoming call, you will hear a musical tone.

- Press MF button to answer the call.
- Press MF button to end the call.
- Long press MF button for 2 seconds to reject the call.

MUTE

During phone calls, short press both MF and Volume up button simultaneously with a "beep" to put call on mute. Repeat the step above to un-mute the device.

VOICE BROADCAST FUNCTION

NBees supports voice prompts and reading incoming number.

TRANSFERRING CALLS

To transfer a call to the mobile phone, press the MF button about 2 seconds and the blue LED light flashes with a voice prompt "transfer audio". If you want to transfer the call back to NBees, press MF button for 2 seconds again. More procedures may be involved for some mobile phones.

PUT THE CALL ON HOLD

Double click MF button to put the current call on hold and accept the call waiting.
Double click MF button to put the second call on hold and resume the first call.

ADJUSTING THE VOLUME

You can increase/decrease the volume by adjusting Volume Up/Volume Down button of NBees or your mobile phone.

Press Volume Up button "⏮" to increase the volume;

Press Volume Down button "⏭" to decrease the volume.

PLAYING/PAUSING MUSIC

Press the MF-button to play or pause music.

Long press Volume Down button "⏭" for 2 seconds to play next song;

Long press Volume Up button "⏮" for 2 seconds to play previous song.

MAGNETIC LOCK EARBUDS



CONNECTING WITH A PC OR PDA

You can connect NBees with a Bluetooth-enabled PC or PDA that supports headphones or hands free profiles. Please refer to the user manual of your Bluetooth-enabled PC or PDA for setup information.

FACTORY RESET

When NBees is turned on and not connected with any devices, press the MF button and Volume Up button “▲” simultaneously for 5 seconds, the LED light flashes in red and blue with a voice prompt “power off”, now the factory reset is successful.

GUARANTEE

Jabees is a registered trademark of FreeTek International Co, Ltd. Other brands and product names are trademarks of their respective owners. Jabees warrants this product against all defects in material and workmanship for a period of twelve (12) months from the date of original purchase of the product. The conditions of this guarantee and the extent of responsibility of Jabees under this guarantee can be read in the Warranty Card.

WARNING

Permanent hearing loss may result from long-term exposure to sound at high volumes. Use as low a volume as possible and avoid prolonged use of the earphone at excessive levels. Please read the safety guidelines below prior to using this earphone.

Prior to using this product follow these steps

1. Before putting on the earphone, turn the volume control to its lowest level.
2. Put the earphone on, and then slowly adjust the volume control to a comfortable level.

During the use of this product

1. Keep the volume at the lowest level as possible.
 2. If increased volume is necessary, adjust the volume control slowly.
 3. If you experience discomfort or ringing in your ears, immediately discontinue using the earphone.
- With continued use at high volume, your ears may become accustomed to the sound level, which may result in permanent damage to your hearing without any noticeable discomfort.

SAFETY INFORMATION

1. If you have a cardiac pacemaker or other electronic medical equipment, you should consult your physician before using this product.
2. This product contains small parts that may be hazardous to children. Keep out of the reach of children. The bags themselves or the many small parts they contain may cause choking if ingested.
3. Never attempt to disassemble the product yourself, or push other objects into this product, as this may cause a short circuit, which could lead to fire or electrical shock.
4. None of the components can be replaced or repaired by users. Only an authorized dealer or service center may open the product.
5. If any parts of your product require replacement for any reason, including normal wear and tear or breakage, please contact your dealer.
6. If the product overheats, has been dropped or damaged or has been submerged in a liquid, discontinue use.

REMEMBER

Drive safely, avoid distractions and follow local laws.

NOTE: This equipment has been tested and found to comply with the limits for a Class B digital device, pursuant to part 15 of the FCC Rules. These limits are designed to provide reasonable protection against harmful interference in a residential installation. This equipment generates uses and can radiate radio frequency energy and, if not installed and used in accordance with the instructions, may cause harmful interference to radio communications. However, there is no guarantee that interference will not occur in a particular installation. If this equipment does cause harmful interference to radio or television reception, which can be determined by turning the equipment off and on, the user is encouraged to try to correct the interference by one or more of the following measures:

- Reorient or relocate the receiving antenna.
- Increase the separation between the equipment and receiver.
- Connect the equipment into an outlet on a circuit different from that to which the receiver is connected.
- Consult the dealer or an experienced radio/TV technician for help

Changes or modifications not expressly approved by the party responsible for compliance could void the user's authority to operate the equipment. This device complies with Part 15 of the FCC Rules. Operation is subject to the following two conditions:

- (1) this device may not cause harmful interference, and
- (2) this device must accept any interference received, including interference that may cause undesired operation.