

STEP 1

PREPARE DOOR PER TEMPLATE PROVIDED. INSTALL MORTISE AS SHOWN AND SECURE WITH 2 SCREWS. FEED WIRE THRU AS SHOWN- DO NOT PINCH OR PULL ON WIRE.

WIRE ROUTING

STEP 2

PUT OUTER SPINDLE & INNER SPINDLE IN MORTISE HUB AND HAND TIGHTEN SCREW TO KEEP IN PLACE. PUT POSTS THROUGH OUTER LEVER TRIM HOLES AND PLACE TRIM ON DOOR.

OUTER SPINDLE

INNER SPINDLE

OUTER LEVER TRIM

WIRE ROUTING - MOTOR WIRE FROM MORTISE

INNER PLATE

HOUNTING SCREW

INNER LEVER TRIM

POST

FEED THE MOTOR WIRE THROUGH THE HOLE IN THE INNER PLATE WHILE PUTTING IT AGAINST THE DOOR. PLACE INNER TRIM AGAINST THE PLATE AND ATTACH WITH THE MOUNTING SCREWS. ENSURE WIRE IS NOT PULLED ON OR PINCHED.

STEP 3

PLUG THE WIRE HARNESS INTO THE CONNECTOR ON THE BACK OF THE KEYPAD. GUIDE ESCUTCHEON ONTO THE OUTER LEVER TRIM. FEED THE WIRE HARNESS THROUGH THE DOOR SLOT AS SHOWN. DO NOT PINCH THE WIRE HARNESS. SCREW THE CYLINDER INTO THE LOCK.

ESCUTCHEON

CYLINDER

WIRE HARNESS

CYLINDER RETAINING SCREW (INSIDE)

ONCE CYLINDER IS SCREWED IN TIGHTEN CYLINDER RETAINING SCREW THEN SECURE THE ESCUTCHEON WITH THE 4 SCREWS PROVIDED

STEP 4

ROUTE WIRES AS SHOWN. PLUG THE MOTOR WIRE AND WIRE HARNESS INTO THE APPROPRIATE CONNECTORS ON THE CIRCUIT BOARD (SEE WIRE HARNESS ROUTING DETAIL)

CIRCUIT BOARD

SECURE THE FACE PLATE WITH THE TWO SUPPLIED SCREWS.

STEP 5

ASSEMBLE BATTERIES (USE ALKALINE ONLY) INTO THE BATTERY HOLDER THEN PUT INTO THE COVER. ATTACH BATTERY CONNECTOR TO THE CIRCUIT BOARD WIRE HARNESS ROUTING DETAIL. SLIDE BOTTOM TAB OF BATTERY COVER IN TAB SLOT ON THE INNER PLATE AND ATTACH WITH THE 2 SCREWS SUPPLIED.

BATTERY HOLDER

BATTERY COVER

STEP 6

GUIDE INNER COVER ONTO THE INNER LEVER TRIM AND SECURE WITH THE 2 SCREWS SUPPLIED. ENSURE WIRES ARE NOT PINCHED BY THE COVER.

IMPORTANT: CHECK LOCK FOR CORRECT OPERATION BEFORE CLOSING THE DOOR

WIRE HARNESS ROUTING DETAIL

WIRE HARNESS FROM FRONT KEYPAD

BATTERY HARNESS

MOTOR WIRE HARNESS

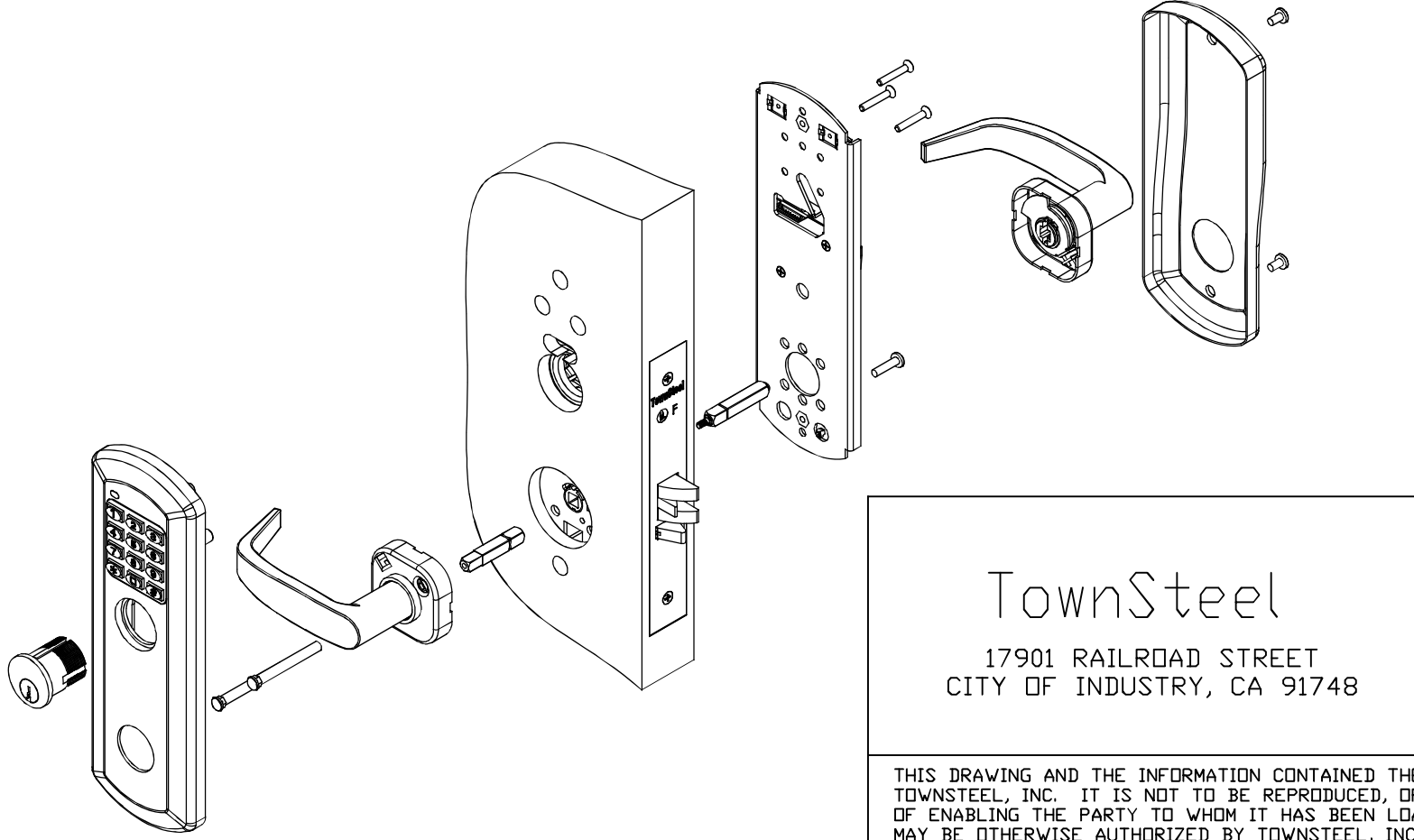

<p>TownSteel</p> <p>17901 RAILROAD STREET CITY OF INDUSTRY, CA 91748</p>	<p>DRAFT UNLESS OTHERWISE SPECIFIED: 1° MAX</p>	<p>TOLERANCES UNLESS OTHERWISE SPECIFIED:</p> <p>X.X (METRIC) = ±0.4</p> <p>X.XX (METRIC) = ±0.15</p> <p>FRACTIONS = ±.8</p> <p>ANGLES = ±1/2°</p> <p>© .12</p> <p>MACHINED SURFACES 125/</p> <p>THIRD ANGLE</p>	<p>MATERIAL: NOTED</p> <p>HEAT TREAT:</p> <p>FINISH:</p> <p>TITLE: XME INSTALLATION ASSY INSTRUCTIONS</p> <p>PART#: XME RIGID SERIES</p>
	<p>DATE: 6/17/14</p>	<p>DRAWN BY: SC</p>	<p>OTHER INFORMATION:</p>
	<p>DATE: 6/17/14</p>	<p>DATE: 6/17/14</p>	<p>DATE: 6/17/14</p>

THIS DRAWING AND THE INFORMATION CONTAINED THEREON OR DERIVED THEREFROM ARE THE CONFIDENTIAL PROPERTY OF TOWNSTEEL, INC. IT IS NOT TO BE REPRODUCED, OR DISCLOSED TO OTHERS, AND MAY BE USED ONLY FOR THE PURPOSE OF ENABLING THE PARTY TO WHOM IT HAS BEEN LOANED TO QUOTE ON OR FILL AN ORDER FOR TOWNSTEEL, INC., OR AS MAY BE OTHERWISE AUTHORIZED BY TOWNSTEEL, INC. IN WRITING.