

SK-004 SERIES

Parts & Accessories Sample & Service Kit

GENERAL FEATURES

The SK-004 contains a sampling of our most popular parts and accessories. The kit comes in its own plastic, 2 level case with parts marked and separated by dividers. The top section provides additional room for extra locks and accessories.



Two level carrying case featuring our most popular parts and accessories.



Top level - empty space for additional locks, parts and accessories

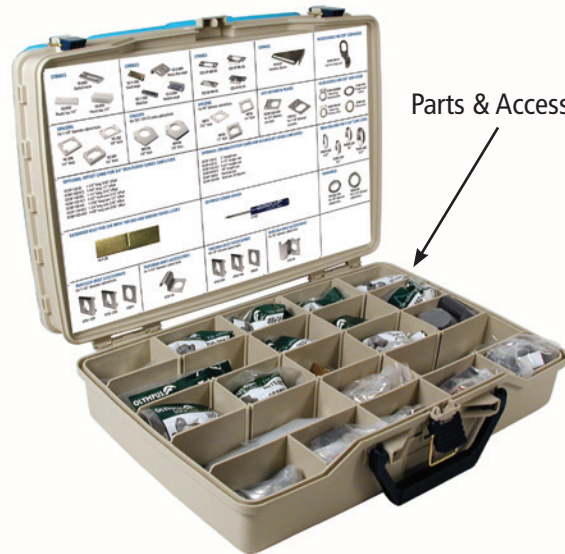

Parts & Accessories



WARNING: This product can expose you to chemicals including chromium, which is known to the State of California to cause cancer and birth defects or other reproductive harm. For more information go to www.P65Warnings.ca.gov.



OLYMPUS[®]
LOCK
INC

SK-004 Parts & Accessories Sample & Service Kit

CONTENTS - TOP LAYER

OTHER AVAILABLE PARTS & ACCESSORIES NOT INCLUDED IN THIS KIT

OPTIONAL CAMS FOR 1-1/8" DIAMETER CAM LOCKS

720-3-3	1-3/4" offset cam, inverted (0.422 offset)
720-3-4	3" straight cam, vertical
720-3-5	1-7/8" shallow offset cam, inverted (0.115 offset)

SWITCH ACCESSORY PACK

SW-1	Parts to convert 1-1/8" diameter cam locks into switch locks. (Note: does not include electronic switches)
------	---

PLASTIC THUMBURNS

725-PA	Works with SFIC and Corbin/Russwin IC
7788-PA-D	Works with Schlage full-size IC
931-PA	Works with Medeco/Yale IC

OPTIONAL CAMS FOR USE WITH DCP/DCP500

DCP-LC	1-1/4" straight cam
DCP-LC-112	1-1/2" straight cam
DCP-LC-134	1-3/4" straight cam
DCP-LC-225	2-1/4" straight cam
DCP-LC-250	2-1/2" straight cam
DCP-SC	7/8" straight cam
DCP-LBC	1-1/4 X 1/4 offset cam
DCP-LBC-138	1-3/8 X 3/8 offset cam
DCP-LBC-178	1-7/8 X 1/2 offset cam
DCP-112-14	1-1/2 X 1/4 offset cam
DCP-114-18	1-1/4 X 1/8 offset cam
DCP-114-38	1-1/4 X 3/8 offset cam
DCP-118-18	1-1/8 X 1/8 offset cam
DCP-1-14	1 X 1/4 offset cam
DCP-2-18	2 X 1/8 offset cam

BUMPER PLATES FOR USE WITH DCP/DCP500

DCP-SP1-US32	DCP strike plate 3 x 4 polished SS
DCP-SP1-26D	DCP strike plate 3 x 4 26D

T37 ACCESSORIES

T37-RC	Spring mounting clip
T37-NKIT	Number plate kit
T37-2	Long bolt (can be cut to length)
T37-3	Short bolt for 25/32 backset

N078/R078 OPTIONAL BOLTS

078-LB-DR	Longer bolt for doors (N078 only)
078-LB1-DW	Outbent bolt for drawers

PLASTIC SPACERS

WP24	1/8" thick for use with 996/997/998/999
10-351	1/8" thick for use with L78

729R / 829R / 929R OPTIONAL STRAPS

729RS-2	Strap for 3/8" material thickness
729RS-3	Strap for up to 5/8" material thickness

STRIKES

L78ST-1	Lipped strike for 1-1/8" barrel length L78, L72 or L92 latch locks
L78ST-2	Lipped strike for 1-3/8" barrel length L78, L72 or L92 latch locks
999-STRIKE	Lipped strike for use with 996/997/998/999 latch locks
850-210	Lipped strike for use with 850 or 950 1-1/8" barrel length locks
850-211	Lipped strike for use with 850 or 950 1-3/8" barrel length locks
10-056	Notched metal bar strike
10-057	White plastic bar strike, .65" thick
10-058	White plastic bar strike, 3/8" thick
075	Metal slotted strike

TRIM COLLARS FOR DCN/DCR/B7 3/4" CAM LOCKS

TRB7-18	Spacer collar, 1/8"
TRB7-14	Spacer collar, 1/4"
TRB7-12	Spacer collar, 1/2"

THROUGH-BOLT PLATES

ETS4	For use with 777 series locks
ETS5	For use with 888 series locks

700/800 PARTS & ACCESSORIES

78-KABA-CONV	For use with KABA cylinders in 700/800 less cylinder products
10-360	Universal driver (fits in back of cylinder)
10-361	Tailpiece/driver bar for 1-1/8" barrel length locks
10-362	Tailpiece/driver bar for 1-3/8" barrel length locks
10-363	Medeco tailpiece/driver bar for 1-3/8" barrel length locks
10-364	ASSA tailpiece/driver bar for 1-3/8" barrel length locks

TOOLS

CL-HIT-25	Cabinet lock drill guide
CL-MP-118	Double-D metal punch for 1-1/8" diameter cam locks
FL1	Small pin follower tool

PIN KITS

N1	For N series (National Keyway) locks
R1	For R series (CCL keyway) locks



CL-HIT-25



CL-MP-118



N1 or R1 PIN KIT

CONTENTS - BOTTOM LAYER

ANTI-ROTATION PLATES

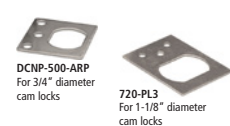

DCNP-500-ARP
For 3/4" diameter
cam locks

720-PL3
For 1-1/8" diameter
cam locks

STRIKES

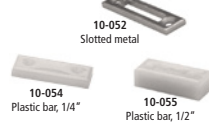

10-052
Slotted metal

10-054
Plastic bar, 1/4"

10-055
Plastic bar, 1/2"

STRIKES



12-1-26D
Small angle

12-2-26D
Heavy duty angle

56-1-26D
Metal bar

12-3-26D
Medium angle

STRIKES



725-SP-MD-SS

725-SP-ML-SS

725-SP-RD-SS

725-SP-RL-SS

TRIM RINGS



TR1256-26D
For 1-1/8" diameter
cabinet locks

TR78-26D
For 1-1/8" diameter
cabinet locks

SPACERS



10-348
1/4" thick

10-349
1/2" thick

10-350
1/8" thick

SPACERS



WP726
1/4" thick

WP725
1/8" thick

SPACERS



WP21
3/32" thick

WP22
1/4" thick

WP23
1/2" thick

STRIKES



12-4-ZP
Frameless drawer

OPTIONAL OFFSET CAMS FOR 3/4" DCN/DCR/B7 SERIES CAM LOCKS

DCNP-100-BC	1-1/4" long, 5/16" offset
DCNP-100-BCS	1-1/4" long, 1/2" offset
DCNP-100-LBC	1-1/2" long, 5/16" offset
DCNP-100-HC1	1-1/2" hook cam, 5/16" offset
DCNP-100-HD	1-7/16" long cam, 1/2" offset
DCNP-100-HD2	1-3/4" long cam, 5/16" offset
DCNP-100-HD3	1-1/8" long cam, 5/16" offset

OPTIONAL STRAIGHT/OTHER CAMS FOR DCN/DCR/B7 SERIES CAM LOCKS

DCNP-100-LC	3" straight cam
DCNP-100-SC	1-1/4" straight cam
DCNP-100-SC2	1-3/4" straight cam
DCNP-HD-875	7/8" straight cam
DCNP-100-B3	Flat hook cam
DCNP-100-WB	Short cam, 90 deg arm

TRIM COLLARS FOR 1-1/8" CAM LOCKS



TR204-32D
5/32"

TR202-32D
1/4"

TR203-32D
3/8"

EXTENDED BOLT FOR USE WITH 100/200 AND 500/600 SERIES LOCKS



15-1-35

OLYMPUS SCREW DRIVER



LIT-5D

ACCESSORIES FOR 3/4" CAM LOCKS



DCNP-200-KDR
Drawer key-
retaining shifter

DCNP-SPW
Pronged wood
washer

DCNP-200-KR
Drawer key-
retaining shifter

DCNP-GW
Glass washer

THROUGH-BOLT ACCESSORIES



ETS1-125

ETS1-250

ETS1

THROUGH-BOLT ACCESSORIES



ETS1-PL

THROUGH-BOLT ACCESSORIES



ETS2-250

ETS2-125

ETS2

THROUGH-BOLT ACCESSORIES



ETS2-PL

ACCESSORIES FOR 3/4" CAM LOCKS



DCNP-300-FP
Cam lock finger pull