

of outside mounting plate as the illustrating bellow.

- c. Rotate outside mounting plate to required door thickness by using a catch tool.
- d. Reassemble exterior assembly.

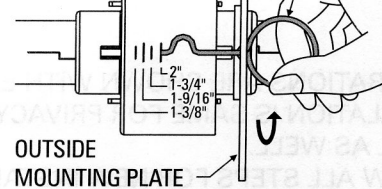
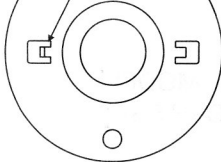

8. REASSEMBLE EXTERIOR ASSEMBLY AND INSTALL

Install the inside rose liner, tab Aligning to the lever notch.



The tab of the rosette assembly is positioned on the opposite side of the lever catch, and align to the notch of the lever hole.

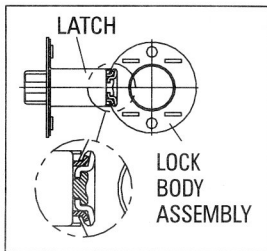

Repeat No. 6 to install the removable Thru-Bolt. Install outside lever assembly on the door. Make sure tail of latch engaging with retractor correctly as illustration left.

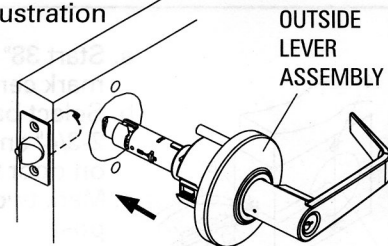

9. INSTALL INSIDE MOUNTING PLATE AND ROSE LINER

a. Place mounting plate on door face and turn up the lever slightly and tighten screws securely.

INSIDE MOUNTING PLATE



MOUNTING SCREW

10. INSTALL INSIDE ROSE AND LEVER

a. Press rose onto rose liner. Be sure to fit rose in recess of rose liner.

INSIDE ROSE LINER

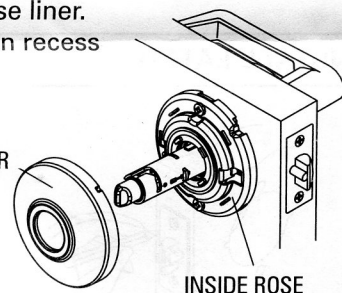

INSIDE ROSE

b. Place rose liner on mounting plate and tighten with screw securely.

INSIDE MOUNTING PLATE

INSIDE ROSE LINER

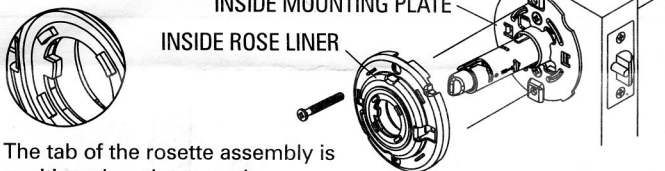

MOUNTING SCREW

The tab of the rosette assembly is positioned on the opposite side of the lever catch, and align to the notch of the lever hole.

b. Use lever catch to press down catch in the hole and push inside lever all the way in until clicks into catch hole.

INSIDE LEVER

INSIDE ROSE

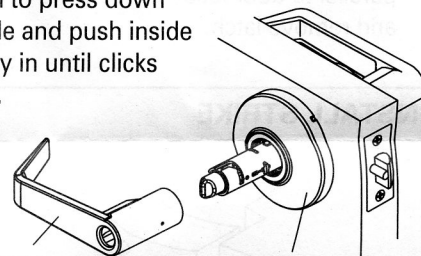

TEMPLATE

FOLD HERE ON DOOR EDGE

2-3/8" (60mm) BACKSET

2-3/4" (70mm) BACKSET

51 45 40 35
2" 1-3/4" 1-9/16" 1-3/8"

Std latch, drill 25.4mm (1") Drive in latch, drill 24.5mm (31/32") hole at center of door edge

5/16"(8mm)x2 hole

MARK CENTER OF 2-1/8"(54mm) HOLE ON DOOR FACE

2-15/32"(62.7mm)

5/32"(4mm)

2-3/4"(70mm)

