

PADLOCK

QUICKSTART GUIDE v1.0

MODEL: BGPL1338

Download the
User Manual at
www.brilliantguard.com/support



THANK YOU

Congratulations on your new padlock. This quick start guide will show you the basics of using this smart device by access through mobile APP or Smart Key (not included in this package, sold separately).

To learn more about the warranty, and frequently asked questions. Please visit www.brilliantguard.com/support or contact us as below.

Email: support@brilliantguard.com

Facebook: www.facebook.com/brilliantguard

/GETTING STARTED



Before using your padlock, please read carefully all the safety precautions in the important product + Safety information guide at www.brilliantguard.com/safety and this quick start guide.

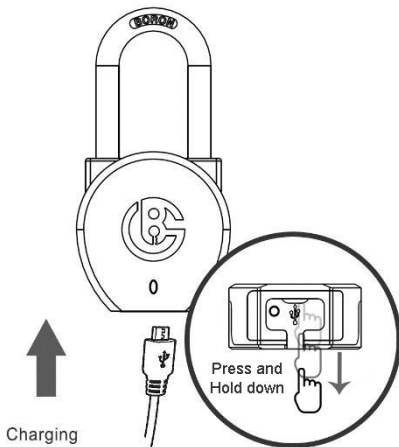

Press and hold down the latch at the bottom of the padlock and insert a USB cable to charge up. While charging, the green LED will be blinking, until full charge is reached with the green light on.

/APP DOWNLOAD

- 1) Scan the provided QR code below or search for “**BG Connect**” in the Apple App Store or Google Play Store.
- 2) Download and launch the “**BG Connect**” app on your mobile device.
- 3) **Register and** create an account. We recommended signing in with Google or Apple for quicker access.

Requirements: Mobile devices running iOS 9 or higher or Android 4.4 or higher



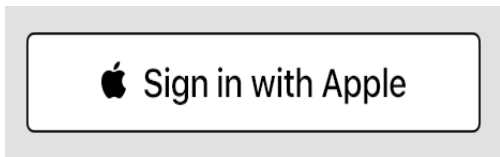

Or create by email and password, ensure you can access your email to verify and complete the registration.

/PAIRING

- 1) Press the wakeup button.
- 2) Open the Brilliant Guard app, log in to your account, press the “+” sign on the home screen, or select “Product” on the bottom menu. Choose the product category (E-Lock), select the model, and press the “+” sign to add a device.
- 3) Place the unique registration QR code (located on the page 13 of this guide). After successfully pairing with your padlock, the padlock will appear on your home screen.

Note: Make sure Bluetooth is enabled on your mobile. Hold close your padlock to the mobile during the pairing process.

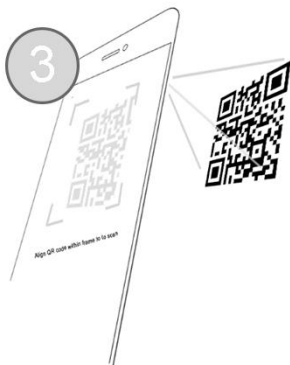
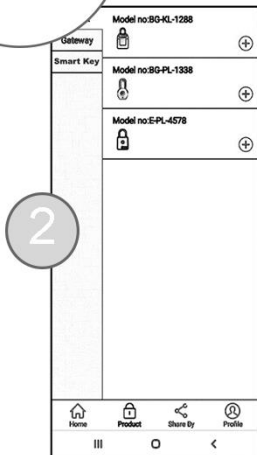
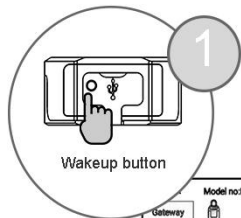

QR Code is located at page 13.

/OPEN LOCK w/ MOBILE APP

Press the Wakeup button* on the bottom of the padlock to wake-up the lock, select the padlock on the mobile app home screen, press and hold the lock icon in middle to unlock the padlock.

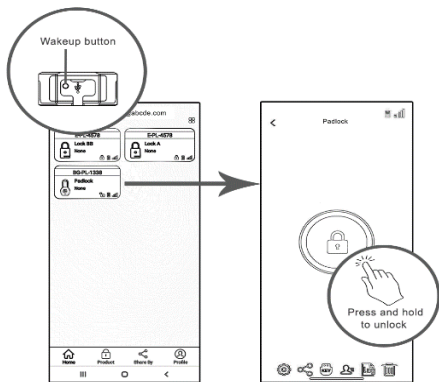

*Wakeup button is to wake up the lock-in sleep mode.

/OPEN LOCK w/ SMART KEY

(*Smart Key sold separately and not included in this package)

The smart key can open up to 100 locks manufactured by Brilliant Guard. Besides smart key also open the lock when the battery drains out. Install smart key into your mobile app, then select the smart key* on the home screen, and select access to your padlock then save.



Press and hold down the latch outward, then insert a smart key and the shackle will auto pop up.

/INFORMATION

Specification

Name: Padlock

Model: BGPL1338

Dimension: 2.5 x 4.9 x 1.2 inch

Net Weight: 508g

IP Rating: IP65

Battery Capacity: 500mAh

Battery Type: Lithium polymer

Compatible: Android 6.0/iOS

10.0 or above

Operating Temperature:

-10°C to 50°C

Connectivity: Bluetooth 5.0 BLE

Disposal and Recycling Information



All products bearing this symbol are waste electrical and electronic equipment (WEEE as in directive 2012/19/EU) which should not be mixed with unsorted household waste. Instead, you should protect human health and the environment by handing over your waste equipment to a designated collection point for the recycling of waste electrical and electronic equipment, appointed by the government or local authorities. Correct disposal and recycling will help prevent potential negative consequences to the environment and human health. Please contact the installer or local authorities for more information about the location as well as the terms and conditions of such collection points.

/HELP AND RESOURCES

DOWNLOAD USER MANUAL

To learn more about your smart key, download the user manual at www.brilliantguard.com/support

TUTORIAL VIDEOS

Watch how-to tutorials and get to learn more features in the smart key at www.brilliantguard.com/support



/REGISTRATION CODE

Please keep this registration QR code and serial number in a safe place and easy to access.



/SUPPORT

Please visit our website for customer support.

www.brilliantguard.com/support



/COMPLIANCE

REGULATORY INFORMATION

To see the list of regulatory information, refer to the important product + safety information at www.brilliantguard.com/regulatory

This device complies with Part 15 of the FCC Rules. Operation is subject to the following two conditions: (1) this device may not cause harmful interference, and (2) this device must accept any interference received, including interference that may cause undesired operation.

/CONNECT US

Send us a message or share your comment about our products and services on our Facebook or Instagram.



Facebook



Instagram