

MLRK1-VD

INSERT INSTRUCTIONS

The Command Access MLRK1 is a field-installable motorized latch-retraction kit for:

- MLRK1-VD - Von Duprin 98/99 & 33/35 series devices

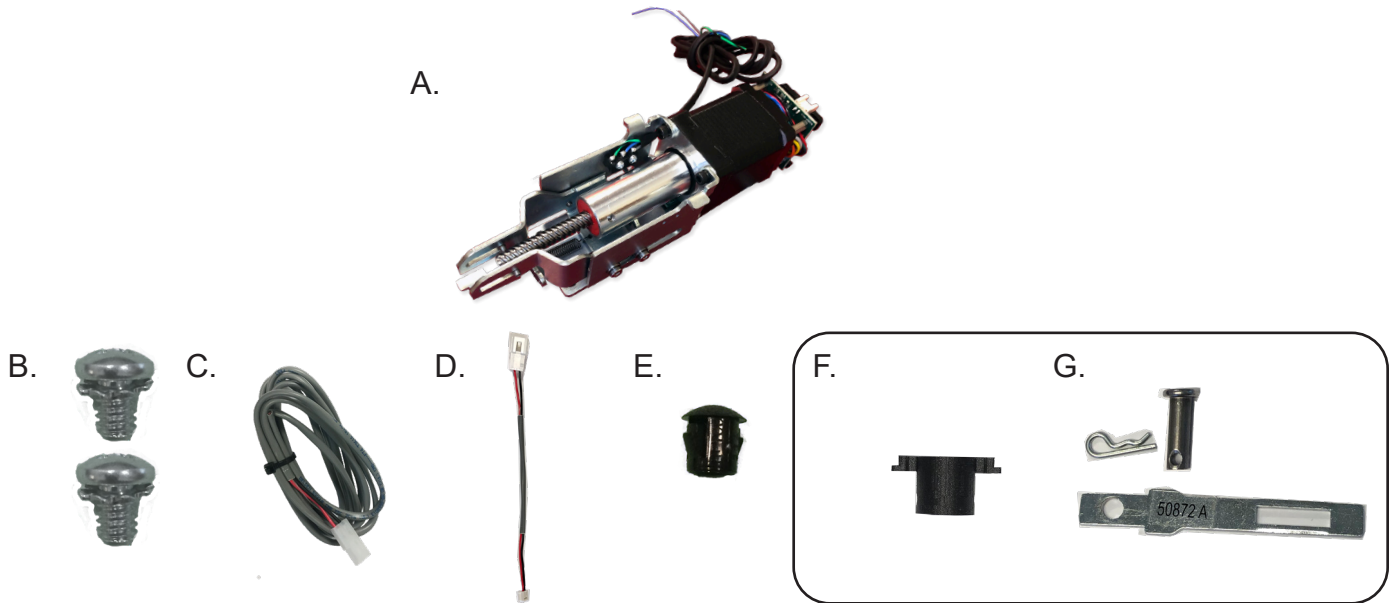

KIT INCLUDES

- A. 1- 60343 Motor Mount w/ MM5 series module
- B. 2- 40002 8/32 X 1/4" Phillips head screws
- C. 1- 50030 8' Lead w/ VD Connector
- D. 1- 50944 Molex Pigtail
- E. 1- 40144 Dogging Hole Cap

TOOLS REQUIRED

- Cordless Drill
- Hammer & Pin Punch(recommend)
- 3/16 & 3/32 drill bit
- 5/16 Nut driver (recommended)
- #2 Phillips head screwdriver

FIRE RATED DOGGING KIT

- F. 1- 50991- Fire Rated Drilling Template (Old Devices)
- G. 1- Replacement Dogging Tail Piece (40006 + 40800 + 50991)

SPECIFICATIONS:

- Input Voltage: 24VDC +/- 10%
- Average Latch Retraction Current: 900mA
- Average Holding Current: 200mA
- Wire Gauge: Minimum 18 gauge
- Direct wire run - no relays or access control units in-between power supply & module

RECOMMENDED POWER SUPPLIES:

All Command Access exit devices & field installable kits have been thoroughly cycle tested with Command Access power supplies at our factory. If you plan on using a non-Command power supply it must be a filtered & regulated linear power supply.

TECHNICAL INFORMATION

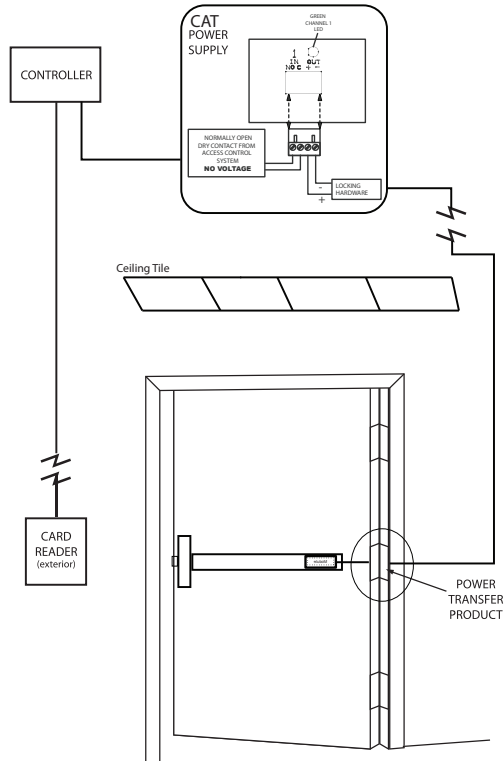

INSTALL VIDEO



SETTING PTS

****IMPORTANT INFO****

MAKE SURE TO SET PTS BEFORE FINISHING INSTALLATION

- STEP 1 -** To enter PTS mode: Depress MM5 button & apply power. The device will emit 1 SHORT beep. The device is now in PTS mode.
- STEP 2 -** While depressing the push pad, apply power. (i.e. presenting the credential to the reader).
- STEP 3 -** Continue to keep pad depressed, the device will emit 1 LONG Beep. After the beep has stopped, release the pad and now the adjustment is complete. test the new location, If not to your liking repeat the 3 steps.

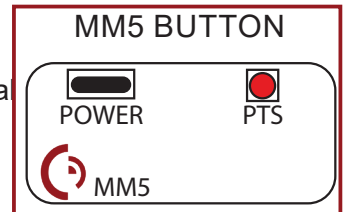

TROUBLESHOOTING & DIAGNOSTICS

BEEPS	EXPLANATION	SOLUTION
1 SHORT BEEP	PUSH TO SET	DEVICE IS READY TO RECORD ITS NEW POSITION.
1 LONG BEEP	PUSH TO SET	DEVICE HAS RECORDED IT'S NEW POSITION.
2 BEEPS	OVER VOLTAGE	> 30V UNIT WILL SHUT DOWN. CHECK VOLTAGE & ADJUST TO 24 V.
3 BEEPS	UNDER VOLTAGE	< 20V UNIT WILL SHUT DOWN. CHECK VOLTAGE & ADJUST TO 24 V.
4 BEEPS	FAILED SENSOR	VERIFY ALL 3 SENSOR WIRES ARE INSTALLED CORRECTLY. REPLACE SENSOR IF PROBLEM PERSISTS BY CONTACTING OFFICE.
5 BEEPS	RETRACTION OR DOGGING FAILURE	AFTER 1ST FAIL: 5 BEEPS THEN IMMEDIATELY ATTEMPTS TO RETRACT AGAIN. AFTER 2ND FAIL: 5 BEEPS WITH PAUSE IN-BETWEEN FOR 30 SECONDS THEN DEVICE ATTEMPTS TO RETRACT AGAIN. AFTER 3RD FAIL: 5 BEEPS EVERY 7 MINUTES, DEVICE WILL NOT ATTEMPT TO RETRACT. TO RESET: DEPRESS BAR FOR 5 SECONDS AT ANY TIME.

INSTALLATION INSTRUCTIONS

- 1. REMOVE ALL (4) SCREWS & HEAD COVER.**

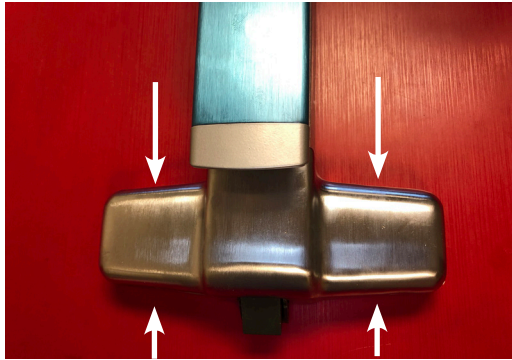

- 2. REMOVE (2) SCREWS SECURING MOUNTING BRACKET TO HOUSING.**

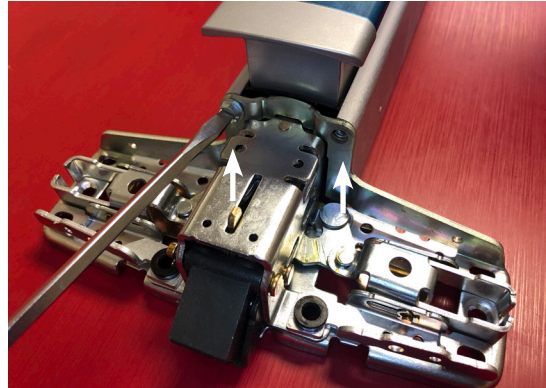

- 3. SLIDE HOUSING OFF PUSH PAD & BASERAIL.**

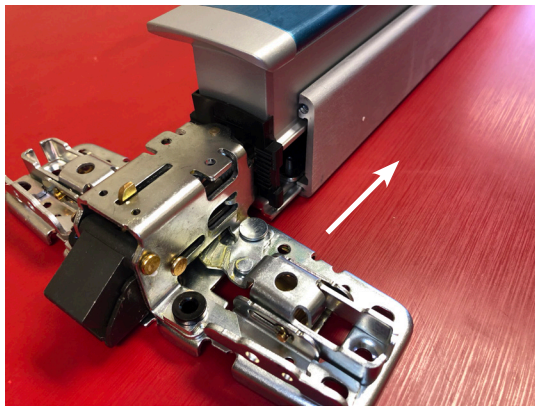

- 4. REMOVE PUSH PAD FROM BASERAIL.**



- 5. IF YOUR DEVICE HAS DOGGING, FLIP BASERAIL OVER & REMOVE (2) SCREWS SECURING DOGGING ASSEMBLY TO RAIL. IF YOU HAVE AN OLDER DEVICE WITH RIVETS, YOU WILL NEED TO DRILL THEM OUT OR USE A PIN PUNCH TO KNOCK THEM OUT.**



INSTALLATION INSTRUCTIONS

FIRE RATED DEVICES ONLY - NON-RATED DEVICES SKIP TO STEP 8



6. USE REPLACEMENT DOGGING TAIL (50872) PROVIDED, & INSERT INTO CONNECTION ROD.

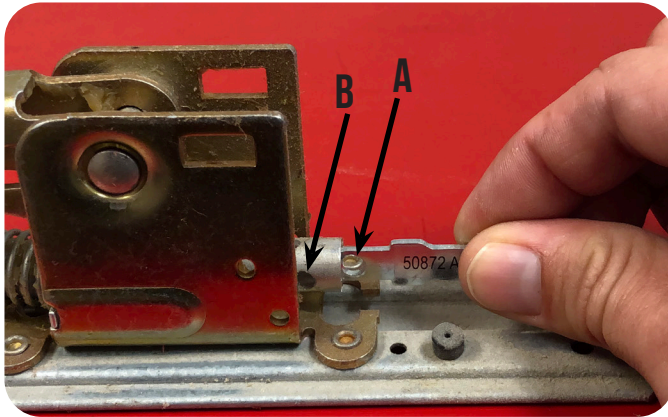

7. LINE UP HOLES A AND B, INSERT PIN AND SECURE IT WITH THE CLIP PROVIDED. IF YOU HAVE AN OLDER DEVICE WITHOUT HOLE B, PLEASE SCAN THE QR CODE FOR A VIDEO ON HOW TO USE THE PROVIDED DOGGING KIT.

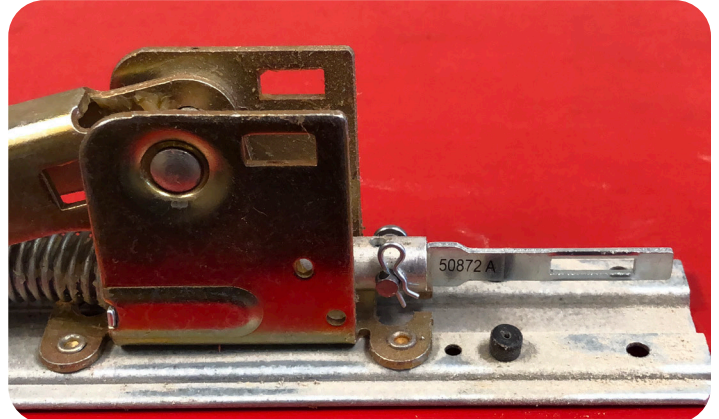

8. GRAB YOUR MOTOR AND INSERT ATTACHING BRACKET AT SLIGHT ANGLE THROUGH THE WINDOW ON THE DOGGING TAIL.



9. STRAIGHTEN KIT, DEPRESS BACK ACTIVATING BRACKET, & GENTLY PULL BACK ON THE MOTOR TO SLIDE MOUNTING BRACKET UNDERNEATH BASERAIL.

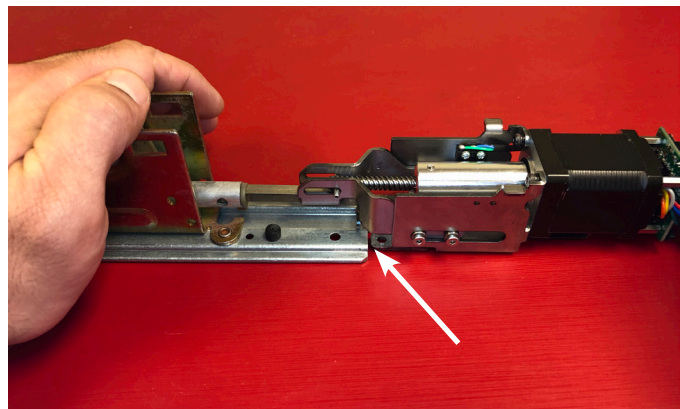
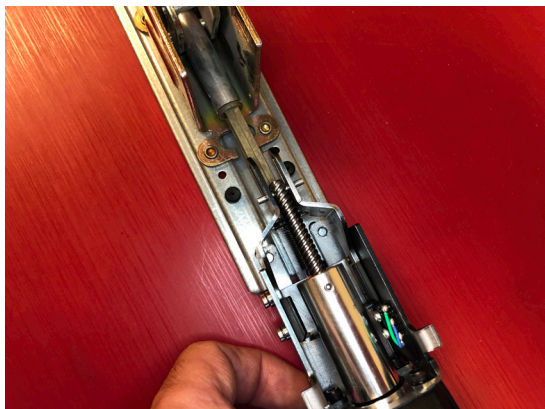

INSTALLATION INSTRUCTIONS

- 10. SECURE MOTOR KIT TO BASERAIL BY INSTALLING (2) SCREWS PROVIDED.**

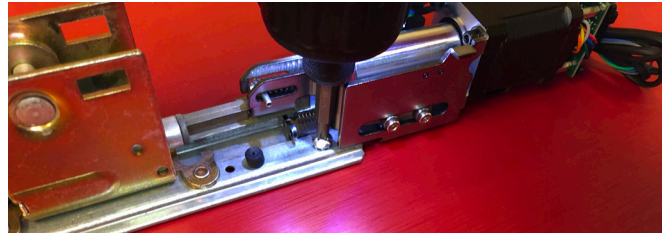
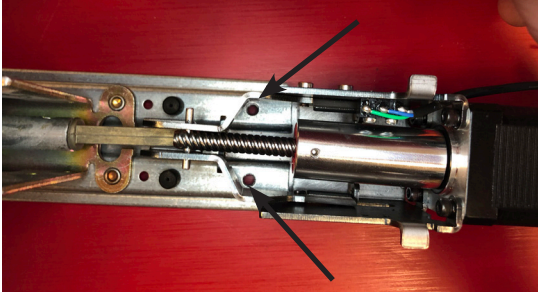

- 11. TEST MOTOR KIT ON BASERAIL TO CONFIRM IT IS FUNCTIONING PROPERLY.**

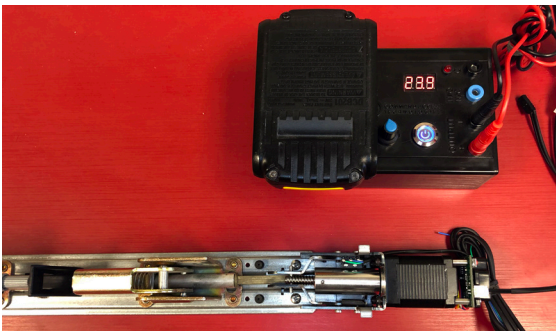

- 12. RE-INSTALL PUSH PAD ONTO BASERAIL.**



- 13. SLIDE HOUSING BACK ONTO BASERAIL & PUSH PAD. MAKE SURE THE BASERAIL & THE BLACK PUSH PAD GUIDES ARE IN THE CORRECT CHANNEL.**

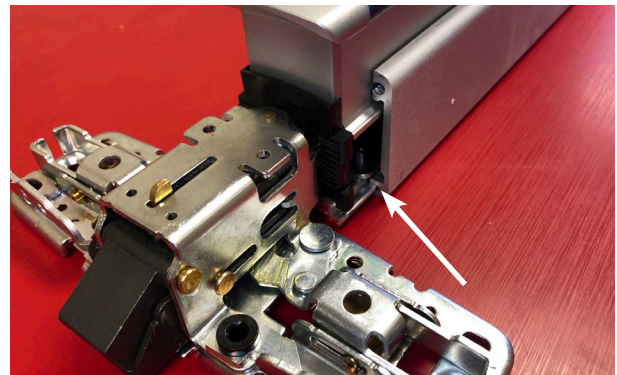
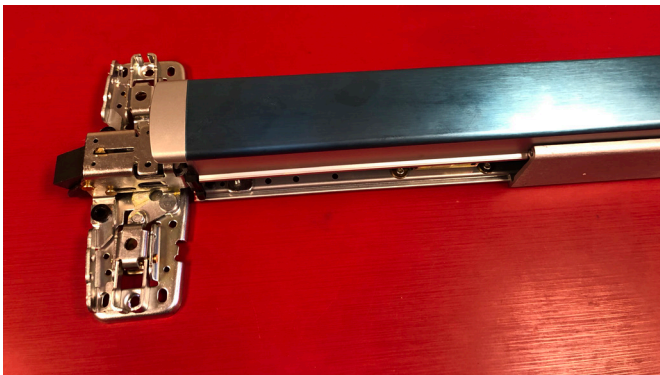

- 14. RE-INSTALL (2) SCREWS INTO MOUNTING BRACKET & HOUSING.**

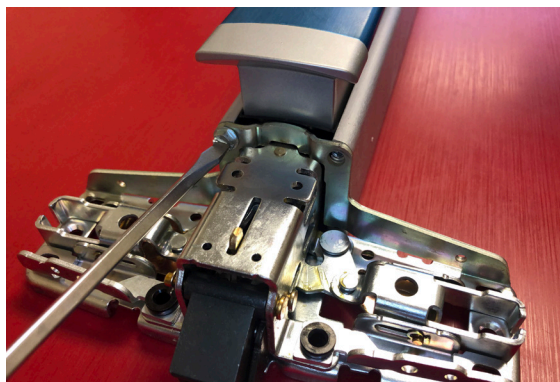

INSTALLATION INSTRUCTIONS

- 15.** NOW, WITH DEVICE REASSEMBLED SET THE PTS BY PRESSING THE RED BUTTON & APPLYING POWER. YOU WILL HEAR ONE QUICK BEEP TO LET YOU KNOW IT IS NOW IN PROGRAMMING MODE.

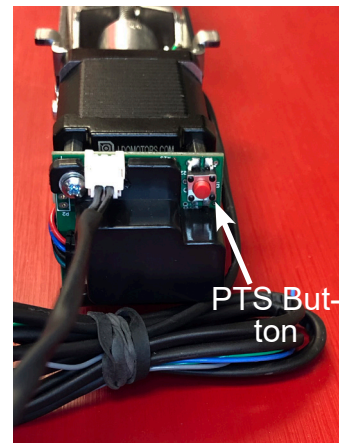
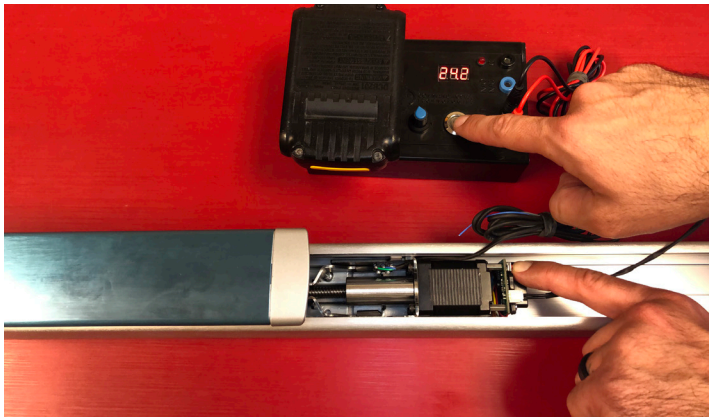

- 16.** NEXT, DEPRESS THE PUSH PAD TO THE LOCATION YOU WANT THE DEVICE TO RETRACT TO & HOLD IT THERE. APPLY POWER & YOU WILL HEAR ONE LONG BEEP. THE DEVICE HAS NOW LEARNED THAT LOCATION.

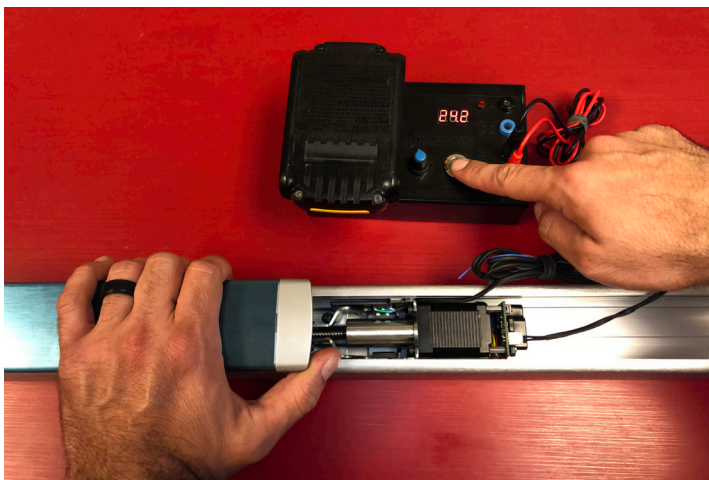

- 17.** FIRE OFF THE DEVICE A FEW TIMES TO ENSURE THE LOCATION IS CORRECT. AFTER INSTALLING THE DEVICE ON THE DOOR, RECHECK TO VERIFY THE PUSH PAD IS RETRACTING TO THE DESIRED LOCATION. IF NOT, REPEAT STEPS 15-16.

SETTING PTS

****IMPORTANT INFO****

MAKE SURE TO SET PTS BEFORE FINISHING INSTALLATION

- STEP 1 -** To enter PTS mode: Depress MM5 button & apply power. The device will emit 1 SHORT beep. The device is now in PTS mode.
- STEP 2 -** While depressing the push pad, apply power. (i.e. presenting the credential to the reader).
- STEP 3 -** Continue to keep pad depressed, the device will emit 1 LONG Beep. After the beep has stopped, release the pad and now the adjustment is complete. test the new location, If not to your liking repeat the 3 steps.

