

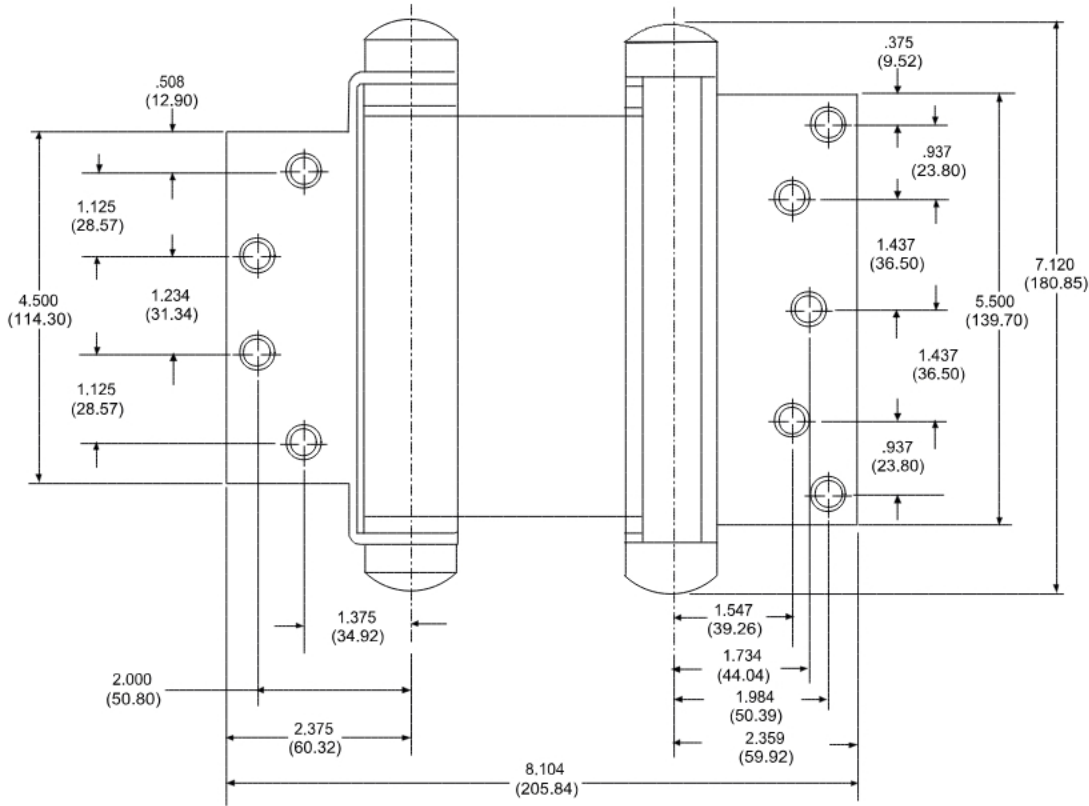

**FULL MORTISE DOUBLE ACTING SPRING HINGE TEMPLATE**

**DA**  
**6" x 4 1/2"**

**For 1-3/4" (44.4)  
 Thick Doors**

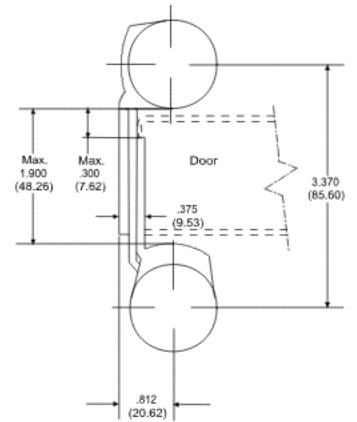
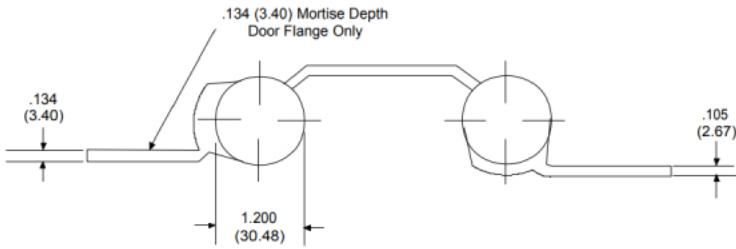

**NOTE:**

- 1 screw pack includes all machine screws (28), and 1/2 wood screws (14). ATMS & AWS also available.
- Screw size: FHMS - 12-24 x 1/2"  
 FHWS - 12 x 1 1/2"
- DO NOT USE ON DOORS WITH HINGE EDGE BEVELED.
- All hinges are ANSI template.

Template: DA8145

**CONTINUED...**

L25



**FULL MORTISE DOUBLE ACTING SPRING HINGE TEMPLATE**

**DA**  
**6" x 4 1/2"**

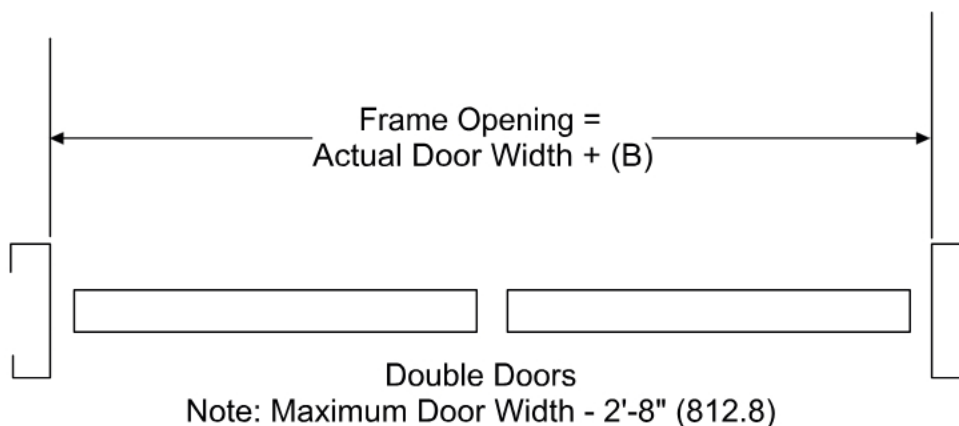
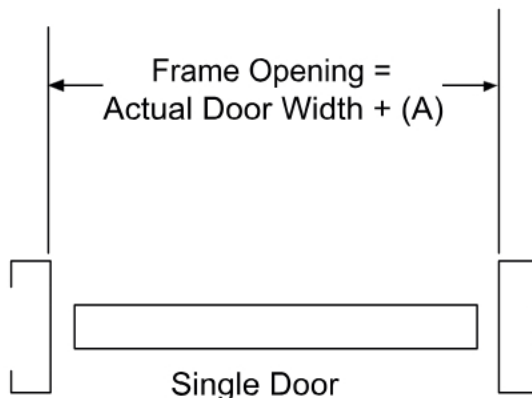

Note: Maximum Door Width - 2'-8" (812.8)

**NOTES:**

1. This hinge is not to be used on doors with hinge edge beveled.
2. Refer to catalog for door weight and hinge size.
3. Hinges should be inverted on one door of a pair for proper centering.

Frame Clearance		
Hinge Mounting	Clearance (A)	Clearance (B)
Surface Applied	1/2"	1 1/32"
Door Flange Mortised	7/16"	13/16"