

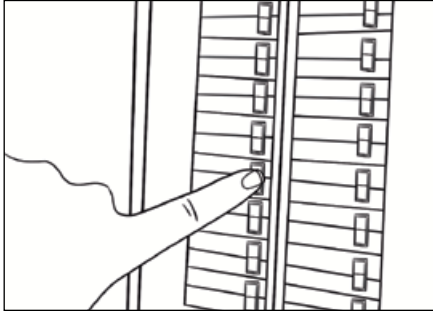

# kul plates Installation Instructions

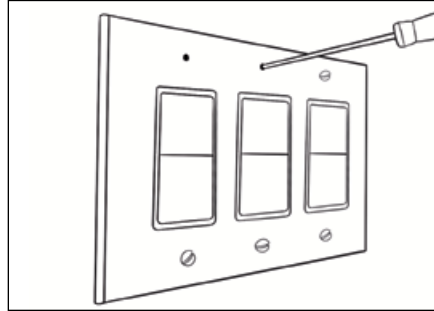

1. Turn off power



2. Remove old cover plate

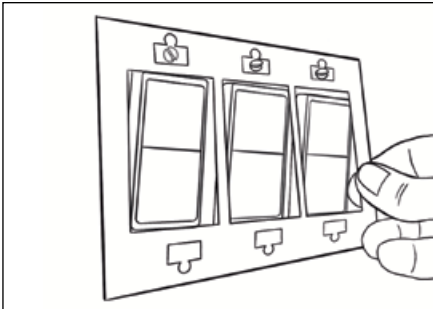

3. Align backing plate into place

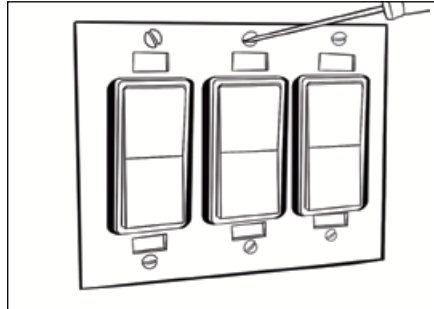

4. Tighten included screws down, but don't over tighten

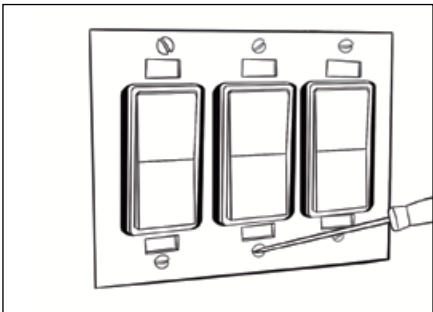

5. Adjust switches to level them out as needed



6. Snap on kul plate

## kul plates Installation Troubleshooting

---

If the plate does not sit flat, this may be because the wall is not flat. Plates can be formed to meet with wall imperfections. Just bend it a little at a time until the desired fit is achieved.

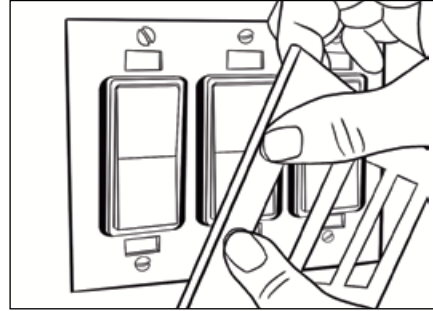
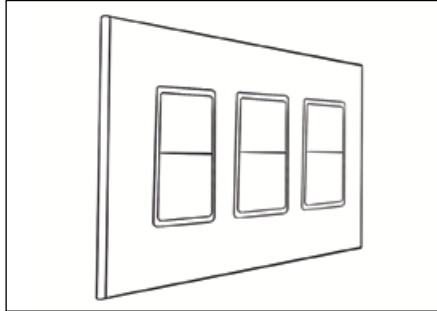

## Removal of kul plates

---

There is a slot on the bottom which can be used to grip the kul plate. You can use a screw driver or even your finger nail.

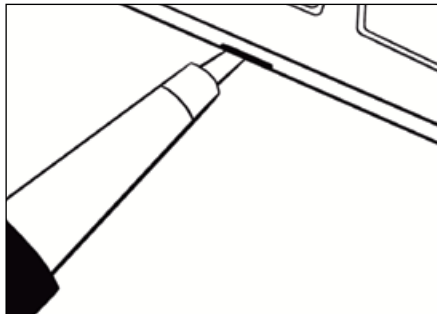

## Warranty

---

kul plate offers a one year warranty that covers replacement parts due to any defect in material.

Please contact us if you have any issues and send photos to [support@kulgrilles.com](mailto:support@kulgrilles.com)



# kul plates Sizing Specs

kul plates are a screwless retrofit cover plate that replaces new and existing switch and socket cover plates with a fresh and modern look.

What makes kul plates different from other covers, is the use of high-powered magnets, so it can be removed and replaced for cleaning, painting and maintenance.

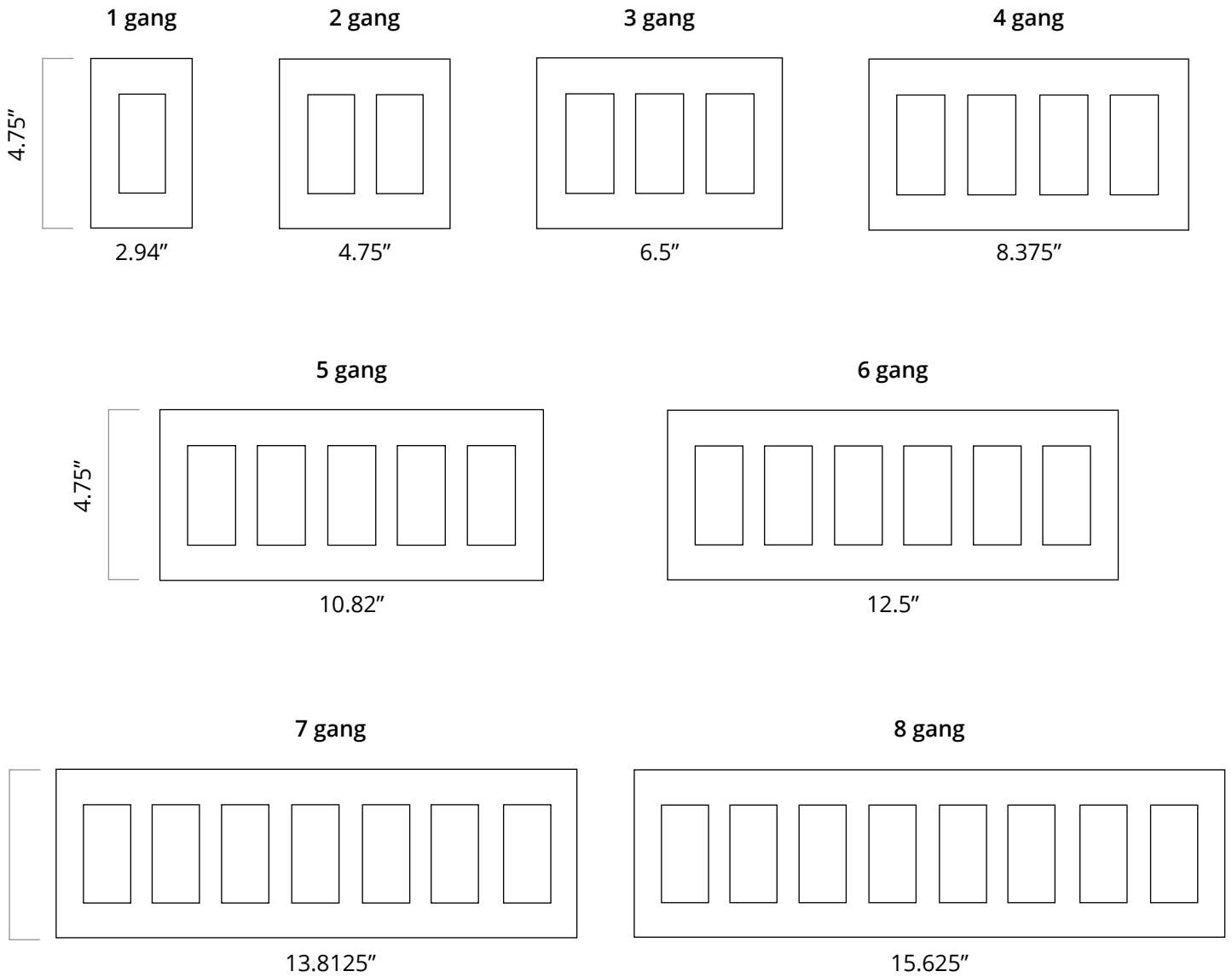



## kul plates Finishes

kul plates are a screwless retrofit cover plate that replaces new and existing switch and socket cover plates with a fresh and modern look.

What makes kul plates different from other covers, is the use of high-powered magnets, so it can be removed and replaced for cleaning, painting and maintenance.

From our stainless steel finish to our durable powder coat paint and anodized finishes, we offer a wide range of architecturally appealing options to suit every project.



Glacier Frost



Stainless Steel



Anodized Matte Black



Anodized Matte Graphite



Anodized Matte Gold